



Leather Element F0032 Fingerprint Drawer Lock User Manual

[Home](#) » [Leather Element](#) » Leather Element F0032 Fingerprint Drawer Lock User Manual 

Contents

- [1 Leather Element F0032 Fingerprint Drawer Lock](#)
- [2 Product parameters](#)
- [3 Installation instructions](#)
- [4 Fingerprint unlock](#)
- [5 Documents / Resources](#)
 - [5.1 References](#)

Leather Element F0032 Fingerprint Drawer Lock



Thank you for purchasing our products
Please read carefully the manual before installation and use

Product parameters

- Name: Fingerprint Drawer Lock

- Operating voltage: 3.3V – 4.2V,
- standby current: 30uA
- Operating temperature: -12 °C – +68 °C
- Number of users: 3
- administrator users; 20 normal users

Warmly reminding

Charging: during normal use, please charge the battery timely when the red light flashes. It can be charged by connecting to a normal Android interface charger. When charging normally, the red light keeps always on. When the battery is fully charged, the red light will turn off automatically. The charging time lasts for 1 5-20 minutes.

Installation instructions

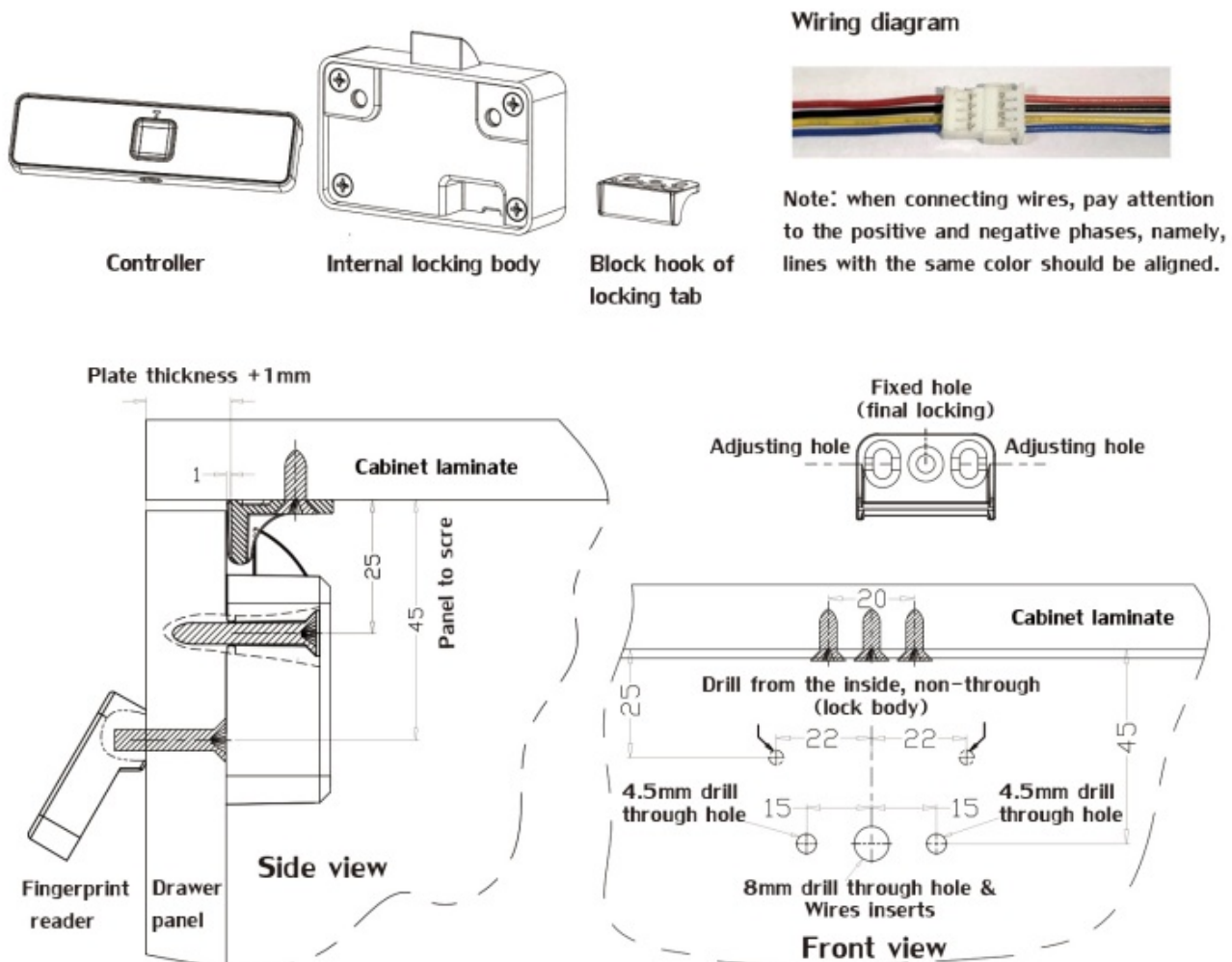

Fingerprint unlock

1. In the initial state, any fingerprint will unlock the system.
2. In the user-registered status, only the registered fingerprint can unlock the system.
3. When the fingerprint is correct, the green light turns on.
4. When the fingerprint is wrong, the red light turns on.

Fingerprint entry method:

1. The first three registered fingerprints are regarded as administrator users, and subsequent fingerprints can only be registered with the verification of the first three fingerprints (administrator users).

Steps of initial registration (illustration)

(press and hold 5 seconds — press 5 times — press and hold 5 seconds — press 10 times — success)

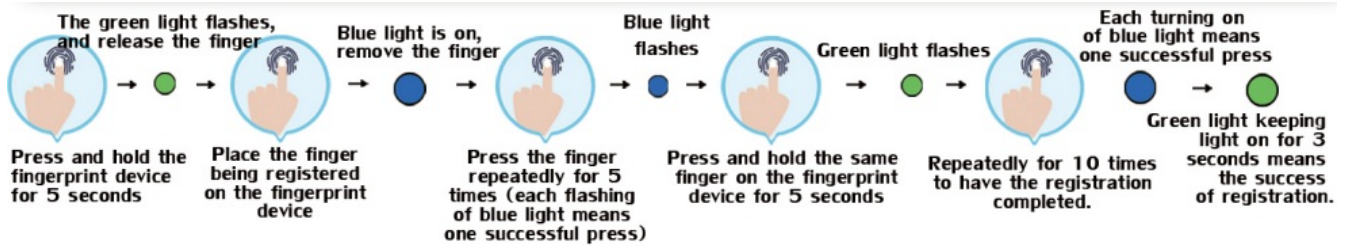

- Steps of initial fingerprint registration: Step 1, input the fingerprint of the administrator users (host): press and hold the fingerprint device for 5 seconds, the green light will flash, and then release the finger. Step 2: put the finger to be registered on the fingerprint device, remove the finger until the blue light turns on, repeat this for 5 times, and the blue light will flash; step 3, press the fingerprint device with the same finger for 5 seconds, the green light will flash, and repeats this for 10 times (each turning on of blue light indicates a successful press). the green light's keeping lighting up for 3 seconds means that the registration is successful.

Registered normal users (Illustration)

(Press and hold for 5 seconds — Verify administrator users — Press 10 times — Success)

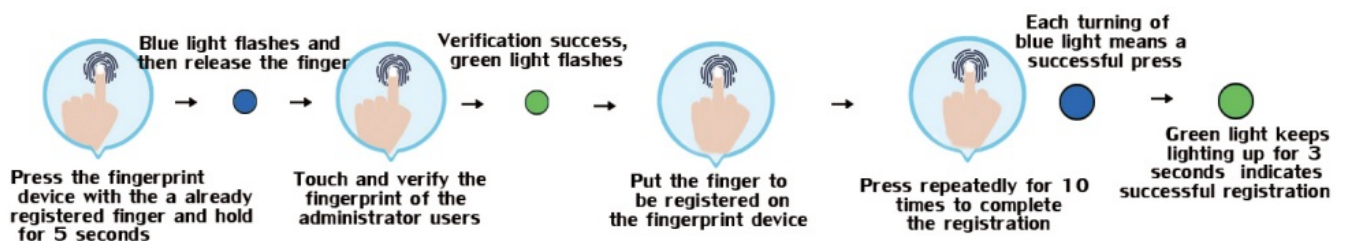

- Registration of normal user: press the fingerprint device with the registered finger for 5 seconds, the blue light will flash, and then release the finger. Verify the administrator fingerprint. If the verification is passed, the green light will flash. Place the fingerprint to be registered on the fingerprint device and press it repeatedly for 10 times (each turning on of the blue light indicates one successful press). If the green light keeps lighting up for 3 seconds, the input is successful. The subsequent fingerprint registration is completed following the above steps.

Restore factory settings

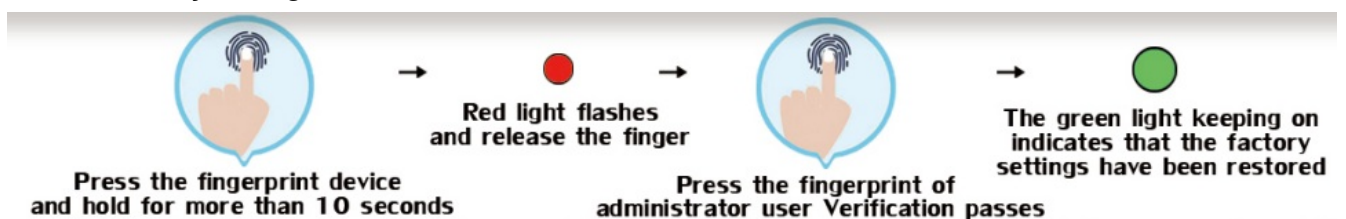

- Restore factory settings: press the fingerprint device with any finger and hold for more than 10 seconds, then the red light will flash and release the finger. Press the fingerprint of administrator users (the first or second fingerprint registered) to have the verification passed, and then the green light will keep lighting on, which indicates that the factory settings have been restored.

Tips:

- The system will enter sleep automatically if no operation occurs within 10 seconds in the process of fingerprint input or verification.
- Please replace another finger if the red light flashes twice when repeatedly inputs the fingerprint.
- Lights description:

Red light keeps on:
in charging



Red light flashes:
waiting for reset



Green light flashes:
waits for fingerprint input



Green light turns on:
fingerprint is correct



Blue light turns on:
corresponding fingerprint
input is successful



Red light turns on:
fingerprint error



Blue light flashes:
waits for verification of
administrator users

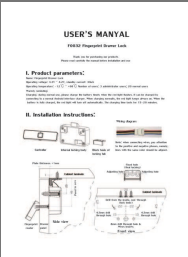

Documents / Resources

	<p>Leather Element F0032 Fingerprint Drawer Lock [pdf] User Manual F0032 Fingerprint Drawer Lock, F0032, Fingerprint Drawer Lock, Drawer Lock, Lock</p>
---	---

References

- [User Manual](#)

[Manuals+.](#) [Privacy Policy](#)

This website is an independent publication and is neither affiliated with nor endorsed by any of the trademark owners. The "Bluetooth®" word mark and logos are registered trademarks owned by Bluetooth SIG, Inc. The "Wi-Fi®" word mark and logos are registered trademarks owned by the Wi-Fi Alliance. Any use of these marks on this website does not imply any affiliation with or endorsement.