



6034  
GO-WITH-ME  
ABC  
BACKPACK



## LeapFrog 6034 Go-with-Me ABC Backpack User's Guide

[Home](#) » [LeapFrog](#) » LeapFrog 6034 Go-with-Me ABC Backpack User's Guide 

### Contents

- [1 LeapFrog 6034 Go-with-Me ABC Backpack](#)
- [2 INTRODUCTION](#)
- [3 GETTING STARTED](#)
- [4 ASSEMBLY INSTRUCTIONS](#)
- [5 PRODUCT FEATURES](#)
- [6 ACTIVITIES](#)
- [7 CARE & MAINTENANCE](#)
- [8 TROUBLESHOOTING](#)
- [9 FREQUENTLY ASKED QUESTIONS](#)
- [10 References](#)
- [11 Related Posts](#)



**LeapFrog 6034 Go-with-Me ABC Backpack**



## INTRODUCTION

Thank you for purchasing the Go-with-Me ABC Backpack™! Pack your bag and get ready to have a blast learning letters, writing and drawing with Mr. Pencil.

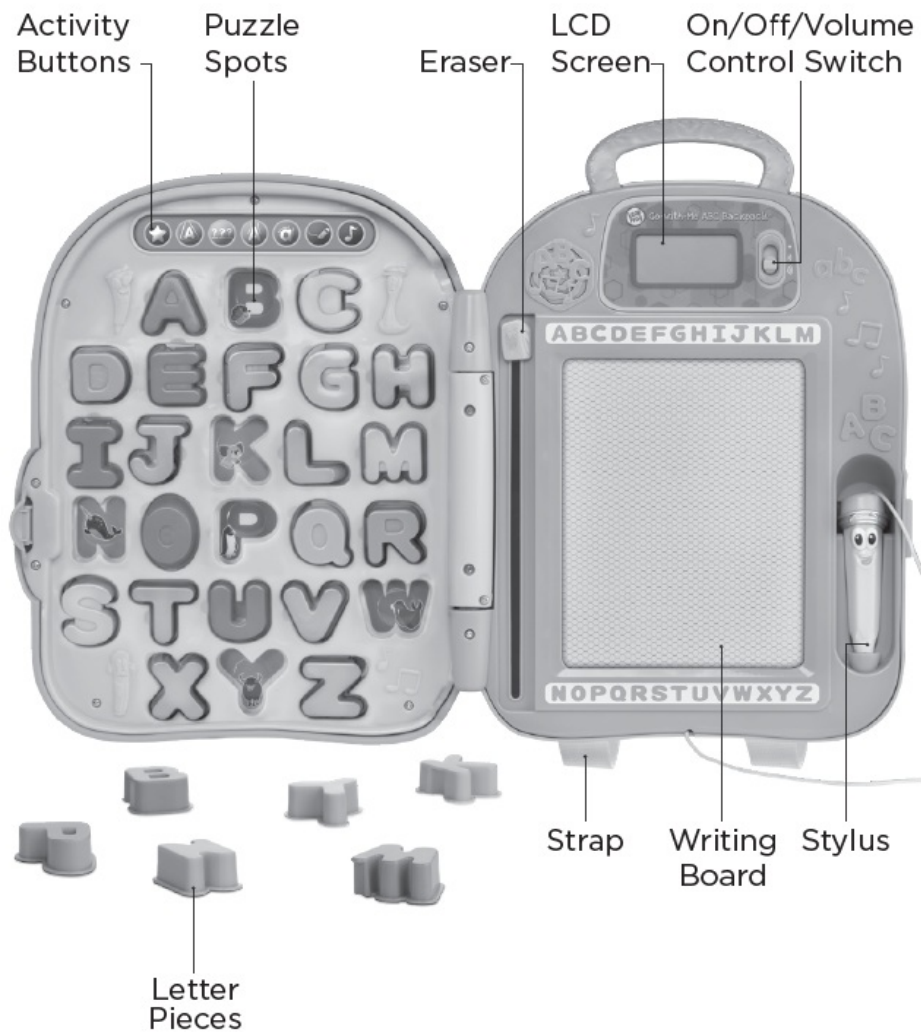

## INCLUDED IN THIS PACKAGE

- One Go-with-Me ABC Backpack™
- 26 letter pieces
- Two backpack straps
- One parent's guide

**WARNING:** All packing materials, such as tape, plastic sheets, packaging locks, removable tags, cable ties and packaging screws are not part of this toy, and should be discarded for your child's safety.

**NOTE:** Please keep this parent's guide as it contains important information.

**Unlock the packaging locks:**

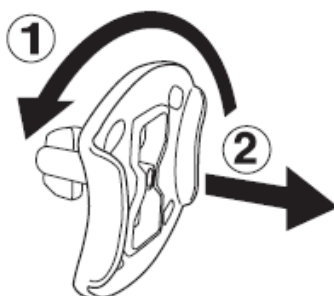

1. Rotate the packaging locks 90 degrees counterclockwise.
2. Pull out the packaging locks and discard.

## GETTING STARTED

### BATTERY INSTALLATION

1. Make sure the unit is turned OFF.
2. Locate the battery cover on the bottom of the unit.
3. Use a screwdriver or a coin to loosen the screw and open the battery cover.
4. Install 2 new AA (AM-3/LR6) batteries into the battery box as illustrated. (The use of new alkaline batteries is recommended for maximum performance.)
5. Replace the battery cover and tighten the screw to secure.

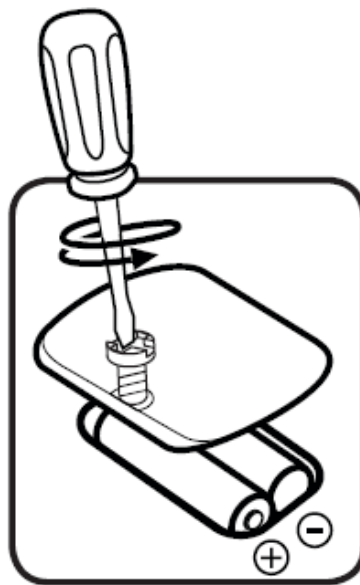

### BATTERY NOTICE

- Use new alkaline batteries for maximum performance.
- Use only batteries of the same or equivalent type as recommended.
- Do not mix different types of batteries: alkaline, standard (carbon-zinc) or rechargeable, or new and used batteries.
- Do not use damaged batteries.
- Insert batteries with the correct polarity.
- Do not short-circuit the battery terminals.
- Remove exhausted batteries from the toy.
- Remove batteries during long periods of non-use.
- Do not dispose of batteries in fire.
- Do not charge non-rechargeable batteries.
- Remove rechargeable batteries from the toy before charging (if removable).
- Rechargeable batteries are only to be charged under adult supervision.

## ASSEMBLY INSTRUCTIONS

The Go-with-Me ABC Backpack™ comes with backpack straps that can be attached or removed at any time. Follow the steps below to attach these straps:

**NOTE:** Adult operation needed.

- Insert one end of the strap through the slot on the top and the other end through the slot on the bottom.

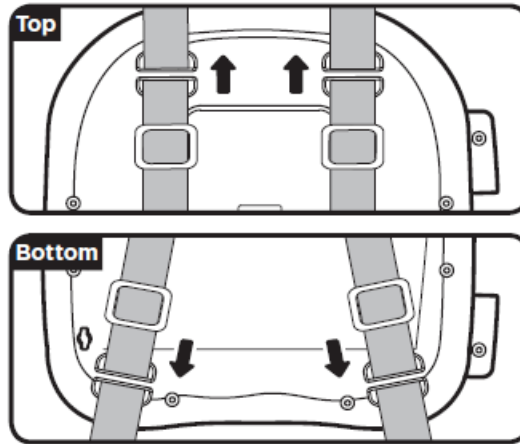

- Loop the strap through the buckle. Secure both ends of the strap as shown. Repeat for the second strap.

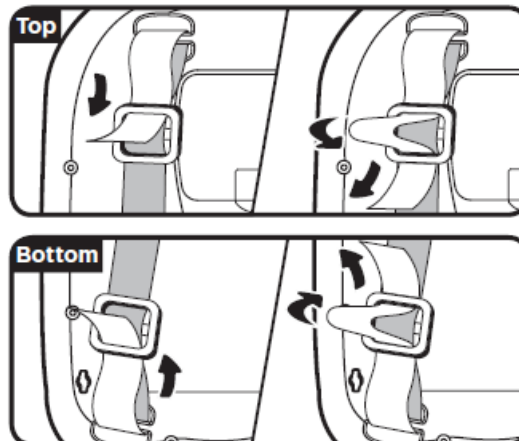

## PRODUCT FEATURES

### 1. On/Off/Volume Control Switch

Slide the On/Off/Volume Control Switch to turn the toy on and select the volume.

### 2. LCD screen

The LCD Screen displays letters, letter stroke order and fun animations.

### 3. Activity Buttons

Press the Activity Buttons to select an activity.

### 4. Letters & Puzzle Spots

Press the Letter Pieces into their Puzzle Spots to trigger fun audio.

### 5. Stylus, Writing Board & Eraser

Use the Stylus to draw on the Writing Board. Slide the Eraser up and down to clear the board.

**NOTE:** For best results, write slowly on the Writing Board using the Stylus. Clean the writing by sliding the Eraser slowly several times.



## 6. Backpack Straps

Attach the Straps to carry just like a backpack.

## 7. Low Battery Indicator

When the batteries run low, this icon  will appear on the screen, flash twice and the unit will power off. Remove the old batteries and replace with a new set.



## ACTIVITIES



### 1. Letter Zoo

Press a Letter Piece into its Puzzle Spot to hear the letter name, letter sound and an animal that begins with

that letter.



## 2. Meet the Letters

Listen to the letter names, then try to find them in this silly game.



## 3. Mystery Word

Listen to the letter sounds, then try to find the correct letters. Fill in the blanks to sound out the mystery word.



## 4. Uppercase Letters

Follow the animations to learn how to write uppercase letters using the Stylus and Writing Board.



## 5. Lowercase Letters

Follow the animations to learn how to write lowercase letters using the Stylus and Writing Board.



## 6. Letter Animals

Follow the animations to learn how to turn letters into animals using the Stylus and Writing Board.



## 7. Music

Press a Letter Piece into its Puzzle Spot to hear the Letter Parade song.

## CARE & MAINTENANCE

1. Keep the unit clean by wiping it with a slightly damp cloth.
2. Keep the unit out of direct sunlight and away from any direct heat sources.
3. Remove the batteries when the unit is not in use for an extended period of time.
4. Do not drop the unit on a hard surface and do not expose the unit to excess moisture.

## TROUBLESHOOTING

**If for some reason the program/activity stops working, please follow these steps:**

1. Turn the unit OFF.
2. Interrupt the power supply by removing the batteries.
3. Let the unit stand for a few minutes, then replace the batteries.
4. Turn the unit back ON. The unit will now be ready to play again.
5. If the unit still does not work, replace it with an entire set of new batteries.

### Environmental phenomena.

- The unit may malfunction if subjected to radio-frequency interference.
- It should revert to normal operation when the interference stops.
- If not, it may become necessary to turn the power OFF and back ON or remove and reinstall the batteries.



- In the unlikely event of an electrostatic discharge, the unit may malfunction and lose memory, requiring the user to reset the device by removing and reinstalling the batteries.

## IMPORTANT NOTE

If the problem persists, please call our Consumer Services Department at 1-[800-701-5327](tel:800-701-5327) in the U.S. or email [support@leapfrog.com](mailto:support@leapfrog.com). Creating and developing LeapFrog® products is accompanied by a responsibility that we take very seriously. We make every effort to ensure the accuracy of the information, which forms the value of our products. However, errors sometimes can occur. It is important for you to know that we stand behind our products and encourage you to contact us with any problems and/or suggestions you might have. A service representative will be happy to help you.

## NOTE

This equipment has been tested and found to comply with the limits for a Class B digital device, pursuant to Part 15 of the FCC Rules. These limits are designed to provide reasonable protection against harmful interference in a residential installation. This equipment generates, uses and can radiate radio frequency energy and, if not installed and used in accordance with the instructions, may cause harmful interference to radio communications. However, there is no guarantee that interference will not occur in a particular installation. If this equipment does cause harmful interference to radio or television reception, which can be determined by turning the equipment off and on, the user is encouraged to try to correct the interference by one or more of the following measures:

- Reorient or relocate the receiving antenna.
- Increase the separation between the equipment and the receiver.
- Connect the equipment to an outlet on a circuit different from that to which the receiver is connected.
- Consult the dealer or an experienced radio/TV technician for help.

## THIS DEVICE COMPLIES WITH PART 15 OF THE FCC RULES. OPERATION IS SUBJECT TO THE FOLLOWING TWO CONDITIONS:

1. THIS DEVICE MAY NOT CAUSE HARMFUL INTERFERENCE, AND
2. THIS DEVICE MUST ACCEPT ANY INTERFERENCE RECEIVED, INCLUDING INTERFERENCE THAT MAY CAUSE UNDESIRE OPERATION.

CAN ICES-3 (B)/NMB-3(B)

## Supplier's Declaration of Conformity

- **Trade Name:** LeapFrog®
- **Model:** 6034
- **Responsible Party:** LeapFrog Enterprises, Inc.
- **Address:** 6401 Hollis Street, Suite 100, Emeryville, CA 94608
- **Website:** [leapfrog.com](http://leapfrog.com)

**Caution:** Changes or modifications not expressly approved by the party responsible for compliance could void the user's authority to operate the equipment.

Visit our website for more information about our products, downloads, resources, and more. [leapfrog.com](http://leapfrog.com) For warranty information, please visit [leapfrog.com/warranty](http://leapfrog.com/warranty).



## FREQUENTLY ASKED QUESTIONS

What is the LeapFrog 6034 Go-with-Me ABC Backpack?

The LeapFrog 6034 Go-with-Me ABC Backpack is an educational toy backpack designed for young children, featuring interactive elements to help them learn the alphabet and more.

What are the dimensions of the LeapFrog 6034 Go-with-Me ABC Backpack?

The LeapFrog 6034 Go-with-Me ABC Backpack measures 9.8 x 2.8 x 12.7 inches, making it a compact and child-friendly size.

How much does the LeapFrog 6034 Go-with-Me ABC Backpack weigh?

The backpack weighs 2.54 pounds, which is lightweight and easy for young children to carry.

What is the price of the LeapFrog 6034 Go-with-Me ABC Backpack?

The LeapFrog 6034 Go-with-Me ABC Backpack is priced at \$43.22.

What age range is the LeapFrog 6034 Go-with-Me ABC Backpack suitable for?

The manufacturer recommends the LeapFrog 6034 Go-with-Me ABC Backpack for children aged 36 months to 6 years.

What type of batteries does the LeapFrog 6034 Go-with-Me ABC Backpack require?

The LeapFrog 6034 Go-with-Me ABC Backpack requires 2 AA batteries for operation.

Who is the manufacturer of the LeapFrog 6034 Go-with-Me ABC Backpack?

The LeapFrog 6034 Go-with-Me ABC Backpack is manufactured by VTech.

What educational features does the LeapFrog 6034 Go-with-Me ABC Backpack have?

The backpack features interactive elements designed to teach children the alphabet, including letters, words, and sounds.

How does the LeapFrog 6034 Go-with-Me ABC Backpack help with learning?

The backpack incorporates interactive learning features that engage children in learning the alphabet through play, helping to reinforce letter recognition and vocabulary.

How durable is the LeapFrog 6034 Go-with-Me ABC Backpack?

The backpack is designed to be durable and withstand the wear and tear of regular use by young children.

What are the interactive features of the LeapFrog 6034 Go-with-Me ABC Backpack?

Interactive features include buttons that activate sounds and lights related to the alphabet and educational content.

Why is my LeapFrog 6034 Go-with-Me ABC Backpack not turning on?

Ensure the batteries are correctly installed and fully charged. If the backpack still doesn't turn on, try replacing the batteries with new ones, and check that the battery compartment is clean and free from corrosion.

What should I do if the LeapFrog 6034 Go-with-Me ABC Backpack is not responding to button presses?

Check to see if the backpack is in the correct mode. If it's still unresponsive, turn the device off and back on again. If the issue persists, the internal components might need inspection or repair.

The sound on the LeapFrog 6034 Go-with-Me ABC Backpack is too low. How can I fix this?

Check the volume settings and adjust them using the appropriate buttons. Also, ensure that the speaker is not obstructed by any debris or dirt, which could be muffling the sound.

Why is the LeapFrog 6034 Go-with-Me ABC Backpack not recognizing the alphabet letters correctly?

Ensure that the letters are being placed correctly in the designated slots. If the issue persists, clean the slots and the letters to remove any dust or debris that might be affecting the sensors.

**DOWNLOAD THE PDF LINK:** [LeapFrog 6034 Go-with-Me ABC Backpack User's Guide](#)

**REFERENCE:** [LeapFrog 6034 Go-with-Me ABC Backpack User's Guide-Device.Report](#)

## References

- [User Manual](#)

[Manuals+](#), [Privacy Policy](#)

This website is an independent publication and is neither affiliated with nor endorsed by any of the trademark owners. The "Bluetooth®" word mark and logos are registered trademarks owned by Bluetooth SIG, Inc. The "Wi-Fi®" word mark and logos are registered trademarks owned by the Wi-Fi Alliance. Any use of these marks on this website does not imply any affiliation with or endorsement.