



## LeapFrog Ironing Time Learning Set Instruction Manual

[Home](#) » [LeapFrog](#) » LeapFrog Ironing Time Learning Set Instruction Manual 



**Ironing Time Learning Set™**



**Instruction Manual**

**This manual contains important information. Please save it for future reference.**

**91-003352-002 US**

## Contents

- 1 INTRODUCTION
- 2 INCLUDED IN THE PACKAGE
- 3 GETTING STARTED
- 4 IMPORTANT: BATTERY INFORMATION
- 5 RECHARGEABLE BATTERIES
- 6 PRODUCT FEATURES
- 7 ACTIVITIES
  - 7.1 Toy-Recognition Activities
- 8 Exploratory Activities
- 9 CARE & MAINTENANCE
- 10 TROUBLESHOOTING
- 11 Environmental Phenomena
- 12 Documents / Resources
- 13 Related Posts

## INTRODUCTION

Thank you for purchasing the LeapFrog® Ironing Time Learning Set™! Press into learning as you explore numbers, colors, and shapes, and sing the alphabet song.

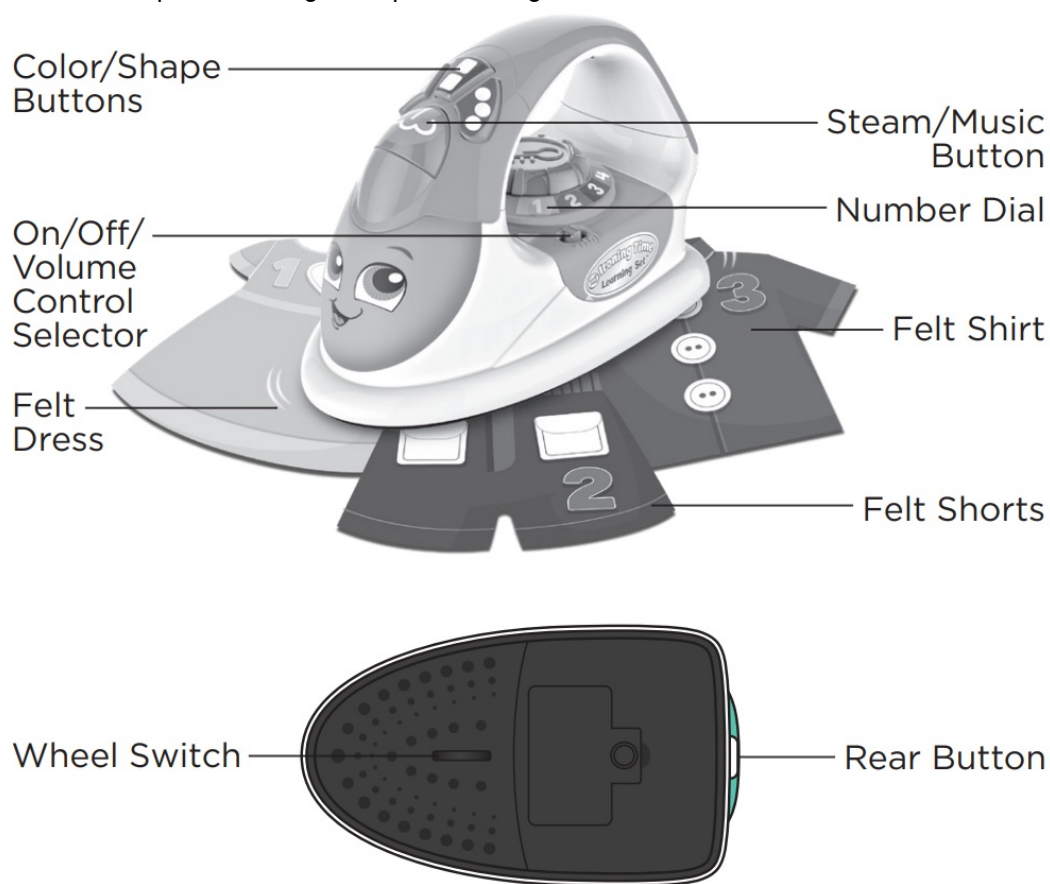

## INCLUDED IN THE PACKAGE

- Ironing Time Learning Set™
- Felt dress
- Felt shorts
- Felt shirt
- Quick Start Guide

**WARNING**

All packing materials such as tape, plastic sheets, packaging locks, removable tags, cable ties, and packaging screws are not part of this toy and should be discarded for your child's safety.

**NOTE**

Please save this Instruction Manual as it contains important information.

**ATTENTION**

Pour la sécurité de votre enfant, débarrassez-vous de tous les produits d'emballage tels que rubans adhésifs, feuilles de plastique, attaches, étiquettes et vis d'emballage. Ils ne font pas partie du jouet.

**NOTE**

Il est conseillé de sauvegarder ce manuel d'instructions car il comporte des informations importantes.

**NOTE**

Iron is surface washable. Felt clothes are hand washed only.

**NOTE**

Please cut and discard the cords before playing with the unit. The cords are not part of the product and should be discarded for your child's safety.

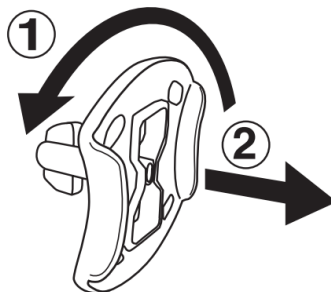
**Unlock the Packaging Locks**

1. Rotate the packaging locks 90 degrees counterclockwise.
2. Pull out the packaging locks and discard them.

**GETTING STARTED****BATTERY REMOVAL AND INSTALLATION**

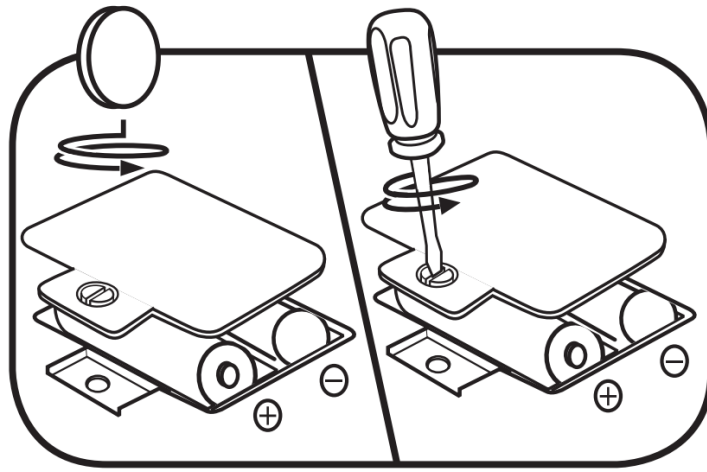

1. Make sure the unit is turned
2. Find the battery cover located on the back of the unit, use a screwdriver to loosen the screw and then open the battery cover
3. Remove old batteries by pulling up on one end of each
4. Install 2 new AA (AM-3/LR6) batteries following the diagram inside the battery box. (For best performance, alkaline batteries or fully charged Ni-MH rechargeable batteries are )
5. Replace the battery cover and tighten the screw to secure.



**WARNING:**

Adult assembly is required for battery installation.  
Keep batteries out of reach of children.

**IMPORTANT: BATTERY INFORMATION**

- Insert batteries with the correct polarity (+ and -).
- Do not mix old and new batteries.
- Do not mix alkaline, standard (carbon-zinc), or rechargeable
- Only batteries of the same or equivalent type as recommended are to be used.
- Do not short-circuit the supply terminals.
- Remove batteries during long periods of non-use.
- Remove exhausted batteries from the toy.
- Dispose of batteries safely. Do not dispose of batteries in a fire.

**RECHARGEABLE BATTERIES**

- Remove rechargeable batteries from the toy before
- Rechargeable batteries are only to be charged under adult supervision.
- Do not charge non-rechargeable batteries.

**PRODUCT FEATURES**

1. **On/Off/Volume Control Selector**



Slide the On/Off/Volume Control Selector to turn the toy on and select Low or High volume

## 2. Color/Shape Buttons

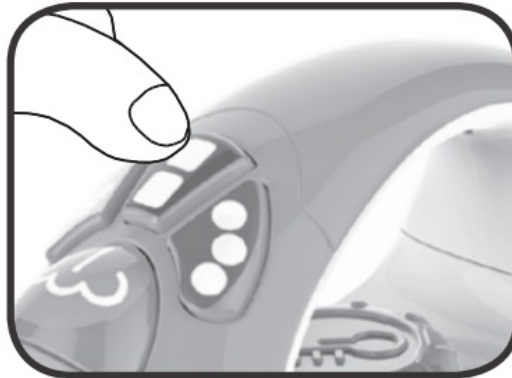

Press to hear silly color and shape phrases and fun sounds.

## 3. Number Dial



Press to hear temperature phrases and engaging sounds.

## 4. Steam/Music Button

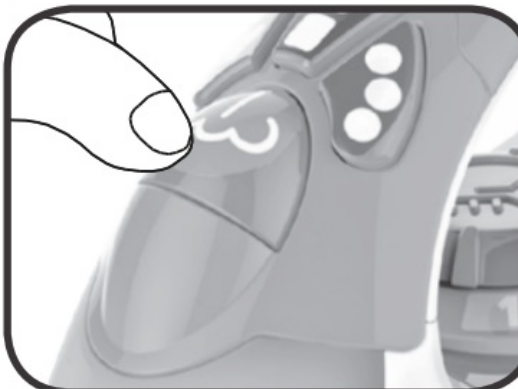

Press to hear realistic steam sounds, three delightful learning songs, and four melodies.

## 5. Wheel Switch

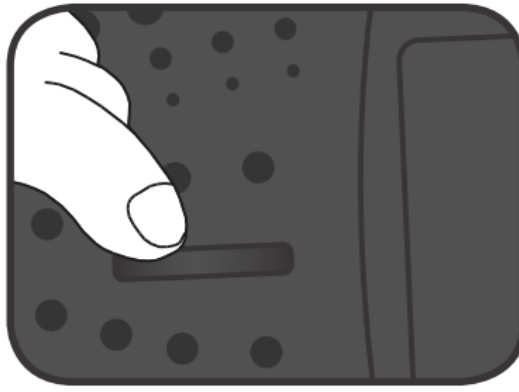

Push the iron forwards or backward to activate the wheel switch and trigger realistic ironing sounds, entertaining learning phrases, and fun learning activities.

#### 6. **Back Button**



Tip the iron upright and set it down on this button to trigger goofy sounds and learning phrases related to the toy's new position.

#### 7. **Felt Dress, Shorts, and Shirt**



Iron these items for pretend play fun.

### **ACTIVITIES**

Pushing the iron back and forth activates the wheel switch, which triggers two kinds of activities. Toy-recognition activities provide your child with responses from the iron based on their actions. Exploratory activities are open-ended opportunities for children to practice what they've learned.

#### **Toy-Recognition Activities**

##### **Count the Wrinkles**

Count to five as you move the iron back and forth.

##### **Theme Song**

Move the iron back and forth to play the iron's theme song verse by verse.

### **ABC Song**

Play the ABC song verse by verse as you move the iron back and forth.

### **Sing the Colors Song**

Move the iron back and forth to play the Colors song verse by verse.

### **Color Dance**

Play upbeat melodies and trigger an engaging light show as you iron.

### **Silly Sounds**

Move the iron back and forth to trigger silly cartoon sounds.

### **Tip Me Up!**

Follow the iron's instructions to set it on its end and give it a rest.

### **Tip Me Over!**

Follow the iron's instructions to get back to work and hear encouraging phrases.

### **Press the Steam Button**

Press the steam button to practice counting.

### **Testing, Testing!**

Turn the dial to the correct number and press the buttons based on their colors and shapes to make sure everything is in working order.

### **Heat Me Up!**

Turn the dial to the correct number to pretend to heat the iron.

## **Exploratory Activities**

### **Iron Clothes That Are a Certain Color**

Practice your colors by choosing the clothes by the color the iron requests.

### **Iron a Certain Type of Clothing Item**

Select the shorts, shirt, or dress to iron.

### **Iron Clothes by Description**

Practice categorizing clothing by descriptions like comfy, fancy, or stylish.

### **Iron Clothes for an Event**

Select clothes to iron that you might wear to a party, school, or bedtime.

## **CARE & MAINTENANCE**

1. Keep the unit clean by wiping it with a slightly damp cloth.
2. Keep the unit out of direct sunlight and away from any direct heat sources.
3. Remove the batteries if the unit will not be in use for an extended period of time.
4. Do not drop the unit on hard surfaces and do not expose the unit to moisture or water.

## **TROUBLESHOOTING**

If for some reason the unit stops working or malfunctions, please follow these steps:

1. Turn the unit
2. Interrupt the power supply by removing the batteries.
3. Let the unit stand for a few minutes, then replace the
4. Turn the unit should now be ready to use again.
5. If the unit still does not work, install a new set of batteries.

## **Environmental Phenomena**

The unit may malfunction if subjected to radio-frequency interference. It should revert to normal operation when the interference stops. If not, it may become necessary to turn the power **Off** and back **On** or remove and reinstall

the batteries. In the unlikely event of an electrostatic discharge, the unit may malfunction and lose memory, requiring the user to reset the device by removing and reinstalling the batteries.

## **NOTE**

This equipment has been tested and found to comply with the limits for a Class B digital device, pursuant to Part 15 of the FCC Rules. These limits are designed to provide reasonable protection against harmful interference in a residential installation. This equipment generates, uses and can radiate radio frequency energy and, if not installed and used in accordance with the instructions, may cause harmful interference to radio communications. However, there is no guarantee that interference will not occur in a particular installation. If this equipment does cause harmful interference to radio or television reception, which can be determined by turning the equipment off and on, the user is encouraged to try to correct the interference by one or more of the following measures:

- Reorient or relocate the receiving
- Increase the separation between the equipment and
- Connect the equipment into an outlet on a circuit different from that to which the receiver is connected.
- Consult the dealer or an experienced radio/TV technician for help.

## **CAUTION**

Changes or modifications not expressly approved by the party responsible for compliance could void the user's authority to operate the equipment.

## **IMPORTANT NOTE:**

If the problem persists, please call our Consumer Services Department at 1-800-701-5327 in the U.S. and Canada or email [support@leapfrog.com](mailto:support@leapfrog.com). Creating and developing LeapFrog products is accompanied by a responsibility that we take very seriously. We make every effort to ensure the accuracy of the information, which forms the value of our products. However, errors sometimes can occur. It is important for you to know that we stand behind our products and encourage you to contact us with any problems and/or suggestions you might have. A service representative will be happy to help you.

## **Supplier's Declaration of Conformity**

47 CFR § 2.1077 Compliance Information

Trade Name: LeapFrog®

Model: 6147

Product Name: Ironing Time Learning Set™

Responsible Party: LeapFrog Enterprises, Inc.

Address: 2200 Powell Street, Suite 500 Emeryville, CA 94608

Website: [leapfrog.com](http://leapfrog.com)

THIS DEVICE COMPLIES WITH PART 15 OF THE FCC RULES. OPERATION IS SUBJECT TO THE FOLLOWING TWO CONDITIONS: (1) THIS DEVICE MAY NOT CAUSE HARMFUL INTERFERENCE, AND (2) THIS DEVICE MUST ACCEPT ANY INTERFERENCE RECEIVED, INCLUDING INTERFERENCE THAT MAY CAUSE UNDESIRE OPERATION.



Visit our website for more  
information about our products,  
downloads, resources, and more.

[leapfrog.com](http://leapfrog.com)  
[leapfrog.ca](http://leapfrog.ca)



Read our complete warranty policy online at  
[leapfrog.com/legal](https://leapfrog.com/legal)

LeapFrog Enterprises, Inc.,  
A subsidiary of VTech Holdings Limited.  
TM & © 2022 LeapFrog Enterprises, Inc.  
All rights reserved.

## Documents / Resources

 The image shows the box art for the LeapFrog Ironing Time Learning Set. It features a cartoon frog character on a steam iron, with the text 'Ironing Time Learning Set' and 'Instruction Manual' visible.	<p><a href="#">LeapFrog Ironing Time Learning Set</a> [pdf] Instruction Manual 614700, Ironing Time Learning Set</p>
---	--

Manuals+