

LeapFrog A to Z Learn with Me Dictionary Instruction Manual

[Home](#) » [LeapFrog](#) » LeapFrog A to Z Learn with Me Dictionary Instruction Manual 

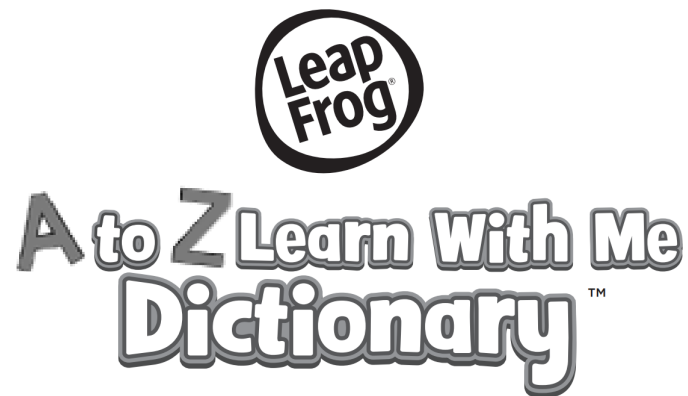

Instruction Manual

This guide contains important information. Please keep it for future reference.

Contents

- 1 INTRODUCTION
- 2 INSTRUCTIONS
- 3 PRODUCT FEATURES
- 4 ACTIVITIES
- 5 CARE & MAINTENANCE
- 6 TROUBLESHOOTING
- 7 CONSUMER SERVICES
- 8 Documents / Resources
- 9 Related Posts

INTRODUCTION

Thank you for purchasing the A to Z Learn With Me Dictionary™. Get ready to explore more than 200 words! Learn about words and their definitions and hear fun sound effects while building vocabulary – an important skill linked to future reading success.

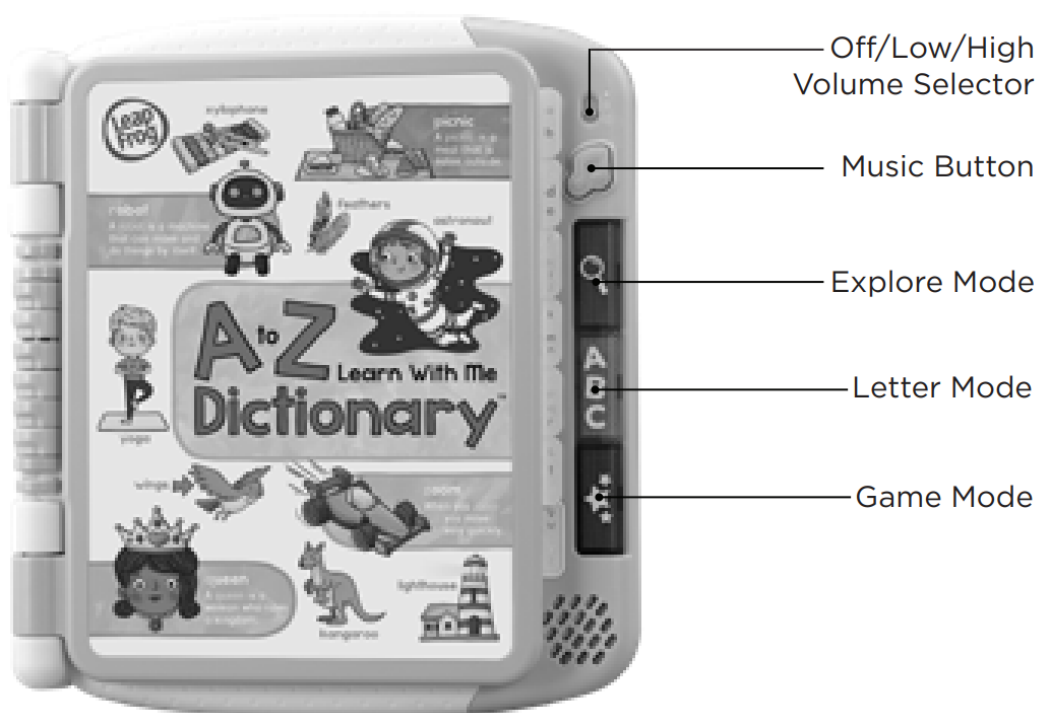

INCLUDED IN THIS PACKAGE

A to Z Learn With Me Dictionary™
Quick Start Guide

WARNING:

All packing materials such as tape, plastic sheets, packaging locks, removable tags, cable ties, cords and packaging screws are not part of this toy and should be discarded for your child's safety.

NOTE: Please save this Instruction Manual as it contains important information.

Unlock the Packaging Locks

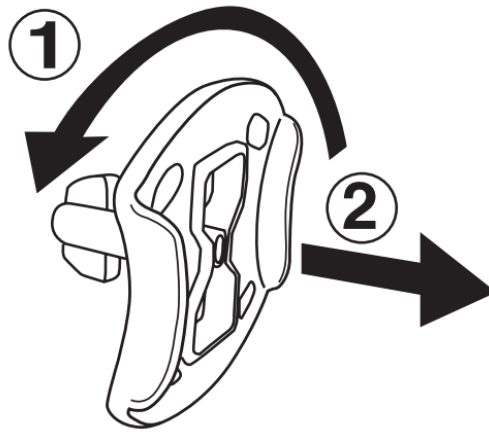

1. Rotate the packaging lock 90 degrees anticlockwise.
2. Pull out the packaging lock and discard.

INSTRUCTIONS

BATTERY REMOVAL AND INSTALLATION

1. Make sure the unit is turned Off.
2. Locate the battery cover on the back of the unit. Use a screwdriver to loosen the screw and then open the battery cover.
3. If used batteries are present, remove these batteries from the unit by pulling up on one end of each battery.
4. Install 2 new AA (AM-3/LR6) batteries following the diagram inside the battery box. (For best performance, alkaline batteries or fully charged Ni-MH rechargeable batteries are recommended.)
5. Replace the battery cover and tighten the screw to secure.

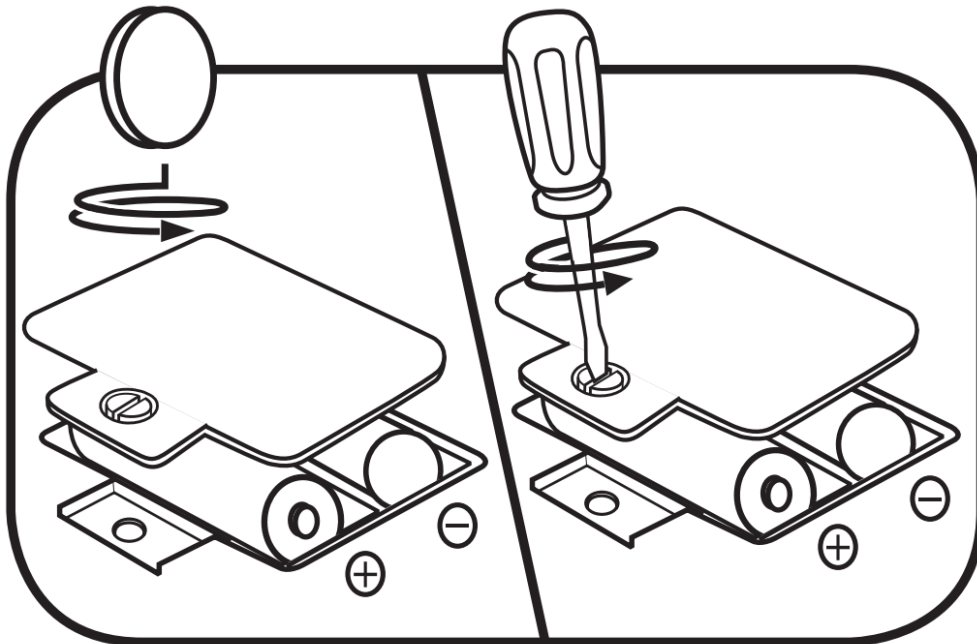

WARNING:

Adult assembly is required for battery installation. Keep batteries out of reach of children.

IMPORTANT: BATTERY INFORMATION

- Insert batteries with the correct polarity (+ and -).

- Do not mix old and new batteries.
- Do not mix alkaline, standard (carbon-zinc) or rechargeable batteries.
- Only batteries of the same or equivalent type as recommended are to be used.
- Do not short-circuit the supply terminals.
- Remove batteries during long periods of non-use.
- Remove exhausted batteries from the toy.
- Dispose of batteries safely. Do not dispose of batteries in fire.

RECHARGEABLE BATTERIES:

- Remove rechargeable batteries from the toy before charging.
- Rechargeable batteries are only to be charged under adult supervision.
- Do not charge non-rechargeable batteries.

Disposal of batteries and product



The crossed-out wheellie bin symbols on products and batteries, or on their respective packaging, indicates they must not be disposed of in domestic waste as they contain substances that can be damaging to the environment and human health.

The chemical symbols Hg, Cd, or Pb, where marked, indicate that the battery contains more than the specified value of mercury (Hg), cadmium (Cd), or lead (Pb) set out in the Batteries and Accumulators Regulation.



The solid bar indicates that the product was placed on the market after 13th August 2005. Help protect the environment by disposing of your product or batteries responsibly.

LeapFrog® cares for the planet.

Care for the environment and give your toy a second life by disposing of it at a small electrical collection point so all its materials can be recycled.

In the UK: Visit www.recyclenow.com to see a list of collection points near you.

In Australia & New Zealand: Check with your local council for kerbside collections.

PRODUCT FEATURES

1. Off/Low/High Volume Selector

Slide the Off/Low/High Volume Selector to turn the unit On and select the volume.

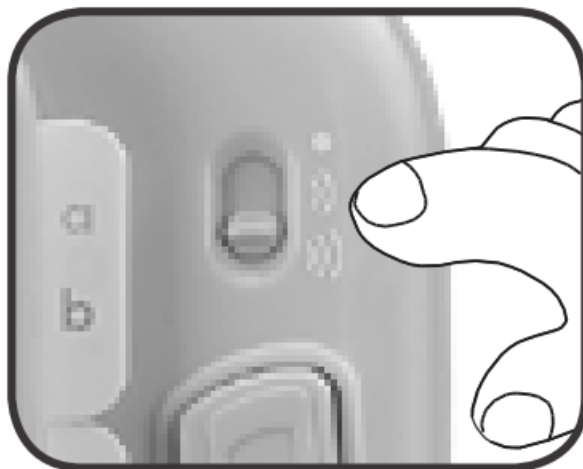

2. Music Button

Touch the music button to hear one of three songs about vocabulary, the dictionary, and the ABCs.

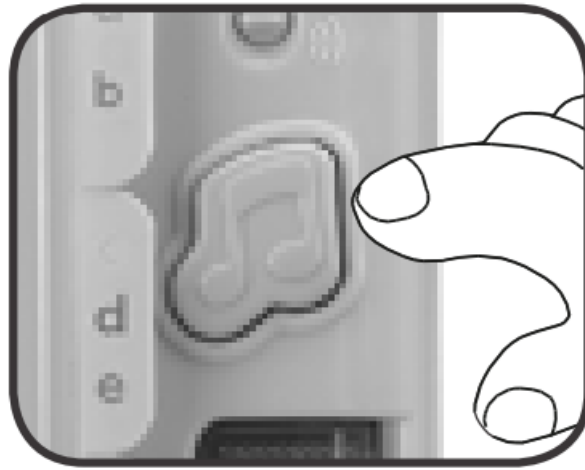

3. Explore Mode

Touch Explore Mode to learn about any of the 200+ words and their definitions.

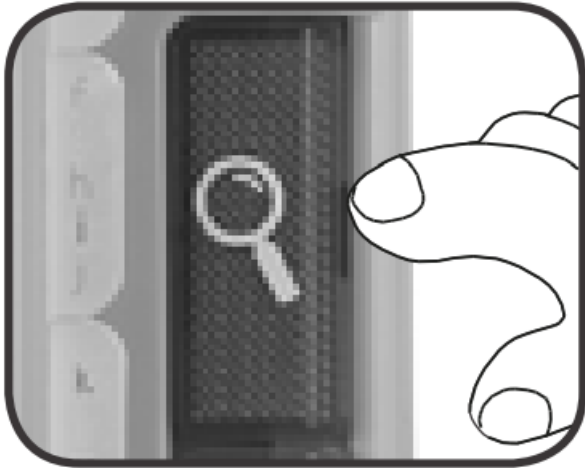

4. Letter Mode

Touch Letter Mode to explore how words begin with different letter sounds.

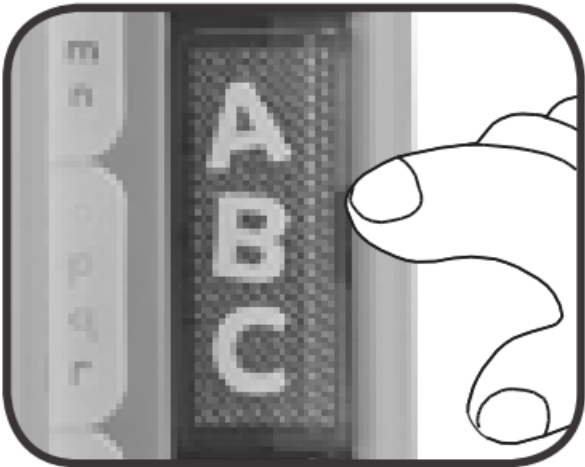

5. Game Mode

Touch the game mode button and use what you are learning about new words to play can-you-find-it games.

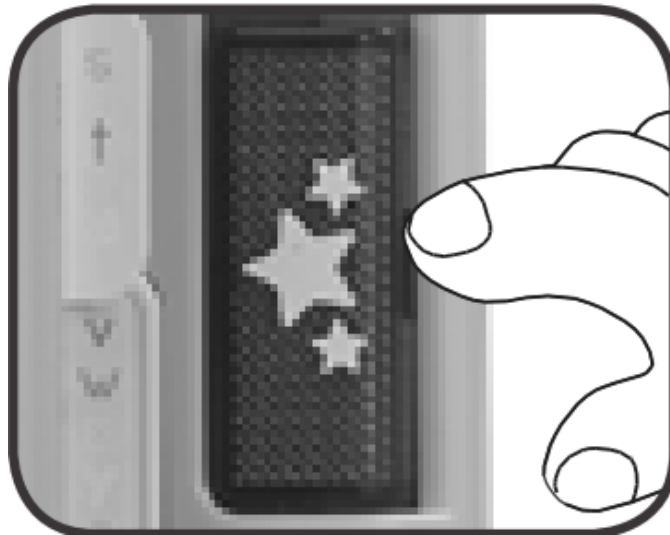

ACTIVITIES

Play activities that help you find words based on the letter they start with, or their definition. Children learn that words are in a dictionary alphabetically. The dictionary reinforces learning with letter searches and word hunts in categories like food, animals and more. Help children build word knowledge as they use their eyes, ears, and hands to explore letters and words from A to Z.

CARE & MAINTENANCE

1. Keep the unit clean by wiping it with a slightly damp cloth.
2. Keep the unit out of direct sunlight and away from any direct heat sources.
3. Remove the batteries if the unit will not be in use for an extended period of time.
4. Do not drop the unit on hard surfaces and do not expose the unit to moisture or water.
5. Try to change the batteries for new ones if the toy is not working properly.

TROUBLESHOOTING

If for some reason the unit stops working or malfunctions, please follow these steps:

1. Turn the unit Off.
2. Interrupt the power supply by removing the batteries.
3. Let the unit stand for a few minutes, then replace the batteries.
4. Turn the unit back On. The unit should now be ready to play again.
5. If the unit still does not work, replace it with an entire set of new batteries.

Environmental phenomena

The unit may malfunction if subjected to radio-frequency interference. It should revert to normal operation when the interference stops. If not, it may become necessary to turn the power OFF and back ON, or remove and reinstall the batteries. In the unlikely event of an electrostatic discharge, the unit may malfunction and lose memory, requiring the user to reset the device by removing and reinstalling the batteries.

CONSUMER SERVICES

Creating and developing LeapFrog® products is accompanied by a responsibility that we at LeapFrog® take very seriously. We make every effort to ensure the accuracy of the information, which forms the value of our products.

However, errors sometimes can occur. It is important for you to know that we stand behind our products and encourage you to call our Consumer Services Department with any problems and/or suggestions that you might have. A service representative will be happy to help you.

UK Customers:

Phone: 01702 200244 (from UK) or +44 1702 200244 (outside UK)

Website: www.leapfrog.co.uk/support

Australian Customers:

Phone: 1800 862 155

Website: support.leapfrog.com.au NZ

Customers: Phone: 0800 400 785

Website: support.leapfrog.com.au

PRODUCT WARRANTY/CONSUMER GUARANTEES

UK Customers: Read our complete warranty policy online at leapfrog.com/warranty.

Australian Customers:

VTECH ELECTRONICS (AUSTRALIA) PTY LIMITED CONSUMER GUARANTEES Under the Australian Consumer Law, a number of consumer guarantees apply to goods and services supplied by VTech Electronics (Australia) Pty Limited. Please refer to leapfrog.com/en-au/legal/warranty for further information.



Visit our website for more information about our products, downloads, resources and more.

www.leapfrog.com

LeapFrog Enterprises, Inc. A subsidiary of VTech
Holdings Limited. TM & © 2022

LeapFrog Enterprises, Inc.

All rights reserved. IM-614400-000

Version:0

Documents / Resources

The image shows the Leap Frog A to Z Learn with Me Dictionary. It is a small, rectangular electronic device with a screen and buttons. The text "Leap Frog" is at the top, and "A to Z Learn with Me Dictionary" is below it. At the bottom, it says "Instruction Manual".	<p>LeapFrog A to Z Learn with Me Dictionary [pdf] Instruction Manual</p> <p>A to Z Learn with Me Dictionary</p>
--	---