



LeapFrog 80-602400 Sorting Surprise Turtle Instruction Manual

[Home](#) » [LeapFrog](#) » LeapFrog 80-602400 Sorting Surprise Turtle Instruction Manual 



Sorting Surprise Turtle
Instruction Manual



Contents

- [1 INTRODUCTION](#)
- [2 INCLUDED IN THIS PACKAGE](#)
- [3 Getting Started](#)
- [4 IMPORTANT: BATTERY INFORMATION](#)
- [5 RECHARGEABLE BATTERIES](#)
- [6 CARE & MAINTENANCE](#)
- [7 TROUBLESHOOTING](#)
- [8 Documents / Resources](#)
- [9 Related Posts](#)

INTRODUCTION

Thank you for purchasing Sorting Surprise Turtle™! As your child inserts the five-colored shape blocks into the turtle's shell, they will learn about numbers, shapes, and color names, as well as practice their fine motor and hand-eye coordination skills. The toy includes numerous rhymes and songs to reinforce learning and encourage your child to press the plunger for block tumbling fun.

INCLUDED IN THIS PACKAGE

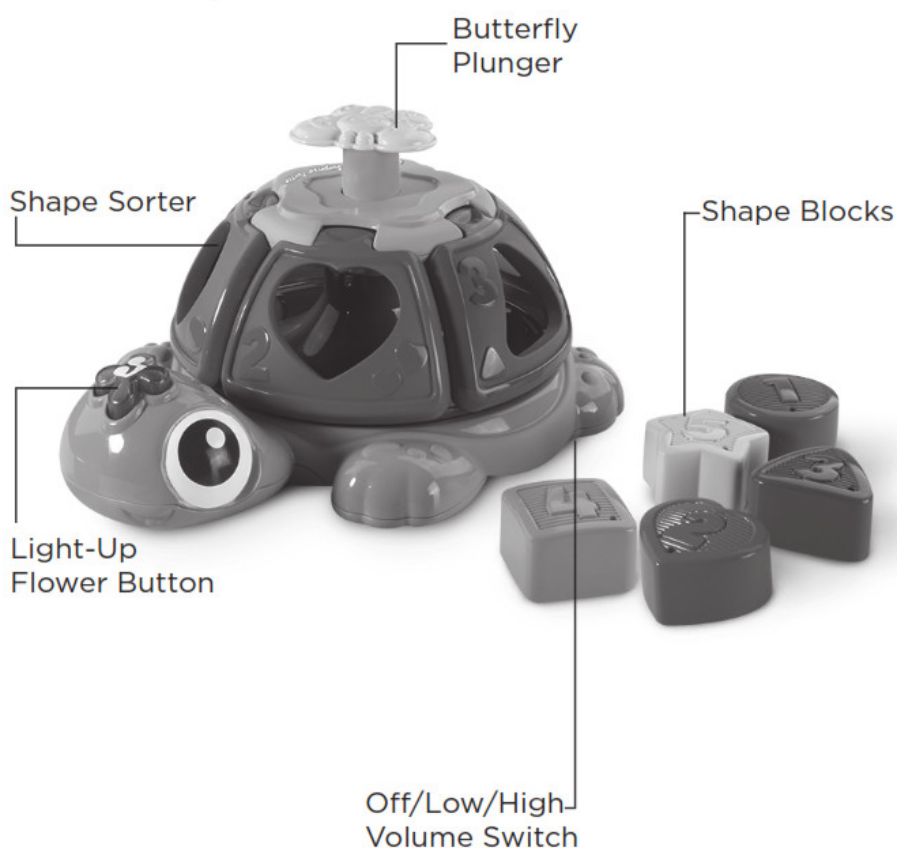

- 1 Sorting Surprise Turtle™
- 1 blue circle block
- 1 red heart block
- 1 purple triangle block
- 1 orange square block

- 1 yellow star block
- 1 Instruction Manual

WARNING

All packing materials such as tape, plastic sheets, packaging locks, removable tags, cable ties, cords, and packaging screws are not part of this toy and should be discarded for your child's safety.

NOTE

Please save this Instruction Manual as it contains important information.

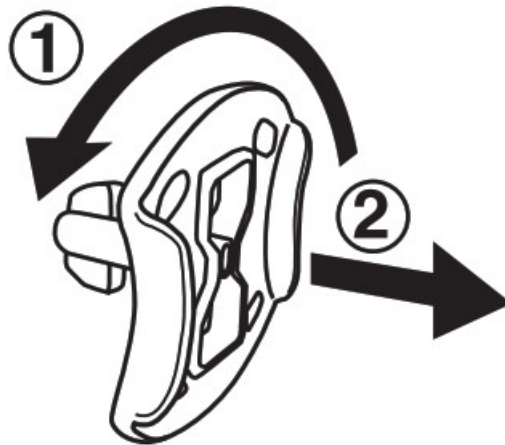
Unlock the Packaging Locks

1. Rotate the packaging locks 90 degrees counterclockwise.
2. Pull out the packaging locks and discard them.

Getting Started**Battery Removal and Installation**

1. Make sure the unit is turned Off.
2. Find the battery cover located on the back of the unit, use a screwdriver or coin to loosen the screw, and then open the battery cover.
3. Remove old batteries by pulling up on one end of each battery.
4. Install 2 new AA (AM-3/LR6) batteries following the diagram inside the battery box. (For best performance, alkaline batteries or fully charged Ni-MH rechargeable batteries are recommended.)

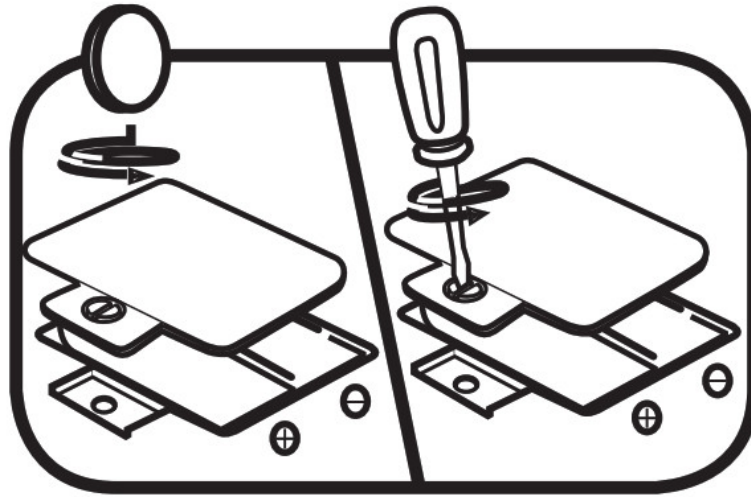

5. Replace the battery cover and tighten the screw to secure.



WARNING:

Adult assembly is required for battery installation. Keep batteries out of reach of children.

IMPORTANT: BATTERY INFORMATION

- Insert batteries with the correct polarity (+ and -).
- Do not mix old and new batteries.
- Do not mix alkaline, standard (carbon-zinc) or rechargeable batteries.
- Only batteries of the same or equivalent type as recommended are to be used.
- Do not short-circuit the supply terminals.
- Remove batteries during long periods of non-use.
- Remove exhausted batteries from the toy.
- Dispose of batteries safely. Do not dispose of batteries in fire.

RECHARGEABLE BATTERIES

- Remove rechargeable batteries from the toy before charging.
- Rechargeable batteries are only to be charged under adult supervision.
- Do not charge non-rechargeable batteries.

PRODUCT FEATURES

1. Off/Low/High Volume Switch

To turn the unit ON, slide the Off/Low/ High Volume Switch to the Low Volume or the High Volume position. To turn the unit OFF, slide the Off/Low/ High Volume Switch to the OFF position.



2. Shape Sorter

Insert a Shape Block by matching the color, shape or number to the holes in the shell. Once inserted, hear the names of colors, shapes and numbers with fun musical sounds.

3. Butterfly Plunger

Push the Butterfly Plunger down to spin the shell and make the Shape Blocks tumble out as you hear musical responses with learning rhymes and phrases.

Note: Please keep away from eyes and face. Don't put objects other than the included Shape Blocks into the holes or inside the turtle's shell.

4. Light-Up Flower Button

Press the Light-Up Flower Button on the turtle's head to listen to fun learning songs.

CARE & MAINTENANCE

1. Keep the unit clean by wiping it with a slightly damp cloth.
2. Keep the unit out of direct sunlight and away from any direct heat sources.
3. Remove the batteries if the unit will not be in use for an extended period of time.
4. Do not drop the unit on hard surfaces and do not expose the unit to moisture or water.

TROUBLESHOOTING

If for some reason the unit stops working or malfunctions, please follow these steps:

1. Turn the unit Off.
2. Interrupt the power supply by removing the batteries.
3. Let the unit stand for a few minutes, then replace the batteries.
4. Turn the unit On. The unit should now be ready to play again.
5. If the unit still does not work, install a new set of batteries.

IMPORTANT NOTE:

If the problem persists, please call our Consumer Services Department at 1-800-701-5327 in the U.S. and Canada or email support@leapfrog.com. Creating and developing LeapFrog products is accompanied by a responsibility that we take very seriously. We make every effort to ensure the accuracy of the information, which forms the value of our products. However, errors sometimes can occur. It is important for you to know that we stand behind our products and encourage you to contact us with any problems and/or suggestions you might have. A service representative will be happy to help you

Environmental Phenomena

The unit may malfunction if subjected to radio-frequency interference. It should revert to normal operation when

the interference stops. If not, it may become necessary to turn the power OFF and back ON, or remove and reinstall the batteries. In the unlikely event of an electrostatic discharge, the unit may malfunction and lose memory, requiring the user to reset the device by removing and reinstalling the batteries.

NOTE

This equipment has been tested and found to comply with the limits for a Class B digital device, pursuant to Part 15 of the FCC Rules. These limits are designed to provide reasonable protection against harmful interference in a residential installation. This equipment generates, uses, and can radiate radio frequency energy and, if not installed and used in accordance with the instructions, may cause harmful interference to radio communications. However, there is no guarantee that interference will not occur in a particular installation. If this equipment does cause harmful interference to radio or television reception, which can be determined by turning the equipment off and on, the user is encouraged to try to correct the interference by one or more of the following measures

- Reorient or relocate the receiving antenna.
- Increase the separation between the equipment and receiver.
- Connect the equipment into an outlet on a circuit different from that to which the receiver is connected.
- Consult the dealer or an experienced radio/TV technician for help.

Caution: Changes or modifications not expressly approved by the party responsible for compliance could void the user's authority to operate the equipment.

Supplier's Declaration of Conformity 47 CFR § 2.1077 Compliance Information

Trade Name: LeapFrog®

Model: 6024

Product Name: Sorting Surprise Turtle™

Responsible Party: LeapFrog Enterprises, Inc.

Address: 2200 Powell Street, Suite 500, Emeryville, CA 94608

Website: leapfrog.com

THIS DEVICE COMPLIES WITH PART 15 OF THE FCC RULES. OPERATION IS SUBJECT TO THE FOLLOWING TWO CONDITIONS: (1) THIS DEVICE MAY NOT CAUSE HARMFUL INTERFERENCE, AND (2) THIS DEVICE MUST ACCEPT ANY INTERFERENCE RECEIVED, INCLUDING INTERFERENCE THAT MAY CAUSE UNDESIRE OPERATION.



Visit our website for more information about our products, downloads, resources and more.

leapfrog.comleapfrog.ca

Read our complete warranty policy online at leapfrog.com/legal

LeapFrog Enterprises, Inc.

A subsidiary of VTech Holdings Limited.

TM & © 2018 LeapFrog Enterprises, Inc.

All rights reserved. Printed in China.

91-003484-015 US CA

Documents / Resources

 The image shows the LeapFrog Sorting Surprise Turtle toy, which is a grey, turtle-shaped container with several small, colorful blocks (red, yellow, green, blue) scattered around it. Above the toy is the LeapFrog logo and the text "Sorting Surprise Turtle". Below the toy is the text "Instruction Manual" and "The original counting and sorting game for toddlers and preschoolers".	<p>LeapFrog 80-602400 Sorting Surprise Turtle [pdf] Instruction Manual 80-602400, Sorting Surprise Turtle, 80-602400 Sorting Surprise Turtle</p>
--	--

Manuals+.