



# LeapFrog 615300 Interactive Learning Easel Instruction Manual

[Home](#) » [LeapFrog](#) » LeapFrog 615300 Interactive Learning Easel Instruction Manual 

## Contents

- [1 LeapFrog 615300 Interactive Learning Easel](#)
- [2 INTRODUCTION](#)
- [3 INCLUDED IN THE PACKAGE](#)
- [4 ASSEMBLY](#)
- [5 GETTING STARTED](#)
- [6 PRODUCT FEATURES](#)
- [7 CARE & MAINTENANCE](#)
- [8 TROUBLESHOOTING](#)
- [9 Documents / Resources](#)
  - [9.1 References](#)
- [10 Related Posts](#)



## LeapFrog 615300 Interactive Learning Easel



### INTRODUCTION

This 2-in-1 blackboard/whiteboard easel comes with 26 letter tiles, six shape tiles, chalk and an erasable marker. The interactive learning panel teaches letters and encourages creative play through drawing. The touch-sensitive pictures in the book describe how to use the magnetic shape tiles to draw pictures. The letter tile reader helps kids explore letter sounds, letter writing and new words.

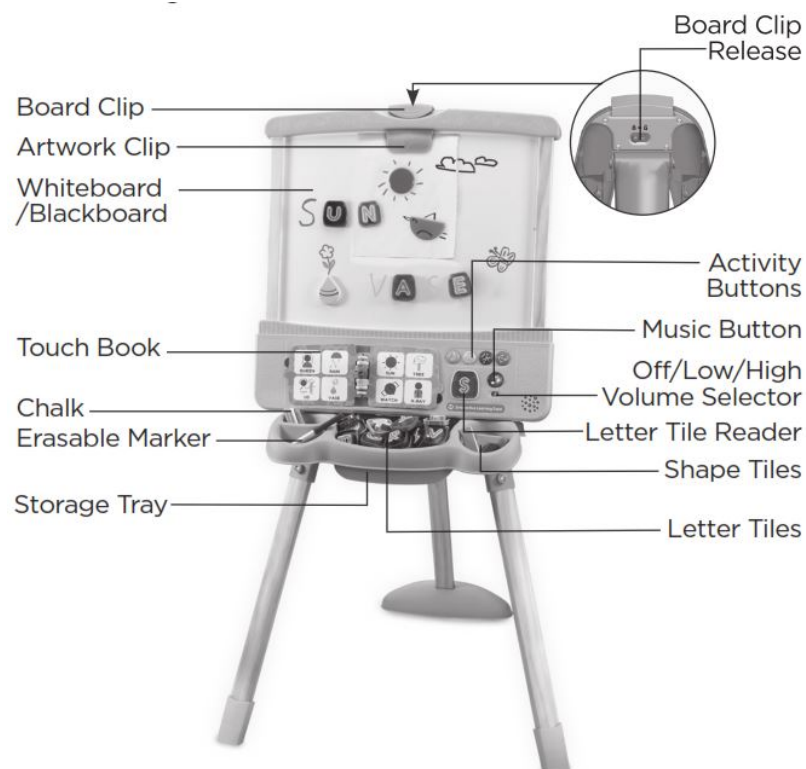

### INCLUDED IN THE PACKAGE

1. A-Frame (1/2)
2. Storage Tray (1/2)

3. Connector (1)



4. Upper Rear Leg (4)

5. Connector (2)

6. Learning Panel (3)



7. Brace (5)



8. Lower Front Leg (6)

9. Lower Front Leg (7)

10. Lower Rear Leg



11. Rear Leg Base (8)

12. 10 Screws

13. 6 Bolts

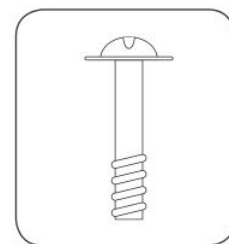
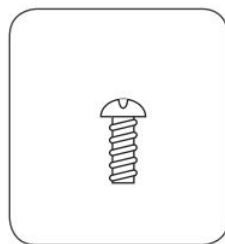

14. 6 Nuts

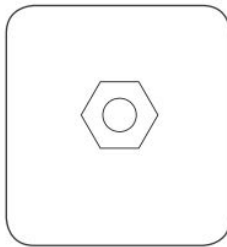

15. Whiteboard/ Blackboard

16. 26 Magnetic Letter Tiles

17. 6 Magnetic Shape Tiles

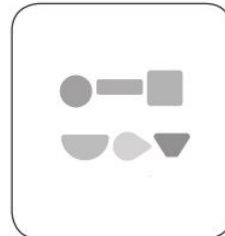

18. 1 Erasable Marker

19. 3 Chalk Pieces

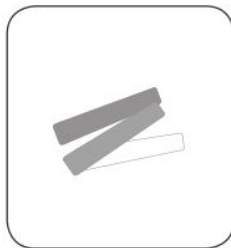

20. Quick Start Guide

## WARNING

All packing materials such as tape, plastic sheets, packaging locks, removable tags, cable ties and packaging screws are not part of this toy, and should be discarded for your child's safety.

**NOTE :** Please save this Instruction Manual as it contains important information.

**NOTE :** Please ask us about the availability of FSC Products.

## Unlock the Packaging Locks

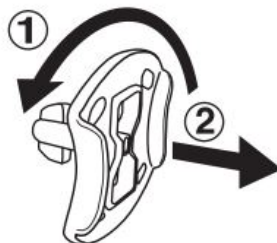

1. Pull out the packaging locks and discard.

2. Rotate the packaging locks 90 degrees counterclockwise.

**NOTE :** Please cut and discard the cords before playing with the unit. The cords are not part of the product and should be discarded for your child's safety.



**CAUTION:** Adult assembly required. Small fasteners included. CHOKING HAZARD—small parts. Not for children under 3 yrs.

## ASSEMBLY

With the Interactive Learning Easel, safety comes first. To ensure your child's safety, adult assembly is required.

### ADULT ASSEMBLY REQUIRED:

Tool needed: Phillips-head screwdriver (not included)

**Note:** Numbers referenced below refer to the molded plastic numbers on assembly parts. See INCLUDED IN THE PACKAGE pages for reference.

1. Locate the marking of numbers 1 and 2 on the A-Frame and on the Storage Tray separately. Align A-Frame 1 with Storage Tray 1 and A-Frame 2 with Storage Tray 2. The legs will rest in the slots until they are secured.



2. Lay the pieces face down on a flat surface so that the back of the Storage Tray 1/2 and the back of the A-Frame 1/2 are facing up.



3. Slide Connector 1 into the slot formed by the aligned pieces A-Frame 1 and Storage Tray 1 with the number 1 on Connector 1 facing up.



4. Use three Screws and your Phillips head screwdriver to secure.

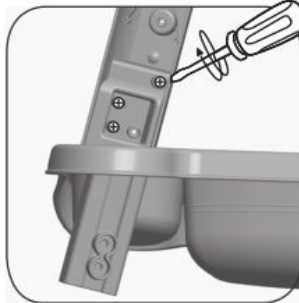

5. Slide Connector 2 into the slot formed by the aligned pieces A-Frame 2 and Storage Tray 2 with the number 2 on Connector 2 facing up.



6. Use three Screws and your Phillips head screwdriver to secure.

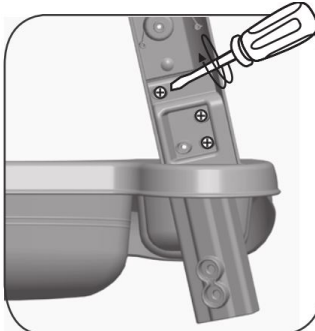

7. Slide the four knobs on the back of the Learning Panel 3 into the slots on the A-Frame 1/2. The Learning Panel 3 will rest in the slots until it is secured.



8. Secure Learning Panel 3 to A-Frame 1/2 with two Screws on each side as shown.

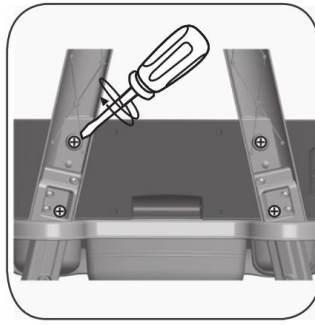

9. Snap Upper Rear Leg 4 into the top of A-Frame 1/2 as shown with the number 4 facing out.



10. Snap Brace 5 into the back of Learning Panel 3 as shown with the number 5 facing up.



11. Firmly snap the other end of Brace 5 into the yellow slot in the back of Upper Rear Leg 4 as shown.



**(Note:** Once inserted, this piece cannot be removed.) You have now assembled the upper easel.

12. Lay the assembled upper easel face down on a flat surface.



13. Fit Lower Front Leg 6 into Connector 1 with the curved side of the leg facing down and the number 6 facing up. Secure with two Nuts and two Bolts, inserting the Nuts from the bottom.

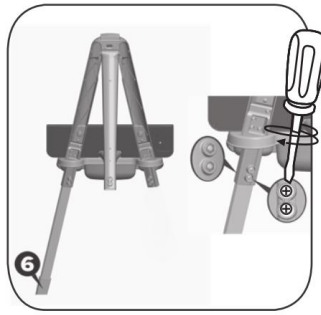

14. Fit Lower Front Leg 7 into Connector 2 with the curved side of the leg facing down and the number 7 facing up. Secure with two Nuts and two Bolts, inserting the Nuts from the bottom.

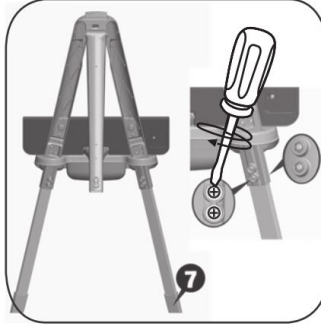

15. Fit Lower Rear Leg into the top of A-Frame 1/2 with the curved side of the leg facing up. Secure with two Nuts and two Bolts, inserting the Nuts from the top.



16. Secure the Lower Rear Leg to the Upper Rear Leg 4 with two Nuts and two Bolts.

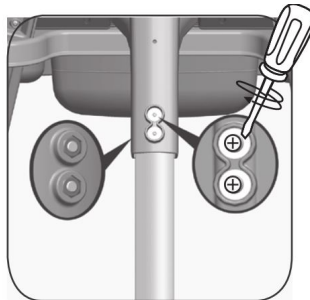

17. Insert Lower Rear Leg into Rear Leg Base 8.



18. Slot the Whiteboard/Blackboard onto the top of the Learning Panel. Lower the Board Clip over the Whiteboard/Blackboard.





19. Slide the Board Clip Release switch to the right and while holding it, lift the Board Clip.



20. Position the Whiteboard/Blackboard under the Board Clip. Release the clip to secure the Whiteboard/Blackboard in place. Repeat these steps when switching from whiteboard to blackboard.



## SET-UP

1. After assembling the easel, place the Erasable Marker and Chalk pieces in the left cups of the Storage Tray.
2. Place the 26 magnetic Letter Tiles in the center cup of the Storage Tray.
3. Place the 6 magnetic Shape Tiles in the right cup of the Storage Tray.

Now, let's create and draw together!

## GETTING STARTED

### BATTERY REMOVAL AND INSTALLATION

1. Make sure the unit is turned Off.
2. Find the battery cover located on the back of the unit, use a screwdriver to loosen the screw, and then open the battery cover.
3. Remove old batteries by pulling up on one end of each battery.
4. Install 2 new AA (AM-3/LR6) batteries following the diagram inside the battery box. (For best performance, alkaline batteries or fully charged Ni-MH rechargeable batteries are recommended.)
5. Replace the battery cover and tighten the screw to secure.

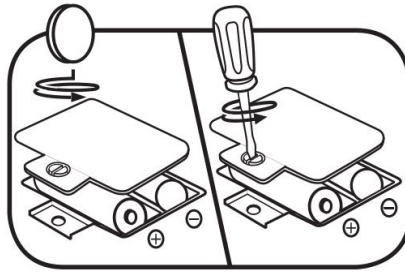

**WARNING:** Adult assembly required for battery installation. Keep batteries out of reach of children.

## IMPORTANT: BATTERY INFORMATION

- Insert batteries with the correct polarity (+ and -).
- Do not mix old and new batteries.
- Do not mix alkaline, standard (carbon-zinc) or rechargeable batteries.
- Only batteries of the same or equivalent type as recommended are to be used.
- Do not short-circuit the supply terminals.
- Remove batteries during long periods of non-use.
- Remove exhausted batteries from the toy.
- Dispose of batteries safely. Do not dispose of batteries in fire.

## RECHARGEABLE BATTERIES

- Remove rechargeable batteries (if removable) from the toy before charging.
- Rechargeable batteries are only to be charged under adult supervision.
- Do not charge non-rechargeable batteries.

## PRODUCT FEATURES

1. **Off/Low/High Volume Selector** : To turn the unit On, slide the Off/Low/ High Volume Selector to the Low



or High  position. To turn the unit Off, slide the Off/Low/High Volume Selector to the Off  position.



2. **Double-sided Whiteboard/Blackboard** : Select either the whiteboard or blackboard side of the easel to explore a variety of activities. (See Assembly Instructions above for details on flipping and securing the board.)

### 1. Whiteboard side:

Use the erasable marker to draw and create pictures by drawing directly on and around the six magnetic Shape Tiles. Practice writing letters and spelling words using the erasable marker and the 26 magnetic

Letter Tiles.



## 2. **Blackboard side:**

Use the three colored chalk pieces to draw and create pictures by tracing around the six magnetic Shape Tiles. Then fill them in with different colors or add fun details. Practice writing and spelling skills with the Chalk and 26 magnetic Letter Tiles.

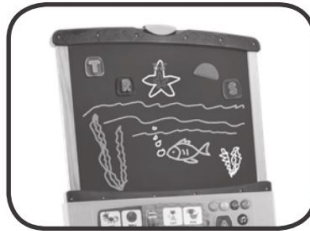

## 3. **26 Magnetic Letter Tiles and Letter Tile Reader :**

Insert any of the 26 magnetic Letter Tiles into the Letter Tile Reader to hear letter names, sounds and a word starting with that letter. Press to explore colors and vocabulary. Then remove the tiles to hear drawing and writing prompts.



## 4. **Touch Book and 6 Magnetic Shape Tiles :**

Flip the pages and touch the pictures in the Touch Book to explore drawing and spelling. Then use the Shape or Letter Tiles to follow along.

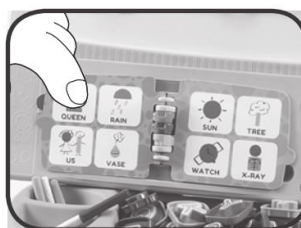

## 5. **Four Activity Buttons :**

Press the buttons for music or art activities:



1. **Drawing Music** – Fun tunes to accompany creative activities.



2. **Shape Art Activity** – Use tiles and draw shapes to make patterns and pictures.



3. **Rhythm Art Activity** – A game to draw lines and dots as you hear silly sounds.



4. **Dot Art & Line Art Activities** – Explore how pictures are composed of simple dots and lines.

#### 6. **Light-Up Music Button:**

Press to hear four learning songs about the alphabet, colors, shapes and creativity while the light blinks along.

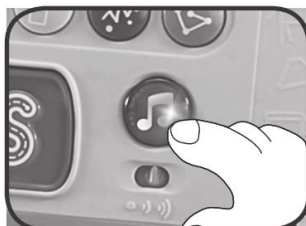

#### 7. **Erasable Marker and Three Chalk Pieces:**

Use the included Erasable Marker for activities on the whiteboard side and to draw directly onto the Six Magnetic Shape Tiles. Wipe the whiteboard with a damp cloth, dry with a dry cloth, and do it all over again! Use the included Chalk to write, draw or create art with, or trace around the Shape Tiles on the Blackboard side.

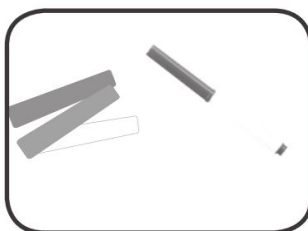

#### 8. **Storage Tray :**

Store all 26 magnetic Letter Tiles, six magnetic Shape Tiles, Erasable Marker and three Pieces of Chalk.



#### 9. **Paper Clip :**

On the whiteboard side, place paper under the Clip to attach it to the board surface to create art or to display your child's artwork.

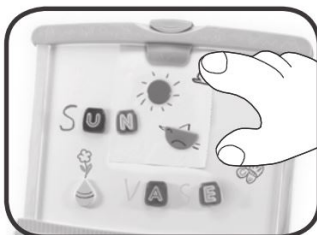

#### 10. **Automatic Shut-Off**

To preserve battery life, the Interactive Learning Easel will automatically shut off after approximately 90 seconds without input. The unit can be turned on again by turning a book page, pressing any of the five buttons, or flipping the board over.

## **SONG LYRICS**

### **Song 1**

Grab your chalk and marker,  
And let's go!  
Use your imagination,  
And let the art flow!

### **Song 2**

Express yourself,  
Create and play!  
Make it silly or smart,  
You can do it your way.  
Draw a line,  
Up and down.  
Make it square,  
Make it round.  
Shapes and colors  
are everywhere!

### **Song 3**

Pictures are made,  
With colors and shapes –  
Red, green and blue.  
Come on, let's make,  
Circles and squares,  
Rectangles, too.  
It's fun to draw;  
Yes, it's fun to do.

## **CARE & MAINTENANCE**

1. Keep the unit clean by wiping it with a slightly damp cloth.
2. Keep the unit out of direct sunlight and away from any direct heat sources.
3. Remove the batteries if the unit will not be in use for an extended period of time.
4. Do not drop the unit on hard surfaces and do not expose the unit to moisture or water.

## **TROUBLESHOOTING**

If for some reason the unit stops working or malfunctions, please follow these steps:

1. Turn the unit Off.
2. Interrupt the power supply by removing the batteries.
3. Let the unit stand for a few minutes, then replace the batteries.
4. Turn the unit On. The unit should now be ready to use again.
5. If the unit still does not work, install a new set of batteries.

## Environmental Phenomena

The unit may malfunction if subjected to radio-frequency interference. It should revert to normal operation when the interference stops. If not, it may become necessary to turn the power off and back on, or remove and reinstall the batteries. In the unlikely event of an electrostatic discharge, the unit may malfunction and lose memory, requiring the user to reset the device by removing and reinstalling the batteries.

## CAUTION

Changes or modifications not expressly approved by the party responsible for compliance could void the user's authority to operate the equipment.

## NOTE

This equipment has been tested and found to comply with the limits for a Class B digital device, pursuant to Part 15 of the FCC Rules. These limits are designed to provide reasonable protection against harmful interference in a residential installation. This equipment generates, uses and can radiate radio frequency energy and, if not installed and used in accordance with the instructions, may cause harmful interference to radio communications. However, there is no guarantee that interference will not occur in a particular installation. If this equipment does cause harmful interference to radio or television reception, which can be determined by turning the equipment off and on, the user is encouraged to try to correct the interference by one or more of the following measures:

- Reorient or relocate the receiving antenna.
- Increase the separation between the equipment and receiver.
- Connect the equipment into an outlet on a circuit different from that to which the receiver is connected.
- Consult the dealer or an experienced radio/TV technician for help.

## IMPORTANT NOTE:

If the problem persists, please call our Consumer Services Department at 1-800-701-5327 in the U.S. and Canada, or email [support@leapfrog.com](mailto:support@leapfrog.com). Creating and developing LeapFrog products is accompanied by a responsibility that we take very seriously. We make every effort to ensure the accuracy of the information, which forms the value of our products. However, errors sometimes can occur. It is important for you to know that we stand behind our products and encourage you to contact us with any problems and/or suggestions you might have. A service representative will be happy to help you.

## Supplier's Declaration of Conformity

47 CFR § 2.1077 Compliance Information Trade Name: LeapFrog®

**Model:** 6153

**Product Name:**

**Responsible Party:** LeapFrog Enterprises, Inc.

**Address:** 2200 Powell St., Suite 500 Emeryville, CA 94608

**Website:** [leapfrog.com](http://leapfrog.com)

THIS DEVICE COMPLIES WITH PART 15 OF THE FCC RULES. OPERATION IS SUBJECT TO THE FOLLOWING TWO CONDITIONS:

1. THIS DEVICE MAY NOT CAUSE HARMFUL INTERFERENCE, AND
2. THIS DEVICE MUST ACCEPT ANY INTERFERENCE RECEIVED, INCLUDING INTERFERENCE THAT MAY

CAUSE UNDESIRED OPERATION.

Read our complete warranty policy online at [leapfrog.com/legal](http://leapfrog.com/legal) Visit our website for more information about our products, downloads, resources and more.  
[leapfrog.com](http://leapfrog.com) , [leapfrog.ca](http://leapfrog.ca)

Documents / Resources

	<a href="#">LeapFrog 615300 Interactive Learning Easel</a> [pdf] Instruction Manual 615300, Interactive Learning Easel, 615300 Interactive Learning Easel, Learning Easel, Easel
---	---

References

- [LeapFrog Kids Learning Games | Educational Toys & Kids Tablets | LeapFrog](#)
- [LeapFrog Kids Learning Games | Educational Toys & Kids Tablets | LeapFrog](#)
- [LeapFrog Legal | LeapFrog](#)