



LC-POWER LC-M28-4K-UHD LC Power Monitor User Manual

[Home](#) » [LC-POWER](#) » LC-POWER LC-M28-4K-UHD LC Power Monitor User Manual 

Contents

- 1 LC-POWER LC-M28-4K-UHD LC Power Monitor
- 2 Safety precautions
- 3 Maintenance
- 4 Product introduction
- 5 Instructions for usage
- 6 Installation of base
- 7 Cable connection
- 8 OSD menu
- 9 Basic parameters
- 10 Documents / Resources
 - 10.1 References
- 11 Related Posts

LC-POWER

LC-POWER LC-M28-4K-UHD LC Power Monitor



Safety precautions

- Keep the monitor away from water sources or damp places, such as bath rooms, kitchens, basements and swimming pools.
- Make sure the monitor is placed on a flat surface. If the monitor falls down, it may cause injury or a damage to the device.
- Store and use the monitor in a cool, dry and well ventilated place, and keep it away from emission and heat sources.
- Do not cover or block the vent hole in the rear casing, and do not use the product on a bed, sofa, blanket or similar objects.
- The range of the supply voltage of the monitor is printed on the label on the rear casing. If it is impossible to determine the supply voltage, please consult the distributor or local power company.
- If the monitor will not be used for a long period, please unplug it from the electrical outlet.
- Please use a reliable earthing socket, do not overload the socket, or it may cause fire or electric shock.
- Do not put foreign matters into the monitor, or it may cause short circuits resulting fire or electric shock.
- Do not disassemble or repair this product by self to avoid electric shock. If faults occur, please contact the after-sales service directly.
- Do not pull or twist the power cable forcedly.
- There is a polarizer layer (not a protective film) on the surface of the screen. Do not peel it off, or the product may be damaged and the warranty will be invalid.

Maintenance

CAUTION: Unplug the power cable from the outlet before cleaning the monitor.

- To clean your screen, slightly moisten a soft, clean cloth with water.
- Please use a special screen-cleaning tissue if possible.
- Do not use benzene, thinner, ammonia, abrasive cleaners or compressed air.
- Inappropriate cleaning solutions may damage the monitor or leave a milky film on the screen or the housing.

- Unplug the monitor if you are not going to use it for a longer time period.
 - Do not expose the monitor to dust, liquids or a humid environment.
 - In case the monitor gets in touch with any liquid, wipe it down immediately using a dry cloth.
- In case any liquid gets spilled into the ventilation holes, do not use the monitor anymore.
Please contact a professional service technician.

Legal note:

HOMI

HIGH-DEFINITION MULTIMEDIA INTERFACE

The terms told me so I went to the store to see one at the store.

Product introduction

Packing list

- Please check that the package of the monitor contains all parts. If any part is missing, please contact the retailer.



Display screen



Stand



Base

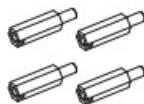

Mounting studs

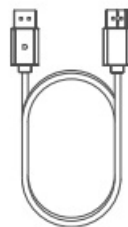

DP signal cable



Power cable



User manual

Instructions for usage

Description of buttons

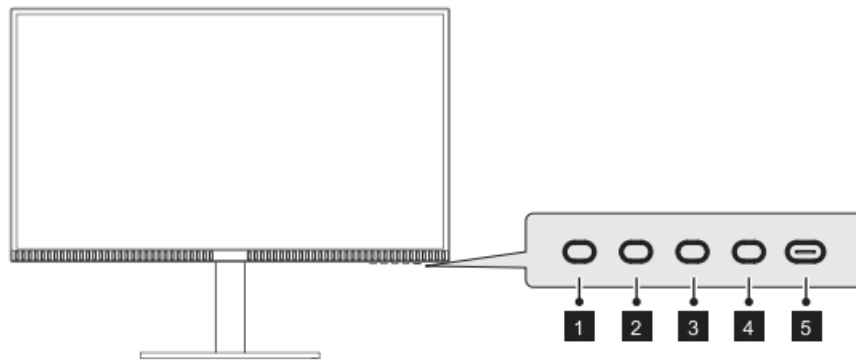

1. **Menu button:** Enter sub-menus/quickly enter the main menu.
2. **Down button:** Move down in the menu/quickly enter the GamePlus mode.
3. **Up button:** Move up in the menu/quickly change the preset mode.
4. **Exit button:** Exit or return to the previous menu/quickly switch the input signal.
5. **Power button:** Turn on/off the monitor.

Explanation of indicators

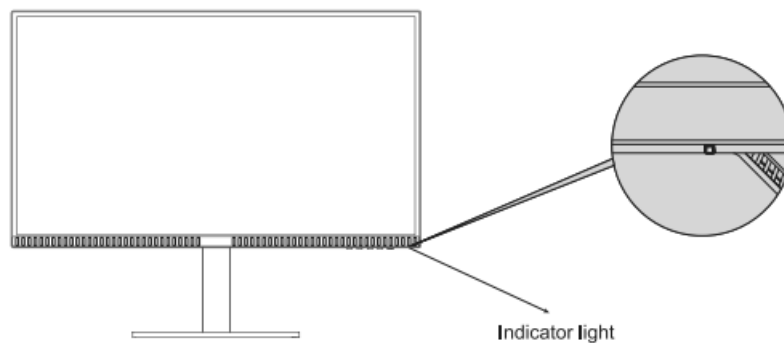

Indicator light:

Steady white light indicates that the power is on and the monitor works normally.

Red light indicates that no horizontal or vertical synchronous signal is detected or that there is no video input signal, and that the monitor is in standby status.

Please make sure your computer is turned on and operates normally and check that all video cables are fully plugged in and/or connected to the monitor.

Adjusting the monitor

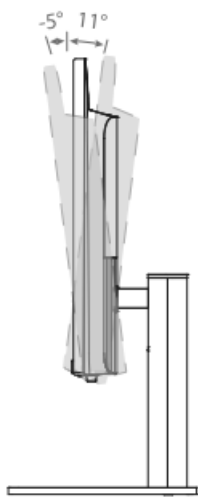

Tilting angle
 $-5,0^{\circ} (\pm 2,0^{\circ}) - +11^{\circ} (\pm 2,0^{\circ})$

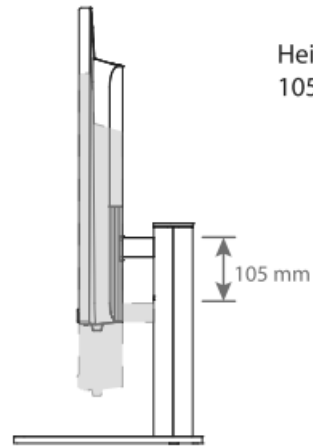

Height adjustment
 105 mm ($\pm 5,0$ mm)

Installation of base

1. Open the carton package, take out the foam part and put it flat on the table top. Keep the foam part underneath the monitor before attaching the stand.

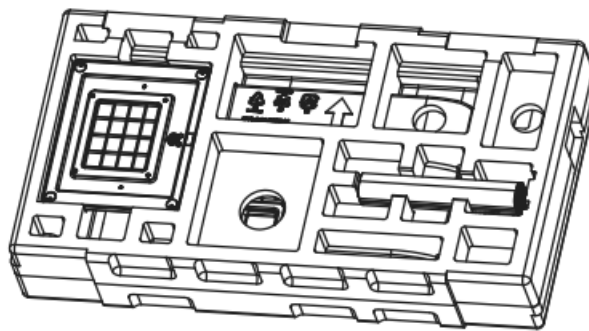

2. Take out the bracket and mount it to the base with a thumb screw.

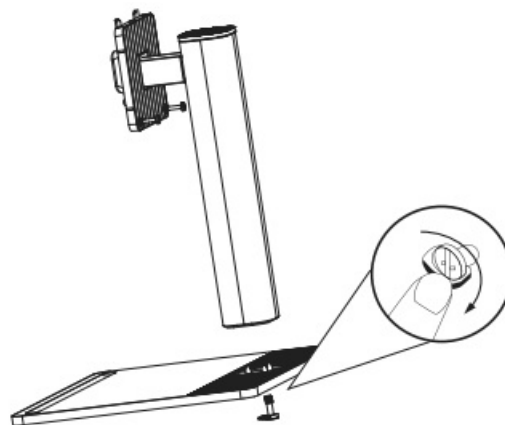

3. Use two screws to mount the base element to the back of the monitor.

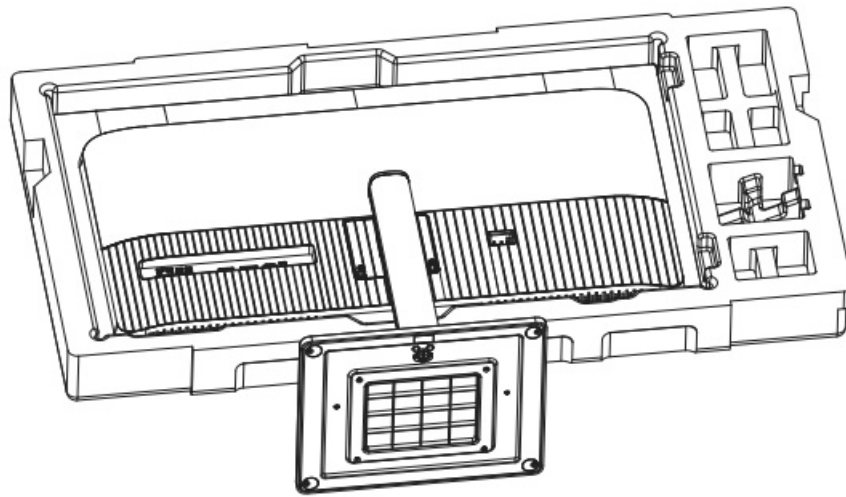

4. After the assembly, take the stand with your hand to put the monitor upright.

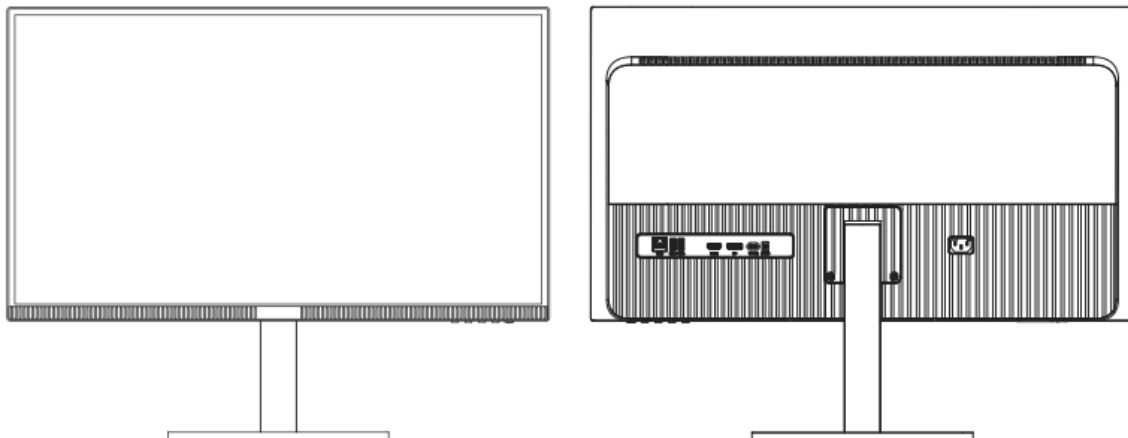

Note: Do not press the liquid crystal screen with hand your to avoid damage to the screen panel.

Installation of a wall-mounting accessory

1. Open the carton package, take out the foam part and put it flat on the table top. Keep the foam part underneath the monitor before attaching the stand.

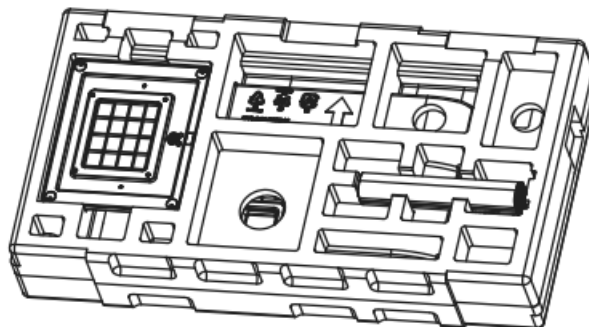

2. Take out the mounting studs and mount them to the back of the monitor.

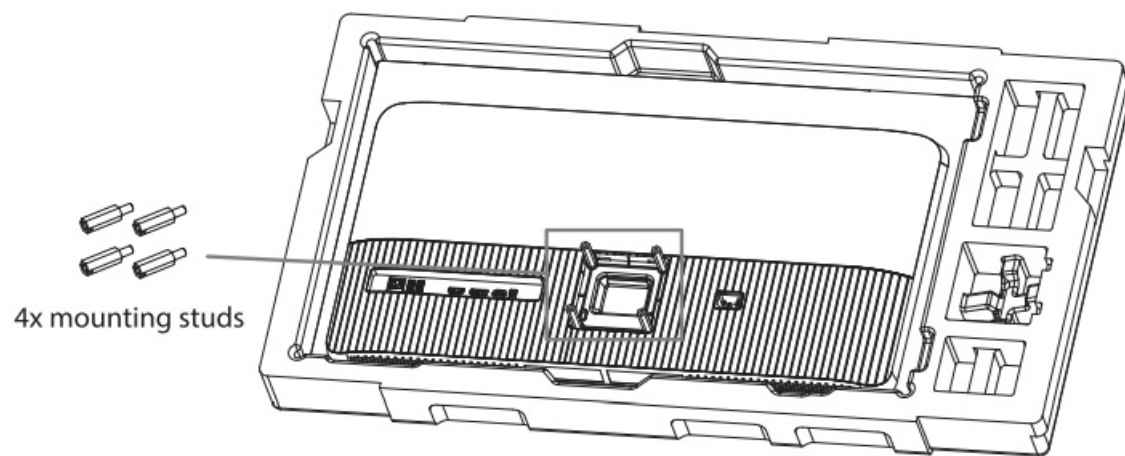

3. **Note:** Hang the assembled product on a hard wall. Do not pinch the screen with your hands to avoid damaging the screen

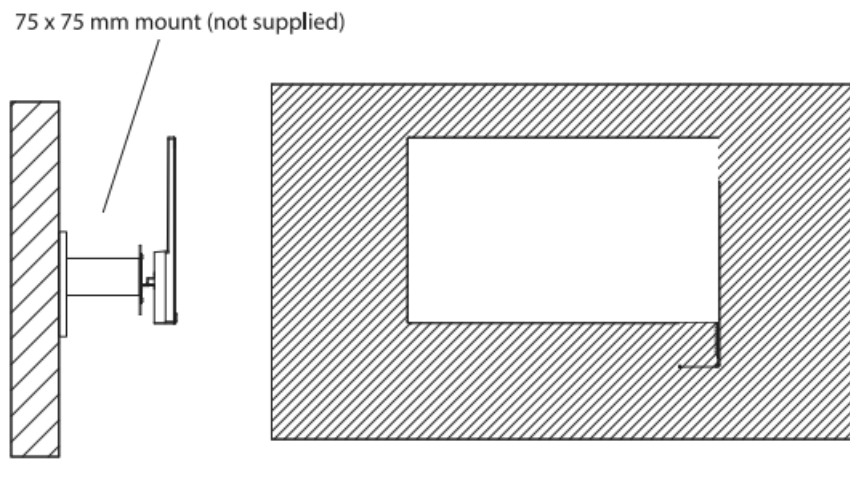

Note: In order to prevent the monitor from falling when it is used on the wall, please install it properly and securely. Do not place or hang any objects on the wall bracket.

Cable connection

Important note: If the power cable or signal cable is damaged, you must replace it immediately.

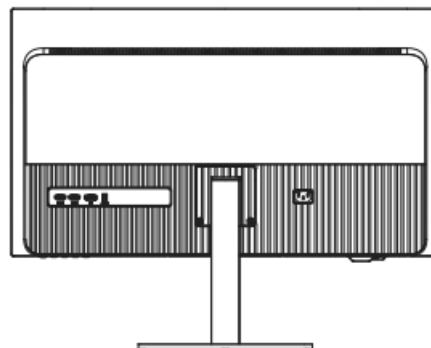

DP or HDMI interface

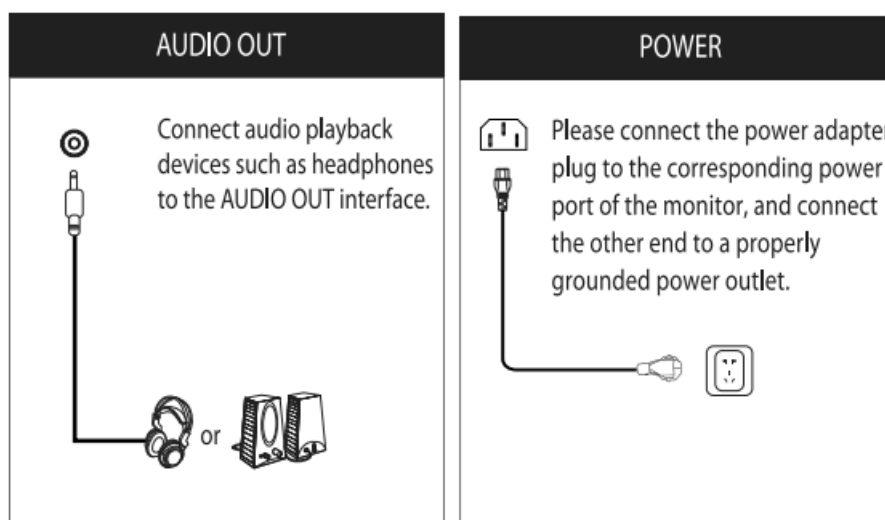
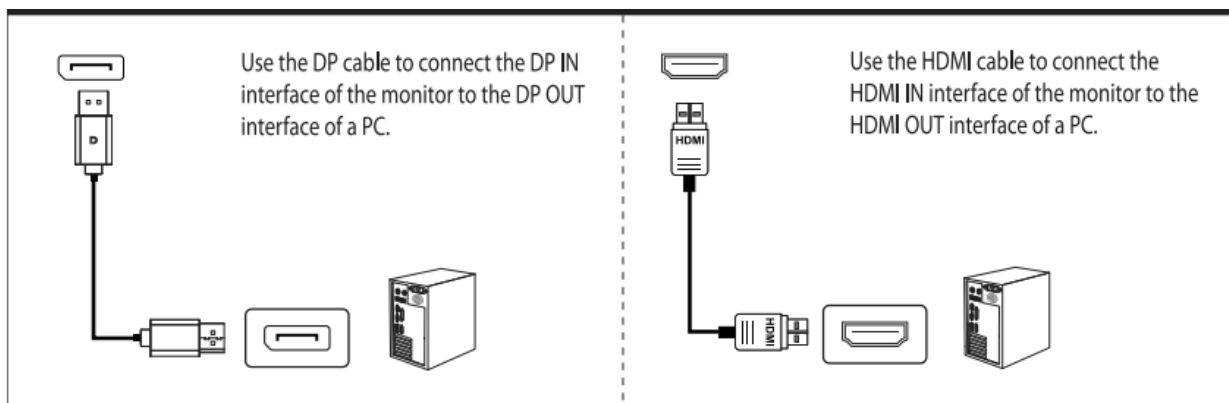

OSD menu

Menu description

- The colour and shape of the OSD menu of the actual monitor may be slightly different from the one shown in the figure below.
- Detail specifications of the OSD menu may change with improvements of functions.

The on-screen display (OSD) menu can be used to adjust the settings of the monitor and is displayed on the screen after turning on the monitor and pressing button 1.

1. Press 1 to enter the OSD menu.

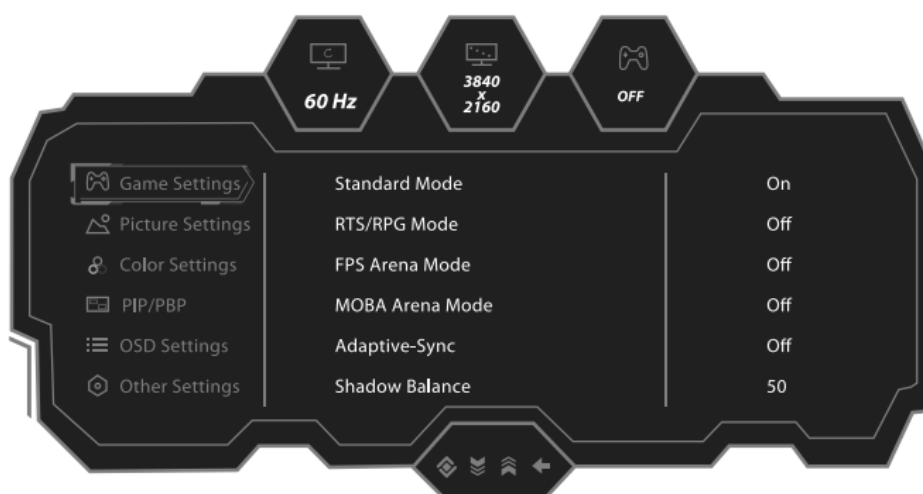

2. Press 2 or 3 to scroll through the functions.
 - Select the desired function and press 1 to enter the sub-menu.
 - Press 2 or 3 to scroll through sub-menus and press 1 to select and confirm the function.
 - Press 2 or 3 to select an option and press 1 to confirm and exit from the current menu.
3. Press 4 to exit the menu.

Functions of the monitor vary with models; the functions in this manual are for reference only.

Main Menu	Sub Menu	Option
Game Settings	Standard Mode	Off/On
	RTS/RPG Mode	Off/On
	FPS Arena Mode	Off/On
	MOBA Arena Mode	Off/On
	Adaptive-Sync	Off/On
	Shadow Balance	0-100
	Response Time	Off/Normal/Fast/Ultrafast
	Refresh Rate	Off/On/Position
	Game Crosshair	Off/Crosshair1/Crosshair2/Crosshair3/Crosshair4/Crosshair5/Crosshair6
	Game Time	Off/On:15:00/30:00/45:00/60:00/Position
	Dynamic Brightness	Off/Normal/Expert/Elaboration
Picture Settings	Brightness	0-100
	Contrast	0-100
	DCR	Off/On
	Contextual Model	Off/On: Movie Mode/Reading Mode/Night Mode
	Low Blue Light	0-100
	Sharpness	0-5
	Gamma	1.8/2.0/2.2/2.4/2.6/5.curve
	Aspect Ratio	Wide Screen/4:3/1:1/Auto

Color Settings	Warm	Off/On
	Natural	Off/On
	Cool	Off/On
	User1	Off/On:0-100(R/G/B)
	User2	Off/On:0-100(R/G/B)
	User3	Off/On:0-100(R/G/B)
	Hue	0-100(R/G/B/C/M/Y)
	Saturation	0-100(R/G/B/C/M/Y)
PIP/PBP	PIP/PBP Mode	Off/PIP Mode/PBP 2Win 1:1
	Sub-Signal Source	DP/HDMI1/HDMI2
	Audio Source	Auto/DP/HDMI1/HDMI2
	PIP Position	TopRight/TopLeft/BottomRight/BottomLeft
	PIP Size	Small/Medium/Large

PIP/PBP	Window Swap	Off/On
OSD Settings	Language	简体中文/English/한국어/عربي/Portugues do Brasilazil / Deutsch/Nederland/Suomi/Français/Ελληνικά/Indonesia/Italiano/日本語/Malaysia/Polskie/Português/Русский/Español/繁體中文/Українська/Tiếng Việt/繁體中文/Türkçe
	OSD Time Out	5-60
	OSD H-Position	0-100
	OSD V-Position	0-100
	OSD Transparency	0-5
	Hotkey1 Setting	Brightness/Contrast/Volume/Mute/Shadow Balance/Game Crosshair/Refresh Rate/Game Time/Adaptive-Sync/Contextual Model/PIP/PBP Mode/Input Signal/Dynamic Brightness
	Hotkey2 Setting	
	Hotkey3 Setting	
	OSD Lock	Off/On
Other Settings	Input Signal	Auto/DP/HDMI1/HDMI2
	Volume	0-100
	Mute	Off/On
	Auto Power	Off/On
	Eyeshield Remind	Off/On
	Reset	No/Yes
	Information	Input Source: /Resolution: /Mode: /SN:

Basic parameters

Product type / model		Liquid Crystal Display / LC-M28-4K-UHD
Screen size / Aspect ratio		23,8" / 60,45 cm / 16:9
Viewing angle / Pixel pitch		178° (H) / 178° (V) / 0,2745 mm (H) x 0,2745 (V) mm
Contrast ratio / Colours		3000:1 (typ.) / 16,7 M
Resolution / Refresh rate		1920 x 1080 pixel / 60 Hz
Power specifications		DC 12,0 V $\overline{=}$ 2,5 A The standard voltage and current may vary with countries, please refer to the label at the back of the product.
Product dimensions		Without base 542,4 x 323,1 x 38,5 mm / With base 542,4 x 402,8 x 160,9 mm
Net weight / Gross weight		3,2 kg / 4,5 kg
Tilting angle / Height adjustment		Forward tilting: -5° \pm 2°; backward tilting: 15° \pm 2° / 105 \pm 5 mm
Environmental conditions	Usage	Temperature: 0° C ~ 40° C (32° F ~ 104° F); humidity: 10 % ~ 90 % RH (non-condensing)
	Storage	Temperature: -20° C ~ 60° C (-4° F ~ 140° F); humidity: 5 % ~ 95 % RH (non-condensing)

Silent Power Electronics GmbH
Formerweg 8
47877 Willich
Germany
www.lc-power.com

Documents / Resources

	<p>LC-POWER LC-M28-4K-UHD LC Power Monitor [pdf] User Manual LC-M28-4K-UHD LC Power Monitor, LC-M28-4K-UHD, LC Power Monitor, Power Monitor, Monit or</p>
---	---

References

- [User Manual](#)