

LC-POWER LC-CC-85 CPU Cooler User Manual

[Home](#) » [LC-POWER](#) » LC-POWER LC-CC-85 CPU Cooler User Manual 

Contents

- [1 LC-POWER LC-CC-85 CPU Cooler](#)
- [2 Specification](#)
- [3 Installation](#)
- [4 Documents / Resources](#)
 - [4.1 References](#)
- [5 Related Posts](#)

LC-POWER

LC-POWER LC-CC-85 CPU Cooler

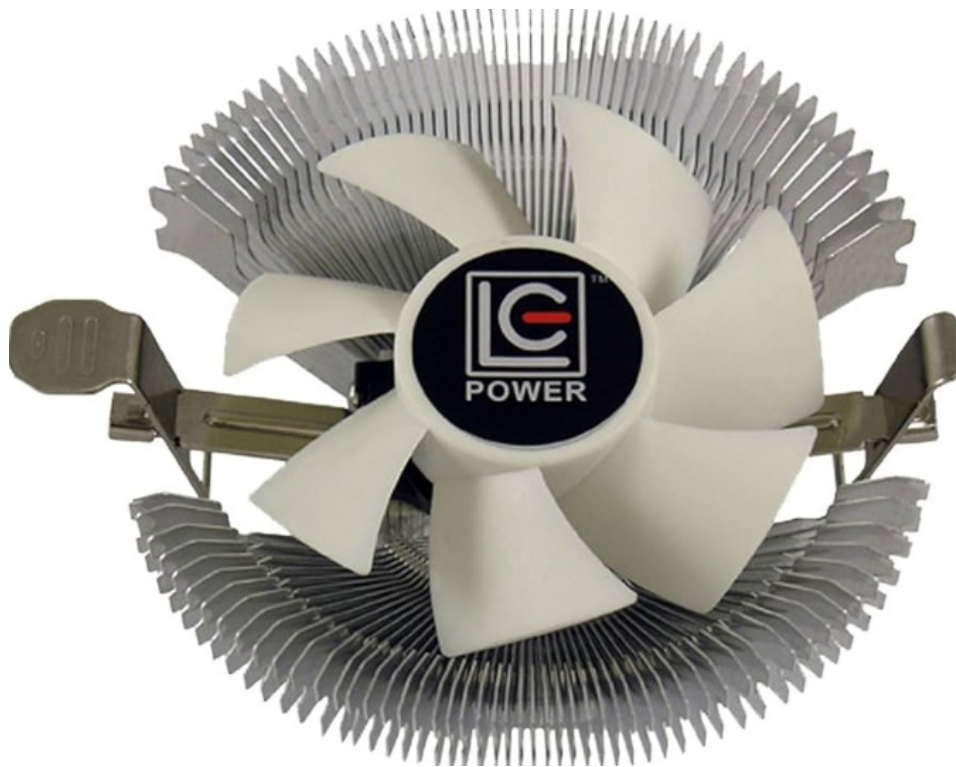

Thank you for choosing a LC-Power product, please read the manual carefully before installation, thank you!

CPU cooler

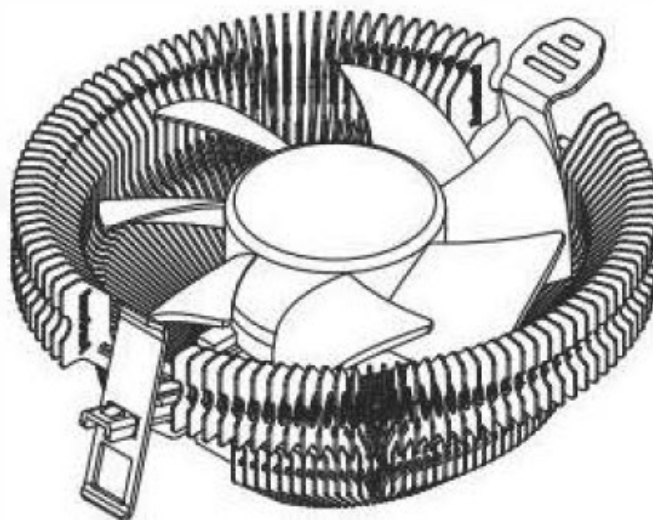

Specification

- **Dimension:** 104 x 100 x 45mm
- **Weight:** 147g
- **Heat sink:** Aluminium
- **Bearing:** Hydraulic
- **Fan Size:** 80 × 80 x 25mm
- **Fan Speed:** 800 – 2200 RPM

- **Air Speed:** 11.62 – 32.45CFM
- **Connector:** 4 pin PWM
- **Socket:** Intel 1851/1700/1200/1156/1155/1151/1150 AMD AM5/4/3/3+/2/2+/FM/2/1

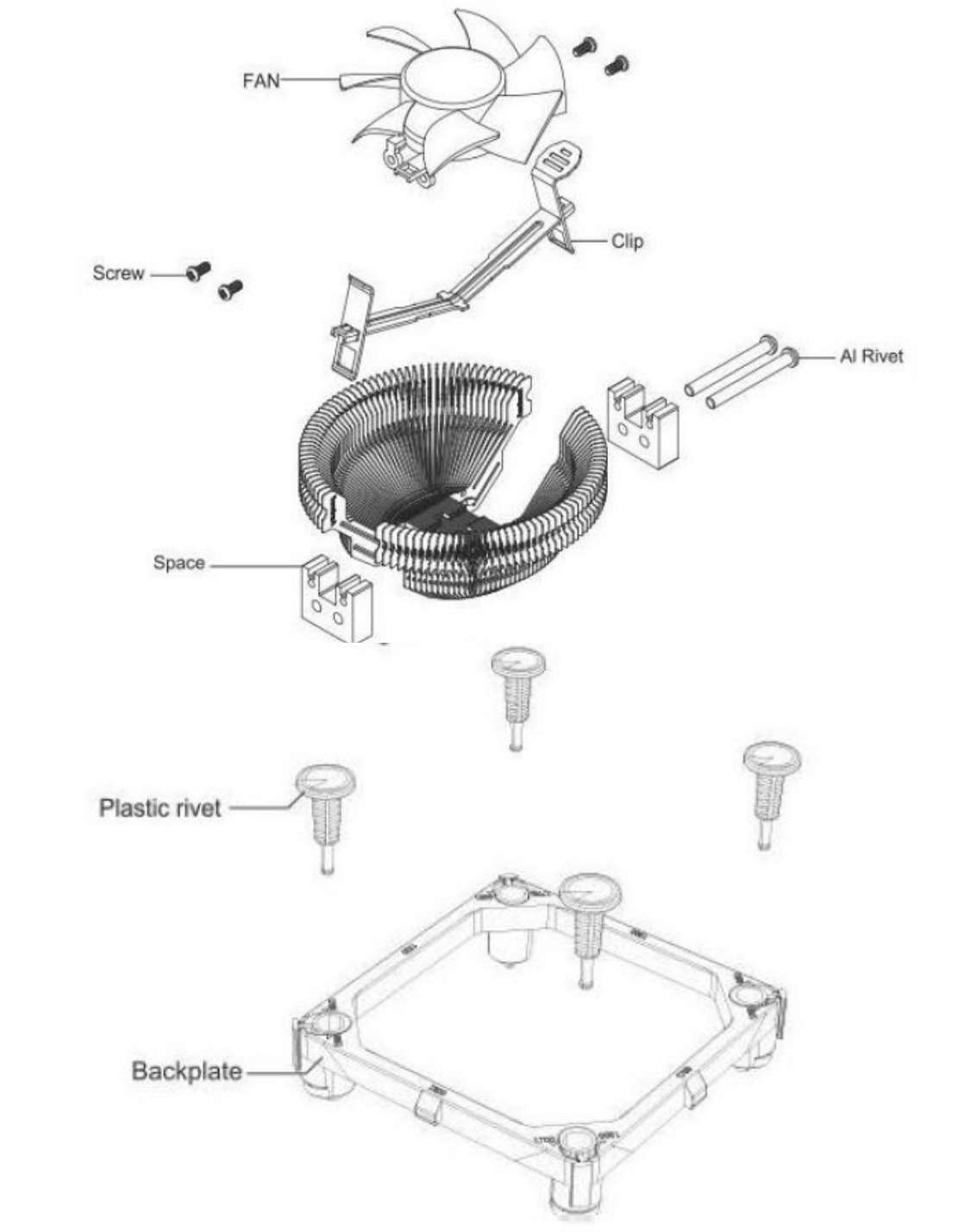

Before installation, please confirm that the CPU cooler is suitable to cool down the heat of your individual CPU model.

Basic information

Please make sure that the thermal paste is evenly distributed on the top of your CPU in case it has not already been applied to the cooler heat sink bottom directly.

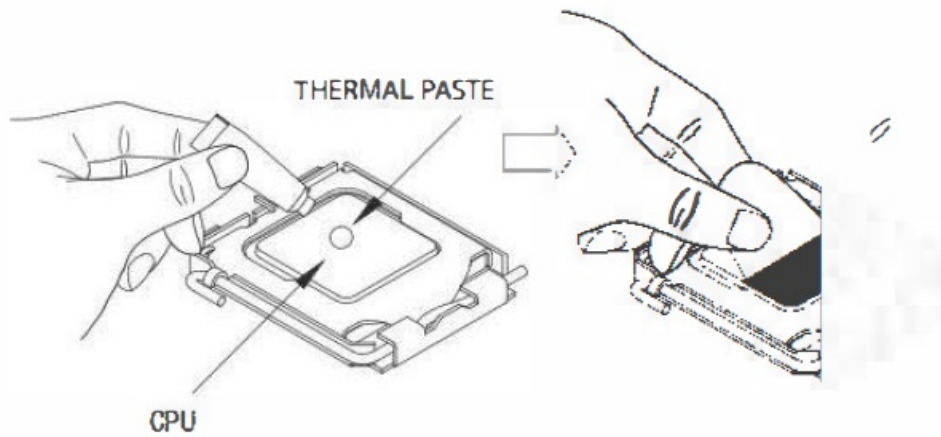

Installation

Intel LGA 1851/1700 socket mainboard installation instructions

1. Please push plastic pin A to the 1851/1700 mark direction as shown' on picture 1-1.
2. Confirm that the direction of the 4 plastic pins is right, then press the whole set of plastic clips into the installation hole on the mainboard, then insert the plastic rivets to fix them as shown on picture 1-2.

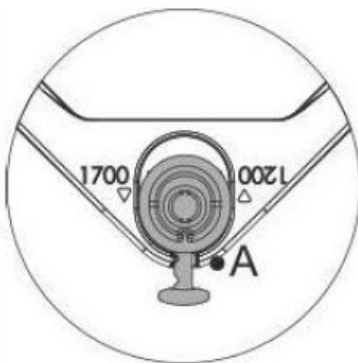

1-1

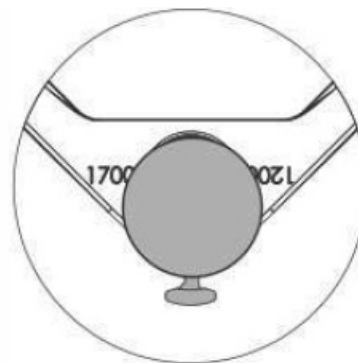

1-2

Intel LGA 115X/1200 socket mainboard installation instructions

1. Please pull plastic pin A to the 1200 mark direction as shown on picture 1-1. 2.
2. Confirm that the direction of the 4 plastic pins is right, then press the whole set of plastic clips into the installation hole on mainboard, then insert the plastic rivets to fix then as shown on picture 2-2.



2-1

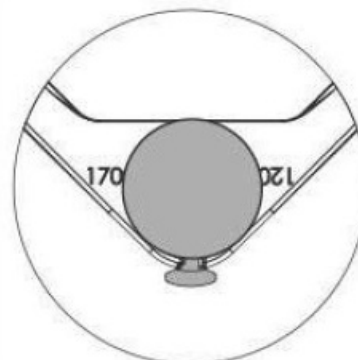

2-2

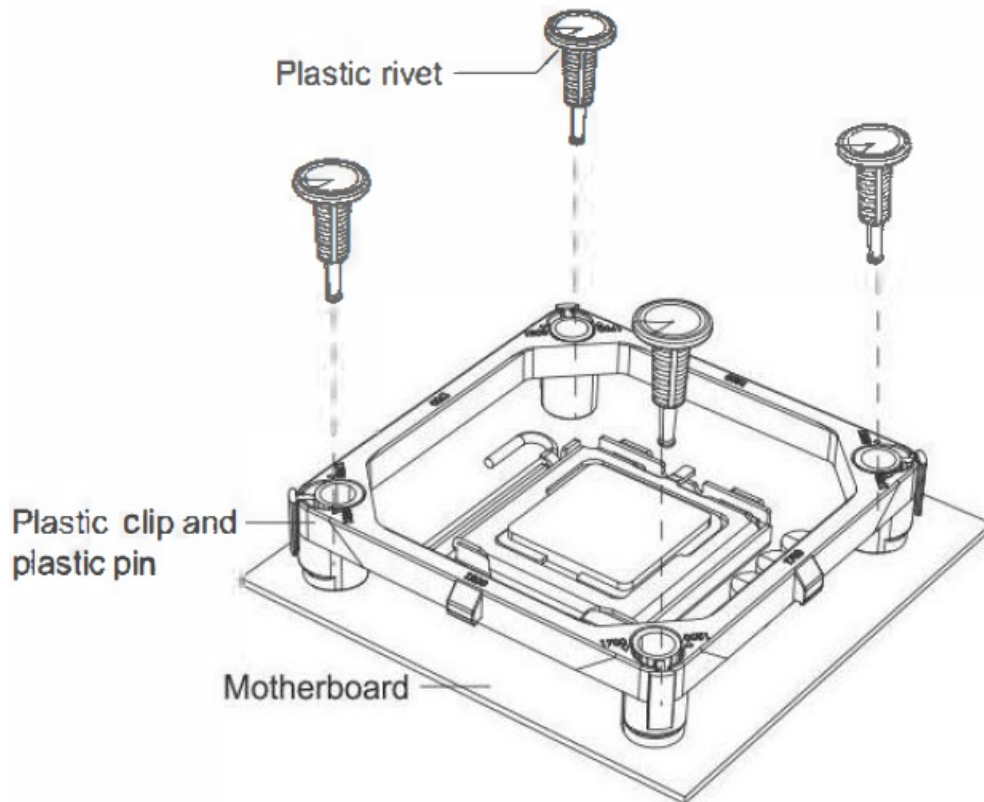

3. Connect the fan cable connector to the power socket on the mainboard where marked as „CPU FAN“. Start your computer and check if everything works properly and if the CPU is properly cooled, then finish installation.

AMD FM1/2/AM2/3/4/5 socket mainboard installation instructions

1. Put the CPU cooler to the center of the plastic clip. Hitch the tail of the cooler clip to the plastic clip. Then move the other side of the cooler clip and hitch it to the other side of the plastic clip.

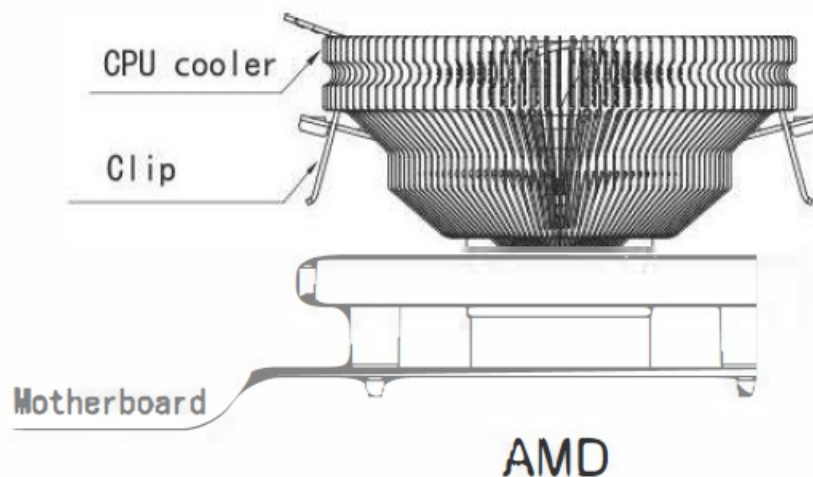

2. Connect the fan cable connector to the power socket on the mainboard where marked as “CPU FAN“. Start your computer and check if everything works properly and if the CPU is properly cooled, then finish installation.

- LEPOWER Silent Power Electronics GmbH, Formerweg 8, 47877 Willich, Germany,
- support@lc-power.com
- www.lc-power.com

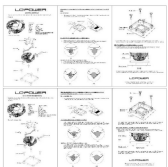

[LC-POWER LC-CC-85 CPU Cooler](#) [pdf] User Manual
LC-CC-85, LC-CC-85 CPU Cooler, LC-CC-85, CPU Cooler, Cooler

References

- [User Manual](#)

Manuals+. [Privacy Policy](#)

This website is an independent publication and is neither affiliated with nor endorsed by any of the trademark owners. The "Bluetooth®" word mark and logos are registered trademarks owned by Bluetooth SIG, Inc. The "Wi-Fi®" word mark and logos are registered trademarks owned by the Wi-Fi Alliance. Any use of these marks on this website does not imply any affiliation with or endorsement.