



LAZER ELITE Linear 6 Elite LED Lightbar Instructions

[Home](#) » [LAZER](#) » LAZER ELITE Linear 6 Elite LED Lightbar Instructions 

LAZER ELITE Linear 6 Elite LED Lightbar



Contents

- [1 ELECTRICAL CONNECTION](#)
- [2 FUNCTIONS](#)
- [3 CANBUS INTEGRATION](#)
- [4 SIDE MOUNTING INFORMATION](#)
- [5 WARRANTY INFORMATION](#)
- [6 FITTING REGULATIONS](#)
- [7 ACCESSORIES](#)
- [8 CUSTOMER SUPPORT](#)
- [9 Documents / Resources](#)
 - [9.1 References](#)

ELECTRICAL CONNECTION

BRANCHEMENT

Please disconnect the vehicle battery before installing or servicing your LED light installation. If in doubt, it is recommended to use the services of a professional installer. It is recommended to use the available

corresponding Lazer wiring kit for your product. If utilizing existing (non Lazer) wiring, make sure to use appropriate wire gauge and fusing in line with your lights.

SUPERSEAL (3-PIN) / APTIV (3-PIN) | LINEAR-6 ELITE+ & LINEAR-18 ELITE+

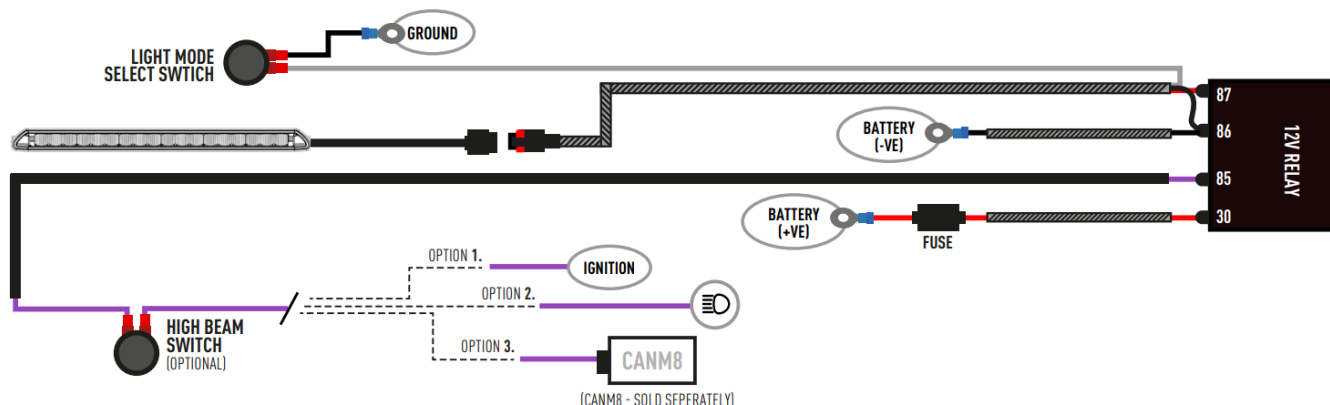

- BLACK WIRE:** GROUND
- RED WIRE:** POSITIVE
- GREY WIRE:** LIGHT MODE SELECT

ECONOSEAL (2-PIN) / APTIV (2-PIN) + SUPERSEAL (3-PIN) | TRIPLE-R 1250 ELITE+ & TRIPLE-R 24 ELITE+

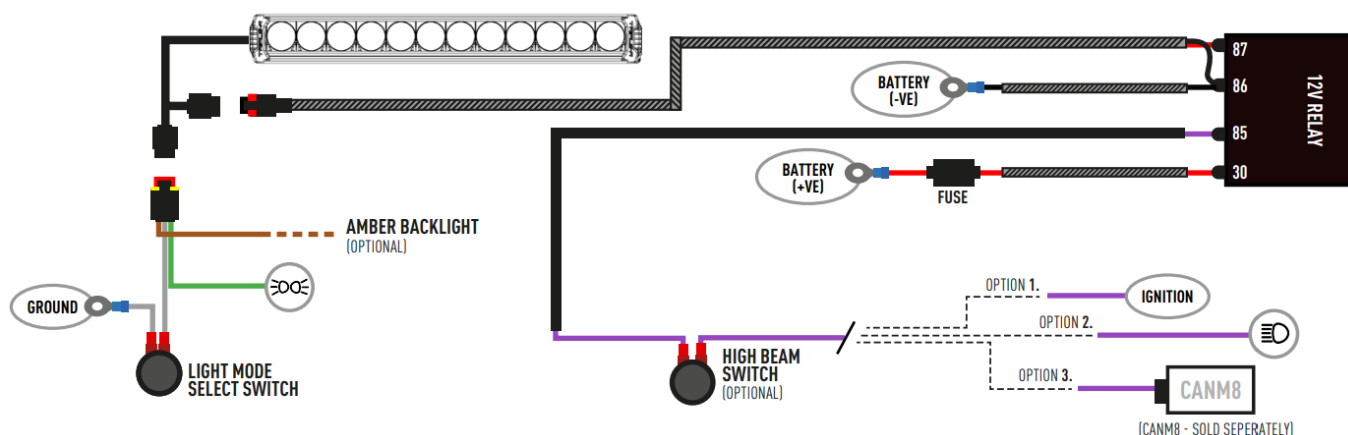

- BLACK WIRE:** GROUND
- RED WIRE:** POSITIVE
- GREY WIRE:** LIGHT MODE SELECT
- GREEN WIRE:** WHITE BACKLIGHT
- BROWN WIRE:** AMBER BACKLIGHT

FUNCTIONS

LES FONCTIONS

The Elite+ LED light bars can operate in 4 different lighting modes, with internal memory to recall the last selected mode:

- Boost (white only)
- Combo (white + yellow)

- Snow/Fog/Dust Mode (yellow only)
- E-mark/Low Output Mode (white only)

The different functions are selected by applying power to the corresponding Light Mode Selection wire on each lamp. It is recommended to install a momentary switch to facilitate selection of each different mode. Depressing such a switch for 2 seconds will cause the light to immediately activate the E-mark/Low Output Mode.

† CANBUS INTEGRATION

INTEGRATION CANBUS

For vehicles where it is not possible to locate a 12V high beam signal, it will be necessary to take the high beam signal from the vehicle's CAN system. For vehicle specific CAN instructions, please download the "CANM8 Connects" App.

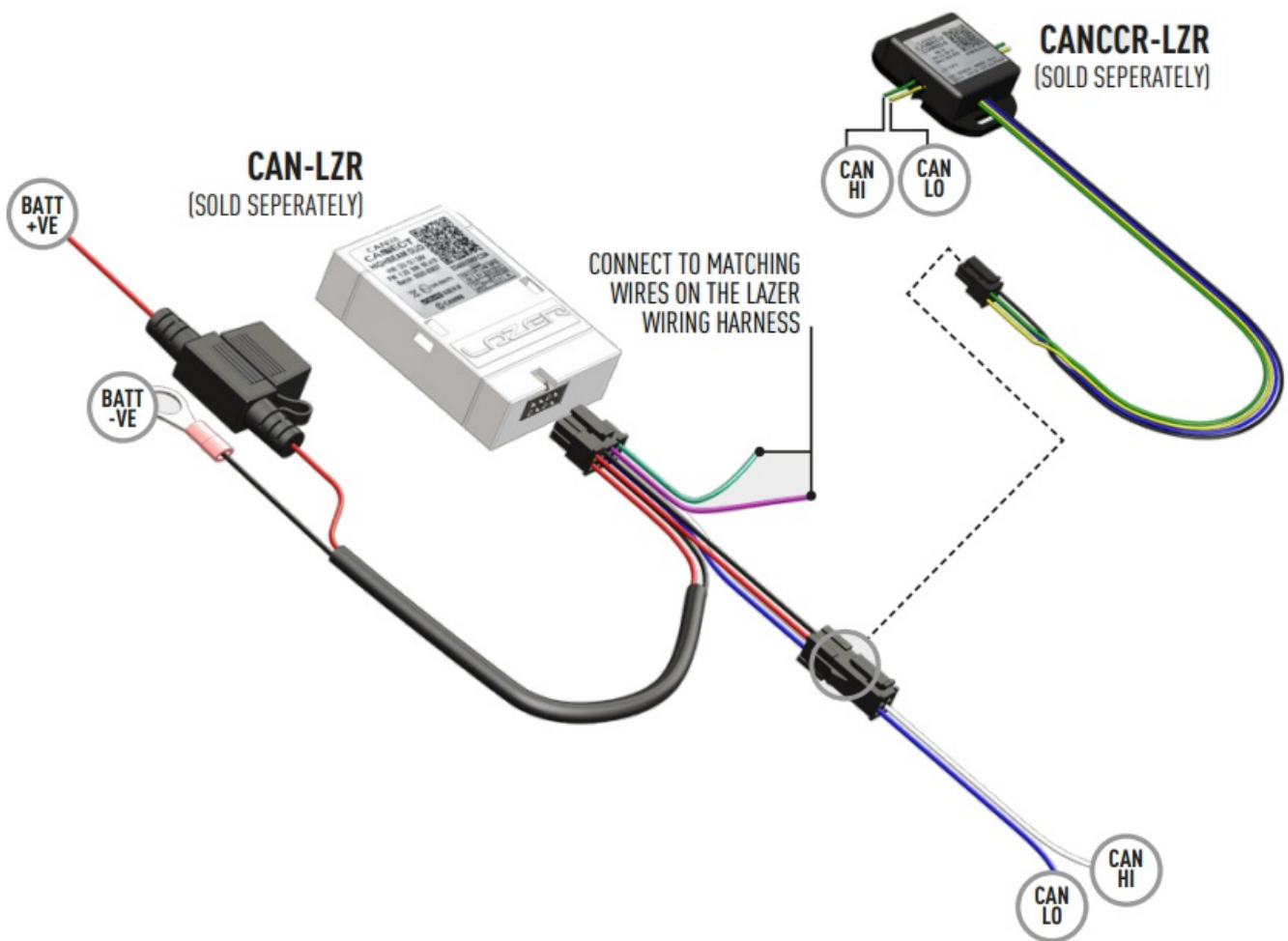

SIDE MOUNTING INFORMATION

INFOS SUR LE MONTAGE

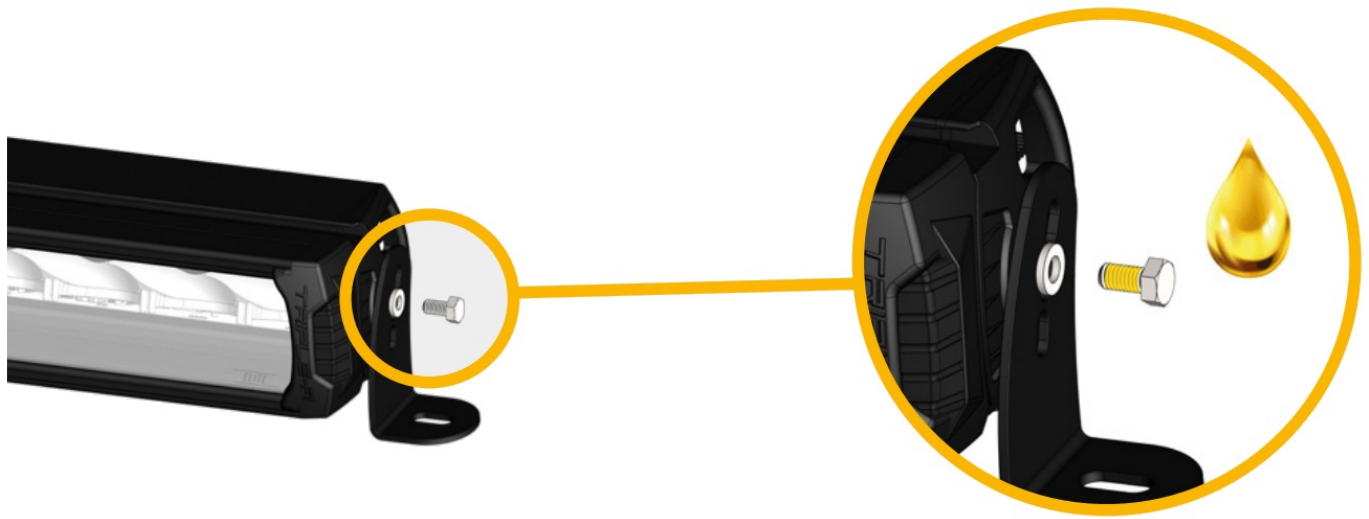

WARRANTY INFORMATION

INFORMATIONS DE GARANTIE

Your purchase of this Lazer Lamps product is an investment in a product designed and manufactured to the highest standards, but sometimes things can go wrong. You do not need to register your product with us, as we can trace the product through the unique serial number of the lamp. In the unlikely event of having to make a claim, please retain your purchase receipt and pass it back to the retailer from where you first purchased the product, at the point of raising any issue. We hope you enjoy your Lazer Lamps product, and wish you many years of a safer, more enjoyable night driving experience.

FITTING REGULATIONS

INSTRUCTIONS DE MONTAGE

Lamps with integrated Position light may need to be positioned according to the above sketch. If an additional pair of position lights is not permitted (e.g. in Switzerland, Austria), the position light should be disconnected. The legal regulations in individual countries must be observed.

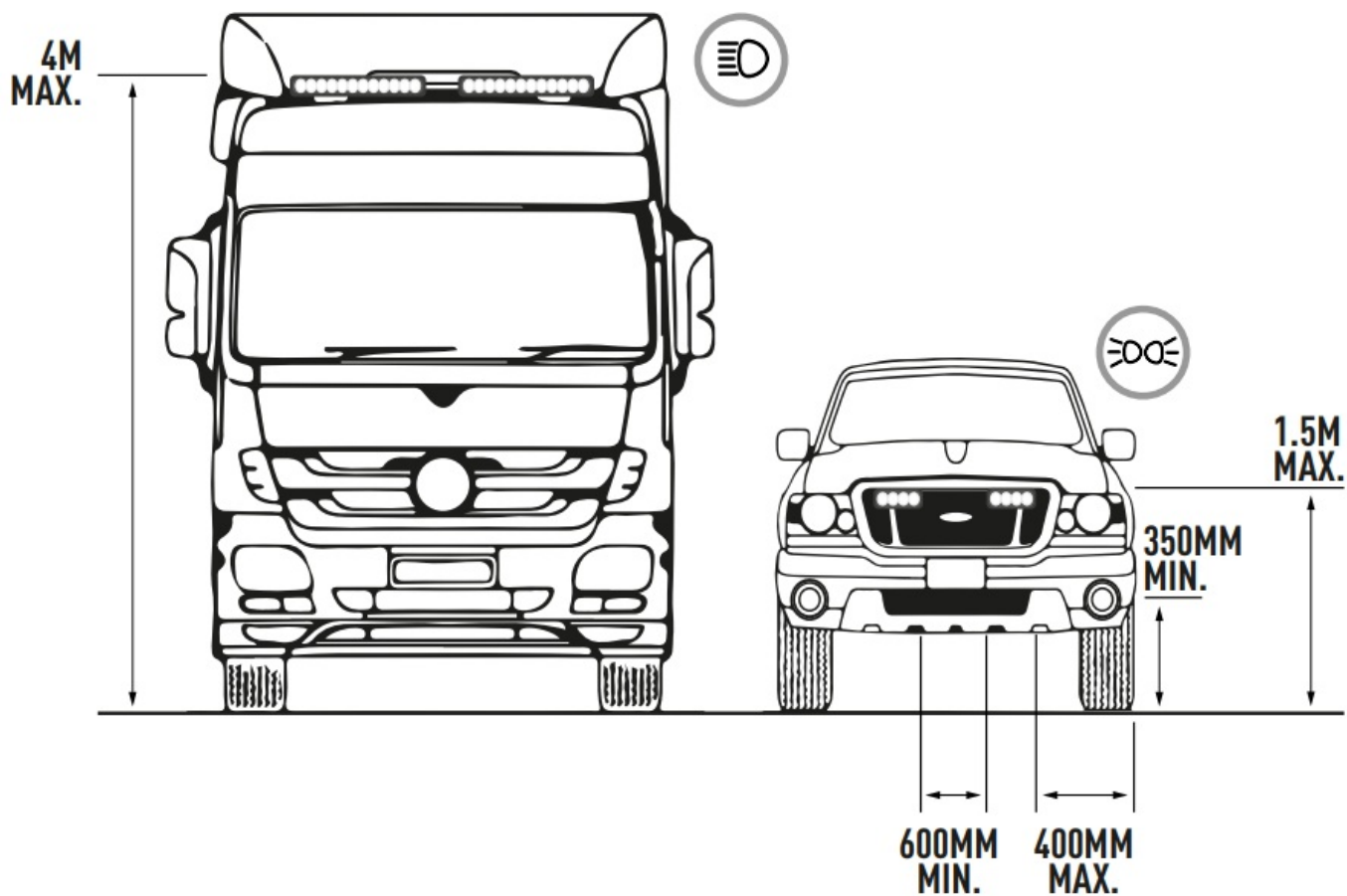

ACCESSORIES

LES ACCESSOIRES DISPONIBLES

- BESPOKE GRILLE INTEGRATION KITS



- UNIVERSAL ROOF MOUNTING KITS



- ACCESSORIES & MOUNTS



- WIRING KITS AND CANBUS SYSTEMS



CUSTOMER SUPPORT

We appreciate your purchase of a Lazer Lamps product, and value your feedback. If you would like to leave feedback on your Lazer experience, please head to the relevant product page on our website

www.lazerlamps.com.

WWW.LAZERLAMPS.COM

T +44 (0) 1992 677374

E sales@lazerlamps.com

Lazer Lamps Ltd, Calder House, Central Road
Harlow, Essex, CM20 2ST, UK



MADE IN THE UK
/LAZERLAMPS



LAZER
HIGH PERFORMANCE LIGHTING

Documents / Resources



[LAZER ELITE Linear 6 Elite LED Lightbar](#) [pdf] Instructions

ELITE Linear 6 Elite LED Lightbar, ELITE, Linear 6 Elite LED Lightbar, 6 Elite LED Lightbar, Elite LED Lightbar, LED Lightbar, Lightbar

References

-  [Lazerlamps: Superior LED Driving Lights - Made In UK](#)
- [User Manual](#)

[Manuals+](#), [Privacy Policy](#)

This website is an independent publication and is neither affiliated with nor endorsed by any of the trademark owners. The "Bluetooth®" word mark and logos are registered trademarks owned by Bluetooth SIG, Inc. The "Wi-Fi®" word mark and logos are registered trademarks owned by the Wi-Fi Alliance. Any use of these marks on this website does not imply any affiliation with or endorsement.