



LAUNCH X431 IMMO Elite Complete Key Programming Tool User Guide

[Home](#) » [Launch](#) » LAUNCH X431 IMMO Elite Complete Key Programming Tool User Guide 

LAUNCH

X431 IMMO Elite Complete Key Programming Tool
User Guide

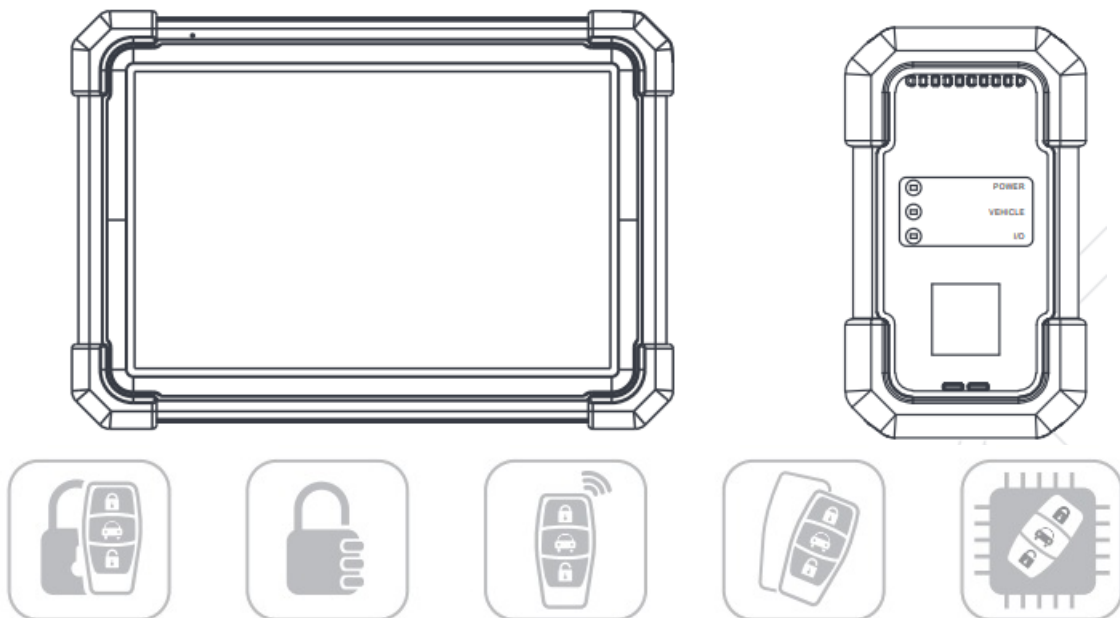

Quick Start Guide

Contents

[1 Safety Instructions](#)

[2 Precautions & Disclaimer](#)

[3 Working Principle](#)

[4 Register & Update](#)

[5 Connection & Operations](#)

[6 Documents / Resources](#)

[6.1 References](#)

[7 Related Posts](#)

Safety Instructions

Before using this test equipment, please read the following safety information carefully.

- Always perform automotive testing in a safe environment.
- Do not connect or disconnect any test equipment while the ignition is on or the engine is running.
- DO NOT attempt to operate the tool while driving the vehicle. Have second personal operate the tool. Any distraction may cause an accident.
- Before starting the engine, put the gear lever in the Neutral position (for manual transmission) or in the Park (for automatic transmission) position to avoid injury.
- NEVER smoke or allow a spark or flame in vicinity of battery or engine. Do not operate the tool in explosive atmospheres, such as in the presence of flammable liquids, gases, or heavy dust.
- Keep a fire extinguisher suitable for gasoline/chemical/electrical fires nearby.
- Wear an ANSI-approved eye shield when testing or repairing vehicles.
- Put blocks in front of the drive wheels and never leave the vehicle unattended while testing.
- Use extreme caution when working around the ignition coil, distributor cap, ignition wires and spark plugs. These components create hazardous voltage when the engine is running.
- To avoid damaging the tool or generating false data, please make sure the vehicle battery is fully charged and the connection to the vehicle DLC (Data Link Connector) is clear and secure.
- Automotive batteries contain sulfuric acid that is harmful to skin. In operation, direct contact with the automotive batteries should be avoided. Keep the ignition sources away from the battery at all times.
- Keep the tool dry, clean, free from oil, water or grease. Use a mild detergent on a clean cloth to clear the outside of the equipment when necessary.
- Keep clothing, hair, hands, tools, test equipment, etc. away from all moving or hot engine parts.
- Store the tool and accessories in a locked area out of the reach of children.
- Do not use the tool while standing in water.
- Do not expose the tool or power adaptor to rain or wet conditions. Water entering the tool or power adaptor increases the risk of electric shock.
- Please use the included battery and power adaptor. Risk of explosion if the battery is replaced with an incorrect type.
- Because there are various procedures, techniques, tools, and parts for servicing vehicles, as well as the skill of the person doing the service work, the technician must be well knowledgeable of the vehicle and the system being tested.
- The vehicle parts and the X-PROG 3 components are welded at a constant temperature.

- When welding vehicle parts with the X-PROG 3 components, the unit is powered off and is grounded.

Precautions & Disclaimer

Copyright Information

Copyright © 2021 by LAUNCH TECH CO., LTD (also called LAUNCH for short). All rights reserved. No part of this publication may be reproduced, stored in a retrieval system, or transmitted in any form or by any means, electronic, mechanical, photocopying, recording or otherwise, without the prior written permission of LAUNCH.

Statement: LAUNCH owns the complete intellectual property rights for the software used by this product. For any reverse engineering or cracking actions against the software, LAUNCH will block the use of this product and reserve the right to pursue their legal liabilities.

Disclaimer of Warranties and Limitation of Liabilities

All information, illustrations, and specifications in this manual are based on the latest information available at the time of publication.

The right is reserved to make changes at any time without notice. We shall not be liable for any direct, special, incidental, indirect damages or any economic consequential damages (including the loss of profits) due to the use of the document.

FCC Statement

Any Changes or modifications not expressly approved by the party responsible for compliance could void the user's authority to operate the equipment.

This device complies with part 15 of the FCC Rules. Operation is subject to the following two conditions: (1) This device may not cause harmful interference, and (2) this device must accept any interference received, including interference that may cause undesired operation.

Note: This equipment has been tested and found to comply with the limits for a Class B digital device, pursuant to Part 15 of the FCC Rules. These limits are designed to provide reasonable protection against harmful interference in a residential installation.

This equipment generates, uses, and can radiate radio frequency energy, and if not installed and used in accordance with the instructions, may cause harmful interference to radio communications. However, there is no guarantee that interference will not occur in a particular installation. If this equipment does cause harmful interference to radio or television reception, which can be determined by turning the equipment off and on, the user is encouraged to try to correct the interference by one or more of the following measures:

- Reorient or relocate the receiving antenna.
- Increase the separation between the equipment and receiver.
- Connect the equipment into an outlet on a circuit different from that to which the receiver is connected.

Working Principle

Diagnostics/Key Immobilizer (IMMO) Operations

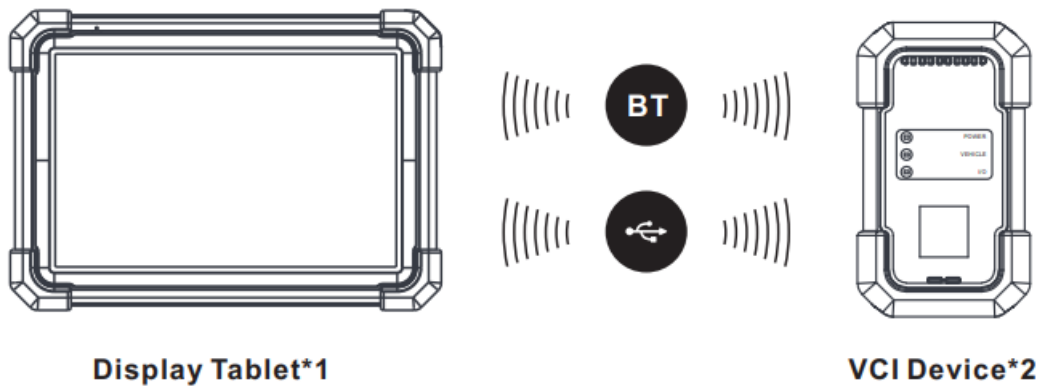

1. On the home screen, tap Settings -> Network & Internet -> WLAN. *1. WLAN Setting
2. Select the desired WLAN connection from the list (Password may be required for secured networks).
3. When “Connected” appears, it indicates that it is properly connected to the network.

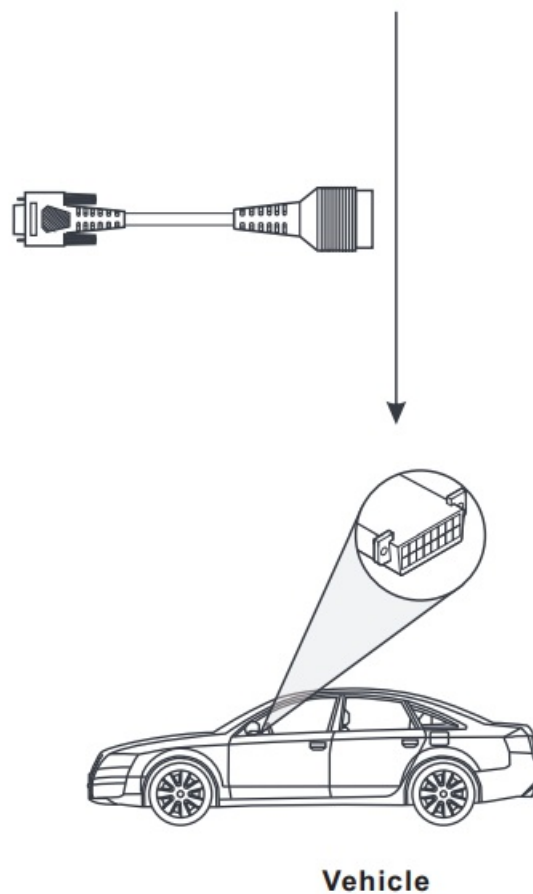

***2. Communication Setup**

If the VCI is successfully activated, it will be automatically bound to the tablet. In this case it is not necessary for the user to manually configure the wireless communication link again. Refer to Section “Register & Update” for VCI activation.

Immobilizer Programming (IMMO PROG) Operations

The X-PROG 3 is required when performing IMMO PROG or IMMO (for some vehicle models) operation. It has the following functions:

- 1). Read transponder data (including Mercedes Benz infrared smart key), and generate exclusive keys.
- 2). Read/write on-board EEPROM chip data, and read/write MCU/ECU chip data.

***Warning:** Programming does not require a connection to the vehicle. To ensure that the X-PROG 3 works properly, ONLY use the power adaptor and OBD I adaptor to supply power to the X-PROG 3. Obtaining power

through a connection to the DC power jack of the X-PROG 3 via the power adaptor alone is prohibited.

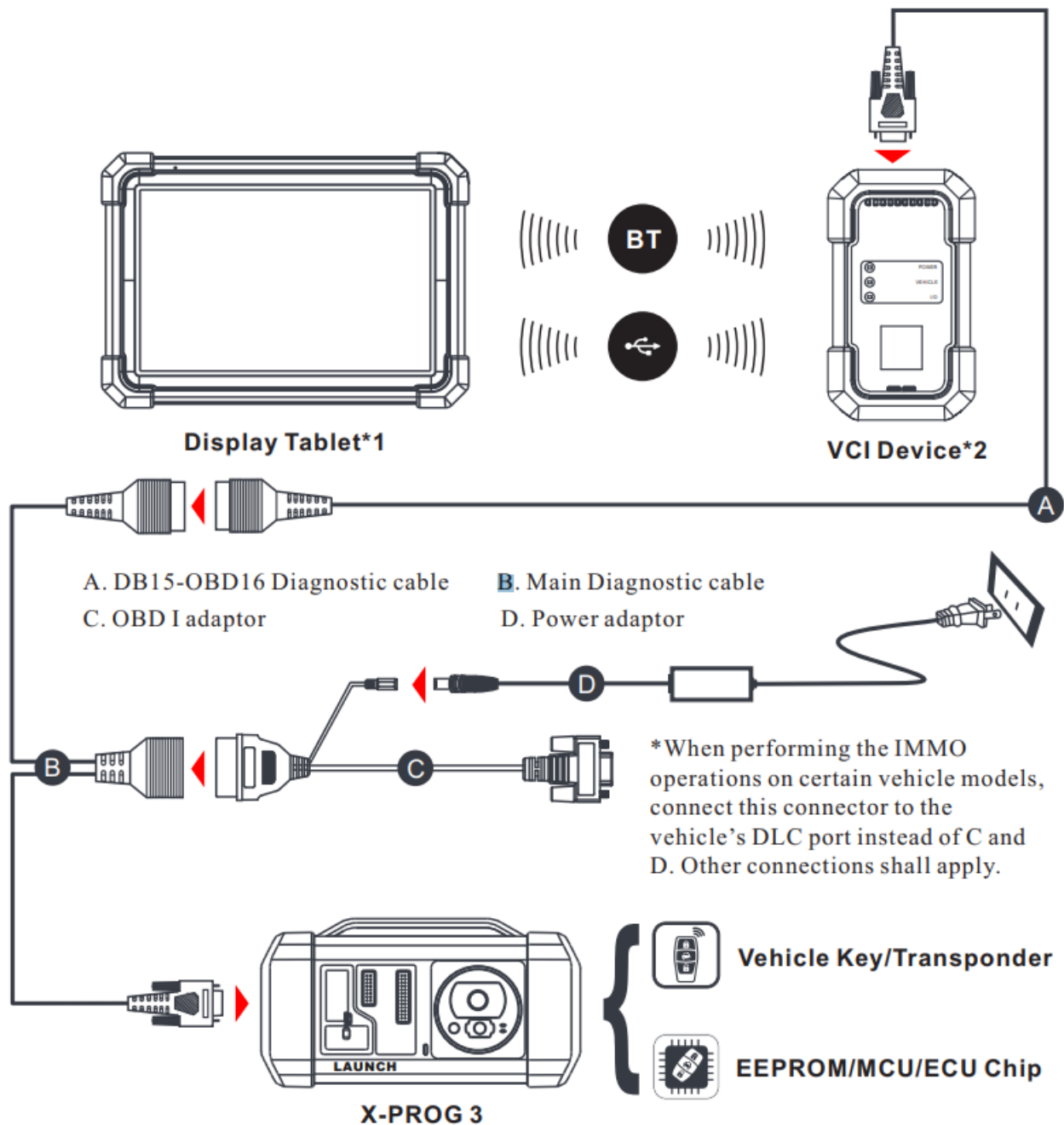

Register & Update

For new users, please follow the operation chart shown below to get started with this tool.

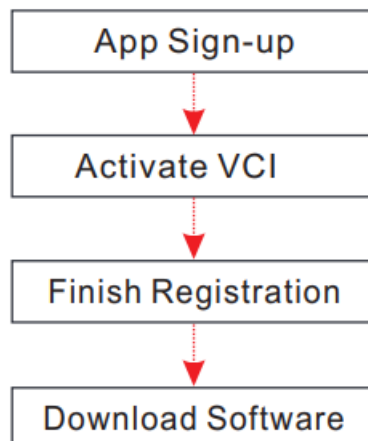

1. Launch App: tap on the application icon on the home screen, and then tap Login on the upper right corner of the screen. The following popup will appear on the screen(*Make sure that the tablet has a strong and stable Wi-Fi signal.).



The image shows a login screen with a red header bar containing the word "Login". Below the header, there are two input fields: "Username" with a user icon and "Password" with a lock icon. A red "LOGIN" button is positioned below these fields. At the bottom left, there is a link "Forgot Password" and at the bottom right, a link "New Registration" which is being pointed to by a hand icon.

2. Create an App Account: Input the information (items with * must be filled) following the on-screen prompts and then tap Register.

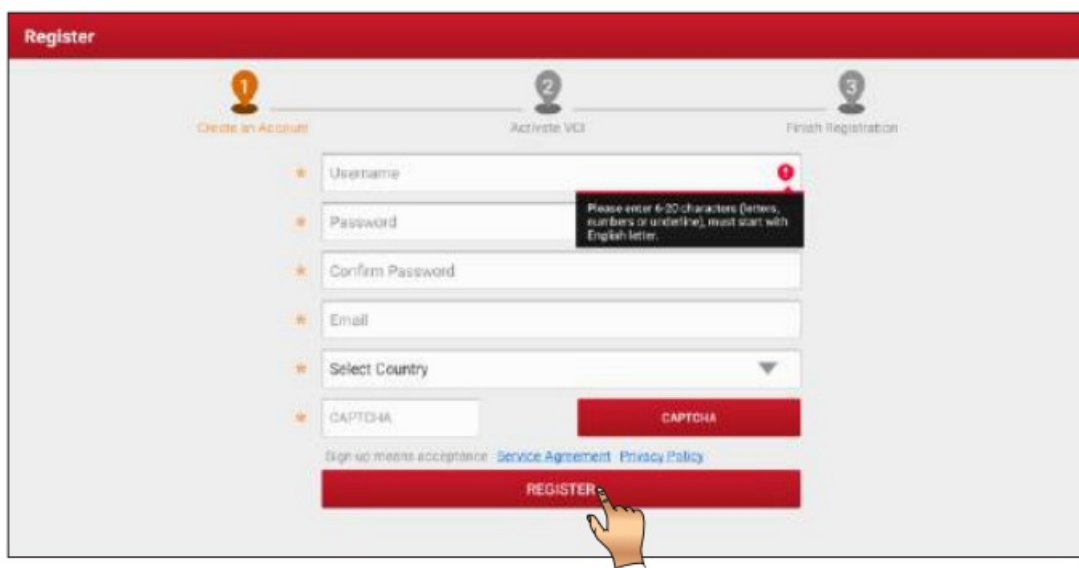

The image shows a registration screen with a red header bar containing the word "Register". Below the header, there are three steps: 1. Create an Account, 2. Activate VCI, and 3. Finish Registration. The first step is active. The form includes fields for Username, Password, Confirm Password, Email, Select Country, and CAPTCHA. A red error message box is visible next to the Password field, stating: "Please enter 6-30 characters (letters, numbers or underline), must start with English letter." A red "REGISTER" button is at the bottom, with a hand icon pointing to it. Links for "Service Agreement" and "Privacy Policy" are also present.

3. Activate VCI: Input the 12-digit Product S/N and 8-digit Activation Code (can be obtained from the included Password Envelope), and then tap Activate.

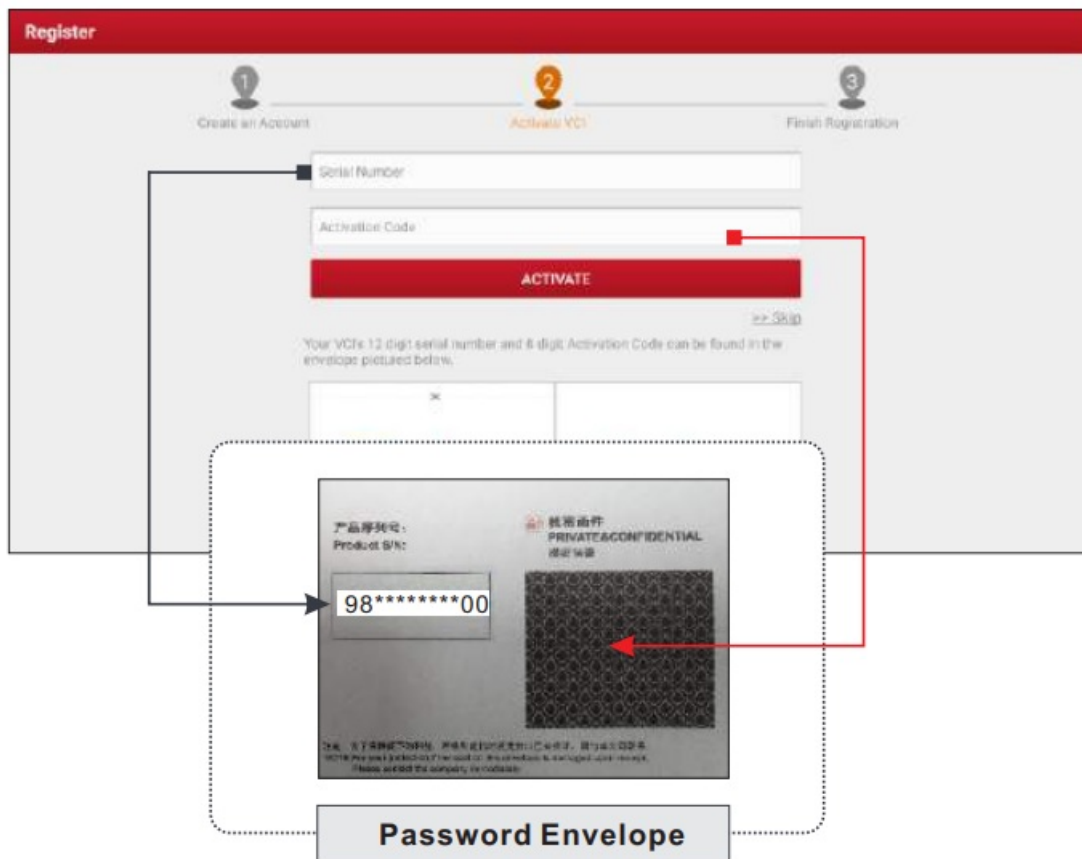

4. Finish Registration & Download Diagnostic Software: Tap OK to enter the vehicle software download screen.
Tap Update on the update page to start downloading.
Once downloading finished, the software packages will be installed automatically.
*All software is updated periodically. It is recommended to check regularly for updates and install the latest software version for the best service and functions.

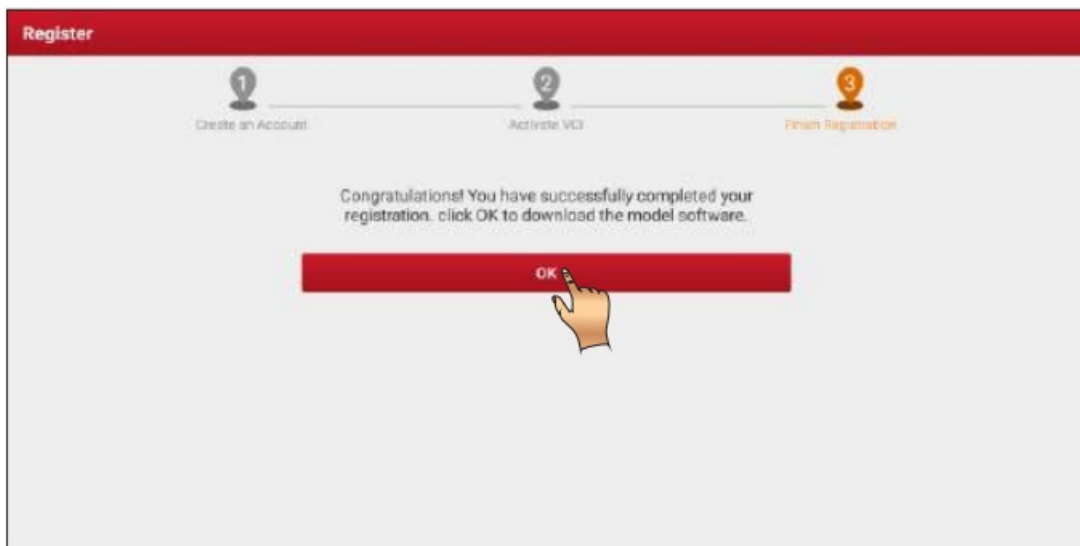

Connection & Operations

1. Preparation

Before diagnosing, please make sure the following conditions are met:

- 1). The ignition is turned on.
- 2). The vehicle battery voltage range is 11-14Volts.
- 3). Locate the vehicle's DLC port.

For passenger cars, the DLC is usually located 12 inches away from the center of the instrument panel, under or around the driver's side for most vehicles. For some vehicles with special designs, the DLC may vary. Refer to the following figure for possible DLC location.

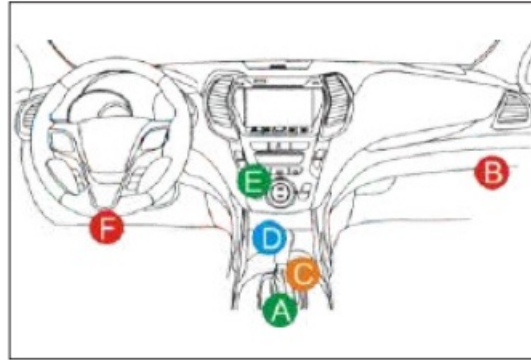

A. Opel, Volkswagen, Audi

B. Honda

C. Volkswagen

D. Opel, Volkswagen, Citroen

E. Chandan

F. Hyundai, Daewoo, Kia, Honda, Toyota, Nissan, Mitsubishi, Renault, Opel, BMW, Mercedes-Benz, Mazda, Volkswagen, Audi, GM, Chrysler, Peugeot, Regal, Beijing Jeep, Citroen and most prevailing models

If the DLC cannot be found, refer to the vehicle's service manual for the location.

2. **Connection** (When performing **Diagnostics / Key Immobilizer operations**) For vehicles equipped with OBD II diagnostic socket, connect the VCI device to the vehicle's DLC via the included diagnostic cable.



*For non-OBD II vehicles, a non-16pin connector(adaptor) is required. Refer to the User Manual for more detailed connection method.

3. **Key Immobilizer & Immobilizer Programming**

1). **Immobilizer**

This function enables you to perform the anti-theft key matching function, so that the immobilizer control system on the car identifies and authorizes remote control keys to normally use the car.

2). **Immobilizer Programming**

This function allows you to perform the following functions:

- 1). Read key transponder data, and generate exclusive keys.
- 2). Read/write on-board EEPROM chip data, and read/write MCU/ECU chip data.

4. **Diagnostics**

- 1). Intelligent Diagnose

This function allows you to use the VIN information of the currently identified vehicle to access its data (including vehicle information, historical diagnostic records) from the cloud server to perform quick test, eliminating guesswork and step-by-step manual menu selection.

2). Local Diagnose

Use this function to diagnose a vehicle manually. For new users, please follow the operation chart shown below to get familiar with and start using this tool.

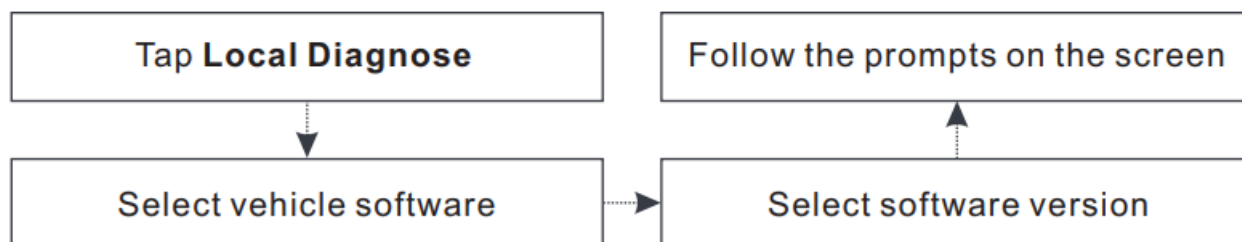

3). Remote Diagnose

This function helps repair shops or mechanics to diagnose a remote vehicle, and launch instant messages, allowing for improved efficiency and faster repairs.

LAUNCH

IF YOU HAVE QUESTIONS OR COMMENTS, CONTACT US.



+86-755-8455-7891

WWW.X431.COM

Documents / Resources

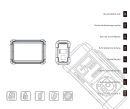

[LAUNCH X431 IMMO Elite Complete Key Programming Tool](#) [pdf] User Guide
X431 IMMO Elite Complete Key Programming Tool, X431, IMMO Elite Complete Key Programming Tool, Complete Key Programming Tool, Key Programming Tool, Programming Tool

References

- [X431](#)