



LASUNEY ALL-IN-ONE USB C HUB WITH TRIPLE DISPLAY User Manual

[Home](#) » [LASUNEY](#) » LASUNEY ALL-IN-ONE USB C HUB WITH TRIPLE DISPLAY User Manual 

LASUNEY

Product Manual

ALL-IN-ONE USB C HUB WITH TRIPLE DISPLAY

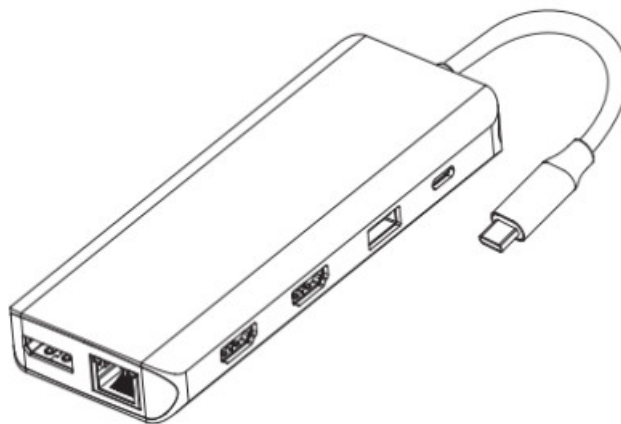

Product Introduction

This All-in-one Multifunction USB-C hub offers convenient access to multiple devices on your USB-C Laptop/MacBook. Simply plug and play to expand your laptop's capabilities. And please connect your charger with the hub.

Contents

- 1 Structure Diagram
- 2 Specifications
- 3 Attention
- 4 Multiple Display Settings for Wins
- 5 Mirror Mode(Clone mode/SST)
- 6 Extended Mode(MST)
- 7 Dual Display Setting for Mac OS
 - 7.1 Mirror Display
 - 7.2 Extend Display
- 8 Resolution Setting
- 9 Documents / Resources
- 10 Related Posts

Structure Diagram

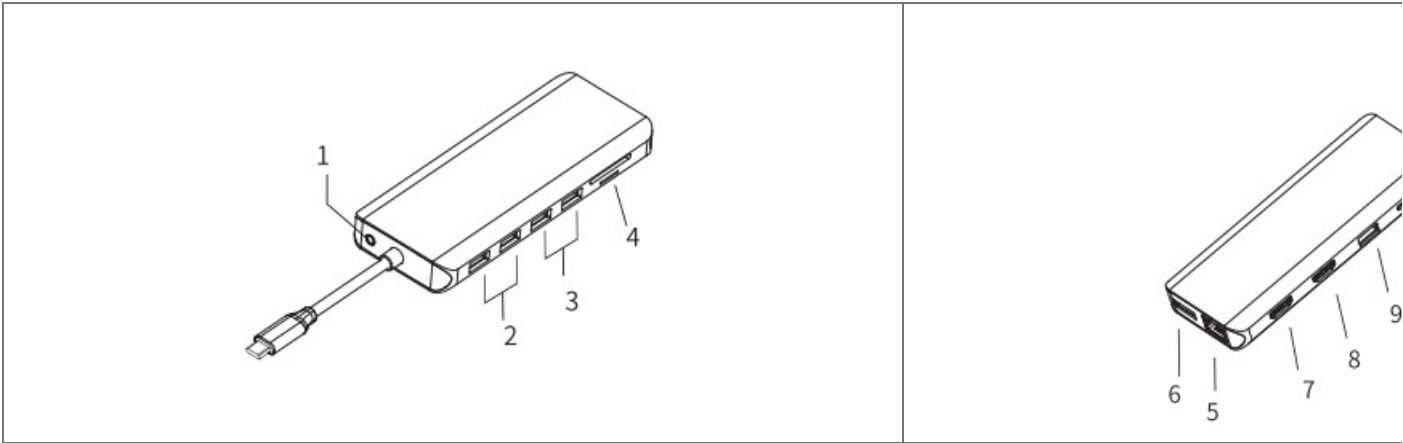

1.Audio/mic 2.USB 3.0 3.USB 2.0 4.SD&TF 5.RJ45	6.DP 7. HDMI 2 8. HDMI 1 9.USB 3.0 10.PD 3.0
--	--

Specifications

Product Model	UC0219
Connector	USB 3.1 Type-C connector
Dimension	4.8×2.13×0.65 inches
Cord Length	6 inches
Weight	0.26 lb
USB-C female charging port(PD3.0)	Only for USB-C laptop or USB-C smartphone charging. Input power can up to 87W but request you to use at least a 90W charger as the hub will consume part of the power.
HDMI output port	Resolution up to 4K/30Hz if two of them play simultaneously. When dual or triple display with DP, they will be 4K/30Hz. If your source is DP1.4, HDMI 1 can up to 4K/60Hz when single plays
DP output port	Resolution up to 4K/60Hz. When dual or triple display with HDMI, they will be 4K/30Hz.
RJ45 Gigabit Ethernet	Speed up to 1000Mbps max.
USB-A 3.0	Speed up to 5Gbps, 5V/0.9A@4.5W.
USB-A 2.0	Speed up to 480Mbps, 5V/0.5A@2.5W. We highly recommend connecting the mouse and keyboard(low-rate devices).
SD/TF Card Reader	Support memory card capacity: up to 512 GB. Read/write speed: up to 104 MB/s SD/TF memory cards can be used on the hub simultaneously.
Mic/Audio	Support Mic and Stereo Audio 2 in 1. Jack standard: CTIA
Requirements	Laptop with available and fully functional USB-C port.
Plug and play	Yes

Attention

1. Please confirm the compatibility of your device before using the hub (whether the Type C port of the computer is a fully functional port).
2. When using the hub, please connect to the computer power supply synchronously to ensure the normal use of

the various functions of the hub.

3. Please don't plug in violently to prevent damaging the ports.

The sound setting for Mac

Apple logo> System preferences > Sound

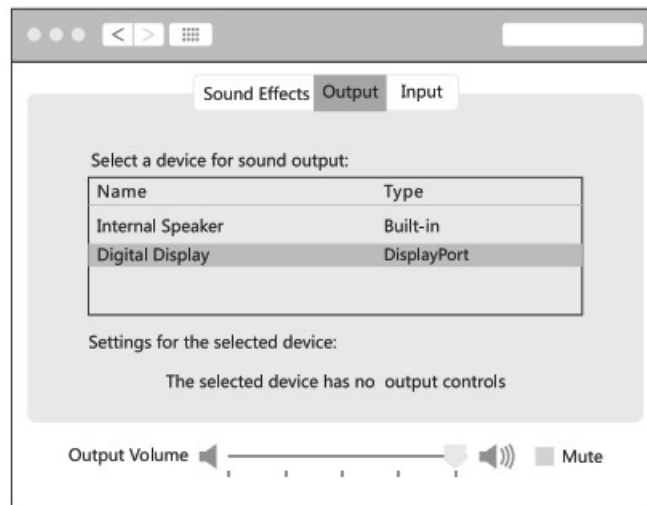

Sound setting for win 10

Right-click desktop >Graphics Settings >Sound> Output

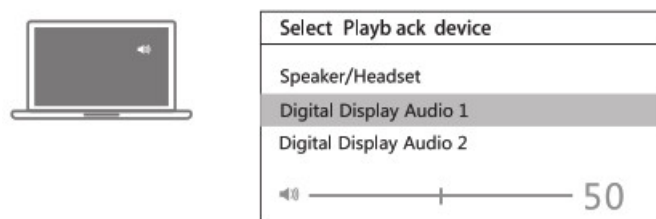

Prerequisites for simultaneous operation of “computer screen + 3 display screens”:

①DP1.4 and AMD processor or ②Computer models listed by Apple after 2018, when the dual system is installed and WIN system is used.

Multiple Display Settings for Wins

NOTE

For most WIN system computers, when multiple external monitors are connected, at most 3 different screens will appear (one computer screen + external monitor 1 + external monitor 2, and the remaining the external monitor will not light up), if you want the images of the three external monitors to be different, you need to turn off the computer screen.

Mirror Mode(Clone mode/SST)

Right-click desktop >Graphics Settings >Display

General Settings	Select Display Mode
Color Settings	Single Display 1 2 3
Multiple Settings	✓ Clone Display Detect
Custom Resolutions	Extended Desktop
DisplayPort Topology	Collage
	Select One or More Active Displays
	Built-in Display ▼
	HDMI Display ▼
	HDMI Display ▼

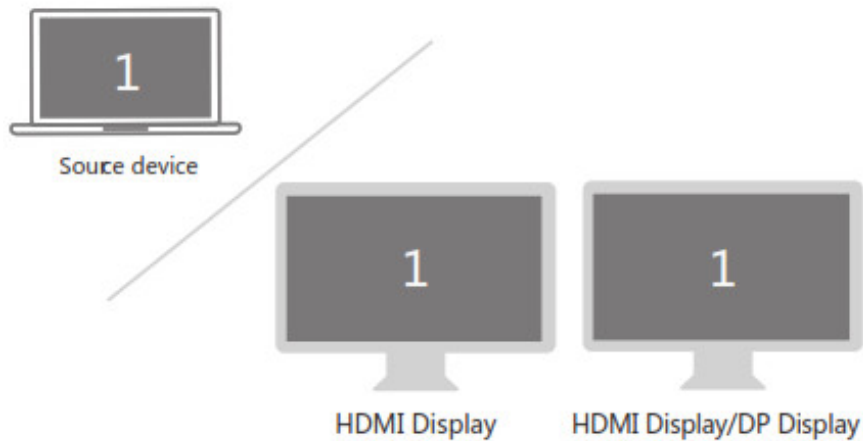

OR

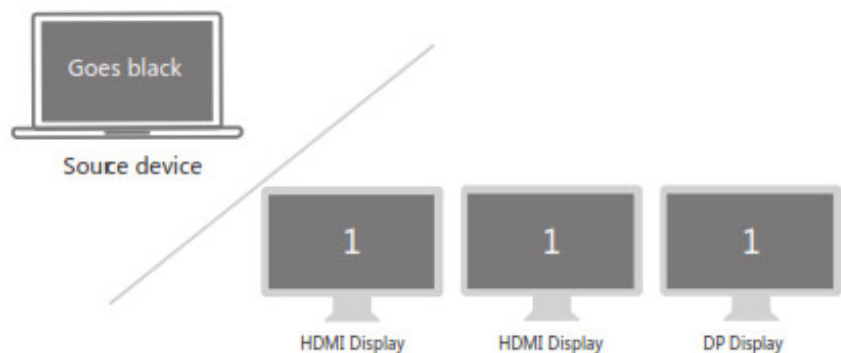

Extended Mode(MST)

Right-click desktop >Graphics Settings >Display

General Settings	Select Display Mode
Color Settings	Single Display 1 2 3
Multiple Settings	✓ Extended Desktop Detect
Custom Resolutions	Collage
DisplayPort Topology	Select One or More Active Displays
	Built-in Display ▼
	HDMI Display ▼
	HDMI Display ▼

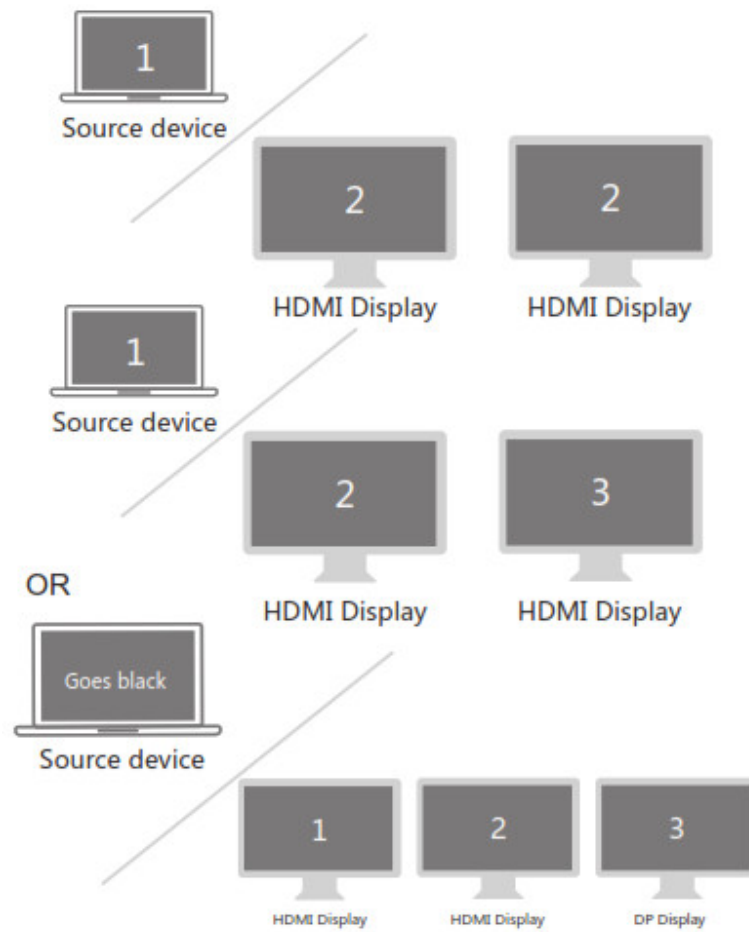

Collage

NOTE: For this mode, PC or Notebook's Video card MUST support MST
Right-click desktop >Graphics Settings >Display

General Settings Color Settings <hr/> Custom Resolutions DisplayPort Topology 	Select Display Mode Single Display Clone Display Extended Desktop <input checked="" type="checkbox"/> Collage		Arrange Display <input checked="" type="checkbox"/> Horizontally Vertically <div>1 2</div> Detect
	<input checked="" type="checkbox"/> Enable Disable		
	Select One or More Active Displays		
	Built-in Display ▼ HDMI Display ▼ HDMI Display ▼		

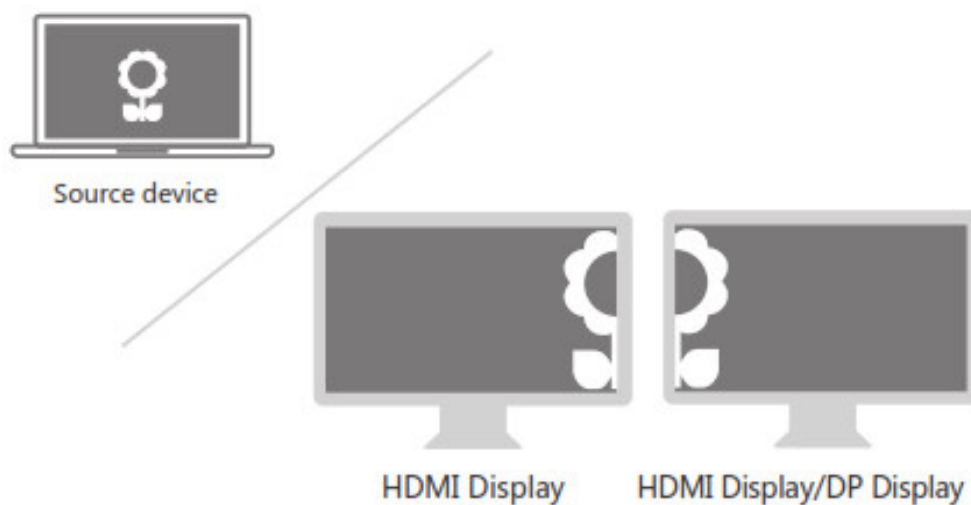

Dual Display Setting for Mac OS

Mirror Display

Apple logo>System Preferences >Displays

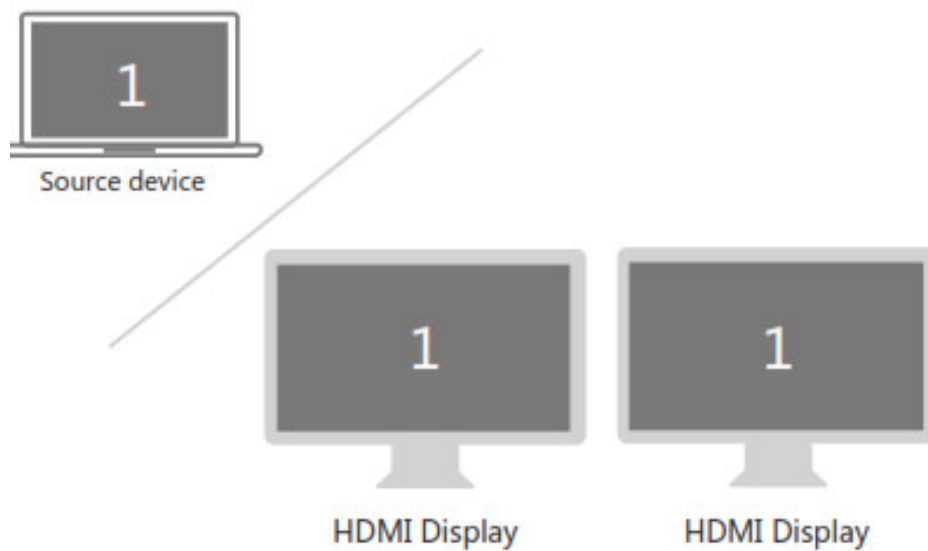
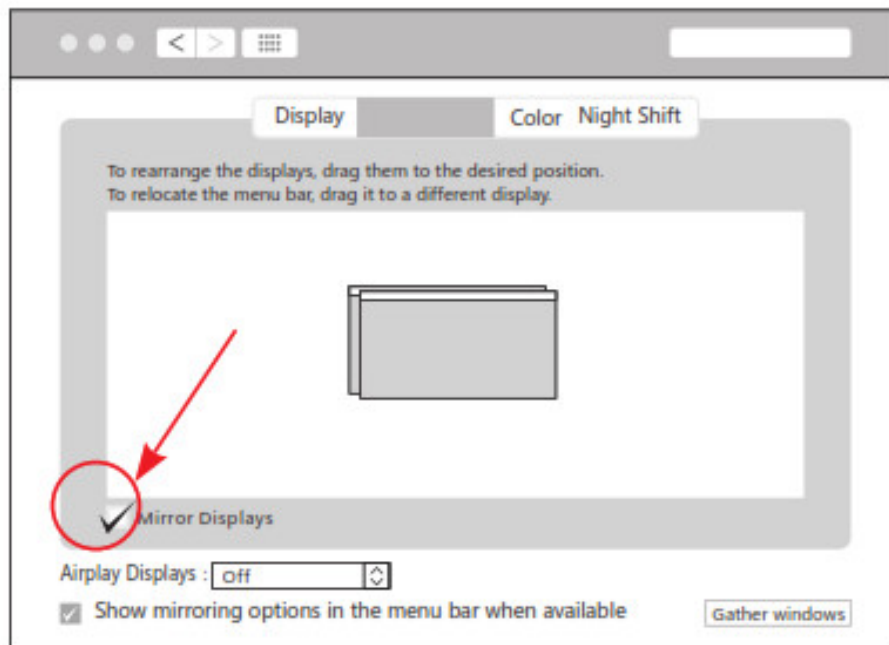

Extend Display

Apple logo>System Preferences >Displays

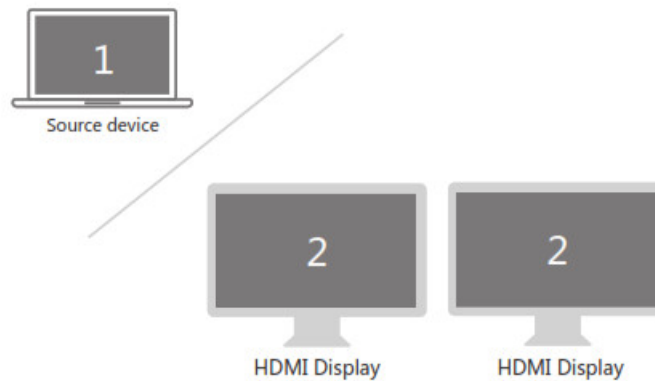
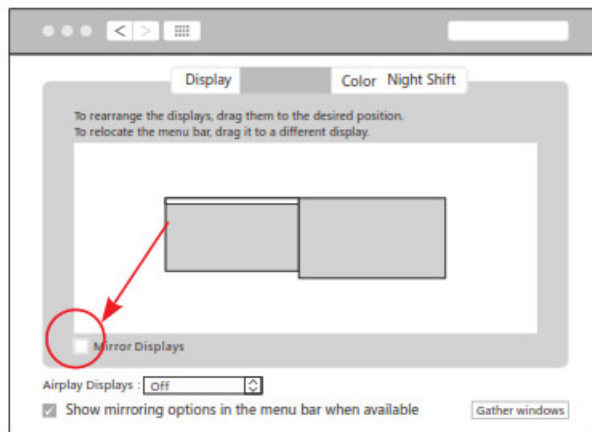

Tip For Resolution: The system will automatically select the resolution that is most suitable for the device currently in use. In order to reduce CPU consumption, it may not be the highest resolution supported by the device. If necessary, you can set it according to the following steps. (The specific resolution is determined by the device and connection method. If you have any questions, please contact us for confirmation.)

Resolution Setting

For Wins

Right-Click Desktop> Display Settings

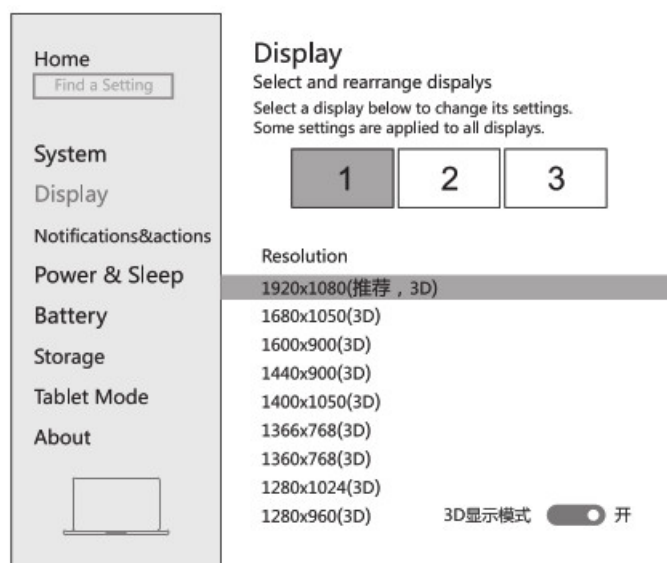

For Mac OS

Apple logo > System Preferences>Display>Scaled>Option+Scaled

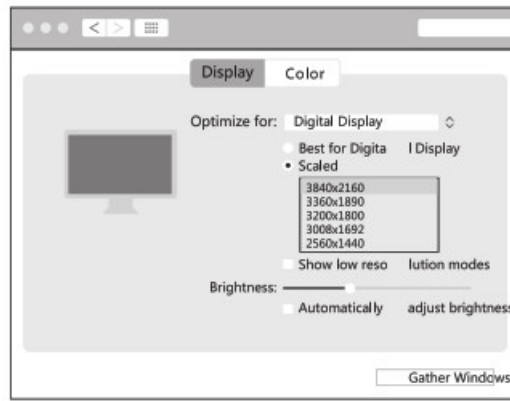

Note:

- 1.Supports DP and HDMI simultaneous output.
However, the maximum resolution may be 4K@30Hz when using them simultaneously.
- 2.This product DOES NOT support replication or extended displays when connecting the gaming device.
- 3.When a device with large power consumption such as a hard disk, it cannot be connected normally, please connect the charger to the USB-C female port of the product to power the computer, hard disk, etc.

Storage Conditions

Ambient Operating Temperature: 0 °C to 70 °C(32°F to 158°F)

Storage Temperature: -30 °C to 120 °C(-22°F to 248°F)

Ambient Operating Humidity: 20%-80%RH

Storage Humidity: 20%-90%RH

Troubleshooting

- ① Please contact E-mail:

 support@lasune.net

Or through the below steps on the

- ② product page to send the message:

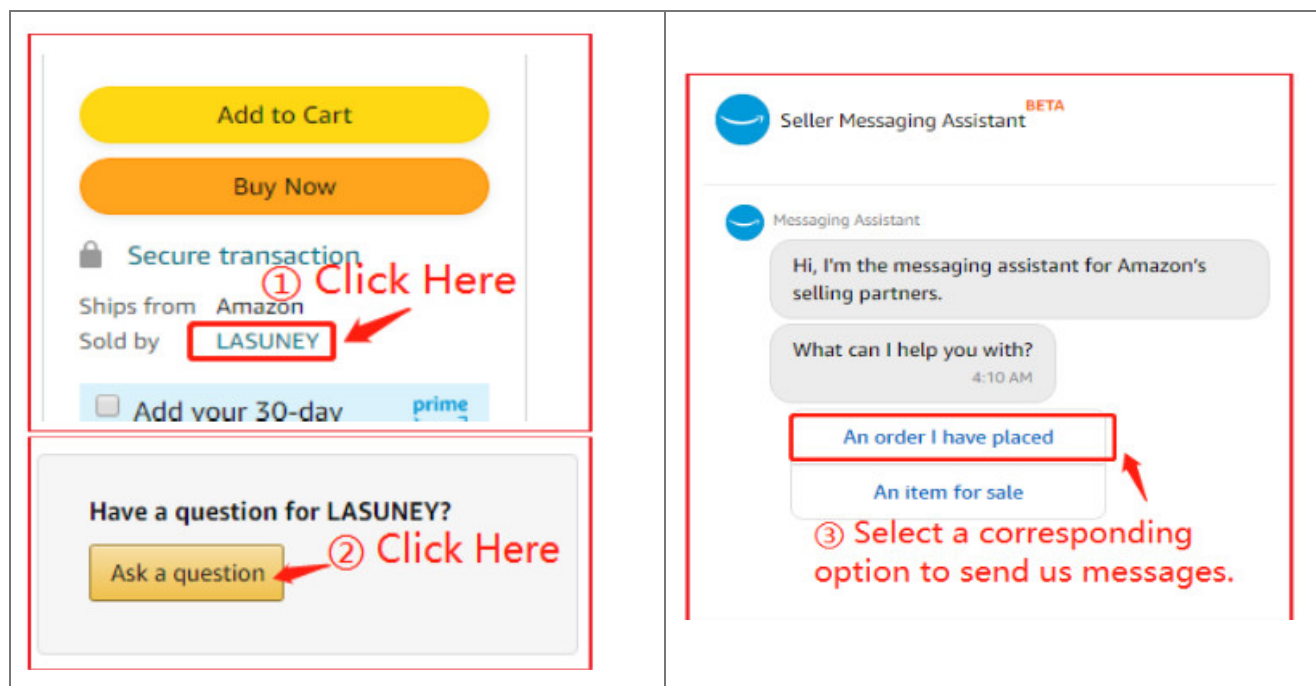

Documents / Resources



[LASUNEY ALL-IN-ONE USB C HUB WITH TRIPLE DISPLAY](#) [pdf] User Manual
ALL-IN-ONE USB C HUB WITH TRIPLE DISPLAY, ALL-IN-ONE USB C HUB, TRIPLE DISPLA
Y