



## Laserliner 1519007 Battery tester BatteryCheck Reading range Instruction Manual

[Home](#) » [Laserliner](#) » Laserliner 1519007 Battery tester BatteryCheck Reading range Instruction Manual 

Laserliner 1519007 Battery tester BatteryCheck Reading range



Read the operating instructions and the enclosed brochure „Guarantee and additional notices“ completely. Follow the instructions they contain. Safely keep these documents for future reference.

## **Contents**

- 1 Function / Application**
- 2 Safety information**
- 3 Additional information on use**
- 4 To check battery charge**
- 5 Technical data**
- 6 Guarantee, product care and disposal**
- 7 SERVICE**
- 8 Documents / Resources**
  - 8.1 References**
- 9 Related Posts**

## **Function / Application**

This battery tester is used to check all commonly used batteries (AA / AAA / C / D / 9V / 1.5V button cells). The battery charge level is shown on a clear 3-colour scale. Operates without a power supply

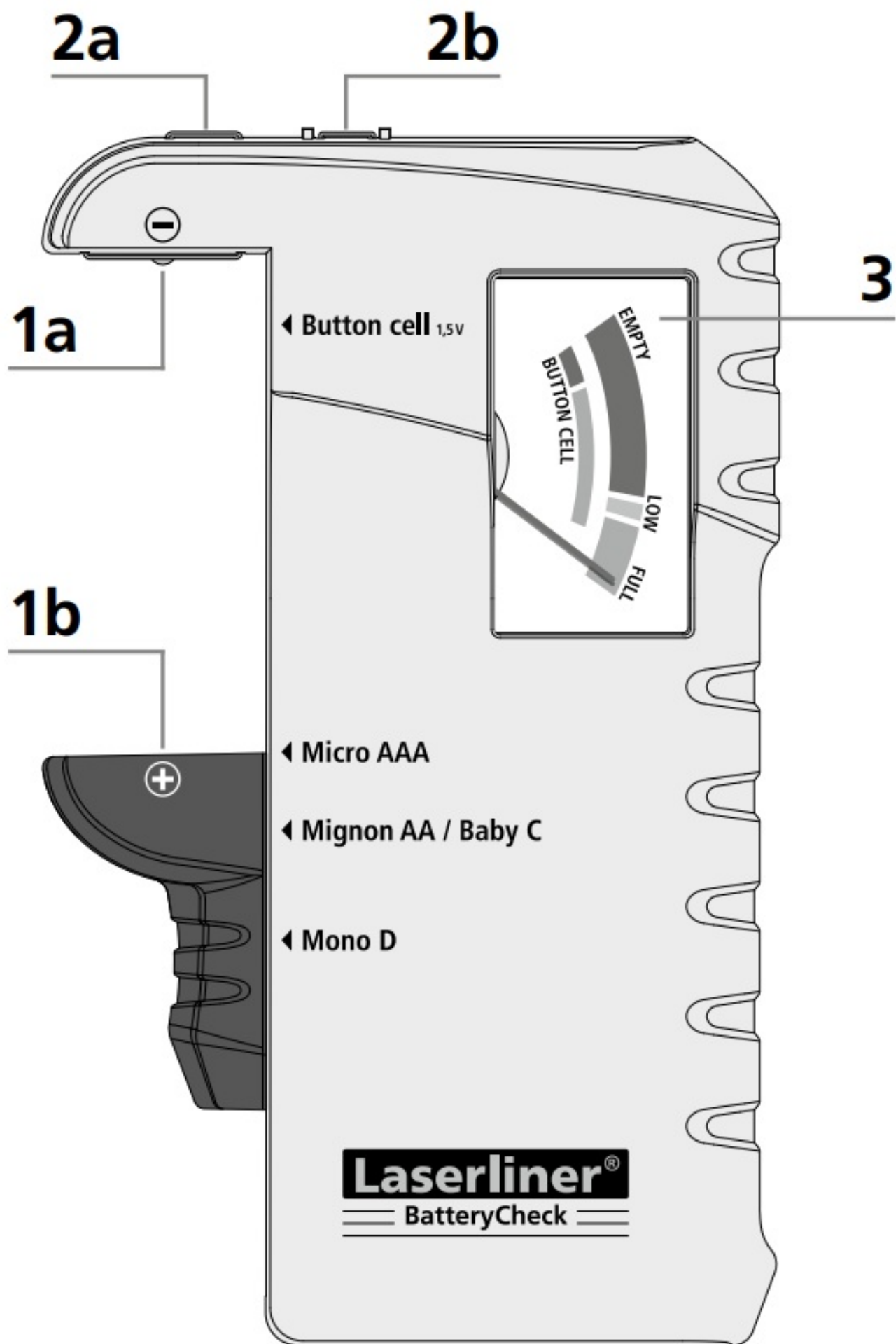

1. Battery holder:

Button cell (1.5V) / Micro AAA / Mignon AA / Baby C / Mono D

**1a** Negative pole, battery holder

**1b** Positive pole, battery holder

2. Battery holder: 9V block

**2a** Negative pole, battery holder

**2b** Positive pole, battery holder

3. 3-colour display scale green: good orange: weak red: replace

## Safety information

- Do not expose the device to mechanical stress, extreme temperatures, moisture or significant vibration.
- The tester operates in the voltage range from 1.5V to 9V.
- Make sure the inserted, correspondingly rated batteries only make contact at the marked contact surfaces.
- Insert the batteries the right way round to ensure correct polarity; polarity reversal can adversely affect operation of the device.
- The device must only be used in accordance with its intended purpose and within the scope of the specifications. Modifications or changes to the device are not permitted, this will otherwise invalidate the approval and safety specifications.

## Additional information on use

The scale divides the usability of batteries in mobile devices into „good“, „weak“ and „replace“.

The divisions are based on general average values for constant use and can vary in devices with abnormal current consumption.

Especially in devices with high, temporary current peaks and/or for inferior quality batteries, it may be necessary to change the battery earlier than indicated on the display.

Devices with efficient power management can generally still operate effectively even when the batteries are almost completely discharged.

In such cases try to correspondingly interpret the deflection of the pointer in relation to the operating time of your specific device/ batteries to ensure optimum utilisation of the batteries.

## To check battery charge

Open battery holder and insert batteries corresponding to the polarity symbols or place 9V block batteries on the contacts 2a and 2b.

Be sure to pay attention to polarity.

## 3-colour display scale

**Good (green):** battery fully charged

**Weak (orange):** battery is weak and will soon need replacing

**Replace (red):** battery is flat and should be replaced

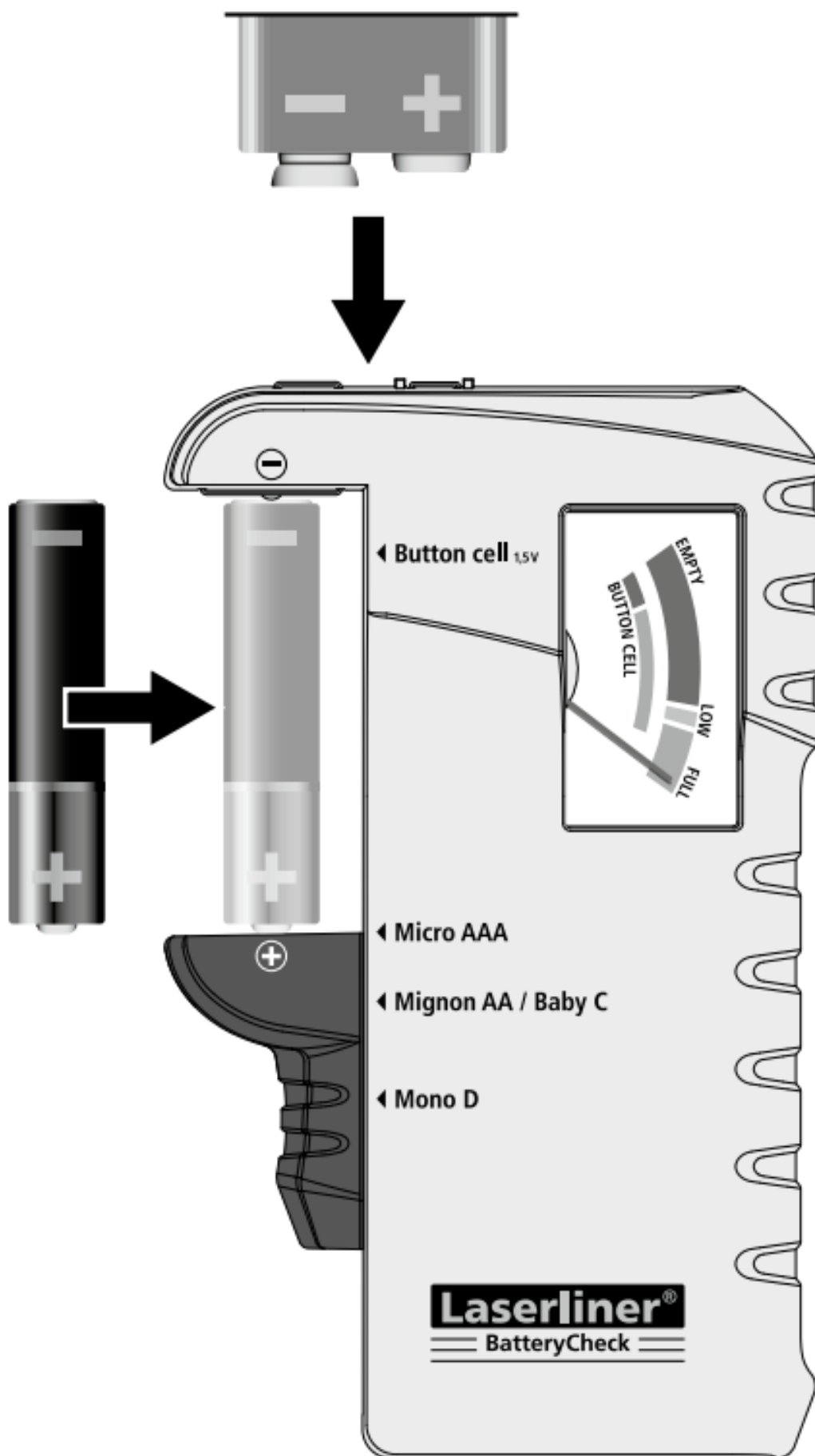

Technical data

Measuring ranges	1,5V / 9,0V
Battery types	1,5V AAA, SH16, MN2400, LR03, R03 AA, HP7, MN1500, UM3, LR6, R6 C, HP11, MN1400, SP11, LR14, R14, UM2 D, HP2, MN1399, SP2, R20, UM1, LR20 LR41, LR43, LR44
	9,0V 6LR61, 6F22, 6LF22 PP3, MN1604, 6F22, 006P
Dimensions (W x H x D)	67 x 110 x 32,5 mm
Weight	51 g

Subject to technical changes without notice. 08.14



## Guarantee, product care and disposal



for the free movement of goods within the EU.

This product is an electric device and must be collected separately for disposal according to the European Directive on waste electrical and electronic equipment.

Further safety and supplementary notices at: [www.laserliner.com/info](http://www.laserliner.com/info)

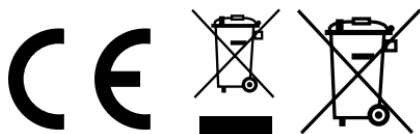

SERVICE

**Umarex GmbH & Co KG**

– Laserliner –

Möhnestraße 149, 59755 Arnsberg, Germany  
Tel.: +49 2932 638-300, Fax: +49 2932 638-333  
[laserliner@umarex.de](mailto:laserliner@umarex.de)

Umarex GmbH & Co KG  
Donnerfeld 2  
59757 Arnsberg, Germany  
Tel.: +49 2932 638-300, Fax: -333  
[www.laserliner.com](http://www.laserliner.com)

**Laserliner®**  
Innovation in Tools

## Documents / Resources

	<p><a href="#">Laserliner 1519007 Battery tester BatteryCheck Reading range</a> [pdf] Instruction Manual 1519007, Battery Tester BatteryCheck Reading Range, 1519007 Battery Tester BatteryCheck Reading Range, Tester BatteryCheck Reading Range, BatteryCheck Reading Range, Reading Range, Range</p>
---	---

## References

-  [Home](#)
-  [Info - Laserliner](#)