



FD13-135 Laser Navigator Dash Camera User Manual

[Home](#) » [Laser](#) » FD13-135 Laser Navigator Dash Camera User Manual 

Contents

- 1 FD13-135 Laser Navigator Dash Camera
- 2 WHAT'S IN THE BOX
- 3 SPECIFICATIONS
- 4 PRODUCT DIAGRAM
- 5 INSTALLATION
- 6 BASIC OPERATION
- 7 CAMERA SETTINGS
- 8 VIDEO SETTINGS
- 9 ICON DESCRIPTION
- 10 TROUBLESHOOTING
- 11 Documents / Resources



FD13-135 Laser Navigator Dash Camera



WHAT'S IN THE BOX

- FHD Dash Cam
- 3.Sm 12V Car Charger
- Camera Suction Mount
- User Manual

SPECIFICATIONS

Chipset	GP2247F
Sensor	SC233 6
Front Camera Resolution	1920 X 1080p
Field of View	120°
Video Codec	MJPG
Audio	Built-in Microphone
Screen	2.4- inch
Storage	Mic ro SD Card (U3 Hig h Speed up to 32gb)
Battery	Built- in 150mAh Lithium- Ion
Power Input	5V/ 1A DC
Power Output	12- 24V DC
Working Temperature	-10° – 60°C
Dimensions	88 x 55 x 35mm

PRODUCT DIAGRAM

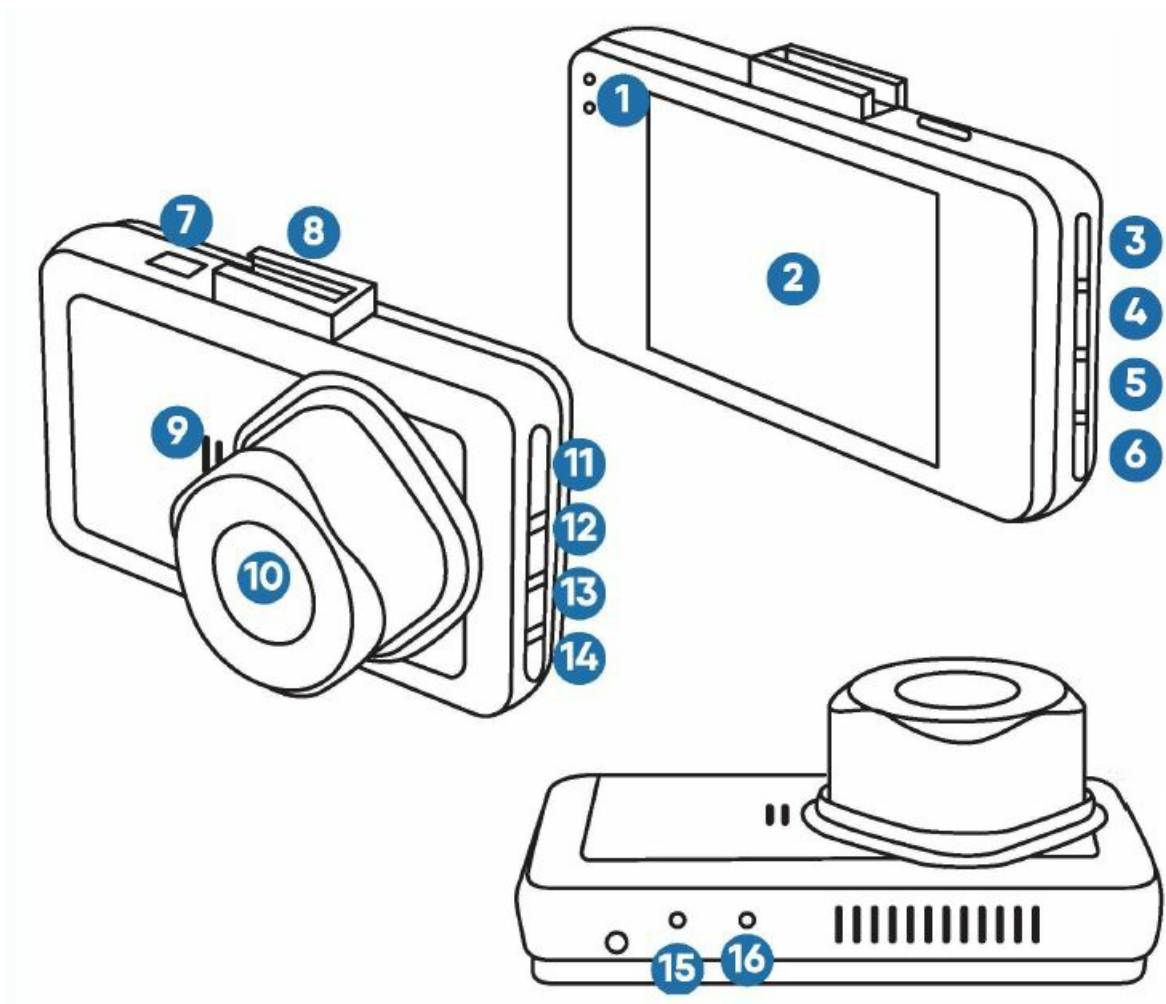

1. LED Indicator Light

2. LCD Screen

3.  OK/Record Button

4. **M** Mode Button

5.  Lock Video Button

6.  Power Button

7. Mini USB Power Port

8. Mounting Socket

9. Speaker

10. Camera Lens

11. MicroSD Card Slot

12.  Up Navigation Button

13.  Menu Button

14.  Down Navigation Button

15. Power Reset Hole

16. Micophone

INSTALLATION

1. Make sure the dash cam is turned off then insert the Micro SD card. The gold-plated contacts on the Micro SD card should face the screen side on the cam. Use your fingernail or a flat object to push in the card until it clicks and locks in place.

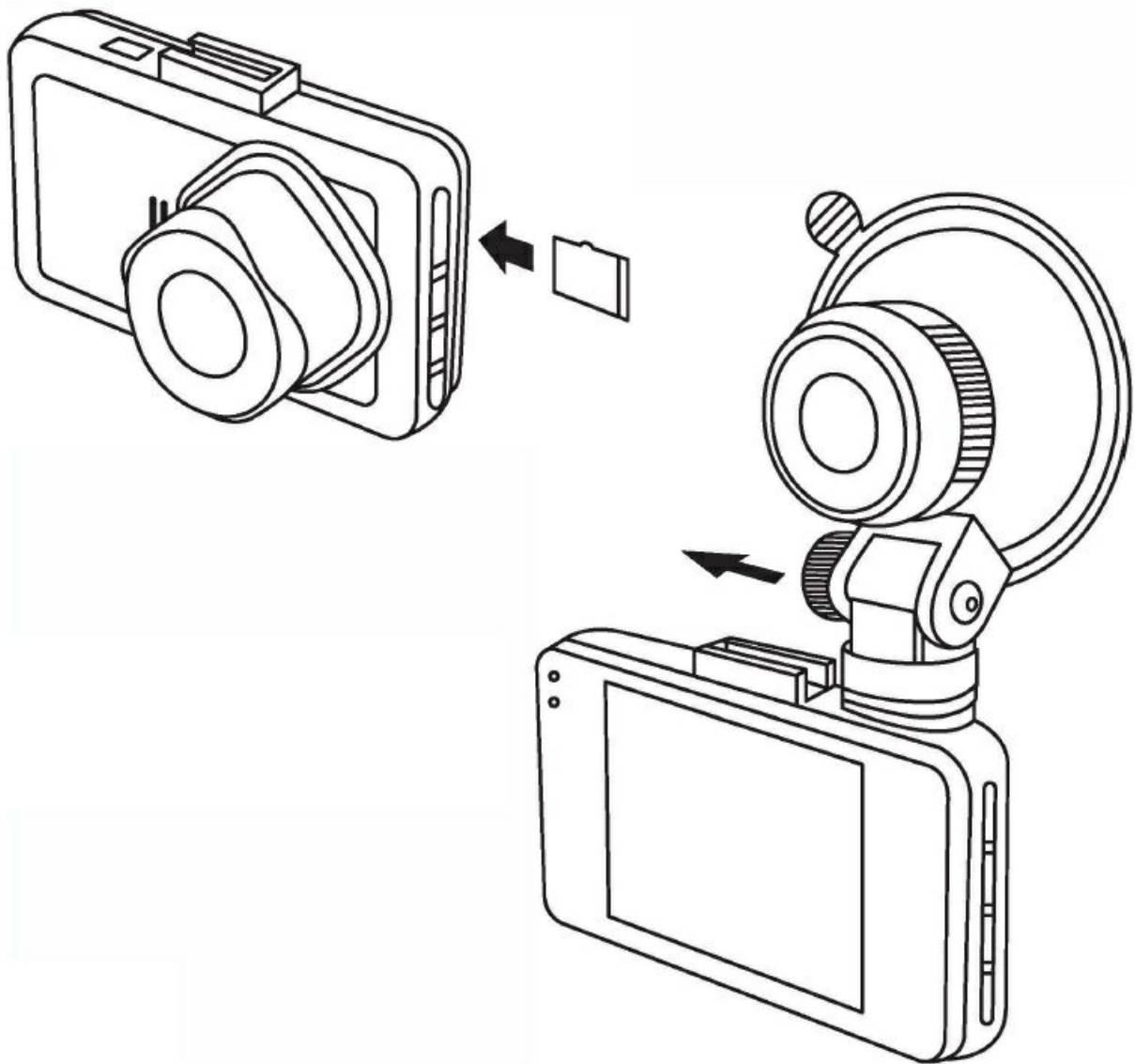

2. Attach the mount to the dash cam.
3. Clean a spot on your windshield to mount the dash cam. We recommend installing the camera on the passenger side of the rear-view mirror.

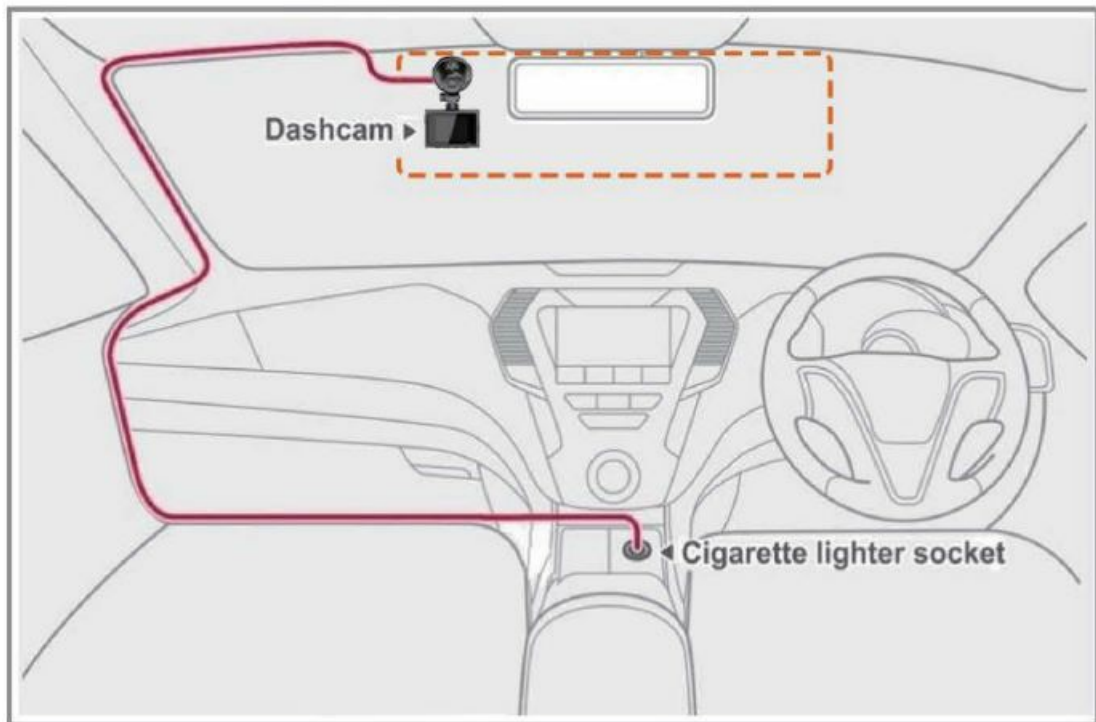

4. Plug one end of the supplied car charger into your vehicle's accessory port and the other end into the Mini-USB port on the dash cam. Route the cable alongside the interior trim of your vehicle for a cleaner install.

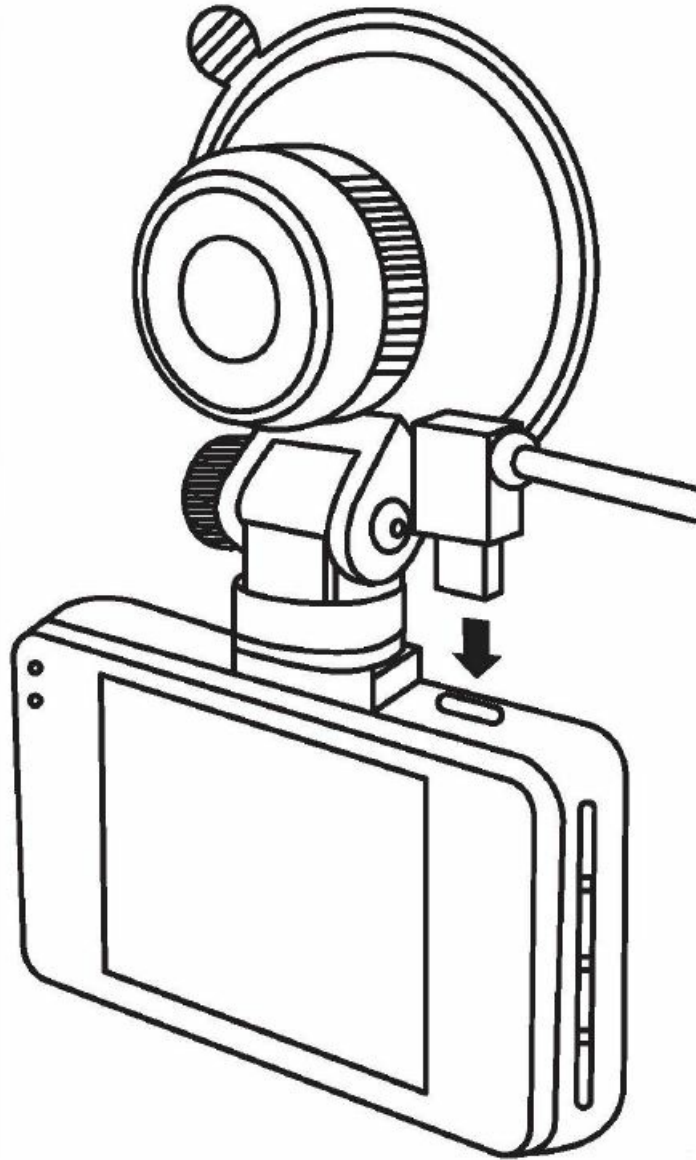

5. Press the mount firmly against the windshield and tighten the knob on the mount to create a firm seal.
6. Turn on the dash cam and format the memory card by tapping the MENU button twice, navigate down to the FORMAT option and tap the OK button. You will receive a prompt to confirm, select OK and press the OK button to finish formatting.

Note: This action will delete all files and data currently on the card.

BASIC OPERATION

Powering On

- The dash cam will power on automatically when connected to power or when the car is turned on.
- Alternatively press and hold the POWER button to turn on.

Powering Off

- When power is disconnected or the battery runs out, the dash cam will save the last video file and power off.
- Alternatively press and hold the POWER button to turn off.

Video Recording

- With a Micro SD card installed the dash cam will automatically start recording every time it is powered on.
- Tap the OK button during the main camera view to stop or start video recording.
- **Note:** If recording has been stopped manually it will not automatically resume unless manually controlled or device is powered off and turned back on.

Navigating Menus

- Press the OK button to stop video recording then press the MENU button to enter the menu setting.
- When in a menu, press UP or DOWN buttons to navigate the menu then press the OK button to confirm or change the selected option.
- To exit the menu press the MENU button until the screen goes back to the main camera view.

Modes

- Pressing the MODE button will cycle between 3 modes: VIDEO, PHOTO and GALLERY.
- Video mode is the default mode and the main video recording function of the dash cam. Press the OK button to start or stop video recording.
- PHOTO mode can be used to take photos. Press the OK button to take a photo.
- GALLERY lets you view any photos or recorded videos.
- Tap the UP and DOWN buttons to cycle between the files and press the OK button on videos for playback.
- Pressing the MENU button while in gallery mode will bring up a menu which lets you DELETE or PROTECT the currently selected file.

Locking Videos

- If an incident occurs or there is a video you want to save, tap the LOCK VIDEO button to save the video and prevent it from being overwritten by the loop recording function.

INDICATOR LIGHT

- **No Light** – There are no indicator lights when dash cam is turned off and not plugged into cable power.
- **Solid Red** – One indicator light is solid red when dash cam is in standby mode but powered by cable power.
- **Solid Blue** – One indicator light is solid blue when dash cam is turned on and power by battery power.
- **Solid Red and Blue** – Both indicator lights are solid red and blue when dash cam is turned on and powered by cable power.
- **Flashing Blue** – One of the indicator lights is flashing blue when dash cam is recording.

RECORD SETTINGS

- The menu setting interface is divided into 2 options while in any mode.
- The first menu will be based on your currently selected mode (VIDEO, CAMERA, or GALLERY).

- The second menu will always be SYSTEM SETTINGS.
- From the main camera view screen tap the MENU button once to enter the VIDEO / CAMERA / GALLERY settings, tap it twice to enter the System Settings, or tap 3 times to exit the menu.

CAMERA SETTINGS

Resolution

- Set the photo resolution. High resolution results in a clearer image but will use more memory.

Burst Photo

- When taking a photo with this setting enabled the camera will take 5 photos in sequence.
- Options are ON or OFF.

Exposure

- Allows you to adjust the dashcam brightness level according to the background.
- Increasing the exposure value can result in a brighter photo at night/dark locations.

Quick Review

- When taking a photo with this setting enabled the camera will pause the photo onscreen for a few seconds.
- Options are OFF, 2 SECONDS, or 5 SECONDS.

Date Stamp

- This option lets you turn on/off the time and date stamp on photos.
- Options are OFF, DATE, DATE/ TIME.

VIDEO SETTINGS

Resolution

- Set the video recording resolution. High resolution results in a clearer image but will use more memory. At 1080P resolution a 16GB Micro SD Card can hold approx. hours of footage.

Loop Recording

- This setting lets you control the duration of each individual clip.
- Loop recording will delete the oldest files and record over newer files when the memory card is full.
- Clips can be set to durations of 1, 3, and 5 minutes.

Exposure

- Allows you to adjust the dashcam brightness level according to the background.
- Increasing the exposure value can result in brighter footage in dark locations or when driving at night.

Motion Detection

- Turning motion detection on will enable the camera to make a short recording when motion is detected in the camera field of view.

Record Audio

- The dash cam has a built-in microphone so audio can be recorded along with the video.
- The microphone can be toggled ON/OFF.

Date Stamp

- This option lets you turn ON/OFF the time and date stamp on recorded video clips.

G-Sensor

- The G-Sensor is a 3-axis impact gravitational accelerometer designed to detect physical and gravitational forces on the dash cam.
- When the G-Sensor is triggered it will create a locked video recording to avoid being overwritten.
- Sensitivity options are OFF/HIGH/MEDIUM/LOW.

SYSTEM SETTINGS

Parking Monitor

- Uses the Motion Sensor setting combined with the G-sensor setting to make a video recording after detecting movement or physical/gravitational forces on the dash cam.
- The Parking Monitor will engage when the above conditions are met after the vehicle/dash cam has been switched off.
- Options are OFF or ON.

Date/Time

- set dash cam date and time.

Screen Save

- Turns the screen off after a set time of no activity to prevent driver distraction.
 - The camera will continue recording.
 - The screen can be awoken by pressing any button. Options are 1 MINUTE, 3 MINUTES, 5 MINUTES, or OFF.
- Beep Sound
- Turn the button press prompt sound ON/OFF in the setting.

BeepSound

- Turn the button press prompt sound ON/OFF In the setting.

Language

- Sets the onscreen display language to English.

Frequency

- Here you can choose the frequency accordingly to the power supply specification used in your country.
- Options are 50Hz or 60Hz.

Format

- Formats the Micro SD card ready for use with the camera.
- **Note:** This action will delete all files and data currently on the card (including locked recordings).

Default Setting

- Resets the dash cam back to all factory settings.
- Use this if you've changed something and not sure how to change it back, or if your dash cam starts to behave irregularly.

Version

- Check the dash cam system software version.

ICON DESCRIPTION

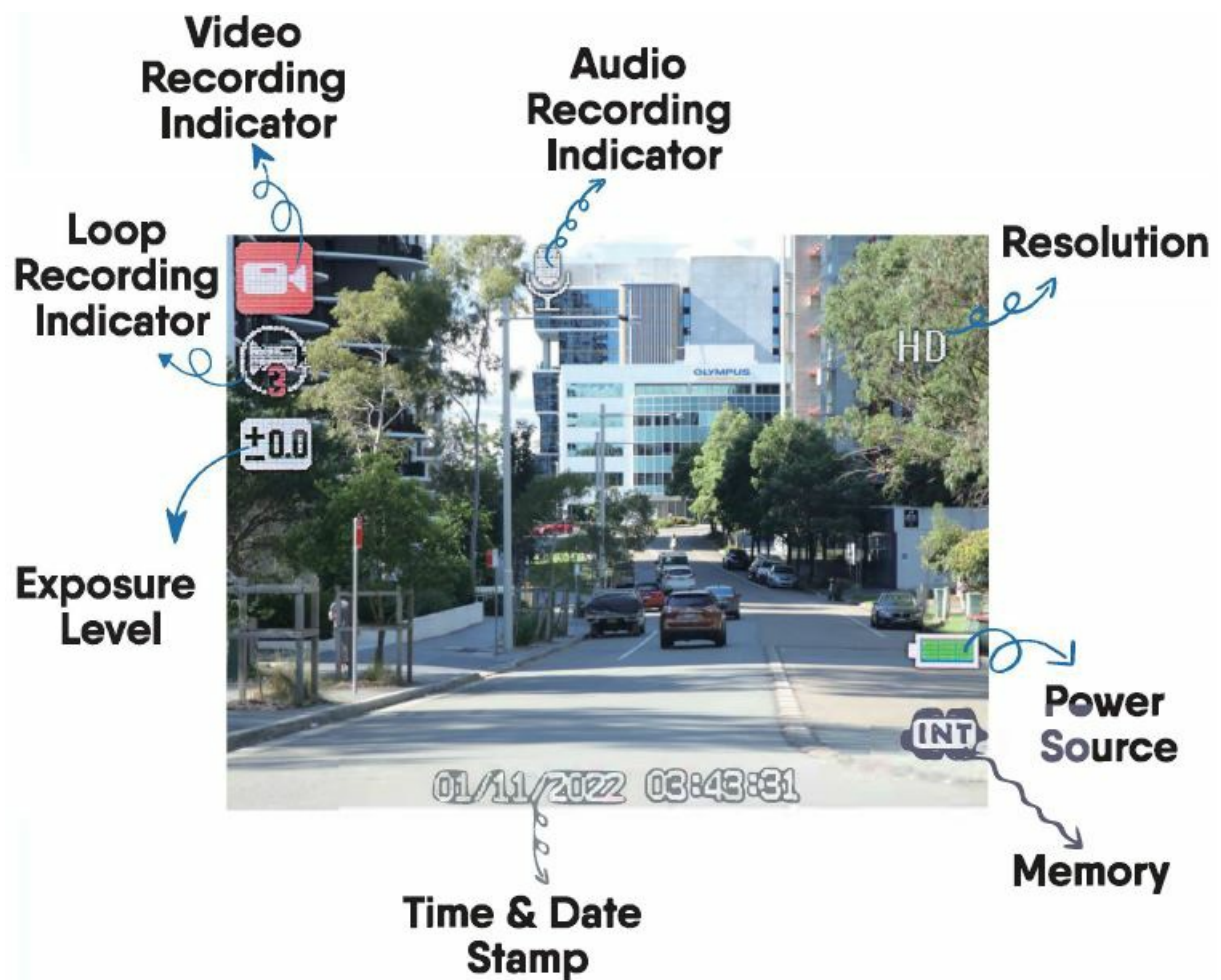

TROUBLESHOOTING

Video is unclear.

- Make sure the lens of the camera is clean and there is no dirt on the windshield.
- Check the plastic screen protector has been removed from the dash cam lens.

Recorded video is stuttering, or dash cam is showing a memory error.

- Make sure you are using a Micro SD card with U3 high-speed and a max size of 32gb.
- Format the Micro SD card by going to Menu > System Settings > Format > Yes.
- Try another Micro SD card.

The memory card is full.

- The loop recording function will not overwrite locked files. Please manually delete files in the GALLERY mode.
- Format the memory card. This action will delete all files and data currently on the card (including locked recordings).

Menu or other buttons on dash cam not working.

- Press the OK button to stop video recording then try pressing the MENU or other button again.

Camera is creating many locked videos.

- Manage your G-Sensor settings.
- A lower sensitivity setting will create less locked videos and a higher sensitivity setting will create more locked videos.
- The sensitivity setting depends on the type of vehicle you are driving and how much vibration your vehicle is creating based on suspension and road condition.

Camera gets hot.

- It is normal for the camera to run slightly hot.

Camera turns ON/OFF automatically.

- Turn off the screen saver function.
- Plug the camera into a power source to stop it from turning off automatically.
- With the Parking Monitor, G-Sensor and Motion
- Detection functions enabled the camera will automatically turn on and create a video recording if motion or physical/ gravitational forces are detected by the dash cam while it is turned off.

Micro SD Card not going into dash cam.

- When inserting the Micro SD card, check that the gold contact pins are facing towards the screen of the dash cam.
- Push the Micro SD card all the way with a fingernail or flat object, You will hear a click and the card will lock in place, so that it is flush with the camera body.

Thank you for your purchase!

- Laser Corporation is 100% Australian owned & operated. To get the most out of your product please read the user manual carefully and keep for future use.
- For specific information relating to your product such as Spare Parts, FAQs, Warranty claims, and more, please scan the following QR code:



Visit our website

- www.laserco.com.au.



Check us out at

- www.youtube.com/lasercoau.

YouTube



Documents / Resources

 <p>LASER User Manual</p> <p>Laser Full HD Dash Cam FD13-135</p>	<p>LASER FD13-135 Laser Navigator Dash Camera [pdf] User Manual</p> <p>FD13-135 Laser Navigator Dash Camera, FD13-135, Laser Navigator Dash Camera, Navigator Dash Camera, Dash Camera, Camera</p>
--	--