



LARIO AMCPlus Smart Control Panel User Manual

[Home](#) » [LARIO](#) » LARIO AMCPlus Smart Control Panel User Manual 



USER MANUAL



www.lariohub.com

Contents

- 1 SYSTEM MANAGEMENT VIA APP
- 2 SYSTEM MANAGEMENT FROM K-LARIO KEYPAD
- 3 GENERAL INFORMATION
- 4 Documents / Resources
 - 4.1 References

SYSTEM MANAGEMENT VIA APP

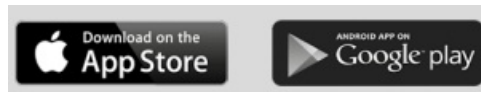

https://app.amc-cloud.com/amc_plus



AMCPlus

1. REGISTERING THE APP

- 1.1 Download the App and proceed with registration by tapping the appropriate "Sign Up" key.
- 1.2 Fill in all the required fields. Set a password and press the "Sign Up" key.
- 1.3 A code will be sent via e-mail.

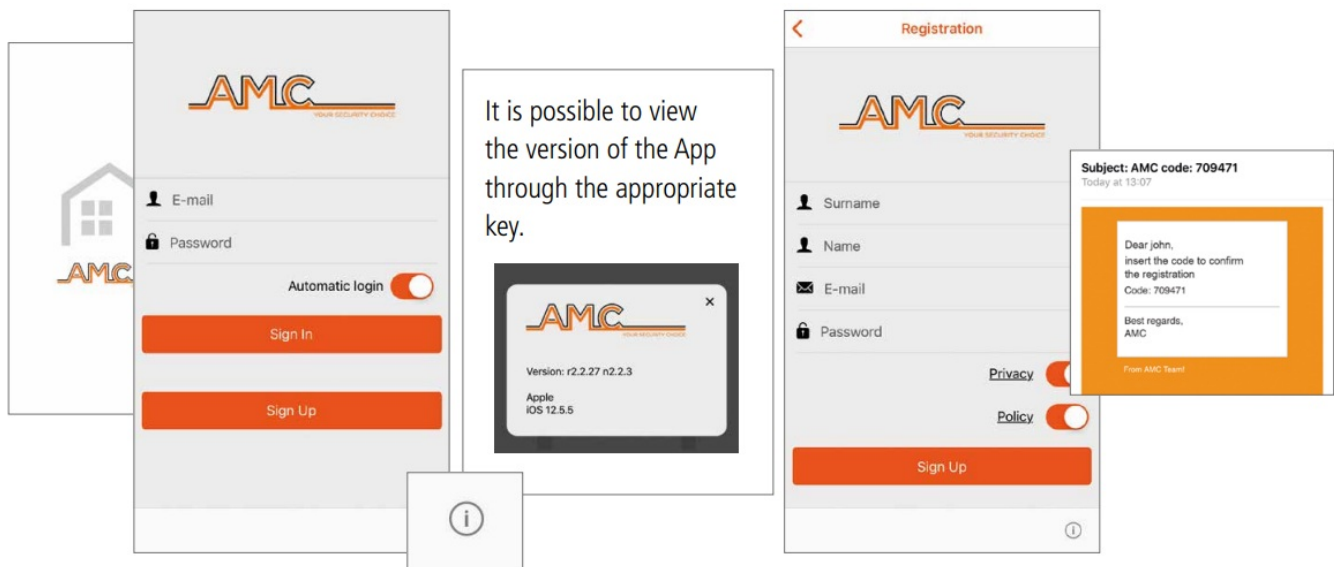

1.4 Enter the code and press the “Sign Up” key.

1.5 An e-mail confirming registration will be sent.

1.6 Now the App is registered and it is possible to log in with the previously set credentials, entering them and tapping the “Sign In” key.

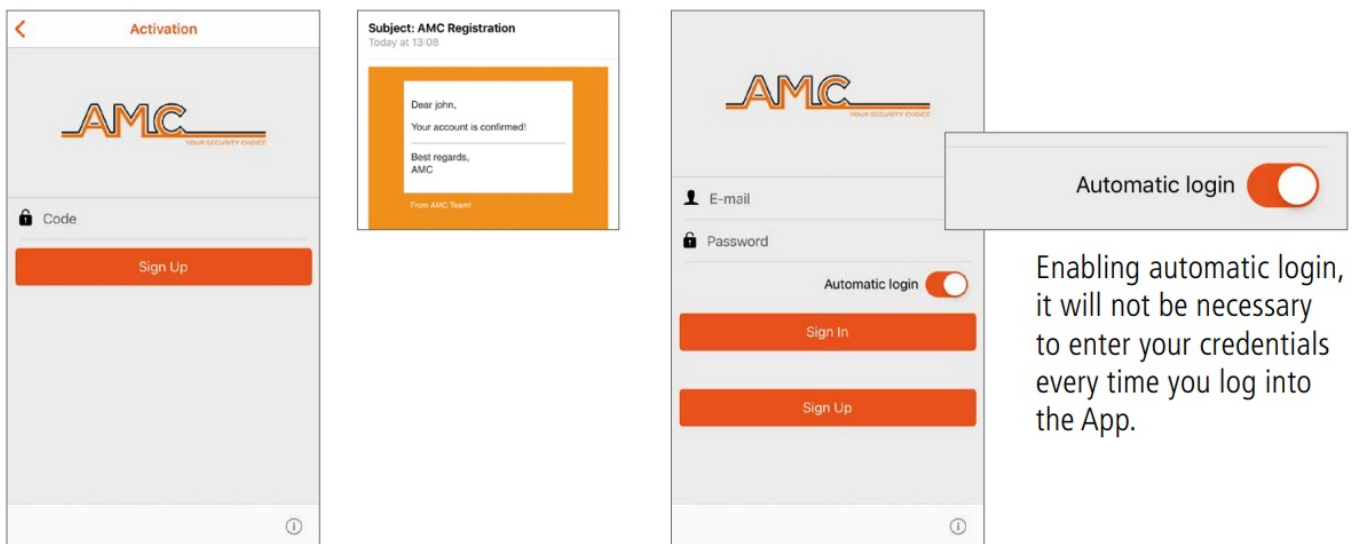

2. PAIRING THE CONTROL PANEL

2.1 Click on the key “+” to add the control panels.

2.2 Fill in all the required fields:

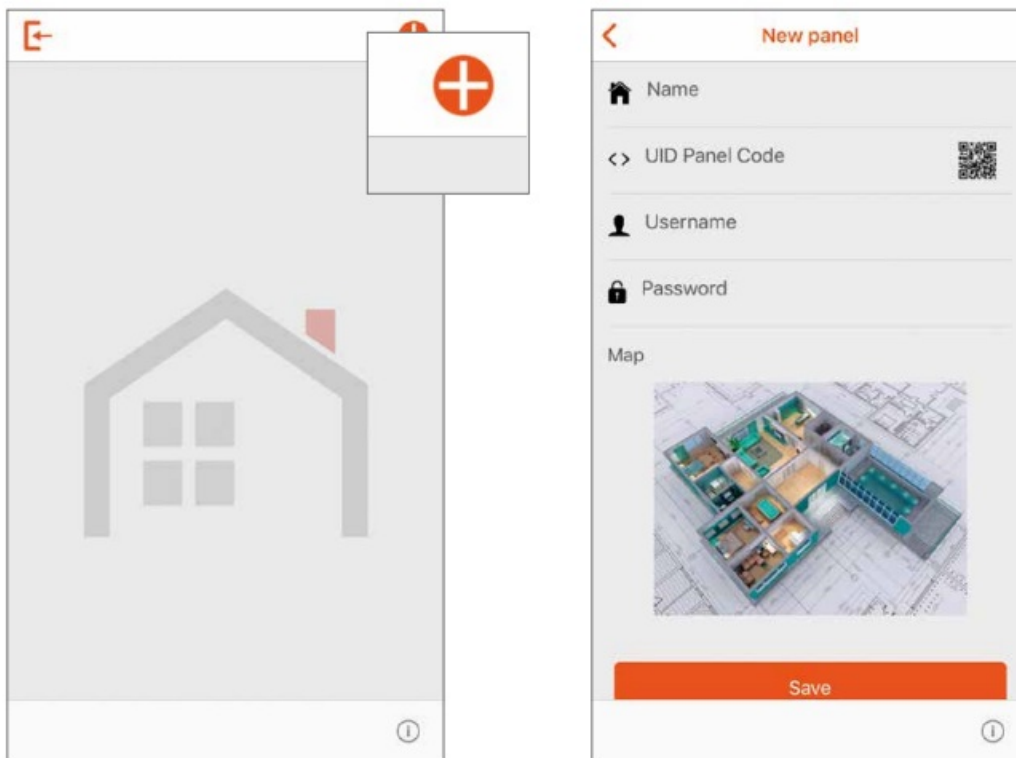

2.3 Once entered, save the data using the appropriate “Save” key.

2.4 The added control panel will be visible at the top of the screen.

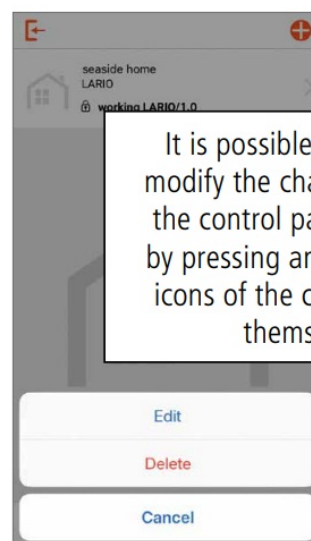
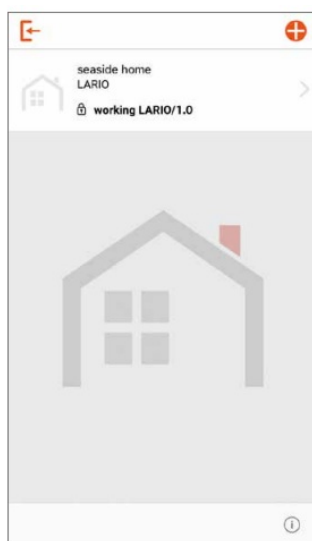
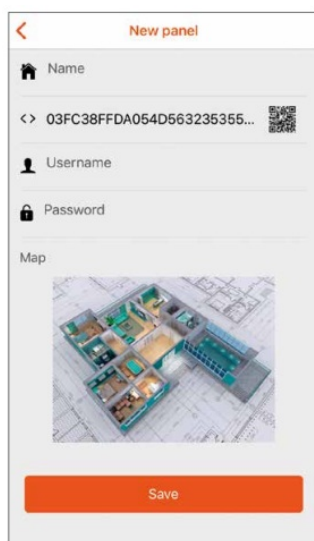

The required fields 2 – 3 – 4 in this section must correspond to those entered during the programming phase by the installer.

They are found on page 6.

1. Give your control panel a name
2. Detect the UID code via the QR code (allow access to the camera)

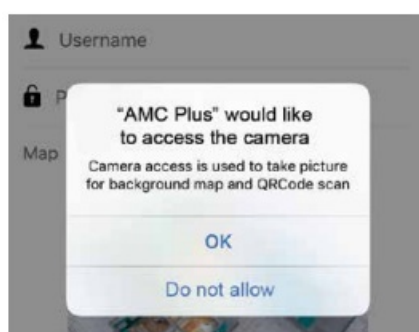

3. Enter the username
4. Enter the password

3. MANAGING THE SYSTEM

3.1 To access the system management, click on the control panel icon and then enter the user code.

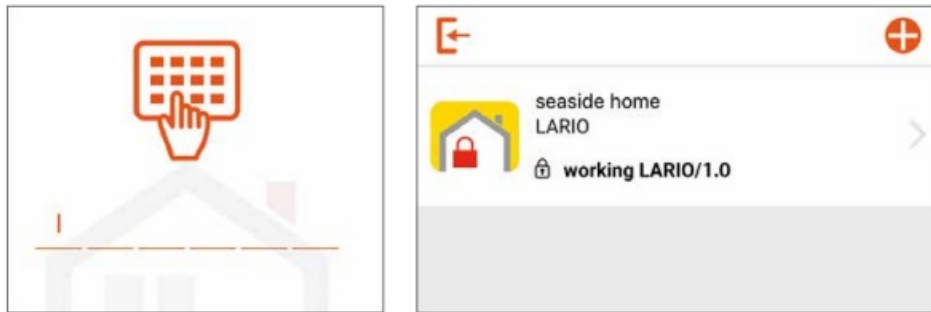

The control panel icon will have different types of colour depending on the status:

Closed red padlock = system armed

Yellow padlock open = system not ready for arming (open zones)

Green padlock open = system ready for arming (zones at rest)

Closed red padlock and red background = system armed and in alarm

Closed red padlock and yellow background = system armed with anomaly

Open yellow padlock and red background = system not ready for arming (an area) and 24h alarm

3.2 Clicking on the arrow accesses the AREAS section where it is possible to arm/disarm the PROGRAMS, to exclude/include the ZONES and activate/deactivate the OUTPUTS.

3.3 Use the appropriate key to arm the individual Program.

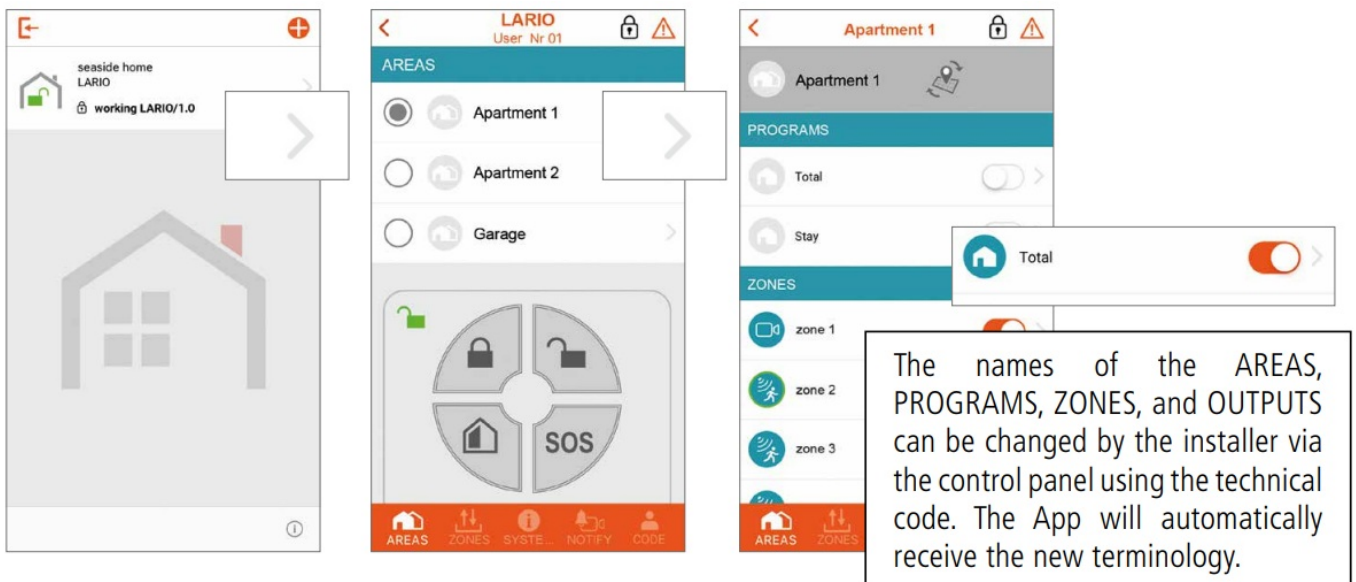

3.4 Clicking on the arrow it is possible to access the Zones and Outputs belonging to the relevant Program. By clicking on the triangular icon it is possible to view the anomalies.

The PROGRAMS and AREAS icons take on different colours depending on the status:

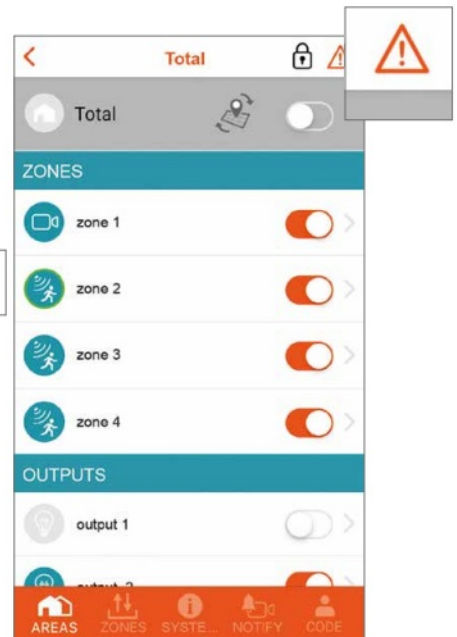
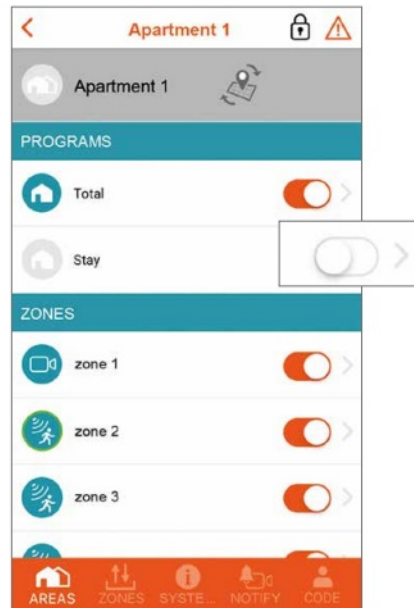

The icons of the ZONES and OUTPUTS take on different colours depending on the status:

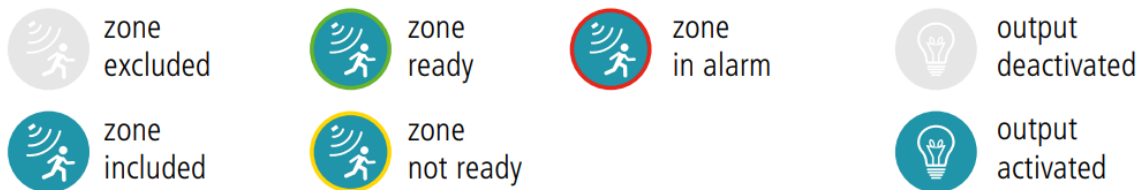

3.5 Clicking on the individual AREAS, PROGRAMS, ZONES, OUTPUTS accesses a screen on which to assign an image (allow access to the camera).

Clicking on the appropriate button it is possible to view the icons of the AREAS, PROGRAMS, ZONES, OUTPUTS on the map and act directly from this screen.

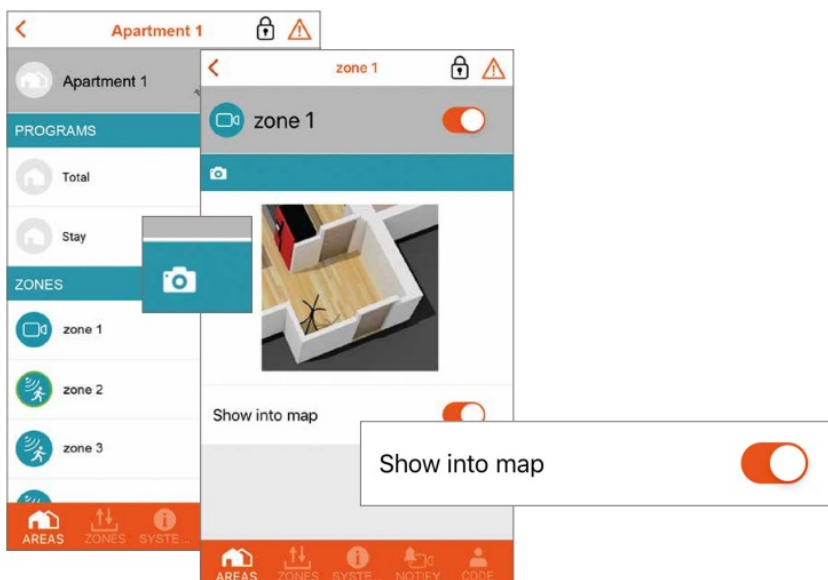

The map can always be viewed by rotating the phone.

3.6 It is also possible to manage the system using a virtual remotecontrol present in the App, consisting of four buttons with the following functions:

CLOSED PADLOCK BUTTON: arming the system

HOUSE BUTTON: partial system activation

OPEN PADLOCK BUTTON: system disarming

SOS BUTTON: send panic signal

In the left corner of the remote control a colored padlock indicates the arming status of the selected area.



4. VIDEO VERIFICATION



video zone

4.1 Clicking on the REC icon it is possible to activate a video recording and subsequently receive it on the App. When the video is available, a PUSH will be sent (average receiving time 1 minute).

4.2 From the NOTIFICATIONS section, by clicking on any video notification, it is possible to access the list of available videos.

4.3 By clicking on the appropriate key it is possible to download the video in the photo gallery of the phone.

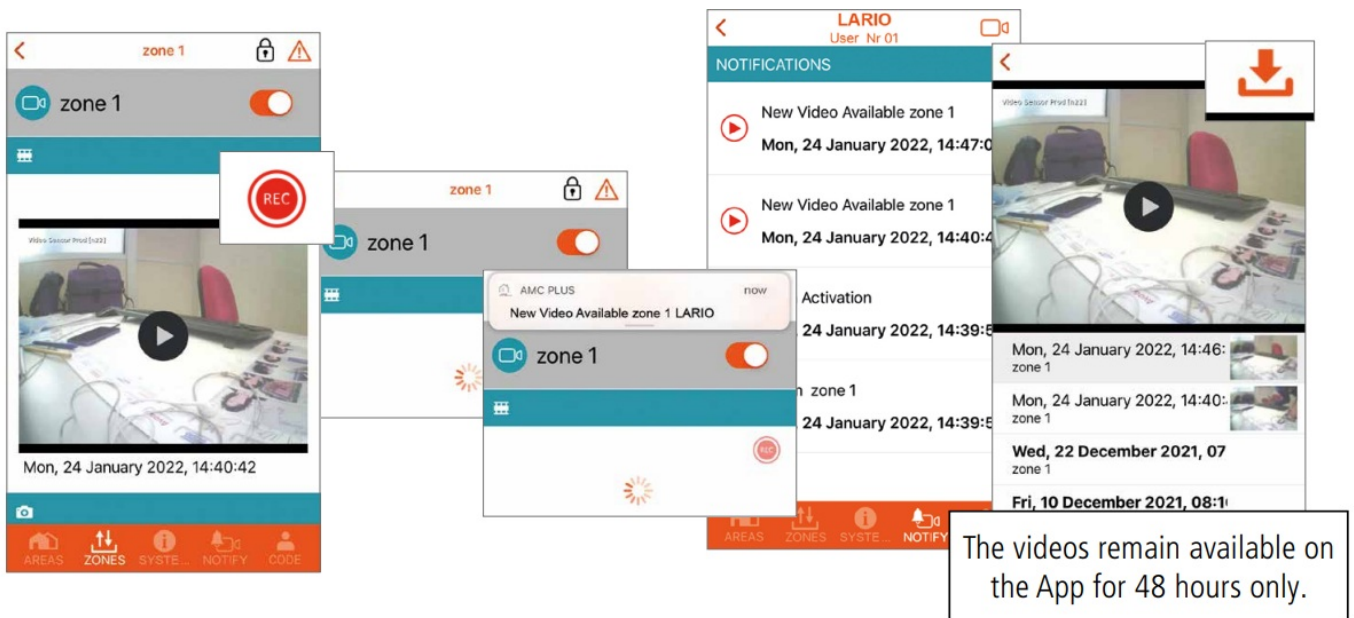

5. OTHER FUNCTIONS

SYSTEM STATUS menu

Through this menu it is possible to check the status of the control panel: battery level, power supply etc. The red icon indicates an anomaly.

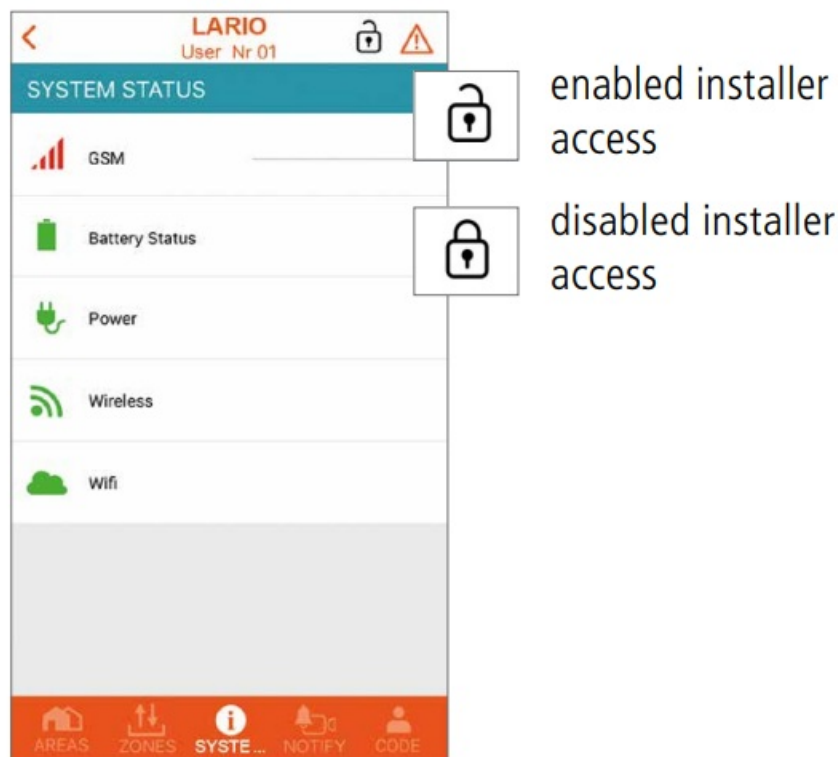

By clicking on the “lock” icon, the installer is given the opportunity to programming the control panel.

NOTIFICATIONS menu

Through this menu it is possible to receive the following default notifications: alarms and anomalies.

The installer, during the programming phase, can enable the sending of other notifications:

- user accesses
- arming/disarming
- name of the user who armed/disarmed the system

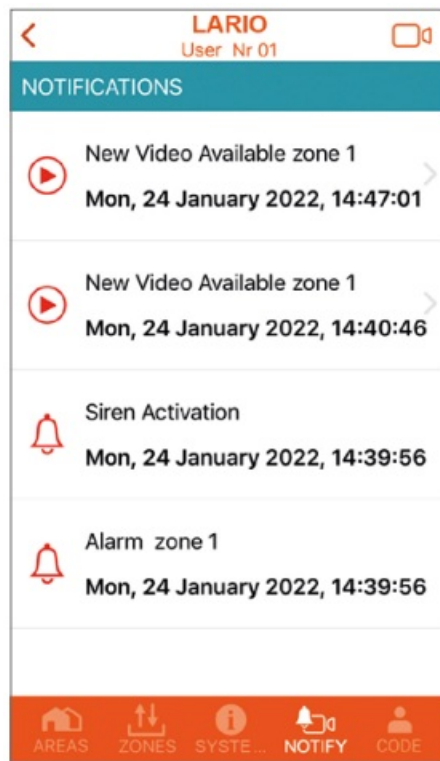

CODE menu

Through this menu it is possible to change your user code (it is also automatically modified for the keypad).

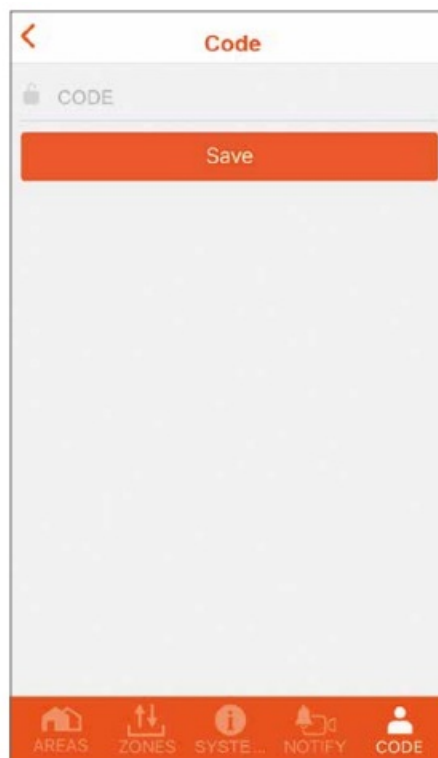

6. INSTALLER SPACE

<div style="border: 1px solid black; width: 100px; height: 100px; margin: 0 auto; display: flex; align-items: center; justify-content: center;"> <div style="border: 1px solid black; width: 80px; height: 80px; margin: 5px;"></div> </div> <p style="margin: 5px 0;">UID QR</p>	<p>Control panel UID</p> <p>Control panel username Control panel password</p>
--	--

SYSTEM MANAGEMENT FROM K-LARIO KEYPAD

K-LARIO is a wireless keypad for manage the LARIO control panel. A maximum of 4 keypads can be installed for each Lario control panel. K-LARIO keypad can operate with an external power supply (from 5 to 12 Vdc) through the special connector or be powered by 3 supplied batteries (alkaline AAA 1.5V).

If you decide to power the keypad at 12 Vdc through the special connector, the batteries will work as a backup. When the keypad is powered by batteries the backlight will always be off; to activate the keypad press any key (only usable keys will light up) and give the command within 6 seconds, otherwise the keypad will turn off. When it is powered at 12 Vdc, through the special connector, the keypad will always be active (system status keys and LEDs always on).

K-LARIO keypad has 4 signaling icons for arm/disarm status and anomalies.

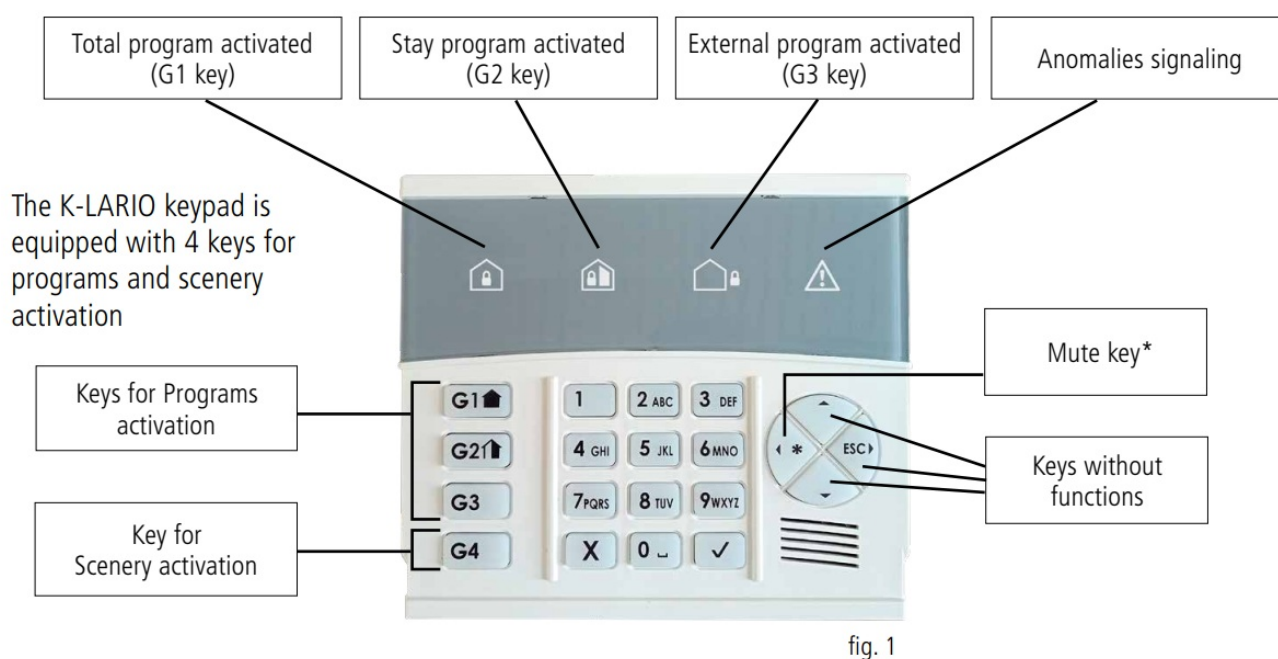

* Keypad mute function:

It is possible silence the keypad by holding down the “*” key for 3 seconds.

An acoustic beep signals that the sounds have been deactivated. To return to the default state hold down again the “*” key for 3 seconds. 3 acoustic beeps will signal that the keypad sounds have been reactivated (with the keypad silenced its autonomy increases).

1. ARMING THE SYSTEM

Arming by user code:

To activate a program press the relative key G1, G2 or G3 (see fig.1) and then enter the user code within 6 seconds. The relative LED will light up on the keypad screen. If the keypad is powered by batteries the LED will turn off after 5 seconds.

If a delayed exit/entry time has been previously assigned by the installer, the relative LED will immediately light up on the keypad accompanied by an acoustic signal (beep) for the duration of the assigned time. If the keypad is powered by batteries, the acoustic signal will consist of only 5 beeps and a final double beep when the time has

elapsed. The LED will turn off after 5 seconds.

Quick arming, without user code

(if set by the installer during programming):

To activate a program press the relative key G1, G2 or G3 directly (see fig.1). The relative LED will light up on the keypad screen. If the keypad is powered by batteries the LED will turn off after 5 seconds.

If a delayed exit/entry time has been previously assigned by the installer, the relative LED will immediately light up on the keypad accompanied by an acoustic signal (beep) for the duration of the assigned time. If the keypad is powered by batteries, the acoustic signal will consist of only 5 beeps and a final double beep when the time has elapsed. The LED will turn off after 5 seconds.

2. SCENERY ACTIVATION (IF SET BY THE INSTALLER DURING PROGRAMMING)

Activation by user code:

To activate a scenery press the relative key G4 (see fig.1) and then enter the user code within 6 seconds.

To confirm that activation has taken place the three LEDs (G1, G2, G3) on the keypad screen, will flash 3 times.

Quick activation, without user code

(if set by the installer during programming):

To activate a scenery press the relative key G4 directly (see fig.1). To confirm that activation has taken place the three LEDs (G1, G2, G3) on the keypad screen, will flash 3 times.

3. DISARMING THE SYSTEM

To switch off the system enter the user code (4 or 6 numbers). In the event of an incorrect code, the operation can be deleted by pressing the “**X**” key. If an incorrect code is entered, the keypad signals an anomaly through the appropriate icon (see fig.1).

In case of alarm the relative LED will flashes until the system will be disarmed.

GENERAL INFORMATION

1. IMPORTANT NOTES

- The information contained in this manual is for informational purposes only and is the property of AMC Elettronica.
- All the information contained in this manual is subject to change without notice.
- Each part of this manual must be interpreted and used only for the purposes for which it has been drawn up. Any use other than that prescribed must be authorised by AMC Elettronica, otherwise the warranty lapses.
- All trademarks, symbols and examples contained in this manual belong to their respective owners.

2. PACK CONTENTS

The cardboard box contains:

- ABS cabinet
- LARIO control panel electronic board
- LITHIUM buffer backup battery model 18650
- anti-opening and removal tamper kit (mandatory for EN standards)
- screws to assemble the parts and to close the cabinet
- adhesive label with product data

The cardboard box does not contain:

- fisher for wall fixing

- standard 12Vdc @ 1A power supply unit (we suggest the AMC model L-AL power supply)
- 4G module

3. INSTALLATION



The LARIO programming APP can be downloaded from the APPLE and GOOGLE markets. The installation manual can be downloaded from www.lariohub.com

- The installation must be performed to a professional standard by specialist personnel, respecting the national plant engineering regulations.

4. CONFORMITY

AMC Elettronica declares that the LARIO intrusion alarm control panels comply with the requirements and provisions established by directive 1999/5/CE.

5. STANDARDS

All the products mentioned in this manual comply with the rules relating to the EN 50131 standard Grade 2 – Class II security systems.

To ensure compliance with these standards, the control panels must be programmed as indicated in the specific tables in the installation manual.

6. MANUFACTURER

AMC ELETTRONICA

Via Pascoli, 359 – Loc. Mirovano – 22040 Alzate Brianza (CO) Italy info@amcelettronica.com – www.amcelettronica.com

7. FEATURES

- Power supply 12 Vdc
- Nominal consumption 100 mA
- Maximum consumption 400 mA
- Battery 18650 Lithium 3.7 Vdc 2Ah
- Wireless 868 full duplex in diversity of frequency
- Wi-Fi on board
- 4G optional module
- 3 areas
- 3 programs for each area
- 64 users
- 64 zones
- 32 generic devices (detectors, etc.)
- 20 remote control
- 4 wireless repeater
- 4 keypads
- 4 sirens
- 8 outputs expansions
- 100 programmable sceneries
- 6 indication LEDs:
 - Power supply
 - Battery

- Radio signal
- SIM
- Wi-Fi
- Cloud activity
- Grade 2, Class II

8. WARRANTY

AMC Elettronica guarantees a product free from manufacturing defects.

As the product is not installed by the manufacturer and can be used together with other products not made by AMC Elettronica, the manufacturer does not guarantee and is not responsible for damage and/or theft or other types of problems deriving from incorrect installation and/or system configuration.

The guarantee therefore does not cover:

- improper use of the equipment
- programming errors or negligence on the part of the installer
- manipulation and vandalism
- wear of the product
- lightning, floods, fire

AMC Elettronica reserves the right to repair or replace the defective product within the established limit of 24 months. Any use other than that indicated in this manual will invalidate the warranty.

The installation must be performed to a professional standard by specialist personnel.

AMC Elettronica

Via Pascoli, 359 – 22040 Alzate Brianza (CO) Italy

info@amcelettronica.com – www.amcelettronica.com

Due to the continuous improvement of its products, AMC reserves the right to modify or replace technical specifications and information contained in this manual without prior notice.

Documents / Resources

	<p>LARIO AMCPlus Smart Control Panel [pdf] User Manual</p> <p>AMCPlus Smart Control Panel, AMCPlus, AMCPlus Control Panel, Smart Control Panel, Control Panel, Smart Panel, Panel</p>
---	---

References

- [LARIO Hub - Smart Control Panel](#)
- [User Manual](#)

Manuals+, Privacy Policy

This website is an independent publication and is neither affiliated with nor endorsed by any of the trademark owners. The "Bluetooth®" word mark and logos are registered trademarks owned by Bluetooth SIG, Inc. The "Wi-Fi®" word mark and logos are registered trademarks owned by the Wi-Fi Alliance. Any use of these marks on this website does not imply any affiliation with or endorsement.