



LANCOM SYSTEMS LANCOM 1790-4G Plus High-Performance VPN Router Instruction Manual

[Home](#) » [LANCOM SYSTEMS](#) » LANCOM SYSTEMS LANCOM 1790-4G Plus High-Performance VPN Router Instruction Manual 

LANCOM
SYSTEM



Hardware Quick Reference
LANCOM 1790-4G+

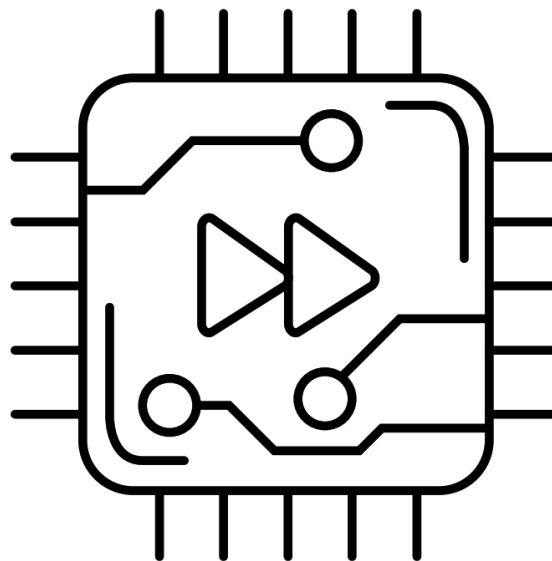

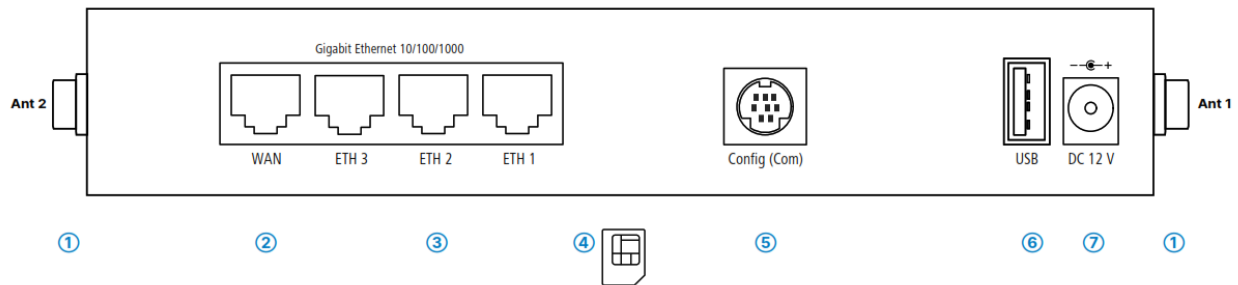

1. LTE / 4G antennas

Connect the two supplied cellular antennas to the connectors Ant 1 and Ant 2.



2. WAN interface

Connect the WAN interface to your WAN modem using the enclosed ethernet cable with the dark green connectors.



3. Ethernet interfaces

Use the cable with the green-colored connectors to connect one of the interfaces ETH 1 to ETH 3 to your PC or a LAN switch.



4. SIM card slot (bottom side of the device)

Release the SIM-card holder and lever it upwards. Slide the SIM card into the guide slot of the SIM-card holder. Press the holder down until it clicks into place.

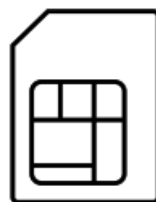

5. Configuration interface

Configuring the device via the serial interface requires a serial configuration cable (available as an accessory).



6. USB interface

You can use the USB interface to connect a USB printer or a USB memory stick.

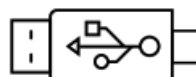

7. Power

After connecting the cable to the device, turn the bayonet connector 90° clockwise until it clicks into place. Use only the supplied power adapter.

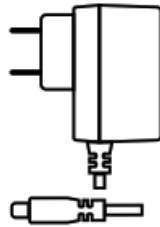

Before initial startup, please make sure to take notice of the information regarding the intended use in the enclosed installation guide!

Operate the device only with a professionally installed power supply at a nearby power socket that is freely accessible at all times.



Please observe the following when setting up the device

- The power plug of the device must be freely accessible.
- For devices to be operated on the desktop, please attach the adhesive rubber footpads
- Do not rest any objects on top of the device
- Keep all ventilation slots on the side of the device clear of obstruction
- In case of wall mounting, use the drilling template as supplied
- Rack installation with the optional LANCOM Rack Mount (separately available)

Contents

- [1 LED description & technical details](#)
- [2 Mounting & connecting](#)
- [3 Documents / Resources](#)
 - [3.1 References](#)
- [4 Related Posts](#)

LED description & technical details

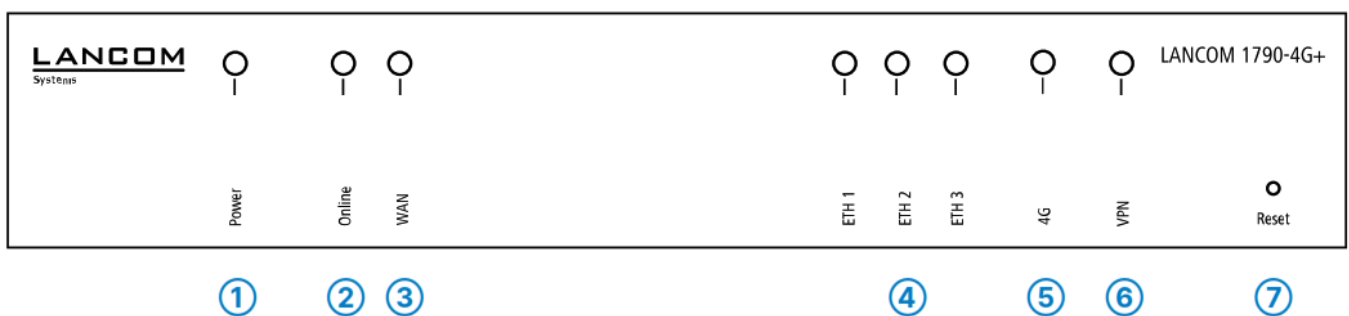

Mounting & connecting

① Power

Off	Device switched off
Green, permanently*	Device operational, resp. the device paired/claimed and LANCOM Management Cloud (LMC) is accessible
Red / green blinking	Configuration password not set. Without a configuration password, the configuration data in the device is unprotected.
Red blinking	Charge or time limit reached
1x green inverse blinking*	connection to the LMC active, pairing OK, device not claimed
2x green inverse blinking*	Pairing error, resp. LMC activation code not available
3x green inverse blinking*	LMC not accessible, resp. communication error

② Online

Off	Interface deactivated
Orange, blinking	Synchronization with the modem
Orange, permanently	Synchronization with the modem successful
Green, permanently	WAN connection established
Green, flickering	WAN data transmission
Red/orange, blinking	Hardware error, ext. modem

④ ETH

Off	No networking device attached
Green, permanently	Connection to network device operational, no data traffic
Green, flickering	Data transmission

⑤ 4G

Off	Cellular interface disabled
Green, permanently	Connection to cellular network active
Green, flickering	Cellular data transfer
Orange, permanently	Logon to cellular network successful
Orange, blinking	Logging on to cellular network
Red, permanently	Hardware error/module unavailable
Red / green, blinking	SIM card error (PIN)
Red/orange, blinking	Uploading module firmware

⑥ VPN

Off	VPN connection inactive
Green, permanently	VPN connection active
Green, flashing	VPN connecting

⑦ Reset

Reset button	Operated e.g. with a paper clip short press: Restart the device long press: Reset the device
--------------	---

Hardware

Power supply	12 V DC, external power adapter (230 V); bayonet connector to secure against disconnection
Power consumption	Max. ca. 9 W
Environment	Temperature range 0–40 °C; humidity 0–95 %; non-condensing
Housing	Robust synthetic housing, rear connectors, ready for wall mounting, Kensington lock; measures 210 x 45 x 140 mm (W x H x D)
Number of fans	1 quiet fan

Interfaces

4G: Ant 1, Ant 2	Two SMA connectors for the supplied dipole rod antennas (LTE, UMTS), are compatible LANCOM AirLancer antennas for 4G or 3G, or from other manufacturers. Please respect the restrictions which apply in your country when setting up an antenna system (in particular the antenna gain and transmission power).
WAN	10 / 100 / 1000 Mbps Gigabit Ethernet
ETH	3 individual 10 / 100 / 1000 Mbps Gigabit Ethernet ports; ex-factory operation as a switch. The ports can be electrically disabled in the LCOS configuration and support energy-saving functionality as per IEEE 802.3az.
USB	USB 2.0 hi-speed host port for connecting USB printers (USB print server), serial devices (COM-port server) or USB drives (FAT file system)
Config (Com) / V.24	Serial configuration interface/COM-port (8-pin mini-DIN): 9,600 – 115,200 baud, suitable for optional connection of analog/GPRS modems. Supports internal COM-port server and provides transparent asynchronous serial-data transfer via TCP.

WAN protocols

Ethernet	PPPoE, PPPoA, IPoA, Multi-PPPoE, ML-PPP, PPTP (PAC or PINS) and IPoE (with or without DHCP), RIP-1, RIP-2, VLAN
----------	---

Package content

Cable	1 Ethernet cable, 3 m (kiwi colored connectors)
Antennas	2 LTE / 4G antennas
Power adapter	External power adapter, 12 V / 2 A DC/S, barrel connector 2.1 / 5.5 mm bayonet, LANCOM item no. 111303 (not for WW devices)

*) The additional power LED statuses are displayed in a 5-second rotation if the device is configured to be managed by the LANCOM Management Cloud.

This product contains separate open-source software components which are subject to their own licenses, in particular the General Public License (GPL). The license information for the device firmware (LCOS) is available on the device's WEBconfig interface under "Extras > License information". If the respective license demands, the source files for the corresponding software components will be made available on a download server upon request.

Hereby, LANCOM Systems GmbH | Adenauerstrasse 20/B2 | D-52146 Wuersele, declares that this device is in compliance with Directives 2014/30/EU, 2014/53/EU, 2014/35/EU, 2011/65/EU, and Regulation (EC) No. 1907/2006. The full text of the EU Declaration of Conformity is available at the following Internet address:

www.lancom-systems.com/doc

LANCOM, LANCOM Systems, LCOS, LAN community, and Hyper Integration are registered trademarks. All other names or descriptions used may be trademarks or registered trademarks of their owners. This document contains statements relating to future products and their attributes. LANCOM Systems reserves the right to change these without notice. No liability for technical errors and/or omissions. 111956/0622

Documents / Resources



[LANCOM SYSTEMS LANCOM 1790-4G Plus High-Performance VPN Router](#) [pdf] Instruction Manual
LANCOM 1790-4G Plus, High-Performance VPN Router, LANCOM 1790-4G Plus High-Performance VPN Router, Performance VPN Router, VPN Router, Router

References

- [L DoC - LANCOM Systems GmbH](#)