

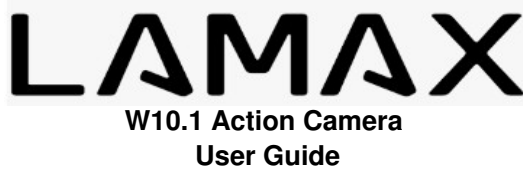

LAMAX W10.1 Action Camera User Guide

[Home](#) » [LAMAX](#) » LAMAX W10.1 Action Camera User Guide 



Contents

- [1 W10.1 Action Camera](#)
- [2 INTRODUCTION TO THE CAMERA / CONTROLS](#)
- [3 USING THE CAMERA FOR THE FIRST TIME](#)
- [4 WIFIAPPLICATION](#)
- [5 Documents / Resources](#)
- [6 Related Posts](#)

W10.1 Action Camera

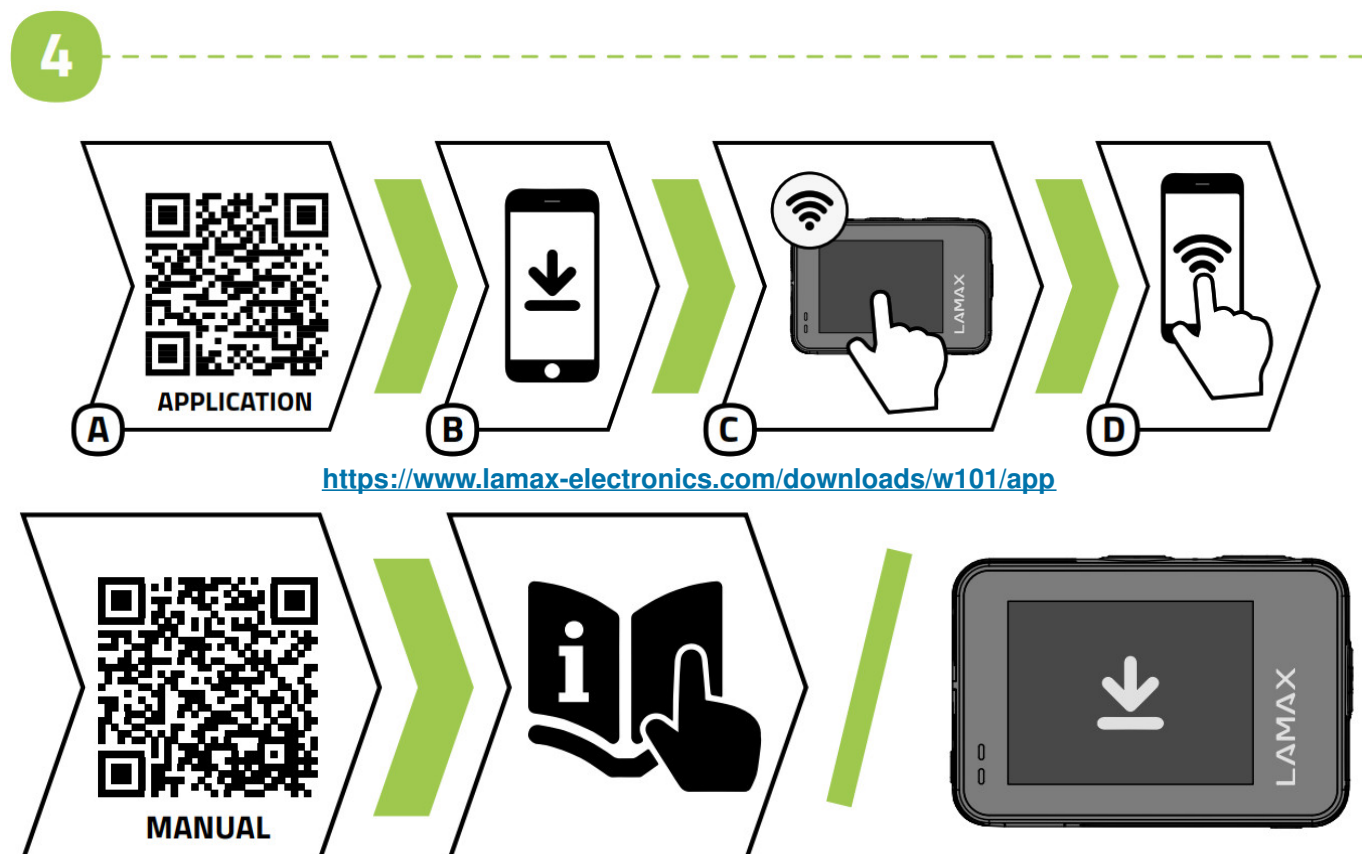
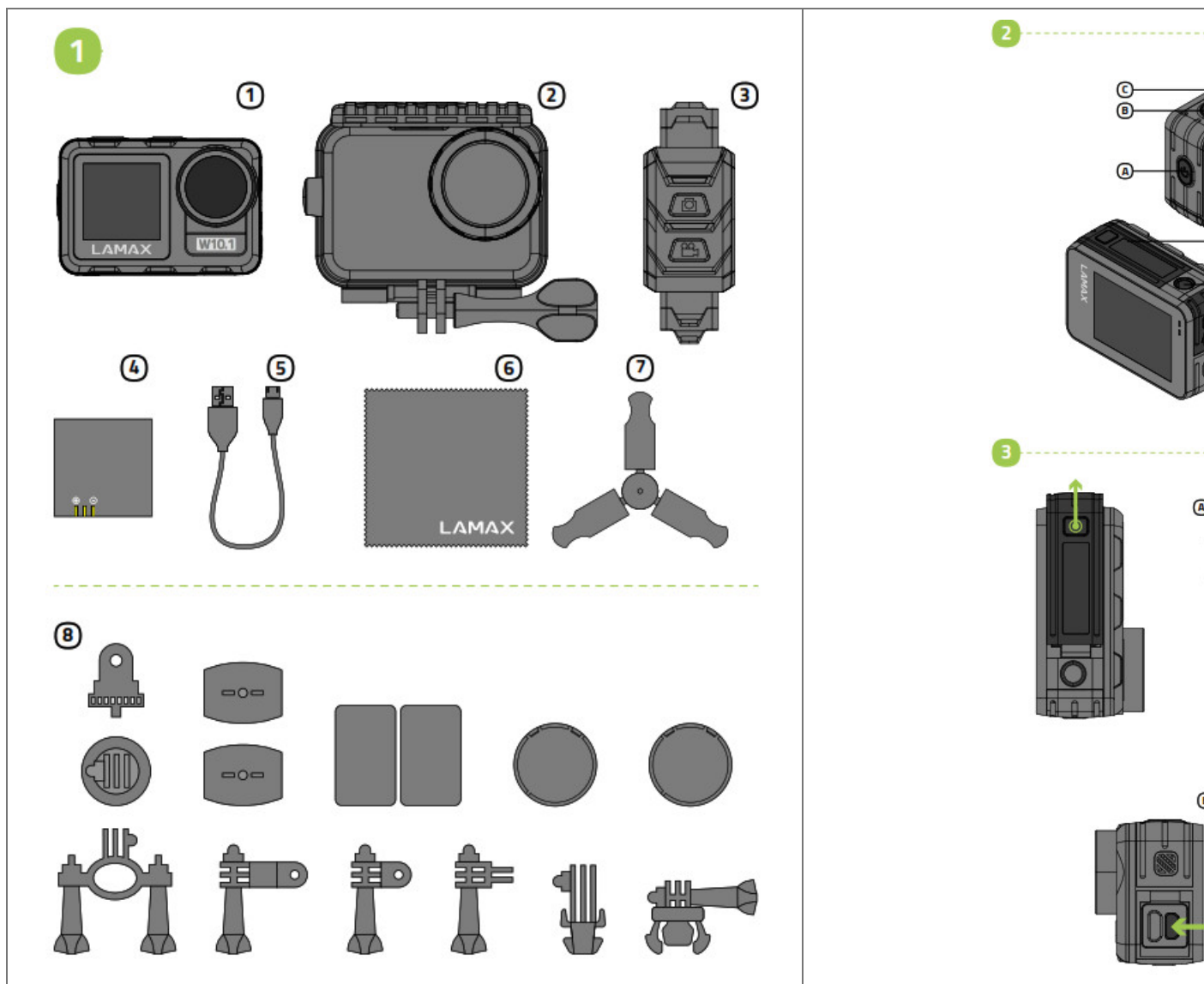

PACKAGE CONTENTS

1. LAMAX W10.1 action camera
2. Case, waterproof up to 40 m
3. Remote control, waterproof up to 2m
4. Li-ion battery
5. Micro USB cable for charging / transferring files
6. Microfibre cloth
7. Mini tripod
8. Mounts

INTRODUCTION TO THE CAMERA / CONTROLS

A POWER

B REC button

C MODE button



D Door to micro USB and micro HDMI connectors

E Door to battery and microSD card slot

F Thread to attach the camera to a tripod or selfie stick

Note: To avoid damaging the camera, only use the recommended accessories.

Camera controls

Turn on and off	Hold down the POWER button or drag your thumb down and then press the POWER icon
Select a mode	Touch the icon  or press the MODE button drag your thumb up to select the desired mode
Mode settings	Touch the icon 4K60 or press the „POWER”
Settings	Touch the icon 
View files	Touch the icon 
Switch between displays	Hold down the MODE button
Return back	Touch the icon <

USING THE CAMERA FOR THE FIRST TIME

A Insert the microSD card into the camera as shown (connectors toward the lens)

- Press the lock button at the bottom of the camera. Slide the door outwards and open it.
- Insert the card only when the camera is turned off and not connected to the computer.
- Format the card directly in the camera itself the first time you use it.
- We recommend memory cards with a higher write speed (UHS Speed Class – U3 and higher) and a maximum capacity of 256 GB.
- **Note:** Only use microSDHC or SDXC cards from reputable manufacturers. Generic cards do not guarantee the proper functioning of the data storage.

B Connecting the camera to the power

- You can charge the camera either by connecting it to a computer or using an optional AC adapter.
- It takes approximately 4.5 hours to charge the battery from 0 to 100 %. The charge indicator turns off after charging.
- **Note:** Charging the battery from 0 to 80 % takes 2.5 hours.

WIFIAPPLICATION

Thanks to the mobile app, you will be able to change camera modes and settings or view and download recorded videos and photos directly to your mobile device.

A Scan the QR code to download the application.

B Install the application on your mobile device.

C Turn on WiFi on the camera by swiping down and then touching the WiFi icon.

B On your mobile device, connect to the WiFi network with the camera's name. The WiFi password is displayed on the camera screen (factory setting is 12345678).

FLIPTHFP INFOPMATION

For complete instructions, firmware updates and the latest news about LAMAX products scan the QR code.

<http://www.lamax-electronics.com/lamax-w101>

Documents / Resources

	<p>LAMAX W10.1 Action Camera [pdf] User Guide W10.1, Action Camera, W10.1 Action Camera, Camera</p>
---	---