



# LAMAX N4 Electronics Auto Camera User Guide

[Home](#) » [LAMAX](#) » LAMAX N4 Electronics Auto Camera User Guide 

## LAMAX

N4 Electronics Auto Camera  
User Guide

### Contents

- [1 N4 Electronics Auto Camera](#)
- [2 BOX CONTENTS](#)
- [3 GETTING TO KNOW THE CAMERA](#)
- [4 BASIC SETTINGS AND FUNCTIONS](#)
- [5 ATTACHING TO THE WINDSCREEN](#)
- [6 WIFI APPLICATION](#)
- [7 FURTHER INFORMATION](#)
- [8 Documents / Resources](#)
  - [8.1 References](#)
- [9 Related Posts](#)

**N4 Electronics Auto Camera**

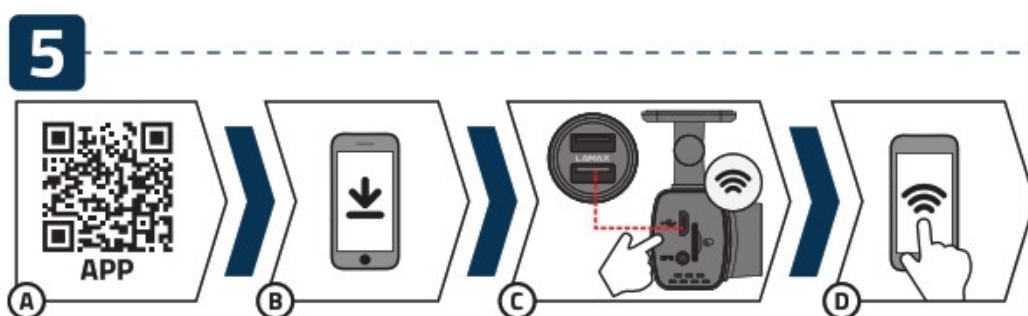
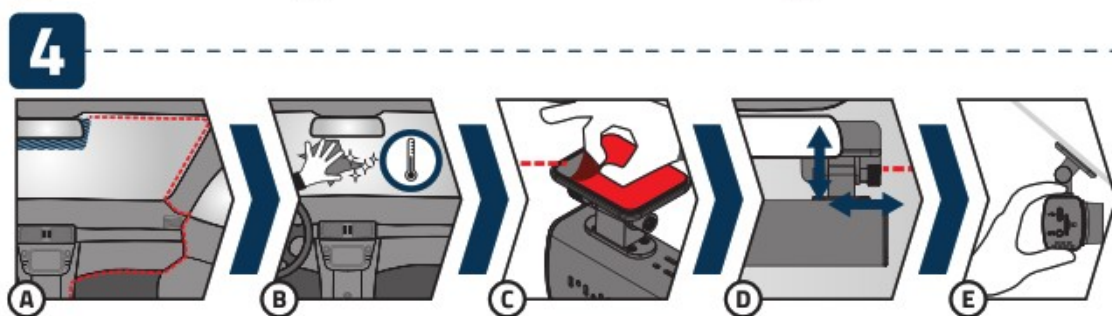
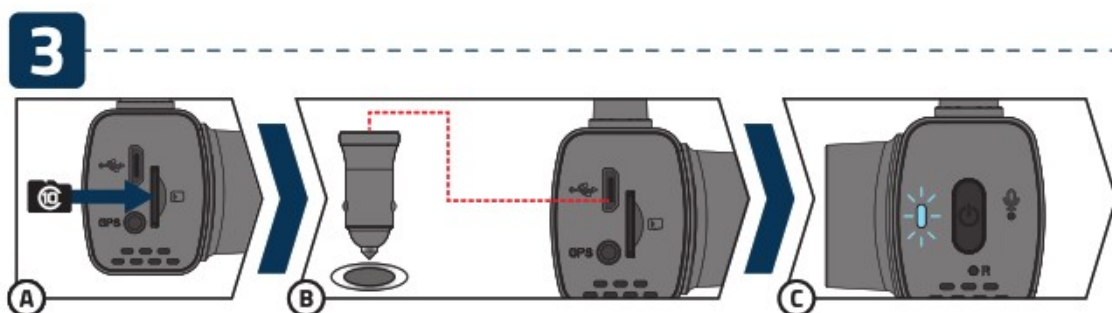
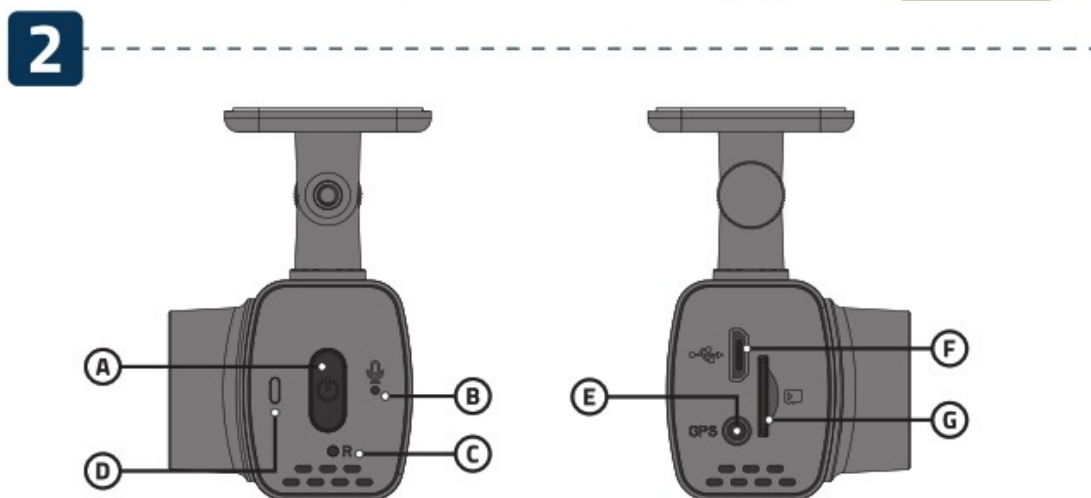
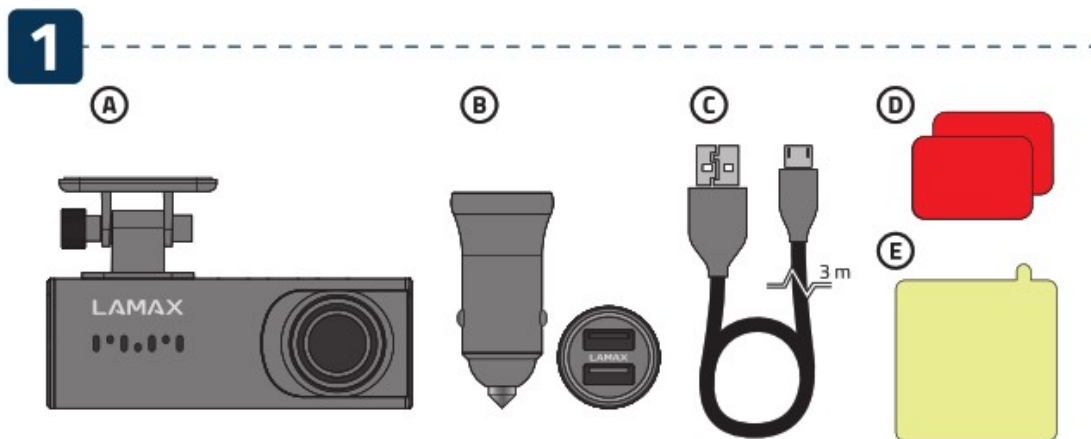

- A. LAMAX N4 dashcam
- B. Cigarette lighter adapter with extra USB port
- C. Micro USB power cable
- D. Spare 3M adhesive pad
- E. Electrostatic sticker

## GETTING TO KNOW THE CAMERA

- A Multifunction button
  - B Microphone
  - C RESTART button
  - D LED indicator
  - E Input for GPS module (optional)
  - F Power input
  - G Memory card slot
- (Blue = camera is on, flashing red = camera is recording, red = recording protected)

### Controls:

Press multifunction button	Protect recording
Hold multifunction button	Turn camera on / off
Press RESTART button with paperclip	Restart the camera

## BASIC SETTINGS AND FUNCTIONS

- A Insert the microSD card into the camera.
- Use branded cards from reputable manufacturers of class 10 and higher with a capacity of up to 128 GB.
  - Only remove the card when the camera is turned off.
  - Format the card directly in the camera the first time you use it, and repeat the formatting at least once a month to ensure proper operation of the camera.
- B Plug the adapter into the car cigarette lighter and use the USB cable to connect it to the camera. The camera is designed to operate only when connected to power.
- Instead of a battery, the camera contains a supercapacitor, which provides power and has a longer lifespan than a conventional battery.
- C When connected to the power, the camera will automatically turn on and start recording.
- In some vehicles, it is first necessary to turn the key in the ignition.

### BASIC FUNCTIONS:

#### Loop recording

- The camera automatically splits the recording into shorter video files and starts overwriting the oldest unprotected files with new ones when the SD card is full. This way you don't have to worry about running out of space on the card.

#### File protection

- You can protect the currently recorded video manually by pressing the multifunction button or through the app. When the recording is protected, a tone will sound and the LED indicator will turn red.

#### G-sensor

- Thanks to the G-sensor, the camera can identify an impact, such as in a traffic accident. Once an impact is detected, the camera immediately protects the current recording from being overwritten. (CAUTION, formatting the card will also delete the protected files).

## ATTACHING TO THE WINDSCREEN

- A The ideal place to mount the dashcam is the space between the windshield and the rearview mirror so that it

does not obstruct the driver`s view.

- When installing, ensure the cable does not interfere with safety features in the car (e.g. airbag).

B Make sure the glass is clean and dry at the attachment point.

- The ideal temperature for bonding is 20 °C 40 °C.

C Peel off the film from the 3M adhesive pad on the camera mount.

D Before attaching it to the glass, turn on the camera and point it so that it has a good view.

E Attach the camera with the 3M pad to the glass and hold for a while.

- For easier removal of the mount, you can apply an electrostatic sticker between the 3M pad and the windscreen.

- Finally, adjust the direction of the lens so that part of the bonnet is visible in the frame.

## WIFI APPLICATION

To use the full range of features of this camera, download the app to your smartphone. This app is used for precise camera setup and to save videos and photos to your phone. Scan the QR code below to install the app.

A Scan the QR code or enter the URL [lamax-electronics.com/n4/app](http://lamax-electronics.com/n4/app)

B Install the app on your smartphone or tablet.

C Plug the power into the camera. When the camera turns on, the WiFi will automatically turn on.

D On your smart device, connect to the WiFi network that has the name of the camera, enter the password (default 12345678), run the app, and click the „Add Camera” button to connect the camera.

## FURTHER INFORMATION

Please visit [lamax-electronics.com/n4](http://lamax-electronics.com/n4) for complete instructions and firmware.

Don`t forget to register your product on our website [lamax-electronics.com/n4/reg](http://lamax-electronics.com/n4/reg)

As soon as we update the firmware, we'll let you know!

By registering the product, you will also get access to news and discounts!



<http://lamax-electronics.com/n4>

## Documents / Resources



[LAMAX N4 Electronics Auto Camera](#) [pdf] User Guide

N4, N4 Electronics Auto Camera, Electronics Auto Camera, Auto Camera, Camera

## References

-  [LAMAX N4 | LAMAX Electronics | EN](#)
-  [Viidure-Universal Dashcam View – Aplikace na Google Play](#)
-  [Product registration | LAMAX Electronics | EN](#)
-  [Viidure-Universal Dashcam View – Aplikace na Google Play](#)

Manuals+.