



Labkotec D15622CE-5 GA-1 Grease Separator Alarm Device User Manual

[Home](#) » [Labkotec](#) » Labkotec D15622CE-5 GA-1 Grease Separator Alarm Device User Manual 

Labkotec D15622CE-5 GA-1 Grease Separator Alarm Device User Manual



Contents

- 1 SYMBOLS
- 2 GENERAL
- 3 INSTALLATION
- 4 OPERATION
- 5 TROUBLE-SHOOTING
- 6 REPAIR AND SERVICE
- 7 SAFETY
- INSTRUCTIONS
- 8 TECHNICAL DATA
- 9 Documents / Resources
 - 9.1 References
- 10 Related Posts

SYMBOLS



Warning / Attention



Device is protected by double or reinforced insulation

GENERAL

GA-1 is an alarm device for monitoring the thickness of the grease layer accumulating in a grease separator.

The system consists of GA-1 control unit, GA-SG1 sensor and a cable joint.

SYSTEM COMPONENTS:

Figure 1. Grease separator supervision with GA-1 alarm device

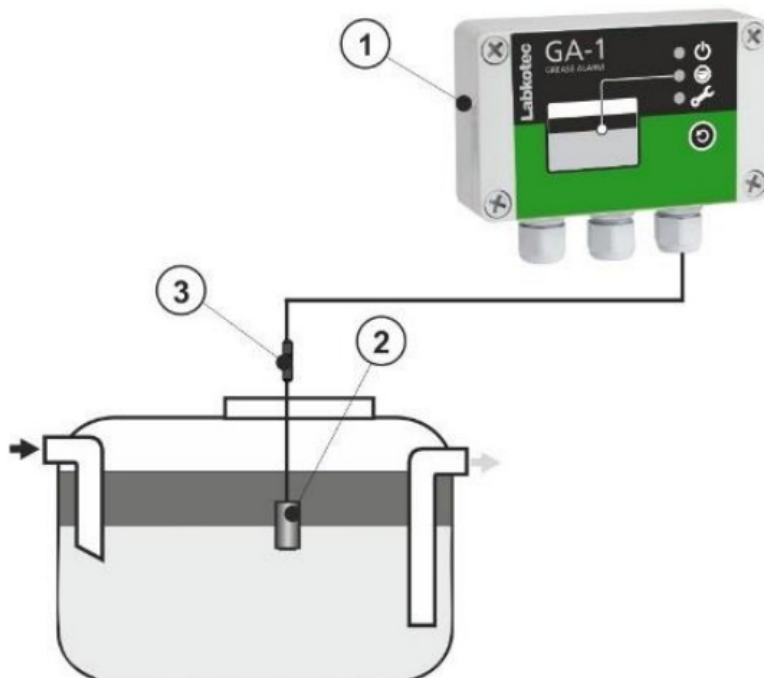

1. GA-1 control unit

2. GA-SG1 sensor (grease alarm) with fixed cable
3. Cable joint

GA-SG1 sensor is installed into the grease separator and it supervises thickness of grease layer.

The LED indicators, push button and interfaces of the GA-1 control unit are described in **figure 2**.

GA-1 USER INTERFACE FEATURES

Figure 2. GA-1 control unit – features

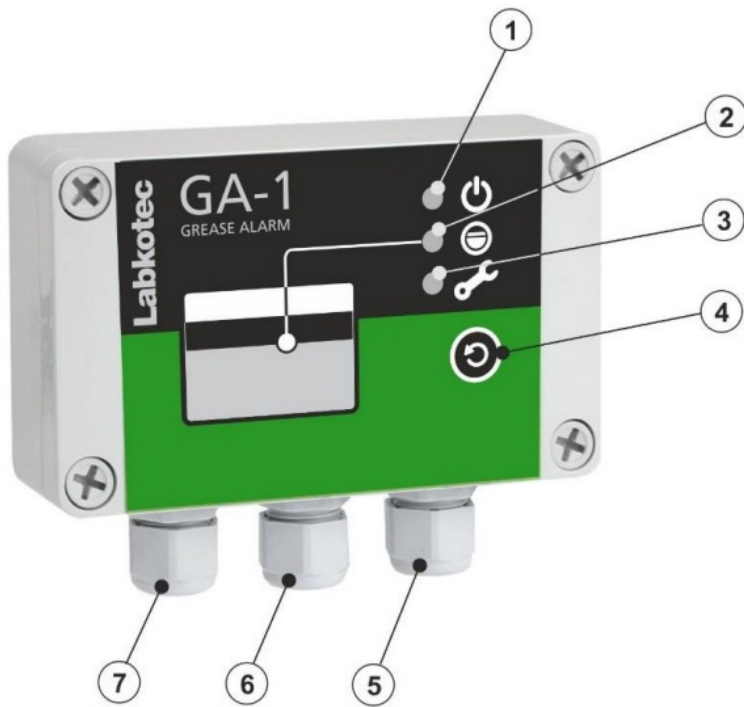

1. LED indicator for mains
2. LED indicator for alarm
3. LED indicator for fault
4. Alarm Reset/Test push button Connector for GA-SG1 sensor
5. Relay output for monitoring and control purposes
6. Supply voltage

INSTALLATION

GA-1 control unit

GA-1 control unit can be wall-mounted. The mounting holes are located in the base plate of the enclosure, beneath the mounting holes of the front cover.

The cover of the enclosure must be tightened so, that the edges touch the base frame. Only then does the push button function properly and the enclosure is tight.

Before installation, please read the safety instructions in chapter 6!

Figure 3. GA-1 alarm device installation.

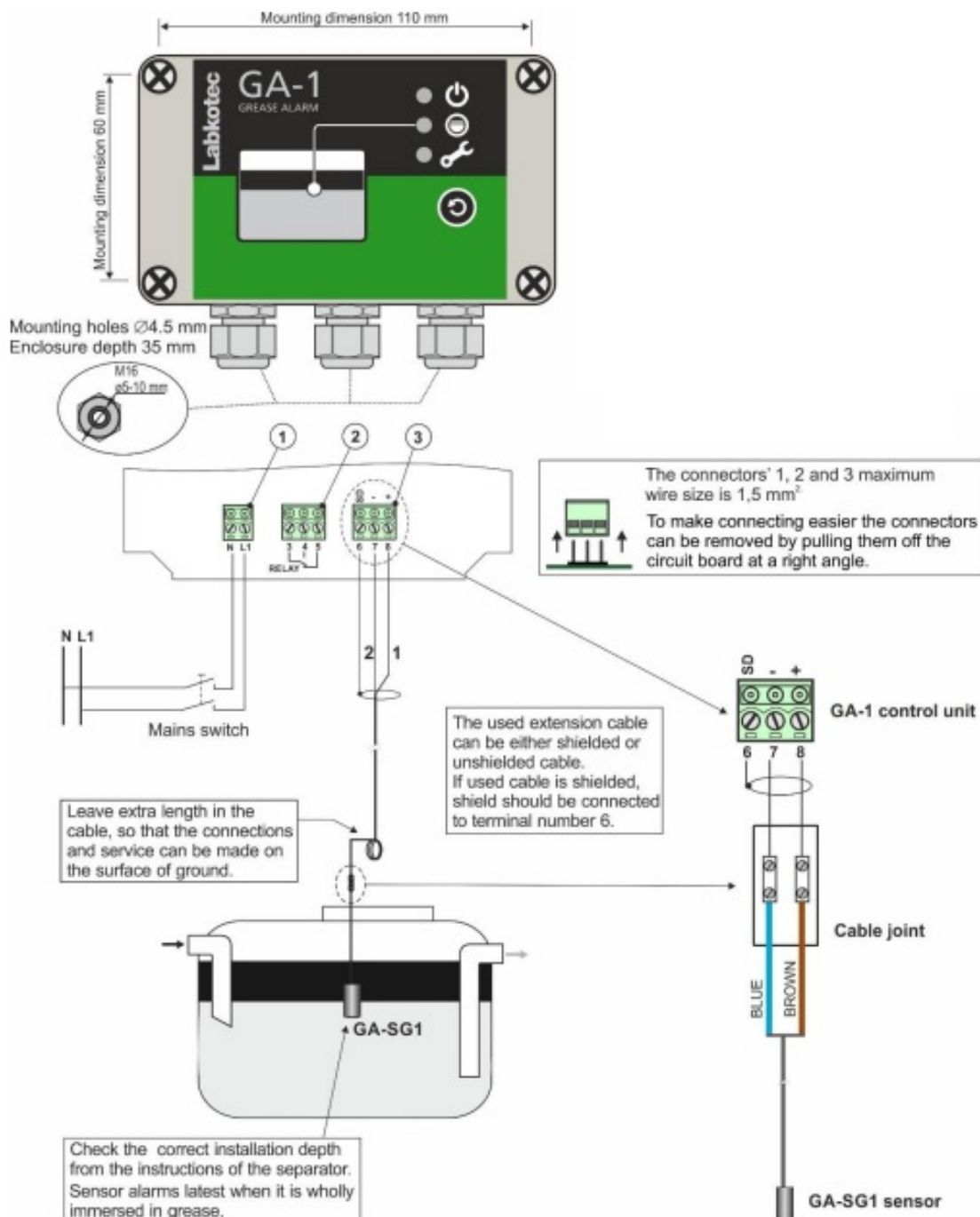

1. SUPPLY VOLTAGE 230 VAC, 50/60 Hz L1 phase conductor Nneutral conductor
2. RELAY (alarm relay) 3=common pole 4 opening pole when alarm 5= closing pole when alarm Relay is in alarm postion, when the mains voltage is off.
3. SENSOR CONNECTOR 6= auxiliary connection (SD) 7=[-] supply pole to sensor 8=[+] supply pole to sensor

GA-SG1 sensor

GA-SG1 sensor should be installed as described in figure 3.

The sensor gives an alarm latest when it is wholly immersed in grease.

Please check the correct installation depth also from the instructions of the grease separator

Installation Accessories

The delivery includes a cable joint (figure 4), fixing accessories (figure 5) for installation of the control unit and the sensor. In figure 6 is an installation example of cable with suspension hook.

Connections of the sensor cable inside the cable joint are explained in figure 3. If shielded cable is used cable shields and possible excess wires need to be connected to the same point in galvanic contact.

IP rating of the cable joint is IP68. Make sure, that the cable joint is closed properly

Figure 4 Cable joint



Figure 5. Fixing accessories



Figure 6. Cable installation example



OPERATION

The operation of the alarm device should be checked always after the installation. Also check the operation always when emptying the separator or at least once every six months.

Functionality test

1. Immerse the sensor into water. The device should be in normal mode.
2. Lift the sensor up in air or grease. A grease alarm should be generated (see chapter 3.1 for more detailed

description).

3. Clean up the sensor.
4. Immerse the sensor back into water. The alarm should go off after a delay of 10 sec.

A more detailed description of the operation is provided in chapter 3.1. If the operation is not as described here, check connections and cabling. If necessary contact a representative of the manufacturer.

Modes of operation

Normal mode – no alarms

Sensor is totally immersed in water.
Mains LED indicator is on.
Other LED indicators are off.
Relay is energized.

Grease alarm

Sensor is immersed in grease. (the sensor gives an alarm latest when it is wholly immersed in grease).
Mains LED indicator is on.
Grease Alarm LED indicator is on.
Buzzer on after 10 sec delay.
Relay de-energize after 10 sec delay.

(Note. The same alarm takes place when GA-SG1 sensor is in the air.)

After removal of an alarm, the Grease Alarm LED indicator and buzzer will be off, and relay will be energized after 10 sec delay

Fault alarm

Sensor cable break, short circuit or a broken sensor.
Mains LED indicator is on.
Sensor circuit Fault LED indicator is on after 10 sec delay.
Buzzer is on after 10 sec delay.
The relay de-energize after 10 sec delay.

Reset of an alarm

When pressing the Reset/Test push button.
Buzzer will go off.
Relay and LED indicator will not change their position until the alarm or fault situation is removed.
If the buzzer is not reset, it goes off automatically after three days

TEST FUNCTION

Test function provides an artificial alarm, which can be used to test the function of the GA-1 alarm device and the function of other equipment, which are connected to GA-1 via its relay.



Attention! Before pressing the Reset/Test button, make sure that the change of relay status does not cause hazards elsewhere!

Normal situation

When pressing the Reset/Test push button:
Grease Alarm and Fault LED indicators are immediately on.
Buzzer is immediately on.
Relay de-energize after 2 sec of continuous pressing.
When the Reset/Test push button is released:

LED indicators and buzzer go immediately off.
Relay energize immediately.

Alarm on

When pressing the Reset/Test push button for the first time:
Buzzer will go off.

When pressing the Reset/Test push button after that:
Fault LED indicator is immediately on.

Grease Alarm LED indicator remains on.

Buzzer remains on. If it has been reset earlier, it will return to be on.

When the Reset/Test push button is released:

The device returns right away to the preceding status

Fault alarm on

When pressing the Reset/Test push button:
The device does not react to the test at all.

TROUBLE-SHOOTING

Problem: No alarm when sensor in grease or air, or the alarm will not go off

Possible reason: Sensor is dirty

To do:

1. Clean-up the sensor and check the operation again.



The following operations must be performed only by a qualified electrician!

Problem: MAINS LED indicator is off

Possible reason: Device doesn't get supply voltage.

To do:

1. Check that power separation switch is not switched off.
2. Measure the voltage between poles N and L1. It should be 230 VAC \pm 10 %

Problem: FAULT LED indicator is on

Possible reason: Current in sensor circuit too low (cable break or out of connector) or too high (cable in short circuit). The sensor might also be broken.

To do:

1. Make sure, that the sensor cable has been connected correctly to the GA-1 control unit.
2. Measure the voltage separately between the poles 7 and 8. The voltages should be between 7,0 – 8,5 V.
3. Measure sensor current when the sensor is in the air or in grease.

The measured current should be 7,0 – 8,5 mA.

4. Measure current when the sensor is in the water. Measured current should be 2,5 – 3,5 mA

If the problem can not be solved with the above instructions, please contact Labkotec Oy's service.

REPAIR AND SERVICE

The sensor should be cleaned and the operation should also be tested when emptying or maintaining the grease separator or at least once every six months. The easiest way to check the operation is to lift the sensor up in the air and to put it back to the separator. The operation is described in chapter 3.

For cleaning, a mild detergent (e.g. washing-up liquid) and a scrubbing brush can be used.

In case of queries, please contact Labkotec Oy's service.

SAFETY INSTRUCTIONS



The device does not include a mains switch. A two pole mains switch (250 VAC 1 A), which isolates both lines (L1, N) must be installed in the main power supply lines in the vicinity of the unit. This switch facilitates maintenance and service operations and it has to be marked to identify the unit. Fuse maximum 10 A.



If opening of housing's cover is needed, only a qualified electrician is allowed to install or to maintain the device.



If the device is used against the manufacturer's instructions, the protection provided by the device may be damaged.



The device is not allowed to install in hazardous areas.

TECHNICAL DATA

GA-1 control unit	
Dimensions	125 mm x 75 mm x 35 mm (L x H x D)
Weight	250 gPackage 0,8 kg (control unit + sensor + cable joint)
Enclosure	IP 65, material polycarbonate
Cable bushings	3 pcs M16 for cable diameter 5-10 mm
Operating environment	Temperature: -30 °C...+50 °CMax. elevation above sea level 2,000 m Relative humidity RH 100%Suitable for indoor and outdoor use (protected from direct rain)
Supply voltage	230 VAC \pm 10 %, 50/60 HzThe device is not equipped with a mains switch . Fuse maximum 10 A.
Power consumption	5 VA
Sensors	GA-SG1 sensor
Relay output	Potential-free relay output 250 V, 5 AOperational delay 10 sec. Relay de-energize at trigger point.
Electrical safety	EN IEC 61010-1, Class II , CAT II, POLLUTION DEGREE 2
EMCEmission Immunity	EN IEC 61000-6-3 EN IEC 61000-6-1
Manufacturing year: Please see the serial number on the type plate	xxx x xxxxx xx YY x where YY = manufacturing year (e.g. 19 = 2019)

Figure 7. GA-1 control unit

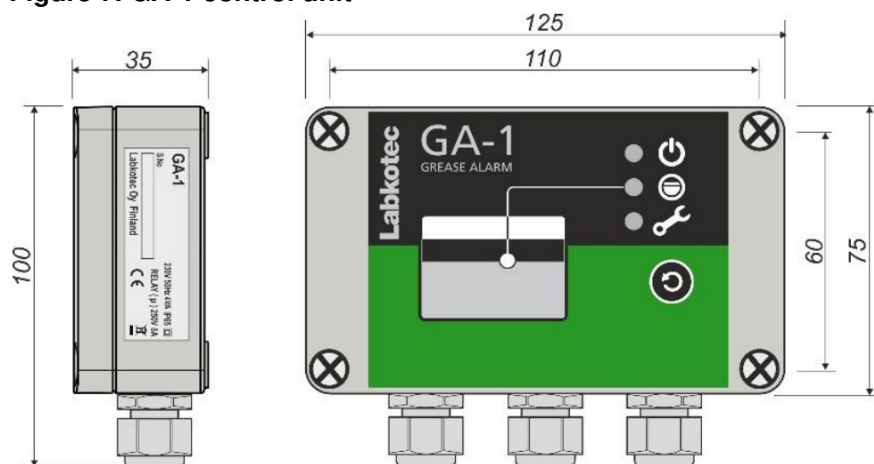

GA-SG1 sensor	
Principle of operation	Capacitive
Material	POM, chlorinated polyethylene rubber (CM), AISI 316
Weight	350 g(sensor + fixed cable)
IP-classification	IP68
Operation temperature	0 °C...+90 °C
Cable	Fixed cable 2 x 0.75 mm ² Ø 5,8mm. Standard length 5 m, other lengths optional. The max. length of the fixed cable is 15 m, can be extended. Maximum cable loop resistance is 75 Ω.
EMCEmission Immunity	EN IEC 61000-6-3 EN IEC 61000-6-1
Manufacturing year: Please see the serial number from the bottom of sensor	GAxxxxxYY where YY = manufacturing year (e.g. 19 = 2019)

Figure 8. GA-SG1 sensor



Labkotec Oy

Myllyhaantie 6, F-33960 Pirkkala, Finland

Tel. +358 29 006 260

info@labkotec.fi

Labkotec Oy

Myllyhaantie 6

FI-33960 PIRKKALA

FINLAND

Tel: 029 006 260

Fax: 029 006 1260

Internet: www.labkotec.fi

Copyright © 2022 Labkotec Oy
We reserve the right for changes without notice



Documents / Resources

	<p>Labkotec D15622CE-5 GA-1 Grease Separator Alarm Device [pdf] User Manual D15622CE-5 GA-1 Grease Separator Alarm Device, D15622CE-5, GA-1 Grease Separator Alarm Device, Grease Separator Alarm Device, Separator Alarm Device, Alarm Device</p>
--	--

References

- [Labkotec.fi](http://www.labkotec.fi) - Measures for a better tomorrow