

Kzzi K98 Mechanical Keyboard



Kzzi K98 Mechanical Keyboard User Manual

[Home](#) » [Kzzi](#) » Kzzi K98 Mechanical Keyboard User Manual 

Contents

- 1 Kzzi K98 Mechanical Keyboard
- 2 Product Usage Instructions
- 3 WARRANT
- 4 PRODUCT BASIC INFORMATION
- 5 INDICATORS
- 6 WIRED MODE
- 7 BT CONNECTION
- 8 2.4G RECEIVER CONNECTION
- 9 KEYBOARD BATTERY LEVEL INDICATION AND CHECK
- 10 BACKLIGHT CONTROL
- 11 BACKLIGHT RECORDING
- 12 FAQ
- 13 Documents / Resources
 - 13.1 References
- 14 Related Posts

Kzzi

Kzzi K98 Mechanical Keyboard



Specifications

- **Product Name:** Mechanical Keyboard
- **Number of Keys:** 98 keys
- **Connection:** USB-C wired/2.4G wireless/BT
- **Switches:** Mechanical switches
- **Backlit:** RGB
- **Indicators:** Light bar for battery status, WIN Lock indicator

Product Usage Instructions

Maintenance and Usage Tips

1. Maintain proper posture and avoid excessive force on the keys.
2. Take regular breaks to prevent hand fatigue.
3. Clean the keyboard regularly to remove dust and dirt.
4. Avoid exposing the keyboard to liquids.
5. Keep the keyboard in a suitable environment, free from extreme temperatures or humidity.

Switching to Wired Mode

To switch to wired mode, follow these steps:

1. Connect the keyboard to the device using the provided USB-C cable.
2. Press the scroll wheel on the keyboard to switch to wired mode.

FCC WARNING:

This device complies with part 15 of the FCC Rules,

Operation is subject to the following two conditions:

1. This device may not cause harmful interference, and
2. this device must accept any interference received, including interference that may cause undesired operation.

Any Changes or modifications not expressly approved by the party responsible for compliance could void the user's authority to operate the equipment

Note: This equipment has been tested and found to comply with the limits for a Class B digital device, pursuant to part 15 of the FCC Rules.

These limits are designed to provide reasonable protection against harmful interference in a residential installation. This equipment generates uses and can radiate radio frequency energy and, if not installed and used in accordance with the instructions, may cause harmful interference to radio communications. However, there is no guarantee that interference will not occur in a particular installation. If this equipment does cause harmful interference to radio or television reception, which can be determined by turning the equipment off and on, the user is encouraged to try to correct the interference by one or more of the following measures:

- Reorient or relocate the receiving antenna.
- Increase the separation between the equipment and receiver.
- Connect the equipment into an outlet on a circuit different from that to which the receiver is connected.
- Consult the dealer or an experienced radio/TV technician for help.

The device has been evaluated to meet general RF exposure requirement. The device can be used in portable exposure condition without restriction.

WHEN USING A KEYBOARD:

1. Maintain proper posture and avoid excessive force on the keys.
2. Take regular breaks to prevent hand fatigue.
3. Clean the keyboard regularly to remove dust and dirt.
4. Avoid exposing the keyboard to liquids.
5. Keep the keyboard in a suitable environment, free from extreme temperatures or humidity. Remember these tips for a comfortable and durable keyboard experience.

WARRANT

12 MONTHS WARRANTY

GUARANTEE

Non-human damage 12-month warranty

PRODUCT BASIC INFORMATION



Manual



Switch and Keycaps Puller

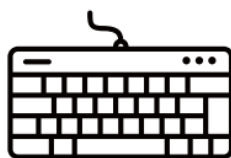

Keyboard

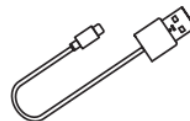





Type-C Cable

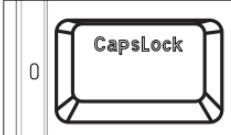

Receiver

INDICATORS

- 1  Num
Light bar indication: When fully charged, the light bar flashes green five times
- 2  WIN Lock (WIN Lock indicator is made on the button, turn on the white light, turn off with the backlight)
- 3  Caps Lock
- 4 Low battery: Fn key continuously flashes red light
- 5 
 - USB Wired mode
 - BT Mode
 - 2.4G Mode

WIRED MODE

1. Connect the keyboard to the device using a USB cable and press the scroll wheel to switch to **USB** wired mode

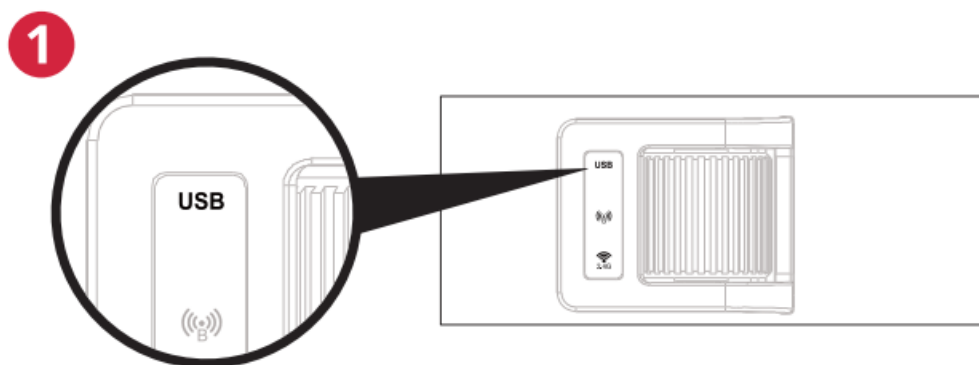

2. (**Recommended:** Use a 5V 1A power supply for keyboard charging)

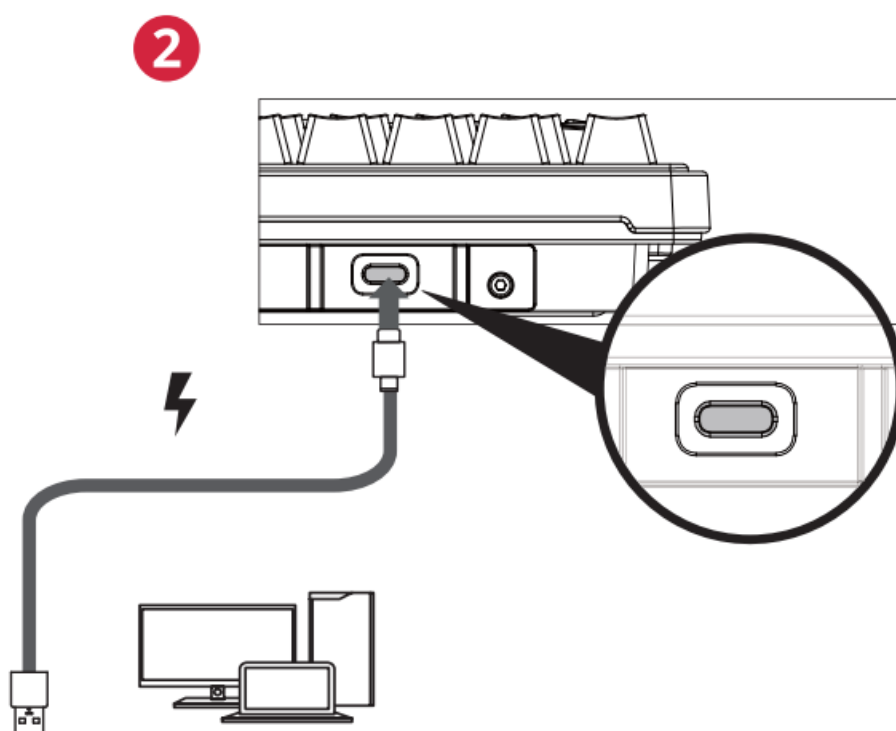

BT CONNECTION

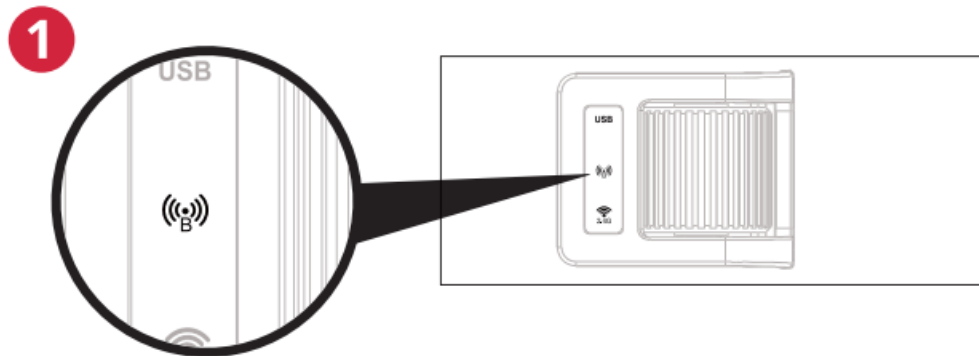

1. Long press scroll wheel for 3 seconds to power on, short press to switch to BT mode.
2. To pair the keyboard, press and hold any of the key combinations of Fn+Q / W / E for 3 seconds. take Fn+Q for example, the Q key will quickly flash to indicate pairing mode, while a slow flash indicates reconnection mode
3. To connect the device, open your computer or mobile device's BT settings and search for "Kzzi-K98". Select it to establish the connection.

Note that it is compatible with Windows 8 and above systems, as well as mobile devices

4. Similarly, Repeat the previous steps to connect and pair each desired BT device using the Fn+Q / W / E key combinations. Short press Fn+Q / W / E to switch between the stored devices

(**Kind reminder:** Please pair the 3 BT devices before switching between them.)

2.4G RECEIVER CONNECTION

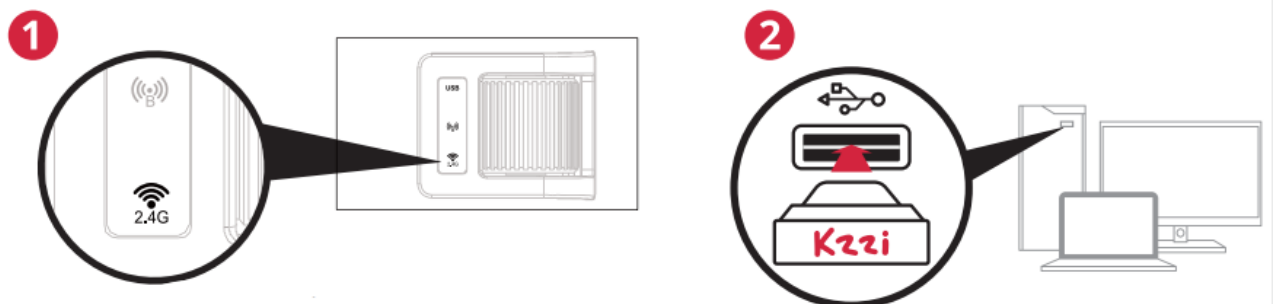

1. Long press scroll wheel for 3 seconds to power on, short press to switch to 2.4G mode.
2. Long press Fn+P to pair, insert the receiver when the P key rapidly flashes, and successful pairing is indicated when the P key stops flashing.
3. Slow flashing P key indicates keyboard in reconnection mode

(**Note:** 2.4G receiver comes pre-paired. This method is only for troubleshooting 2.4G connection issues. Set it up once and no further setup is required.)

KEYBOARD BATTERY LEVEL INDICATION AND CHECK

The keyboard's lighting can display the current battery level status.

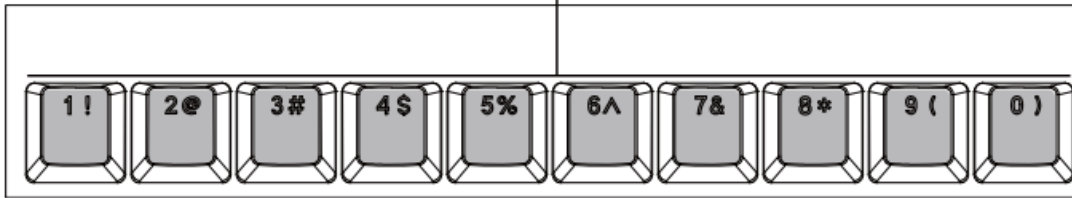

- Pressing Fn+ENTER allows you to view the battery level status. Each key from “1” to “0” represents a specific battery level range.
- The “1” and “2” keys are both illuminated, indicating that the keyboard’s current battery level is at 20%.
- The backlight of the “1” key is illuminated, indicating that the keyboard’s current battery level is at 10%.
- When the backlighting illuminates from 1 to 0 simultaneously, it indicates that the keyboard battery is at 100% charge.

BACKLIGHT CONTROL

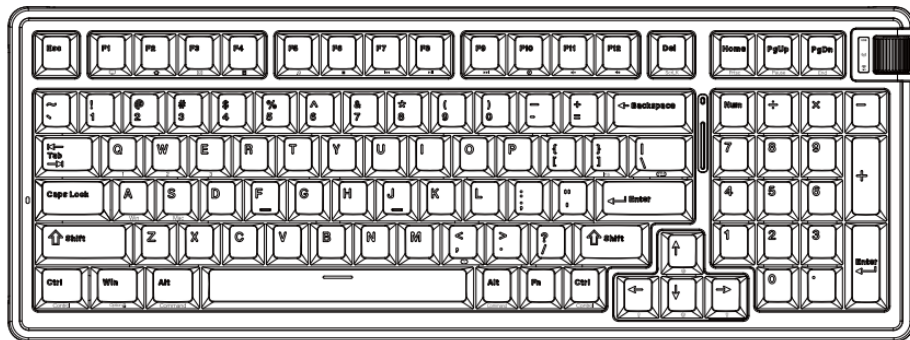

Fn + INS	Fn + [Icon: Three dots] Multiple Backlight Effects Switch	Fn + [Icon: Left arrow] Backlight Monochrome Switching (Only Applicable to RGB Versions)	Fn + [Icon: Right arrow] Switch light bar lighting effect
Fn + Del Scrk	Fn + [Icon: Up arrow] Backlight Brightness +	Fn + [Icon: Left arrow] Backlight Speed -	Fn + Num + Light bar brightness +
Fn + Home Prtsc	Fn + [Icon: Down arrow] Backlight Brightness -	Fn + [Icon: Right arrow] Backlight Speed +	Fn + Num - Light bar brightness -
Fn + PgUp Pause	Fn + WIN Window Lock	Fn + Esc Turn Off / On Backlight	
Fn + PgDn END	Fn + space bar Restore Factory Settings(Press And Hold For 3 Seconds)		

ISED STATEMENT:

This device contains license-exempt transmitters/receivers that comply with Innovation, Science and Economic Development Canada’s licence-exempt RSS(s).

Operation is subject to the following two conditions:

1. This device may not cause interference.
2. This device must accept any interference, including interference that may cause undesired operation of the device.

This device meets the exemption from the routine evaluation limits in section 2.5 of RSS 102 and compliance with RSS 102 RF exposure, users can obtain Canadian information on RF exposure and compliance.

BATTERIES:

A warning that batteries (battery pack or batteries installed) shall not be exposed to excessive heat such as sunshine, fire or the light.

1. Replacement of a battery with an incorrect type that can defeat a safeguard;
2. Disposal of a battery into fire or a hot oven, or mechanically crushing or cutting of a battery, that can result in an explosion;
3. Leaving a battery in an extremely high temperature surrounding environment that can result in an explosion or the leakage of flammable liquid or gas;
4. A battery subjected to extremely low air pressure that may result in an explosion or the leakage of flammable liquid or gas.

BACKLIGHT RECORDING

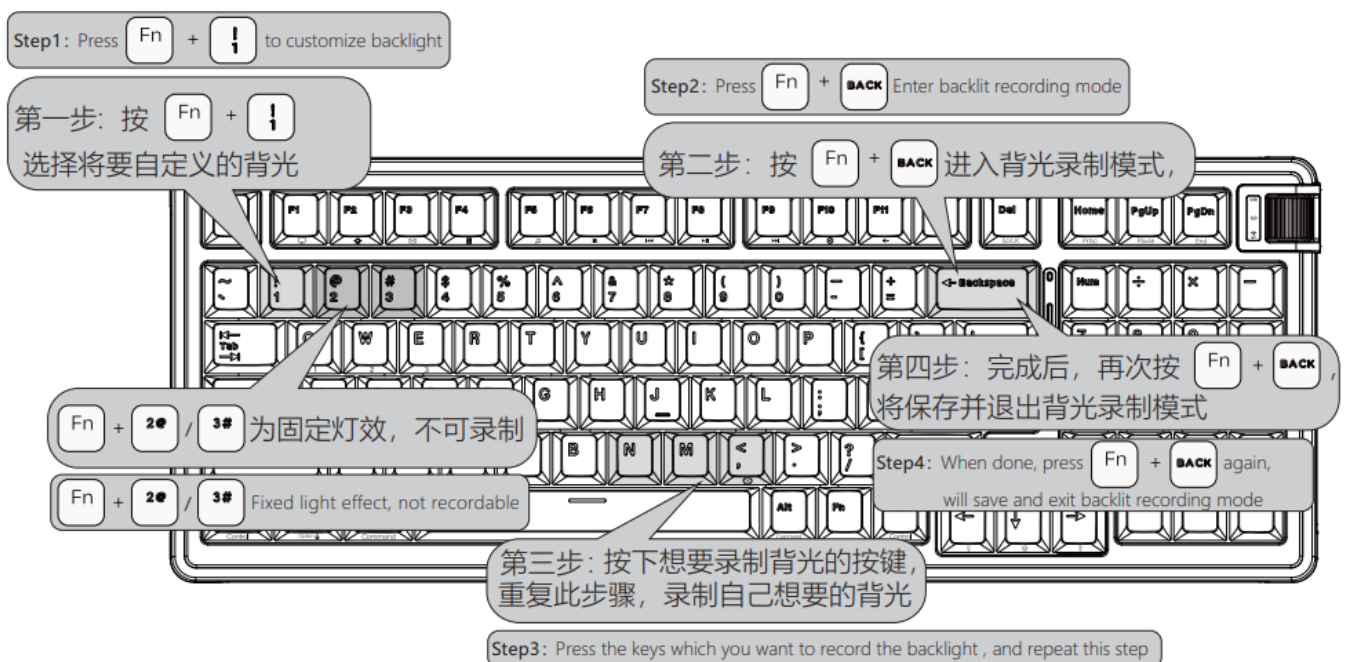

WINDOWS MULTIMEDIA KEYS

In Windows mode (FN+A: Switch to Windows system)

Fn + F1	Computer	Fn + F4	Calculator	Fn + F7	Previous Song	Fn + F10	Mute
Fn + F2	Browser	Fn + F5	Media Player	Fn + F8	Play/Pause	Fn + F11	Volume -
Fn + F3	Email	Fn + F6	Pause	Fn + F9	Next Song	Fn + F12	Volume +

MAC MULTIMEDIA KEYS

In macOS mode (FN+S: Switch to macOS system)



Thank you for choosing KZZI products! If you have any questions or need assistance, please feel free to contact us. Our team is dedicated to providing support and addressing your inquiries. We highly value your feedback and suggestions as they help us continuously improve and enhance product quality. Once again, we appreciate your support for KZZI!

- Email: kzzi@kzzi.com
- Official Website: www.kzzi.com
- Brand: Kezhi(Huizhou)Electronic Technology Co., Ltd
- Implementation standard: GB / T 14081-2010

FAQ

Q: How do I know when the keyboard is fully charged?

A: The light bar will flash green five times when the keyboard is fully charged.

Q: What should I do if the keyboard shows low battery?

A: When the battery is low, the Fn key will continuously flash a red light. Connect the keyboard to a power source using the USB-C cable to recharge.

Documents / Resources

	<p>Kzzi K98 Mechanical Keyboard [pdf] User Manual 2BBA6-K98, 2BBA6K98, k98, K98 Mechanical Keyboard, K98 Keyboard, Mechanical Keyboard, Keyboard</p>
--	--

References

- [User Manual](#)

[Manuals+](#), [Privacy Policy](#)

This website is an independent publication and is neither affiliated with nor endorsed by any of the trademark owners. The "Bluetooth®" word mark and logos are registered trademarks owned by Bluetooth SIG, Inc. The "Wi-Fi®" word mark and logos are registered trademarks owned by the Wi-Fi Alliance. Any use of these marks on this website does not imply any affiliation with or endorsement.