



KYOCERA MA2100c Series Laser Multi function printer User Guide

[Home](#) » [Kyocera](#) » KYOCERA MA2100c Series Laser Multi function printer User Guide 

KYOCERA MA2100c Series Laser Multi function printer



- Printer Driver & Utility Install
- Manual Download

Refer to the following URL. <https://kyocera.info/>

Please scan the code on the right.
Or please check the following URL.





- Printer Driver & Utility Install
- Manual Download Refer to the following URL.
<https://kyocera.inst-guide.com/tb11f/>



Contents

- 1 Login
- 2 Preface
- 3 Unpacking
- 4 Setting up the Toner Container
- 5 Connect Cable
- 6 Loading Paper
- 7 Connect Power Cord
- 8 Replace Operation Panel Sheet
- 9 Power On
- 10 Altitude Adjustment (1000m or higher Only)
- 11 Print Status Page
- 12 Install Drivers and Utilities
- 13 Cancelling
- 14 Copy
- 15 Scan (E-mail)
 - 15.1 Setup
 - 15.2 Send
- 16 FAX
- 17 Private printing
 - 17.1 From a PC
 - 17.2 From the Operation Panel
- 18 Troubleshooting
- 19 Clear Paper Jam
- 20 Documents / Resources
- 21 Related Posts

Login

Login User Name:  

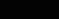
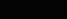
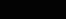

Login Password:

 [Menu]  [Login] 

If this screen is displayed during operations, enter following login user name and password

Login User Name: 2100

Login Password: 2100

Preface



This guide (A) only explains the basic operations of the machine.
 For other information, refer to the manual (B) included on the DVD or the manual (B) available from our website.

Unpacking

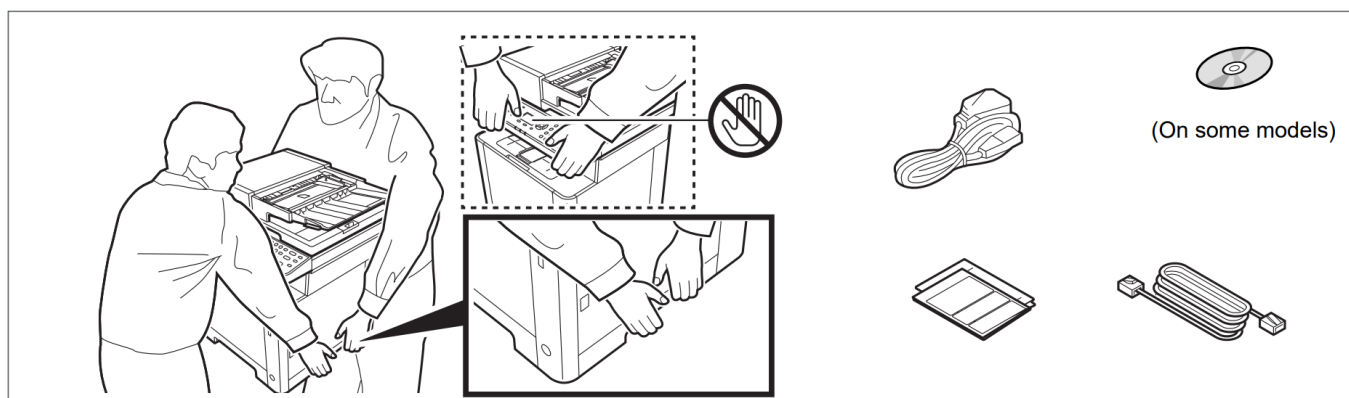

The included components differ depending on the countries or regions.

Setting up the Toner Container

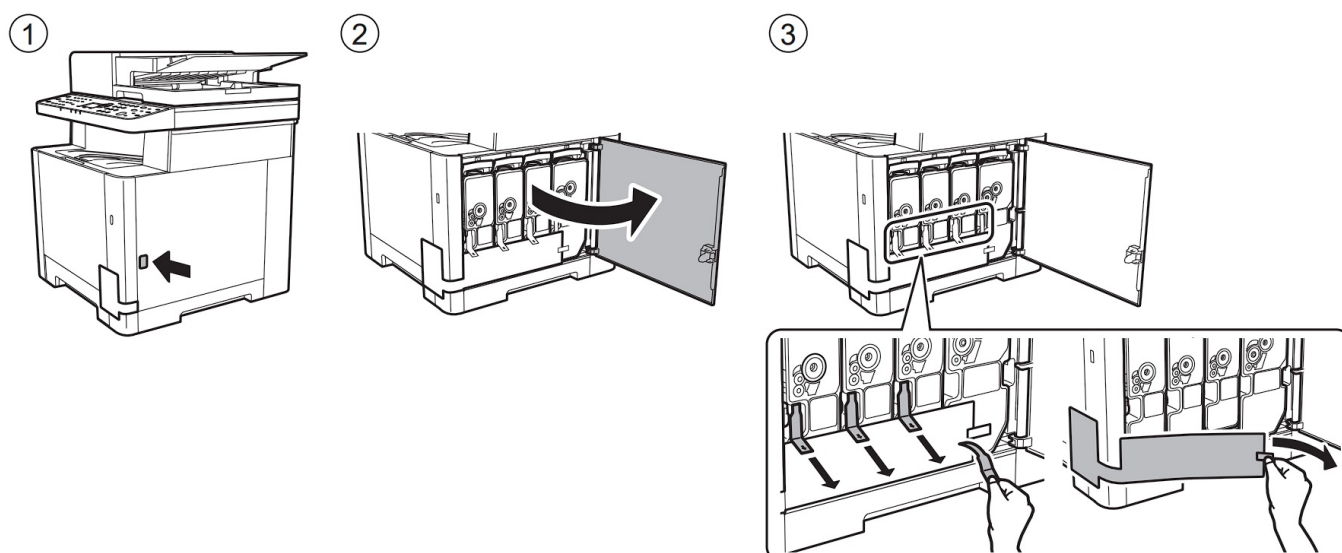

④

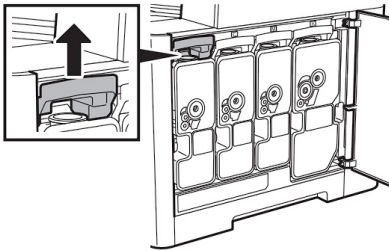

⑤

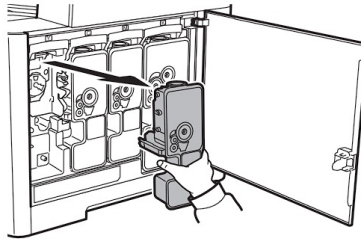

⑥

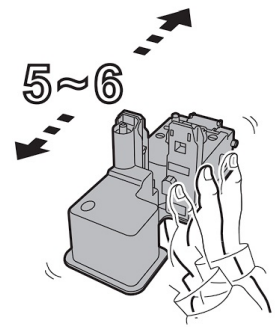

⑦

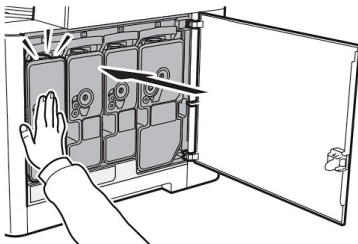

⑧

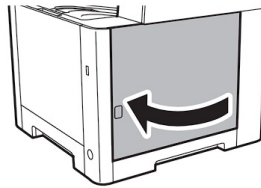

Connect Cable

Network

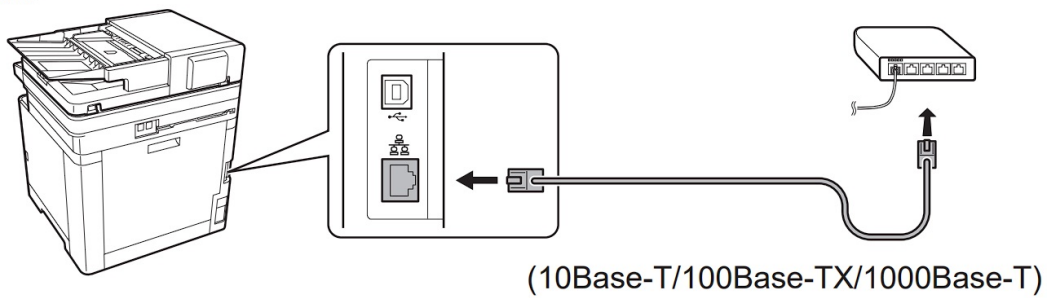

USB

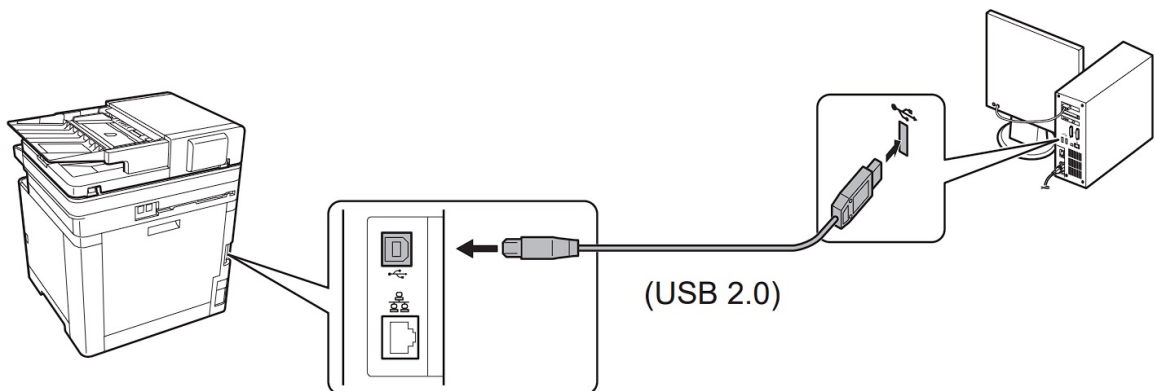

FAX

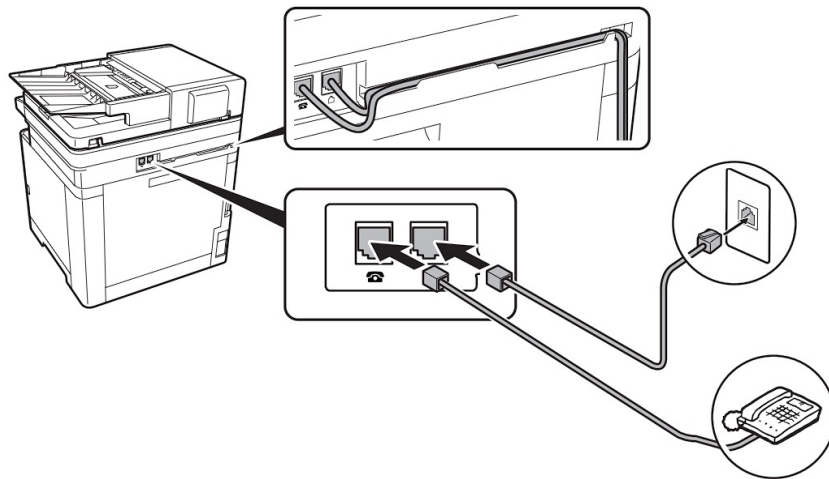

Loading Paper

①

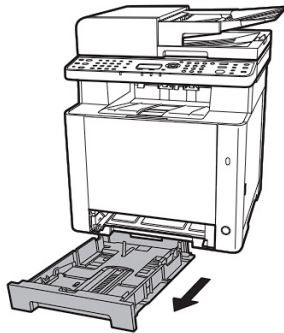

②

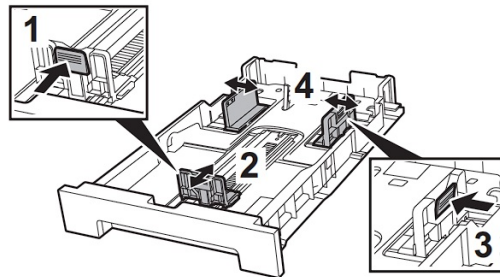

③

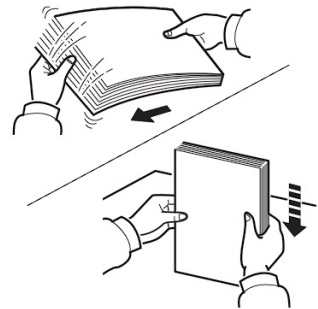

④

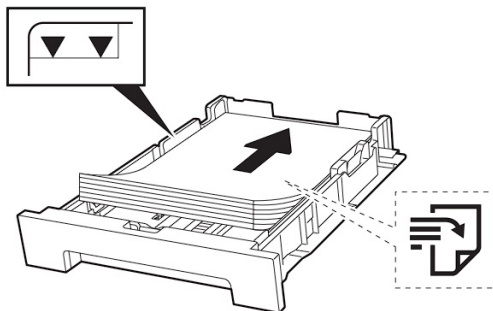

⑤

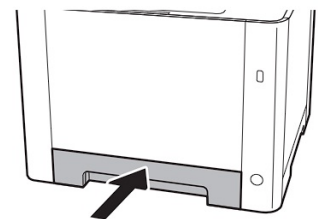

Connect Power Cord

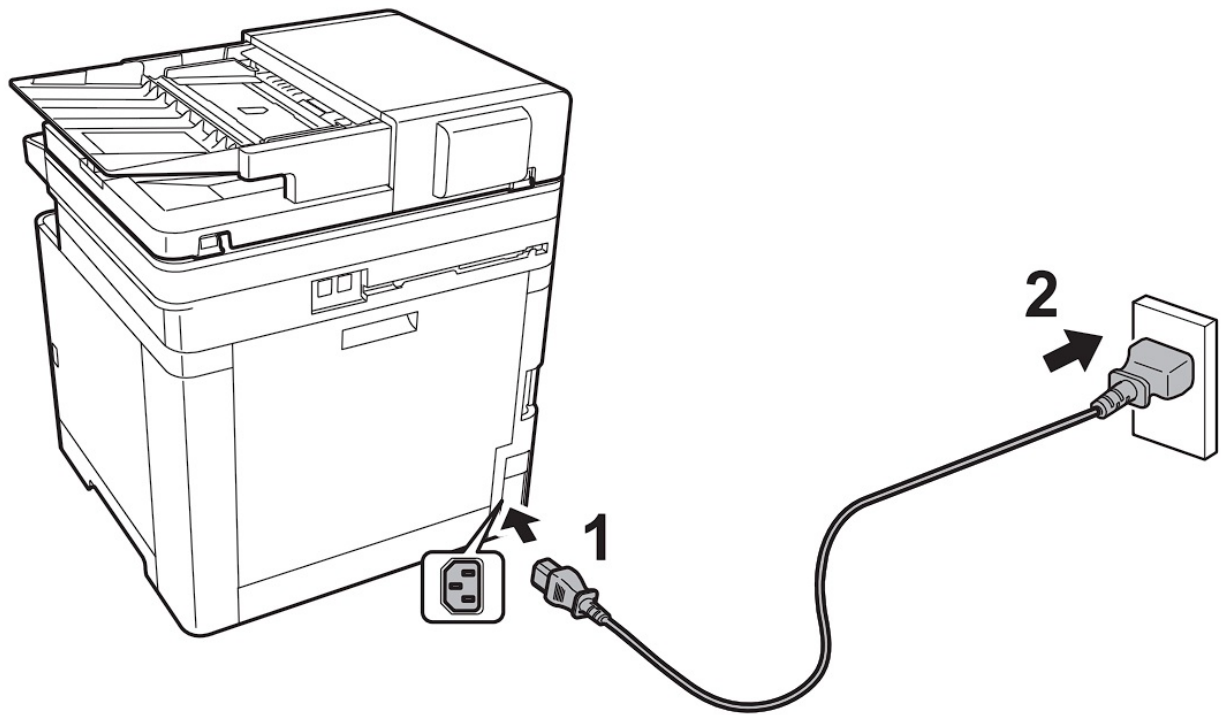

Replace Operation Panel Sheet

①

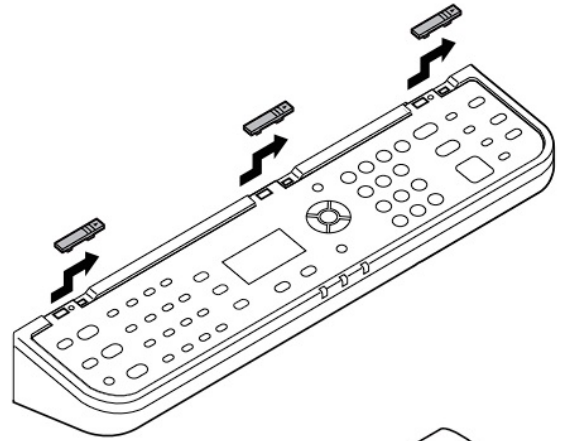
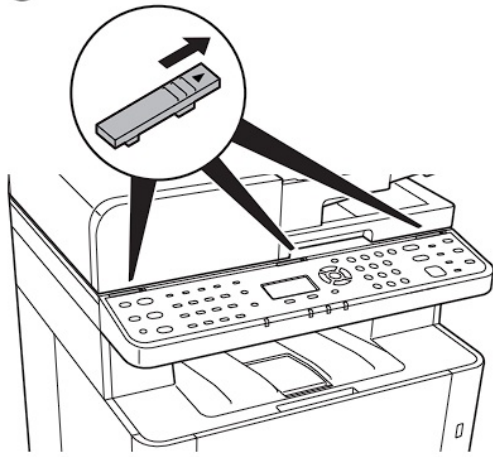

②

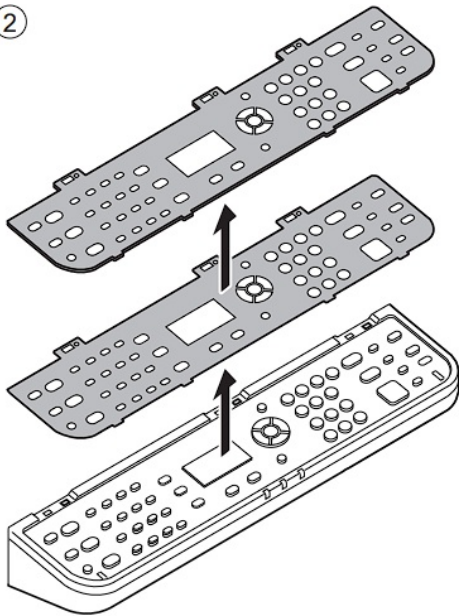

③

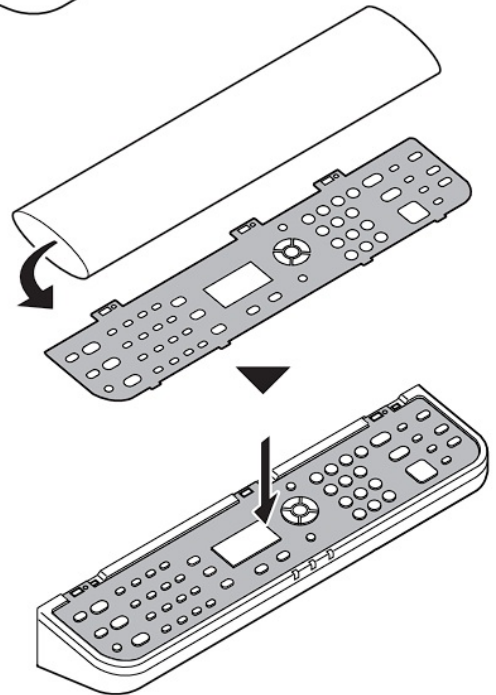

④

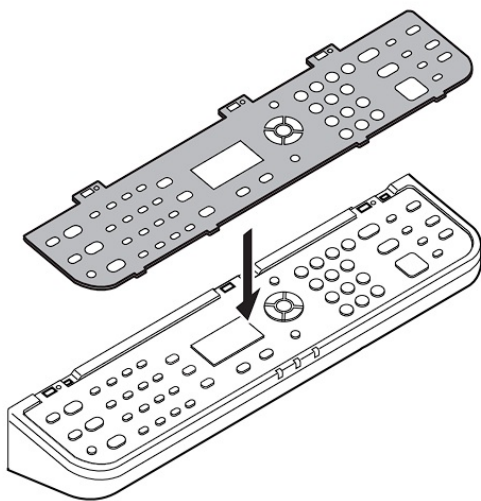

⑤

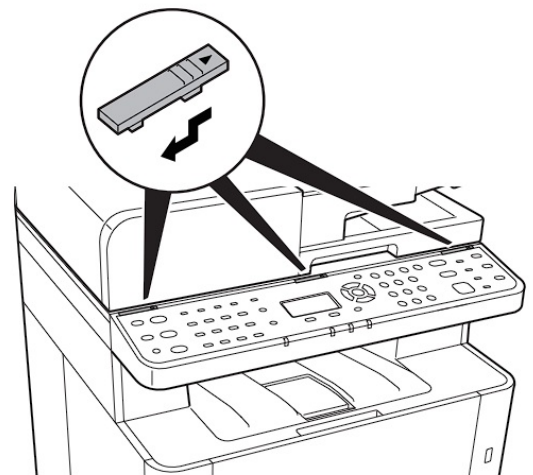

Power On

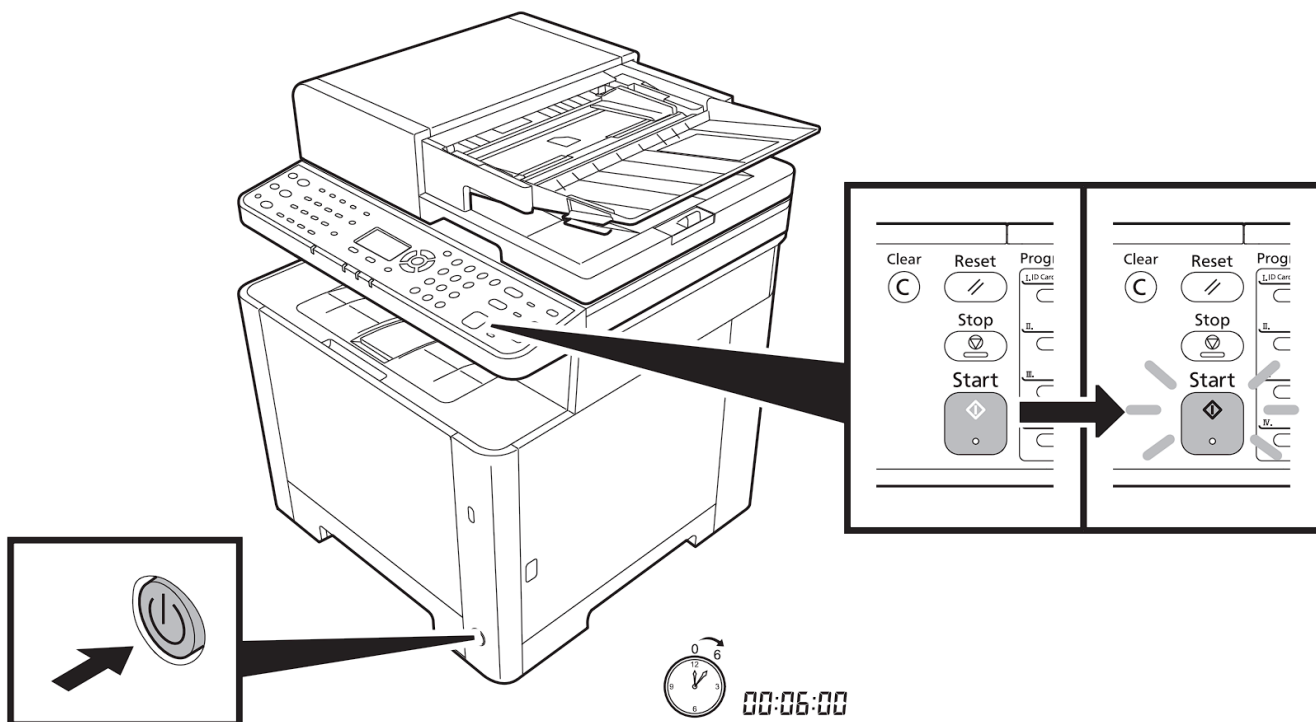

At the first time when turning on the main power switch, the machine runs Startup Wizard to set the following:
 Language > Managed by Admin...
 Follow the instructions on the operation panel.

Altitude Adjustment (1000m or higher Only)

1

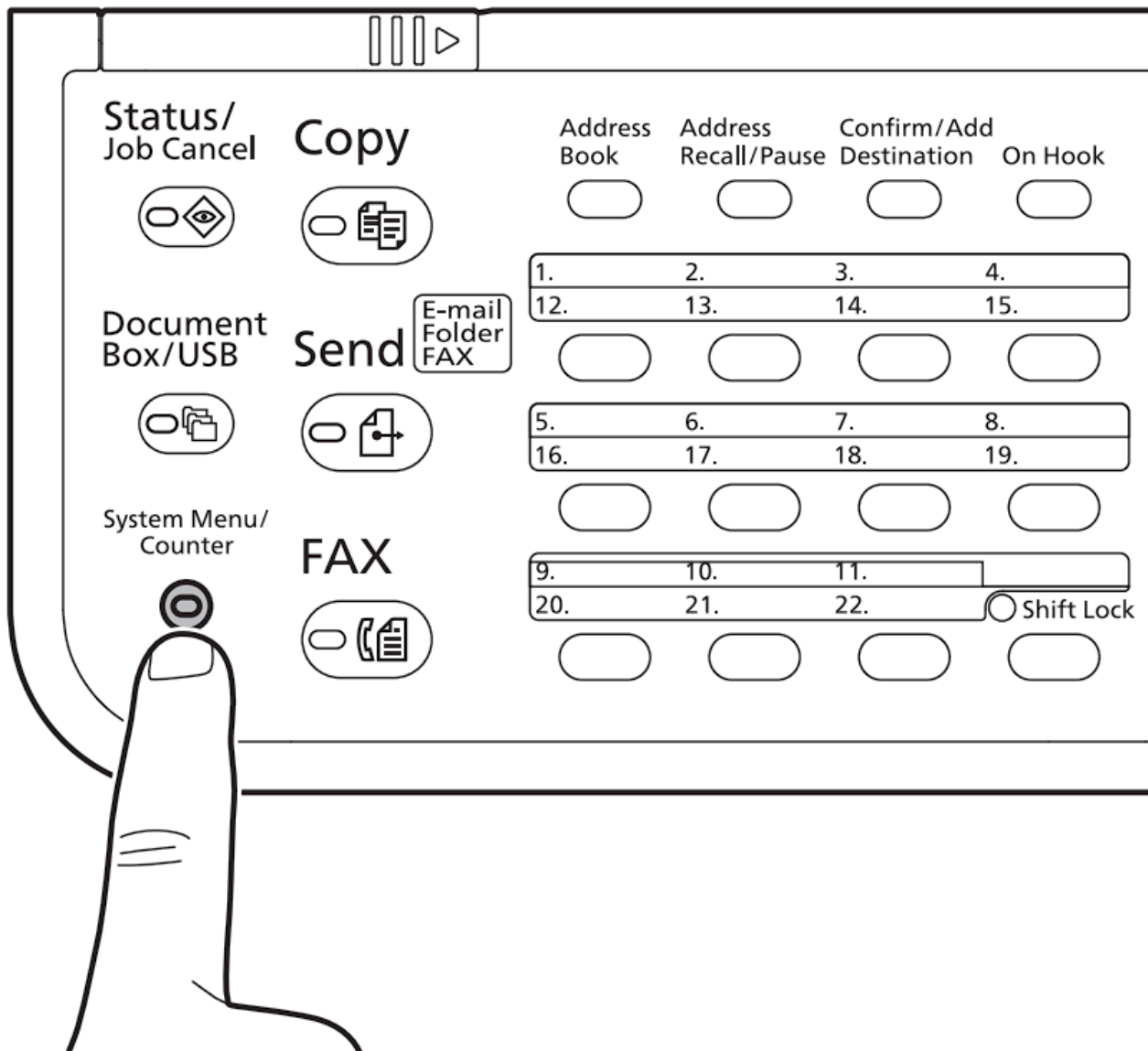

2

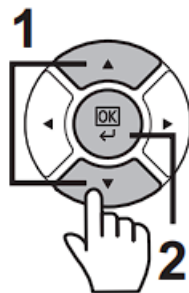
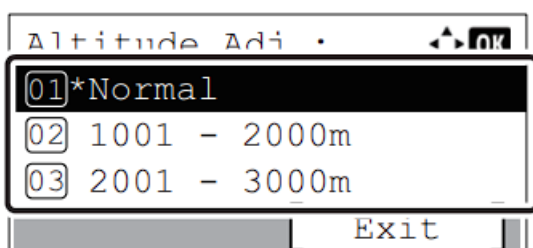
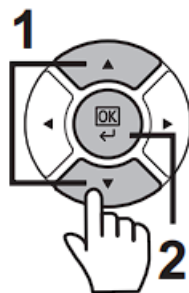
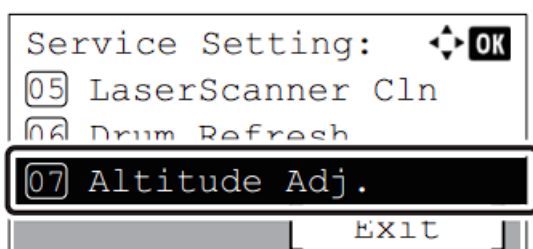
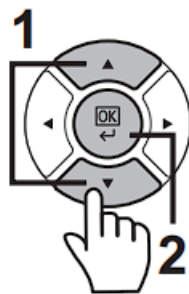
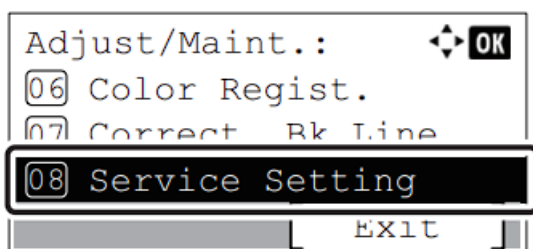
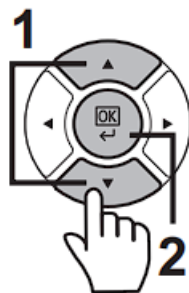
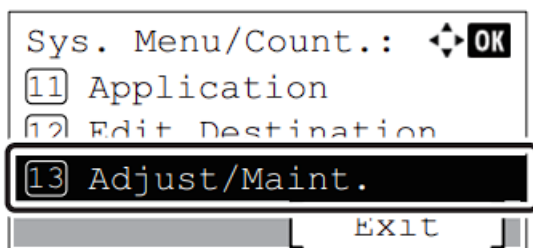

Print Status Page

1

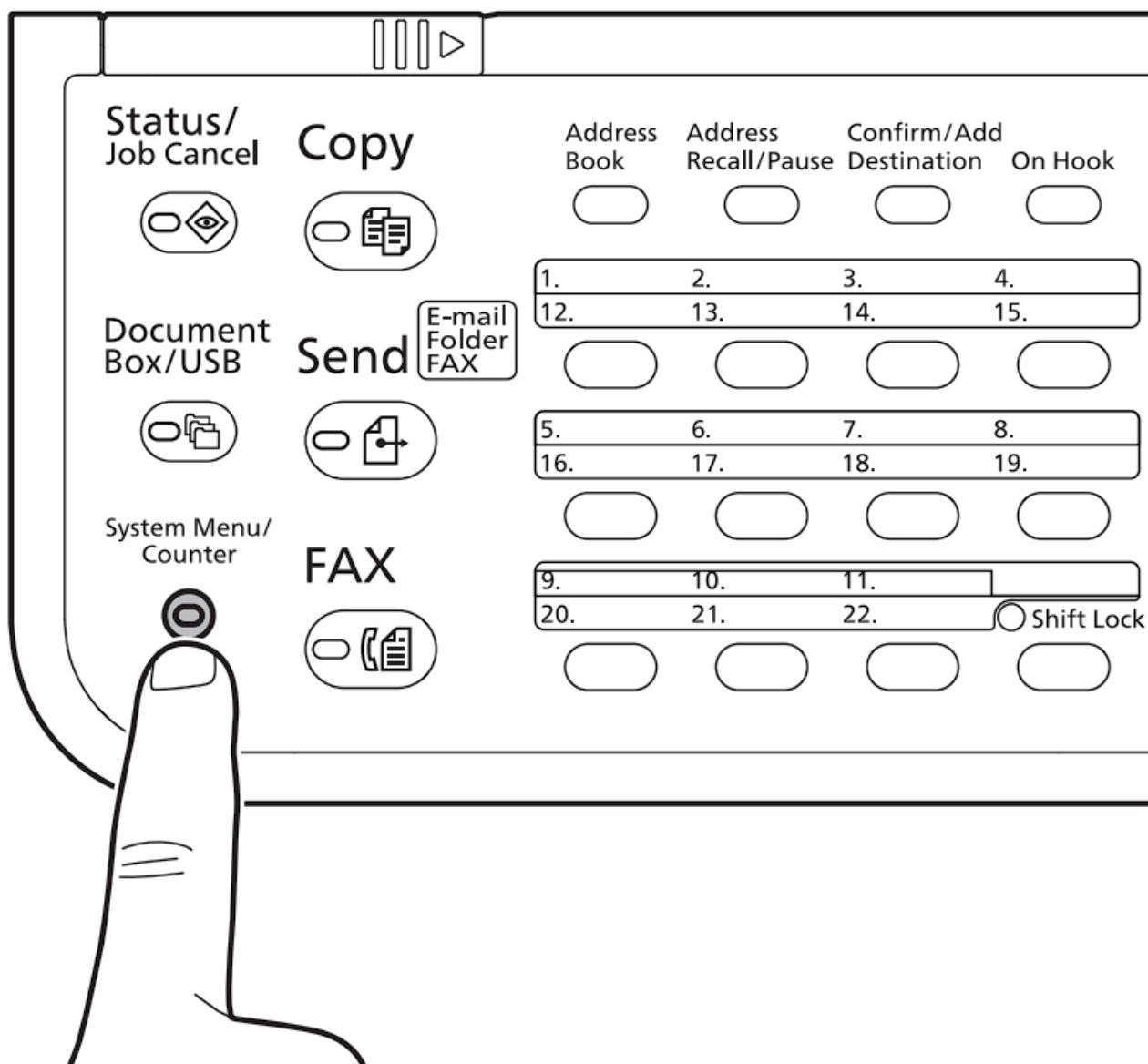

2

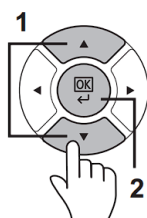
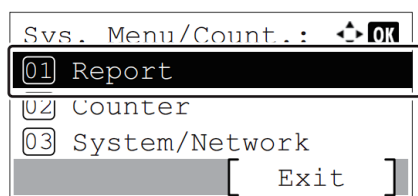

[Report]

3

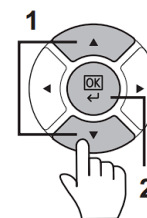
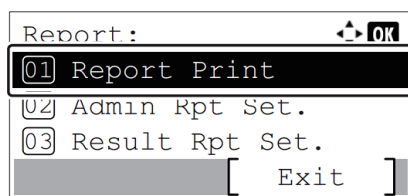

[Report Print]

④

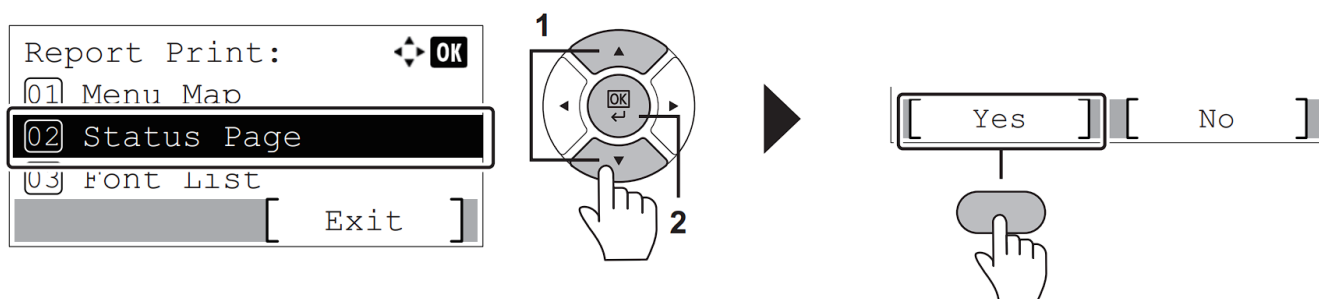

[Status Page]

[Yes]

Install Drivers and Utilities

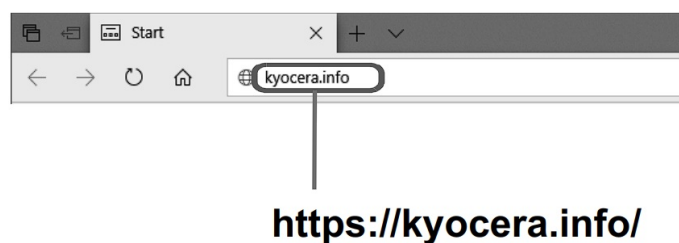
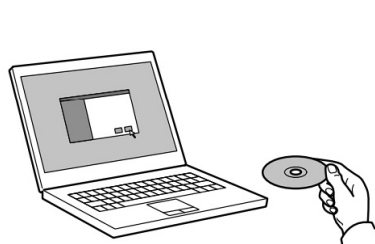

Install the software using the installer either from the DVD or downloaded from the above URL.
Follow the instructions on screen to install.

Cancelling

Copy/Scan

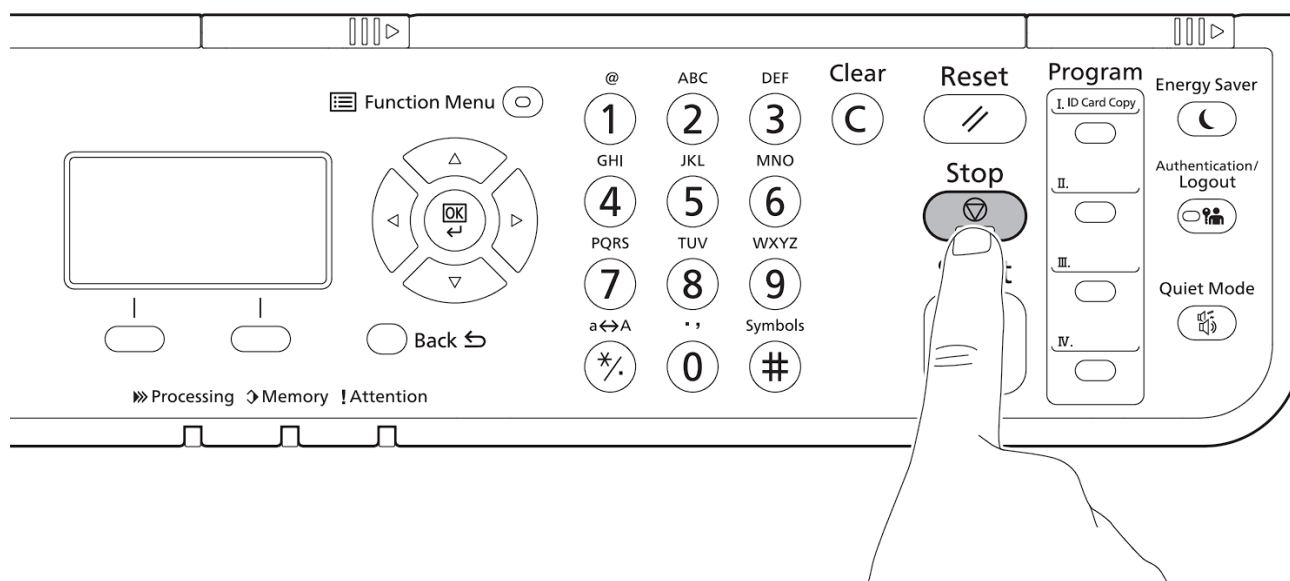

Print

①

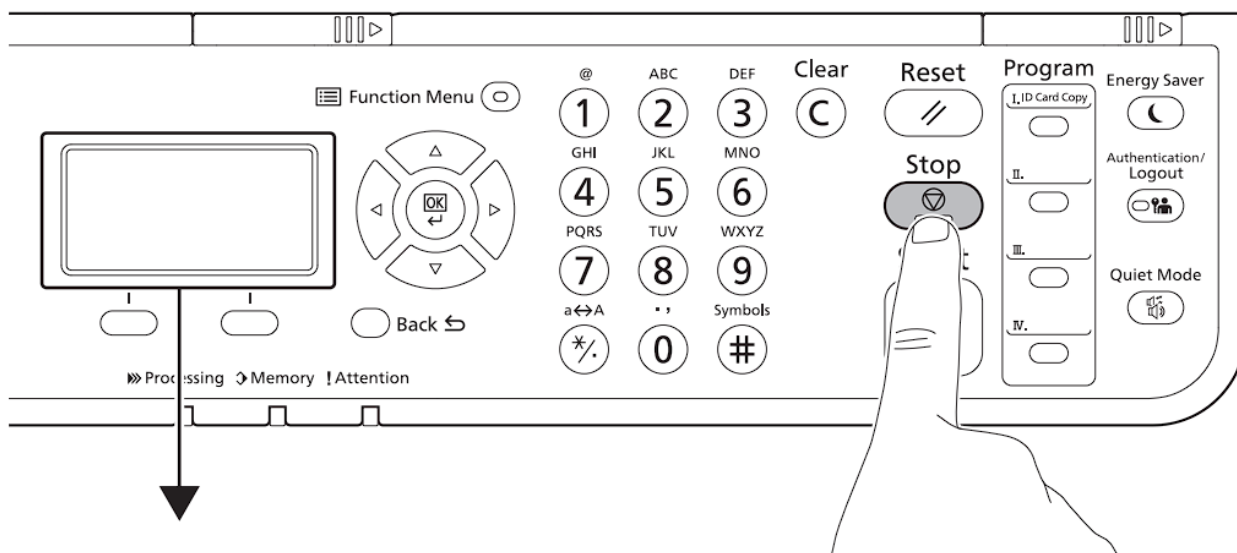

②

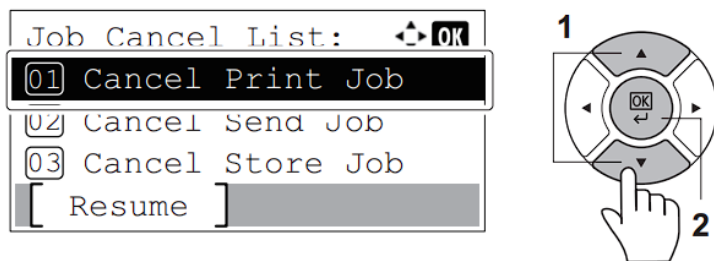

[Cancel Print Job]

③

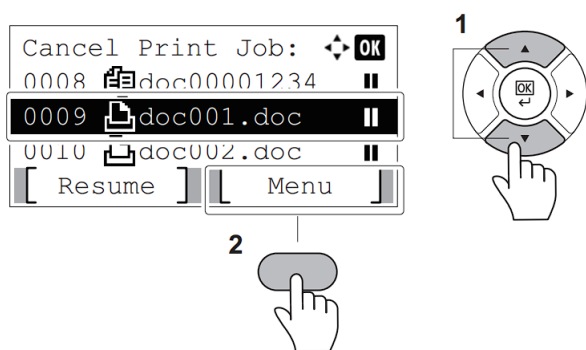

④

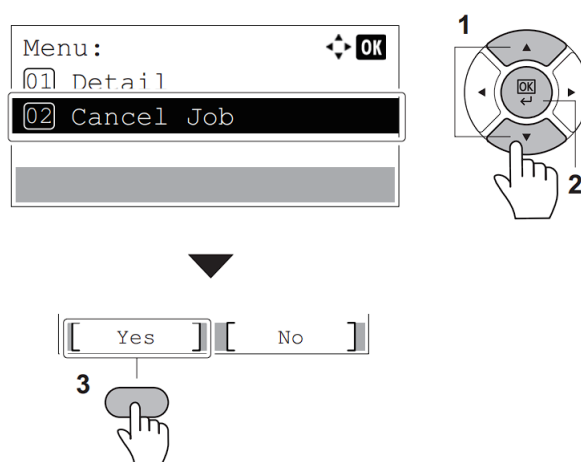

Select the job you want to cancel. > [Menu]

[Cancel Job] > [Yes]

Copy

1

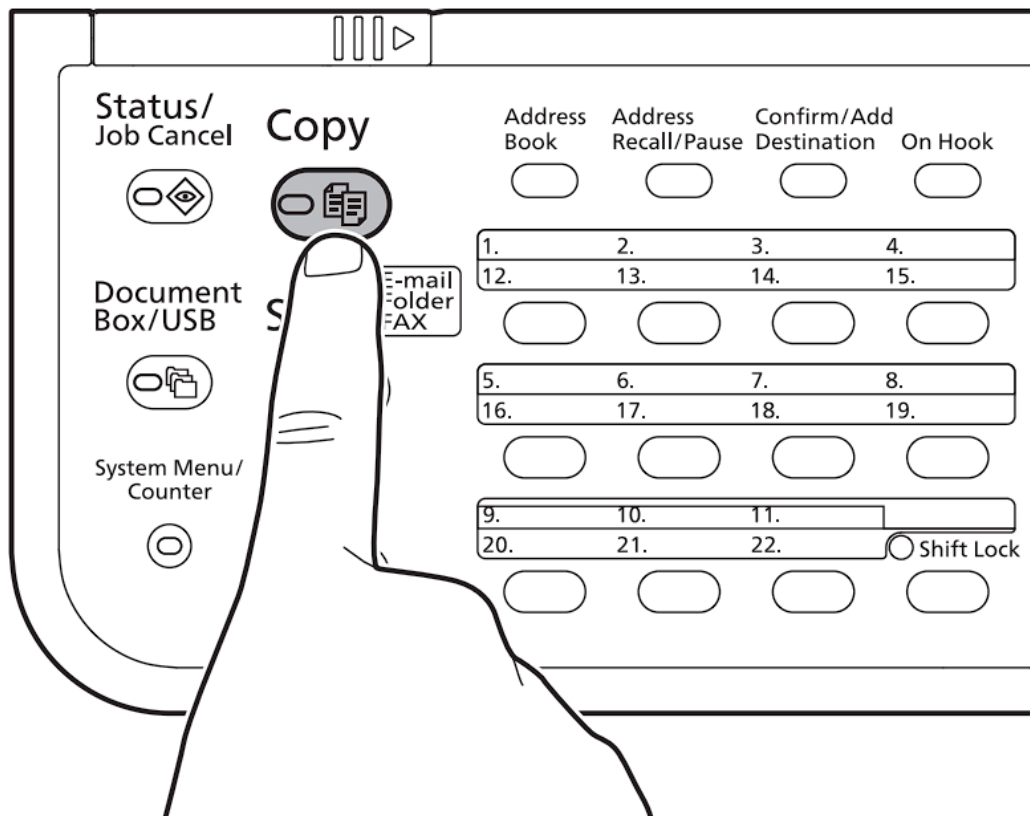

2

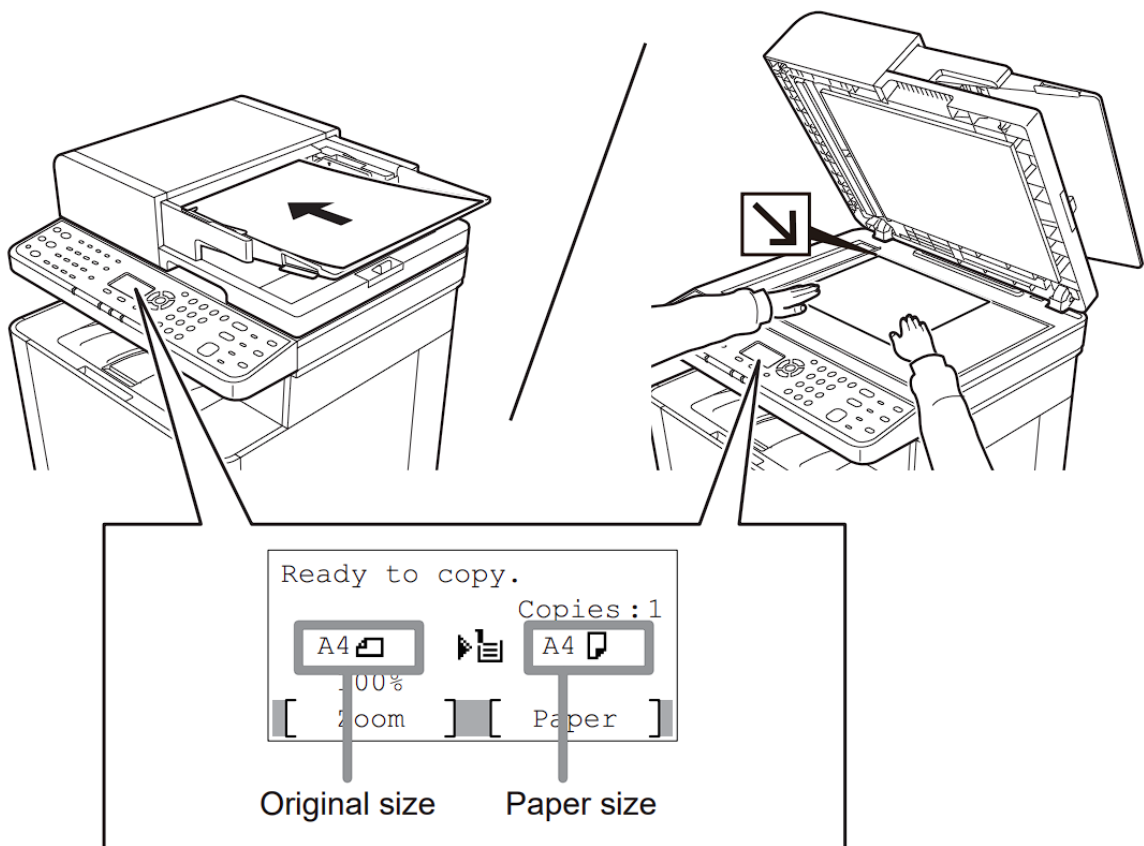

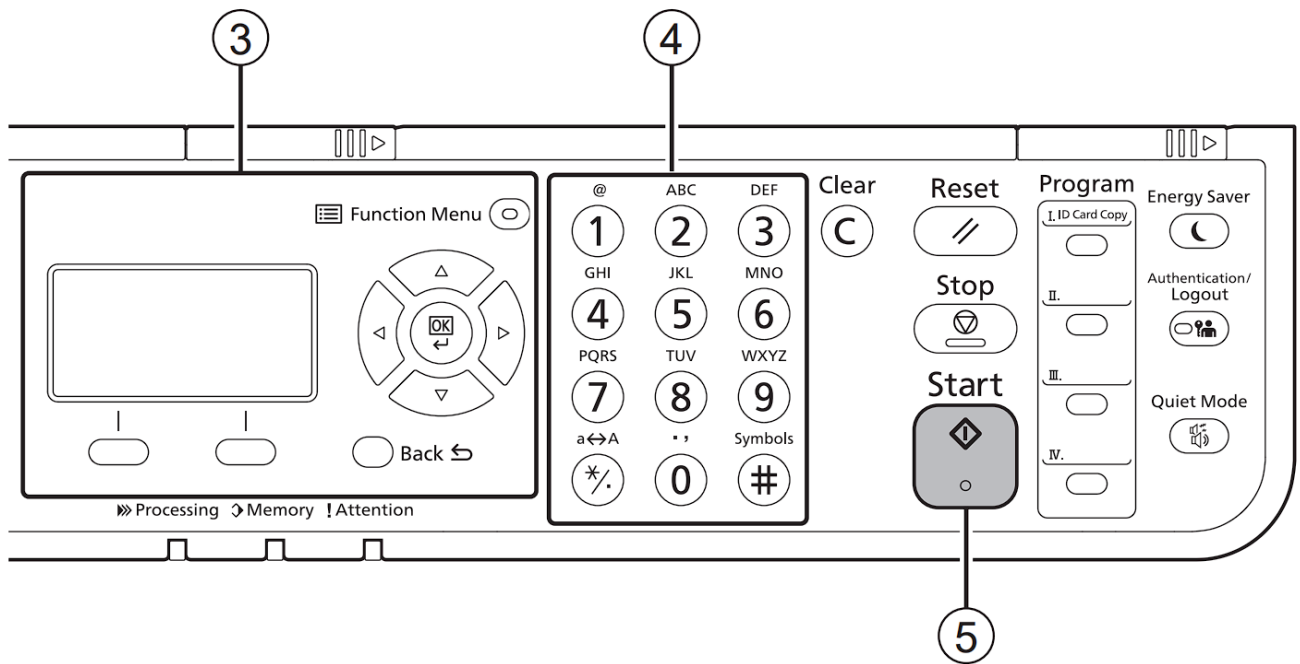

Scan (E-mail)

Setup

Launch your Web browser.

2

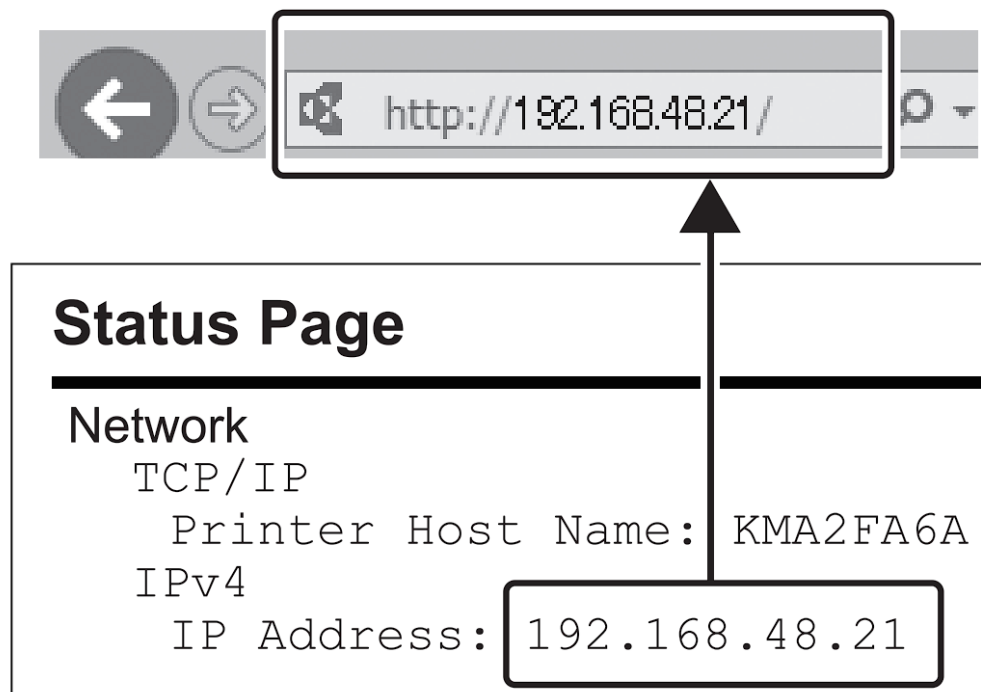

In the Address or Location bar, enter the machine's IP address or Printer Host Name.

3



Enter "Admin" and log in to Command Center RX with administrator authority

From the [Function Settings] menu, click [E-mail].

Set SMTP Protocol [On], and then enter the following items.

- SMTP Server Name
- E-mail Size Limit
- Sender Address

Send

1

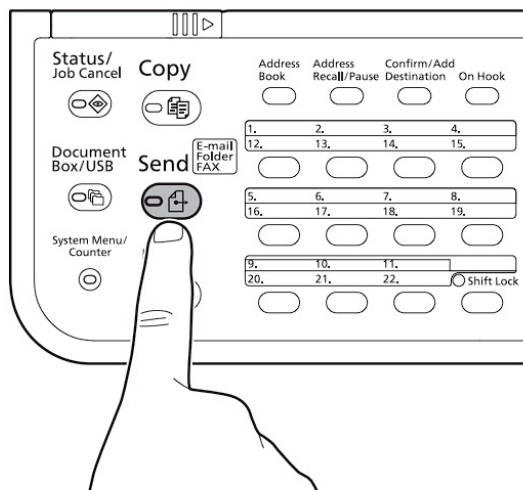

2

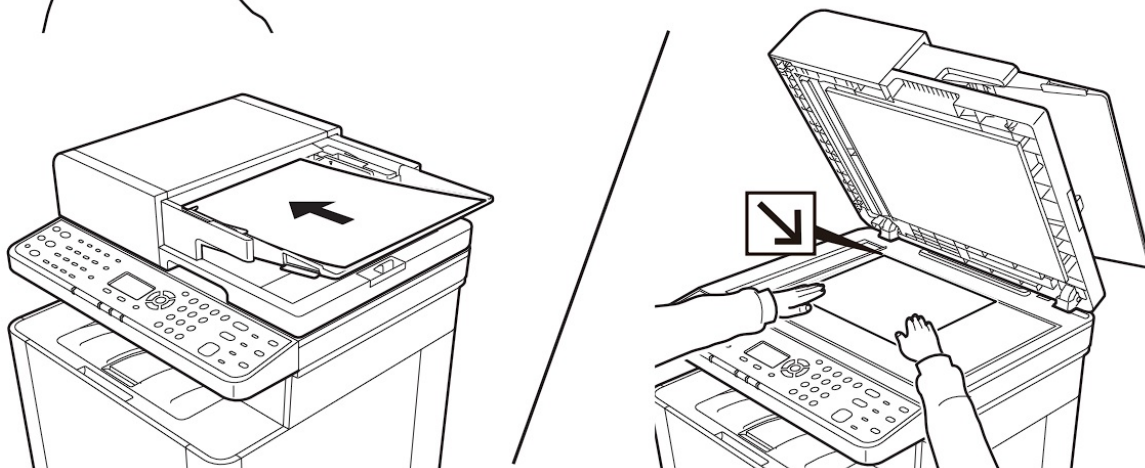

3

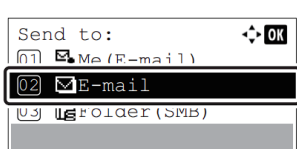

[E-mail]

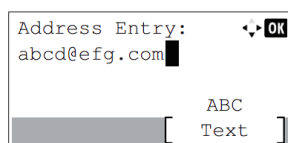

Enter the E-mail address.

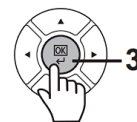

4

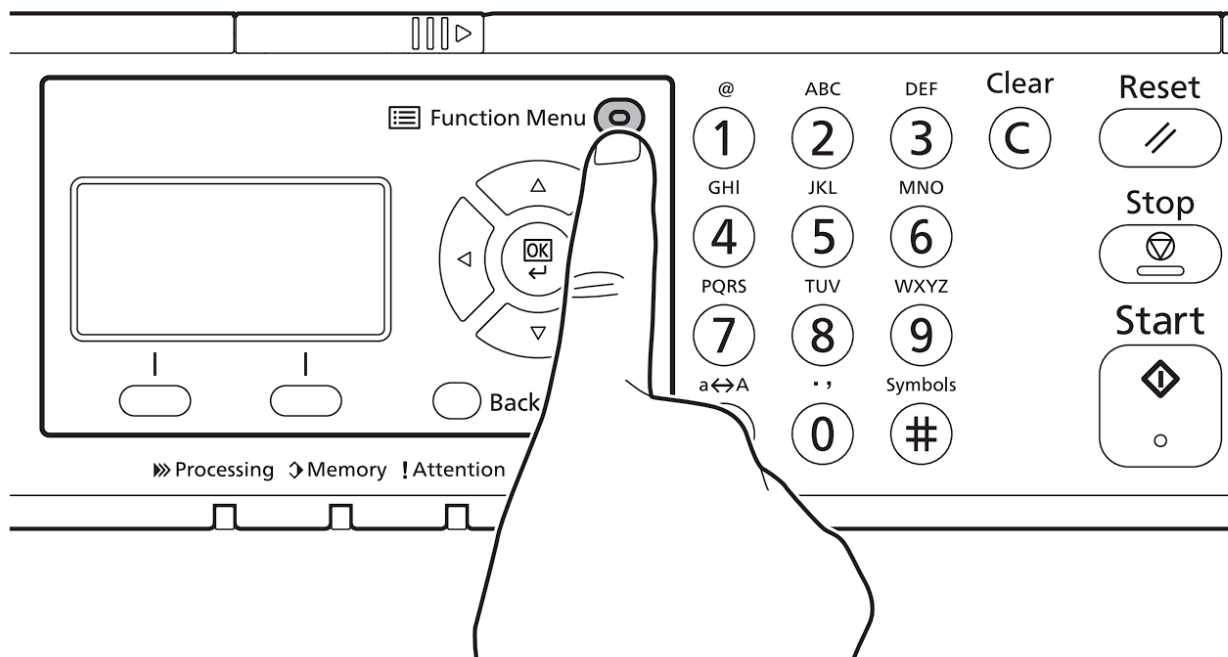

5

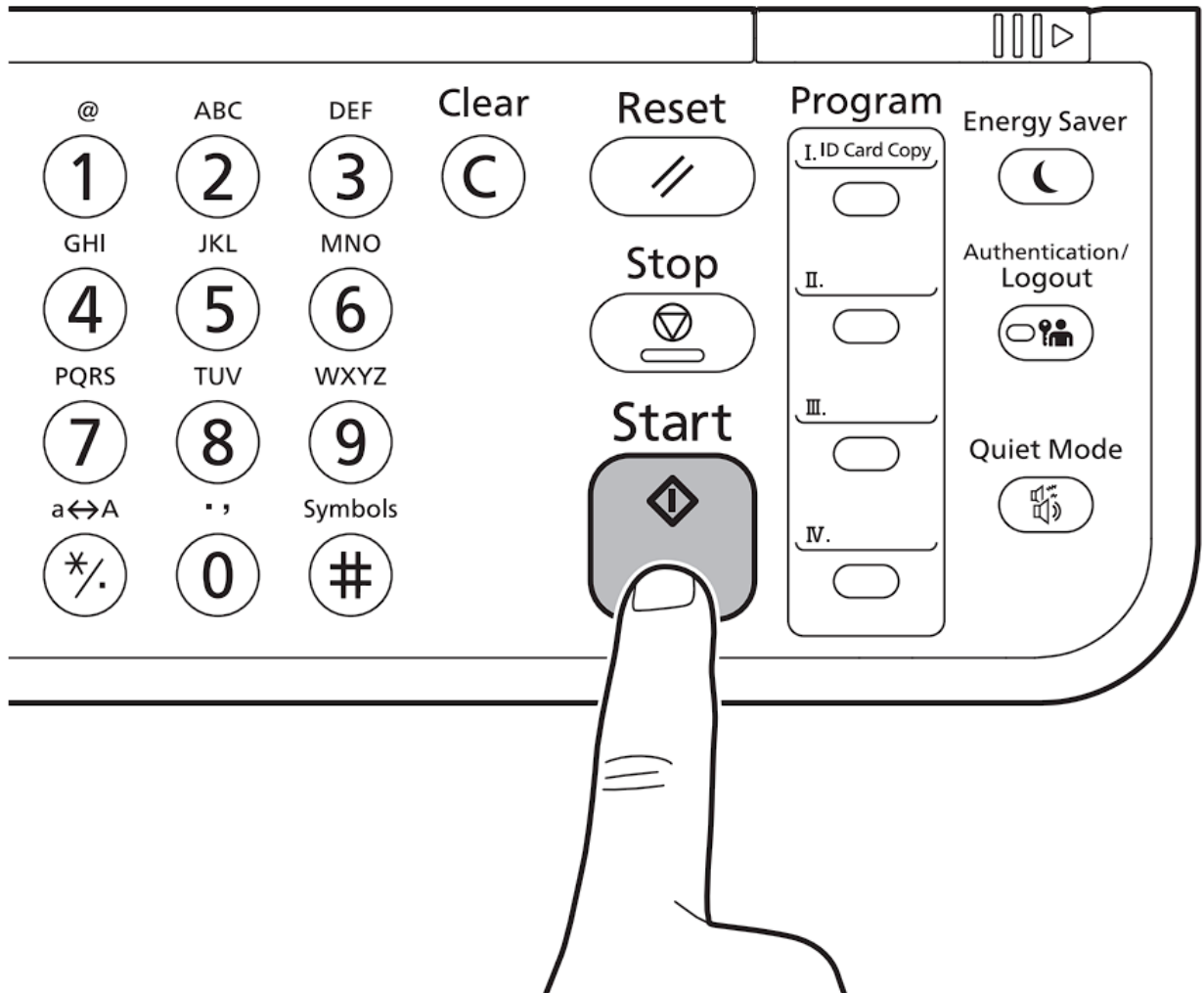

FAX

1

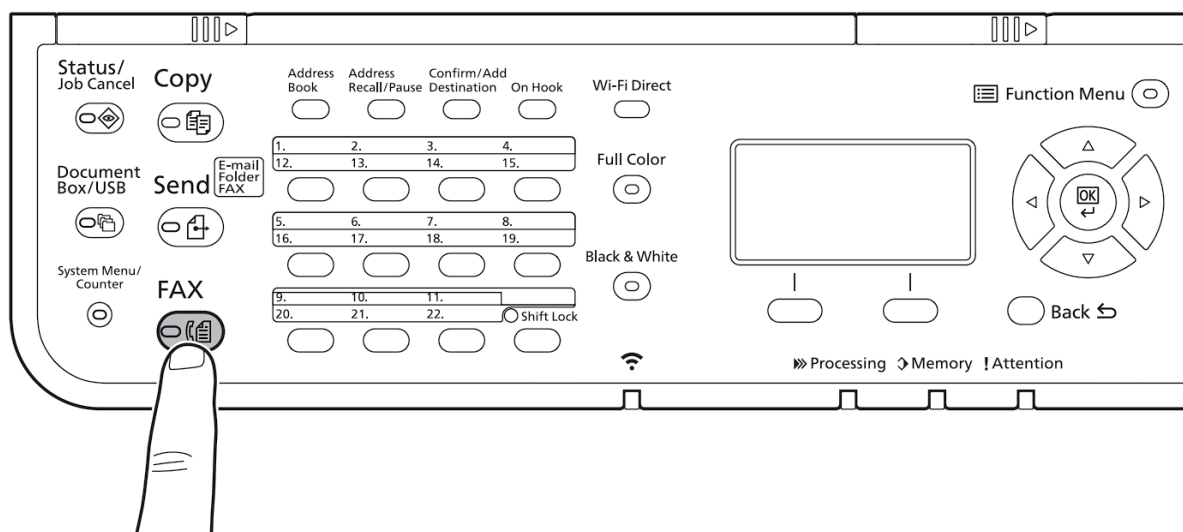

2

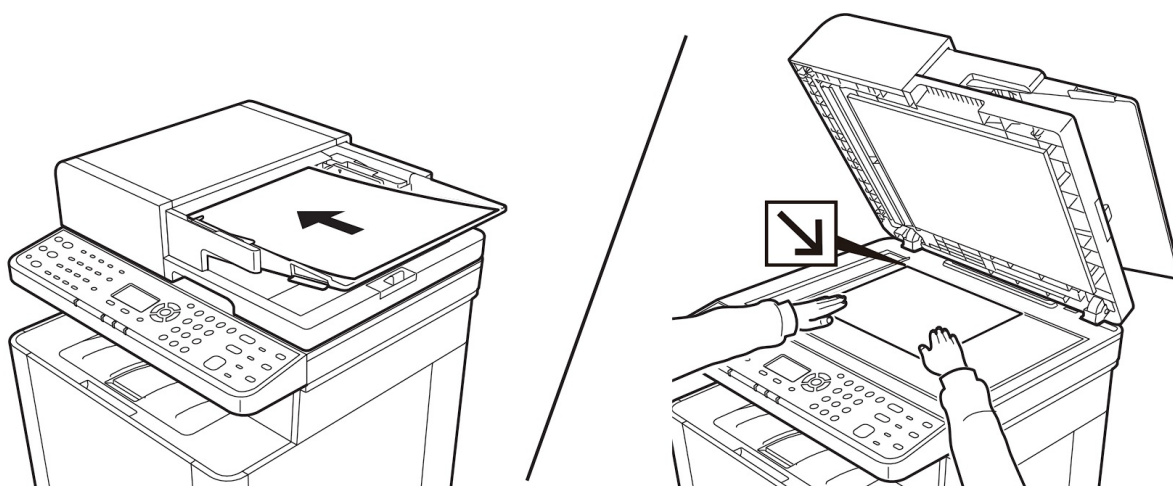

3

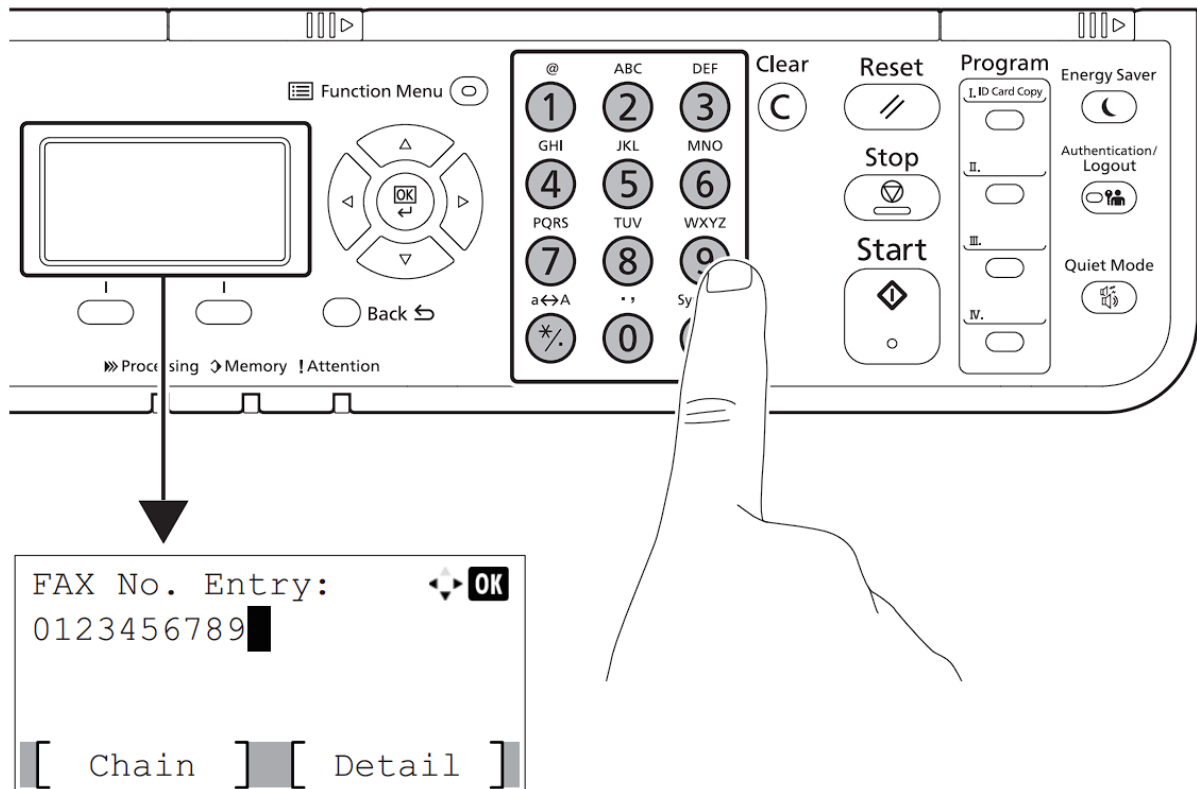

Enter the fax number.

4

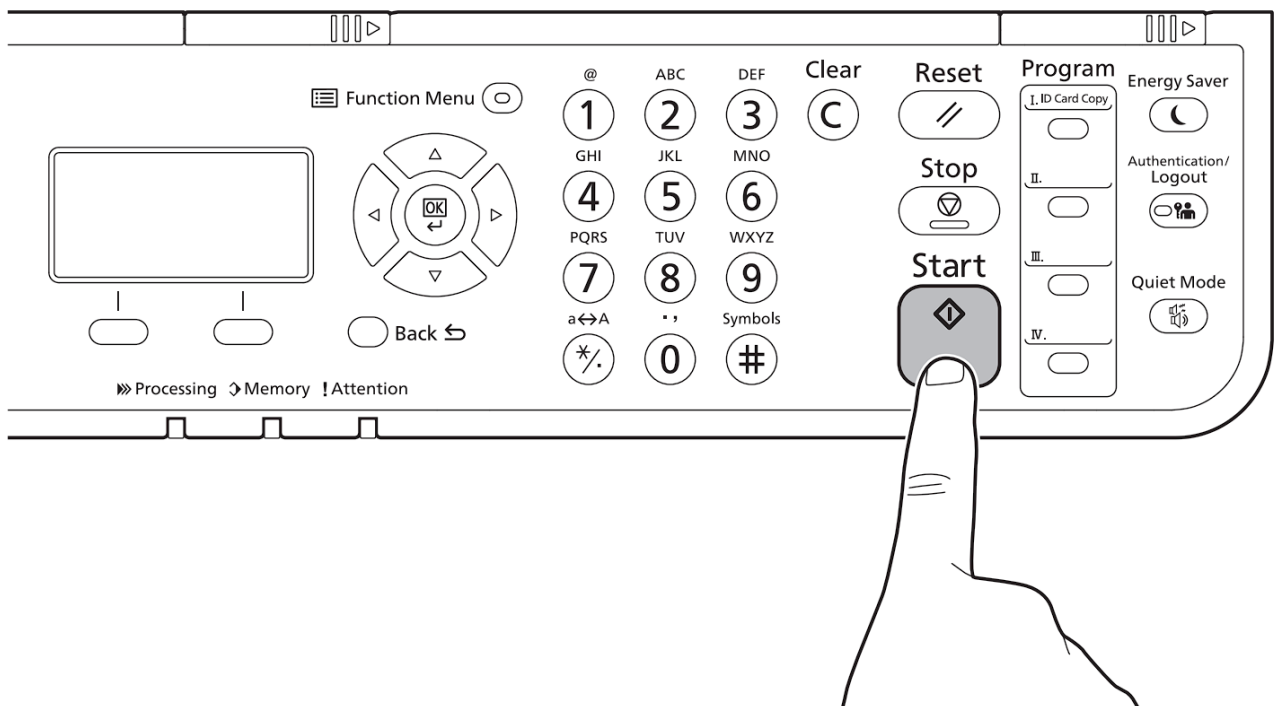

Private printing

From a PC

1

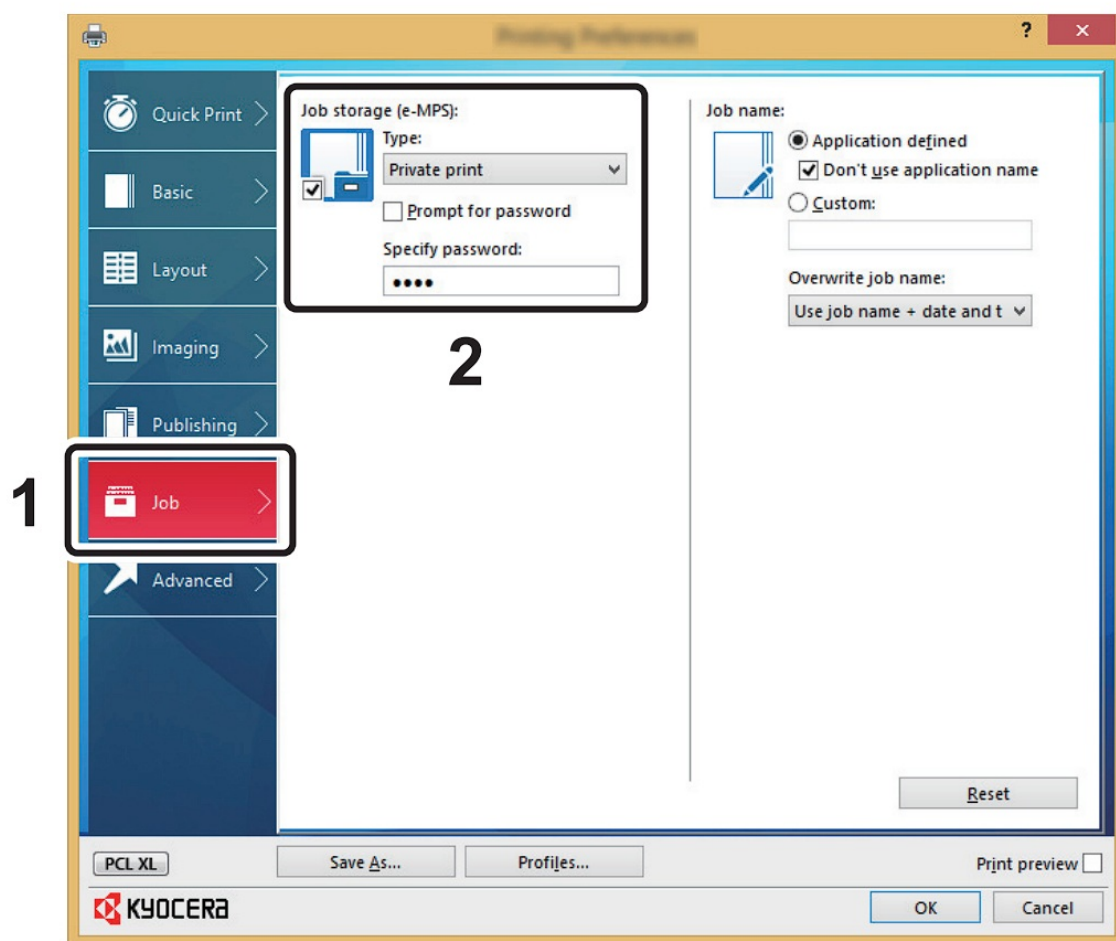

To activate the private printing from the PC, set the items No. 1 and 2 in the screen.

From the Operation Panel

1

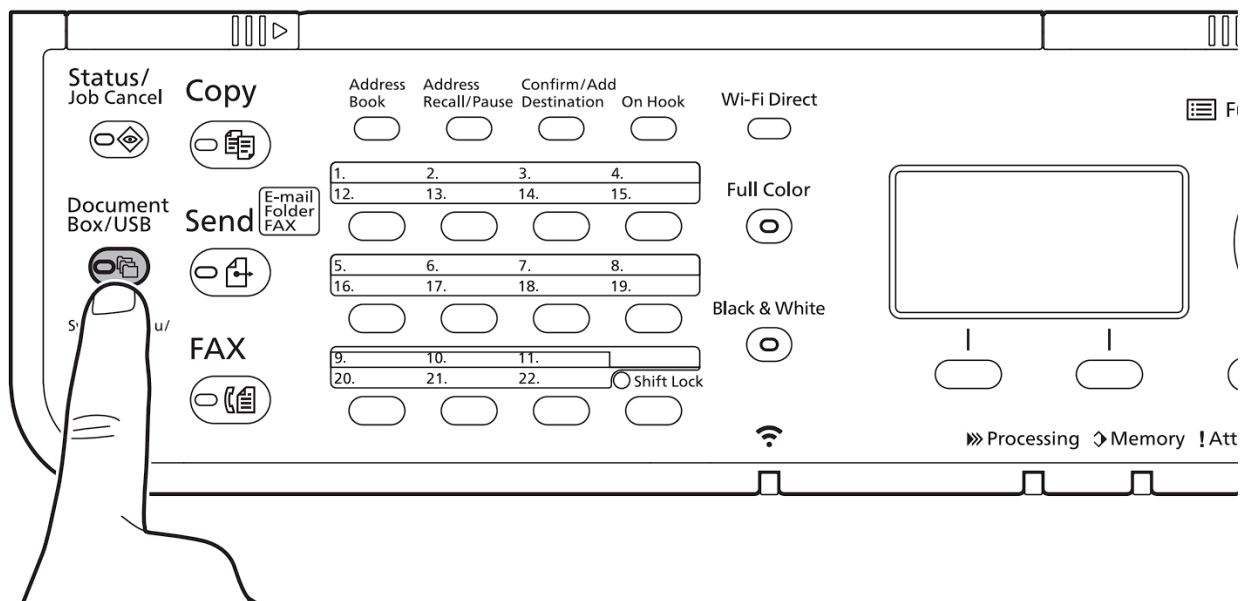

2

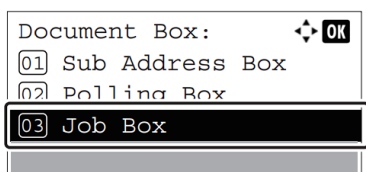

[Job Box]

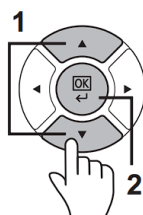

3

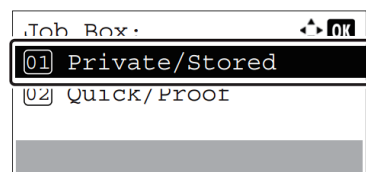

[Private/Stored]

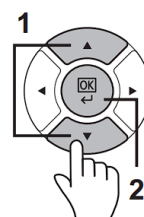

4

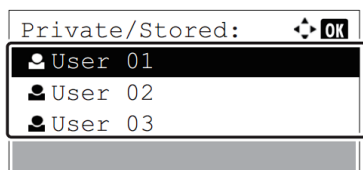

Select the user of the document.

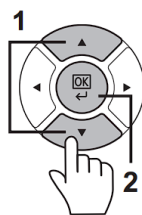

5

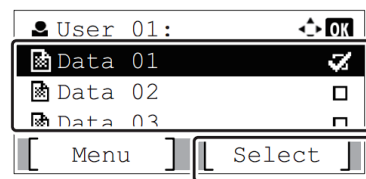

Select the document to print. > [Select]

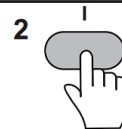

⑥

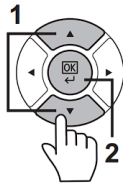
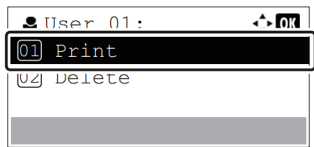

⑦

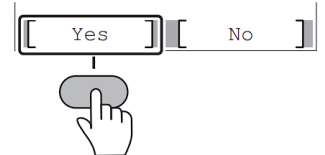
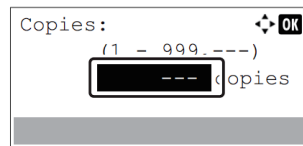

EN [Print]

EN Specify the number of copies to print as desired. > [Yes]

Troubleshooting

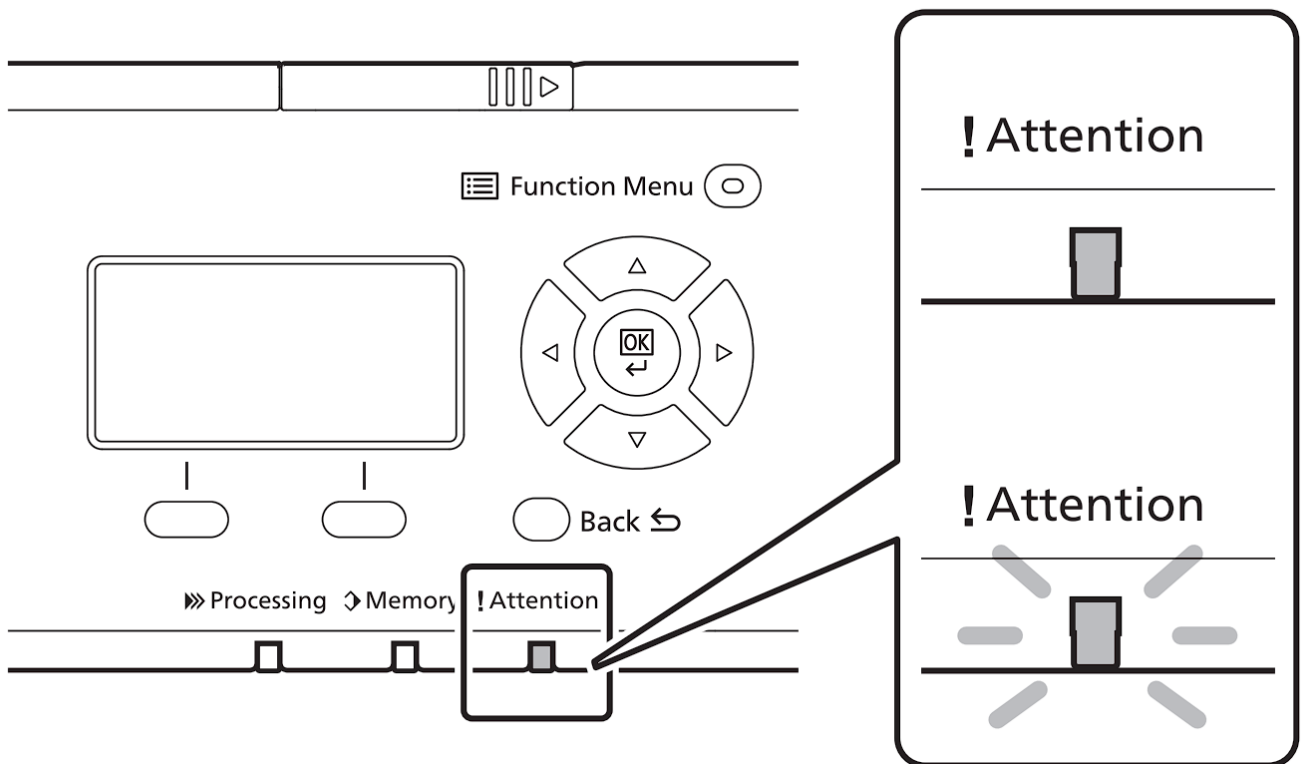

If an error occurs on the machine, the error message appears on the screen. Also the Attention indicator on the operation panel will light up or flash. Refer to the Operation Guide to Clear the error. For details, refer to the Operation Guide on the Product Library disc.

Clear Paper Jam

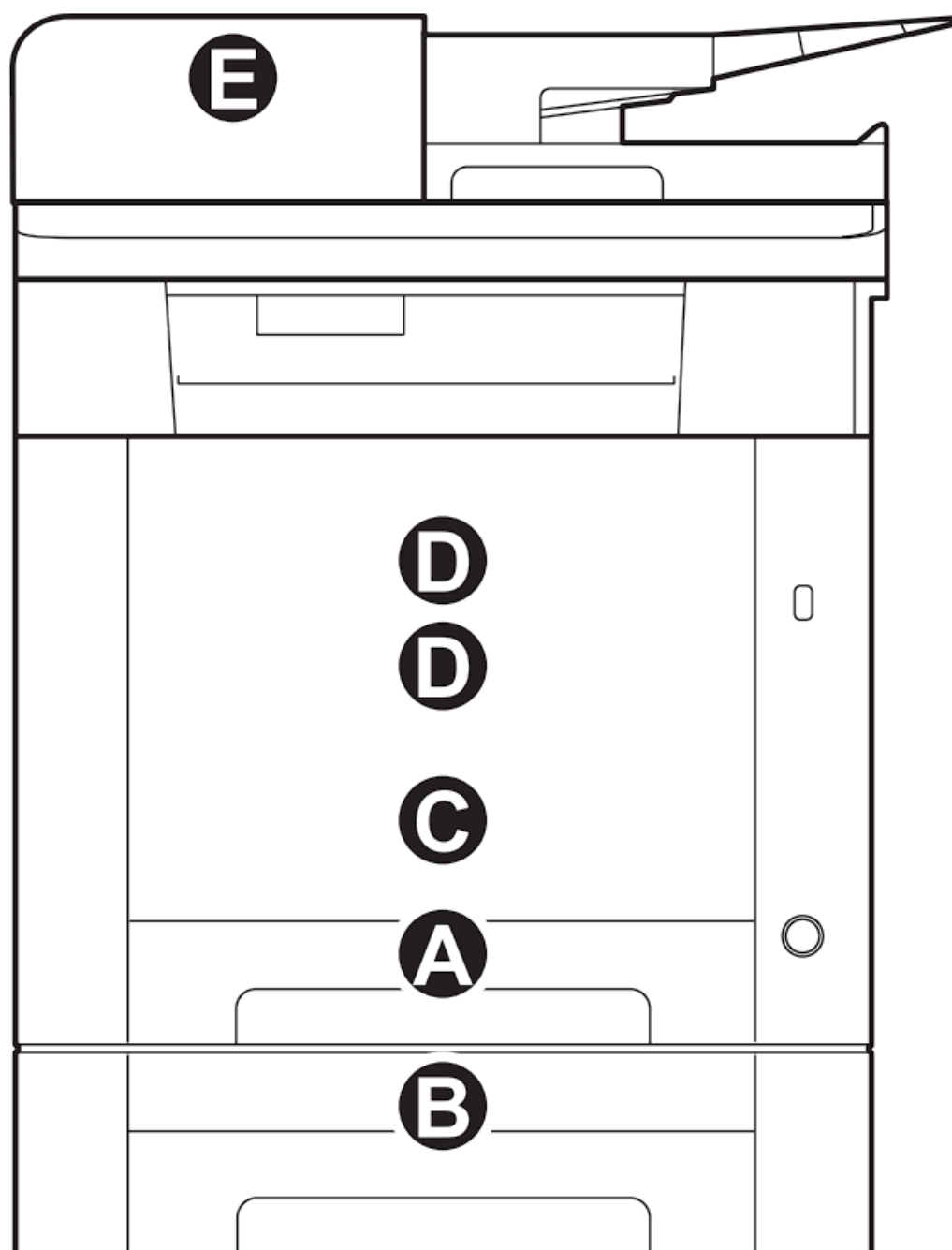

A

1

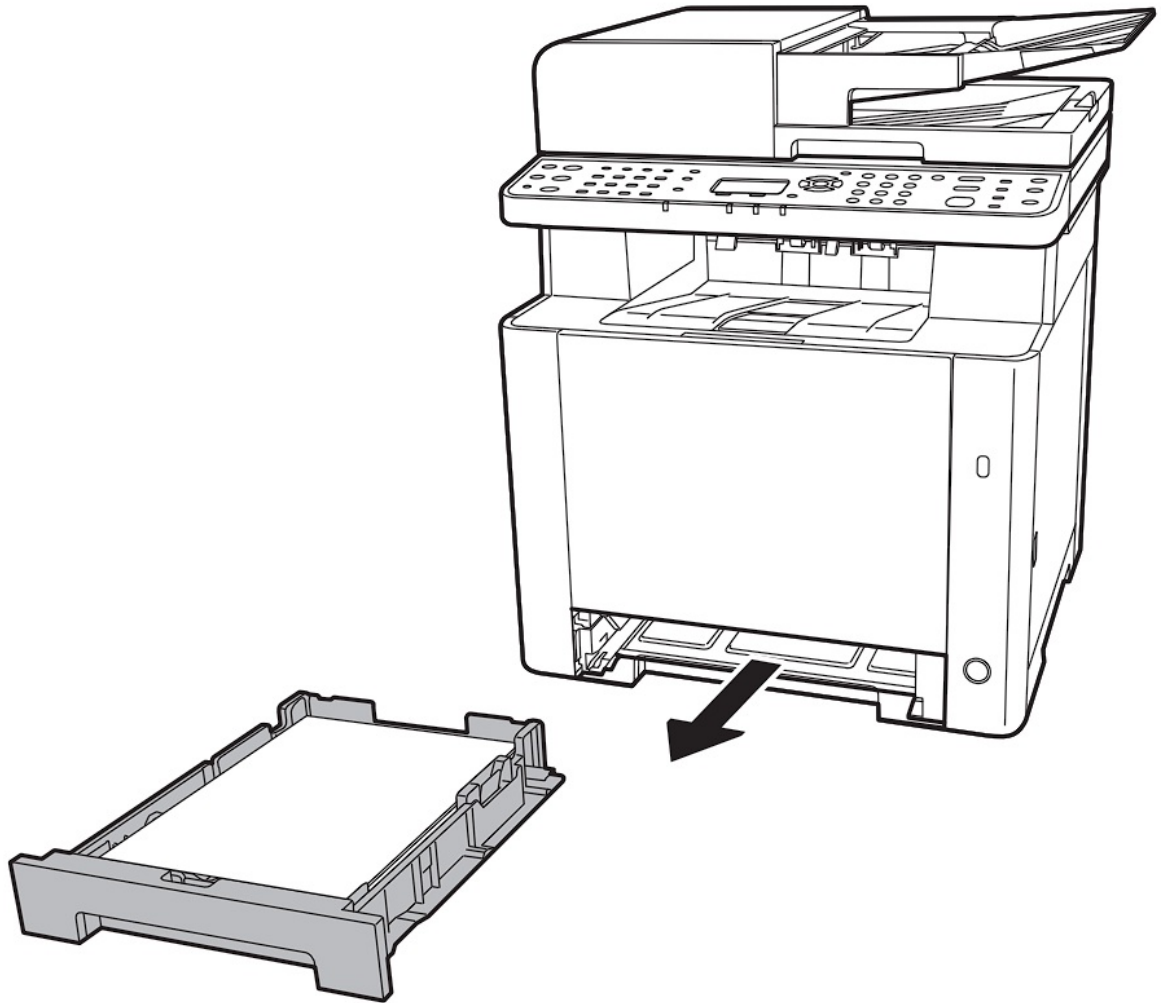

2

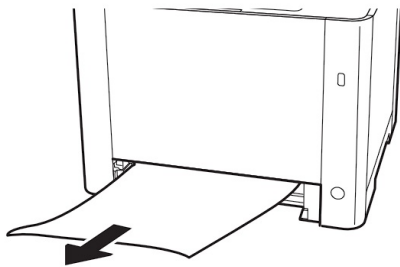

3

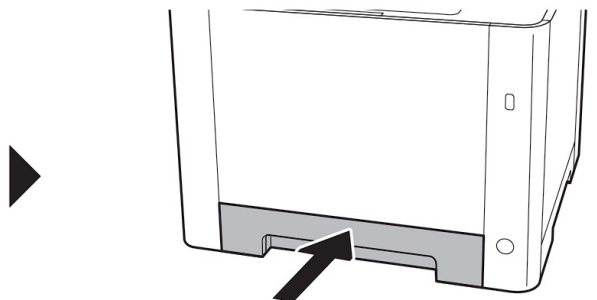
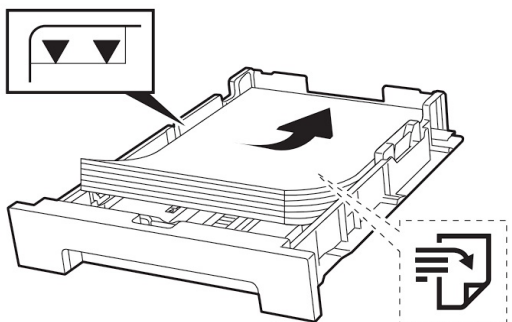

B

①

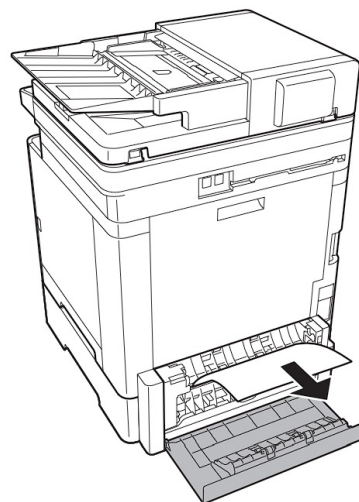
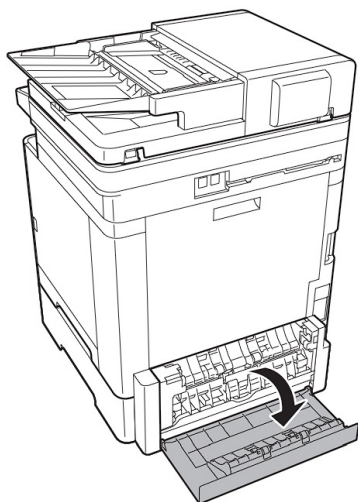

②

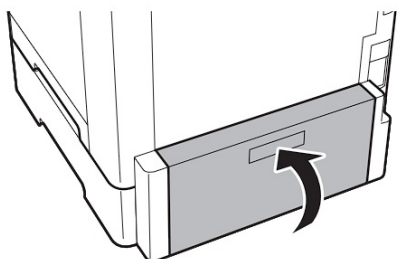

③

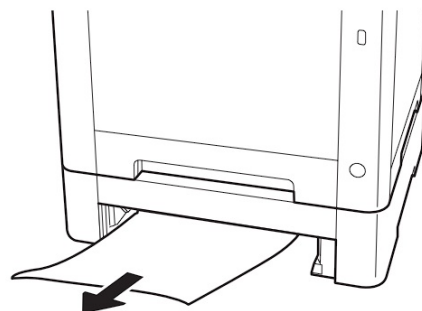
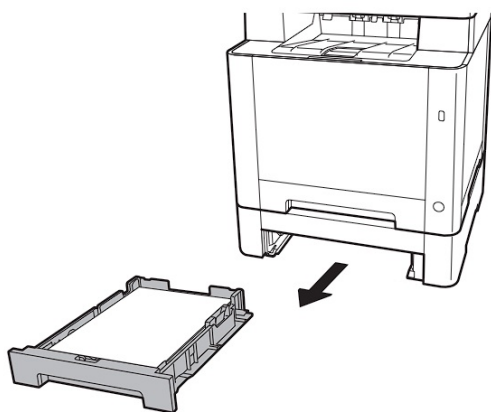

④

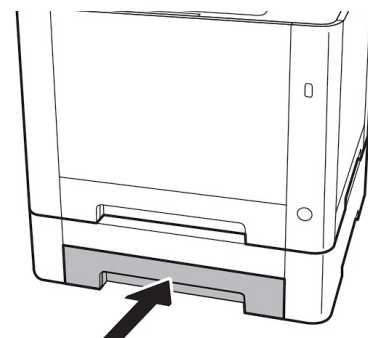
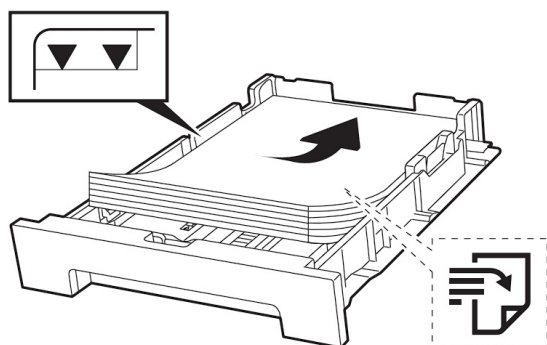

C

①

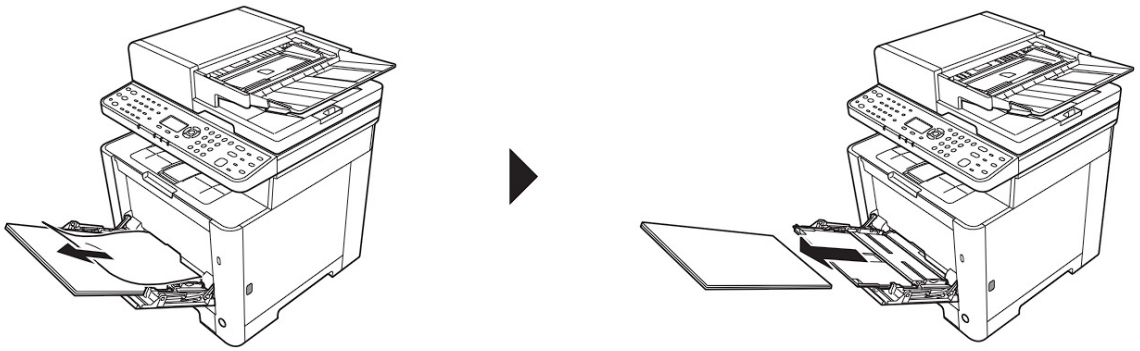

②

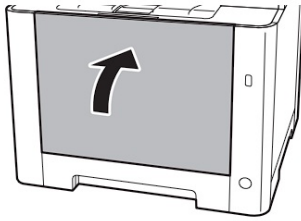

③

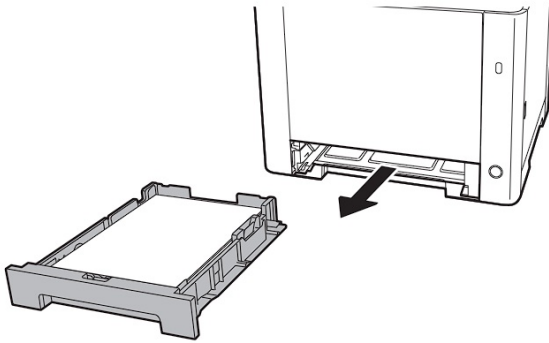

④

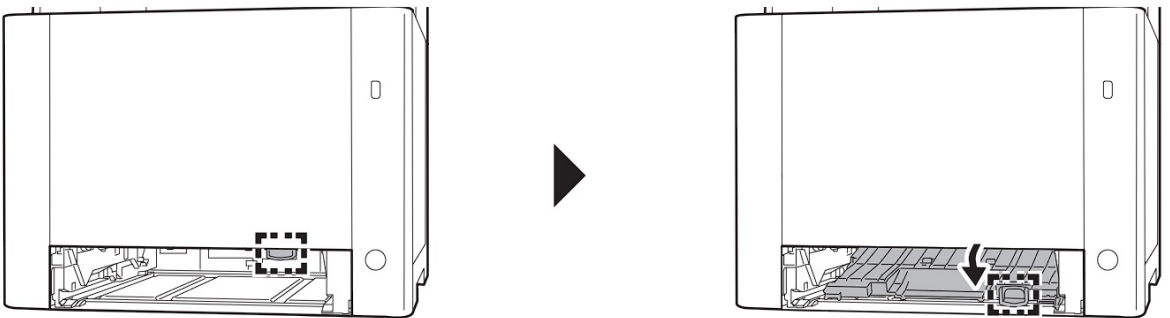

⑤

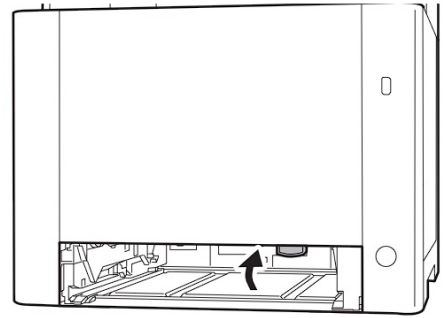
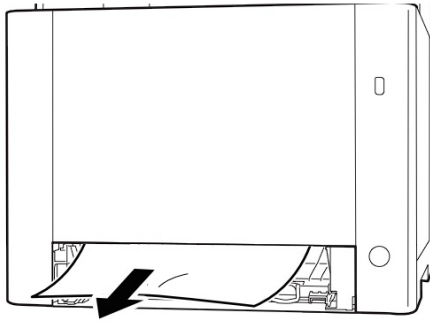

⑥

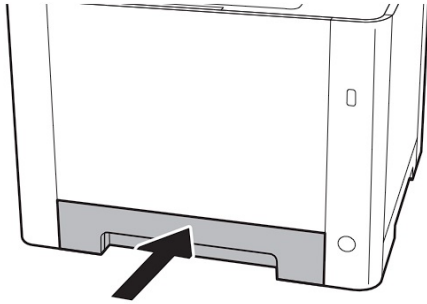

⑦

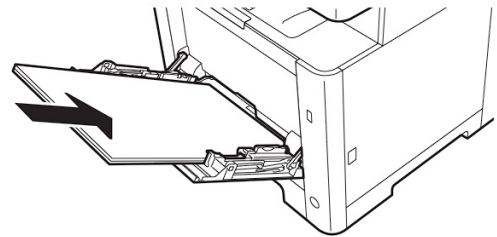
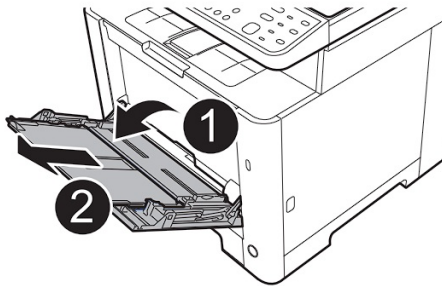

D

①

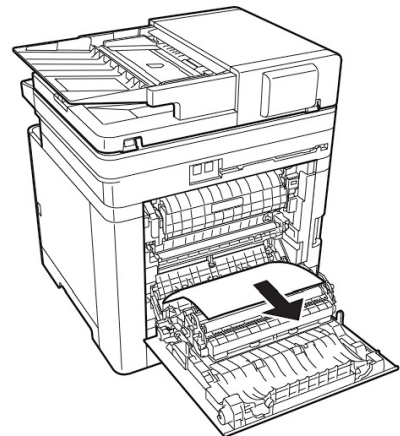
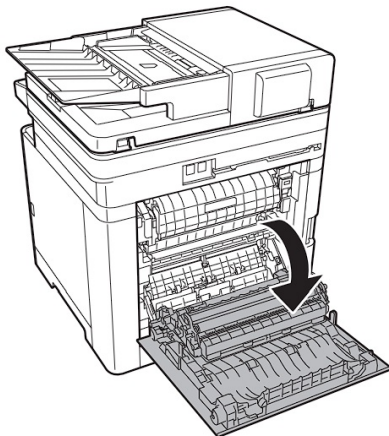

②

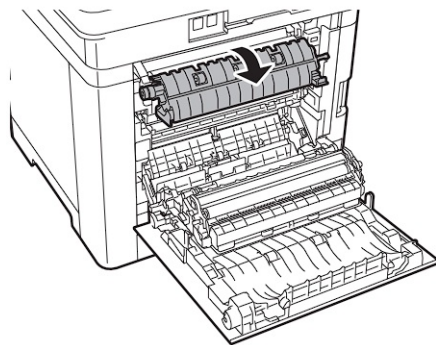
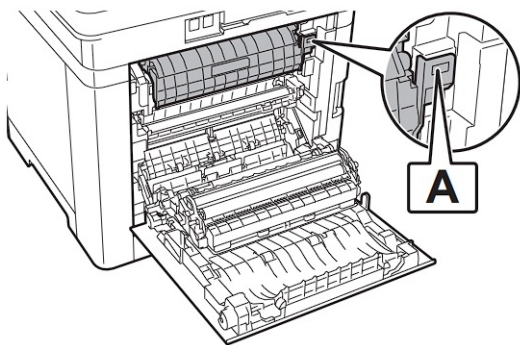

③

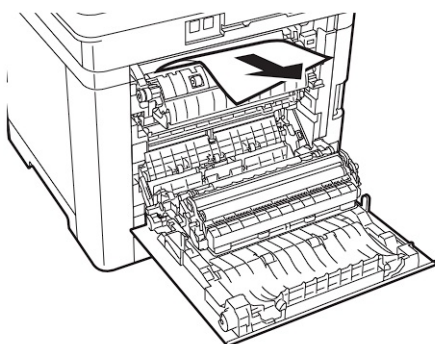

④

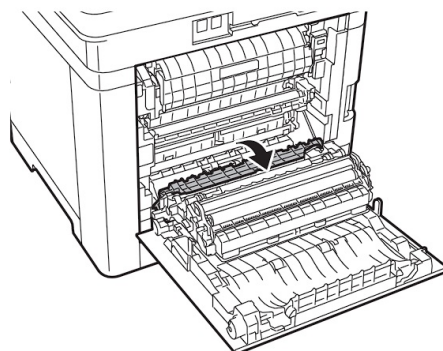
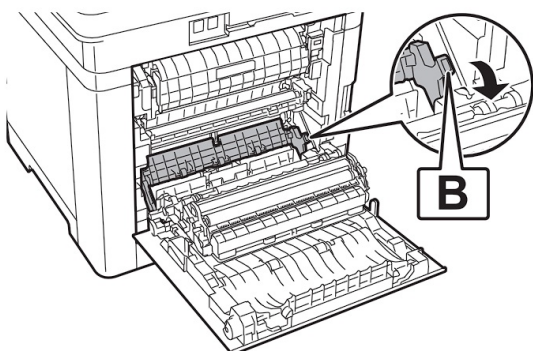

⑤

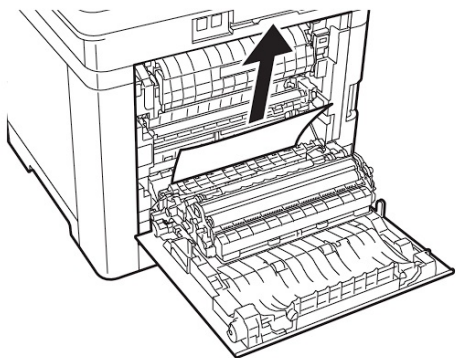

⑥

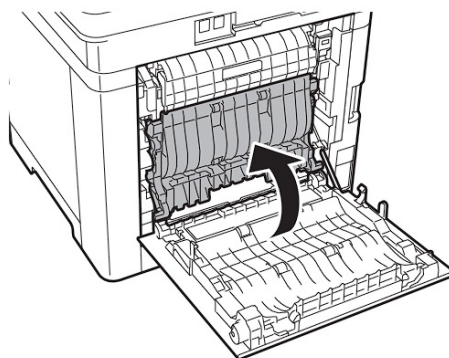
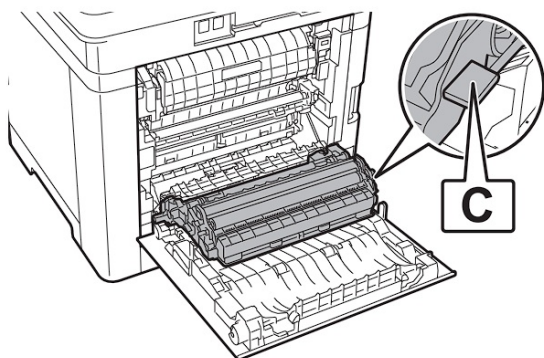

7

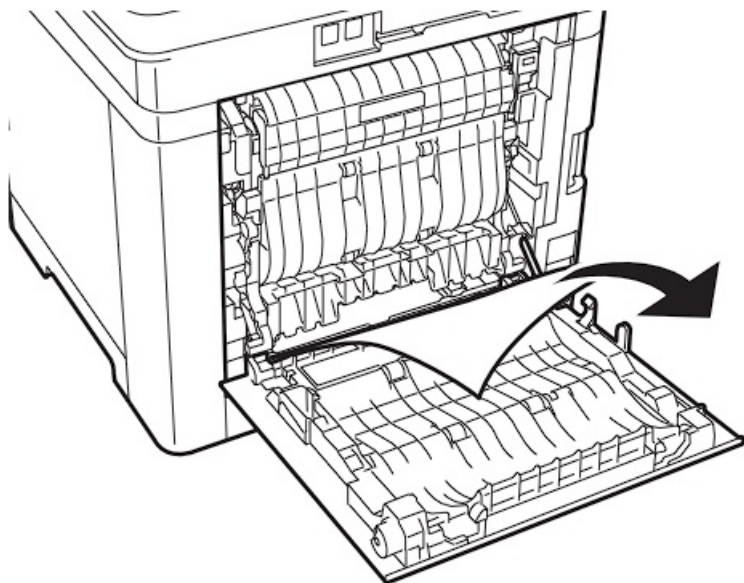

8

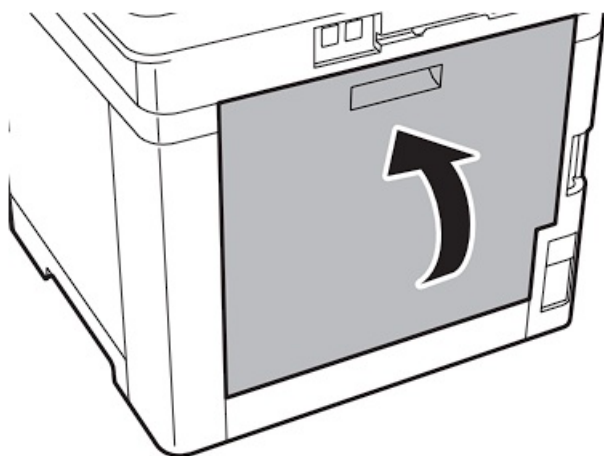

E

①

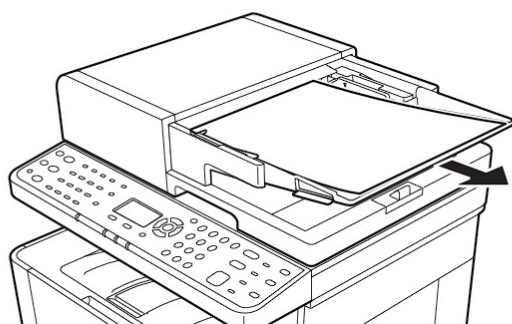

②

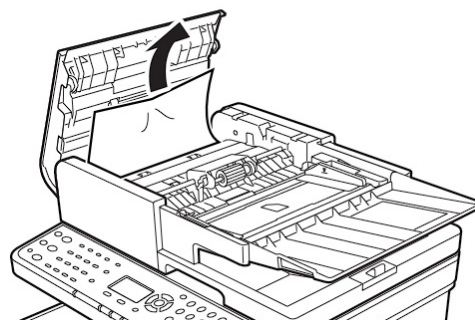
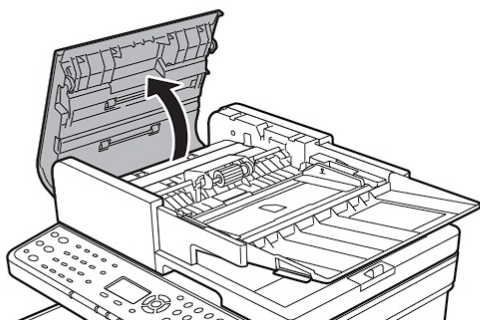

③

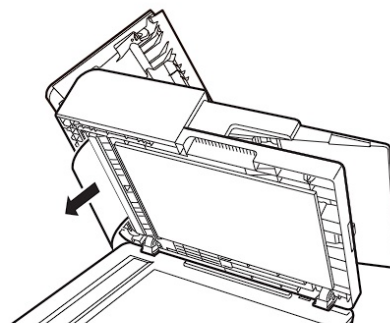
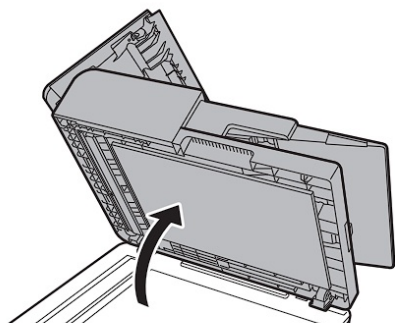

④

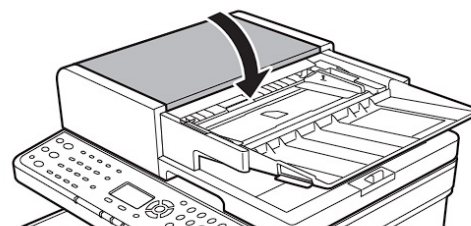
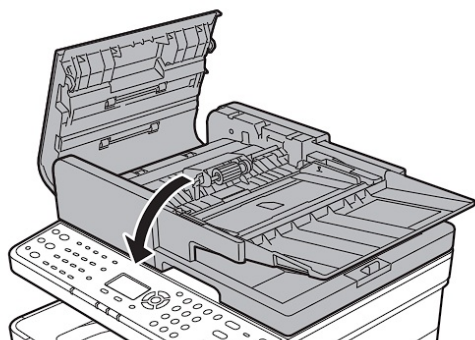

QUALITY CERTIFICATE

This machine has passed
all quality controls and
final inspection.

© 2021 KYOCERA Document Solutions Inc.

 **KYOCERA** is a trademark of KYOCERA Corporation

Documents / Resources

	<p>KYOCERA MA2100c Series Laser Multi function printer [pdf] User Guide MA2100c Series Laser Multi function printer, MA2100c Series, MA2100cwfx, Laser Multi function printer, Multi function printer, function printer, printer</p>
---	--

[Manuals+](#)