



Kwikset Adding Your First Aura Lock User Guide

[Home](#) » [Kwikset](#) » Kwikset Adding Your First Aura Lock User Guide 

Kwikset[®]

Adding Your First Aura Lock

This section is for **Aura locks** only. For **Halo locks**, skip to the next section.

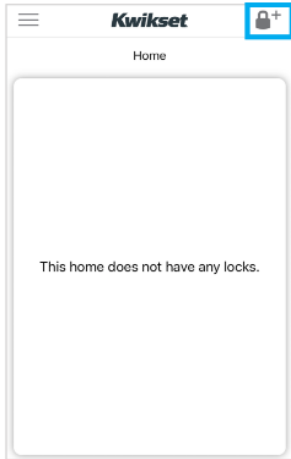

1. Tap  in the upper right corner.

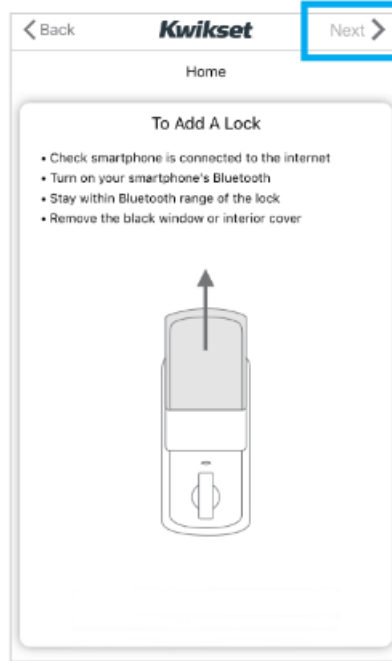

2. Follow the on-screen directions, then tap "Next."



3. Follow th

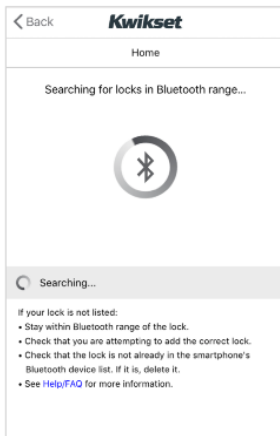

4. The app will begin searching for the lock.

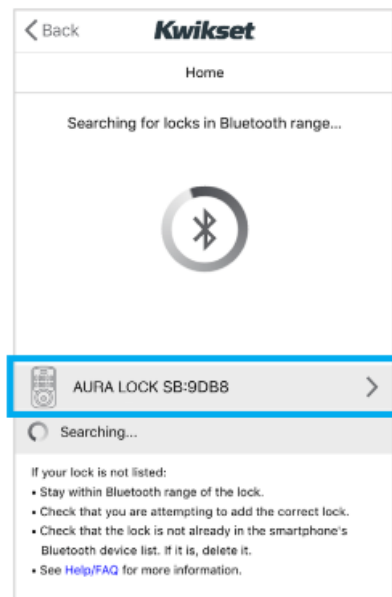

5. When the lock appears in the list, tap on the lock to begin the pairing process.

The name may appear as:

- AURA LOCK: #####
- AU: #####



6. If pairing is successful, the lock will sound and continue.

If unsuccessful, tap "No, try again" to retry. If the lock does not appear in the smartphone's Bluetooth device list, remove the lock and repeat the previous steps.

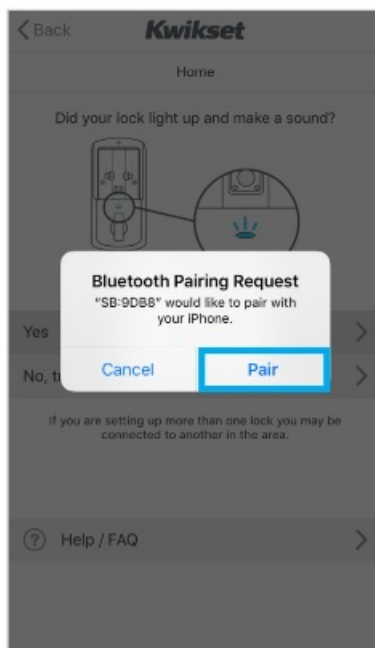

7. If your phone displays a Pairing Request message, tap “Pair” to allow the lock to pair with your phone. Tapping “Cancel” will prevent the lock from pairing with your smartphone and stop the Add Lock process.

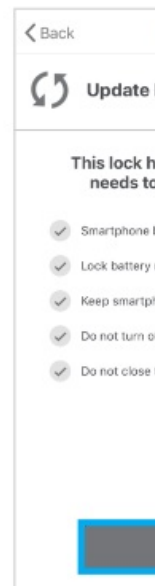

8. Your lock needs to be updated its firmware. Tap “Update” to update the lock and complete the update process.

- Keep the smartphone lock within Bluetooth range of the lock.
- Keep the smartphone lock running the Kwikset app while the lock is running in the background.

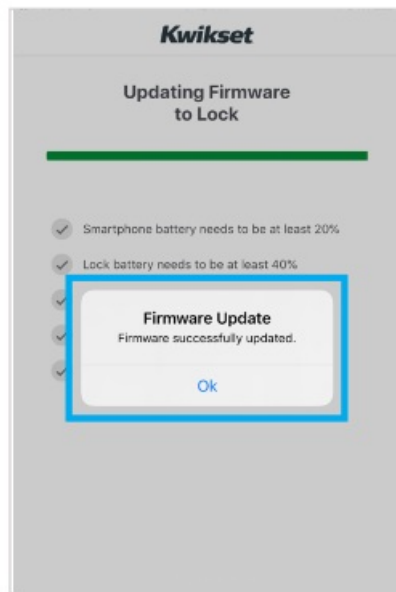

11. Enter a name for the lock names must be 1-30 characters, and:
- Can include letters, numbers, and underscores
 - Cannot include spaces or special characters

10. A message will appear signifying that the firmware was successfully updated. Tap “Ok” to continue.

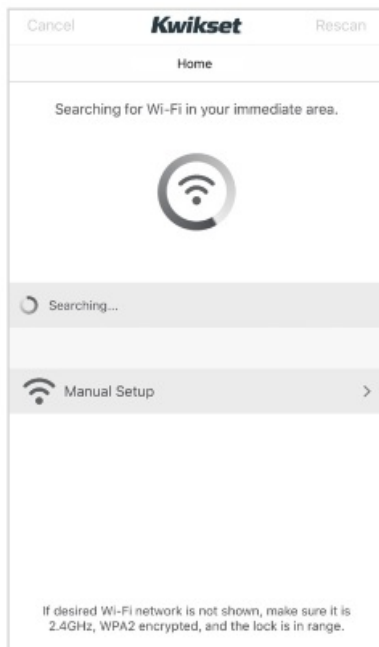

13. The app will begin searching for available WiFi connections. Make sure the WiFi network is 2.4GHz and is password protected using WPA2 encryption. You may need to un-hide your network.



14. When your home's WiFi appears in the list, tap on it to search for it again. You may also choose "Manual Setup" to search for it again.

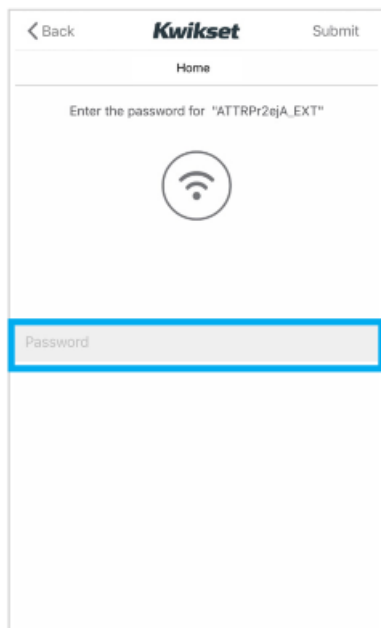

15. Enter the password for your WiFi then tap “Submit.”

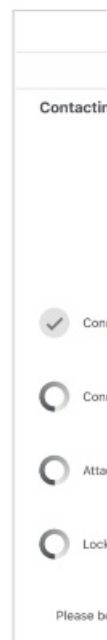

16. The lock will contact the remote server to finalize

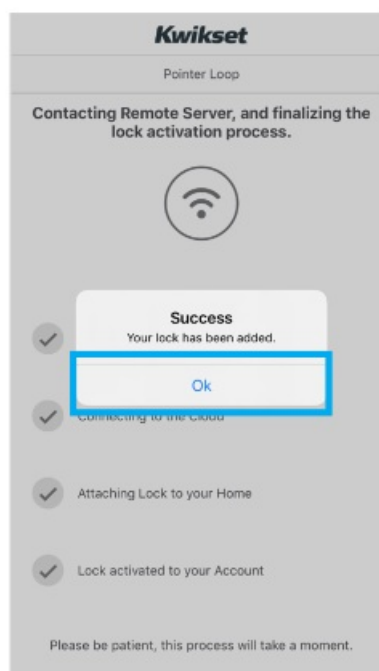

17. A message will appear signifying that the lock activation process was successful. Tap “Ok” to continue. You may now re-hide your network, if applicable.

Enter a name for the first Access Code. Enter an Access Code or tap “Generate Random Code,” then tap “Submit.”

Access Code names must be 2 to 14 characters, and:

- Can include letters and numbers
- Cannot include special characters

For more information about Schedule Types, see Code Schedule page on www.kwikset.com



Important Information About Access Codes

- Always test each new Access Code after creating it to make sure it works.
- For security reasons, the first 4 digits of each Access Code must be unique. For example, you are unable to program an Access Code **1-2-3-4-5**, as well as an Access Code **1-2-3-4-6**.
- A total of 250 Access Codes can be programmed.

Kwikset

For more information
about Schedule Types,
see Code Schedule page on
www.kwikset.com

Contents

- [1 Documents / Resources](#)
- [2 Related Posts](#)

Documents / Resources

	<p>Kwikset Adding Your First Aura Lock [pdf] User Guide Adding Your First Aura Lock</p>
--	---