



# KRUX Leda KRX0007 Computer Case Installation Guide

[Home](#) » [KRUX](#) » KRUX Leda KRX0007 Computer Case Installation Guide 

## Contents











- [1 KRUX Leda KRX0007 Computer Case](#)
- [2 ACCESSORY PACKET CONTENTS](#)
- [3 REMOVAL OF PANELS](#)
- [4 ADD-ON CARD INSTALLATION](#)
- [5 POWER SUPPLY INSTALLATION](#)
- [6 FRONT/REAR FAN INSTALLATION](#)
- [7 TOP FAN INSTALLATION](#)
- [8 WATER COOLING INSTALLATION](#)
- [9 2-year manufacturer warranty](#)
- [10 Documents / Resources](#)



**KRUX Leda KRX0007 Computer Case**



## ACCESSORY PACKET CONTENTS

 <b>x6</b>	 <b>x1</b>	 <b>x4</b>	 <b>x3</b>
 <b>x4</b>	 <b>x12</b>	 <b>x2</b>	 <b>x4</b>
 <b>x3</b>	 <b>x1</b>		

SPB3-10-F16

## REMOVAL OF PANELS

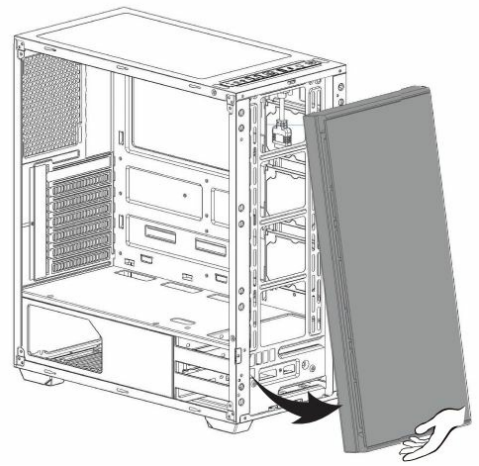
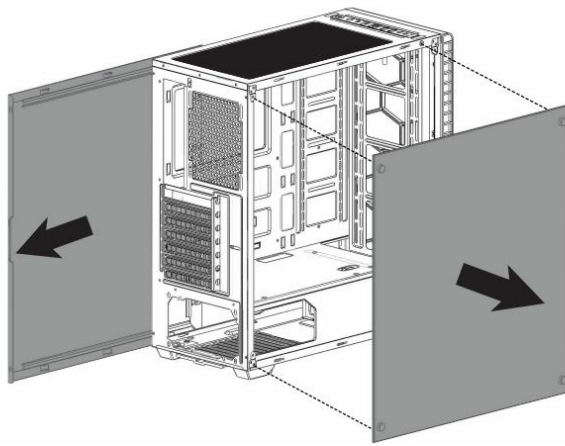

## CASE FEATURES

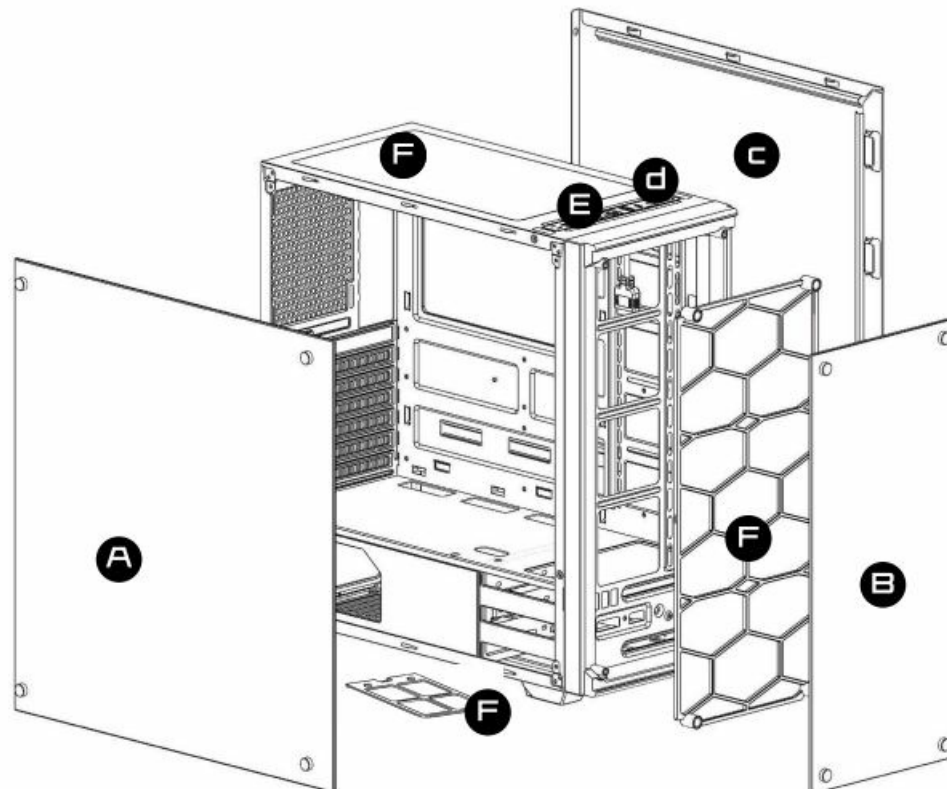

- **A** – SIDE TEMPERED GLASS PANEL
- **B** – FRONT TEMPERED GLASS PANEL
- **C** – SIDE PANEL
- **D** – POWER+ RESET BUTTON
- **E** – 1x USB 3.0, 2x USB 2.0, HD AUDIO
- **F** – DUST FILTERS

## ADD-ON CARD INSTALLATION

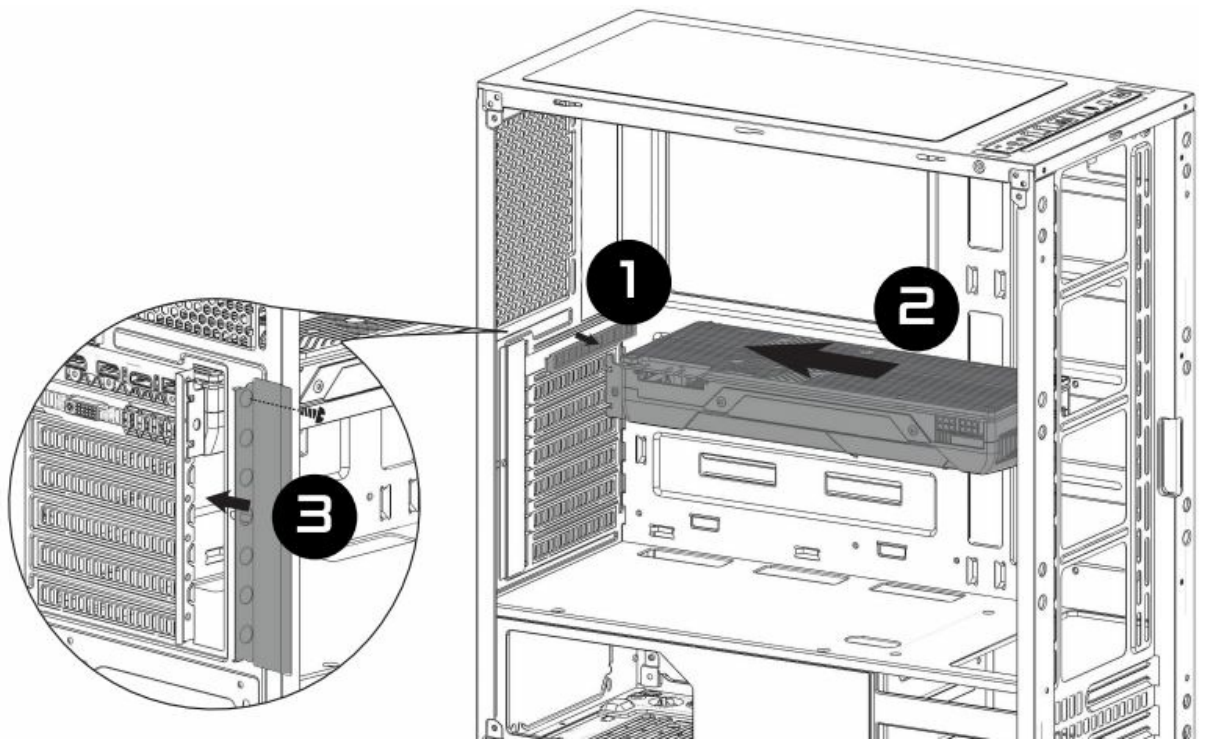

1. BEND ADD-ON CARD COVER
2. SLIDE PCI-E CARD INTO POSITION
3. SECURE PCI-E CARD WITH ADD-ON SCREW

## POWER SUPPLY INSTALLATION

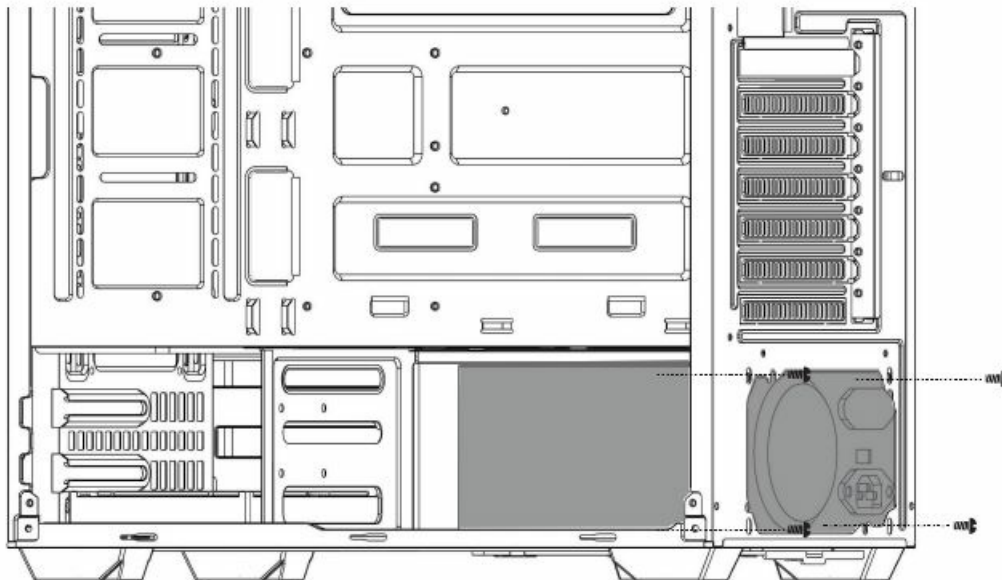

## 3,5' HDD INSTALLATION

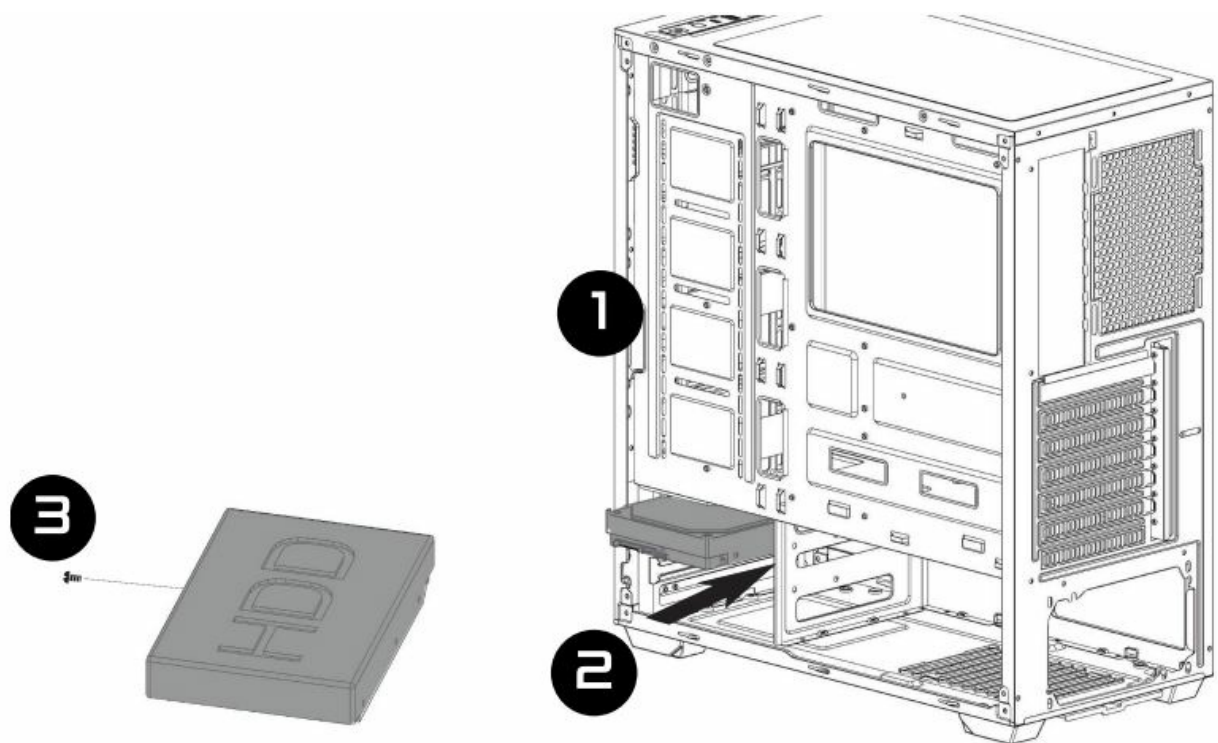

1. REMOVE FRONT FAN BY UNSCREWING THE FAN SCREWS
2. SLIDE 3,5 DRIVE INTO THE BAY
3. SECURE WITH SCREWS ON BOTH SIDES

#### 2,5' 550 INSTALLATION

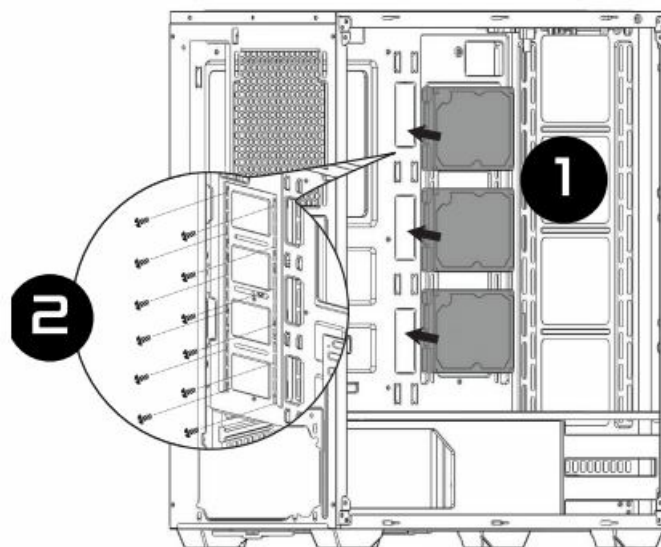

1. PLACE 2,5 DRIVE IN
2. SECURE WITH SCREWS

#### FRONT/REAR FAN INSTALLATION



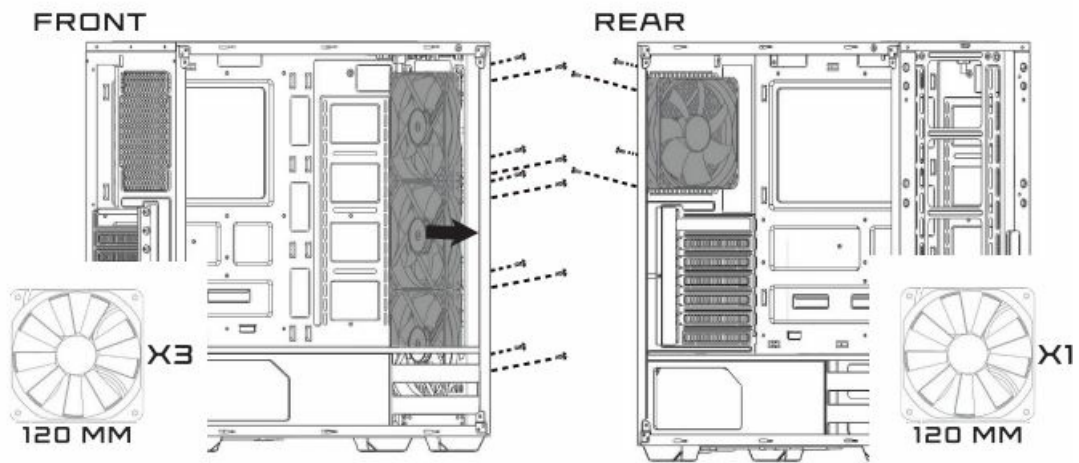

## TOP FAN INSTALLATION

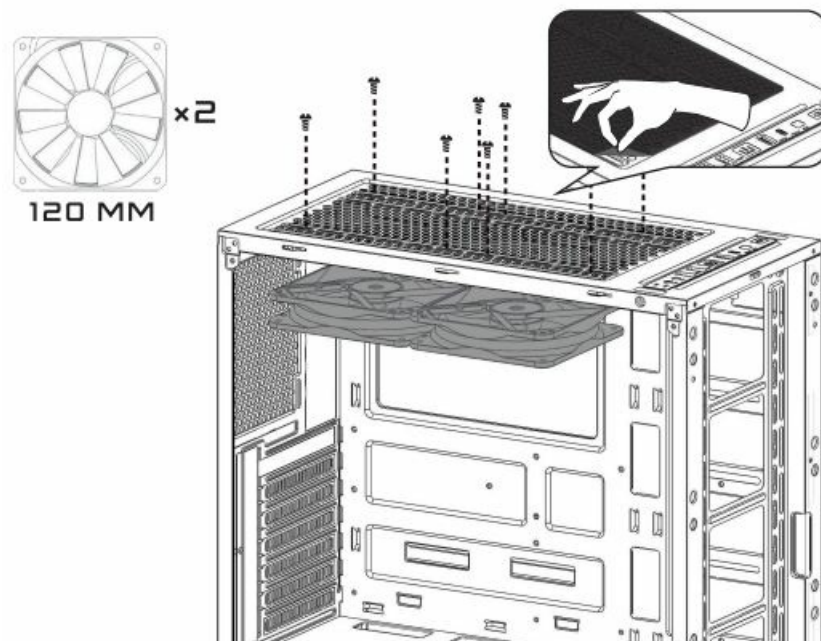

## WATER COOLING INSTALLATION

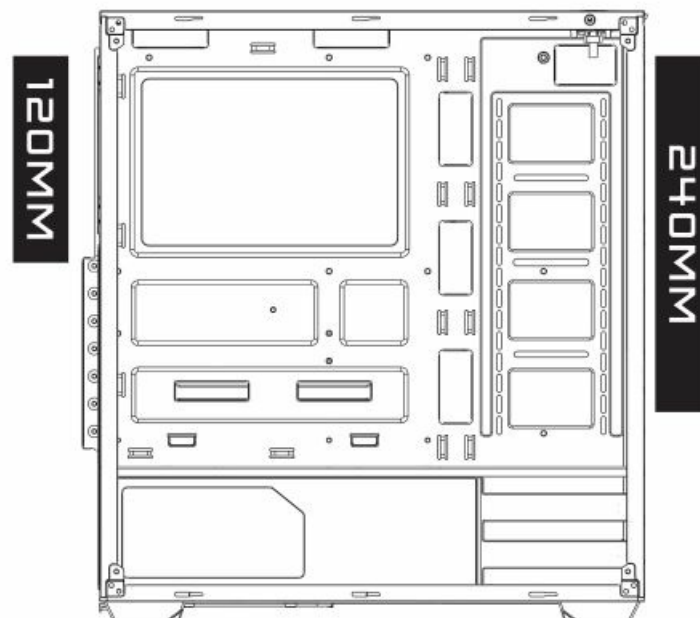

## MULTIPLE FANS

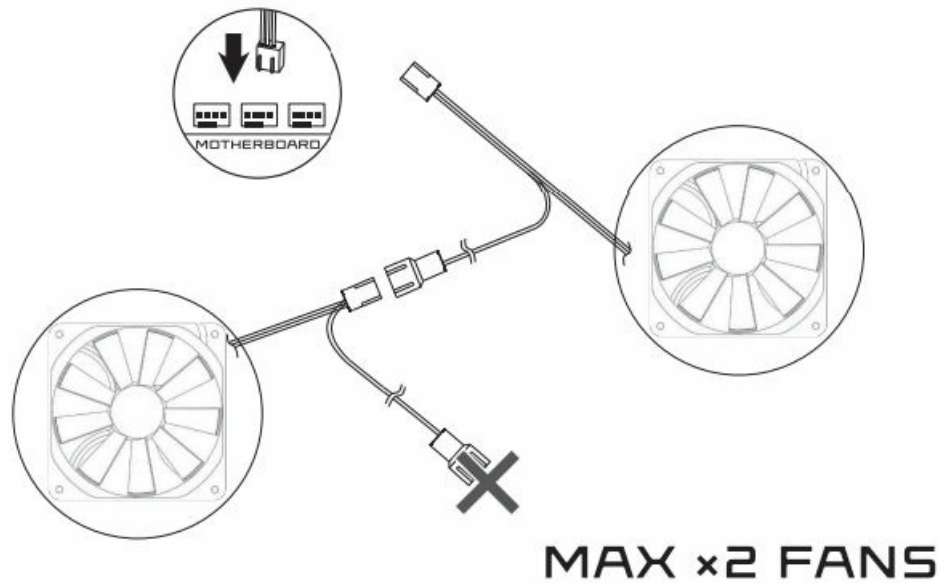

## 2-year manufacturer warranty

### Use and warranty limitations

- The product should be used according to its intended purpose. Incorrect use can damage the product and endanger the life of the user.
- Excessive humidity, dust and other contaminations can result in product damage which is not covered by the warranty.
- The warranty does not cover mechanical damage to the product.
- Avoid exposure to rapid changes in ambient temperature. Should they occur, wait approx. 30 minutes before using the product until the temperature is leveled.
- You can find the Warranty Terms and Conditions in “Support” at <https://krux.tech/>

### ENTITY RESPONSIBLE:

COOLING SP. Z O.O. UL. SOKOŁOWSKA 24 05-806 SOKOŁOW, POLSKA

TEL. +48 22 292 01 30

BDO: 000020025

## Documents / Resources

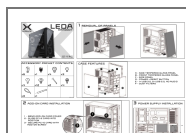

[KRUX Leda KRX0007 Computer Case](#) [pdf] Installation Guide  
Leda KRX0007 Computer Case, Leda KRX0007, Computer Case, Case