

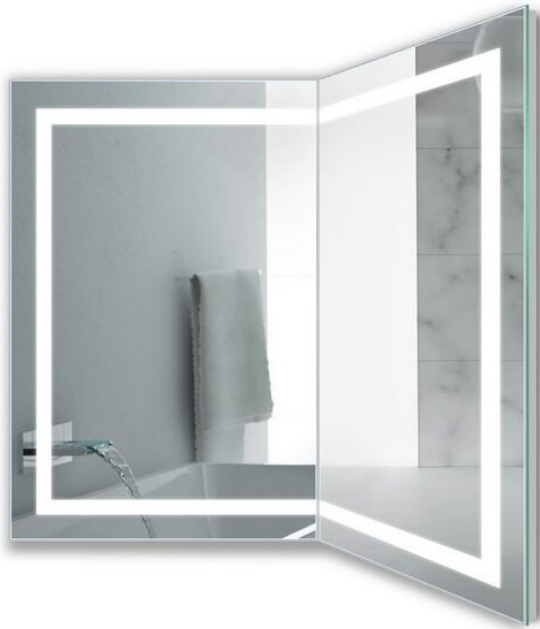

Krugg MODSMCORNER24D LED Mirror System User Guide

[Home](#) » [Krugg](#) » Krugg MODSMCORNER24D LED Mirror System User Guide 

Krugg MODSMCORNER24D LED Mirror System User Guide



DANGER



Risk of personal injury. To avoid possible electrical shock, the electricity must be turned off at the circuit breaker or fuse box before attempting any installation procedure. The mirror must also be properly grounded. To reduce the risk of burns, fire, electric shock or injury to persons. Use this furnishing only for it's intended use as described in these instructions. Do not use ttachments not recommended by the manufacturer. Never drop or insert any object into any opening. Do not use outdoors.

Contents

- 1 GROUNDING INSTRUCTIONS
- 2 IMPORTANT – BEFORE YOU BEGIN
- 3 TOOLS USED
- 4 ELECTRICAL WIRE INFORMATION
- 5 CONFIGURATIONS
- 6 INSTALLATION
- 7 FRONT
- 8 USE AND MAINTENANCE
- 9 LIMITED WARRANTY
- 10 COMMERCIAL WARRANTY
- 11 Documents / Resources
 - 11.1 References
- 12 Related Posts

GROUNDING INSTRUCTIONS



This product must be connected to a grounded metal, permanent wiring system, or an equipment-grounding conductor must be run with the circuit conductors and connected to the equipment-grounding terminal or lead on the product.

WARNING

- All fittings must be installed in accordance with current IEE wiring regulations. If in doubt, consult a qualified electrician.
- Switch off the electrical supply at the main circuit board BEFORE installation and maintenance.
- Suitable for Bathroom Zones 2, 3 and non bathroom/dry areas. See diagram below.
- NOT suitable for above baths or Zone 1 not for installation in Saunas, Steam Rooms or Shower Cubicles.
- DO NOT fix to damp or conductive surfaces. Suitable for indoor use only.
- Site well away from curtains and fabrics.
- Never cover the mirror.
- Switch off after use.

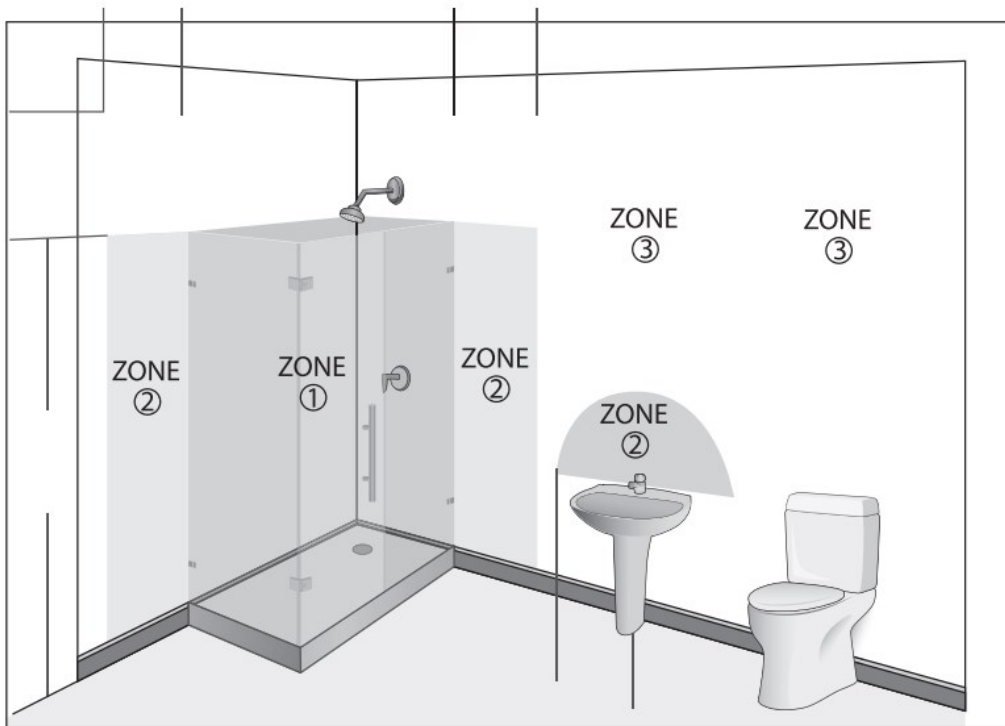

IMPORTANT – BEFORE YOU BEGIN

- Inspect the product immediately upon receipt for transit damage or missing parts.
- Handle the product with care and protect against knock to all sides and edges of the glass.
- Make sure that you have all the tools you need to complete the job. (SEE BELOW)
- Ensure there are no hidden pipes or cables in the wall before drilling.
- If drilling holes in ceramic tiles use a piece of masking tape on the tile to stop the drill bit from slipping.

Aftercare Instructions

- Clean using a soft dry cloth only when turned off.
- Never use cleaning agents or abrasive materials.
- Do not allow moisture to come into contact with lamps.

TOOLS USED

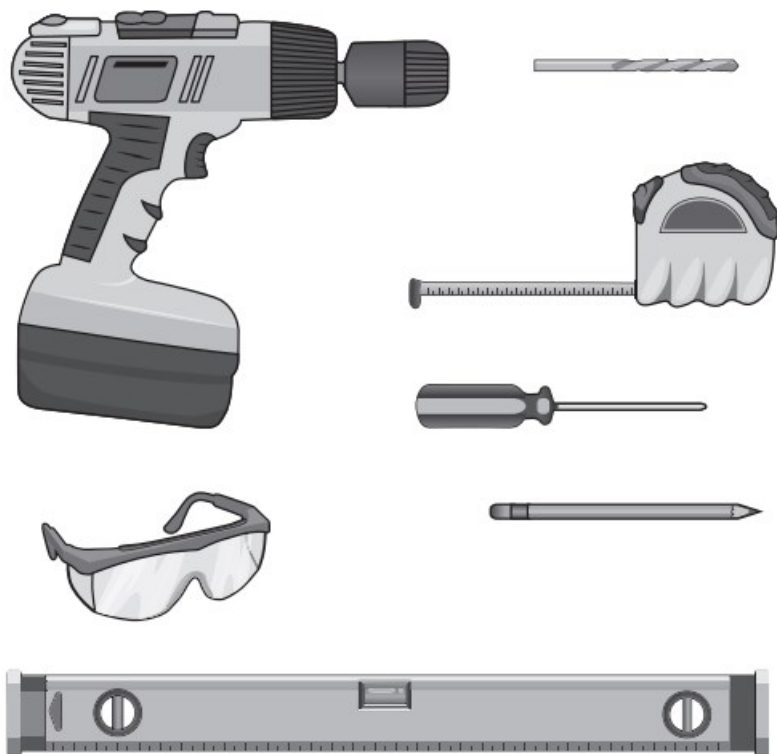

ELECTRICAL WIRE INFORMATION

The Lead Contains 3 Wires:

COPPER WIRE (GREEN) = GROUND WIRE...Connect to GROUND WIRE in your box, or to the box as a ground.

WHITE (or BROWN) = NEUTRAL WIRE... Connect to the WHITE NEUTRAL WIRE in your box.

BLACK (or BLUE) = HOT WIRE... Connect to the BLACK HOT WIRE in your box.

The Modular wires will be connected to your 120 Volt electric box. This should be placed in the wall, behind your Modular Mirror. The suggested method for placement is towards the center, however there is flexibility with the lead wire

Please follow below illustrations

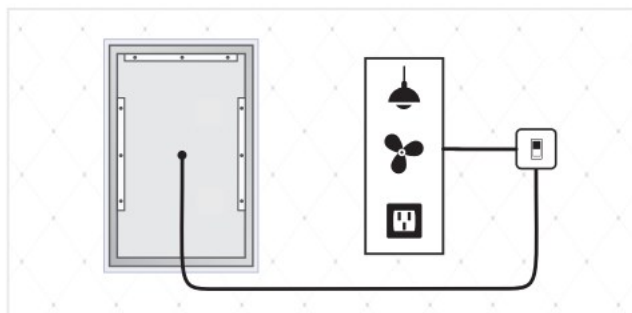
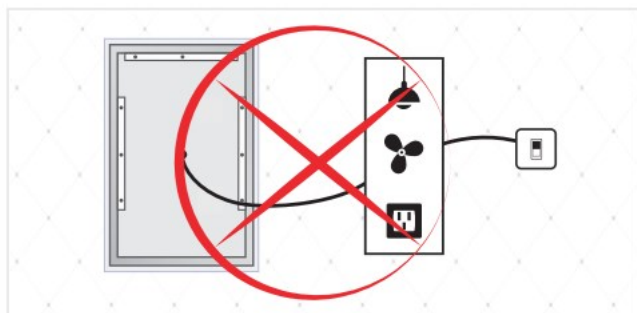

Install optional outside switch to control the defogger

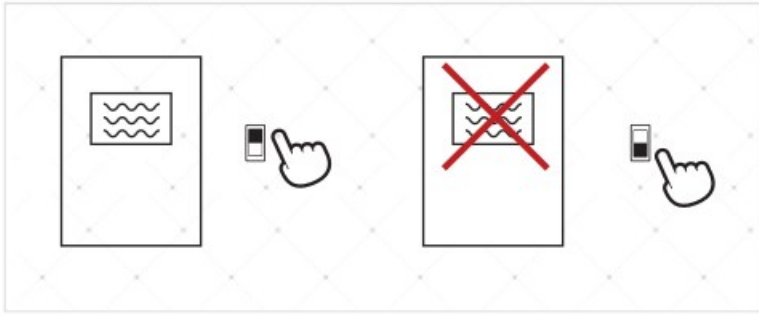

Install Optional Dimmer to control the brightness of the mirror

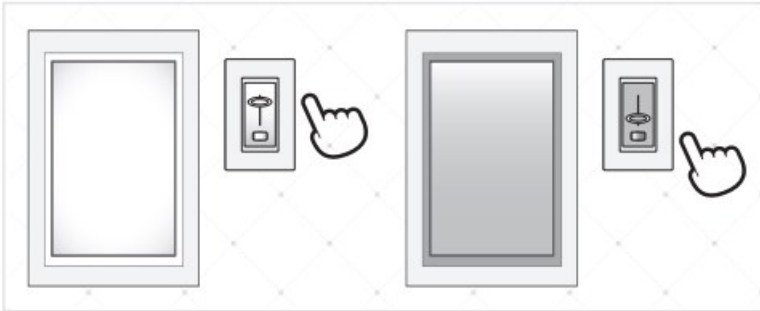

Refer to how to use guide for more information

CONFIGURATIONS

- Mod 1836 Left LED Mirror



- Mod 1836 Right LED Mirror



- Mod 2136 Left LED Mirror



- Mod 2136 Right LED Mirror



- Mod 2436 Left LED Mirror



- Mod 2436 Right LED Mirror



- Mod 3636 Left LED Mirror

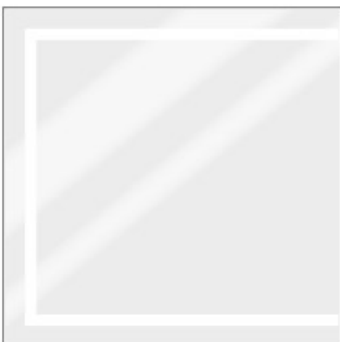

- Mod 3636 Right LED Mirror

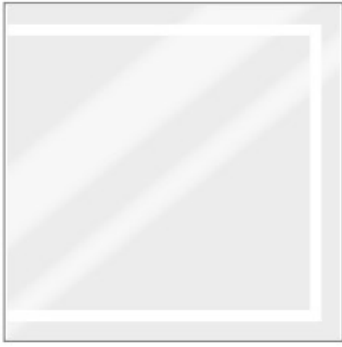

- Mod 2436 Center LED Mirror



- Mod 3636 Center LED Mirror



- Mod 4836 Center LED Mirror

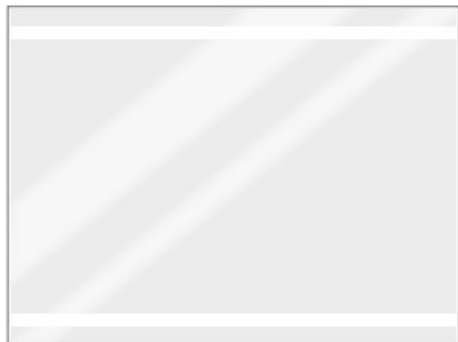

CONFIGURATIONS

Mod 1836 Left Mod 2436 Center Mod 1836 Left

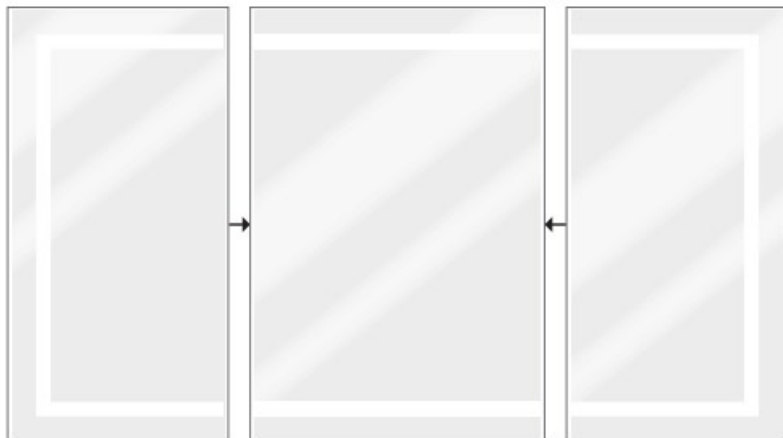

Mod 2436 Left Mod 2436 Center Mod 2436 Center Mod 2436 Center Mod 2436 Right



Mod 2436 Left Mod 2436 Center Mod 2436 Right

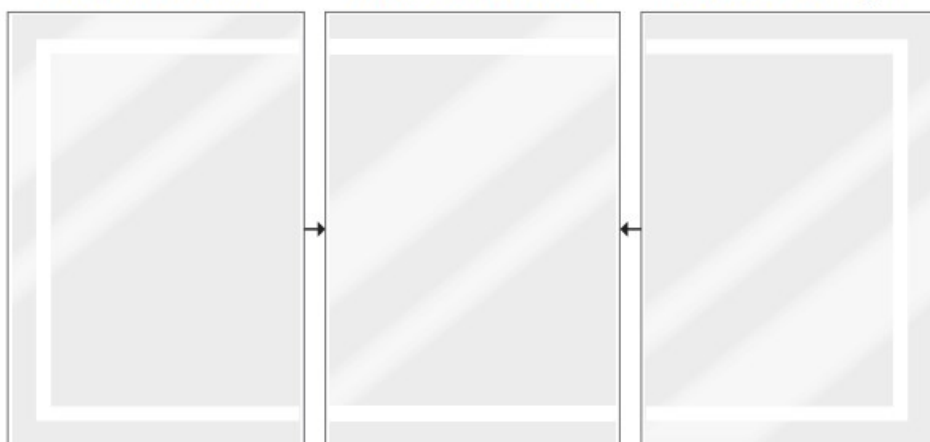

Mod 2136 Left Mod 3636 Center Mod 3636 Center Mod 2136 Right



Mod 3636 Left



Mod 3636 Right



Mod 2436 Left



Mod 4836 Center

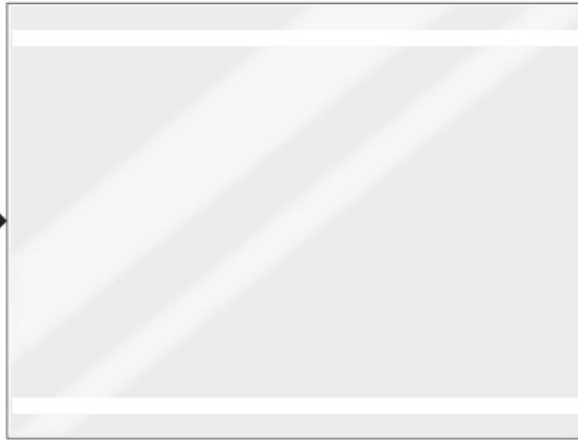

Mod 2436 Right



Mod 3636 Left



Mod 4836 Center

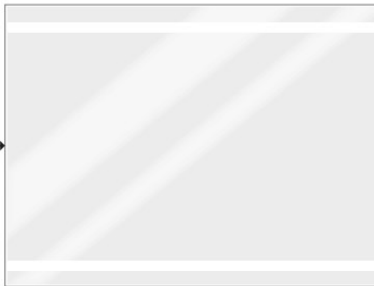

Mod 4836 Center

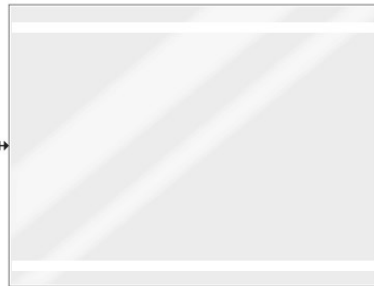

Mod 3636 Right

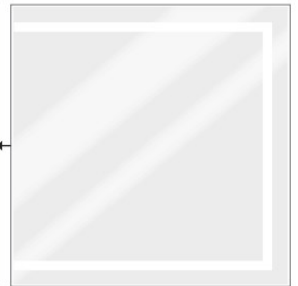

INSTALLATION

1

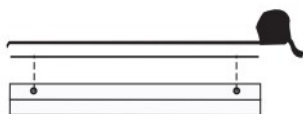

Measure
distance
between holes
for the
mounting
brackets
installation

2

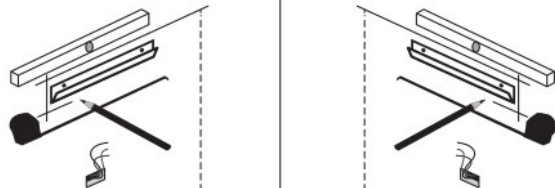

Mark hole positions on the wall ready for drilling

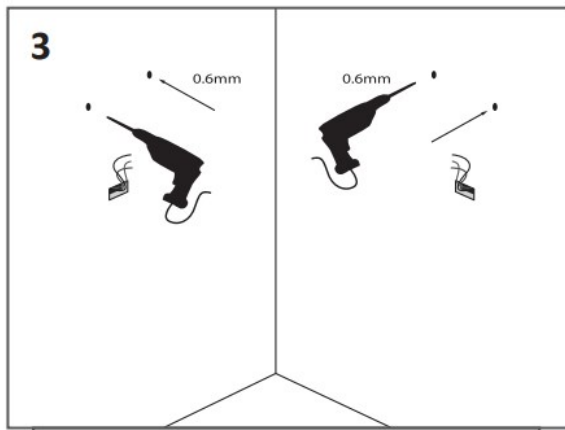

Carefully drill each of the holes

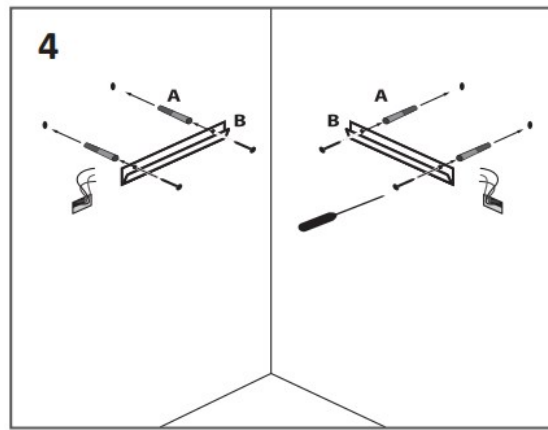

Insert anchors into predrilled holes and fix the mounting brackets to the wall

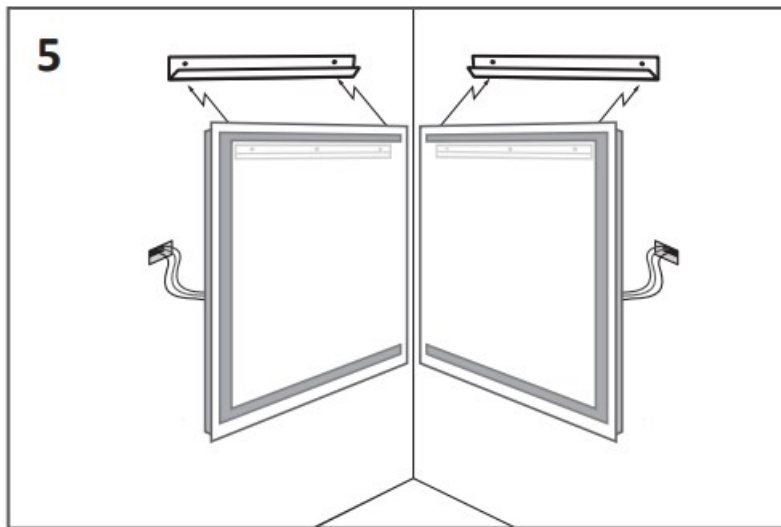

Line up the brackets of the mirror with wall brackets and slide the mirror down

FRONT

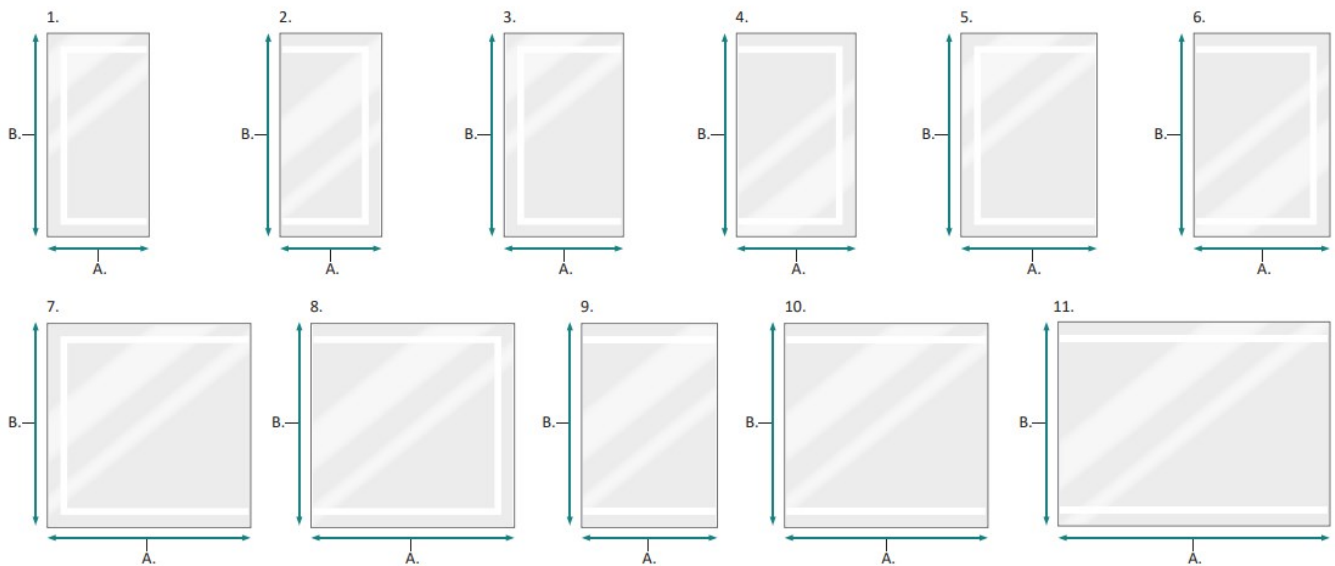

BACK

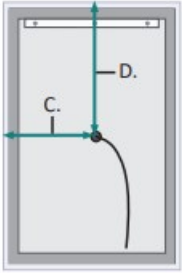

SIDE



#	MODEL	A	B	C	D	E	F	ELECTRIC CURRENT	WATTAGES
1	Mod 1836 Left LED Mirror	18	36	8-13/20	17-7/8	1-3/8	3/16	0.28A	34W
2	Mod 1836 Right LED Mirror	18	36	8-13/20	17-7/8	1-3/8	3/16	0.28A	34W
3	Mod 2136 Left LED Mirror	21	36	9-3/4	17-7/8	1-3/8	3/16	0.30A	37W
4	Mod 2136 Right LED Mirror	21	36	9-3/4	17-7/8	1-3/8	3/16	0.30A	37W
5	Mod 2436 Left LED Mirror	24	36	9-5/8	17-7/8	1-3/8	3/16	0.40A	49W
6	Mod 2436 Right LED Mirror	24	36	9-5/8	17-7/8	1-3/8	3/16	0.40A	49W
7	Mod 3636 Left LED Mirror	36	36	17-7/8	17-7/8	1-3/8	3/16	0.46A	55.5W
8	Mod 3636 Right LED Mirror	36	36	17-7/8	17-7/8	1-3/8	3/16	0.46A	55.5W
9	Mod 2436 Center LED Mirror	24	36	9-5/8	17-7/8	1-3/8	3/16	0.33A	40W
10	Mod 3636 Center LED Mirror	36	36	17-7/8	17-7/8	1-3/8	3/16	0.38A	46.6W
11	Mod 4836 Center LED Mirror	48	36	12	17-7/8	1-3/8	3/16	0.48A	58W

USE AND MAINTENANCE

- The interior is constructed of mirrored glass and aluminum. Use only a damp cloth to clean. Ammonia or vinegar-based cleaners can damage mirrors.
- When cleaning, spray the cloth, not the mirror, or surrounding surfaces. Do not use abrasive cleansers on any part of the light fixture.

LIMITED WARRANTY

Subject to the terms and conditions specified herein, Krugg Reflections USA LLC , (“KRUGG”) hereby extends a limited lifetime warranty (this “Limited Warranty”) to original Purchasers (as defined below) of the Krugg LED Medicine Cabinet (the “Product”) with respect to certain specified components of the Product. Specifically, KRUGG, by this Limited Warranty, warrants that, for the duraons specified herein, Products purchaseddirectly from KRUGG or KRUGG’s authorized retailers will be free of defects in the material and workmanship of the Product’s electrical components, glass, mirrors, and certain mechanical components, which defects would cause the Product to substantially fail to function when subject to normal use.

COMMERCIAL WARRANTY

Subject to the terms and conditions specified herein, Krugg Reflections USA LLC, (“KRUGG”) hereby extends a limited one-year warranty (this “Limited Warranty”) to Commercial Purchasers (as defined below) of the Krugg LED Lighted Mirror (the “Product”) with respect to certain specified structural components of the Product. Specifically, KRUGG, by this Limited Warranty, warrants that, for a one-year period, Products purchased directly from KRUGG or KRUGG’s authorized retailers will be free of defects in the material and workmanship of the Product’s electrical components, glass and mirrors, which defects would cause the Product to substantially fail to function when subject to normal use.

Additional Warranty Information can be found @ <http://www.kruggusa.com>
For any installation and warranty related issues, contact us at info@kruggusa.com

Documents / Resources

	<p>Krugg MODSMCORNER24D LED Mirror System [pdf] User Guide</p> <p>MODSMCORNER24D LED Mirror System, MODSMCORNER24D, LED Mirror System, LED Mi rror, Mirror</p>
---	--

References

- [Krugg](#)