



Kruger Matz KM2209 IP Wi-Fi Security Camera Owner's Manual

[Home](#) » [Kruger Matz](#) » Kruger Matz KM2209 IP Wi-Fi Security Camera Owner's Manual 

Krüger&Matz

KM2209

KM2210

KM2211

KM2212

KM2213

IP Wi-Fi security camera

Extended manual

Contents

[1 SAFETY](#)

[INSTRUCTIONS](#)

[2 INSTALLATION](#)

[3 Documents / Resources](#)

[3.1 References](#)

[4 Related Posts](#)

SAFETY INSTRUCTIONS

1. Before the installation make sure to read up on local restrictions about recording and surveillance systems.
2. Protect the device from exposure to high or low temperatures.
3. Protect the device from water and other liquids. Do not handle this device with wet hands.
4. Do not use the device where it is prohibited to use 2,4 GHz band.
5. Use memory cards of class 10 or higher.
6. Before cleaning the device, make sure that it is unplugged from power.
7. Clean this device regularly, with soft, dry cloth, without any abrasive agents.
8. Do not disassemble or try to repair the device. In case of damage or malfunction, contact authorized service point.

CONNECTING KM2211

1. Connect the microUSB of the provided cable to the camera's plug. Connect the USB plug to the provided power adapter.
2. Connect the power adapter to a power supply socket.
3. After a while, the camera will turn on. The starting sound will play, and the camera will rotate the lens in all directions.
4. If this is the first time the camera is used, the camera will be playing the pairing sound.

KM2209, KM2210, KM2212, KM2213, KM2215

1. Connect the power adapter to the power socket of the camera.
2. After a while, the camera will turn on. The starting sound will play, and the camera will rotate the lens in all directions.
3. if this is the first time the camera is used, the camera will be playing the pairing sound.

KM2214

1. Unscrew the battery compartment cover of the solar panel and take it out.
2. Each battery is shrink wrapped. Take every battery out and remove the shrink wrap. Caution: to do this do not use very sharp objects.
3. insert batteries back into the solar panel and make sure that the polarization is correct. Close the battery compartment and screw it in.

Connecting external power supply

1. Connect the solar panel to the camera.
2. Connect the microUSB plug of the external power supply to the microUSB socket on the solar panel (placed under the rubber cap).
3. Set the switch on the solar panel to ON position (the switch is under the rubber cap).

SIM card installation (only KM2214 model)

Unscrew the cover from the back of the camera and insert the SIM card.
Caution: the SIM card cannot be locked with a PIN code.

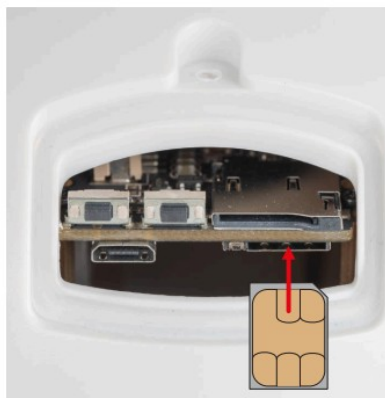

INSTALLATION

1. Download and run the TuyaSmart app from Play Store or AppStore. Attention: screenshots shown may be different from current version of the app.



<https://smartapp.tuya.com/tuyasmart>

2. Sign up and/or login to the Tuya app. It is possible to use the app without an account, however it is necessary to set up a home and add family members.

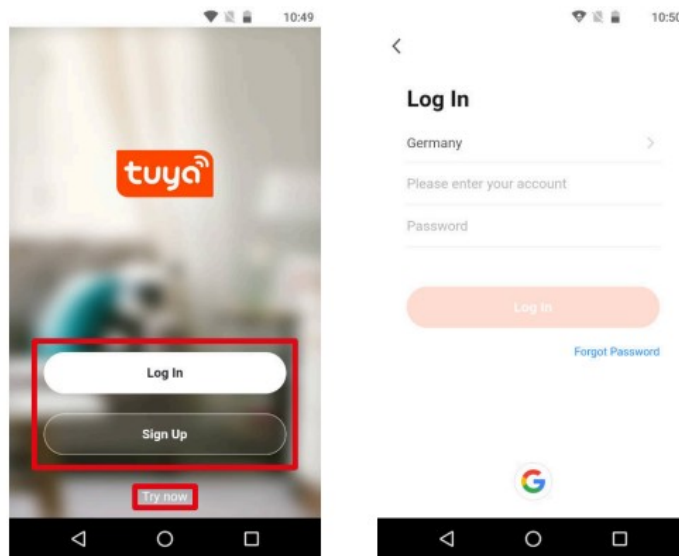

3. Press the Add new device button.

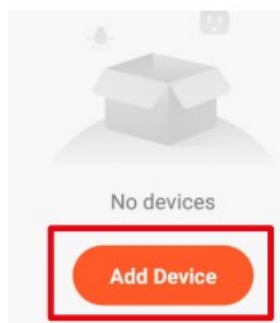

4. Go to the Security & Video Surveillance category and select the Smart Camera option.

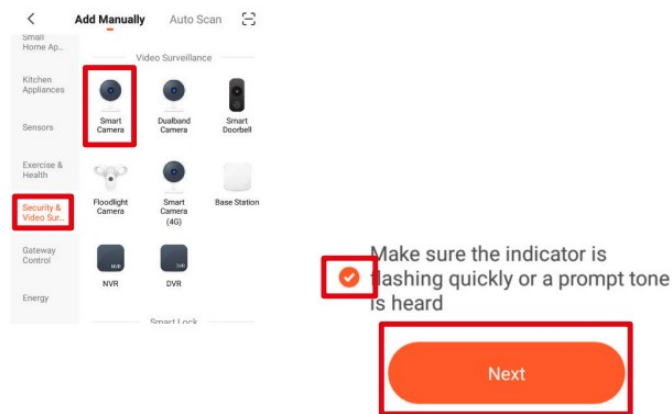

5. Check the mark and press the Next button.

6. Select a network and input the password.

Attention: make sure that the router is working on 2,4 GHz band (5 GHz is not supported).

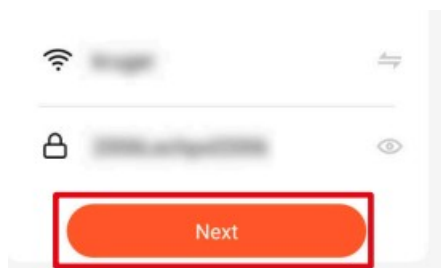

7. Show the QR code to the camera. Make sure that the distance between the camera and the phone is around 15-20 cm, and the camera is pointing directly at the phone. The camera will play a chime, once it establishes the connection. Attention: if the camera will not detect the QR code, try turning the camera by 180°.

Please scan the QR code from 15 to 20 cm away

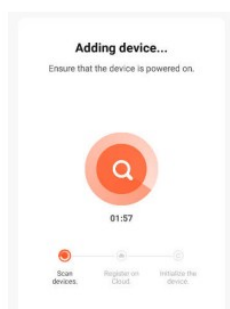

8. Press the I Heard a Prompt button. Wait until the app add the camera.

9. Ready! The camera has been added. If you want to change the name of the camera, press the Edit button and input the name. Press the Done button.

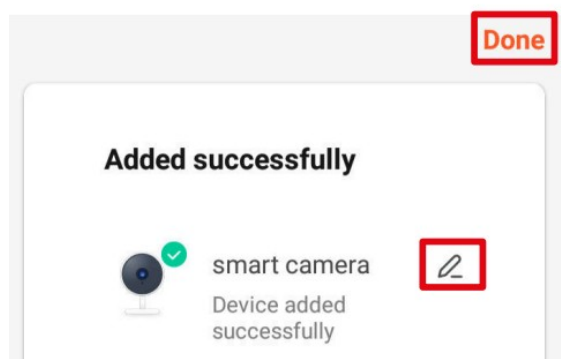

10. On the main screen, press the camera to view the details.

- a. Live view
- b. Mute sound from the camera
- c. Switch the image quality
- d. Switch full screen
- e. Signal level
- f. Camera settings
- g. Make a screenshot
- h. Press and talk, and the camera will play your voice
- i. Record video to phone storage
- j. Play the saved recordings on a memory card
- k. Open the gallery of recordings saved on the phone
- l. Theme change
- m. Private mode (temporarily turn off the camera)
- n. Automatic night mode
- o. Motion detection
- p. Sound detection
- q. Switching on the siren

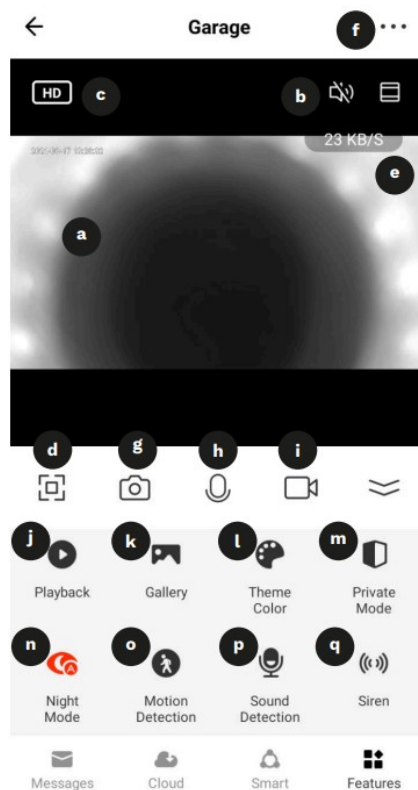

Memory card installation

The camera can record continuously on a memory card. Installation of a memory card:
KM2210 / KM2212

1. Lift the rubber cover.
2. Slide a memory card to the slot, until it clicks.

KM2211

1. Slide a memory card to the slot, until it clicks.

KM2209 / KM2213 / KM2214 / KM2215

1. Unscrew two screws securing the cover.
2. Lift the cover.
3. Slide a memory card to the slot, until it clicks.
4. Close the cover and screw the security screws.



Resetting the camera

If the camera has stopped responding or you want to disconnect it from the app, do the reset.

KM2211

5. Slide a thin object (ex. a paper clip) to the button hole.
6. Press and hold the button for 5 seconds (while still connected to the power supply).

KM2210 / KM2212 / KM2215

1. Lift the rubber cover.
2. Press and hold the button for 5 seconds (while still connected to the power supply).

KM2209 / KM2213

1. Unscrew two screws securing the cover.
2. Lift the cover.
3. Slide a thin object (ex. a paper clip) to the button hole.
4. Press and hold the button for 5 seconds (while still connected to the power supply).

Multiple camera view

To view the feed from multiple cameras (up to 4), press the button on the main screen. Orange frame around the view indicates the camera, that you can move with buttons below.

Camera settings

1. Change the name and icon of the camera
2. Basic information about the device
3. Tap-to-Run Automation
4. Link with the voice assistant

5. Private mode
6. Basic settings (flip the view and set the talk mode)
7. Purchase cloud storage
8. Offline notifications
9. Share the device
10. Firmware update
11. Remove the device

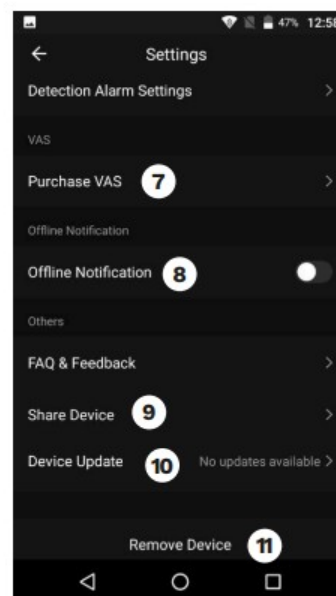
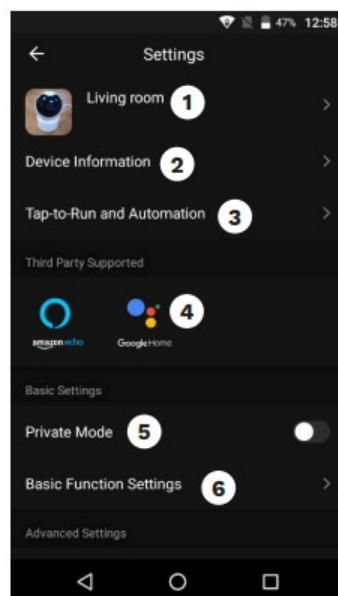
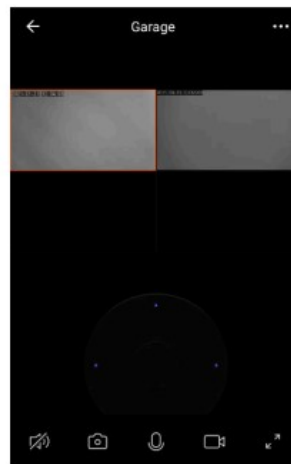
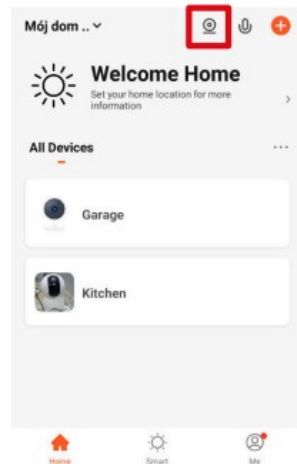

Creating a home

1. From main screen go to the Me menu.
2. Press the Home management button.
3. Press the Create a home button, or select an existing home to edit it.
4. Set the home name. Optional: set the localization of the home.
5. Select the rooms, that are in the home, or add your own.
6. Press the Save button.
7. Go back to "Home" menu and select your home from the list.
8. All devices and rooms will be shown.
9. To add a device to a room, select the room and press the Add device button.
10. Repeat the steps 3-10 from Connecting paragraph. Before clicking the Done button, select a room, in which you

want to add the socket.

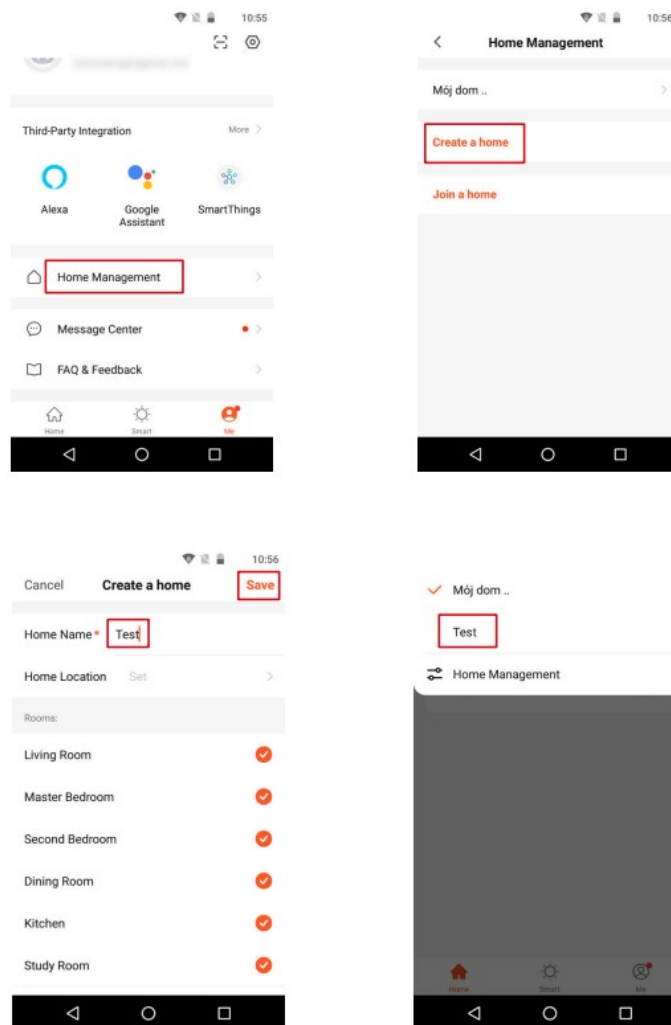

Web browser access

Feed from the camera is available only in Google Chrome.

1. Open the browser and type ipc-eu.ismartlife.me/login in the address bar.
2. Open the Tuya app on your smartphone.
3. Go to the “Me” menu.
4. Press the icon in the top right.
5. Scan the QR code from the browser.
6. Press the button, to authorize the login.
7. The feed from the camera will be shown in the browser.

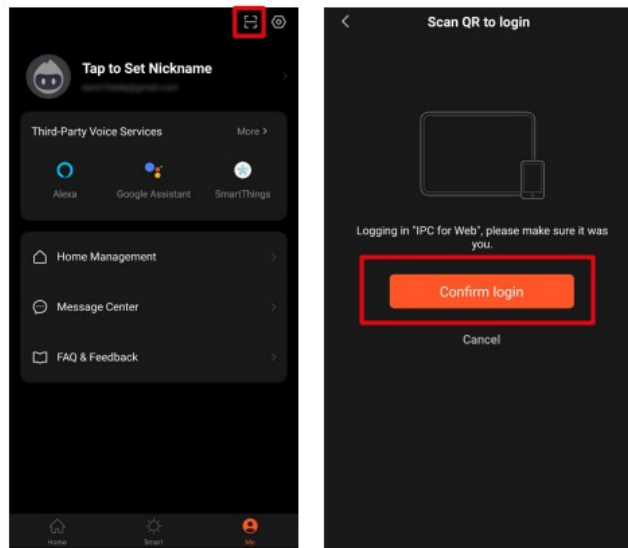

Adding family members

Attention: adding family members requires to be logged in on all devices (main device and members devices).

1. Go to the Me menu and select Home Management.
2. Select your home and press the Add Member button.
 - Automatically:
 - a. Select the App account option.
 - b. Input members name. In the Account, input the email address, that is registered in the app on members device.
 - c. After a moment, there will be a notification in the app on members device, about being added to the home. Confirm it.
 - d. Ready. Now the member can control devices that are added to the home.
 - Manual:
 - a. Select the More option. The invitation code will be shown.
 - b. On the members device, go to the Me menu and go to the Home management menu.
 - c. Select the Join a home option.
 - d. In the Invitation code field, input the invitation code from the main device. Press the Next button.
 - e. Ready. Now the member can control devices that are added to the home.

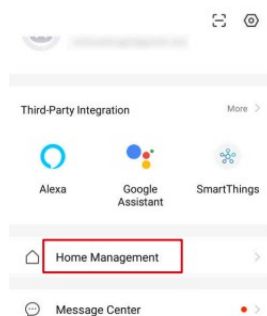

1

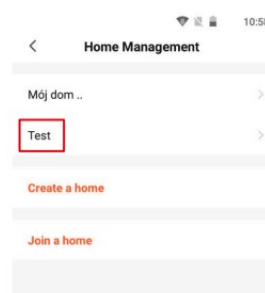

2

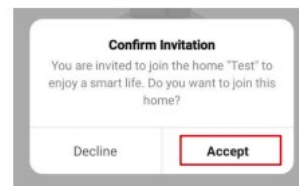
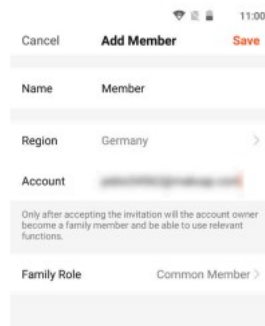
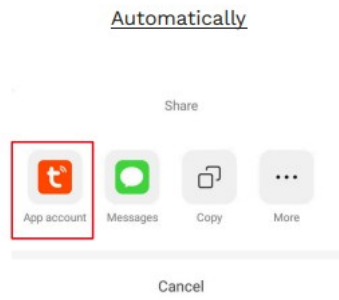
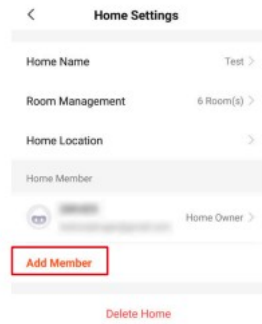

Manual

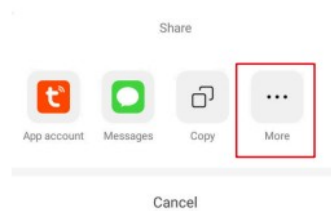

Invitation code: [redacted]
[redacted] invites you to join "Test"
App: Please download ITiva

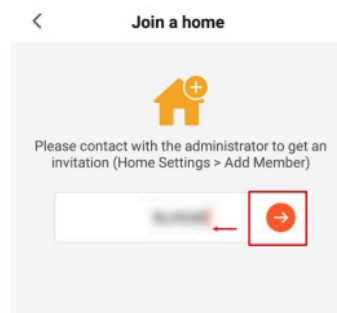
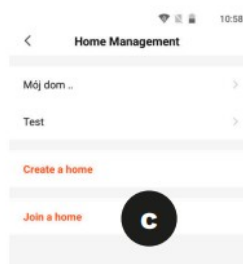

ONVIF

If the camera connected to the DVR requires a login and password, enter the following data:

- Login: admin
- Password: 12345678

Lechpol Electronics Leszek Sp.k. hereby declares that the Wi-Fi security cameras KM2209-15 are consistent with directive 2014/53/UE.

Full text of the EU Declaration of Conformity is available at following Internet address: www.lechpol.pl.



Correct Disposal of This Product

(Waste Electrical & Electronic Equipment)

(Applicable in the European Union and other European countries with separate collection systems) This marking shown on the product or its literature, indicates that it should not be disposed with other household wastes at the end of its working life. To prevent possible harm to the environment or human health from uncontrolled waste disposal, please separate this from other types of wastes and recycle it responsibly to promote the sustainable reuse of material resources. Household users should contact either the retailer where they purchased this product, or their local government office, for details of where and how they can take this item for environmentally safe recycling. Business users should contact their supplier and check the terms and conditions of the purchase contract. This product should not be mixed with other commercial wastes for disposal.

Made in China for Lechpol Electronics Leszek Sp.k., ul. Garwolińska 1, 08-400 Miętno.



<http://www.krugermatz.com/>

Kruger Matz is a registered trademark

Documents / Resources

	<p>Kruger Matz KM2209 IP Wi-Fi Security Camera [pdf] Owner's Manual KM2209 IP Wi-Fi Security Camera, KM2209, IP Wi-Fi Security Camera, Wi-Fi Security Camera, Security Camera, Camera</p>
---	---

References

- ipc-eu.ismartlife.me/
- ipc-eu.ismartlife.me/login
- [Lechpol Electronics Leszek - producent i dystrybutor produktów elektronicznych!](#)
- [User Manual](#)

[Manuals+](#), [Privacy Policy](#)

This website is an independent publication and is neither affiliated with nor endorsed by any of the trademark owners. The "Bluetooth®" word mark and logos are registered trademarks owned by Bluetooth SIG, Inc. The "Wi-Fi®" word mark and logos are registered trademarks owned by the Wi-Fi Alliance. Any use of these marks on this website does not imply any affiliation with or endorsement.