



kronings RT2500 Robot Trolley User Manual

[Home](#) » [kronings](#) » kronings RT2500 Robot Trolley User Manual 

Contents

- 1 [kronings RT2500 Robot Trolley](#)
- 2 [ROBOT TROLLEY Model 2500 and Model 1500](#)
- 3 [Technical Data](#)
- 4 [EC DECLARATION OF CONFORMITY](#)
- 5 [Before Use: Preparing the Robot Trolley](#)
- 6 [After Use: Detaching, Cleaning, Storing, and Maintenance](#)
- 7 [Documents / Resources](#)
 - 7.1 [References](#)
- 8 [Related Posts](#)

kronings[®]

kronings RT2500 Robot Trolley



ROBOT TROLLEY Model 2500 and Model 1500

Congratulations on the purchase of your new Robot Trolley, and thank you for choosing a product from Kronings Aps.

It is important that you read this manual thoroughly before using your Robot Trolley. Unauthorized use or maintenance may result in voidance of the guarantee.

WARNING NOTICE FOR BATTERY

Charge the battery completely before first use!

The Lithium battery installed in this machine has only been charged to part of its capacity (as freight regulations prescribe). It is vital that you charge the battery to its full capacity before operating the machine to ensure high performance and long life. Charging for the first time may take 6-8 hours (see recharging instructions).

Always recharge fully after use until the LED light turns green!

Recharge Periodically!

If the Robot Trolley goes unused for more than two months, it is highly recommended to inspect and charge the battery until the LED on the charger changes from red to green, in order to maintain maximum battery life and performance.

Do not store the Robot Trolley in direct sunlight or at high temperatures. High temperatures may drain the battery quickly.

Failure to follow these instructions will damage the battery and void the battery's warranty!

Batteries: Charging and changing

Battery for Robot Trolley

1. To charge the Robot Trolley battery, connect the charger to the Robot Trolley by placing the charging plug in the outlet on the back end cover.
2. The battery charger displays a constant red light while charging is in progress. Completion of battery charging is indicated by a constant green light.



Battery Charger
Charging



Battery Charger
Fully Charged



Changing the remote control battery

1. Loosen the 4 screws on the back of the remote control and remove the panel.
2. Replace the old battery with a new one of the same type.

Remember to protect the environment when disposing of batteries – do not dispose of them with ordinary household waste.

Technical Data

	Model 2500	Model 1500
Battery voltage	14.8	14.8V (some versions may use 14.4 V)
Battery type	Lithium	Lithium
Battery capacity	Approx. 10,000 mAh	Approx. 5,000 mAh
Battery operating capacity	Approx. 30 min. operation	Approx. 30 min. operation
Battery charger	100-240 V, 2 A	100-240 V, 1 A
Remote control battery	2 x AA 1.5 Volt	2 x AA 1.5 Volt
Max. load stress	300 kg	300 kg
Speed unloaded	Approx. 9 m/min.	Approx. 9 m/min.
Speed loaded	Approx. 7 m/min.	Approx. 7 m/min.
Motor	4 x DC motors	2 x DC motors
Safety function	3 min. Auto shut-off.	3 min. Auto shut-off.
Hauling capacity	Trailers up to 2,500 kg	Trailers up to 1,500 kg
Caterpillar tracks	2 with rubber profiles	2 with rubber profiles
Weight	Approx. 35 kg	Approx. 20 kg

Contents of carton

When unpacking the Robot Trolley, please check that all parts are in the carton. If any of the items are missing: Contact your dealer.

	Model 2500	Model 1500
Operating Manual	1	1
Robot Trolley	1	1
Charger	1	1
Remote control incl. 2x AA batteries	1	1
Transport bag	1	1

+ Suspension fixture consisting of the following parts1:

Security ring (cotter)	1	1
Outer mounting tube	1	1
Inner mounting tube	1	1
Extension for inner tube	1	1
Mounting bracket for inner tube	1	1
Female for mounting Bracket	1	1
Support plate for female mounting bracket	1	0
Clamp	1	0

+ Screws and nuts for suspension fitting.

EC DECLARATION OF CONFORMITY

No.: 1

The manufacturer, and/or any authorized representative of the manufacturer within the European Community, hereinafter referred to as Kronings ApS
Susaavaenget 1, DK-6710 Esbjerg V

declares that the products

Robot Trolley CT1500 and Robot Trolley CT2500

have been manufactured in conformity with the provisions of the following EC directives

- 98/37/EC – The Machinery Directive
- 99/5/EC – The R&TTE Directive
- 2004/108/EC – The EMC Directive
- 2002/95/EC – The RoHS Directive
- 2002/96/EC – The WEEE Directive
- 2006/42/EC – The EU machine directive

and that all standards mentioned overleaf have been applied.

The last two digits of the year of the CE approval: 12

Reference to standards (or parts hereof) applied in connection with this Declaration of Conformity:

• harmonized standards:

- EN 953: 2003 Safety of Machinery – Guards – General requirements for the design and construction of fixed and movable guards
- EN 954-1:2003 Safety of Machinery. Safety-related parts of control systems. Part 1: General principles for design
- EN 1037:1998 Safety of Machinery – prevention of unexpected start-up
- EN 12100-1:2005 Safety of Machinery – Basic concepts and general principles for design –Part 1: Basic terminology, methodology
- EN 12100-2:2005 Safety of Machinery – Basic concepts and general principles for design –Part 2: Technical principles
- EN 13850:2006 Safety of Machinery – Emergency stop – Principles for design
- EN 13857:2008 Safety distances to prevent hazard zones being reached by upper and lower limbs
- EN 60204-1:2006 Safety of Machinery – Electrical equipment of machines – Part 1: General requirements

Kronings ApS

Susaavaenget 1, DK-6710 Esbjerg V, Denmark

Before Use: Preparing the Robot Trolley

Checking the status

1. Unpack the Robot Trolley and check that the Robot Trolley is clean and not broken
2. Make sure the Robot Trolley battery is charged according to instructions

Mounting the suspension fitting – standard bracket

REGIONAL VARIANTS

Some countries and makes of caravan may require a special bracket version. Please inquire with your dealer.

If there is a plastic cover over the side member system on the caravan, it can be helpful to remove it while mounting the suspension fitting.



1. When mounting the suspension fitting from the Robot Trolley onto the caravan, start by gliding the two mounting tubes, A1 and A2, together, and then placing them up inside the side members.

2. Next, loosely screw on the mounting bracket to the inner mounting tube, and screw the female piece to the mounting bracket. If there are larger distances between side members, place the extension tube inside the inner mounting tube.

The illustration below shows the assembled suspension fitting mounted on the side members2:



3. Slide the entire suspension fitting as far back on the side members as possible to put maximum weight on the Robot Trolley. Do not push the suspension fitting so far back that mounting and removing the Robot Trolley becomes difficult.

The following illustration shows the optimal placement of the suspension fitting on the caravan:



4. Push the Outer and Inner Mounting Tube as far from each other as possible, towards the sides of the side members. Tighten the left and right brackets so that the bent undersides of these are positioned precisely against the outer side of the side members. Make sure that the bolts are tightened to the maximum extent. (If the caravan's bearers are extremely narrow, and the mounting tubes cannot be pressed far enough together upon mounting, you can use a hacksaw to shorten mounting tube A2. There must be minimum 10-15 cm inner overlap of the Outer and Inner mounting tubes.)
5. Once the suspension fitting is adjusted and fastened to the side members, tighten the clamp bolt into the side of the inner mounting tube.

Mounting of Robot Trolley

1. When mounting the Robot Trolley on the suspension fitting, adjust the height of the suspension fitting using the nose/jockey wheel.
2. The suspension fitting mounted on the Robot Trolley fits into a slit on the underside of the mounting fitting on the left side (seen from the ball catch) and can be pushed into place in this slot.
3. After pushing the Robot Trolley into the slot in the mounting fitting, attach the factory-provided cotter ring, which locks the Robot Trolley in place.
4. After attaching the cotter ring to the Robot Trolley, raise the support wheel to its highest position, and release the hand brake. This shifts the weight of the caravan onto the Robot Trolley. You are now ready to tow your caravan.

Illustration of the Robot Trolley mounted on the side members of the caravan:



VARIANTS
CT2500 is equipped with a tall or low tower with ball joint
CT2500 Tall tower
Height is adjustable
CT2500 Low tower



Using the Robot Trolley

SOME ADVICE ON SAFETY AND OPERATION BEFORE STARTING

1. Familiarize yourself with the operating manual, and practice maneuvering the caravan on a flat surface before attempting to maneuver it on sloping surfaces. We recommend testing your Robot Trolley at home – also without a caravan – so you can try out the different maneuvering options.
2. Load: The Robot Trolley is designed for moving caravans weighing up to approx. 2500 kg (Model CT2500) or 1500 kg (Model CT1500). In order for Robot Trolley to function optimally, the ball weight must be at least 75-85 kg. This ball weight creates about 120-150 kg of pressure on the Robot Trolley. Too little weight on the Robot Trolley may result in poor gripping and poor towing results. Greatest pressure is achieved by mounting the Robot Trolley as far back on the side members as possible.
3. Level surfaces: To ensure optimal transfer of the Robot Trolley's power to the surface it is to operate on, the Robot Trolley must move in the direction of the antenna, i.e. forward. (Except on sloping surfaces, see below).
4. Sloping surfaces: Operating the Robot Trolley on sloping surfaces may shift and decrease the pressure on the Robot Trolley, resulting in poor contact with the terrain.
 - When using your Camper-Trolley to move your caravan or trailer UP a slope or edge, the CT must PUSH the caravan up the slope – if necessary, one wheel at a time. Optionally, use a ramp.
 - When moving your caravan DOWN a slope the CT must LEAD the caravan DOWN the slope.

ATTENTION: If going downhill, it is very important that the Robot Trolley is turned 180 degrees, so that it is moving in reverse, down the hill, i.e. with the antenna opposite the maneuvering direction and facing the caravan. This is important, as the Robot Trolley might otherwise tip over forward.

Special precaution

5. Be aware that if towing down very steep inclines or on wet, oily surfaces, it may be necessary to use the hand brake on your caravan during operation if the Robot Trolley is unable to hold the caravan or the caterpillar tracks cannot adequately grip the surface.

Activating and Pairing the Robot Trolley with the remote control

The Robot Trolley comes pre-paired with the remote control.

- Turn on the Robot Trolley by simply pressing the Start/Stop button for maximum 1-2 seconds.
- Turn on the remote control by pushing the forward button () once.
- The Robot Trolley is now ready to use.

The start/stop button and operating status indicator are located on the front of the Robot Trolley

(The diode lighting can be difficult to see in strong sunlight):



The maneuvering buttons on the remote control: Forward: (↑); Turn right: (→)
Backward: (↓); Turn left: (←)

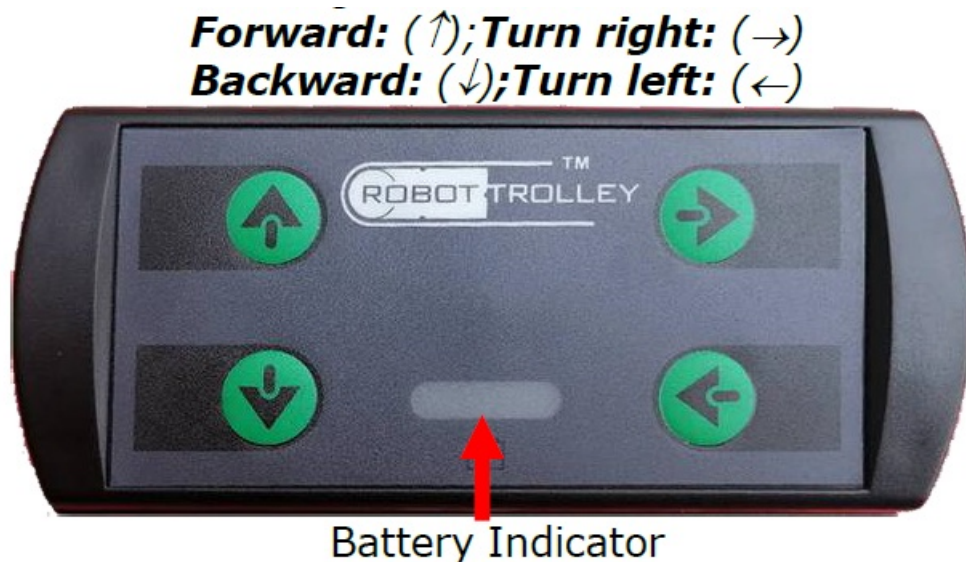

The battery indicator shows the Robot Trolley's remaining battery status. If the capacity is too low, the CT may not respond correctly. If the indicator itself weakens, the remote control battery needs to be replaced, otherwise the CT may not respond correctly.

Maneuvering the Robot Trolley

The Robot Trolley logo on the remote control must always point toward the trolley. Use both hands on the remote control, and hold it horizontally during use.

- **Forward:** To move forward, in the same direction as the antenna, hold down forward button (↑).
- **Backward:** To move backward/reverse, hold down the back button (↓).
- **Turn:** To turn, hold down the forward (↑) or backward (↓) button while at the same time holding down one of the turn buttons of the remote control to turn right (→) or left (←). The Robot Trolley will only turn if you first hold the forward or backward button, followed by a turn button.
- **Stop:** To stop the Robot Trolley from moving, simply release the forward or backward button.

Deactivating the Robot Trolley

- The Robot Trolley shuts off automatically after 3 minutes if the remote control is not activated within that period.
- If you do not want to wait 3 minutes until the Robot Trolley shuts off automatically, press the start/stop button to disconnect the power manually on the Robot Trolley. Turn off the Remote Control LED light by holding down the Right Button (→), and then pressing the left button(←) at the same time

After Use: Detaching, Cleaning, Storing, and Maintenance

Detaching the Robot Trolley

Never leave the Robot Trolley mounted to the caravan while towing the caravan behind a car.

It is important that you always detach the Robot Trolley after use and place it in the storage box/bag together with the remote control.

When you have finished towing the caravan and you want to disconnect the Robot Trolley, pull the parking brake and adjust the nose/jockey wheel so that the caravan is slightly elevated. This takes the weight off the Robot Trolley.

Remove the cotter ring and use the remote control to move the Robot Trolley out of the lock fitting (or pull it out manually).

Cleaning

If you have used the Robot Trolley in wet or dirty conditions, you can clean it in the following manner:

Remove pebbles, clay, grass and the like from the belts. Then give it a gentle cleaning using a small amount of clean water and a brush or cloth. Do not use soap or cleansing agents or a high-pressure cleaner.

Storage

Put the Robot Trolley in the transport box/bag delivered from the factory. If the storage box/bag should become damaged, discard it. A new plastic storage box/bag may be obtained from your Robot Trolley distributor.

Store the Robot Trolley in dry, frost-free conditions.

Do not store the Robot Trolley in direct sunlight or at high temperatures. High temperatures may drain the battery quickly.

Maintenance

The Robot Trolley should be operated at least every second month in order to keep the battery healthy.

If the Robot Trolley goes unused for more than two months, it is highly recommended that you operate the Robot Trolley for a short while and then charge the battery until the LED on the charger turns green, in order to maintain maximum battery life and performance.

Repair

Please contact your local dealer for repair issues.

Complaints

In case of any claim regarding this product, please contact your dealer and provide information about: The cause of the error or defect and the date of purchase. Present your invoice as proof of purchase.

Children

Note that children under age 3 should not play with any plastic bags or small parts from the Robot Trolley, as there is a risk of suffocation. Children should not tow the caravan with the remote control.

Kronings ApS

Address: Susaavaenget 1, DK-6710 Esbjerg V, Denmark

Website: www.kronings.com

Documents / Resources

 <p>ROBOT TROLLEY</p> <p>kronings</p>	<p>kronings RT2500 Robot Trolley [pdf] User Manual</p> <p>RT2500, RT1500, RT2500 Robot Trolley, RT2500, Robot Trolley, Trolley</p>
---	--

References

- [🌐 Home - Get Out And Stay Home - #HeroCamper](#)

Manuals+.