

KRIBA Z Series Pool Filter |



KRIBA Z Series Pool Filter Instruction Manual

[Home](#) » [KRIBA](#) » KRIBA Z Series Pool Filter Instruction Manual 

Contents

- 1 KRIBA Z Series Pool Filter
- 2 SAFETY NOTICE, PLEASE READ THEM CAREFULLY
- 3 PACKAGING COMPONENTS
- 4 BEFORE CONNECTING
- 5 SELECTOR VALVE
- 6 FILTRATION
- 7 TROUBLESHOOTING
- 8 Documents / Resources
 - 8.1 References
- 9 Related Posts



KRIBA Z Series Pool Filter



SAFETY NOTICE, PLEASE READ THEM CAREFULLY

- All electrical connections should follow the European Standard regulation

NF C15-100

NF EN 60-335-2-41

- Which refers to the «construction of electrical installations», both in outdoor as in indoor pools, or similar regulations specific of each area or country.
- Electric installation should be performed by a professional qualified for electric installations.
- When filling the tank with sand, sand should not exceed 2/3 of the tank height.
- Do not start the device before it has been previously primed.
- When handling the filter or valve, always disconnect it from the electricity supply.
- Do not allow children or unauthorized adults to manipulate the filter.

PACKAGING COMPONENTS

The filter you just purchased has been specially designed for pools. Thanks to its design and functionality you have all necessary elements to clean and filtrate the water of your pool. This packaging contains the filter body and the valve. Main components of this filter are the following:

BEFORE CONNECTING

THE FILTER

Location

The filter must be installed as close to the pool as possible, preferably within 50 meters of the surface of the pool. Be sure there is a drainpipe in the spot where the filter will be located. This drainpipe must be adequately sized to the installation flow.

Be sure the surface area where the filter is installed is horizontal, stable, resistant to the weight of the filter, and is completely clean.

There must be enough space in the area around the filter so that the required inspections and maintenance throughout the life of the pool can be carried out.

Installation

Once the filter has been placed in the right location proceed as follows:

FIG. POS. **DENOMINATION**

- 1 1 Cover
- 1 2 Filter body
- 1 3 Out filter
- 1 4 Filter base
- 2 1 Manometer
- 2 2 Air relief valve



Fig.1

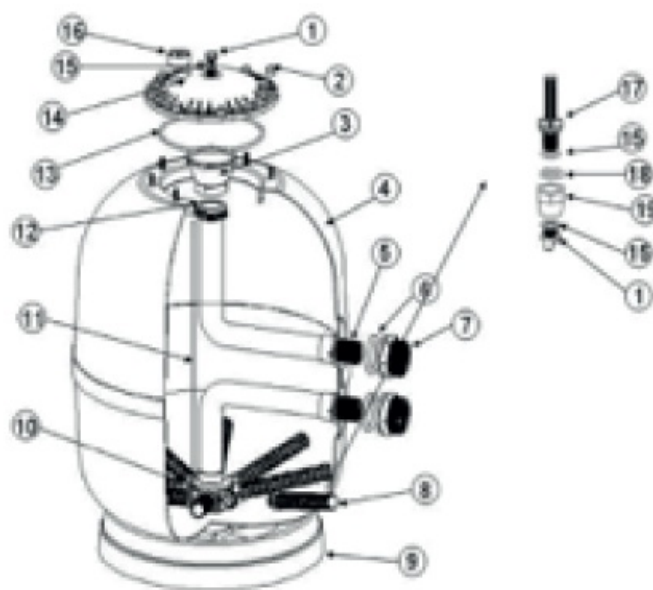

Make the three connections needed for the selector valve:

1. pump tubing to the valve,
2. valve to the waste drain

3. and from the valve to pool return

Each of the three outputs is identified on the valve. See Figure No. 3.

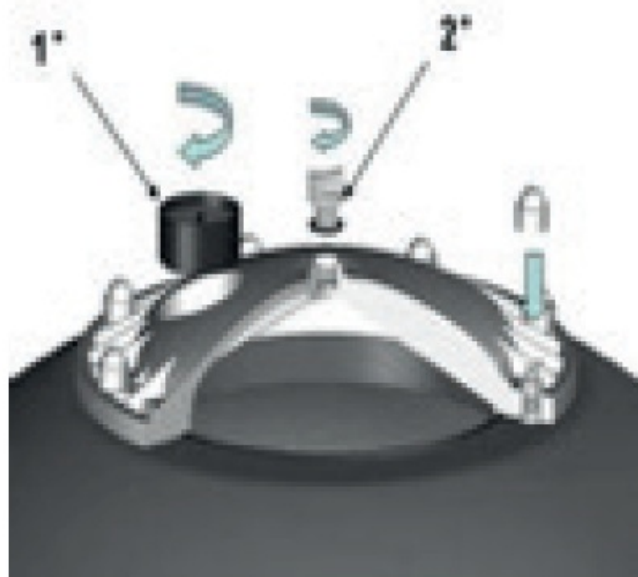

Fig.2

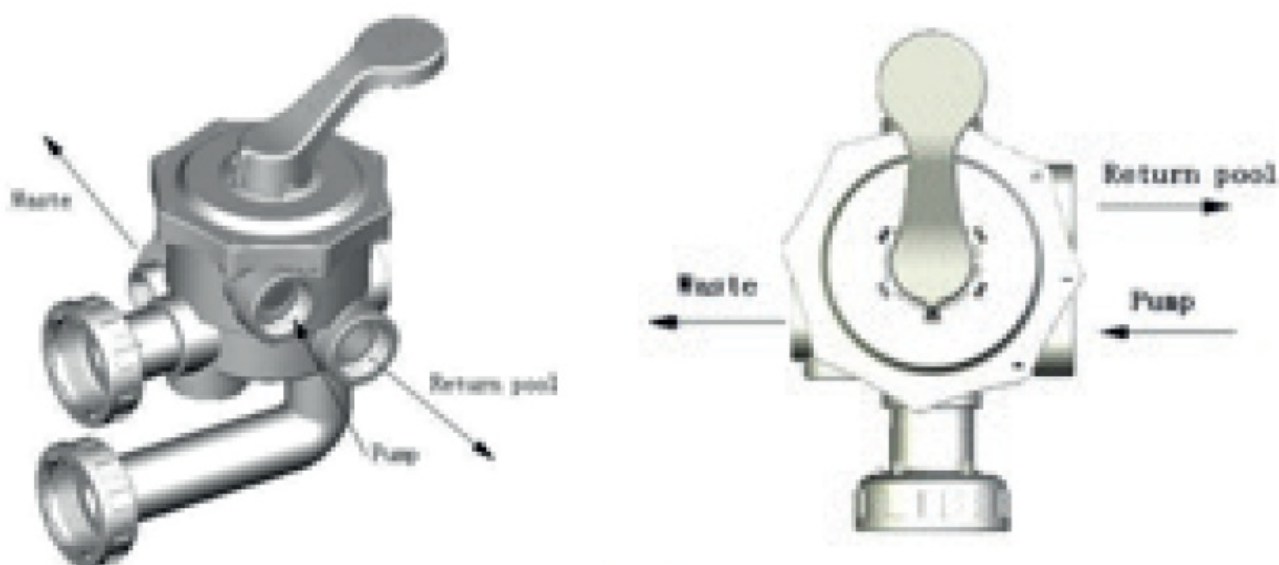

Fig.3

- Install the selector valve in the filter, ensuring that the gaskets between the valve and the filter are correctly positioned and none of the gasket has dropped inside the filter tank. Place the bag to avoid sand getting into the pipe.
- Fill the filter with water up to the half way point. Pour the necessary quantity of sand into the filter. It must be filled with silica sand with a particle size from 0.4 to 0.8 mm. with the quantity indicated in the table of characteristics. Silica sand should be only replaced in case of sand losses. See figure no. 4



Fig.4

- Clean the area around the cover seal and remove the bag..
- The nuts of the cover must be strongly tightened.
- Once the filter is filled with sand it is necessary to carry out a wash cycle. Proceed as described in the paragraph 4.2.

SELECTOR VALVE

The selector valve has a handle of 6 positions that selects any of the necessary operations to obtain the maximum efficiency from the filter: filter, backwash, recirculation, waste, rinse and closed. These 6 positions are identified on the label on the top of the valve.

Manometer assembly

For the assembly of the manometer is not necessary the use of tools or Teflon tape; use the o-rings and fix it by tightening it with your hands (see figure no. 2).

Change of valve handle function (see figure no. 5)



Fig.5

IMPORTANT: The pump should be switched off when the position of the selector valve handle is being changed

- Press softly the valve handle until freeing the rib from its housing (1º)
- Proceed to turn the handle to its desired position until the rib fits in the housing in front of the function (2º)
- Release the handle softly, checking that the rib is perfectly coupled in the housing

FILTRATION

This filter is based on the silica sand inside the tank, capable of retaining any dirt coming from the pool. The water is drawn in from the bottom of the pool and is carried through the pump to the filter. The silica sand load through which the water circulates in a descending motion, retains the debris suspended in the pool and send clear water back to the pool.

Trees, insect, bath frequency, weather conditions determine the dirt degree of the water, as well as the frequency of cleaning the sand filter (see paragraph 4.2.). Filtration is only one part of maintaining clean swimming pool water, and it is inseparable from the chemical treatment; one without the other will not achieve the desired result.

NEVER PLACE THE CHEMICAL

PRODUCT IN THE BASKET OR THROUGH THE FILTER. IT COULD DAMAGE THE COMPONENTS OF THIS DEVICE AND REDUCE ITS EFFICIENCY.

Priming of the filter

The filter should be at all times correctly primed. Not being properly primed means that an air chamber has appeared inside the filter tank, thus preventing the proper circulation of the water, and, consequently, the proper functioning if the filter.

How to prime the filter?

- Place the valve handle in the Filter position. Slightly loosen the drain screw placed by the manometer. This will allow the air kept inside the filter body to escape the tank.
- Once ONLY water is coming out the drain (between 10 and 20 seconds), tighten again the drain screw.

NEVER MANIPULATE THE VALVE WITHOUT SWITCHING OFF THE PUMP

Filtration

- Filtration is only one part of maintaining a clean swimming pool, and it is inseparable from the chemical treatment; through the filter the water is physically cleaned, retaining the debris particles in the water. In fact the purification process consists of a perfect combination of the two treatments; chemical and physical.
- With the pump switched off, move the selector valve handle to "FILTRATION".
- Turn on the pump.
- While it is operating, it is best to periodically observe the pressure gauge, where the filter saturation degree is indicated.

Before using the filter for the first time, the sand should be backwashed (see paragraph 4.2.)

When it is necessary to wash the filter sand?

Each load of sand forms thousands of channels which pick up all the material contained and caught up in the filtering process, the number of free channels allowing the water to pass is continually decreasing.

This is why the pressure rises progressively until it reaches the saturation level. At this pressure, yellow or red area of the manometer, the filtering sand is unable to collect any more impurities and must be cleaned.

If you observe a decrease of the return water flow, check also the filter pressure.

Wash

Con el proceso de autoclavado procede a With the valve in the Backwash position, the sand inside the filter will be cleaned by reversing the water flow direction.

Proceed as follows:

- Switch off the pump. Never manipulate the valve handle before switching off the pump.
- Press the valve handle until freeing the rib from its housing, figure 5.
- Turn on the handle until the BACKWASH position, figure 5.
- Switch on the pump and let it run for 2 minutes. Carry out this process until you can see transparent water running past the valve viewfinder.
- Switch off the pump
- Turn on the valve handle to the RINSE position. Switch on the pump again and let it run for 1 minute.
- Switch off the pump and turn the handle to the FILTER position
- Switch on the pump and proceed with the filtration process.

Rinse

After the carrying out the "BACKWASH" operation on the filter and placing the installation in the "FILTER" position, the water flowing into the swimming pool will be cloudy for a few seconds, so to prevent it from reaching the swimming pool there is a "RINSE" position for the selector valve which is operated as follows:

- immediately after the "BACKWASH" switched off the pump
- Turn the valve handle to the "RINSE" position, figure 5.
- Switch on the pump and let it run for 1 minute. This position ensures that the filtered water goes directly to the drain.
- Switch off the pump and turn the handle to the FILTER position

- Switch on the pump and proceed with the filtration process

Closed

As its name indicates, this position is for closing off the water from the filter to the pump and it is used for opening the collector prefiltre of the pump.

Recirculation

In this position, the selector valve allows the water coming from the pump to go directly to the swimming pool without passing through the inside of the filter.

Waste

If the swimming pool needs to be completely drained, this can be done using the filter pump. In order to do this, the selector valve should be placed in the "WASTE" position. The motor should run with the main drain valve fully open, for the pump to have sufficient suction. For the pump to suction, keep the main drain pipes full of water. Before drainage, make sure that the skimmer valves and the bottom cleaner valves are closed.

Keep in mind that the pool water will not be 100% removed, some centimeters will always be left. Once the pump does not suction any more water, switch it off.

TROUBLESHOOTING

PROBLEM	CAUSE	SOLUTION
The filter only provides a small volume of the filtered water.	Valve handle is not correctly placed in the FILTER position	Switch off the pump and place the handle in the correct position
Vacuum heads have poor suction.	Filter is above the water level and it is not correctly primed	Place the filter in a correct location and prime it.
	Pool suction valves are closed	Open the pool suction valves
	Suction lid or skimmer lid are not removed	Remove the skimmer or suction lid
Intermittent functioning	Skimmer water level too low	Fill up the pool with water and prime the filter
	Filter is not correctly primed	Proceed to prime the filter

Poor filter flow	Filter is dirty	Perform BACKWASH
	Filter is not correctly primed	operation
		Prime the filter
Water appears in the filter	Union between cover and	Clean the remaining sand
mouth	filter body is dirty	from the filter mouth, place
	Cover is not tightened	the o/ring in the cover and
		tightened the cover strongly
Filter valve drops by the waste	o/ring damaged by incorrect	Change the upper valve lid
terminal	usage of the chemical	Do not place chemical
	product	product inside the skimmer
	Valve lid broken due to	basket
	wrong usage or excessively	Change the vale lid, do not
	tightening	tighten excessively.

Documents / Resources

	<p>KRIBA Z Series Pool Filter [pdf] Instruction Manual</p> <p>Z-01003, Z01002, Z-01017, Z-01013-Z01014, 807505, Z-01005-Z-01006, Z-01009-Z01010-Z-01011, P01-P02-P03, Z-01012, T-06750, Z-01018, 829520, Z01001, 801702, Z-01004, Z-01008, 802204, Z-01007, Z Series Pool Filter, Z Series, Pool Filter, Filter</p>
---	--

References

- [User Manual](#)

Manuals+. [Privacy Policy](#)

This website is an independent publication and is neither affiliated with nor endorsed by any of the trademark owners. The "Bluetooth®" word mark and logos are registered trademarks owned by Bluetooth SIG, Inc. The "Wi-Fi®" word mark and logos are registered trademarks owned by the Wi-Fi Alliance. Any use of these marks on this website does not imply any affiliation with or endorsement.