



Kreg Multi-Mark KMA2900 Multi Purpose Marking and Measuring Tool User Manual

[Home](#) » [Kreg](#) » Kreg Multi-Mark KMA2900 Multi Purpose Marking and Measuring Tool User Manual 

Contents

- [1 Kreg Multi-Mark KMA2900 Multi Purpose Marking and Measuring Tool User Manual](#)
- [2 User Manual Guide d'utilisation • Manual del usuario](#)
- [3 Position](#)
- [4 Position #2](#)
- [5 Position #3](#)
- [6 More Kreg Products](#)
- [7 Kreg Rip-Cut™](#)
- [8 Kreg Adaptive Cutting System Master Kit](#)
- [9 Read More About This Manual & Download PDF:](#)
- [10 Documents / Resources](#)
 - [10.1 References](#)

Kreg Multi-Mark KMA2900 Multi Purpose Marking and Measuring Tool User Manual

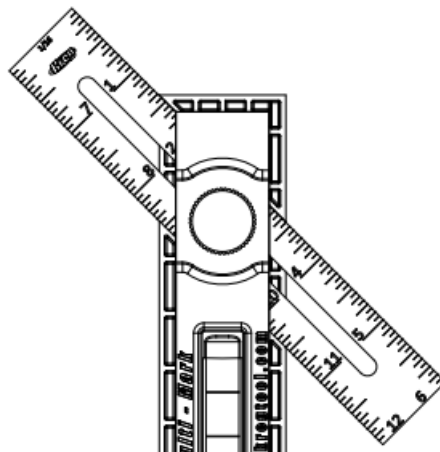

User Manual Guide d'utilisation • Manual del usuario

Congratulations on your purchase of a Kreg Multi-Mark™ multi-purpose layout tool. For more ideas on how to use this product, please see the video on www.kregtool.com.

To change the position of the Multi-Mark's scale to one of the three positions shown below, simply loosen the brass thumb screw, reposition the scale as needed, and retighten the thumb screw.

Position

The Multi-Mark™'s first position sets the scale at a 45° angle. This is good for marking up mitered joints such as picture frames and door trim

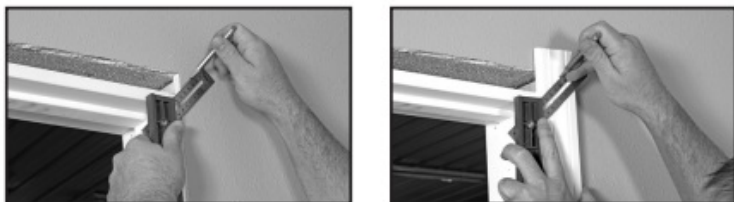

Position #2

The Multi-Mark™'s second position sets the scale at a 90° angle. This is good for squaring your projects and making marks at a 90° angle

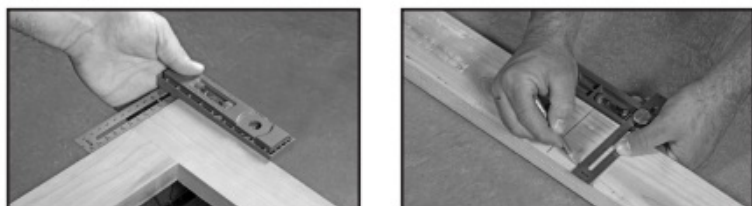

Position #3

The Multi-Mark™'s third position sets the scale at a 0° angle, in line with the base.

This is good for use as a depth gauge on your table saw as well as a general scribing tool or simply transferring measurements.

More Kreg Products



Kreg Rip-Cut™



Kreg Adaptive Cutting System Master Kit



Read More About This Manual & Download PDF:

Documents / Resources

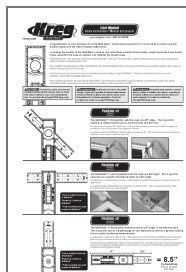

[Kreg Multi-Mark KMA2900 Multi Purpose Marking and Measuring Tool](#) [pdf] User Manual KMA2900, Multi-Mark KMA2900, Multi-Mark KMA2900 Multi Purpose Marking and Measuring Tool, Multi Purpose Marking and Measuring Tool, Marking and Measuring Tool, Measuring Tool

References

- [Welcome to Kreg Tool](#)
- [P65Warnings.ca.gov](#)

