

[Skip to content](#)

Manuals+

User Manuals Simplified.



kreafunk Stone Bluetooth Speaker Instruction Manual

[Home](#) » [KREAFUNK](#) » kreafunk Stone Bluetooth Speaker Instruction Manual

Contents [hide](#)

- [1 kreafunk Stone Bluetooth Speaker](#)
- [2 Product Usage Instructions](#)
- [3 Overview](#)
- [4 Technical specifications](#)
- [5 FCC statement](#)
- [6 Safety and maintenance instructions](#)
- [7 Documents / Resources](#)
- [7.1 References](#)
- [8 Related Posts](#)



kreafunk Stone Bluetooth Speaker

kreafunk Stone Bluetooth Speaker-fig1

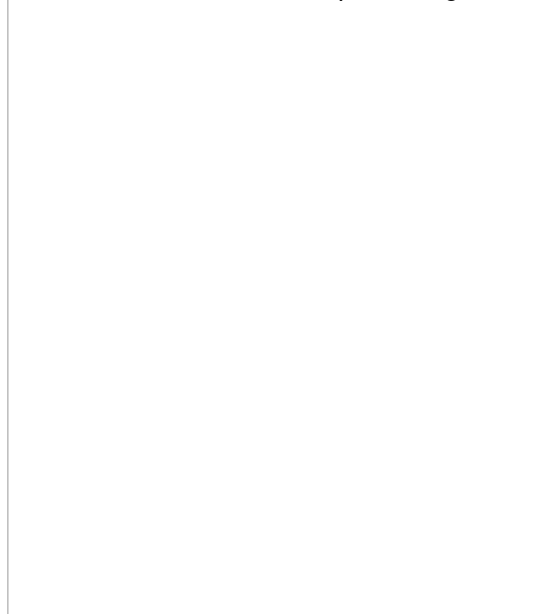

aJAZZ Stone Bluetooth Speaker

The aJAZZ Stone Bluetooth Speaker is a portable wireless speaker that can be paired with Bluetooth-enabled devices to provide high-quality audio playback. It comes with a range of features and functions that make it easy to use and maintain.

Technical Specifications:

- Input voltage: 5V/2A
- Output power: 5W
- Battery capacity: 1200mAh
- Bluetooth version: 4.2
- Wireless range: up to 10 meters

Safety and Maintenance Instructions:

To ensure the safe and proper use of the aJAZZ Stone Bluetooth Speaker, please follow these guidelines:

- Do not expose the speaker to water or moisture.
- Do not use the speaker near heat sources or flames.
- Do not disassemble or modify the speaker in any way.
- Keep the speaker away from children and pets.
- Clean the speaker with a soft, dry cloth.

Product Usage Instructions

Step 1: Power On/Off

To turn on/off the speaker, press and hold the power button located on the back of the speaker for 2 seconds.

Step 2: Bluetooth Pairing

To pair your Bluetooth-enabled device with the speaker, follow these steps:

1. Press and hold the Bluetooth button on the back of the speaker for 2 seconds to enter pairing mode. The LED indicator will flash blue.
2. On your device, turn on Bluetooth and search for available devices. Select “aJAZZ Stone” from the list of available devices to connect.
3. Once connected, the LED indicator will turn solid blue.

Step 3: Charging

To charge the speaker, connect the provided USB cable to a power source and the charging port on the back of the speaker. The LED indicator will turn orange while charging and green when fully charged.

Step 4: Playback Controls

To control playback, use the buttons located on the top of the speaker:

- Play/Pause: Press the play/pause button once to start or stop playback.
- Volume: Press the “+” or “-” button to adjust the volume.
- Next/Previous Track: Press and hold the “+” or “-” button to skip to the next or previous track.

Step 5: Voice Assistant

To activate your device’s voice assistant, press the multifunction button located on the top of the speaker three times.

Step 6: TWS Mode

To enable True Wireless Stereo (TWS) mode, follow these steps:

1. Ensure that two aJAZZ Stone speakers are turned on and paired with your device.
 2. Press and hold the TWS button on both speakers simultaneously for 2 seconds.
 3. The LED indicators on both speakers will flash white to indicate successful pairing.
- For more information and technical specifications, please refer to the product manual.

Stone

At Kreafunk, we love to incorporate natural materials and sustainability in our design. Concrete has added an honest authenticity to this product –

an eco-friendly substance that is kind to the Planet.

Like nature, each product is unique and has its own expression. The surface is rough and will, in time, achieve a unique patina. It hasn’t had any surface treatment or chemistry, so its use and surroundings will naturally affect the material. You can use a wet cloth to wipe the concrete surface, but the patina will stay just like the sun in the sky.

This product is in compliance with the essential requirements and other relevant provisions of Directive 2014/53/EU.
The declaration of conformity may be consulted at: <https://Kreafunk.com/pages/declaration-of-conformity>

Overview

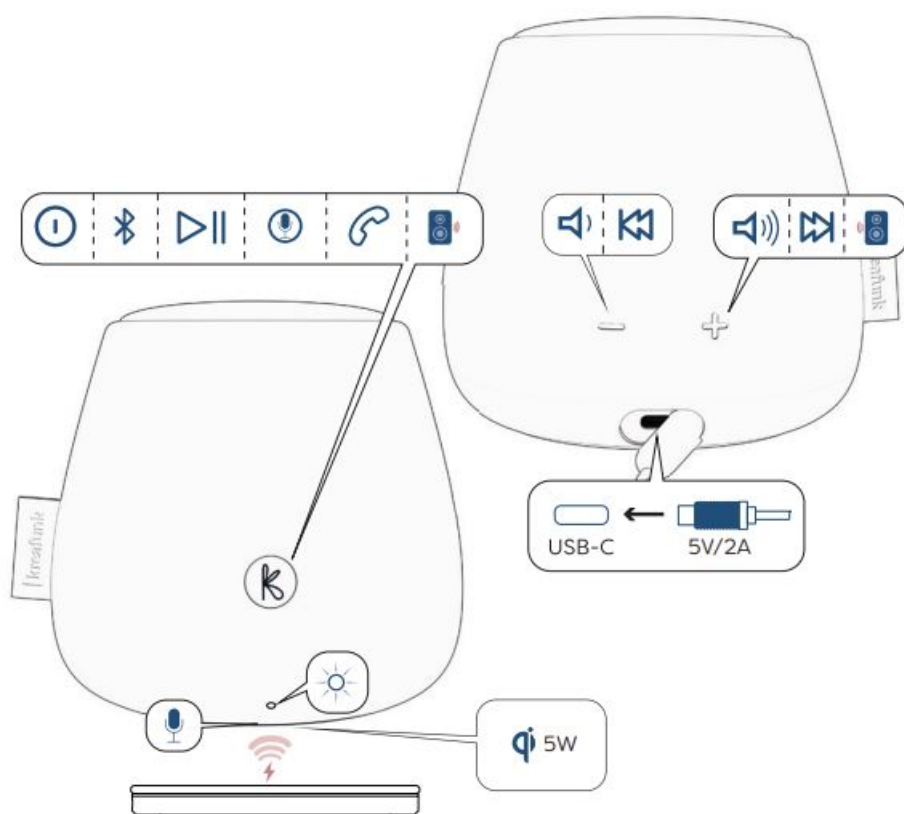

On/off

Step 1

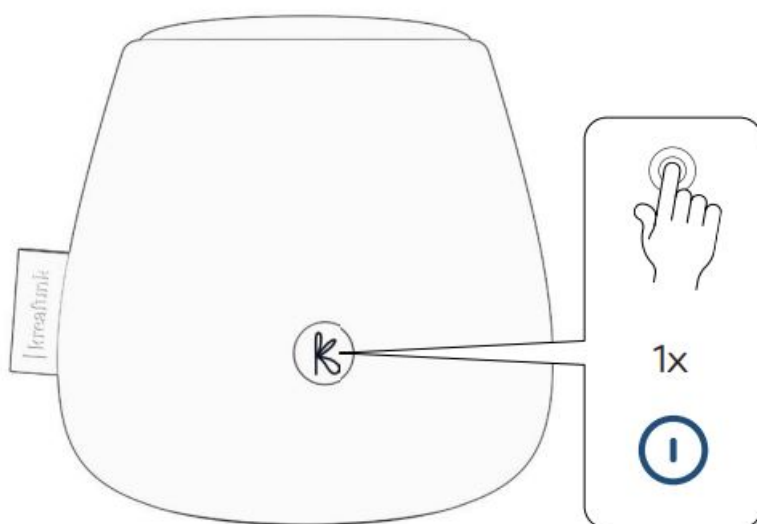

Listen via bluetooth

Step 2

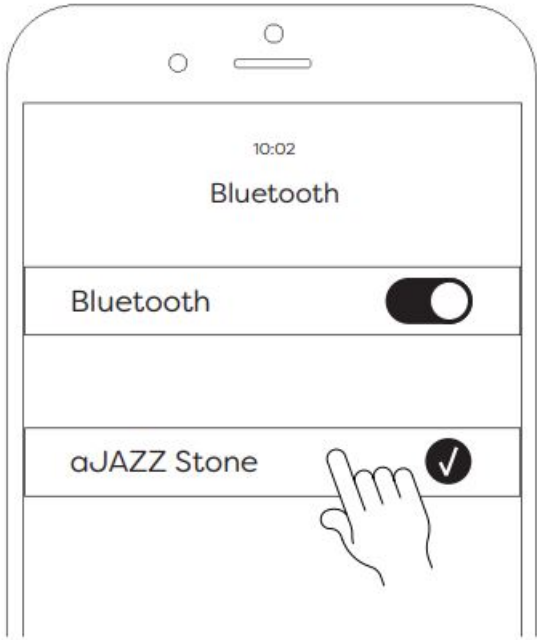

Manual bluetooth pairing

Step 1

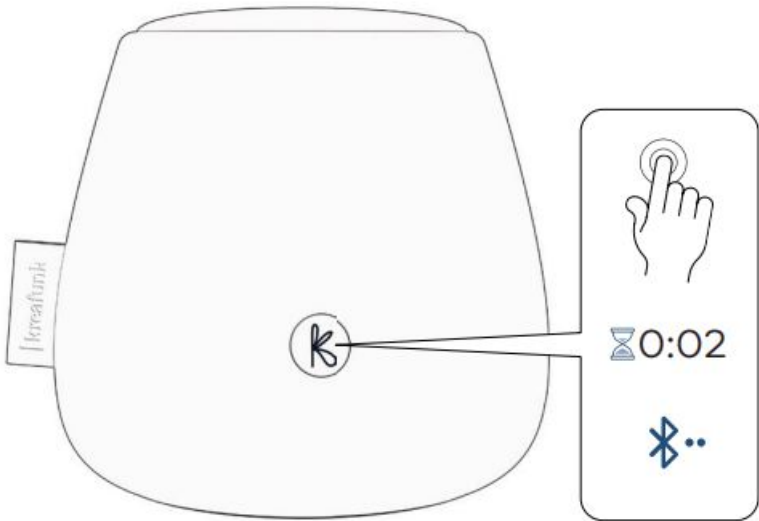

Listen via bluetooth

Step 2

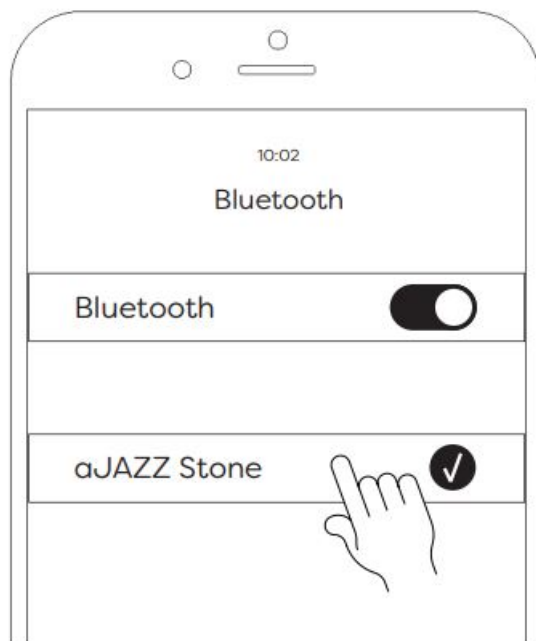

Charging

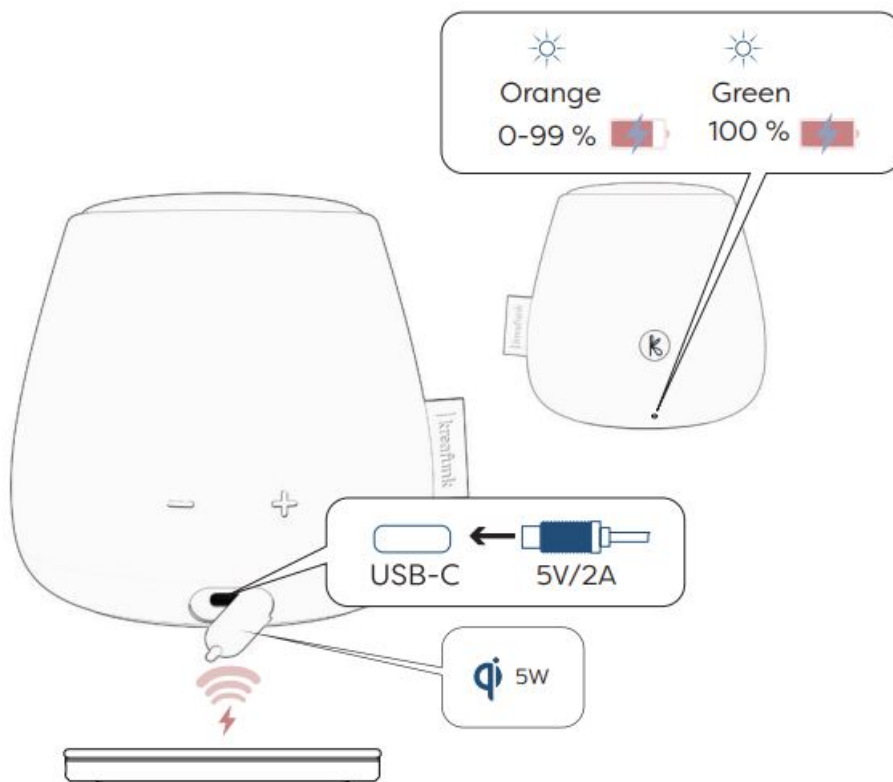

Battery status

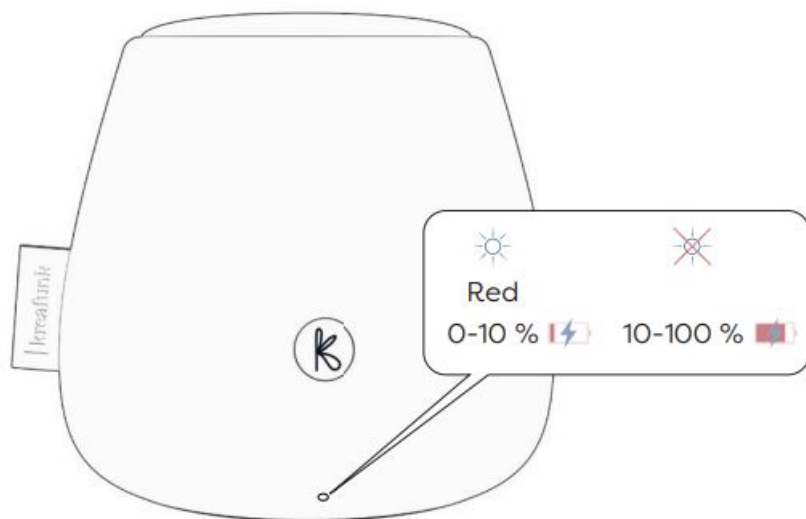

Play/pause

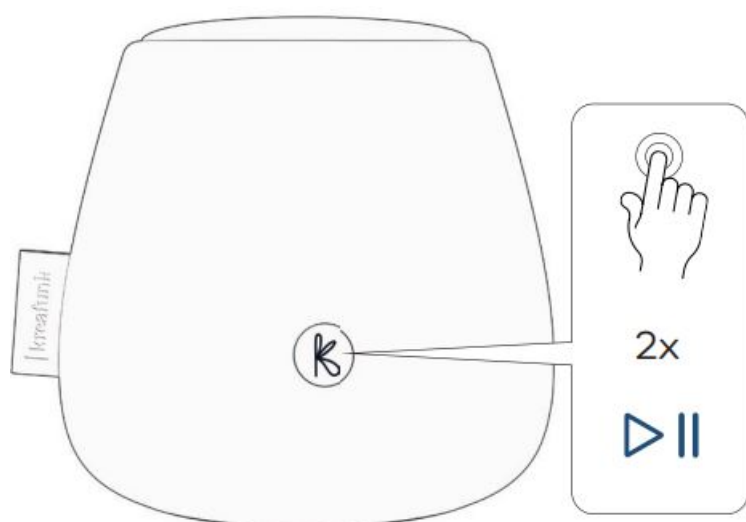

Change volume, change track

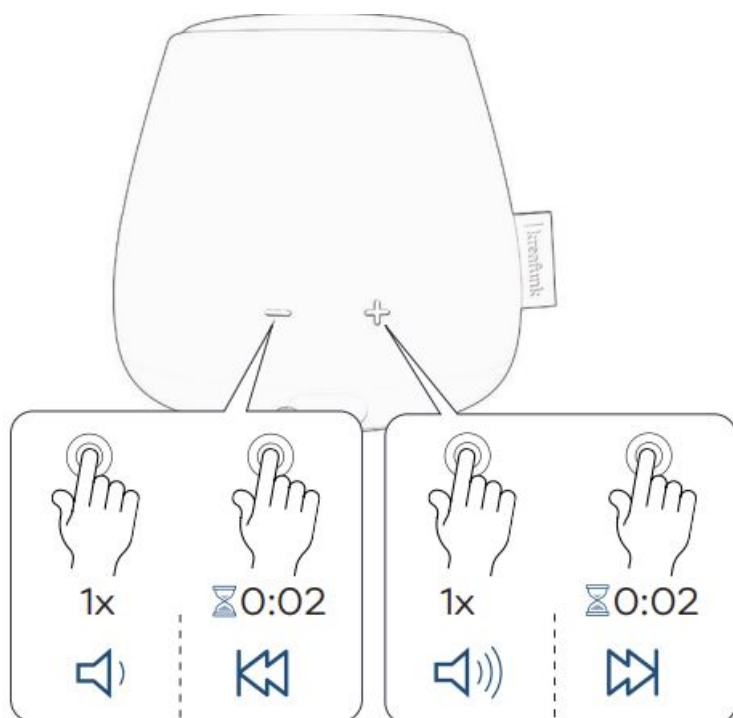

Phone

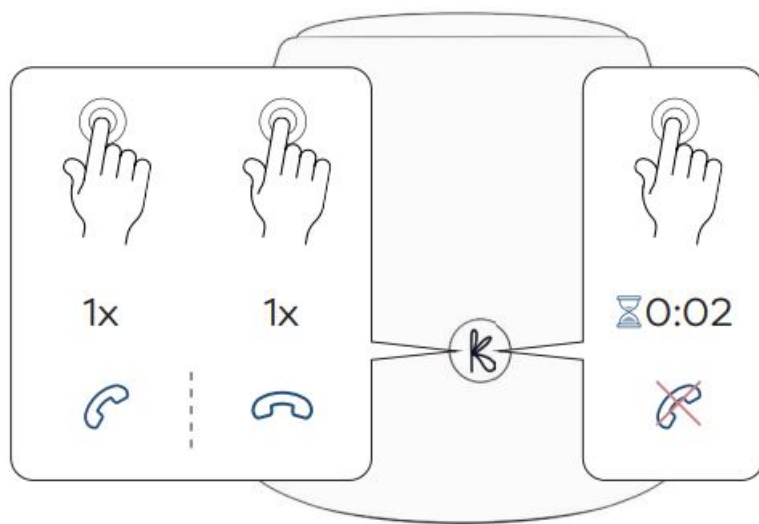

Voice assistant

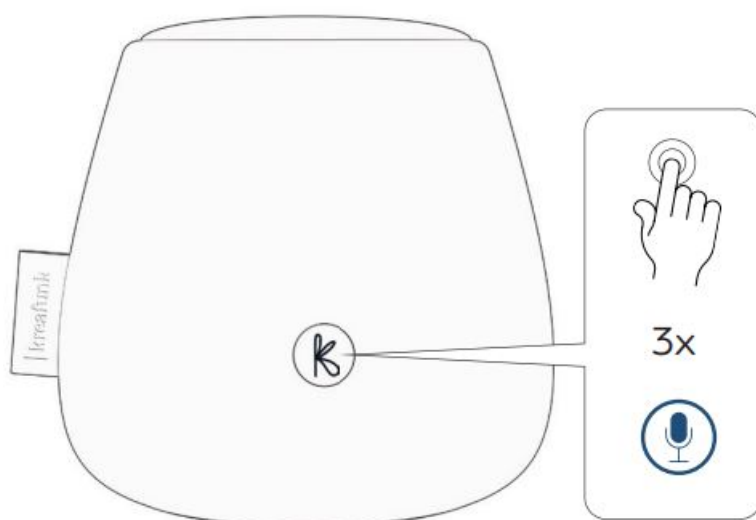

Stereo play (TWS)

Step 1

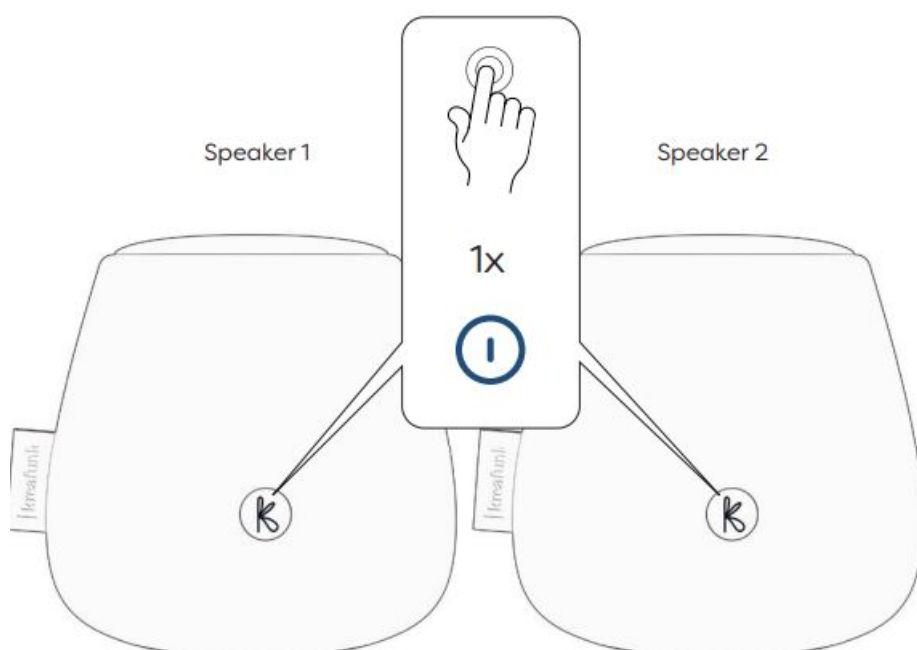

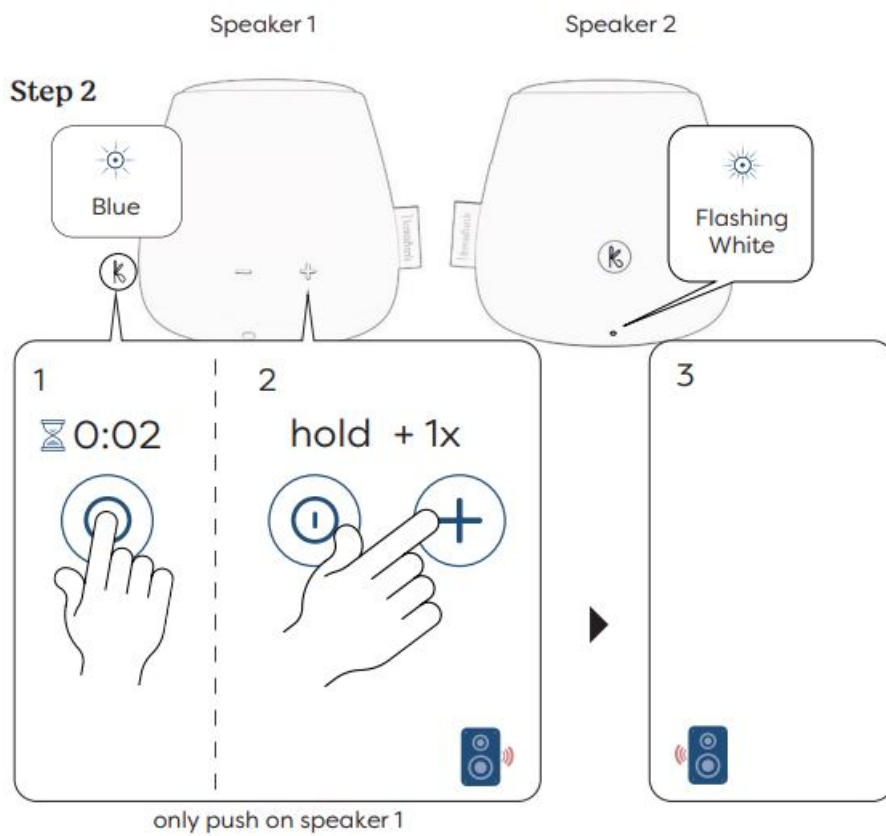

Step 3

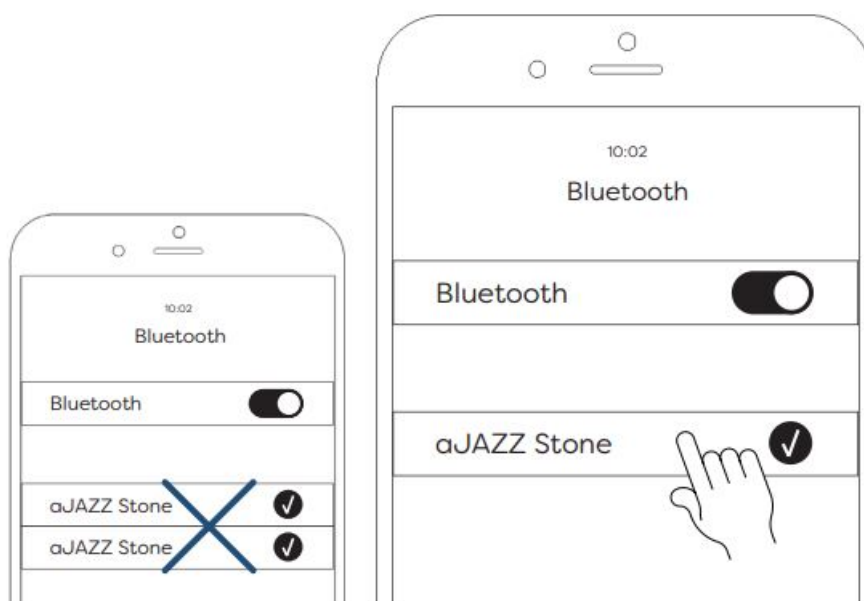

TWS off

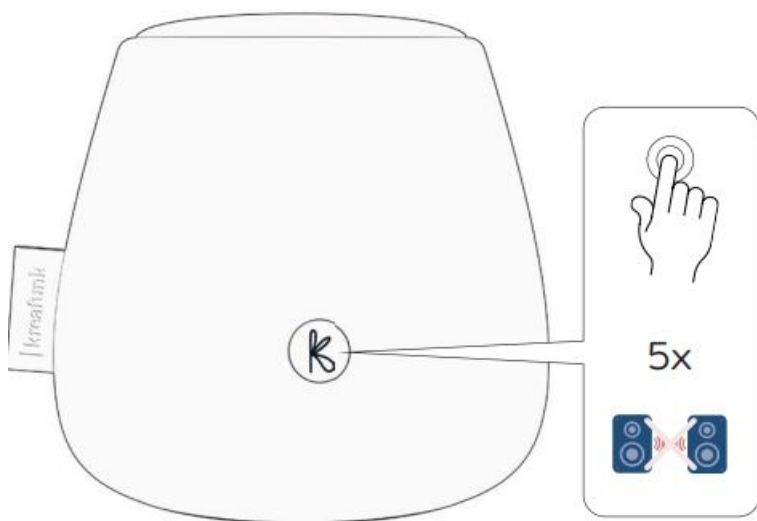

Reset/nulstil

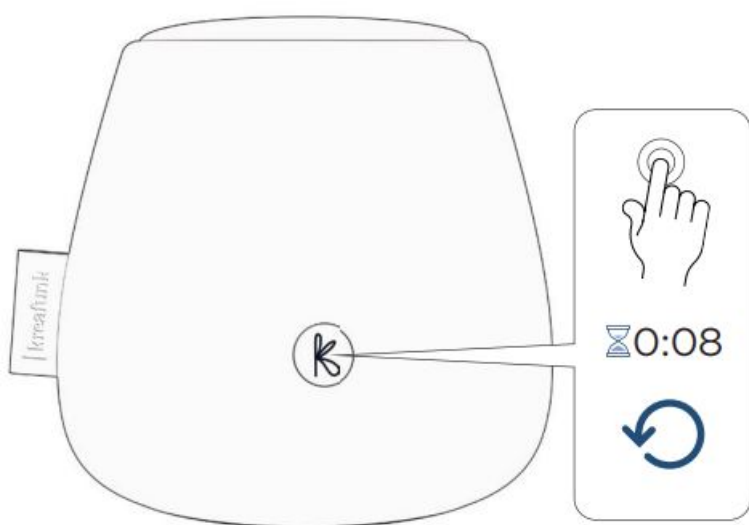

Technical specifications

- Dimensions: 100*90 mm (Ø*H)
- Weight: 540g
- Speaker: Ø65 mm 4Ω 15W
- Playing time: up to 30 hours
- Charging time: 3-4 hours (USB) / 6-7 hours (Qi)
- Charging cable included
- Stereo Play (TWS)
- Voice Assistant
- Build in Lithium battery with 7.4V, 2000mAh
- Frequency band: 2402–2480 MHz
- Maximal radio frequency effect: <3 dBm
- Bluetooth: version 5.3
- Range: up to 10 m
- Input power: 5V / 2A
- Dust and water-resistant (IPX3)

FCC statement

This device complies with part 15 of the fcc rules. operation is subject to the following two conditions:

1. This device may not cause harmful interference and
2. This device must accept any interference received, including inter-ference that may cause undesired operation.

Important: Changes or modifications to this product not authorized could void the FCC compliance and negate your authority to operate the product.

NOTE: This equipment has been tested and found to comply with the limits for a Class B digital device, pursuant to part 15 of the FCC Rules. These limits are designed to provide reasonable protection against harmful interference in a residential installation. This equipment generates uses and can radiate radio frequency energy and, if not installed and used in accordance with the instructions, may cause harmful interference to radio communications. However, there is no guarantee that interference will not occur in a particular installation. If this equipment does cause harmful interference to radio or television reception, which can be determined by turning the equipment off and on, the user is encouraged to try to correct the interference by one or more of the following measures:

- Reorient or relocate the receiving antenna.
- Increase the separation between the equipment and receiver.
- Connect the equipment into an outlet on a circuit different from that to which the receiver is connected.
- Consult the dealer or an experienced radio / TV technician for help.

FCC Radiation Exposure Statement: This equipment complies with FCC radiation exposure limits set forth for an uncontrolled environment. This equipment should be installed and operated with minimum distance 20cm between the radiator & your body.

FCC ID: 2ACVC-AJAZZSTONE

Safety and maintenance instructions

1. Please read this operation manual carefully before use.
2. The safety and maintenance instructions in this operation manual should be retained for future reference and must be followed at all times.
3. Keep the product away from heat sources such as radiators, heaters or other appliances that produce heat.
4. Place the speakers in a stable position to avoid fall and cause damage or personal injury.
5. Do not expose the product to direct sunlight for longer periods. High temperatures may shorten the life of the product, destroy the battery and distort certain plastic parts.
6. Do not expose the product to extreme cold as it may damage the internal circuit board.
7. Rechargeable batteries have a limited number of charge cycles. Battery life and number of charge cycles varies by use and settings.
8. Avoid liquids getting into the product.
9. Before wiping with a dry cloth to clean the speakers, set the power switch to the off position and unplug the power cord from the power outlet.
10. Do not throw with or stamp on the product. This may damage the internal circuit board.
11. Do not try to disassemble the product. This must only be done by a professional.
12. Do not use concentrated chemical products or detergent to clean the product.
13. Keep the surface away from sharp things, as these may cause damage to the plastic parts.
14. Use 5V / 2A power supplies only. The connection of power supplies with higher voltage may lead to severe damage.
15. Do not arbitrarily discard or place the lithium battery near fire or intense heat in order to avoid a risk of explosion.

If you do experience any problems with your product please contact the retailer you purchased the product from. The retailer will provide you with guidance and if that does not solve the problem, the retailer will handle the claim directly with Kreafunk.

Kreafunk ApS Klamsagervej 35A, st. 8230 Aabyhoej Denmark

www.Kreafunk.com

info@Kreafunk.dk

+45 96 99 00 20

Documents / Resources

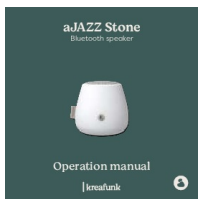

[kneafunk Stone Bluetooth Speaker](#) [pdf] Instruction Manual
Stone Bluetooth Speaker, Bluetooth Speaker, Speaker

References

- [Kneafunk | Stilfuldt dansk design med fantastisk lyd](#)
- [Declaration of conformity – Kneafunk](#)

[Manuals+](#),

- [home](#)
- [privacy](#)