



kreafunk AMAJOR2 Bluetooth Speaker Instruction Manual

[Home](#) » [KREAFUNK](#) » kreafunk AMAJOR2 Bluetooth Speaker Instruction Manual 

Contents

- [1 kreafunk AMAJOR2 Bluetooth Speaker](#)
- [2 Product Information](#)
- [3 Product Usage Instructions](#)
- [4 Overview](#)
- [5 On/off](#)
- [6 Listen via bluetooth](#)
- [7 Manual Bluetooth pairing](#)
- [8 Listen via Bluetooth](#)
- [9 Charging](#)
- [10 Battery status](#)
- [11 Play/pause](#)
- [12 Change volume, change track](#)
- [13 Phone](#)
- [14 Voice assistant](#)
- [15 Stereo play \(TWS\)](#)
- [16 Reset](#)
- [17 Technical specifications](#)
- [18 FCC statement](#)
- [19 Safety and maintenance instructions](#)
- [20 Documents / Resources](#)
 - [20.1 References](#)
- [21 Related Posts](#)

kreafunk

kreafunk AMAJOR2 Bluetooth Speaker



Product Information

- **Product:** Bluetooth Speaker
- **Operation Manual:** Included
- **Safety and Maintenance Instructions:** Included
- **Compliance:** This product is in compliance with the essential requirements and other relevant provisions of Directive 2014/53/EU.
- **Declaration of Conformity:** The declaration of conformity can be consulted at <https://Kreafunk.com/pages/declaration-of-conformity>
- **Technical Specifications:** Not provided in the text extract

Product Usage Instructions

1. **Step 1:** Turn on/off the Bluetooth speaker.
2. **Step 2:** Perform manual Bluetooth pairing by following the specific instructions for your language:
 - English: aMAJOR 2 Bluetooth pairing
 - Français: Couplage Bluetooth manuel
 - Deutsch: Manuelle Bluetooth-Kopplung
 - Italiano: Accoppiamento Bluetooth manuale
 - Español: Emparejamiento manual de Bluetooth
3. **Charging:** Connect the speaker to a power source using the provided charging cable. The LED indicator will show the charging status:
 - Orange (0-99% charge)
 - Green (100% charge)
4. **Battery Status:** The LED indicator will display the battery status:
 - Red (0-10% charge)
 - Green (10-100% charge)
5. **Play/Pause:** Press the play/pause button to start or pause playback.
6. **Volume/Track Control:** Use the volume buttons to adjust the volume and change tracks.

7. **Voice Assistant:** Activate the voice assistant feature by pressing the corresponding button.

8. **Speaker Configuration:** Follow the steps below to configure the speakers:

1. Select "Speaker 1" on the first step.
2. Both speakers will flash white on the second step.
3. If required, push only on speaker 1 during the third step.

Please refer to the complete user manual for detailed instructions and additional information.

This product is in compliance with the essential requirements and other relevant provisions of Directive 2014/53/EU.

The declaration of conformity may be consulted at: <https://Kreafunk.com/pages/declaration-of-conformity>

Overview

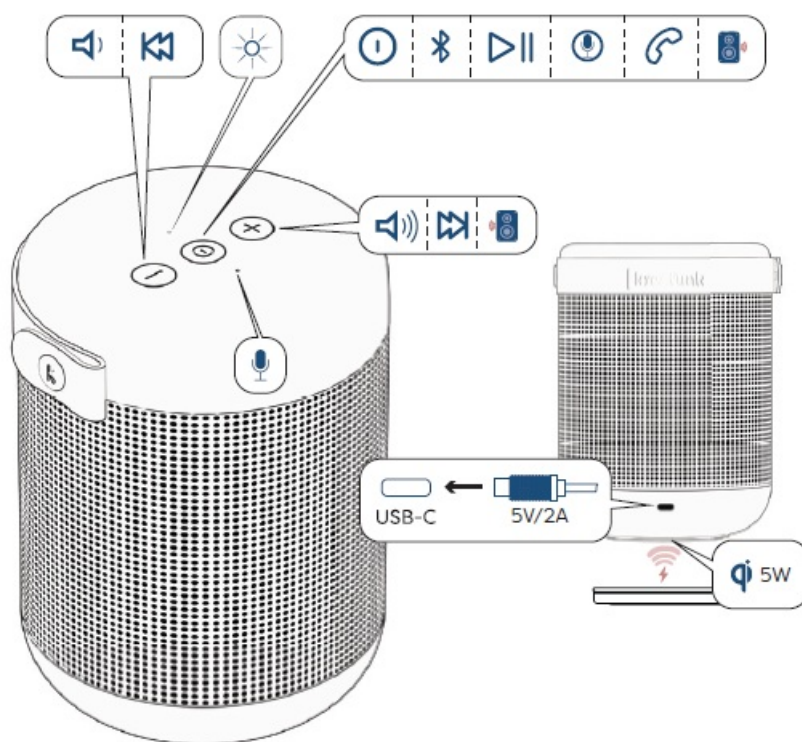

On/off

Step 1

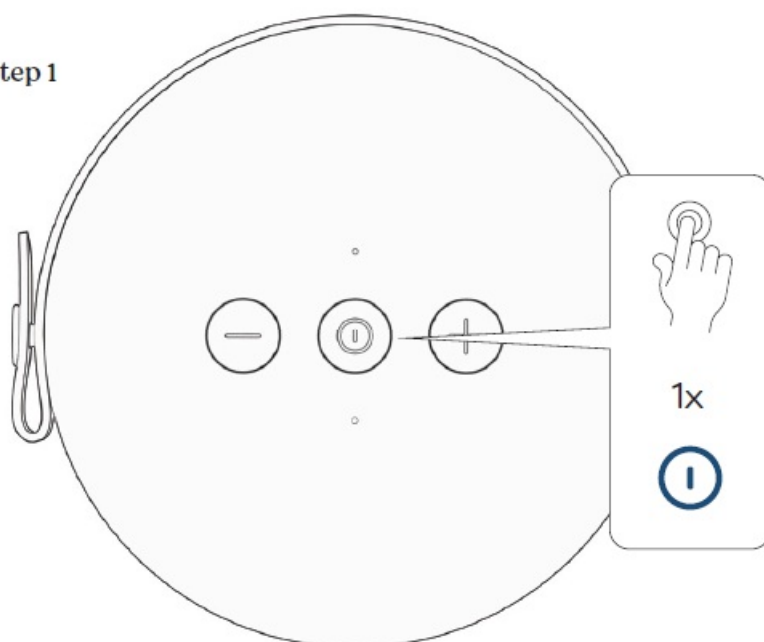

Listen via bluetooth

Step 2

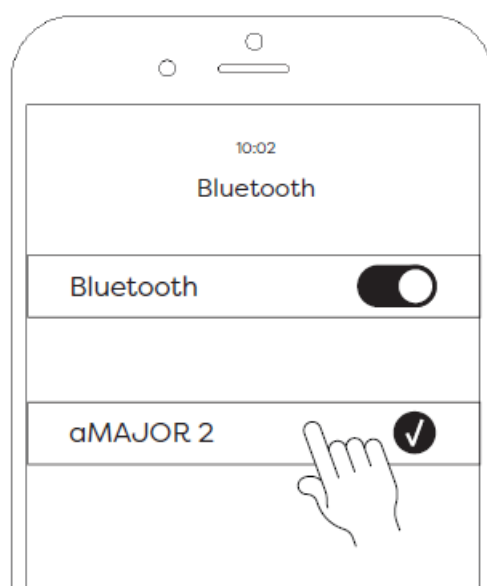

Manual Bluetooth pairing

Step 1

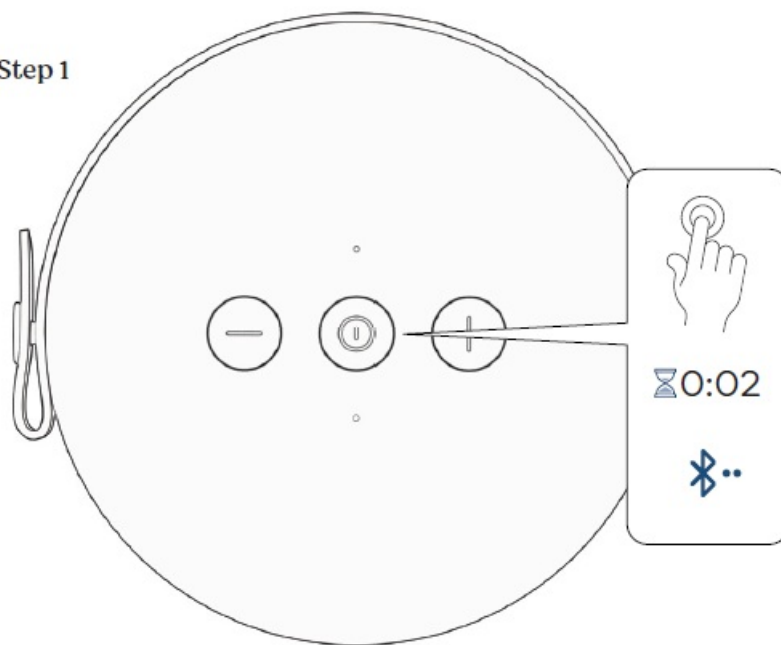

Listen via Bluetooth

Step 2

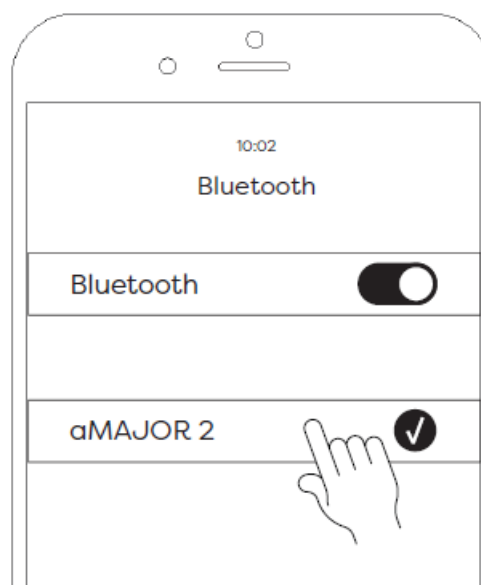

Charging

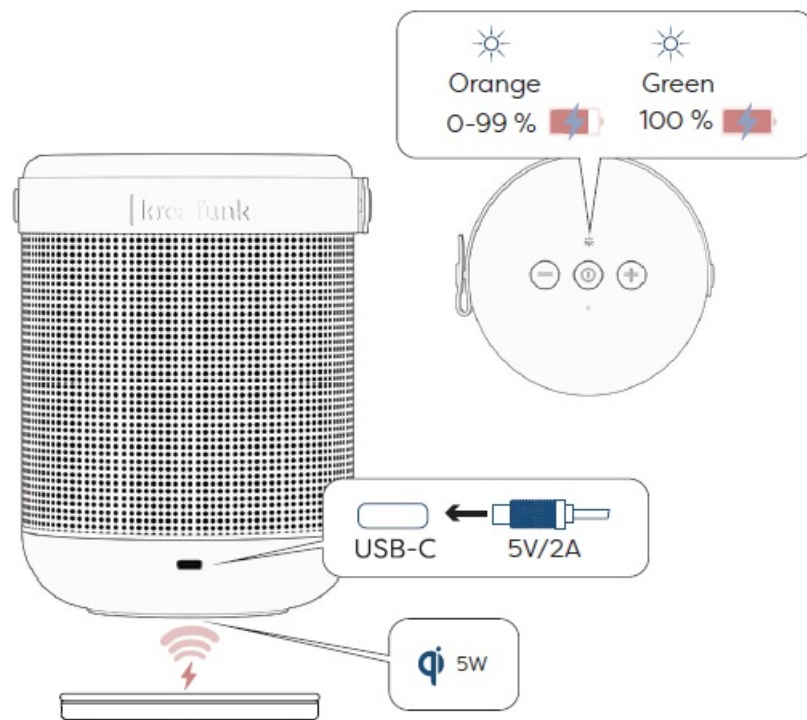

Battery status

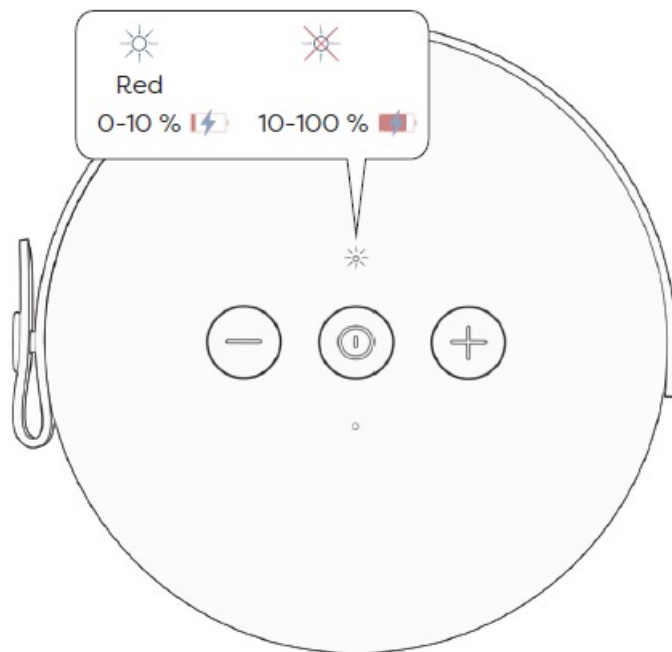

Play/pause

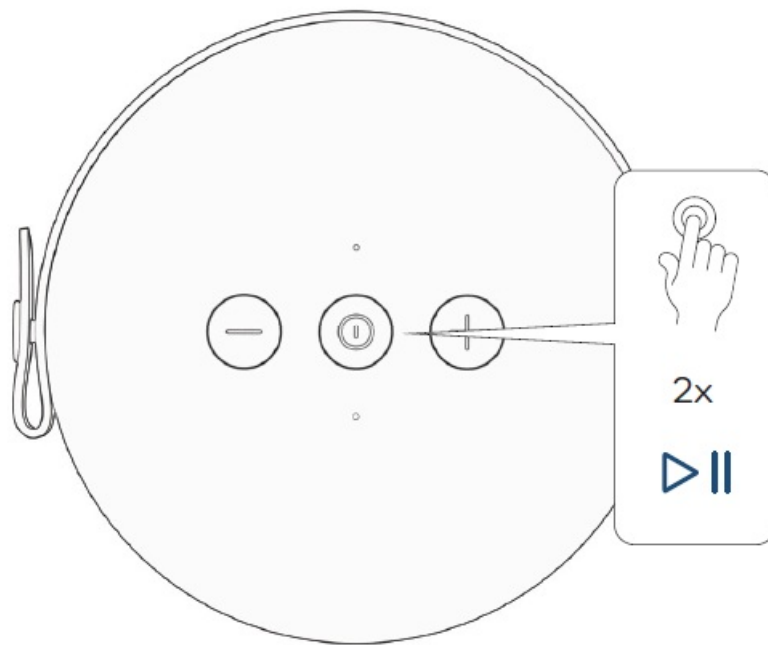

Change volume, change track

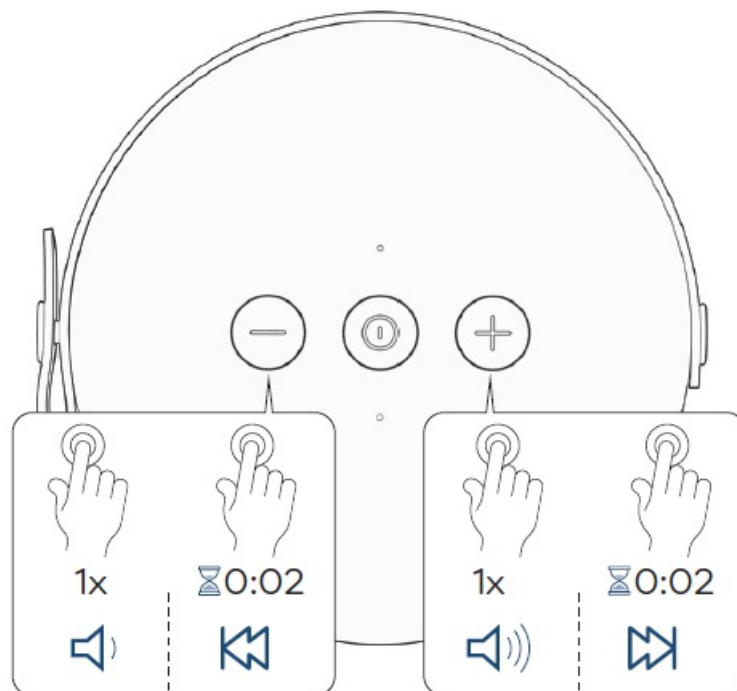

Phone

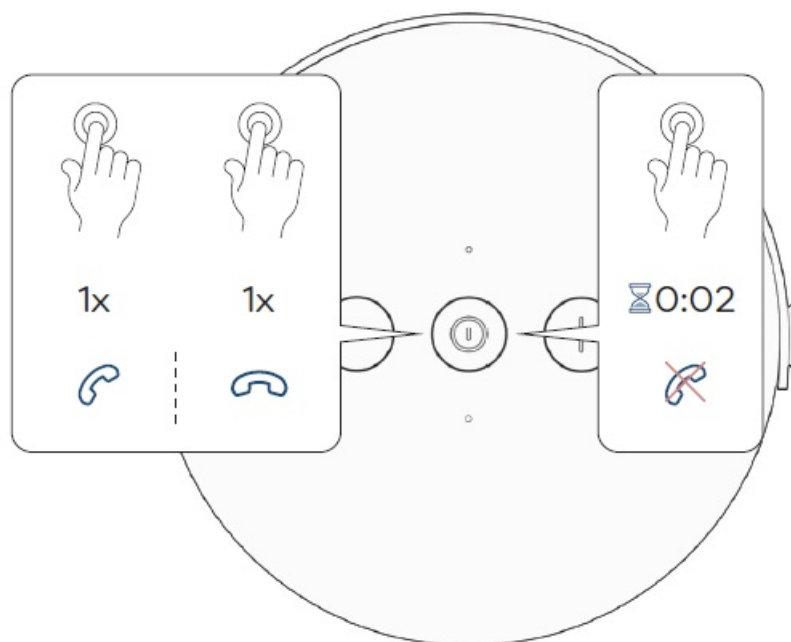

Voice assistant

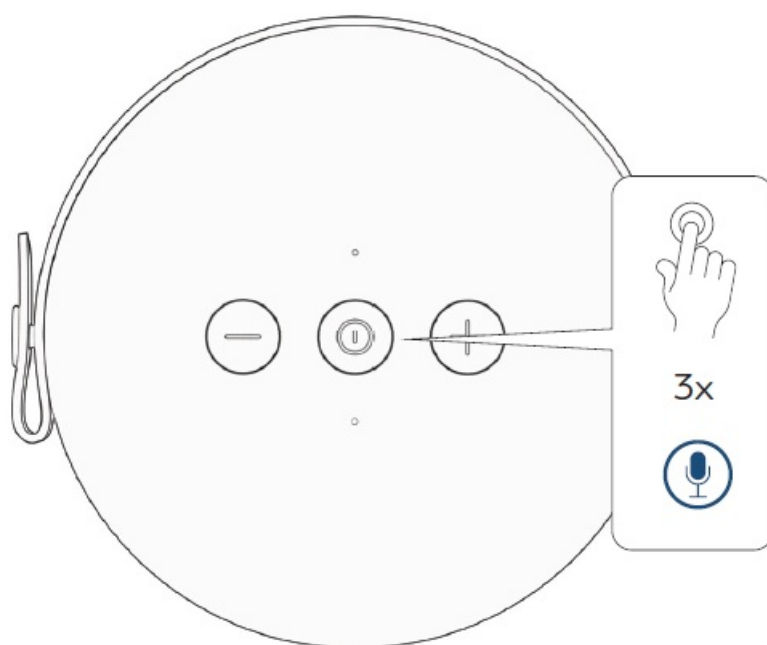

Stereo play (TWS)

Step 1

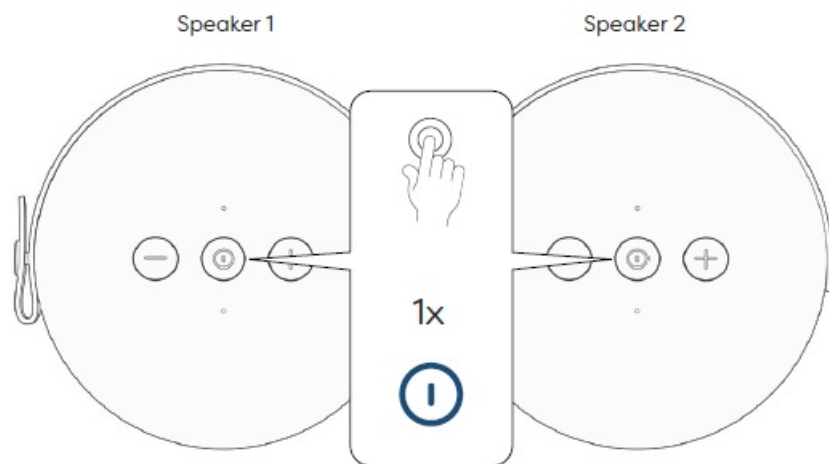

Step 2

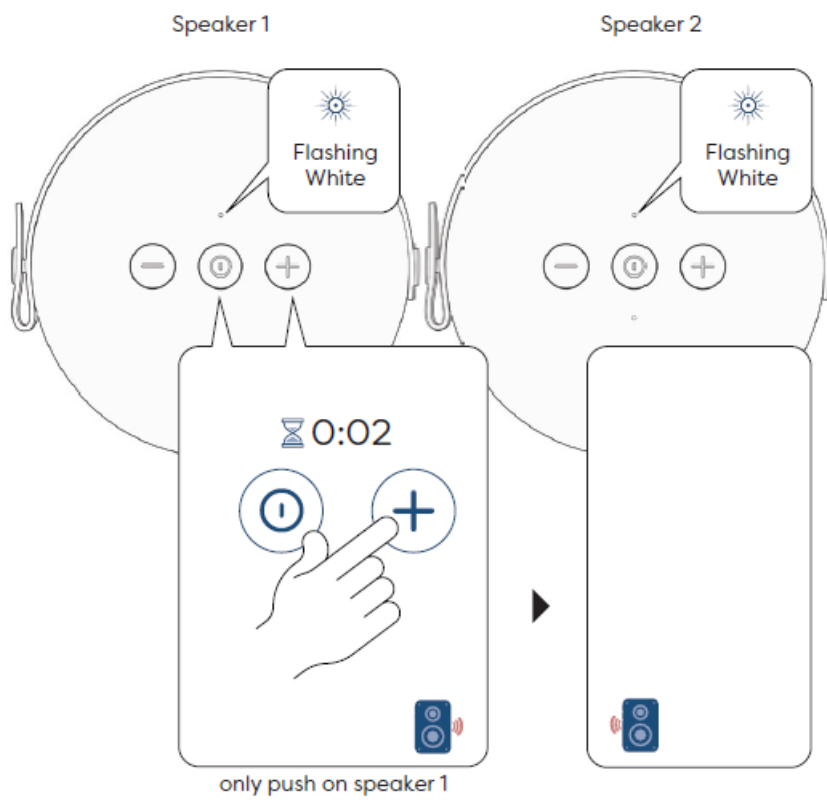

Step 3

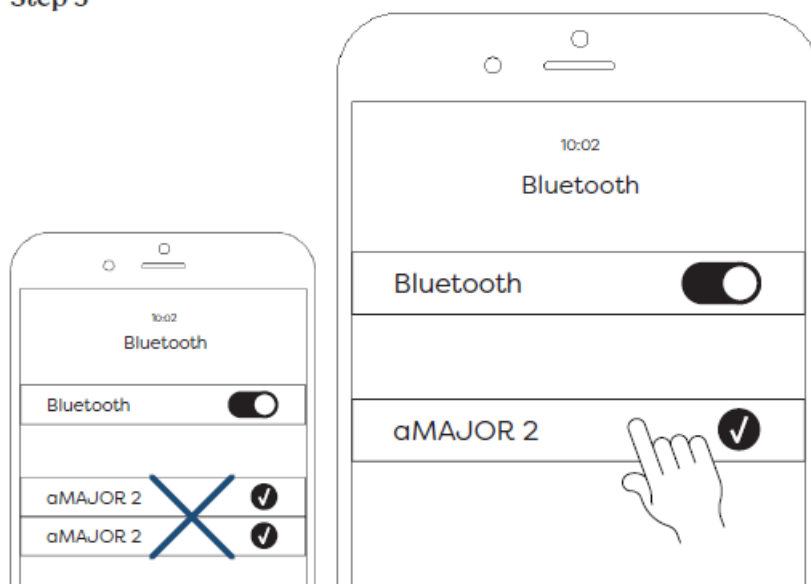

Reset

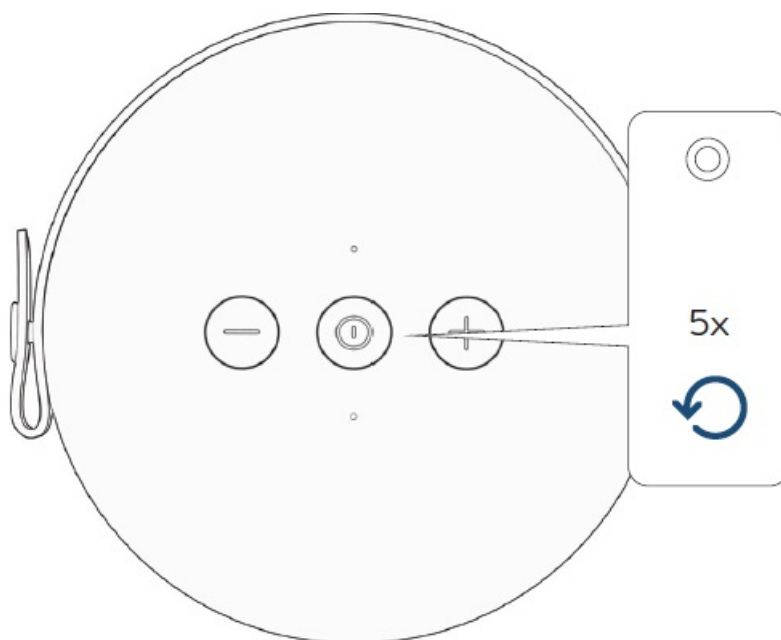

Technical specifications

- **Dimensions:** 128,5*176 mm (Ø*H)
- **Weight:** 1690g
- **Speaker:** 40W (Ø45 mm 4Ω 10W*2 + Ø76 mm 4Ω 20W)
- **DSP (digital signal processor)**
- **Playing time:** up to 30 hours
- **Charging time:** 4-5 hours (USB) / 15-16 hours (Qi)
- **Including USB** to USB-C charging cable
- **Stereo Play (TWS)**
- **Voice Assistant**
- Build in Lithium battery with 7.4V, 4400mAh
- **Frequency band:** 2402–2480 MHz

- **Maximal radio frequency effect:** <3 dBm
- **Bluetooth:** version 5.0
- **Range:** up to 10 m
- **Input power:** 5V / 2A
- **Water-resistant (IPX5)**

FCC statement

This device complies with part 15 of the fcc rules. operation is subject to the following two conditions:

1. This device may not cause harmful interference and
2. This device must accept any interference received, including interference that may cause undesired operation.

Important: Changes or modifications to this product not authorized could void the FCC compliance and negate your authority to operate the product.

NOTE: This equipment has been tested and found to comply with the limits for a Class B digital device, pursuant to part 15 of the FCC Rules. These limits for a signed to provide reasonable protection against harm-ful interference in a residential installation. This equipment generates uses and can radiate radio frequency energy and, if not installed and used in accordance with the instructions, may cause harmful interference to radio communications.

However, there is no guarantee that interference will not occur in a particular installation. If this equipment does cause harmful interference to radio or television reception, which can be determined by turning the equipment off and on, the user is encouraged to try to correct the interference by one or more of the following measures:

- Reorient or relocate the receiving antenna.
- Increase the separation between the equipment and receiver.
- Connect the equipment into an outlet on a circuit different from that to which the receiver is connected.
- Consult the dealer or an experienced radio / TV technician for help.

FCC Radiation Exposure Statement: This equipment complies with FCC radiation exposure limits set forth for an uncontrolled environment. This

FCC ID: 2ACVC-AMAJOR2

Safety and maintenance instructions

1. Please read this operation manual carefully before use.
2. The safety and maintenance instructions in this operation manual should be retained for future reference and must be followed at all times.
3. Keep the product away from heat sources such as radiators, heaters or other appliances that produce heat.
4. Place the speakers in a stable position to avoid fall and cause damage or personal injury.
5. Do not expose the product to direct sunlight for longer periods. High temperatures may shorten the life of the product, destroy the battery and distort certain plastic parts.
6. Do not expose the product to extreme cold as it may damage the internal circuit board.
7. Rechargeable batteries have a limited number of charge cycles. Battery life and number of charge cycles varies by use and settings.
8. Avoid liquids getting into the product.
9. Before wiping with a dry cloth to clean the speakers, set the power switch to the off position and unplug the

power cord from the power outlet.

10. Do not throw with or stamp on the product. This may damage the internal circuit board.
11. Do not try to disassemble the product. This must only be done by a professional.
12. Do not use concentrated chemical products or detergent to clean the product.
13. Keep the surface away from sharp things, as these may cause damage to the plastic parts.
14. Use 5V / 1A power supplies only. The connection of power supplies with higher voltage may lead to severe damage.
15. Do not arbitrarily discard or place the lithium battery near fire or intense heat in order to avoid a risk of explosion.

If you do experience any problems with your product please contact the retailer you purchased the product from. The retailer will provide you with guidance and if that does not solve the problem, the retailer will handle the claim directly with Kreafunk.

Kreafunk ApS Klamsagervej 35A, st. 8230 Aabyhoej Denmark

www.Kreafunk.com



info@Kreafunk.dk

+45 96 99 00 20

Documents / Resources

	<p>kreafunk AMAJOR2 Bluetooth Speaker [pdf] Instruction Manual 2ACVC-AMAJOR2, 2ACVCAMAJOR2, AMAJOR2, AMAJOR2 Bluetooth Speaker, Bluetooth Speaker, Speaker</p>
--	--

References

-  [Kreafunk | Stilfuldt dansk design med fantastisk lyd](#)
-  [Declaration of conformity – Kreafunk](#)