



## Kompernass FA 110 A2 Door and Window Alarm Set Instruction Manual

[Home](#) » [Kompernass](#) » Kompernass FA 110 A2 Door and Window Alarm Set Instruction Manual 

Kompernass FA 110 A2 Door and Window Alarm Set Instruction Manual



## Contents

- 1 Introduction
  - 1.1 Intended use
  - 1.2 Package contents
  - 1.3 Technical details
- 2 Safety instructions
  - 2.1 Information on using batteries
- 3 Appliance description
- 4 Start-up
  - 4.1 Inserting/replacing the batteries
- 5 Assembly
- 6 Activate/deactivate alarm function
- 7 Cleaning/storage
- 8 Disposal
  - 8.1 Disposing of the batteries
- 9 Kompernass Handels GmbH warranty
- 10 Service
- 11 Documents / Resources
  - 11.1 References
- 12 Related Posts

## Introduction

Congratulations on the purchase of your new appliance. You have selected a high-quality product. The operating instructions are a constituent of this product. They contain important information about safety, use and disposal. Before using the product, familiarise yourself with all operating and safety instructions. Use this product only as described and only for the specified areas of application. Retain these instructions for future reference. Please also pass these operating instructions on to any future owner(s).

### Intended use

This door/window alarm is exclusively intended for monitoring doors and windows in private properties, and is intended to deter burglars by emitting an extremely loud acoustic alarm. This product is not intended for commercial or industrial use. The warranty does not apply to damage caused by improper use of the appliance.

### Package contents

- 4 x alarm devices
- 4 x magnets
- 4 x self-adhesive strips (7 x 45 x 2 mm)
- 4 x self-adhesive strips (15 x 45 x 2 mm)
- 8 x 1.5 V batteries type AAA/Micro
- This operating manual

**Remove all packaging materials from the appliance.**

### Technical details

- Voltage supply: 2 x 1.5 V (direct current) batteries type AAA/Micro



- Alarm volume: approx. 110 dB(A)/3 cm

## **Safety instructions**

### **WARNING**

Loud acoustic alarm! Subjecting your hearing to this sound over long periods could cause serious hearing damage!

- Check the appliance for any visible external damage before use. Do not use an appliance that has been damaged or dropped.
- This appliance is not intended for use by persons (including children) with limited physical, physiological or intellectual abilities or lack of experience and/or knowledge unless they are supervised by a person who is responsible for their safety, or receive instructions from this person on how to use the appliance.
- Children should be supervised to ensure that they do not play with the appliance.
- Do not make any unauthorised modifications or alterations to the appliance.
- Repairs to the appliance during the warranty period may only be carried out by a customer service department authorised by the manufacturer. Otherwise no additional warranty claims can be considered for subsequent damage.
- Do not place the appliance in locations that are subject to direct sunlight. Otherwise it may overheat and be irreparably damaged.
- Protect the appliance from moisture, spray and dripping water and penetration by liquids.

### **Information on using batteries**

### **DANGER**

#### **Mishandling the batteries can cause fires, explosions, leakages or other hazards!**

- Do not throw the batteries into the fire.
- Do not short-circuit the batteries.
- Do not attempt to recharge the batteries.
- Check the condition of the batteries regularly. Leaking battery acid can cause permanent damage to the appliance.
- Special care should be taken when handling damaged or leaking batteries. Risk of acid burns! Wear protective gloves. If necessary, clean the battery and appliance contacts.
- Store batteries in a place that is inaccessible to children. If a battery is swallowed, seek medical attention IMMEDIATELY.
- If you do not intend to use the appliance for a long time, remove the batteries.
- Do not use different types of batteries together or mix new batteries with used batteries.
- Inserting the wrong type of battery can lead to a risk of explosion. Dispose of used batteries as described in the instructions.
- Do not short-circuit the connection terminals.

## Appliance description

1. Alarm device
2. Siren
3. Alignment mark
4. Alignment mark
5. Magnet
6. On/Off switch
7. Battery compartment

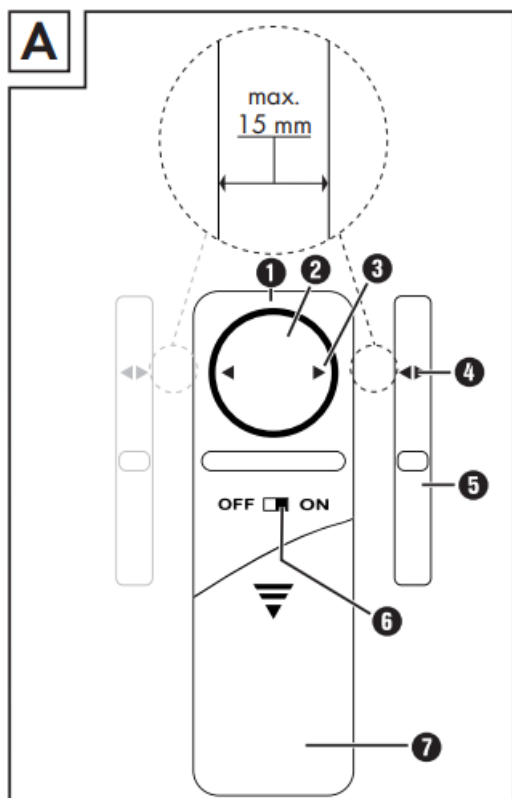

## Start-up

### Inserting/replacing the batteries

- Move the On/Off switch 6 to the "OFF" position.
- Open the battery compartment 7. To do this, press on the arrow marking on the battery compartment cover and, at the same time, push it downwards.
- Insert two type AAA/Micro batteries, as shown in the battery compartment 7.
- Close battery compartment 7.

## Assembly

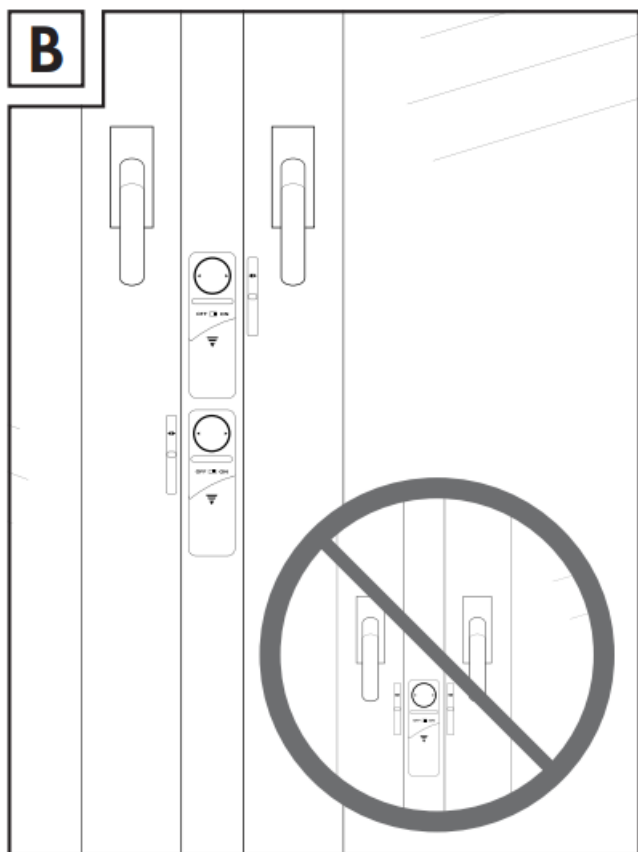
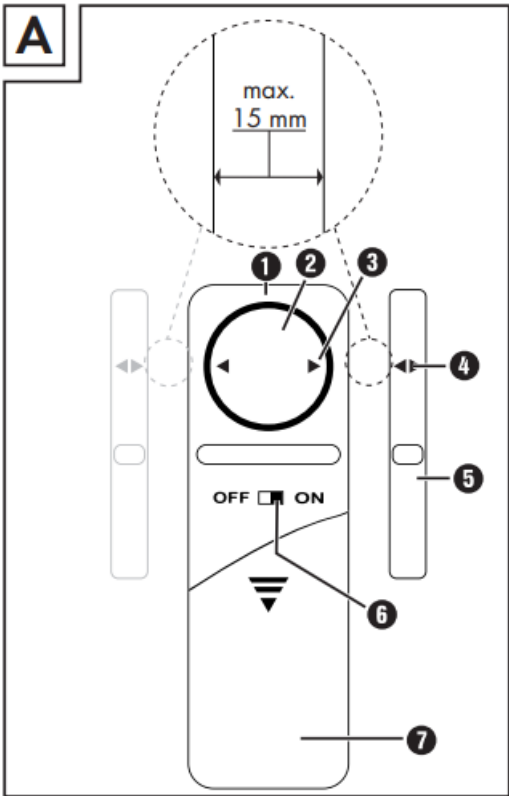

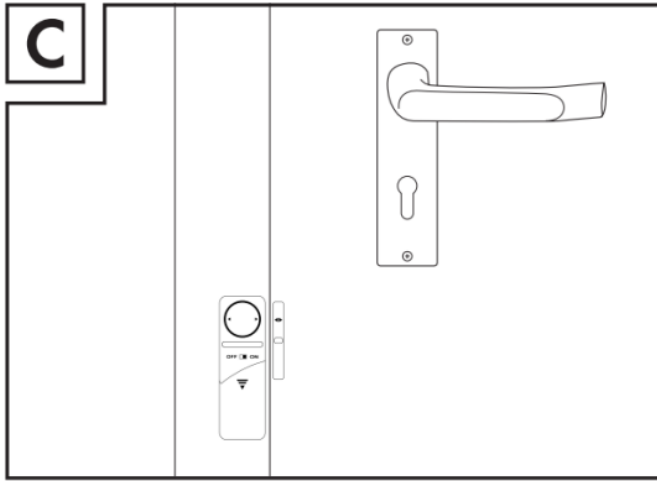

The appliance is suitable for doors/windows with hinges on the right or left. Operating two magnets 5 with only one alarm device 1 is not possible. The alarm device 1 and the magnets 5 are attached using the self-adhesive strips on the rear side. The surface to which the self-adhesive strips are affixed must be clean, free of grease and dry. Remove the protective film from the self-adhesive strips and affix the alarm device 1 to the frame of the window or door. Attach the magnets 5 parallel to the alarm device 1 on the door window casement or the door panel. The alignment mark 4 on the magnet 5 must match up with the alignment mark 3 on the alarm device 1. With larger window casements or door panels, you can compensate the height difference between the alarm device 1 and the magnet 5 using the additional self-adhesive strips.

## NOTE

When the door or window is closed, the distance between the alarm device 1 and the magnet 5 must not be greater than 15 mm!

## Activate/deactivate alarm function

- Push the On/Off switch 6 to the “ON” position. The alarm function is now activated and the alarm will sound if the door or window is opened.
- Move the On/Off switch 6 to the “OFF” position to deactivate the alarm.

## Cleaning/storage

### CAUTION

- To avoid irreparable damage, ensure that no moisture penetrates the appliance during cleaning.
- Clean the appliance with a soft, dry cloth.
- If you decide not to use the appliance for a long period, remove the batteries and store it in a clean, dry place away from direct sunlight.

## Disposal



The adjacent symbol of a crossed-out wheellie bin means that this appliance is subject to Directive 2012/19/EU. This directive states that this appliance may not be disposed of in normal household waste at the end of its usable life, but must be handed over to specially set-up collection locations, recycling depots or disposal companies. This disposal is free of charge for the user. Protect the environment and dispose of this appliance properly.



You can obtain further information from your local disposal company or the city or local authority.



The product is recyclable, subject to extended producer responsibility and is collected separately.



The packaging materials have been selected for their environmental compatibility and ease of disposal, and are therefore recyclable.

Dispose of packaging materials that are no longer needed in accordance with applicable local regulations.



Note the labelling on the packaging and separate the packaging material components for disposal if necessary. The packaging material is labelled with abbreviations (a) and numbers (b) with the following meanings:  
1–7: Plastics,  
20–22: Paper and cardboard,  
80–98: Composites.

### **Disposing of the batteries**

Batteries should not be disposed of with normal household waste. Consumers are legally obliged to dispose of used batteries at a collection point in their town/district or at a retail store. They may contain poisonous heavy metals and must be disposed of in accordance with the rules for the treatment of hazardous waste. The chemical symbols for heavy metals are as follows: Cd = cadmium, Hg = mercury, Pb = lead.

Dispose of batteries only when they are fully discharged.

## **Kompernass Handels GmbH warranty**

**Dear Customer,**

This appliance has a 3-year warranty valid from the date of purchase. If this product has any faults, you, the buyer, have certain statutory rights. Your statutory rights are not restricted in any way by the warranty described below.

### **Warranty conditions**

The warranty period starts on the date of purchase. Please keep your receipt in a safe place. This will be required as proof of purchase.

If any material or manufacturing fault occurs within three years of the date of purchase of the product, we will either repair or replace the product for you or refund the purchase price (at our discretion). This warranty service requires that you present the defective appliance and the proof of purchase (receipt) within the three-year warranty period, along with a brief written description of the fault and of when it occurred.

If the defect is covered by the warranty, your product will either be repaired or replaced by us. The repair or replacement of a product does not signify the beginning of a new warranty period.

### **Warranty period and statutory claims for defects**

The warranty period is not prolonged by repairs effected under the warranty. This also applies to replaced and

repaired components. Any damage and defects present at the time of purchase must be reported immediately after unpacking. Repairs carried out after expiry of the warranty period shall be subject to a fee.

### **Scope of the warranty**

This appliance has been manufactured in accordance with strict quality guidelines and inspected meticulously prior to delivery.

The warranty covers material faults or production faults. The warranty does not extend to product parts subject to normal wear and tear or to fragile parts which could be considered as consumable parts such as switches, batteries or parts made of glass.

The warranty does not apply if the product has been damaged, improperly used or improperly maintained. The directions in the operating instructions for the product regarding proper use of the product are to be strictly followed. Uses and actions that are discouraged in the operating instructions or which are warned against must be avoided.

This product is intended solely for private use and not for commercial purposes. The warranty shall be deemed void in cases of misuse or improper handling, use of force and modifications / repairs which have not been carried out by one of our authorised Service centres.

### **Warranty claim procedure**

To ensure quick processing of your case, please observe the following instructions:

- Please have the till receipt and the item number (e.g. IAN 123456\_7890) available as proof of purchase.
- You will find the item number on the type plate on the product, an engraving on the product, on the front page of the operating instructions (below left) or on the sticker on the rear or bottom of the product.
- If functional or other defects occur, please contact the service department listed either by telephone or by e-mail.
- You can return a defective product to us free of charge to the service address that will be provided to you. Ensure that you enclose the proof of purchase (till receipt) and information about what the defect is and when it occurred.

You can download these instructions along with many other manuals, product videos and installation software at [www.lidl-service.com](http://www.lidl-service.com).



This QR code will take you directly to the Lidl service page ([www.lidl-service.com](http://www.lidl-service.com)) where you can open your operating instructions by entering the item number (IAN) 353745\_2010.



## Service

Service Great Britain

Tel.: 0800 404 7657

**E-Mail:** [kompernass@lidl.co.uk](mailto:kompernass@lidl.co.uk)

Service Ireland

Tel.: 1890 930 034

(0,08 EUR /Min., (peak))

(0,06 EUR /Min., (off peak))

**E-Mail:** [kompernass@lidl.ie](mailto:kompernass@lidl.ie)

IAN 353745\_2010

## Importer

Please note that the following address is not the service address. Please use the service address provided in the operating instructions.

KOMPERNASS HANDELS GMBH



BURGSTRASSE 21

44867 BOCHUM

GERMANY

[www.kompernass.com](http://www.kompernass.com)

## Documents / Resources

 <p><b>DOOR &amp; WINDOW ALARM SET</b> TÜR- UND FENSTERALARM-SET SET D'ALARME DE PORTE ET DE FENÊTRE FA 110 A2</p> <p> <b>DOOR &amp; WINDOW ALARM SET</b> Tür- und Fensteralarm-Set Set d'alarmes de porte et de fenêtre DUR- EN RAAMALARMSET DVERNÍ A OKENNÍ ALARM ZESTAW ALARMOWY DO DRZWI I OKIEN DVEROVÝ A OKENNÝ ALARM SET DE ALARMA PARA PUERTAS Y VENTANAS SÆT MED DØR- OG VINDUESALARM</p> <p>IAN 353745_2010</p>	<p><a href="#">Kompernass FA 110 A2 Door and Window Alarm Set</a> [pdf] Instruction Manual FA 110 A2, Door and Window Alarm Set</p>
---	---

## References

-  [Kompernaß - Online shop for accessories and spare parts](#)
-  [de/](#)