



KOLVER PLUTO Precision Power Screwdrivers Owner's Manual

[Home](#) » [kolver](#) » KOLVER PLUTO Precision Power Screwdrivers Owner's Manual 

Contents

- 1 KOLVER PLUTO Precision Power Screwdrivers
- 2 Operator's Handbook
- 3 OPERATING MODE
 - 3.1 Clutch adjustment
 - 3.2 LUBRICATION
- 4 MAINTENANCE INSTRUCTIONS
 - 4.1 GUARANTEE
- 5 SPARE PARTS
- 6 Documents / Resources
 - 6.1 References
- 7 Related Posts



KOLVER PLUTO Precision Power Screwdrivers



Operator's Handbook

DICHIARAZIONE DI CONFORMITA'/ DECLARATION OF CONFORMITY VIA MARCO CORNER, 19/21
36016 THIENE (VI) ITALIA

Declare that the new screwdriver here described: Is in conformity with the following standards and other normative documents:

2006/42/CE, LVD 2014/35/UE, EMCD 2014/30/UE,

- 62841-2-2:2014, EN 62841-1: 2015, EN 60204-1,
- 61000-6-2, EN 61000-6-3 (con/with EDU2AE/TOP series),
- 61000-6-2, EN 61000-6-4 (con/with EDU2AE/FR).

It is also in conformity with RoHS III normative (2011/65/UE and following 2015/863).

- Nome/Name: Giovanni Colas ante
- Position: Administrator
- General Manager

Person authorized to compile the technical file in Korver

Model	Code	Torque (Nm)	Speed		Control unit
			Min	Max	
Inline (PLUTO FR)					
PLUTO 3FR/HS	131203/HS	0,5-2,5	1550	2400	EDU2AE/FR, TOP
PLUTO 5FR	131205	1,0-5,0	600	1000	
PLUTO 7FR	131207	1,5-7,0	350	600	
Pistol grip (PLUTO FR/P)					
PLUTO 3FR/P/HS	131204/HS	0,5-2,5	1550	2400	EDU2AE/FR, TOP
PLUTO 5FR/P	131206	1,0-5,0	600	1000	
PLUTO 7FR/P	131208	1,5-7,0	350	600	
Pistol grip with top connector (PLUTO FR/P/U)					
PLUTO 3FR/P/U/HS	131204/U/HS	0,5-2,5	1550	2400	EDU2AE/FR, TOP
PLUTO 5FR/P/U	131206/U	1,0-5,0	600	1000	
PLUTO 7FR/P/U	131208/U	1,5-7,0	350	600	
For automation (PLUTO FR/CA)					
PLUTO 5FR/CA	133205	1,0-5,0	600	1000	
PLUTO 7FR/CA	133207	1,5-7,0	350	600	
PLUTO 5FR/CA/FN	133205/FN	0,7-5,0	600	1000	
PLUTO 7FR/CA/FN	133207/FN	1,5-7,0	350	600	
With angle head (PLUTO FR/ANG)					
PLUTO 5FR/ANG	131205/A	1,0-5,0	600	1000	EDU2AE/FR, TOP
PLUTO 7FR/ANG	131207/A	1,5-7,0	350	600	

WARNING: To reduce the risk of injury, before using or servicing screwdriver, read and understand the following information as well as separately provided safety instructions (item code: 0MS000). The features and descriptions of our products are subject to change without prior notice.

DECLARATION OF USE

Screwdriver suitable for industrial environment only. It shall be used for tightening. No other use will be permitted. For professional use only.

DATA

Noise level: < 70 dB(A)

Vibration level: < 2.5 m/s²

Declaration of noise and vibration emission

These declared values were obtained by laboratory type testing in compliance with the stated standards and are not adequate for use in risk assessments. Values measured in individual work places may be higher than the declared values. The actual exposure values and risk of harm experienced by an individual user are unique and depend upon the way the user works, the work piece and the workstation design, as well as upon the exposure time and the physical condition of the user. We, KOLVER, cannot be held liable for the consequences of using the declared values, instead of values reflecting the actual exposure, in an individual risk assessment in a work place situation over which we have no control.

OPERATING MODE

The screwdriver can be manual or used as fixed spindle on an automatic machine.

Manual screwdriver

- Fit the screwdriver with a suitable fastening accessory, then connect it to the control unit.
- Hold the screwdriver by the handle and apply to the fastener to be tightened.
- Press the lever to start the screwdriver.
- The screwdriver stops when the preset torque is reached.
- For each second of operation, the motor needs to rest for 3 seconds.
- Failure to do so may result in motor overheating and damage.
- That will be considered as a misuse and the warranty will not be applied.

As the reaction increases in proportion to the tightening torque, make sure that the screwdriver is in perfect working and the control unit is programmed correctly, to reduce the risk of injury to the operator as a result of unexpected behavior of the screwdriver.

Clutch adjustment

PLUTO clutch screwdrivers work in combination with the EDU2AE/FR control unit. which acts as an AC to DC transformer and torque controller. The electronic control circuit cuts the power supply to the motor as soon as the pre-set torque has been reached. An easy-to-use scroll menu allows to select, set and/or adjust a number of parameters in a quick and easy way to optimize the performance of each type of application (see the manual of the control unit). Veers. 190521

The torque value is adjusted by changing the compression of the clutch spring. The torque can be increased by turning the nut clockwise and decreased by turning it anticlockwise.

To check the torque value we suggest the use of KOLVER K or mink torque testers.

IMPORTANT: Continuous use over 80% of torque range is not recommended.

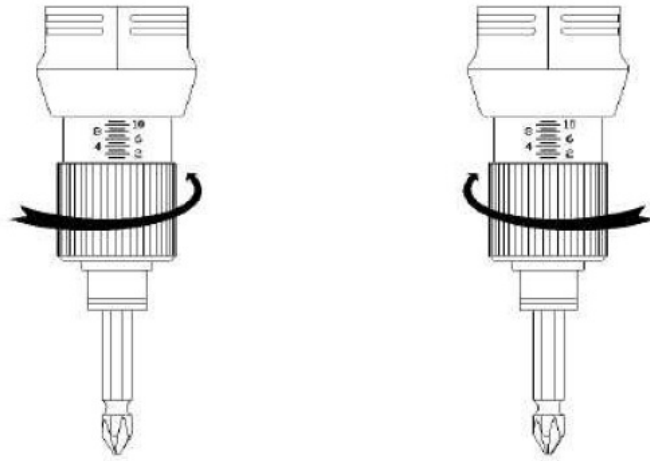

LUBRICATION

Do not grease too much gears or bearings; a thin coat shall be sufficient. Grease after 300.000 cycles.

MAINTENANCE INSTRUCTIONS

Maintenance should be performed by qualified personnel only.

- Prior to any maintenance task: disconnect the screwdriver.
- When disassembling / reassembling the screwdriver, take the following precautions:
 - Check that the controller is switched off.
 - Disconnect the cable.

According to Directive 2012/19/UE concerning Waste Electrical and Electronic Equipment (RAEE), this product must be recycled.

GUARANTEE

1. This KOLVER product is guaranteed against defective workmanship or materials, for a maximum period of 12 months following the date of purchase from KOLVER, provided that its usage is limited to single shift operation throughout that period. If the usage rate exceeds of single shift operation, the guarantee period shall be reduced on a prorate basis.
2. If, during the guarantee period, the product appears to be defective in workmanship or materials, it should be returned to KOLVER or its distributors, transport prepaid, together with a short description of the alleged defect. KOLVER shall, at its sole discretion, arrange to repair or replace free of charge such items.
3. This guarantee does not cover repair or replacement required as a consequence of products which have been abused, misused or modified, or which have been repaired using not original KOLVER spare parts or by not authorized service personnel.
4. KOLVER accepts no claim for labor or other expenditure made upon defective products.
5. Any direct, incidental or consequential damages whatsoever arising from any defect are expressly excluded.
6. This guarantee replaces all other guarantees, or conditions, expressed or implied, regarding the quality, the marketability or the fitness for any particular purpose.
7. No one, whether an agent, servant or employee of KOLVER, is authorized to add to or modify the terms of this limited guarantee in any way. However it's possible to extend the warranty with an extra cost. Further

PLUTO..FR: ESPLOSO/ EXPLODED VIEW+ INGOMBRO/ DRAWING

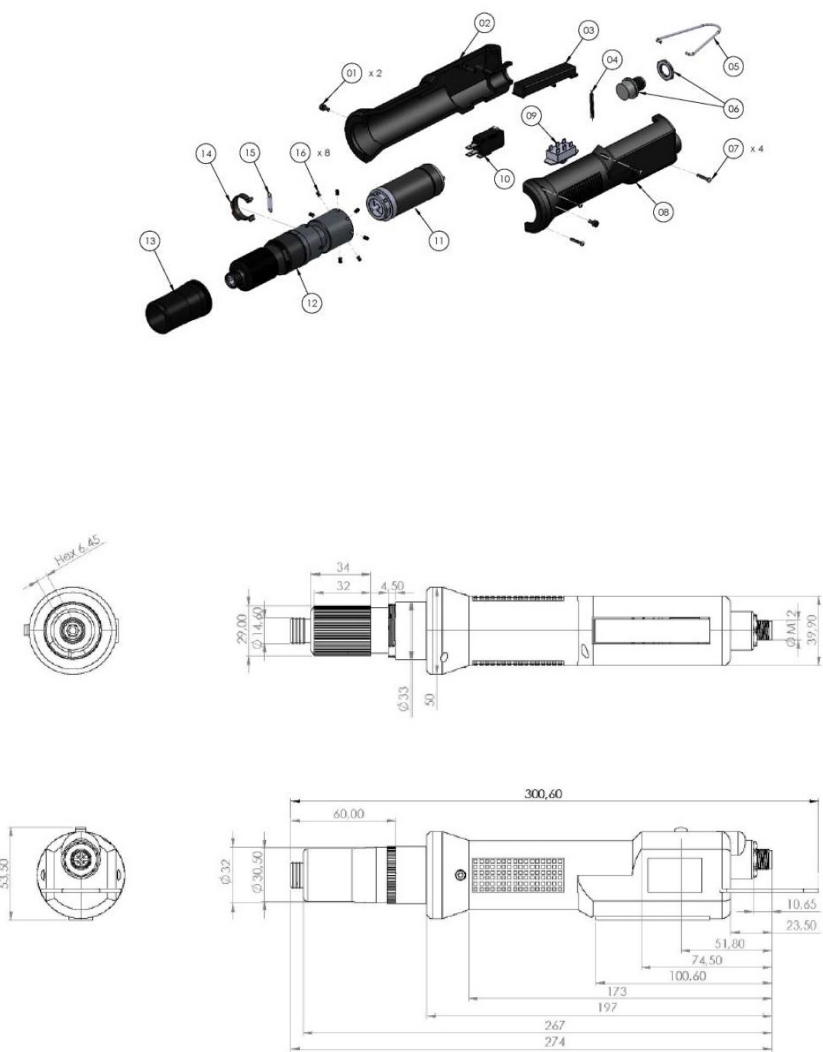

SPARE PARTS

RIF	DESCRIZIONE/ DESCRIPTION	COD.
1	Screw M3 x 6 (2)	231504
2	Left housing	220354/ESD
3	Start lever	221455/ESD
4	Spring	219855
5	Hook	200060
6	Connector M 5 pin	201666
7	Screw M3 x 6 (4)	220059
8	Right housing	220354/ESD
9	Reverse switch	200057
10	Microswitch	201056
11	Motor PL..FR	231509/FRM
12	Clutch PL3FR/HS	221090/HS
	Reduction gears clutch PL5..FR	231510/5FR
	Reduction gears+ clutch PL7..FR	231510/7FR
13	COV.PLF Cover PL..FR	020034
14	Micro switch	200034
15	Spring	200033
16	Screw M3x4 (8)	210039
	Cavo/ Cable 5 pin 2,5 mt.	200063



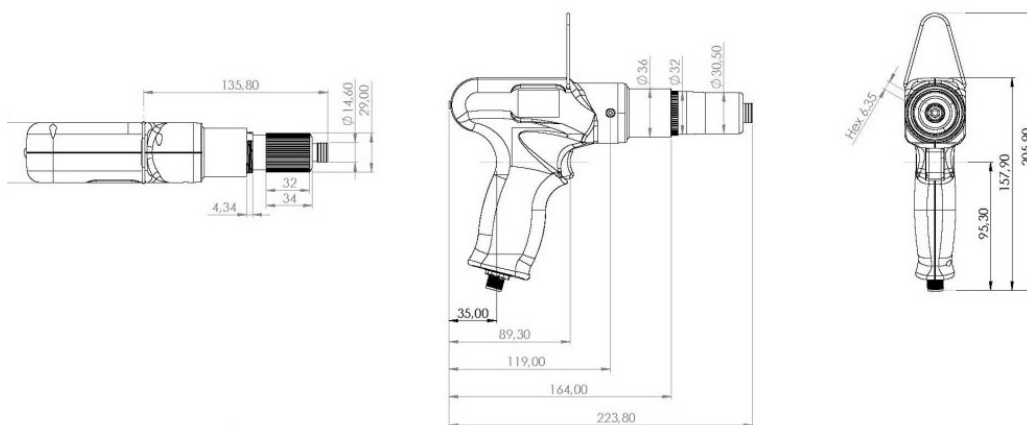

RIF	DESCRIZIONE/ DESCRIPTION	COD.
1	Hook	200060
2	Reverse switch	200057
3	Right housing	234501/ESD
4	Screw M3 x 6 (3)	220059
5	Screw 2,2x9,5 Inox (4)	234504
6	Connector seat	234506/ESD
7	Connector M 5 pin	231666
8	Microswitch	201056
9	Trigger spring	221061
10	Trigger	234503/ESD
11	Motor PL..FR	231509/FRM
12	corona/ Screw M3x4 (8)	210039
13	Clutch PL3FR/HS	221090/HS
	Reduction gears+ clutch PL5..FR	231510/5FR
	Reduction gears+ clutch PL7..FR	231510/7FR
14	COV.PLF Cover PL..FR	020034
15	Motor cover	234505/FRR
16	Micro switch	200034
		200033
18	Screw M3x6 Torx (6)	801002
		234502/ESD
	Cavo/ Cable 5 pin 2,5 mt.	200063

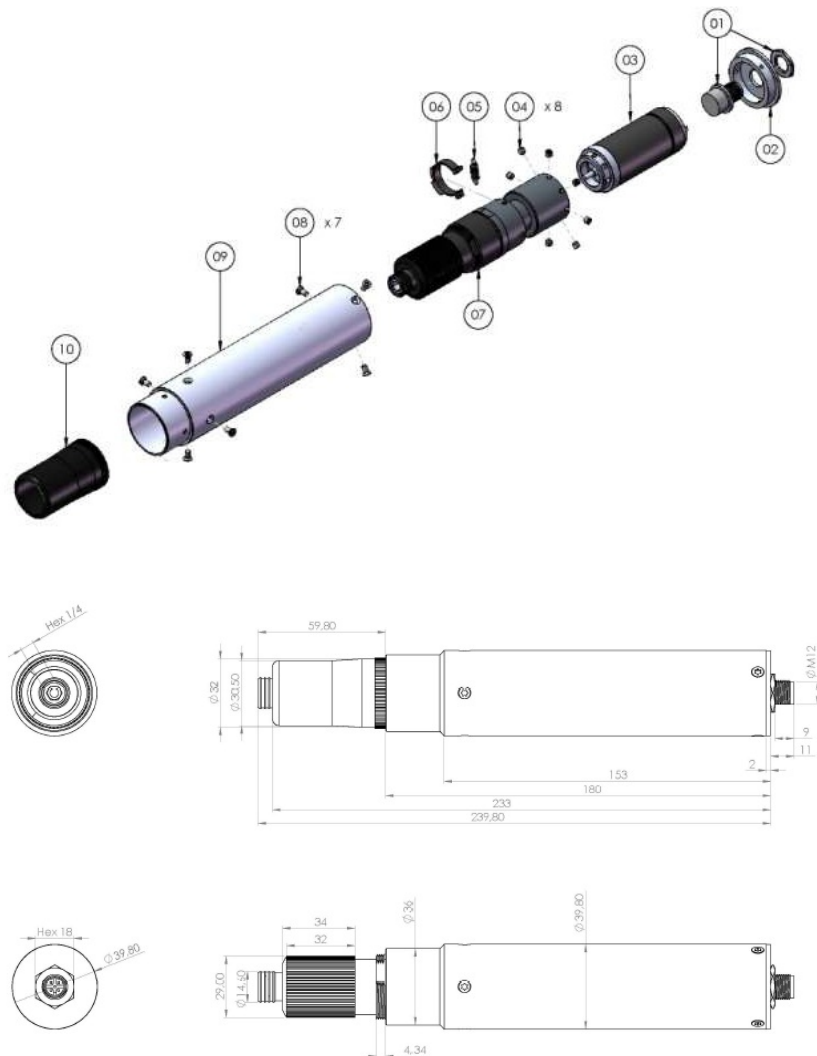

RIF	DESCRIZIONE/ DESCRIPTION	COD.
1	Connector M 5 pin	201666
2	Cap	800304
3	Motor PL..FR	231509/FRM
4	Screw M3x4(8)	210039
5	Spring	200033
6	Micro switch	200034
7	Clutch PL3FR/HS	221090/HS
	Reduction gears+ clutch PL5..FR	231510/5FR
	Reduction gears+ clutch PL7..FR	231510/7FR
8	Screw M3x6 Torx (7)	801002
9	Aluminum body	234510/FR
10	COV.PLF Cover PL..FR	020034
	Cavo/ Cable 5 pin 2,5 mt.	200063

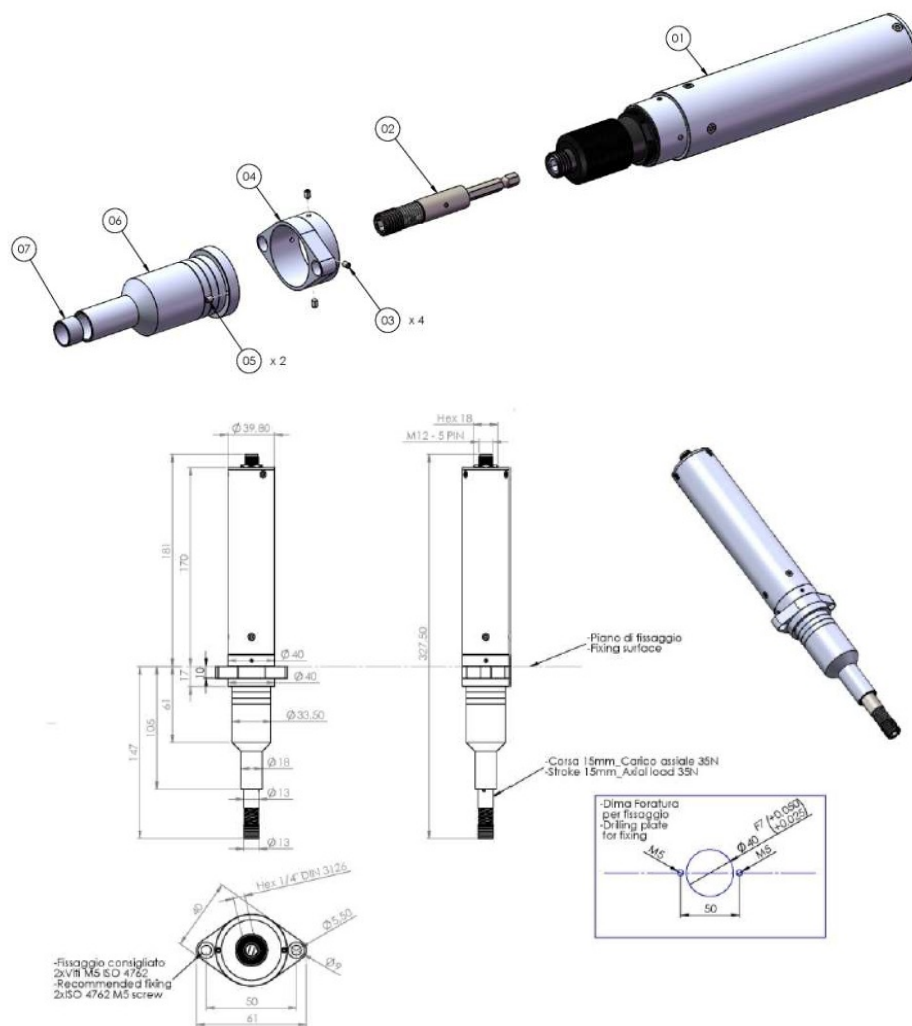

RIF	DESCRIZIONE/ DESCRIPTION	COD.
1	CA	133205
	CA	133207
2	Axial compensator	800322
3	Screw M3x5 (4)	200039
4	Support plate	231240
5	Screw M3x5 (2)	200039
6	Telescopic drive bush	234551
7	Paraglide	800334
	Cavo/ Cable 5 pin 2,5 mt.	200063

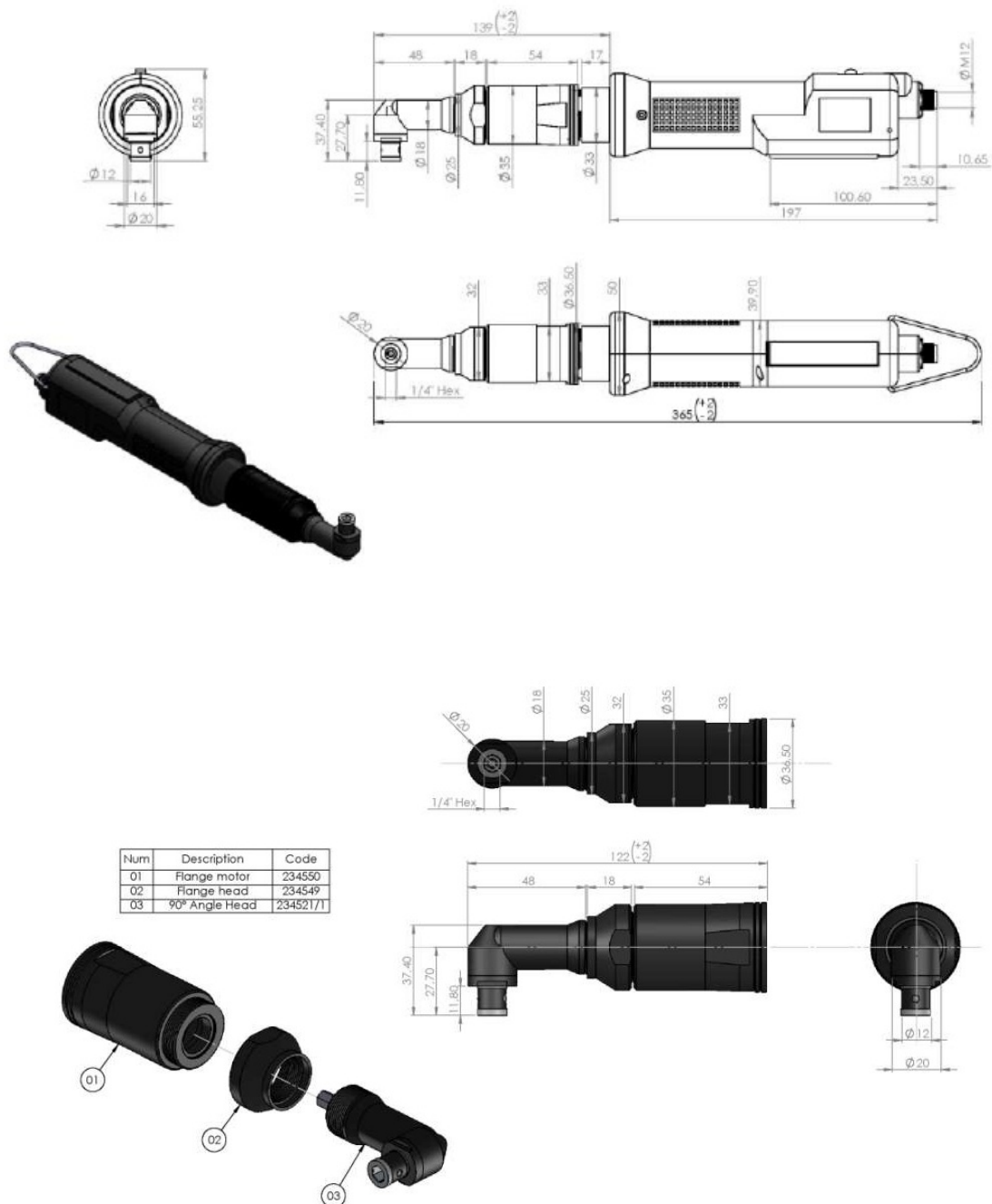

Documents / Resources

	<p>KOLVER PLUTO Precision Power Screwdrivers [pdf] Owner's Manual PLUTO, Precision Power Screwdrivers, Power Screwdrivers, Precision Screwdrivers, Screwdrivers, PLUTO</p>
---	--

References

- [Kolver srl Avvitatori elettrici ed accessori per l'assemblaggio - Homepage](#)