



KOHLER 8524T Slide Bar Instruction Manual

[Home](#) » [Kohler](#) » KOHLER 8524T Slide Bar Instruction Manual

Contents [[hide](#)]

- 1 KOHLER 8524T Slide Bar
- 2 BEFORE YOU BEGIN
- 3 ROUGH-IN DIMENSIONS
- 4 INSTALLATION
- 5 CLEANING INSTRUCTIONS
- 6 SERVICE PARTS
- 7 Documents / Resources
- 8 Related Posts

KOHLER®

KOHLER 8524T Slide Bar



BEFORE YOU BEGIN

- All information is based on the latest product information available at the time of publication. Kohler Co. reserves the right to make changes in product characteristics, packaging, or availability at any time without notice.
- Please leave these instructions for the consumer. They contain important information.

NOTES: The slide bar 8524T must be used with slide bar escutcheon 349T, 421T, 974T, 20214T or EX27055T

ROUGH-IN DIMENSIONS

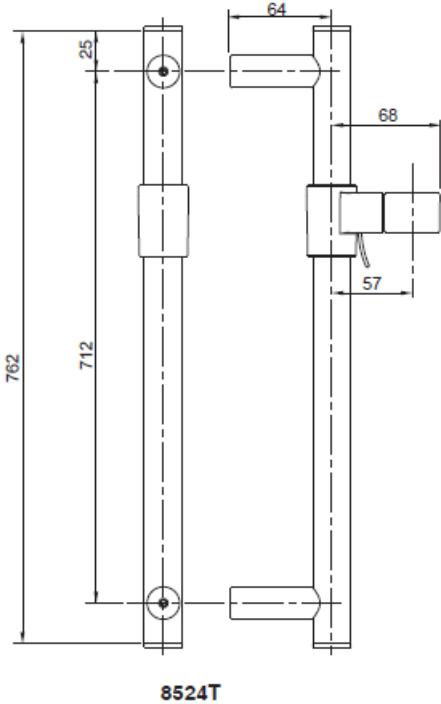

349T

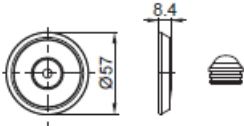

421T

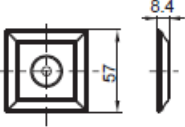

974T

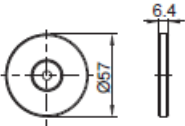

20214T

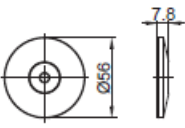

EX27055T

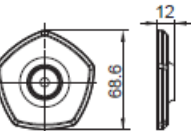

INSTALLATION

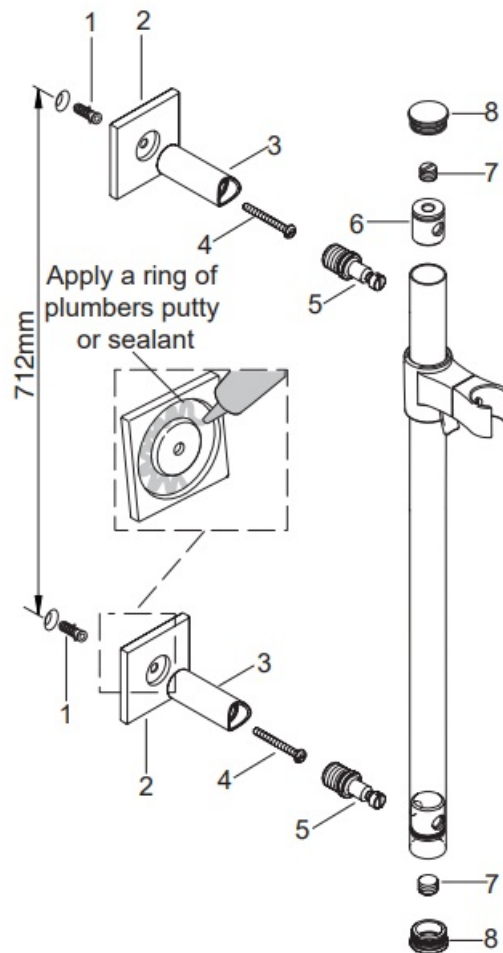

- Select a suitable location to drill two holes on the finished wall according to the rough-in dimensions and diameter of the anchor(1), their distance is 712mm. Press the anchors into the holes.
- Customer could select and install the slide bar escutcheon(2): 349T, 421T, 974T, 20214T or EX27055T.
- Apply a ring of plumbers putty or sealant into the groove on the backside of an escutcheon. Position an escutcheon and post(3) over the mounting hole. Secure an escutcheon and post to the wall with a screw(4). Loosely tighten the screw.
- Hold the slide bar up against the posts. Adjust the position of the posts until the slide bar fits snug against the curved cutout of the posts. Remove the slide bar and tighten the screws to secure the posts.
- Thread the pin(5) into the post; tighten with a flat blade screwdriver.
- Line up the hole of each lock assembly(6) with the holes of the slide bar. If needed, use a screwdriver to adjust the position of the lock assemblies.
- Align the pins with the holes in the slide bar and slide bar locks. Insert the pins through the sidebar and lock assemblies.
- Secure the slide bar by tightening the setscrews(7) into the lock assemblies.
- Press the cap(8) into each end of the slide bar.

INSTALLATION CHECKOUT

	<p>KOHLER 8524T Slide Bar [pdf] Instruction Manual 8524T Slide Bar, 8524T, Slide Bar, Bar</p>
---	---