



Kogan KASMTAGGO1A Smart Tag Tracker Compatible with Google Find My Device User Guide

[Home](#) » [Kogan](#) » Kogan KASMTAGGO1A Smart Tag Tracker Compatible with Google Find My Device User Guide



Smart Tag Tracker Compatible with Google Find My Device
Single Pack
KASMTAGGO1A, KASMTAGGO2A & KASMTAGGO4A
User Guide



Contents

1 Safety & Warnings

2 Operation

3 Specifications

4 Documents / Resources

4.1 References

Safety & Warnings

- Remove and immediately recycle or dispose of used batteries according to local environmental authority and keep away from children.
- Do not dispose of batteries in household trash or incinerate.
- Even used batteries may cause severe injury or death.
- Non-rechargeable batteries are not to be recharged.
- Do not force discharge, recharge, disassemble, heat above 100°C or incinerate. Doing so may result in injury due to venting, leakage or explosion resulting in chemical burns.
- Ensure the batteries are installed correctly according to polarity symbols (+ and -).
- Do not mix old and new batteries, different brands or types of batteries, such as alkaline, carbon-zinc or rechargeable batteries
- Always completely secure the battery compartment. If the battery compartment does not close securely, cease using the product, remove the battery and contact [help.Kogan.com](https://help.kogan.com) for support.
- Smart tag works with the Google Find My Device network helping to locate belongings in an easy and secure way. The Find My network is a crowd sourced network of almost one billion Android devices that uses Bluetooth wireless technology to detect missing devices or items nearby and report their approximate location

back to the owner in the Find My Device app. The entire process is end-to-end encrypted and anonymous, so no one else, not even Google or DNS can view a device's location or information. Visit www.google.com for more information.

- This product contains a replaceable and non-rechargeable DC 3V CR2032 coin battery, please attention below warnings:
- If this equipment causes interference to radio or television reception, which can be determined by turning the equipment off and on, correct the interference by one or more of the following measures:
- Reorient or relocate the receiving antenna
- Increase the separation between the equipment and receiver.
- Connect the equipment into an outlet on a circuit different from that to which the receiver is connected.
- Consult the dealer or an experienced radio/TV technician for help.

WARNING
KEEP OUT OF REACH OF CHILDREN



- Swallowing can lead to chemical burns, perforation of soft tissue, and death.
- If you suspect your child has swallowed or inserted a button battery, immediately call the 24-hour Poisons Information Centre on 13 11 26 (Australia) or 0800 764 766 (New Zealand) for fast, expert advice.
- Examine devices and make sure the battery compartment is correctly secured, e.g. that the screw or other mechanical fastener is tightened. Do not use if compartment is not secure.
- Dispose of used button batteries immediately and safely. Flat batteries can still be dangerous.
- Tell others about the risk associated with button batteries and how to keep their children safe.
- Severe burns can occur within 2 hours of ingestion. Seek medical attention immediately.

 **Bluetooth®** The Bluetooth® word mark and logos are registered trademarks owned by Bluetooth SIG, Inc. Any use of such marks by Shenzhen DNS Industries Co., Ltd is under license. Other trademarks and trade names are those of their respective owners.

Operation

Add Tag to 'Find My Device'

Requires: Android OS with the latest software

Note:

Make sure the phone's OS is Android 9.0 and above.

1. Place the tag close (<20cm) to your Android phone.
2. Pull out the insulation sheet and press the upper and lower covers to make them close.
3. When the tag beeps, it is ready to pair.

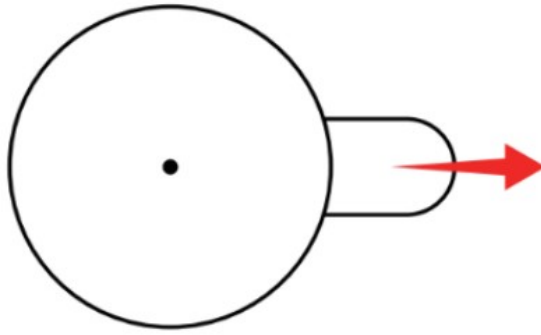

4. Turn on Bluetooth on your device.
5. Open the 'Find My Device' app on your Android phone.
6. When the tag is discovered, click 'Connect' → 'Agree and Continue' → 'Open the Application'.

Note:

If the tag isn't discovered after multiple attempts, you will need to factory reset the tag by removing and replacing the battery five times.



7. Click the Settings icon to rename the tag and change the category.

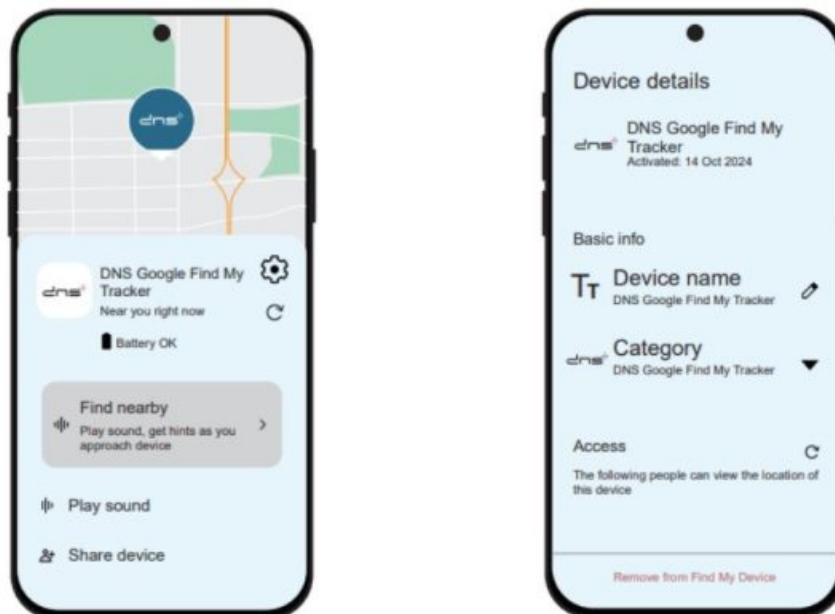

How To Remove Items

Ensure the tag is close to your phone. Click the settings icon, select 'Remove from Find My Device' to remove the tag. The tag will emit a long sound, indicating that it was successfully removed.



View Location

After adding the item successfully, you can view the location of the tag using the 'Find My Device' app.

Play Sound

Click 'Play sound' button, the tag will play sound. If you don't stop it, it will continue playing for 1 minute.

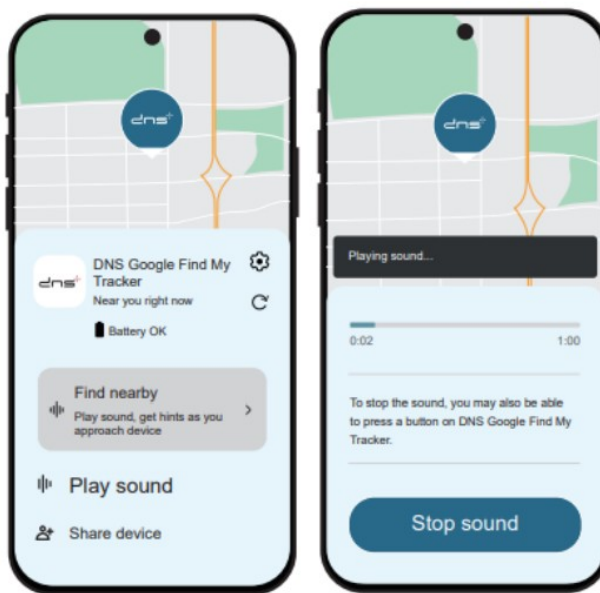

Mark as Lost

1. To mark the tag as lost, select 'Mark as lost' → 'Add contact info' → 'confirm'.
2. You can add message, phone number and email address. This info will appear if someone finds tag and taps it with their phone.

Sharing the Tag

Select 'Share Device' → 'Continue' → Select Email, Messages or other methods to share the device, then it will allow someone that you trust to locate the device in Find My Device app.

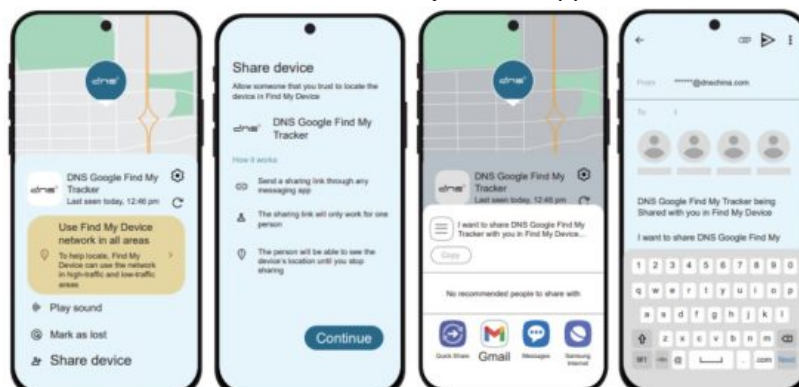

Replacing the Battery

1. The tag contains a coin battery. Replace only with a CR2032.
2. Find the slot and using including prying tool open the tag case.
3. Remove the old battery and replace it with a new CR2032 battery paying close attention to the polarity symbols (+ & -).
4. Firmly press the upper and lower case together.



Factory Reset the Tag

1. Open the case and remove and replace the battery within 3 seconds.
2. When the battery is installed back, two beeps will be heard. Repeat this process a total of five times. When the battery is installed back for the 5th time, a long beep will be heard, indicating that the factory reset is successfully.

Specifications

Range	≥40m (≥131 feet) depending on environment
Operating Temperature	-15°C – 50°C
Operating Frequency Band	2.4GHz
Alarm	Max. 82 dB
Dimensions	Ø32.4 x 8.7mm

Notes

Need more information?

We hope that this user guide has given you the assistance needed for a simple set-up.

For the most up-to-date guide for your product, as well as any additional assistance you may require, head online to [help.Kogan.com](https://help.kogan.com).

Documents / Resources

<div><div>User Guide</div><div></div><div>Smart Tag Tracker Compatible with Google Find My Device</div></div>	<div>Kogan KASMTAGGO1A Smart Tag Tracker Compatible with Google Find My Device [pdf]</div> <div>User Guide</div> <div>KASMTAGGO1A, KASMTAGGO2A, KASMTAGGO4A, KASMTAGGO1A Smart Tag Tracker Compatible with Google Find My Device, KASMTAGGO1A, Smart Tag Tracker Compatible with Google Find My Device, Compatible with Google Find My Device, Google Find My Device, Find My Device, Device</div>
--	--

References

- [🔌 Kogan Help Centre](#)
- [User Manual](#)

Manuals+. [Privacy Policy](#)

This website is an independent publication and is neither affiliated with nor endorsed by any of the trademark owners. The "Bluetooth®" word mark and logos are registered trademarks owned by Bluetooth SIG, Inc. The "Wi-Fi®" word mark and logos are registered trademarks owned by the Wi-Fi Alliance. Any use of these marks on this website does not imply any affiliation with or endorsement.