

**KOENIG PLUS NEURATH
ACTIVE.T Neurath Height
Adjustable Desk**



KOENIG PLUS NEURATH ACTIVE.T Neurath Height Adjustable Desk Instruction Manual

[Home](#) » [KOENIG PLUS NEURATH](#) » KOENIG PLUS NEURATH ACTIVE.T Neurath Height Adjustable Desk Instruction Manual 

Contents

- 1 KOENIG PLUS NEURATH ACTIVE.T Neurath Height Adjustable Desk
- 2 Product Information
- 3 Product Usage Instructions
- 4 INTRODUCTION
- 5 TECHNICAL DATA
- 6 SAFETY INSTRUCTIONS
- 7 GETTING STARTED
- 8 PEDESTAL AND SHELF STOP
- 9 CONTROL PANEL
- 10 ROCKER SWITCH
- 11 DECLARATION OF EC CONFORMITY
- 12 CARE AND CLEANING INFORMATION
- 13 APPENDIX
- 14 Contact Information
- 15 Documents / Resources
 - 15.1 References



KOENIG PLUS NEURATH ACTIVE.T Neurath Height Adjustable Desk



Product Information

Specifications

- **Weight Capacity:** max. 80 kg, evenly distributed load
- **Lifting Speed:** 38 – 50 mm/sec.
- **Noise Level:** < 45 dB
- **Power Supply:** 100-240 Volt / 50-60 Hz
- **Power Consumption:** 250 W
- **Standby Power Consumption:** 0.3 W
- **Operating Mode:** S2 10%, max. 2 minutes intermittent operation

Product Usage Instructions

Safety Instructions

Before operating the product, ensure you have read and understood all safety instructions provided in the manual.

Installation

Refer to the assembly instructions available in the media database at www.koenig-neurath.com for proper installation.

Operation

- **Basic Operation (without Memory Function)**

Use the UP and DOWN buttons to adjust the height of the table.

- **Setting Container and Shelf Stops**

Follow the instructions in the manual to set stops for containers and shelves at desired positions.

- **Advanced Operation (with Memory Function)**

Utilize the Memory button to save preferred table heights for easy access. The display will show the saved positions.

- **Saving Table Positions**

With the Memory function, save table positions by following the steps displayed on the screen.

- **Recalling Saved Positions**

To recall saved table positions, press the corresponding Memory button.

- **Troubleshooting**

If you encounter any error codes or issues, refer to the manual for specific troubleshooting steps based on the displayed code or problem description.

FAQ

- **Q: What should I do if the table does not move when I press the buttons?**

A: Check the power supply and ensure the cables are properly connected. If the issue persists, refer to the troubleshooting section in the manual.

- **Q: How do I reset the table to its default settings?**

A: Follow the reset instructions provided in the manual to restore the table to its initial configuration.

MOTORISED HEIGHT-ADJUSTABLE TABLES

PLEASE READ THE FOLLOWING INSTRUCTIONS CAREFULLY! KEEP THESE OPERATING INSTRUCTIONS IN A SAFE PLACE.

INTRODUCTION

Dear customer,

You have chosen a quality product from König+Neurath. To ensure that your furniture performs to your complete satisfaction, please read the following instructions carefully and take note of the safety guidelines.

AREA OF APPLICATION

- The ACTIVE.T tables are suitable for sitting and standing work in the office.
- The tables are not suitable for use in the workshop or warehouse or wet areas.

TRANSPORT

DO NOT TRANSPORT THE TABLE IN A VERTICAL POSITION! DO NOT STORE THE TABLE IN A VERTICAL POSITION!

- Please do not carry or lift the table by the tabletop but by the frame.
- Do not drag the table along the floor, even on the carpet, as it could be damaged.

The assembly instructions can be found in the media database at: www.koenig-neurath.com.

TECHNICAL DATA

- **Load capacity:** max. 80 kg, load uniformly distributed
- **Lifting speed:** 38 – 50 mm/sec.
- **Noise emission:** < 45 dB
- **Supply voltage:** 100-240 Volt / 50-60 Hz

- **Power input:** 250 W
- **Power input (standby):** 0,3 W
- **Mode of operation:** S2 10%, max. 2 min. short-term

SAFETY INSTRUCTIONS

Failure to follow the instructions can lead to accidents with serious personal injury, please read the following safety instructions carefully. It is crucial that any person installing or using the system has the necessary information and access to the user instructions.

Before starting:

Make sure the table has been properly assembled. The table may only be connected to the mains voltage which is indicated on the control box.

During operation:

If the control box makes any unusual noises or emits odors, pull the mains plug immediately. Make sure the cables have not been damaged. If the power cord is damaged, it must be replaced by the manufacturer or its customer service or a similarly qualified person to avoid a hazard.

Before uninstalling or troubleshooting:

Stop the motorized table!

Switch off the power supply and pull the mains plug! Remove any load from the table!

- Please read the following safety instructions carefully to avoid injury to yourself and others.
- Lay the hand that is not operating the table on the tabletop.
- Make sure that no one is at or under the table when lifting and lowering.
- During lowering make sure that no objects such as waste bins or pedestals become wedged under the table.
- To prevent the risk of crushing and shearing, the table and all of its moving parts (incl. attachments and accessories) must have a clearance of at least 25 mm to adjacent objects. Failure to comply could cause serious injury to the user.
- **Caution!** Tables at standing height can tip over more easily than at seated height.
- The max. permissible net load is 80 kg.
- Please do not sit on the tabletop!
- The table is not suitable for transporting people.
- The table can be used by children aged 8 years and above and persons with reduced physical, sensory, or mental capabilities or lack of experience and knowledge if they have been given supervision or instructions concerning the safe use of the device and when they understand the potential risks.
- Never leave the table unattended while in use! Children should be supervised to ensure that they do not play with the table. Pull out the mains plug when the table is not in use.
- Cleaning and user maintenance must not be performed by children without supervision.
- The lifting system is designed for short-term operation. After two minutes of operating time, an 18-minute break is required.
- Please note that the lifting system has a circuit breaker that switches off the system in the event of an overload.
- Repairs of the control box or the control panel should only be carried out by qualified personnel. Unauthorized opening and improper repairs can present risks to the user and, if ignored, could result in personal injury or danger to life because of an electric shock. Failure to follow the instructions will make all guarantee, warranty,

and compensation claims null and void.

GETTING STARTED

- Make sure the table has been set up correctly, that the plug to the control panel is inserted firmly, and that the cables from your office equipment and the computer are in the appropriate trays. Connect the table to the mains.
- Initialize the table as described on page 47 (reset).

ERGONOMICS

You should always adjust the table height so that your elbows form an angle of at least 90° whether you are seated or standing.

Tip!

Make sure your screen position does not cause glare.

You can get more information on ergonomics in the office from the Administrative Professional Association at: www.vbg.de/bueroarbeit.

RESET

A reset run is required when the drive system is started up for the first time or in the event of a malfunction (e.g. power cut).

- During the reset process, the collision cut-out is inactive! Beware of the risk of crushing. Please ensure that there are no objects or persons in the hazard area (the total potential lift and movement area for all components) and that they cannot be pulled into the hazard area.

• NOTE

Releasing the key too soon results in a function error. If this happens, repeat the reset process.

- To perform a reset, proceed as follows:
- (Control panel with memory function: First press any key to activate the display.)
- Press the button downwards and keep it pressed until the table stops automatically.
- The pedestal stop position is reached.
- Press and hold the button down again.
- The table moves to the minimum position at a reduced speed.
- Release the button and press and hold it down again for at least 8 seconds.
- The table moves to the lowest mechanical position, and “ref” appears in the display if the control panel has a display.

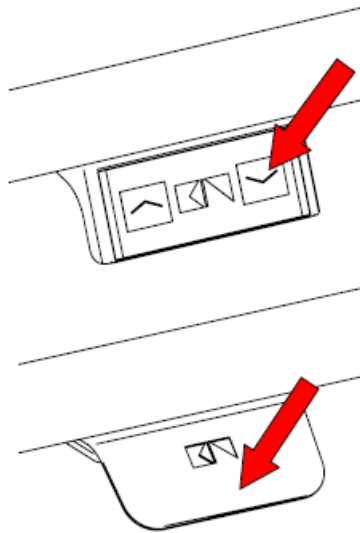

- When you release the button, the table moves back to the minimum position, and “CAL” appears on the display for control panels with display.
- The reset process is confirmed by the control unit clicking twice.

NOTE

For optimum function, the table sensor automatically performs a calibration after the reset. This takes approx. 5-10 seconds. The table must not be touched or moved during calibration.

PEDESTAL AND SHELF STOP

- Pedestal and shelf stops are safety positions that cannot be crossed during normal operation so that collisions with existing obstacles can be prevented. The pedestal stop limits the movement downwards (minimum height) and can be used if there is, for example, a pedestal below the table.
- The shelf stop limits the movement of the table upwards. The shelf stop can be used if there is, for example, a shelf above the table.
- Control panel without memory function.
- Control panel with memory function.
- Rocker switch.
 - Only trained personnel should set and delete pedestal and shelf stops. There is a danger of injury from incorrect settings and the table may be damaged.

CONTROL PANEL

CONTROL PANEL (WITHOUT MEMORY FUNCTION)

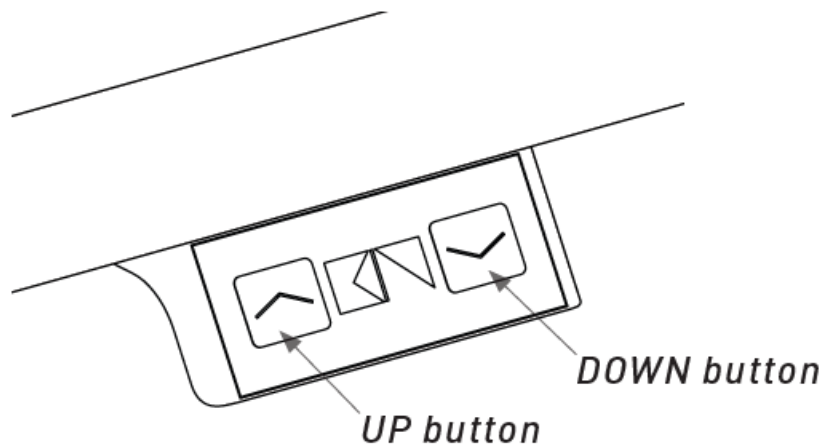

- **Move tabletop upwards**

Keep the UP button pressed until the desired height is reached.

- **Move tabletop downwards**

Keep the DOWN button pressed until the desired height is reached.

NOTE

The table moves up or down until you release the button or the minimal or maximum height is reached.

SET PEDESTAL AND SHELF STOP

The procedure for setting the respective stop is identical, proceed as follows:

1. Move the table, using the UP or DOWN button, to the desired position.
2. Press the UP and DOWN buttons at the same time.
3. The control unit clicks twice to confirm.

(If there is no clicking sound, setting may not be permitted.)

DELETE PEDESTAL STOP

1. Keep the DOWN button pressed.
2. The table stops automatically upon reaching the pedestal.
3. Press the UP and DOWN buttons at the same time.
4. The control unit clicks twice to confirm.

DELETE SHELF STOP

1. Keep the UP button pressed.
2. Steps 2 to 4 are identical to deleting the pedestal stop.

NOTE

If an attempt is made to set the pedestal stop or shelf stop too close to the middle of the adjustment range, the controller signals this with six “click-clack” sounds.

CONTROL PANEL (WITH MEMORY FUNCTION)

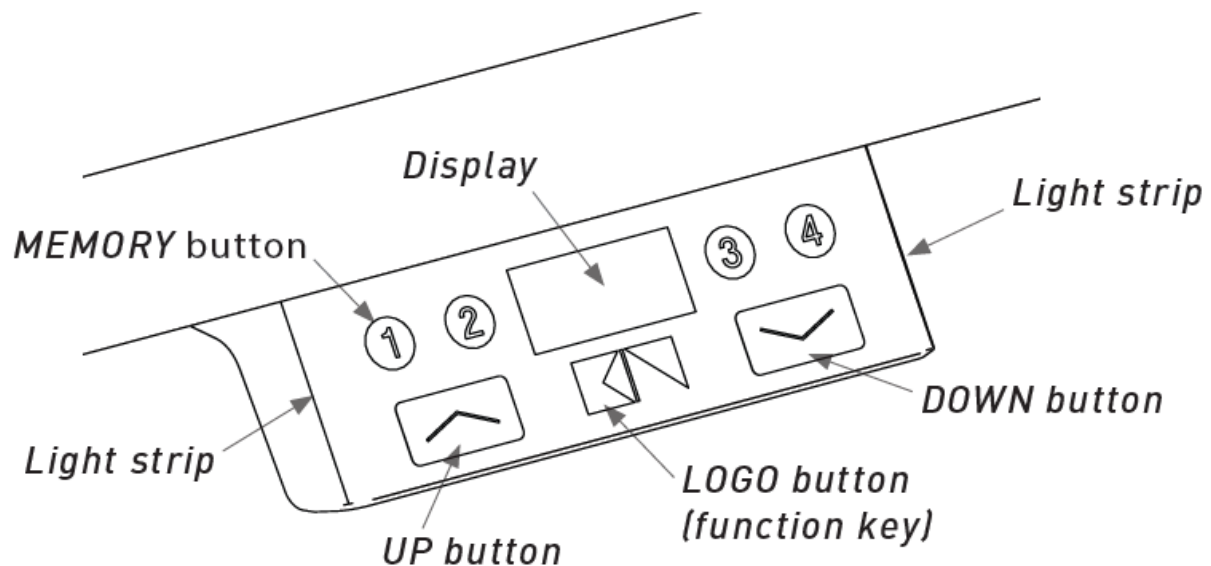

- The control panel is equipped with a display to show the current tabletop height. Error messages and table status are shown on the display. Positions 1-4 can be used to move to previously saved positions.
- Press any button when the display is deactivated.
- **Move tabletop upwards**
Keep the UP button pressed until the desired height is reached.
- **Move tabletop downwards**
Keep the DOWN button pressed until the desired height is reached.

NOTE

The table moves up or down until you release the button or the minimal or maximum height is reached.

SAVE TABLETOP POSITION

(only control panel with memory function)

- Move the table, using the UP or DOWN button, to the desired position.
- Press the LOGO button below the display.

- The display shows P _. The light strips flash.
- Press a MEMORY button (for example 1).

- The Display shows P _1.

The saving process is completed. After approx. 2 seconds the current height is displayed. In this way, 4 different positions can be saved. The saved positions cannot be deleted. A saved position can be overwritten.

NOTE

No positions can be saved below an existing pedestal stop.

RETRIEVE A SAVED POSITION

Press the button for the desired position (1, 2, 3, or 4), the table moves independently from the current position to the saved position.

NOTE

The button must be pressed until the position is reached, if the button is released prematurely, the table will stop.

MENU SETTINGS

The control panel offers various setting options that can be made by the user. Press the LOGO button for approx. 6 seconds to select a menu to change a selected setting. This is indicated by the flashing light strips. If no setting is made in the submenu for 10 seconds, the control panel returns to the main menu. All settings made in the submenus are permanently saved in the control, even when the control panel is replaced.

Menu structure:

- F 1 Change unit (inch – cm) F 2 Height calibration
- F 3 Reset to factory settings
- F 4 Set pedestal and shelf stop
- F 5 Delete pedestal and shelf stop
- F 11 Keylock

To enter the submenu, press the LOGO button.

F 1 CHANGE UNIT

The display can show the height of the tabletop in centimeters or inches. The unit can be changed via the menu. The height is displayed in whole centimeters or in inches to one decimal place.

- To change the units, proceed as follows:
- Press the LOGO button below the display.
- If necessary, use the UP and DOWN buttons to navigate to menu item 1. F 1 must appear in the display.
- Confirm the selection by pressing the LOGO button again.
- The display shows the current setting I or C.
- Now select the desired unit by pressing the UP or DOWN button.
- Confirm the selection by pressing the LOGO button again.
- Without selection and further actions, the display automatically returns to the main menu after approx. 10 seconds.
- This setting is saved permanently.

F 2 HEIGHT CALIBRATION

The control panel may not show the actual height of the tabletop. This can be due, for example, to the height adjustment using leveling glides on the table. The height can be adjusted subsequently in the menu of the control panel.

Proceed as follows:

- Measure the current, correct table height.
- Press the LOGO button below the display.
- If necessary, use the UP and DOWN buttons to navigate to menu item 2. F 2 must appear in the display.
- Confirm the selection by pressing the LOGO button again.
- Adjust the displayed height with the UP or DOWN button to the actual height, up or down.
- Confirm the selection by pressing the LOGO button again.
- Without selection or further actions, the display automatically returns to the main menu after approx. 10

seconds.

F 3 RESET TO FACTORY SETTINGS

To reset the control to factory settings, proceed as follows:

- Press the LOGO button below the display.
- If necessary, use the UP and DOWN buttons to navigate to menu item 3. F 3 must appear in the display.
- Confirm the selection by pressing the LOGO button again.
- The display shows 000.
- Press the LOGO button again.
- All settings are reset to factory settings. The menu is automatically exited and the display shows C38.
- Finally, carry out a reference run (reset).

F 4 SET PEDESTAL AND SHELF STOP

Pedestal and shelf stops are safety positions that cannot be crossed during normal operation so that collisions with existing obstacles can be prevented. The pedestal stop limits the movement downwards (minimum height) and can be used if there is, for example, a pedestal below the table. The shelf stop limits the movement of the table upwards. The shelf stop can be used if there is, for example, a shelf above the table.

- Move the table, using the UP or DOWN button, to the desired position.
- Press the LOGO button below the display.
- If necessary, use the UP and DOWN buttons to navigate to menu item 4. F 4 must appear in the display.
- A display appears with a bar at the top left or bottom right.
- Press the UP button to save the upper-end position (shelf stop).
- Press the DOWN button to save the lower-end position (pedestal stop).
- Confirm by pressing the LOGO button again or wait 10 seconds.

F 5 DELETE PEDESTAL AND SHELF STOP

To delete a pedestal or shelf stop, proceed as follows:

- Press the LOGO button below the display.
- If necessary, use the UP and DOWN buttons to navigate to menu item 5. F 5 must appear in the display.
- A display appears with one bar at the top and one at the bottom.
- Press the UP button to delete the shelf stop (upper stop). or
- Press the DOWN button to delete the pedestal stop (lower stop).
- Confirm by pressing the LOGO button again or wait 10 seconds.
 - Only trained personnel should set and delete pedestal and shelf stops. There is a danger of injury from incorrect settings and the table may be damaged.

F 11 KEYLOCK

To protect the table against unauthorized use, the movement of the table can be activated or deactivated via the menu using the control panel.

To activate or deactivate, proceed as follows:

- Press the LOGO button below the display.
- Use the UP and DOWN buttons to navigate to menu item 11. F 11 must appear in the display.

- Confirm the selection by once again pressing the LOGO button.
- Switch the function ON or OFF with the UP and DOWN buttons:
 - ON – The table works normally
 - OFF – Table is deactivated, movement is not possible
- Confirm by pressing the LOGO button again or wait 10 seconds.

TROUBLESHOOTING

Fault description	Troubleshooting
The table does not move	Check whether the controller has power.
	Check the connection between the drives and the controller(s). Restore the connections.
	Check the load on the table. Reduce the weight on the table.
	Power on duration exceeded. Wait until the table is ready for use again (approx. 3 min.).
	Drive defective: Contact customer service
	Controller defective: Contact customer service
	Hand switch faulty: Replace the hand switch or contact customer service.
	Carry out an initialization run
The table is not moving, but moved earlier	The table is at a slant: Carry out an initialization run.
	The table leg was disconnected: Check all the connections and carry out an initialization run.
	Power on duration exceeded. Wait until the table is ready for use again.
Table stops abruptly	Power on duration exceeded. Wait until the table is ready for use again.
	Check the load on the table. Reduce the weight on the table.
The table stops abruptly and moves back	Collision protection has been triggered: Remove the obstacle and try it again.
Table moves slowly and downwards only	The table is in an initialization run. Allow it to finish.
The table only moves briefly on one side and then remains stationary	The table is below the safety stop (downward movement slow; upward movement at normal speed): Move upwards, out of this zone.
	Drive defective: Contact customer service
Table moves slowly	The table is below the safety stop (downward movement slow; upward movement at normal speed): Move upwards, out of this zone.
	Check the load on the table. Reduce the weight on the table.

NOTE

If an error cannot be corrected as described, please pull out the mains plug and wait at least 3 minutes. Initialize the table as described on page 47. If the error persists, pull out the mains plug again and inform customer service.

ERROR CODES

Display	Description	Remedy	Display after troubleshooting
C01	Short circuit of motor 1	Pull out the mains plug! Eliminate the external short circuit, check the cables to the motors for possible damage or plug the correct motor into the socket concerned. Put the control back into operation.	00 1-999 Normal height display
C02	Short circuit of motor 2		
C05	Relay contact is sticking	Replace the controller.	C3B an initialisation run is required
C11	Cable of motor 1 was pulled out	Check the cable or plug connection to the motors	C3B an initialisation run is required
C12	Cable of motor 2 was pulled out		
C15	No pulses measurable	Check the cables to the motors for possible damage and secure contact or, if necessary, replace the motor at the relevant socket. Put the controller back into operation.	C3B an initialisation run is required
C34	Overcurrent at motor 1	Max. load exceeded; remove the load from the table.	00 1-999 Normal height display
C35	Overcurrent at motor 2		
C3B	The motors are out of sync. An initialisation run is required	Motor positions too different. Distribute the load more evenly on the table. If necessary, reduce the load on the table. Perform an initialisation run.	00 1-999 Normal height display
SP	System protection / system pause The powering-on duration of the system was exceeded.	Wait until the controller has cooled down and the display disappears. Then, the movement duration of 20 seconds is cleared. Only after 18 minutes does the table move again for a full 2 minutes. Attention! The calculation of the powering-on duration is performed even if there is no mains voltage present.	

C39	Cascading error a controller is not communicating	Check whether the STAND.CONNECT connection cable between the controllers is correctly plugged in and a power cable is plugged into both controllers.	00 1-999 Normal height display
		Use the F3 menu to restore the factory settings in order to carry out a reconfiguration.	C38 an initialisation run is required
C40	Sensor module error	Further movements are made without collision protection. Movement remains possible. Check sensor module.	00 1-999 Normal height display after entering in one direction
C51	Contradictory movement commands	Stop operation at all the present hand switches.	00 1-999 Normal height display after entering in one direction
C52	The UP button on the hand switch is stuck.	Replace hand switch.	00 1-999 Normal height display
C53	The DOWN button on the hand switch is stuck.		
C81	Voltage too small	Can occur after disconnecting the power cord.	00 1-999 Normal height display after powering up
		Fault on mains power input, replace controller	C38 an initialisation run is required
C82	Voltage too high	Fault on mains power input, replace controller	C38 an initialisation run is required
C84	No columns connected when the controller is switched on	First connect the desired number of columns and hand switches and use the F3 menu to restore the factory settings	C38 an initialisation run is required
C85	Number of columns does not match the current configuration	Check the motor cables or use the F3 menu to restore the factory settings.	C38 an initialisation run is required
REF	Initialisation run is carried out.	Perform the initialisation run to the lowest block position.	00 1-999 Normal height display

CLICK CODES

Number of “click-clack” sounds	When	Status information
1	Supply of electrical power (*dependent on configuration)	Normal operation: The system is functioning without any problems. Faulty operation: The controller does not have any firmware: Only one click is heard.
1	UP button pressed	Reset: Initialisation run is required.

1	Lower stop detected	Reset: The table has reached the Reset position during the initialization run. The DOWN button can be released.
1	Lower stop detected	Reset: The initialization run has ended; the DOWN button continues to be pressed. Release the button.
2	Set pedestal or shelf stop	Confirmation: The position was successfully saved.
3	The first movement after the sensor out	Caution: A previously detected sensor has been removed. Normal operation can continue.
3	First movement after sensor reinserted	Note: A sensor was reconnected after a previously detected sensor had been removed. Normal operation can continue.
4	Delete pedestal or shelf stop	Confirmation: The position was successfully deleted.
6	Pedestal stop or shelf stop is set too near the middle of the desk travel.	Warning: An attempt is being made to set the pedestal stop or shelf stop too near the middle of the total desk travel.
7	Motor cable pulled out or missing	Warning: Motor cable absent when connecting to the mains, or has been disconnected during operation. Connect the missing motor cable with the controller.
7	The table moves at an angle	Warning: The slanted position of the table has become too great. Carry out an initialization run.

ROCKER SWITCH

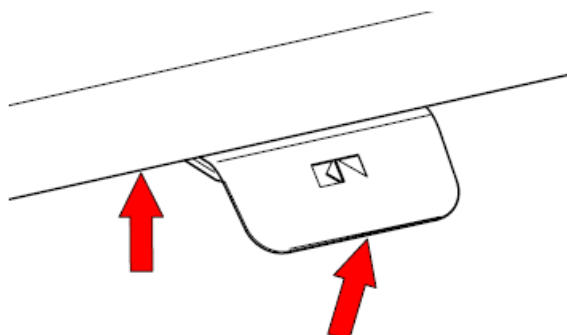

Tabletop upwards

Pull the button slightly upwards and hold it. Release the button when you have reached the desired tabletop height. The control panel lights up as long as it is pressed.

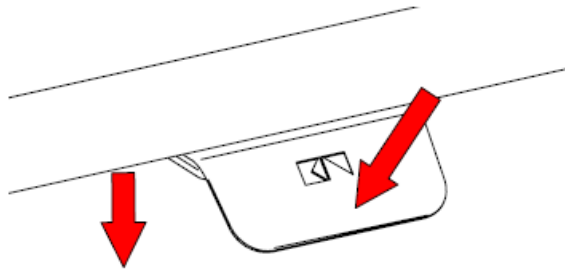
**Tabletop downwards**

Press the button slightly downwards and keep it pressed. Release the button when you have reached the desired tabletop height. The control panel lights up as long as it is pressed.

NOTE

The tabletop moves up or down until you release the button or until the maximum or minimum tabletop height is reached.

SET PEDESTAL AND SHELF STOPP

The procedure for setting the respective stop is identical. Proceed as follows:

- Move the table to the desired height.
- Press the center button below the control panel for 5 seconds.
- The control unit clicks twice to confirm.
- The pedestal/shelf stop has been set.

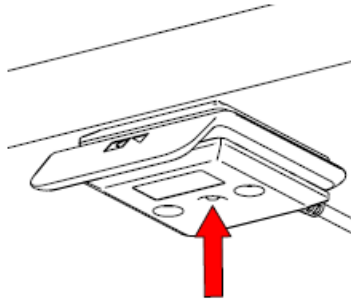
**NOTE**

If the click does not occur, the setting may not be permitted.

DELETE PEDESTAL STOP

- Press the button down and keep it pressed.
- The table stops automatically when the pedestal stop is reached.
- Press the center button below the control panel for 5 seconds.
- The control unit clicks twice to confirm.
- The pedestal stop has been canceled.

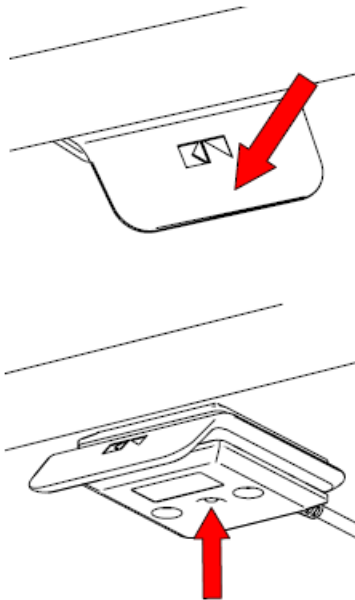

DELETE SHELF STOP

- Pull the button upwards and hold it.
- The table stops automatically when the shelf stop is reached.
- Press the center button below the control panel for 5 seconds.
- The control unit clicks twice to confirm.
- The shelf stop has been canceled.

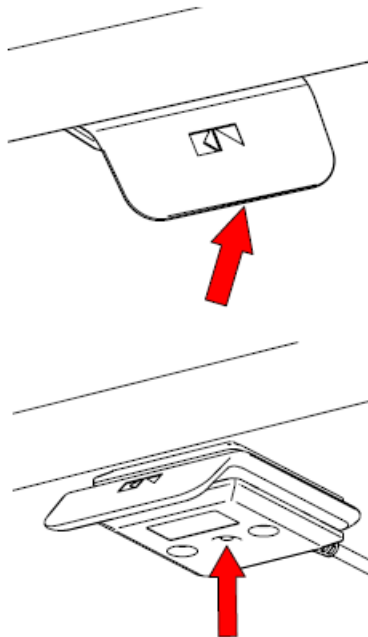

RESET TO FACTORY SETTINGS

- Press the center button below the control panel for 10 seconds.
- After 5 seconds, the control unit already clicks due to the pedestal/shelf stop functions.
- Keep the button pressed until the control unit clicks again after a further 5 seconds.
- The factory settings are then restored.
- Finally, an initialization run (reset) must be carried out.

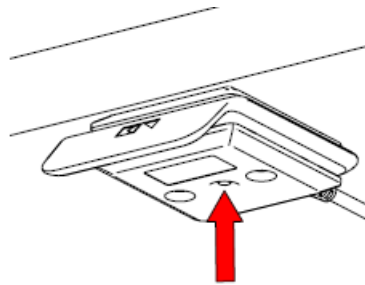

NOTE

- Immediately after setting the factory settings, only approx. 20 seconds of traveling time may be available.
- After a waiting time of approx. 18 minutes and 2 minutes of traveling time are available again.

TROUBLESHOOTING

Error description	Troubleshooting
The table does not move	Check whether the table frame has power.
	Check the connection between the control unit and the control panel. Re-establish the connection if necessary.
	Switch-on time exceeded. Wait until the table is ready for use again (approx. 3 minutes).
	The control panel is defective. Replace the control panel or contact customer service.

NOTE

If an error cannot be corrected as described, please pull out the mains plug and wait at least 3 minutes. Initialize the table as described on page 47. If the error persists, pull out the mains plug again and inform customer service.

DECLARATION OF EC CONFORMITY

The company König + Neurath AG, Industriestraße 1-3, 61184 Karben, Germany - hereby declares that the following product: sitting/standing office desk with an electric height-adjustment mechanism from the ACTIVE.T system meets all applicable requirements of the EC Machinery Directive 2006/42/EC. In addition, we also confirm that this machinery is in compliance with EU Directive on Electromagnetic Compatibility 2014/30/EU, Low Voltage Directive 2014/35/EU and complies with RoHS Directive 2011/65/EU.

The following standards and specifications have been applied:

Standards and specifications that have been applied:*

DIN EN ISO 12100	Safety of machinery - General principles for design - Risk assessment and risk reduction
DIN EN ISO 13849-1	Safety of machinery - Safety-related parts of control systems - Part 1: General principles for design
DIN EN 60335-1	Household and similar electrical appliances - Safety - Part 1: General requirements
DIN EN 527-1/-2	Office furniture - Work tables
DGV Principle 315-410:2021	Safety requirements for work tables, office cabinets and upgradable room dividing elements in Germany
DIN EN 55014-1/-2	Electromagnetic compatibility - Requirements for household appliances, electric tools and similar apparatus
DIN EN 62233	Measurement methods for electromagnetic fields of household appliances and similar apparatus with regard to human exposure.
DIN EN 61000-3-2	Electromagnetic compatibility (EMC) - Part 3-2: Limits - Limits for harmonic current emissions
DIN EN 61000-3-3	Electromagnetic compatibility (EMC) - Part 3-3: Limits - Limitation of voltage changes, voltage fluctuations

We hereby confirm that the equipment stated above, in the version in which we have marketed it, complies with the EU directives listed. In the event of improper use or unauthorized product modifications, this declaration will cease to be valid.

*The applicable version of any standards/specifications is the one which is valid on the day of issue of this declaration.

Karben, 17 January 2024

Documentation officer:
Raphael Groh
Team Leader, Development
König + Neurath AG
Industriestraße 1-3
61184 Karben



Raphael Groh
Team Leader, Development

Dirk Fischer
Chief Technical Officer

CARE AND CLEANING INFORMATION

- Melamine-coated and metal surfaces
- Clean the surface with a duster. Use warm water and/or a mild cleaner to remove marks, then wipe dry.
- Caution: Do not use abrasive cleaners! This can cause permanent visible damage.

Natural wood surfaces

- Wipe the surface with a duster, Use a damp cloth and a neutral cleaning agent to remove soiling, then wipe dry.
- Caution: Do not use abrasive cleaners! This can cause permanent visible damage. Avoid direct exposure of the natural wood surface to high temperatures and moisture.
- Please note that the natural wood surface can change color over time if exposed to UV rays. This is a natural aging process of the wood.

Control panel

Always keep the control panel and plug connectors free of dirt! Clean the control panel with a dry, soft

NOTE

No liability is accepted for damage to the surface caused by incorrect cleaning.

APPENDIX

Repairs

- To prevent malfunctions, any repairs on the lift columns may only be made by specialists.
- Please notify K+N customer service!

Maintenance

The lift columns are maintenance-free.

Disposal

The ACTIVE.T tables with motorized height adjustment must be disposed of under the valid directives and regulations.

Contact Information

Deutschland

- König + Neurath AG Industriestraße 1–3 61184 Karben
- T +49 6039 483-0
- info@koenig-neurath.de

Great Britain

- König + Neurath (UK) Ltd. Ground and Lower Ground Floor 75 Farringdon Road London EC1M 3JY
- T +44 20 74909340
- info@koenig-neurath.co.uk

Nederland

- König + Neurath Nederland Beethovenstraat 530 1082 PR Amsterdam
- T +31 20 4109410
- info@konig-neurath.nl

France

- König + Neurath AG 53, rue de Chateaudun 75009 Paris
- T +33 1 44632393
- info@koenig-neurath.fr

Schweiz

- König + Neurath (Schweiz) GmbH St. Gallerstrasse 106 d CH-9032 Engelburg/St. Gallen
- T +41 52 7702242
- info@koenig-neurath.de

Österreich

- König + Neurath AG Gonzagagasse 1/Morzinplatz 1010 Wien
- T +43 676 4117512
- info@koenig-neurath.de

koenig-neurath.com.

Documents / Resources

	<p>KOENIG PLUS NEURATH ACTIVE.T Neurath Height Adjustable Desk [pdf] Instruction Manual</p> <p>ACTIVE.T Neurath Height Adjustable Desk, ACTIVE.T, Neurath Height Adjustable Desk, Height Adjustable Desk, Adjustable Desk, Desk</p>
---	---

References

- koenig-neurath.com
- [STRATO - Domain reserved](#)
- [Geen webhosting actief](#)
- koenig-neurath.com
- [User Manual](#)

Manuals+, Privacy Policy

This website is an independent publication and is neither affiliated with nor endorsed by any of the trademark owners. The "Bluetooth®" word mark and logos are registered trademarks owned by Bluetooth SIG, Inc. The "Wi-Fi®" word mark and logos are registered trademarks owned by the Wi-Fi Alliance. Any use of these marks on this website does not imply any affiliation with or endorsement.