



P210R
PORTABLE
PHOTO
PRINTER



KODAK P210R Portable Photo Printer User Guide

[Home](#) » [Kodak](#) » KODAK P210R Portable Photo Printer User Guide 

Contents

- [1 KODAK P210R Portable Photo Printer](#)
- [2 Smartphone App Installation](#)
- [3 BLUETOOTH Connection](#)
- [4 Printing in the App](#)
- [5 FEATURES](#)
- [6 CARE & MAINTENANCE](#)
- [7 Troubleshooting](#)
- [8 FREQUENTLY ASKED QUESTIONS](#)
- [9 VIDEO – PRODUCT OVERVIEW](#)
- [10 References](#)
- [11 Related Posts](#)



KODAK P210R Portable Photo Printer



Before Start

1. This Printer has a built-in battery. Charge the printer before using it.
2. How to Change Cartridge

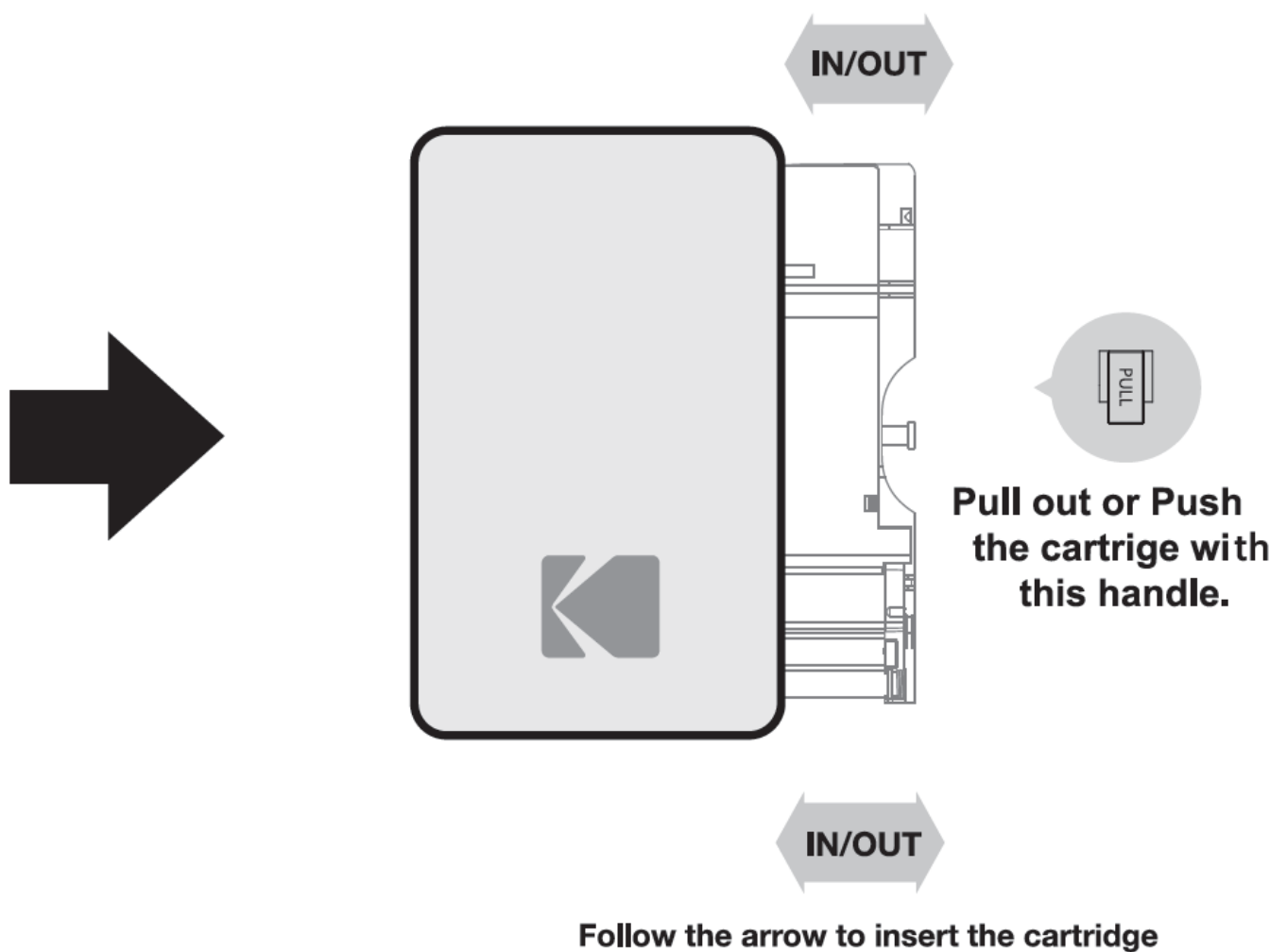

Smartphone App Installation

ANDROID

1. Go to the GOOGLE Play Store on your smartphone.
2. Search “KODAK Instant Printer”
3. Install “KODAK Instant Printer”. Into your smartphone

APPLE Device

1. Go to APP STORE on your iPhone, IPOD TOUCH, or IPAD.
2. Search “KODAK Instant Printer”
3. Install “KODAK Instant Printer”. Application into your device.

BLUETOOTH Connection

1. Turn on BLUETOOTH on your smartphone
2. Turn on the printer.
3. Go to the BLUETOOTH setting in your smartphone and you can find “KODAK Instant-XXXX” (‘XXXX’ are 4 4-digit combinations of numbers and letters.)
4. Select it for connection.

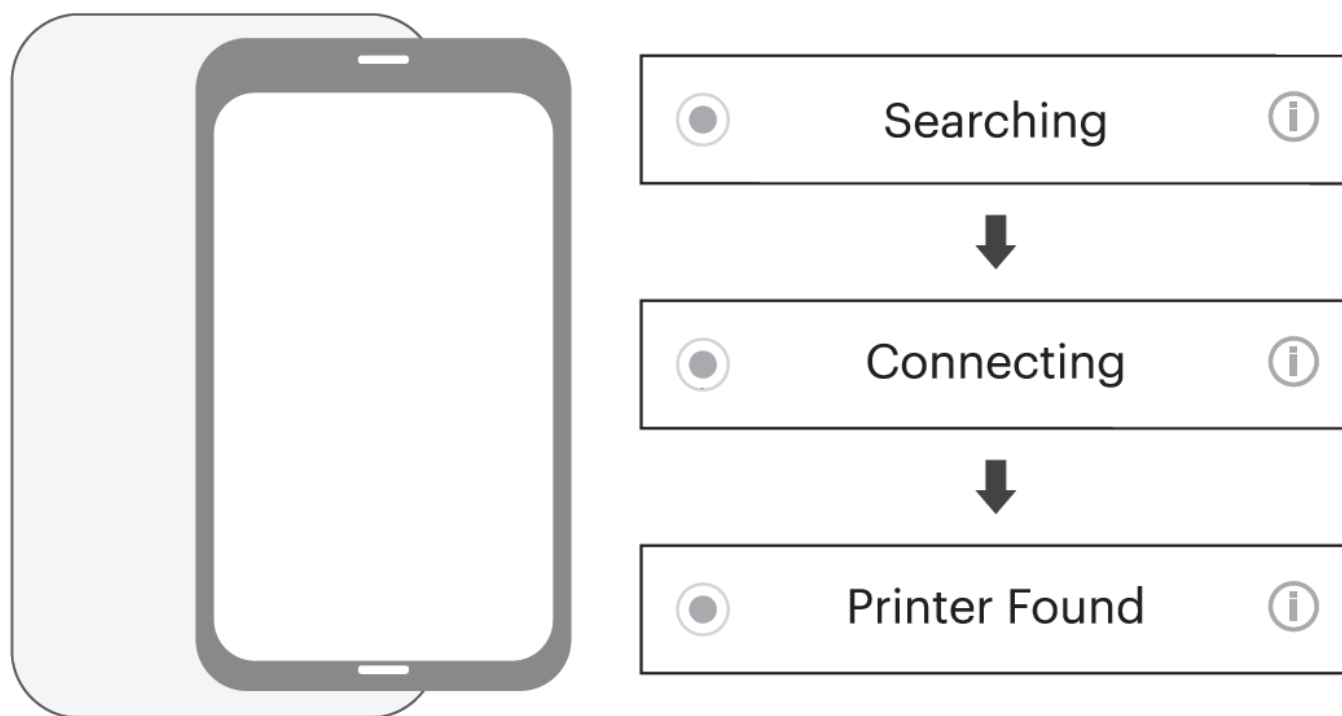

Power and Active Status

-  Power ON: White / Power OFF(2Sec): Off / Printing: White Flickering F.W Upgrade: Pink Flickering / No Cartridge, Error: Red Flickering Waiting, Cooling: White
- **Charge**

- **Charging:** Red
- **Charging Complete:** Green
-  Connecting: Green Blink / Bluetooth Complete: Green

Printing in the App

1. KODAK Instant Printer app launch
2. "Gallery" to load your device's photos.
3. Choose Photo
4. Select Print Number
5. Select Printer Icon

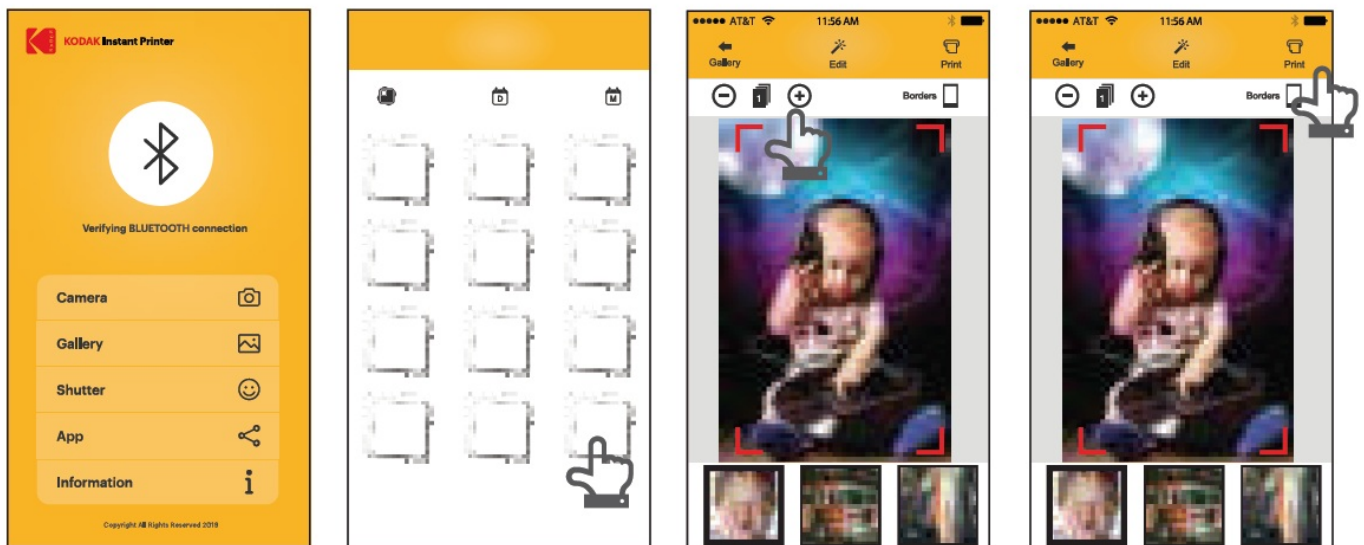

Select SNS if you want to print the photo from it.

FEATURES

- **Compact Design:** It's small, light, and movable, so you can print on the go.
- **Wireless Connectivity:** It connects via Bluetooth so you can print easily from your phone or computer.
- **Fits a lot of devices:** It works with both iOS and Android, so it fits a lot of devices.
- **Printing Method:** For good picture prints, it uses dye-sublimation technology.
- **Size of Print:** It prints 2×3-inch pictures, which are great for quick prints.
- **High Resolution:** Prints at a high resolution, usually up to 300 dpi, so pictures are clear and bright.
- **Instant Printing:** Prints are sent out right away, giving you quick results.
- **Recharging Battery:** It has a built-in recharging battery that lets you print on the go without an extra power source.
- **No Ink Refills:** It uses ZINK (Zero Ink) paper, so you don't need regular ink refills.
- **Self-Adhesive Backing:** Photos can be used as stickers because the back of them sticks to itself.
- **Easy to Use App:** The KODAK app makes it simple to change printer settings, make changes, and edit photos.
- **LED Indicator Lights:** Make it easy to see what the printer is doing (printing, charging, etc.).
- **Simple Setup:** It's easy to set up, and you only need to do a few things to get Bluetooth to work.

- **Lightweight:** It only weighs a few ounces, so it's great for traveling and using outside.
- **KODAK Photo Paper:** It comes with KODAK 2×3-inch ZINK picture paper, which is small and easy to carry.
- **Color Print Mode:** Full-color printing lets you make photos that look bright and clear.
- **Durable Prints:** Photos won't get wet, smudged, or torn, so your memories will last a lifetime.
- **Multiple Print Options:** You can print several pictures at once or make layouts right in the app.
- **Stylish Design:** The design is modern and sleek, and it comes in different colors so that everyone can find something they like.
- **Affordable:** It's a cheap way to print because you don't have to buy expensive ink refills.

CARE & MAINTENANCE

- **Use a Soft, Dry Cloth:** Wipe down the outside of the printer regularly to get rid of dust and other dirt.
- **Clean the Print Head:** To keep ink from building up, clean the print head gently with a cotton swab or soft cloth.
- **Use the Right Paper:** For the best print quality and performance, always use KODAK 2×3-inch ZINK picture paper.
- **Store in a Dry Place:** Keep the printer away from extreme temperatures or high humidity, which can damage internal parts.
- **Avoid Direct Sunlight:** Don't store the printer in direct sunlight, as it could overheat or break down.
- **Regularly Charge:** To keep the battery from dying, keep the printer charged when it's not in use.
- **Do Not Overcharge:** Disconnect the charger once the battery is fully charged to make it last longer.
- **Turn Off After Use:** Always turn off the printer when you're done using it to save battery life and reduce wear.
- **Use the Original Charger:** Always use the USB wire and adapter that came with the printer for charging.
- **Handle Carefully:** Avoid dropping or handling the printer roughly, as this can damage internal components.
- **Check for Code Updates:** Update the printer's code regularly for better performance and bug fixes.
- **Keep Bluetooth Up to Date:** Ensure your device's Bluetooth is up to date and properly paired for seamless connectivity.
- **Keep the Paper Tray Clean:** Remove dust or dirt from the paper tray to prevent clogs.
- **Store in a Cool, Well-Ventilated Area:** Avoid storing the printer in hot places or cramped spaces with poor airflow.
- **Do Not Use Non-Kodak Paper:** Using incompatible paper can damage the printer and produce poor-quality prints.
- **Check the Health of the Battery:** If battery life drops significantly, consider replacing the battery or seeking expert help.
- **Replace Broken Parts:** Replace damaged parts like the paper tray or cover promptly to ensure smooth operation.
- **Use Compatible Apps Only:** Stick to apps designed for the printer and avoid third-party apps that might not work properly.
- **Test the Printer Often:** Print a test picture periodically, even when the printer isn't in use, to ensure it's in good condition.

Troubleshooting

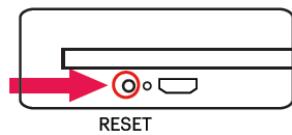
Symptom	cause/Solution
Paper Jam	Power off and Power On again. Paper will be automatically ejected If not, please contact customer service.
The image quality is not good.	Print quality could be less if your photo source has low resolution.
	Over 1280 x 2448 pixels is recommended for best image quality.
The printer is not responding	<p>Press the reset button with a sharp tool like a pin.</p> 



www.kodak.com

FREQUENTLY ASKED QUESTIONS

What are the dimensions of the KODAK P210R Portable Photo Printer?

The KODAK P210R Portable Photo Printer has dimensions of 3 D x 5 W x 1 H inches, making it compact and portable.

Which devices are compatible with the KODAK P210R Portable Photo Printer?

The KODAK P210R Portable Photo Printer is compatible with smartphones and tablets, ensuring versatility across devices.

What type of controller is used for the KODAK P210R Portable Photo Printer?

The KODAK P210R Portable Photo Printer can be controlled via iOS and Android devices, making it user-friendly.

What is the sheet size used by the KODAK P210R Portable Photo Printer?

The KODAK P210R Portable Photo Printer uses a 2.1 x 3.4-inch sheet size, ideal for creating pocket-sized photos.

What is the maximum input sheet capacity of the KODAK P210R Portable Photo Printer?

The KODAK P210R Portable Photo Printer has a maximum input sheet capacity of 60 sheets, allowing for continuous printing.

How is the KODAK P210R Portable Photo Printer controlled?

The KODAK P210R Portable Photo Printer is controlled through an app, offering seamless operation with connected devices.

What is the memory storage capacity of the KODAK P210R Portable Photo Printer?

The KODAK P210R Portable Photo Printer has a memory storage capacity of 64 MB, enabling efficient operation.

How much does the KODAK P210R Portable Photo Printer weigh?

The KODAK P210R Portable Photo Printer weighs 7.1 ounces, ensuring it is lightweight and easy to carry.

VIDEO – PRODUCT OVERVIEW



[Download the PDF link: KODAK P210R/KODAK P210R Portable Photo-Printer-User-Guide](#)
[Photo-Printer-User-Guide.mp4](#)

References

- [User Manual](#)

[Manuals+.](#) [Privacy Policy](#)

This website is an independent publication and is neither affiliated with nor endorsed by any of the trademark owners. The "Bluetooth®" word mark and logos are registered trademarks owned by Bluetooth SIG, Inc. The "Wi-Fi®" word mark and logos are registered trademarks owned by the Wi-Fi Alliance. Any use of these marks on this website does not imply any affiliation with or endorsement.