



KOBANOICA SWD-VK-CX77 Wireless Backup Camera System User Manual

[Home](#) » [KOBANOICA](#) » KOBANOICA SWD-VK-CX77 Wireless Backup Camera System User Manual 

KOBANOICA

Wireless Backup Camera System
User Manual



Please read this manual carefully before installing this system

Contents

- [1 Package includes](#)
- [2 Please test before installing](#)
- [3 Connection](#)
- [4 Install SD Card](#)
- [5 MONITOR OPERATION](#)
- [6 Documents / Resources](#)
- [7 Related Posts](#)

Package includes



Furion mounting brackets are not required for installation if it is not a Ferroin RV

Please test before installing

The system is mainly used for RVs, travel trailers, fifth wheels, trucks, motor homes, etc. Please test the system to see if it works properly before you install it in your vehicle.

Test steps

Step 1: Connect the two power cables to the camera and monitor.

Step 2: Loosen the screw on the green connector, then insert the red wire (copper wire) into the positive (+) slot and the black wire (copper wire) into the negative (-) slot.

Step 3: Insert the cigarette lighter and turn on the red switch.



If no image is displayed after you install it, please check if your power supply is connected correctly. Reverse connection of the positive and negative terminals will damage the camera. If you cannot confirm which wire is positive, you can connect the black wire to the ground (the metal part of the vehicle).
Note: Do not cut off the DC connector on the camera, this may damage the camera.

Connection

Please pay attention to the positive and negative terminals of the wires, if the positive and negative terminals are reversed, it may cause damage to the device.
 If the device does not work properly, please turn off the power immediately and contact customer support.

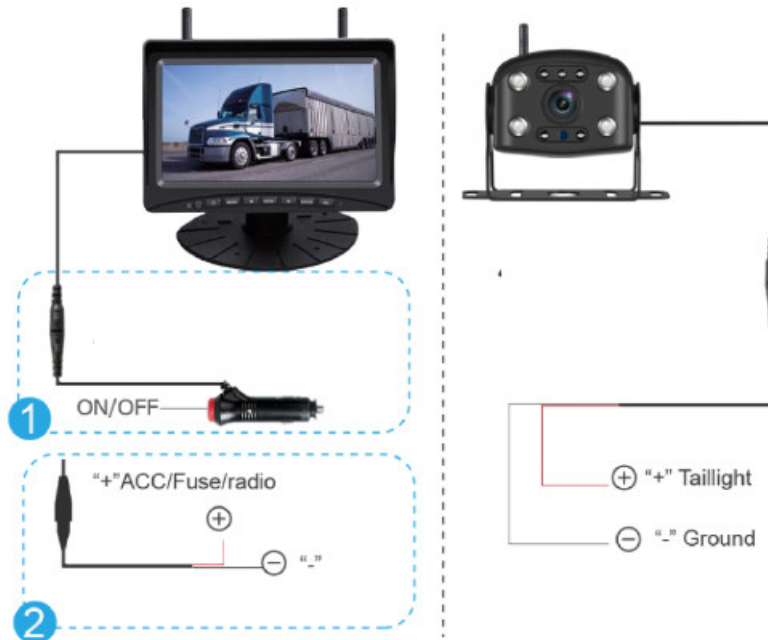

The monitor can be powered by a cigarette lighter/ACC/Fuse/Radio etc.
 Connect the positive of the Power supply to the red wire and the ground or negative to the black wire.(Before installing, make sure that the power cable and antenna of the camera are connected.)

Three steps to install the camera

Step 1: Select the location for mounting the camera.

Step 2: Drill a 12mm diameter cable hole and secure the camera with the included screws.

Step 3: Locate the reverse or running light wiring on the vehicle and connect the red wire to the positive terminal and the black wire to the ground or negative terminal.



Install SD Card

KOBANOICA RV backup camera system with video recording function, remove the screw at the back of the monitor, you can insert the SD card into the card slot for video data storage.



MONITOR OPERATION



	Turn On/Turn Off
MODE	Switch channel
	1) Enter the menu and select left 2) Open the car ruler to adjust the position of the ruler
MENU	1) Menu 2) Return to the previous level
	1) Enter the menu and select right 2) Open the car ruler and select M/W/H 3) +
ENTER	1) Enter 2) Open the car ruler to start/pause recording
SFI	Car scale shortcut

Backup Camera Function Introduction

1. Pairing



1. Click "Menu" to go to the main screen.
2. Select the option "PAIRING" and press the "ENTER" button.



3. Waiting for pairing.
4. The monitor successfully displays the screen and the pairing is successful.

2. Picture Setting



1. Go to "MENU", use the ◀ and ▶ to switch between the options, and select the second icon "PICTURE".
2. Click "ENTER" to confirm and enter this mode. You can adjust the brightness/ contrast/volume of the screen, etc.

3. MIR-FLIP

Rotation Options (Vertical/Rear View/Front View)

TIP : The screen rotation setting can only be toggled when displayed in full screen alone.



4. Split Screen Mode

Select the split screen "MODE" option and click "ENTER", you can choose one of the eight split screen modes.

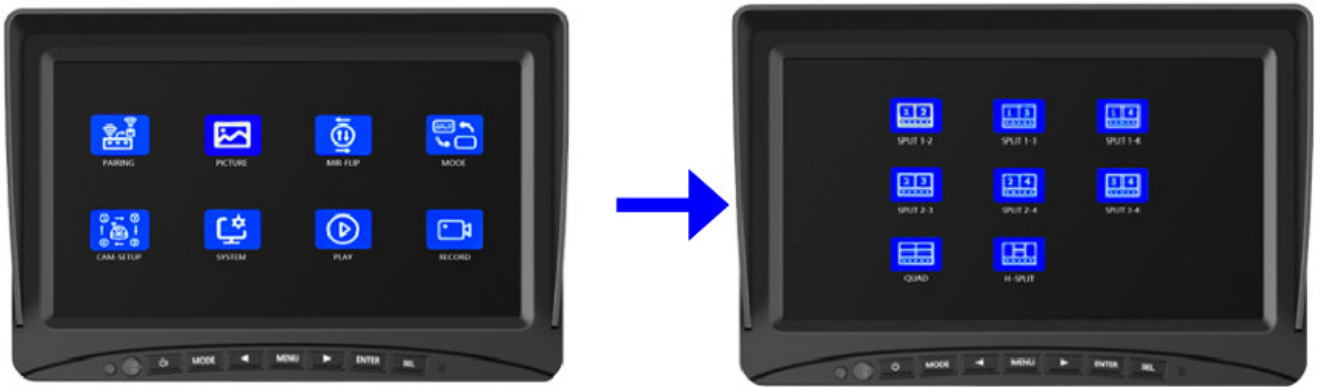

The monitor supports adding 1 to 4 cameras, If you need additional cameras, please contact us.



Single full screen



Split screen



Quad split screen

For example : Select the split screen for CAM1 and CAM2, click “ENTER” to confirm, then click “MENU” to return to the menu home page. First a single screen will appear and you will need to click the “MODE” button to switch screens until the split screen appears.

5. Camera ON/OFF

Select the “CAM-SETUP” option, click “ENTER” to enter, you can turn off or on the selected camera. (Please make sure that all cameras are turned on).



For example, to turn off Camera 1: First select the CAM1 icon, click on the “ENTER” button, enter CAM1 for adjustment, and then switch to “Off. (When the camera is off, the image will not be displayed on the CAM1 screen even if camera 1 is connected).

6. System

Select the “System” option and click “ENTER” to enter, then you can adjust some data of time/language/NTSC PAL and turn on/off the guide line.

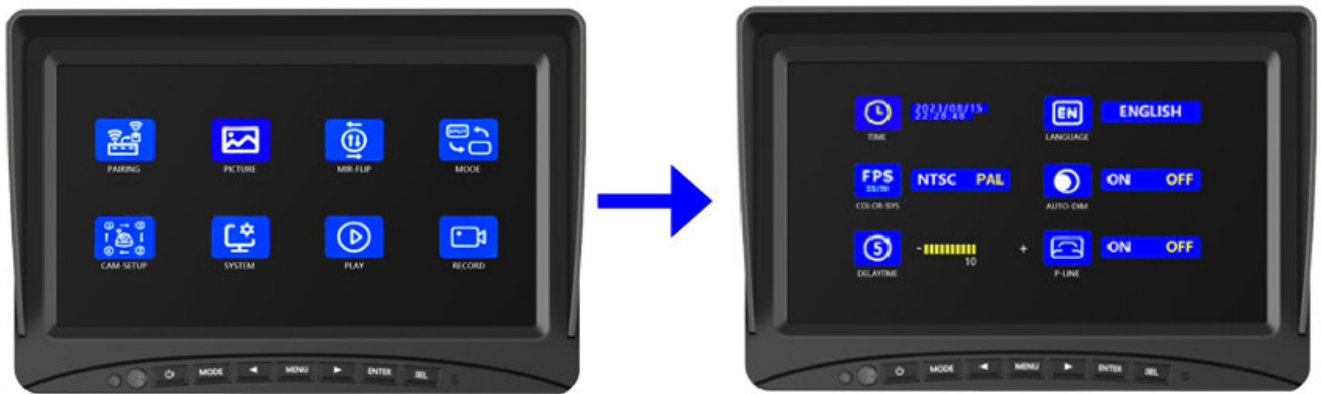

For example, to open the reversing auxiliary line: select “P-LINES”, click “ENTER”, use the left and right toggle, select open, and return to the interface, the reversing line will be displayed automatically.



7. Play

The monitor requires an SD card to be inserted in order to record video. If you need an SD card, please contact us. Select the “Play” option and click “ENTER”, the recorded video will be stored here, and you can watch the recorded video here.



8. Record

Select the “Record” option and click “ENTER”, you can turn on/off the Rewrite and Format the SD card.



1. When the rewrite function is on, if the memory card is full, the previously recorded video will be automatically deleted, and then the video will be automatically re-recorded. (When inserting the SD card for the first time, you need to use it after formatting the SD card)
2. Start or stop recording: When the signal screen or split screen is normal, press and hold the "ENTER" button to start recording the screen. (At this time, the REC mark will appear in the middle of the screen.) Click the SEL button again to stop the screen recording.



Documents / Resources

	<p>KOBANOICA SWD-VK-CX77 Wireless Backup Camera System [pdf] User Manual SWD-VK-CX77 Wireless Backup Camera System, SWD-VK-CX77, Wireless Backup Camera System, Backup Camera System, Camera System</p>
--	--