



KOBALT KST 2224B-03 Brushless String Trimmer User Manual

[Home](#) » [Kobalt](#) » KOBALT KST 2224B-03 Brushless String Trimmer User Manual

Contents [[hide](#)]

- 1 KOBALT KST 2224B-03 Brushless String Trimmer
- 2 PRODUCT SPECIFICATIONS
- 3 SAFETY INFORMATION
- 4 SAFETY INFORMATION
- 5 IMPORTANT SAFETY INSTRUCTIONS
- 6 READ ALL INSTRUCTIONS
- 7 SAFETY INFORMATION
- 8 PREPARATION
- 9 ASSEMBLY INSTRUCTIONS
- 10 Mounting the Guard
- 11 ASSEMBLY INSTRUCTIONS
- 12 Mounting the Front-Assist Handle
- 13 Holding the String Trimmer
- 14 CARE AND MAINTENANCE
- 15 WARRANTY
- 16 Documents / Resources
- 17 Related Posts

KOBALT™

KOBALT KST 2224B-03 Brushless String Trimmer



PRODUCT SPECIFICATIONS

COMPONENT	SPECIFICATION
Rated voltage	24 V d.c.
No-load speed	5,800-7,100 RPM
Cutting-Line Type	0.08 in. twisted nylon line
Cutting Width	12 in.

PACKAGE CONTENTS

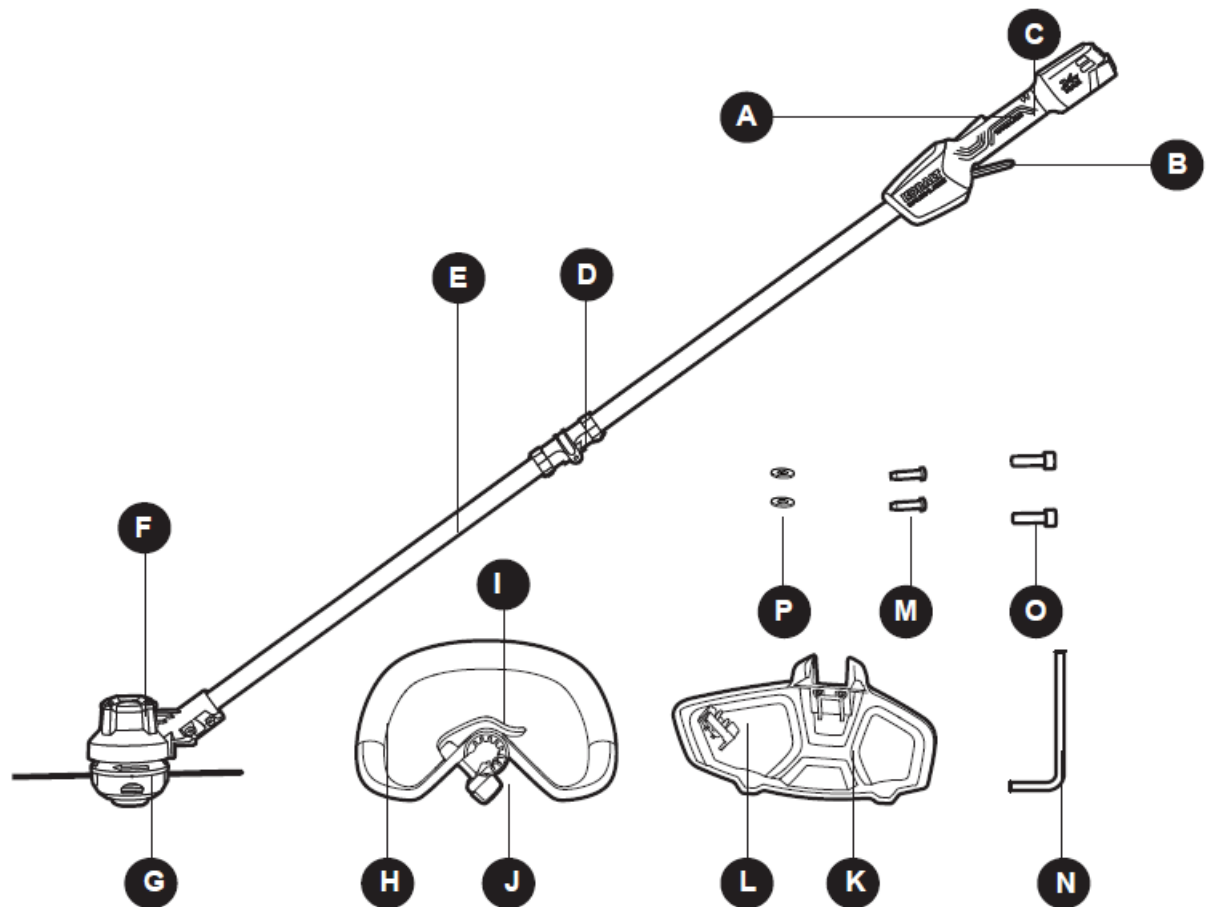

PART	DESCRIPTION
A	Lock-off button
B	Variable-speed trigger switch
C	Rear handle
D	hinge
E	Trimmer shaft
F	Trimmer head
G	Bump knob
H	Front-assist handle

PART	DESCRIPTION
I	Adjusting lever
J	Screw knob
K	Guard
L	Line-cutting blade
M	Screws (2)
N	Hex wrench
O	Bolts (2)
P	Plain washer (2)

WARNING

- Remove the tool from the package and examine it carefully. Inspect the tool carefully to make sure that no breakage or damage occurred during shipping. If any parts are damaged or missing, please return the product to the place of purchase. Do not discard the carton or any packaging material until all parts have been examined.
- If any part of the tool is missing or damaged, do not connect the battery to the tool or use the tool until the part has been repaired or replaced. Failure to heed this warning could result in serious injury.

SAFETY INFORMATION

Please read and understand this entire manual before attempting to assemble or operate this product. If you have any questions regarding the product, please call customer service at 1-888-3KOBALT, 8 a.m. – 8 p.m., EST, Monday – Friday.

WARNING

- The operation of any power tool can result in foreign objects being thrown into your eyes, which can result in severe eye damage. Before beginning power-tool operation, always wear safety goggles or safety glasses with side shields and a full-face shield, when needed. We recommend using a wide vision safety mask over eyeglasses or standard safety glasses with shields. Always use eye protection marked to comply with ANSI Z87.1.
- Some dust created by power sanding, sawing, grinding, drilling, and other construction activities contains chemicals known to the state of California to cause cancer, birth defects, or other reproductive harm. Some examples of these chemicals are:
 - Lead from lead-based paints
 - Crystalline silica from bricks, cement, and other masonry products
 - Arsenic and chromium from chemically-treated lumber
- Your risk from these exposures varies, depending upon how often you do this type of work.
- To reduce your exposure to these chemicals:
 - Work in a well-ventilated area.
 - Work with approved safety equipment, such as dust masks that are specially designed to filter out microscopic

particles.

- Avoid prolonged contact with dust from power sanding, sawing, grinding, drilling, and other construction activities. Wear protective clothing and wash exposed areas with soap and water. Allowing dust to get into your mouth or eyes or to lie on the skin may promote absorption of harmful chemicals.

DANGER

People with electronic devices, such as pacemakers, should consult their physician(s) before using this product. Operation of electrical equipment in close proximity to a heart pacemaker could cause interference or failure of the pacemaker.

Know the Tool



To operate this tool, carefully read this manual and all labels affixed to the tool before using it. Keep this manual available for future reference.

Important

This tool should be serviced only by a qualified service technician.

SAFETY INFORMATION

Some of the following symbols may be used on this tool. Please study them and their meaning. Proper interpretation of these symbols will allow you to operate the tool better and more safely.

SYMBOL	DEFINITION	SYMBOL	DEFINITION
V	Volts	n 0	No-load Speed
A	Amps	RPM	Revolutions per Minute
Hz	Hertz		Direct Current
	WARNING- To reduce the risk of injury , user must read instruction manual.		A danger, warning or caution. It means ‘ Attention! Your safety is involved.’

IMPORTANT SAFETY INSTRUCTIONS

WARNING

When using electric trimmers, basic safety precautions should always be followed to reduce the risk of fire, electric shock, and personal injury, including the following:

READ ALL INSTRUCTIONS

DANGER

Do not rely on the tool’s insulation against electric shock. To reduce the risk of electrocution, never operate the tool in the vicinity of any wires or cables which may carry

CAUTION

- Wear appropriate personal hearing protection during use. Under some conditions and durations of use, noise from this product may contribute to hearing loss.
- Avoid dangerous environments – Don't use appliances in damp or wet location.
- Don't use in rain.
- Keep children away – All visitors should be kept at least 100 ft. away from work area.
- Dress properly – Do not wear loose clothing or jewelry. They can be caught in moving parts.
- Use of rubber gloves and substantial footwear is recommended when working outdoors.
- Wear protective hair covering to contain long hair.
- Use safety glasses – Always use face or dust mask if operation is dusty.
- Use the right appliance – Do not use the tool for any job except that for which it is intended.
- Don't force the appliance – It will do the job better and with less likelihood of a risk of injury at the rate for which it was designed.
- Don't overreach – Keep proper footing and balance at all times.
- Stay alert – Watch what you are doing. Use common sense. Do not operate the appliance when you are tired.
- Keep guards in place and in working order.
- Keep hands and feet away from the cutting area.
- Store idle appliances indoors – When not in use, the appliances should be stored indoors in a dry and high or locked-up place with the battery pack removed out of reach of children.

SAFETY INFORMATION

- Maintain appliance with care – Keep cutting edge sharp and clean for best performance and to reduce the risk of injury. Follow instructions for lubricating and changing accessories. Keep handles dry, clean, and free from oil and grease.
- Check damaged parts – Before further use of the appliance trimmer, a guard or other part that is damaged should be carefully checked to determine that it will operate properly and perform its intended function. Check for alignment of moving parts, binding of moving parts, breakage of parts, mounting, and any other condition that may affect its operation. A guard or other part that is damaged should be properly repaired or replaced by an authorized service center unless indicated elsewhere in this manual.
- Do not charge the battery pack in rain, or in wet locations.
- Prevent unintentional starting. Ensure the switch is in the "off" position before connecting to battery pack, picking up or carrying the appliance. Carrying the appliance with your finger on the switch or energizing appliance that have the switch on invites accidents.
- Disconnect the battery pack from the appliance before making any adjustments, changing accessories, or storing appliance. Such preventive safety measures reduce the risk of starting the appliance accidentally.
- Use the battery operated blower only with specifically designated battery pack. Use of any other batteries may create a risk of fire.
- Use only with the battery packs and chargers listed below:

BATTERY PACK	CHARGER
KB 124-03; KB 224-03; KB 424-03;	KRC 2445-03;
KB 524-03; KB 624-03; KB 924-03	KRC 2490-03

- Do not use a battery pack or appliance that is damaged or modified. Damaged or modified batteries may exhibit unpredictable behavior resulting in fire explosion or risk of injury.
- Do not expose a battery pack or appliance to fire or excessive temperature. Exposure to fire or temperature above 130°C may cause explosion.
- Follow all charging instructions and do not charge the battery pack or appliance outside of the temperature range specified in the instructions. Charging improperly or at temperatures outside of the specified range may damage the battery and increase the risk of fire.
- Have servicing performed by a qualified repair person using only identical replacement parts. This will ensure that the safety of the product is maintained.
- Do not modify or attempt to repair the appliance or the battery pack except as indicated in the instructions for use and care.
- Do not dispose of the battery in a fire. The cells may explode. Check with local codes for possible special disposal instructions.
- Do not open or mutilate the battery. Released electrolyte is corrosive and may cause damage to the eyes or skin. It may be toxic if swallowed.
- Exercise care in handling batteries in order not to short the battery with conducting materials such as rings, bracelets, and keys. The battery or conductor may overheat and cause burns.
- Do not operate the trimmer while under the influence of alcohol or drugs.
- Clear the area to be cut before each use. Remove all objects such as rocks, broken glass, nails, wire, or string that can be thrown or become entangled in the cutting attachment. Make sure that other persons and pets are at least 100 ft. (30.5m) away.
- Always hold the trimmer firmly, with both hands on the handles, while operating. Wrap your fingers and thumbs around the handles.
- To reduce the risk of injury from loss of control, never work on a ladder or on any other insecure support. Never hold the cutting attachment above waist height.
- Do not operate the trimmer in gaseous or explosive atmospheres. Motors in these appliances normally spark, and the sparks might ignite fumes.
- Wear heavy long pants, long sleeves, boots, and gloves. Avoid loose garments or jewelry that could get caught in moving parts of the machine or its motor.
- Damage to trimmer – If you strike a foreign object with the trimmer or it becomes entangled, stop the tool immediately, check for damage and have any damage repaired before further operation is attempted. Do not operate with a broken guard or spool.
- If the equipment should start to vibrate abnormally, stop the motor and check immediately for the cause. Vibration is generally a warning of trouble.
- A loose head may vibrate, crack, break or come off the trimmer, which may result in serious or fatal injury. Make sure that the cutting attachment is properly fixed in position. If the head loosens after fixing it in position, replace it immediately.
- Never use a trimmer with a loose cutting attachment.
- Replace a cracked, damaged or worn-out cutting head immediately, even if damage is limited to superficial cracks. Such attachments may shatter at high speed and cause serious or fatal injury.
- Check the cutting attachment at regular short intervals during operation, or immediately if there is a noticeable

change in cutting behavior.

- When replacing the cutting line, use triangle-shaped twisted nylon cutting line with a size that does not exceed 0.08 in. (2.0 mm); using heavier lines than recommended by the manufacturer increases the load on the motor and reduces its operating speed. This results in overheating and damage to the trimmer.
- To reduce the risk of serious injury, never use wire or metal-reinforced line or other material in place of the nylon cutting lines. Pieces of wire could break off and be thrown at high speed toward the operator or bystanders.
- When servicing, use only identical replacement parts. Use of any other accessory or attachment which is not recommended for use with this tool may increase the risk of injury.
- Do not wash with a hose; avoid getting water in motor and electrical connections.
- Save these instructions. Refer to them frequently and use them to instruct others who may use this tool. If you lend this tool to someone else, also lend these instructions to them to prevent misuse of the product and possible injury.

PREPARATION

Know Your String Trimmer

This product requires assembly. Carefully lift the tool from the carton and place it on a level work surface. Before attempting to use the string trimmer, familiarize yourself with all of its operating features and safety requirements.

WARNING

- Do not allow familiarity with the tool to cause carelessness. Remember that one careless moment is enough to cause severe injury. Before attempting to use any tool, be sure to become familiar with all of the operating features and safety instructions.
- Do not attempt to modify this tool or create accessories not recommended for use with this tool. Any such alteration or modification is misuse and could result in a hazardous condition leading to possible serious personal injury.

ASSEMBLY INSTRUCTIONS

This product requires assembly. To reduce the risk of injury to persons, never operate without guards in place. The guard must always be on the tool to protect the user.

Unfolding the Shaft

WARNING

In order to avoid pinching your hands or fingers, do not hold the shaft at the joints. Do not attempt to start the trimmer until the shaft has been locked.

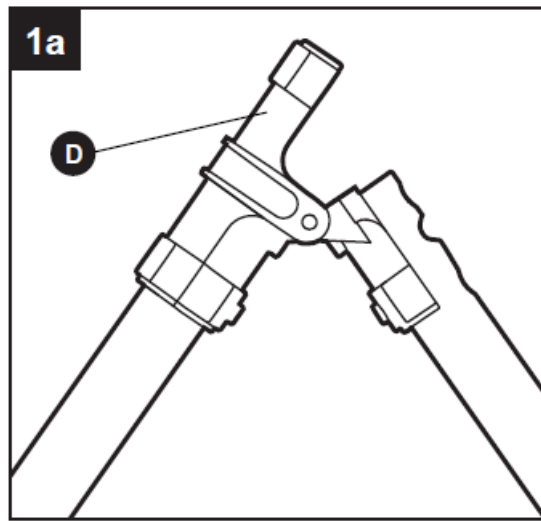

Remove the battery pack from the trimmer. b. Put your trimmer on the ground and carefully unfold the shaft. Make sure that the cable is inside the shaft so that it will not be pinched when closing the hinge (D). c. Use the hex wrench (N) to lock the shaft with the two bolts(O) supplied.

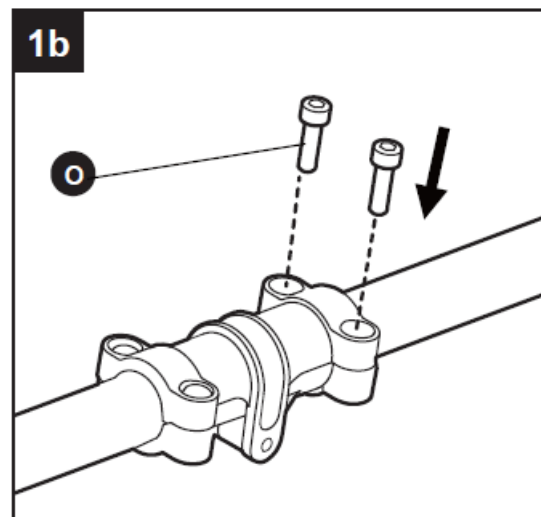

Mounting the Guard

WARNING

- Always wear gloves when mounting or replacing the guard. Be careful of the blade on the guard and protect your hands from being injured by the blade.
- Always remove the battery pack from the product when you are assembling parts, making adjustments, cleaning, or when the product is not in use.

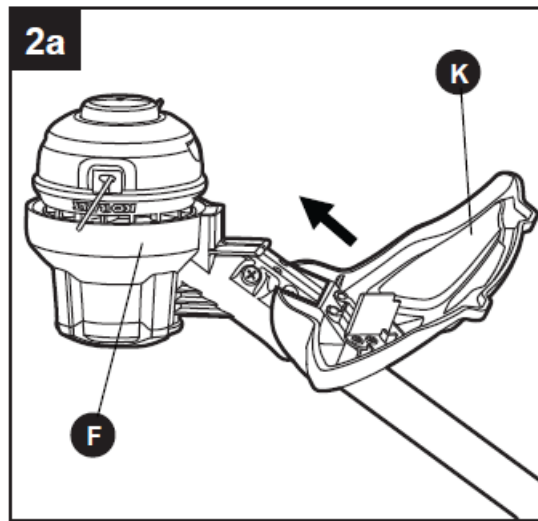

- Remove the battery pack (not included) from the trimmer.
- Lift the trimmer head (F) and face it upward; align the groove on the bottom of the guard (K) with the raised portion on the base of the trimmer head, and then slide guard onto the base as shown.
- Make sure that the two mounting holes in the guard are aligned with the two assembly

ASSEMBLY INSTRUCTIONS

holes in the base of the shaft. Lock the guard in place by tightening the two screws (M) with a Phillips screwdriver (not included).

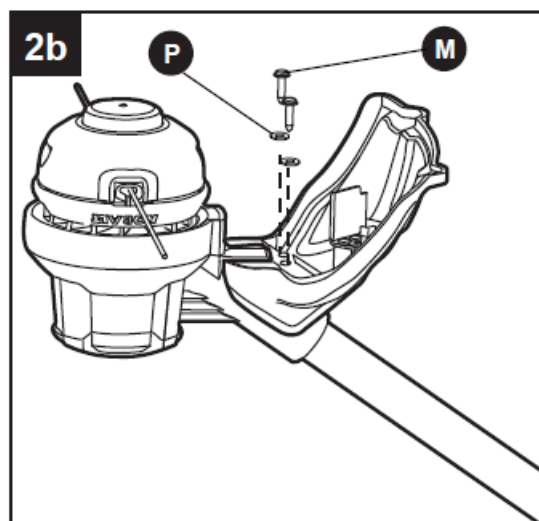

Mounting the Front-Assist Handle

WARNING

Always remove the battery pack from the product when you are assembling parts, making adjustments, cleaning, or when the product is not in use.

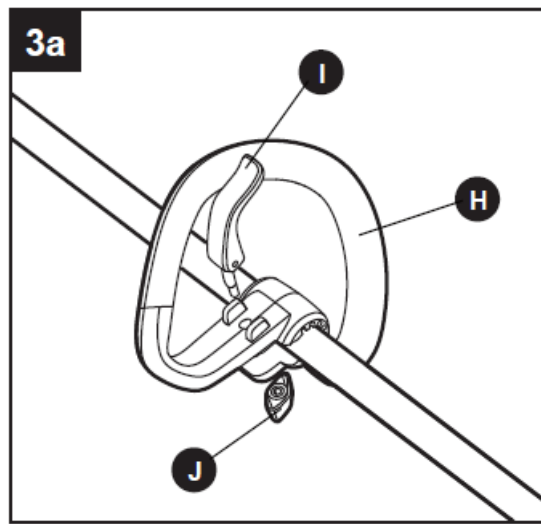

- Remove the battery pack (not included) from the trimmer.
- Remove the screw knob (J) and the adjusting lever (I) from the front-assist handle (H).
- To attach the front-assist handle on the shaft, insert the adjusting lever into the front-assist handle, and then tighten the screw knob. Make sure that the front-assist handle faces upwards so that it points toward the top of the handle.
- Lower the adjusting lever to secure the frontassist handle onto the shaft so that it cannot move on the shaft during operating.

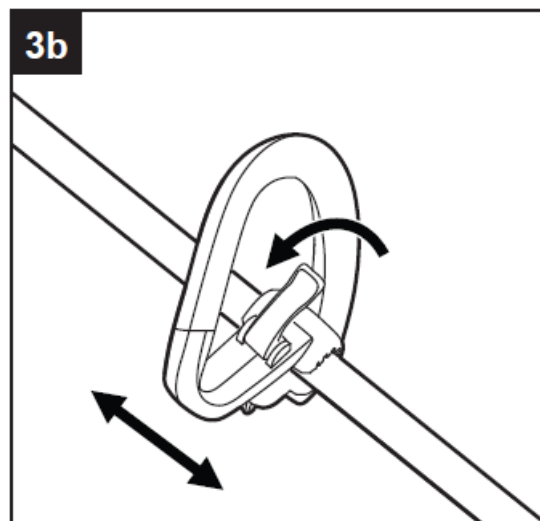

To Adjust the Front-Assist Handle Position

The handle should be adjusted so that your front arm will be straight when using the trimmer. To adjust the front-assist handle (H) position, lift the adjusting lever so that the front-assistant handle can be moved to the desired position of the shaft. Lower the adjusting lever so that the handle cannot move on the shaft during operating.

To Attach Battery Pack

- Make sure that the switch is in the OFF position.
- Align the raised portion on the battery pack (not included) with the grooves on the bottom of the tool, then slide the battery pack onto the tool as shown.
- Ensure that the battery-release buttons on the battery pack snap into place and the battery pack is secured to the tool before beginning operation.

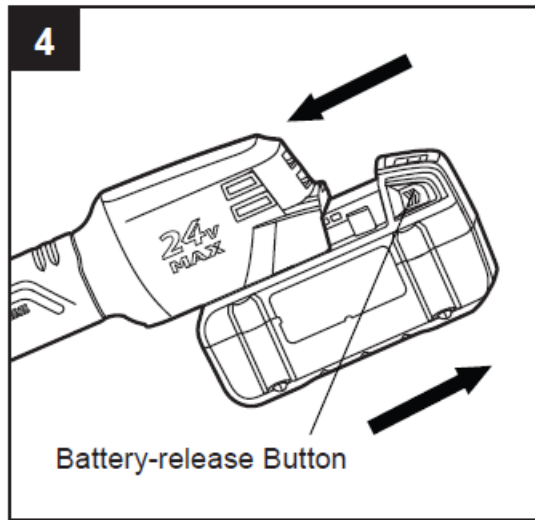

NOTICE: When placing the battery pack on the tool, be sure that the raised rib on the battery pack aligns with the groove on the tool and the latches snap into place properly. Improper assembly of the battery pack can cause damage to internal components.

To Remove Battery Pack

- Make sure that the switch is in the OFF position.
- Press the battery-release buttons to release the battery pack.
- Pull rearward on the battery pack to remove it from the tool.

WARNING

Battery tools are always in operating condition. Therefore, the trigger switch should always be in the OFF position when the tool is not in use or when carrying the tool at your side.

Holding the String Trimmer

WARNING

- Dress properly to reduce the risk of injury when operating this tool. Do not wear loose clothing or jewelry. Wear eye and ear/hearing protection. Wear heavy, long pants, boots and gloves. Do not wear short pants or sandals or go barefoot. Before operating the unit, stand in the operating position and check that:
- The operator is wearing eye protection and proper clothing.
- One arm is slightly bent, and the hand on that arm is holding the rear handle.
- The other arm is straight, with that hand holding the front-assist handle.
- The trimmer head is parallel to the ground and easily contacts the material to be cut without the operator having to bend over.

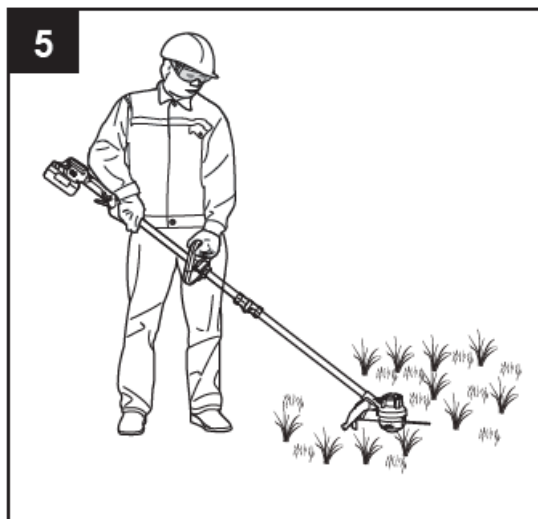

To Start/Stop the String Trimmer

- Before starting the string trimmer:
- Make sure that you have a secure and balanced footing.
- Stand upright and hold the string trimmer in a relaxed position.
- Make sure that the cutting line is not touching the ground or any other objects.
- Hold the string trimmer with both hands: one hand on the rear handle (C) and one hand on the front-assist handle (H).
- To turn the string trimmer ON, press down the lock-off button (A) and then depress the variable-speed trigger switch (B).
- The variable-speed trigger switch delivers higher speed with increased trigger pressure and lower speed with decreased trigger pressure.
- To turn it off, release the variable-speed trigger switch and allow the trimmer to come to a complete stop.

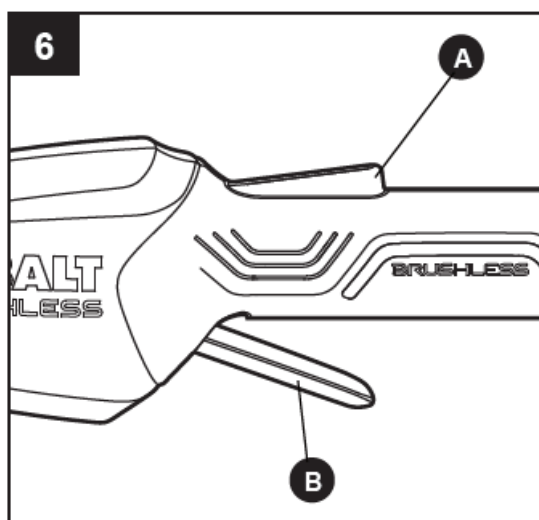

WARNING

Always remove the battery pack from the string trimmer during work breaks and after finishing work.

OPERATING INSTRUCTIONS

Using the String Trimmer Check for damaged/worn parts before each use

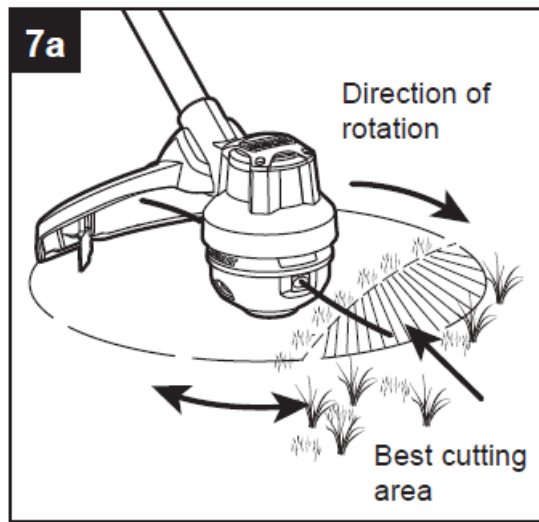

To prevent serious personal injury, remove the battery pack from the tool before servicing, cleaning, changing attachments or removing material from the unit. Check the bump head, guard (K) and front-assist handle (H) and replace any parts that are cracked, warped, bent, or damaged in any way. The line-cutting blade (L) on the edge of the guard can dull over time. It is recommended that you periodically sharpen it with a file or replace it with a new blade.

Always wear gloves when mounting or replacing the guard or when sharpening or replacing the blade. Note the location of the blade on the guard and protect your hand from injury.

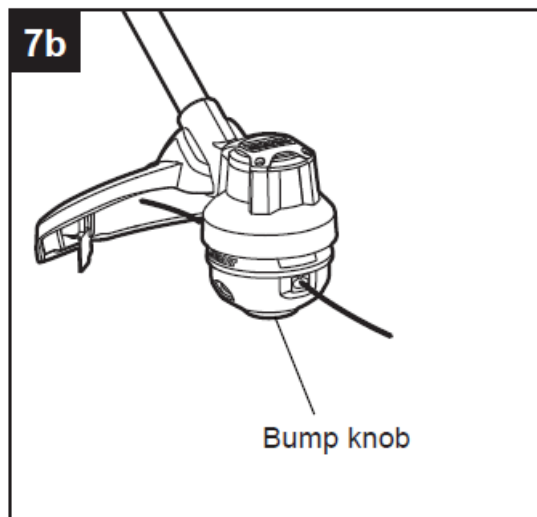

Tips for best trimming results

- To avoid serious personal injury, wear goggles or safety glasses at all times when operating this unit. Wear a face mask or dust mask in dusty locations. Wear proper clothing and footwear during operation to reduce the risk of injury that may be caused by flying debris.
- Clear the area to be cut before each use. Remove all objects, such as rocks, broken glass, nails, wire, or string that can be thrown or become entangled in the cutting attachment. Clear the area of children, bystanders, and pets. At a minimum, keep all children, bystanders and pets at least 100 ft. (30.5 m) away; there still may be risk to bystanders from thrown objects.
- Bystanders should be encouraged to wear eye protection. If you are approached, stop the motor and cutting attachment immediately. The correct angle for the cutting attachment is parallel to the ground.
- This string trimmer allows you to rest the bump knob (G) on the ground for more comfortable operation.
- Do not force the trimmer. Allow the very tip of the line to do the cutting (especially along walls). Cutting with

more than the tip will reduce cutting efficiency and may overload the motor.

- The cutting height is determined by the distance of the cutting line from the lawn surface.
- Grass over 8 in. (200 mm) should be cut by working from top to the bottom in small increments to avoid premature line wear or motor drag.
- Slowly move the trimmer into and out of the area being cut, maintaining the cutting head position at the desired cutting height. This movement can be either a forward-backward motion or a side-to-side motion. Cutting shorter lengths produces best results.
- Trim only when grass and weeds are dry.
- Wire and picket fences can cause extra string wear or breakage. Stone and brick walls, curbs, and wood may wear strings rapidly.
- Avoid trees and shrubs. Tree bark, wood moldings, siding, and fence posts can easily be damaged by the strings.

Adjusting Cutting Line Length (Fig 7b)

The trimmer head allows the operator to release more cutting line without stopping the motor. As line becomes frayed or worn, additional line can be released by lightly tapping the bump knob (G) on the ground while operating the trimmer. For best results, tap the bump knob on bare ground or hard soil. If line release is attempted in tall grass, the motor may overheat. Always keep the trimming line fully extended. Line release becomes more difficult as the cutting line becomes shorter.

WARNING

- Do not remove or alter the line cutting blade assembly. Excessive line length will cause the motor to overheat and may result in serious personal injury.
- To prevent serious personal injury, remove the battery pack from the tool before servicing, cleaning, changing attachments or removing material from the unit.
- Clear any grass that may have wrapped itself around the motor shaft or trimmer head.
- Use only a clean, dry and soft cloth to clean the tool. Never let any liquid get inside the tool; never immerse any part of the tool into a liquid.
- Keep the air vents in the rear housing free from debris at all times.

NOTICE: Obstructing the vents will prevent the air from flowing into the motor housing and may result in overheating or damage to the motor.

Never use water for cleaning your trimmer. Avoid using solvents when cleaning plastic parts. Most plastics are susceptible to damage from various types of commercial solvents. Use clean clothes to remove dirt, dust, oil, grease, etc.

Line Replacement

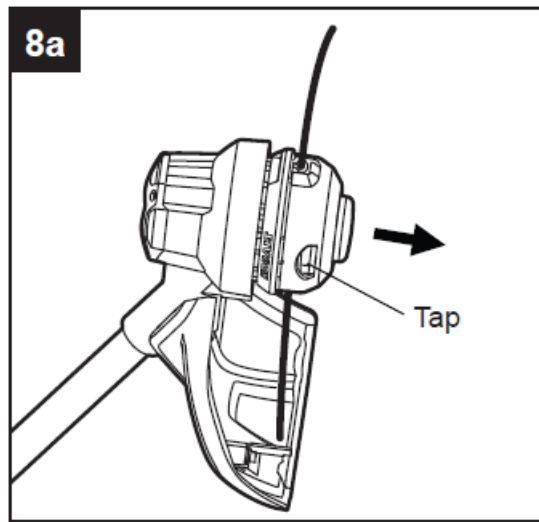

NOTICE: Always use triangle-shaped twisted nylon cutting line with a size that does not exceed 0.08 in. (2.0 mm). Using line other than that specified may cause the string trimmer to overheat or become damaged.

WARNING

Never use metal-reinforced line, wire, or rope, etc. These can break off and become dangerous projectiles.

Wind the spool with new line

To prevent serious personal injury, remove the battery pack from the tool before servicing, cleaning, changing attachments or removing material from the unit.

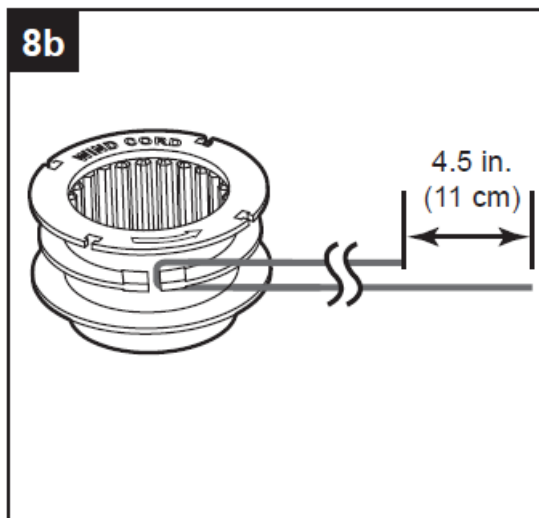

- Press the two release tabs on the spool base and remove the spool retainer by pulling it straight out (Fig. 8a).
- Remove the spool. Use a clean cloth to clean the inner surface of the spool retainer and spool base.

NOTICE: Always clean the spool retainer and spool base before reassembling the trimmer head.

- Check the spool retainer, spool and spool base worn wear parts.
- Take approximately 15 ft. (4.5 m) of 0.08 in. (2.0 mm) diameter cutting line. Fold the line in half and then adjust it so that one end is 4.5 in. (11 cm) longer than the other (Fig. 8b).
- Hook the folded end of the cutting line onto either of the slots in the spool.
- Wind the line, in two even and tight layers, onto the spool. Wind the line in the direction indicated on the spool.

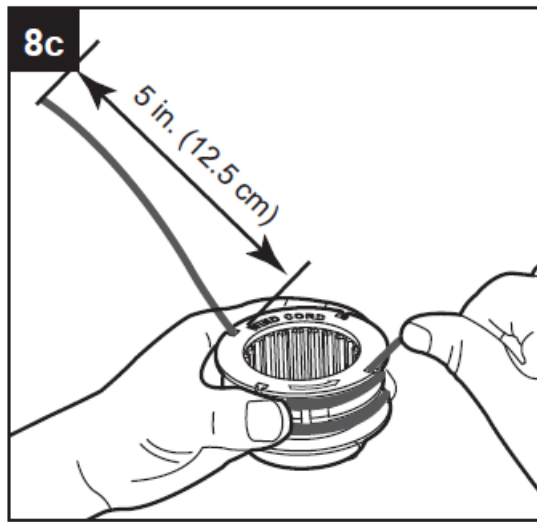

NOTICE: Failure to wind the line in the direction indicated will cause the trimmer head to operate incorrectly. Place the ends of the line in two opposite notches in the spool, with approximately 5 in. (12.5 cm) protruding (Fig. 8c).

- Align the notches of the spool from which the lines protrude with the eyelets in the spool retainer and position the spool in the retainer (Fig. 8d).
- Holding the spool and spool retainer, grasp one end of the line and pull it to release the line from the notch in the eyelet (Fig. 8e). Repeat with the other end.
- With the spool base facing downward, align the slots in the spool retainer with the tabs on the spool base and press the retainer evenly down until it snaps into place (Fig. 8f).

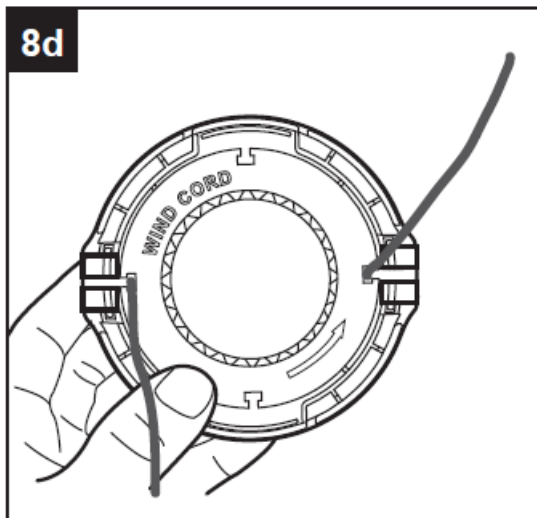

NOTICE: Make sure that the tabs on the spool base snap into place or the spool will come out during operation.

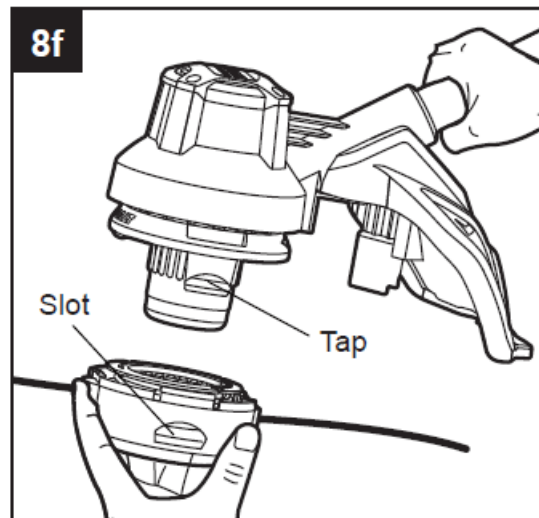
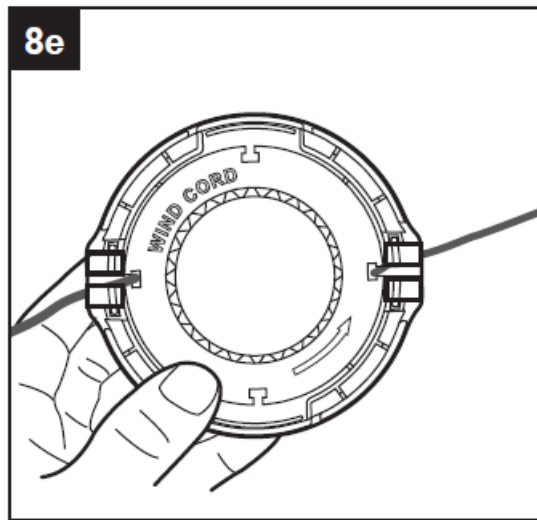

CARE AND MAINTENANCE

All maintenance should only be carried out by a qualified service technician. Before cleaning or performing any maintenance, remove battery from the tool. For safe and proper operation, always keep the tool and its ventilation slots clean. **Cleaning** Always use only a soft, dry cloth to clean your string trimmer; never use detergent or alcohol. Clear any grass that may have wrapped itself around the motor shaft or trimmer head. Keep the air vents free of obstructions. **Storage** Clean the tool thoroughly before storing it. Store the unit in a dry, well-ventilated area, locked-up or up high, out of the reach of children. Keep away from corrosive agents, such as garden chemicals and de-icing salts.

TROUBLESHOOTING

Turn the switch to the "OFF" position and remove battery from the tool before performing troubleshooting procedures.

PROBLEM	POSSIBLE CAUSE	CORRECTIVE ACTION
Tool does not work.	Low battery capacity.	Charge the battery pack.
String trimmer stops while cutting.	1. The motor shaft or trimmer head is bound with grass.	1. Stop the trimmer, remove the battery, and remove the grass from the motor shaft and trimmer head.
	2. The motor is overloaded.	2. Move the trimmer head to cut the grass no more than 8 in. of length in a single cut. Remove the trimmer head from the grass and restart the tool.
	3. The battery pack or string trimmer is too hot.	3. Release the trigger switch, wait for the tool to cool down, and then start the tool again.
Trimmer head will not advance line.	1. The motor shaft or trimmer head is bound with grass.	1. Stop the trimmer, remove the battery, and clean the motor shaft and trimmer head.
	2. There is not enough line on the spool.	2. Remove the battery and replace the cutting line; follow the section "Line Replacement" in the manual.

WARRANTY

For 5 years from the date of purchase, this product is warranted for the original purchaser to be free from defects in material and workmanship. This guarantee does not cover damage due to abuse, normal wear, improper maintenance, neglect, unauthorized repair/alteration, or expendable parts and accessories expected to become unusable after a reasonable period of use. This warranty is limited to 90 days for commercial and rental use. If you think your product meets the above guarantee criteria, please return it to the place of purchase with valid proof of purchase and the defective product will be repaired or replaced at no charge. This guarantee gives you specific legal rights, and you may also have other rights that vary from state to state.

ITEM #1157557/1137837/0856457 BRUSHLESS STRING TRIMMER MODEL #KST 2224B-03 ATTACH YOUR RECEIPT HERE

Serial Number Purchase Date Questions, problems, missing parts? Before returning to your retailer, call our customer service department at 1-888-3KOBALT (1-888-356-2258), 8 a.m. – 8 p.m., EST, Monday – Friday. PH18597

Documents / Resources

	<p>KOBALT KST 2224B-03 Brushless String Trimmer [pdf] User Manual</p> <p>KST 2224B-03 Brushless String Trimmer, KST 2224B-03, KST 2224B-03 String Trimmer, Brushless String Trimmer, Brushless Trimmer, String Trimmer, Trimmer, PH18597</p>
---	---