



# KOBALT KMS 1040-03 String Trimmer Attachment User Manual

[Home](#) » [Kobalt](#) » KOBALT KMS 1040-03 String Trimmer Attachment User Manual 

## Contents

- 1 KOBALT KMS 1040-03 String Trimmer Attachment
- 2 PRODUCT SPECIFICATIONS
- 3 PACKAGE CONTENTS
- 4 SAFETY INFORMATION
- 5 IMPORTANT SAFETY INSTRUCTIONS
- 6 PREPARATION
- 7 ASSEMBLY INSTRUCTIONS
  - 7.1 Mounting the Guard
  - 7.2 Installing the attachment
- 8 OPERATING INSTRUCTIONS
  - 8.1 Holding the String Trimmer
  - 8.2 Using the String Trimmer
- 9 CARE AND MAINTENANCE
- 10 TROUBLESHOOTING
- 11 WARRANTY
- 12 Documents / Resources
  - 12.1 References
- 13 Related Posts



**KOBALT KMS 1040-03 String Trimmer Attachment**



**PRODUCT SPECIFICATIONS**

COMPONENT	SPECIFICATION
Cutting Mechanism	Bump Head
Cutting-Line Type	0.08 in. twisted nylon line
Cutting Width	15 in. (38cm)
Operating temperature	32°F (0°C) – 104°F (40°C)
Storage temperature	32°F (0°C) – 104°F (40°C)

**PACKAGE CONTENTS**

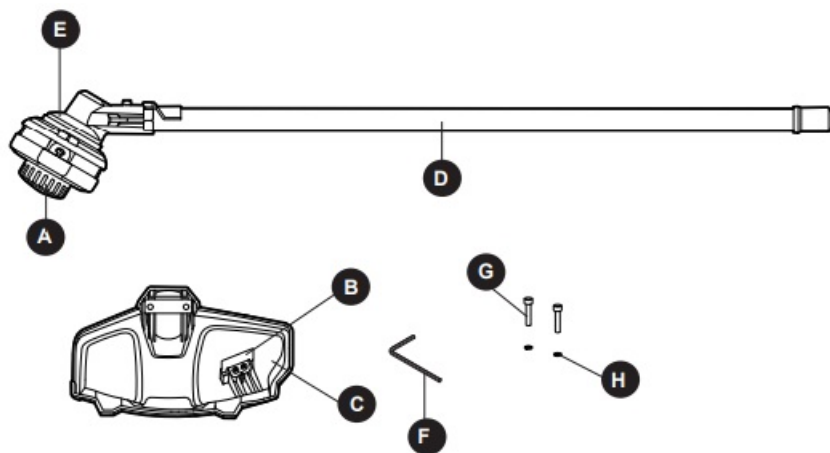

PART	DESCRIPTION
A	Bump head
B	Line-cutting blade
C	Guard
D	Trimmer attachment shaft
E	Trimmer head

PART	DESCRIPTION
F	Hex Key
G	Bolt (2)
H	Spring washer (2)

## WARNING

- Remove the tool from the package and examine it carefully. Inspect the tool carefully to make sure that no breakage or damage occurred during shipping. If any parts are damaged or missing, please return the product to the place of purchase. Do not discard the carton or any packaging material until all parts have been examined.
- If any part of the tool is missing or damaged, do not attach the battery to use the tool until the part has been repaired or replaced. Failure to heed this warning could result in serious injury.

## SAFETY INFORMATION

Please read and understand this entire manual before attempting to assemble or operate this product. If you have any questions regarding the product, please call customer service at 1-888-3KOBALT (1-888-356-2258), 8 a.m. – 8 p.m., EST, Monday – Sunday. You could also contact us at [partsplus@lowes.com](mailto:partsplus@lowes.com) or visit [www.lowespartsplus.com](http://www.lowespartsplus.com).

## WARNING

- The operation of any power tool can result in foreign objects being thrown into your eyes, which can result in severe eye damage. Before beginning power-tool operation, always wear safety goggles or safety glasses with side shields and a full-face shield, when needed. We recommend using a wide vision safety mask over eyeglasses or standard safety glasses with shields. Always use eye protection marked to comply with ANSI Z87.1.
- Some dust created by power sanding, sawing, grinding, drilling, and other construction activities contains chemicals known to the state of California to cause cancer, birth defects, or other reproductive harm. Some examples of these chemicals are:
  - Lead from lead-based paints
  - Crystalline silica from bricks, cement, and other masonry products
  - Arsenic and chromium from chemically-treated lumber
- Your risk from these exposures varies, depending upon how often you do this type of work.

To reduce your exposure to these chemicals:

- Work in a well-ventilated area.
- Work with approved safety equipment, such as dust masks that are specially designed to filter out microscopic particles.
- Avoid prolonged contact with dust from power sanding, sawing, grinding, drilling, and other construction activities. Wear protective clothing and wash exposed areas with soap and water. Allowing dust to get into your mouth or eyes or to lie on the skin may promote absorption of harmful chemicals.

### Know the Tool



To operate this tool, carefully read this manual and all labels affixed to the tool before using it. Keep this manual available for future reference.

### Important

This tool should be serviced only by a qualified service technician.

### Read All Instructions Thoroughly

Some of the following symbols may be used on this tool. Please study them and their meaning. Proper interpretation of these symbols will allow you to operate the tool better and more safely.

SYMBOL	DEFINITION	SYMBOL	DEFINITION
V	Volts	n 0	No-load speed
— —	Direct current	RPM	Revolutions per Minute
	A danger, warning, or caution. It means 'Attention! Your safety is involved.'		To reduce the risk of injury, user must read instruction manual.

## IMPORTANT SAFETY INSTRUCTIONS

### WARNING

- When using electric trimmers, basic safety precautions should always be followed to reduce the risk of fire,

electric shock, and personal injury, including the following:

## **READ ALL INSTRUCTIONS**

### **DANGER**

- Do not rely on the tool's insulation against electric shock. To reduce the risk of electrocution, never operate the tool in the vicinity of any wires or cables which may carry electric current.

### **CAUTION**

- Wear appropriate personal hearing protection during use. Under some conditions and durations of use, noise from this product may contribute to hearing loss.
- Avoid dangerous environments – Don't use appliances in damp or wet location.
- Don't use in rain.
- Keep children away – All visitors should be kept at least 100 ft. (30.5 m) away from work area.
- Dress properly – Do not wear loose clothing or jewelry. They can be caught in moving parts. Use of rubber gloves and substantial footwear is recommended when working outdoors. Wear protective hair covering to contain long hair.
- Use safety glasses. Always use face or dust mask if operation is dusty.
- Use the right appliance – Do not use the tool for any job except that for which it is intended.
- Don't force the appliance – It will do the job better and with less likelihood of a risk of injury at the rate for which it was designed.
- Don't overreach – Keep proper footing and balance at all times.
- Stay alert – Watch what you are doing. Use common sense. Do not operate the appliance when you are tired.
- Keep guards in place and in working order.
- Keep hands and feet away from the cutting area.
- Store idle appliances indoors – When not in use, the appliances should be stored indoors in a dry and high or locked-up place with the battery pack removed and out of reach of children.
- Maintain appliance with care – Keep cutting edge sharp and clean for best performance and to reduce the risk of injury. Follow instructions for lubricating and changing accessories. Keep handles dry, clean, and free from oil and grease.
- Check damaged parts – Before further use of the trimmer, a guard or other part that is damaged should be carefully checked to determine that it will operate properly and perform its intended function. Check for alignment of moving parts, binding of moving parts, breakage of parts, mounting, and any other condition that may affect its operation. A guard or other part that is damaged should be properly repaired or replaced by an authorized service center unless indicated elsewhere in this manual.
- Do not charge the battery pack in rain or in wet locations.
- Prevent unintentional starting. Ensure the switch is in the "off" position before connecting to battery pack, picking up or carrying the appliance. Carrying the appliance with your finger on the switch or energizing appliances that have the switch on invites accidents.
- Disconnect the battery pack from the appliance before making any adjustments, changing accessories, or storing appliance. Such preventive safety measures reduce the risk of starting the appliance accidentally.
- Use the battery-operated trimmer only with specifically designated battery pack. Use of any other batteries may

create a risk of fire.

- Use only with the battery packs and chargers listed below:

BATTERY PACK	CHARGER
KB 240-03; KB 440-03; KB 640-03;	KRC 840-03

- Do not use a battery pack or appliance that is damaged or modified. Damaged or modified batteries may exhibit unpredictable behavior resulting in fire explosion or risk of injury.
- Do not expose a battery pack or appliance to fire or excessive temperature. Exposure to fire or temperature above 212°F (100°C) may cause explosion.
- Follow all charging instructions and do not charge the battery pack or appliance outside of the temperature range specified in the instructions. Charging improperly or at temperatures outside of the specified range may damage the battery and increase the risk of fire.
- Have servicing performed by a qualified repair person using only identical replacement parts. This will ensure that the safety of the product is maintained.
- Do not modify or attempt to repair the appliance or the battery pack except as indicated in the instructions for use and care.
- Do not dispose of the battery in a fire. The cells may explode. Check with local codes for possible special disposal instructions.
- Do not open or mutilate the battery. Released electrolyte is corrosive and may cause damage to the eyes or skin. It may be toxic if swallowed.
- Exercise care in handling batteries in order not to short the battery with conducting materials such as rings, bracelets, and keys. The battery or conductor may overheat and cause burns.
- Use Only With the 40V Lithium-Ion Power Head KMH 1040-03.
- Do not operate the trimmer while under the influence of alcohol or drugs.
- Clear the area to be cut before each use. Remove all objects such as rocks, broken glass, nails, wire, or string that can be thrown or become entangled in the cutting attachment. Make sure that other persons and pets are at least 100 ft. (30.5m) away.
- Always hold the trimmer firmly, with both hands on the handles, while operating. Wrap your fingers and thumbs around the handles.
- To reduce the risk of injury from loss of control, never work on a ladder or on any other insecure support. Never hold the cutting attachment above waist height.
- Do not operate the trimmer in gaseous or explosive atmospheres. Motors in these appliances normally spark, and the sparks might ignite fumes.
- Wear heavy long pants, long sleeves, boots, and gloves. Avoid loose garments or jewelry that could get caught in moving parts of the machine or its motor.
- Damage to trimmer – If you strike a foreign object with the trimmer or it becomes entangled, stop the tool immediately, check for damage and have any damage repaired before further operation is attempted. Do not operate with a broken guard or spool.
- If the equipment should start to vibrate abnormally, stop the motor and check immediately for the cause. Vibration is generally a warning of trouble.
- A loose head may vibrate, crack, break or come off the trimmer, which may result in serious or fatal injury. Make sure that the cutting attachment is properly fixed in position. If the head loosens after fixing it in position, replace it immediately.

- Never use a trimmer with a loose cutting attachment.
- Replace a cracked, damaged or worn-out cutting head immediately, even if damage is limited to superficial cracks. Such attachments may shatter at high speed and cause serious or fatal injury.
- Check the cutting attachment at regular short intervals during operation, or immediately if there is a noticeable change in cutting behavior.
- When replacing the cutting line, use triangle-shaped twisted nylon cutting line with a size that does not exceed 0.08 in. (2.0 mm); using heavier lines than recommended by the manufacturer increases the load on the motor and reduces its operating speed. This results in overheating and damage to the trimmer.
- To reduce the risk of serious injury, never use wire or metal-reinforced line or other material in place of the nylon cutting lines. Pieces of wire could break off and be thrown at high speed toward the operator or bystanders.
- When servicing, use only identical replacement parts. Use of any other accessory or attachment which is not recommended for use with this tool may increase the risk of injury.
- Do not wash with a hose; avoid getting water in motor and electrical connections.
- Save these instructions. Refer to them frequently and use them to instruct others who may use this tool. If you lend this tool to someone else, also lend these instructions to them to prevent misuse of the product and possible injury.

**NOTE:** SEE OPERATOR'S MANUAL FOR YOUR KOBALT KMH 1040-03 POWER HEAD FOR SPECIFIC SAFETY RULES.

## PREPARATION

### Know Your String Trimmer

This product requires assembly. Carefully lift the tool from the carton and place it on a level work surface. Before attempting to use the string trimmer attachment, familiarize yourself with all of its operating features and safety requirements.

### WARNING

- Do not allow familiarity with the tool to cause carelessness. Remember that one careless moment is enough to cause severe injury. Before attempting to use any tool, be sure to become familiar with all of the operating features and safety instructions.
- Do not attempt to modify this tool or create accessories not recommended for use with this tool. Any such alteration or modification is misuse and could result in a hazardous condition leading to possible serious personal injury.

## ASSEMBLY INSTRUCTIONS

**WARNING:** This product requires assembly. To reduce the risk of injury to persons, never operate without the guard in place. The guard must always be on the tool to protect the user.

### Mounting the Guard

### WARNING

- Install the guard before the attachment is connected to the power head.

- To reduce the risk of injury to persons, do not operate without a guard in place.
  - Loosen the two bolts (G) in the guard with the supplied hex key (F). Remove the bolts and spring washers (H) from the guard (C) (Fig. 1a).

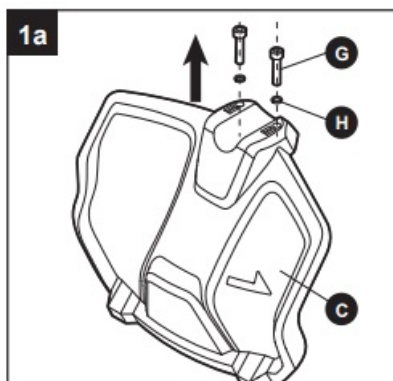

- Lift the trimmer head (E) and face it downward; align the two mounting holes in the guard with the two assembly holes in the base of the shaft. Make sure that the inner surface of the guard faces toward the trimmer head (Fig. 1b).

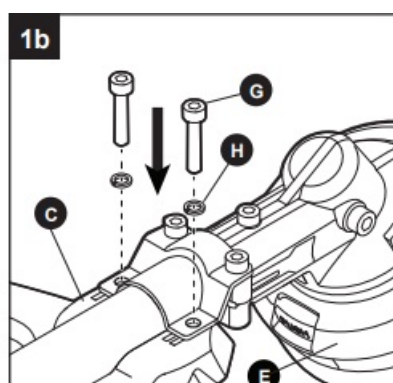

- Use the supplied hex key to secure the guard in place with the washers and bolts.

## Connecting the String Trimmer Attachment to the Power Head (KMH 1040-03)

### Installing the attachment

- Remove the battery pack from the power head.
- Loosen the wing knob on the power-head shaft (Fig. 2a).

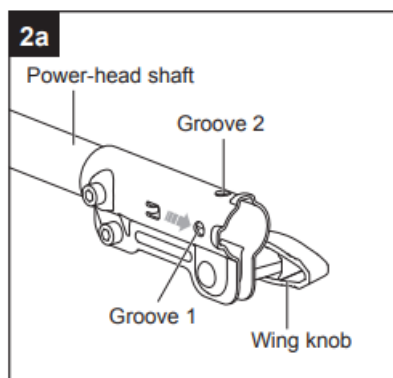

- The power head has two grooves on the coupler, ONLY groove 1 is used to connect attachments: KMS 1040-03 and KEG 1040-03.
- Align the spring-loaded pin on the attachment with the groove on the coupler and push the attachment shaft into the power head shaft until the pin pops out of the groove and you hear an audible “click” sound at the same time (Fig. 2b).



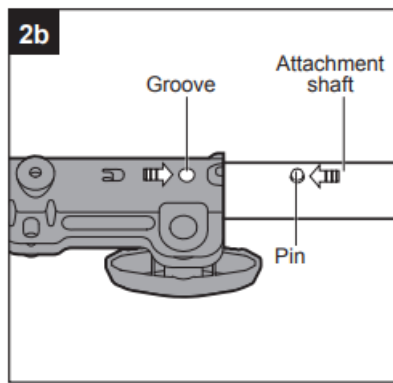

- Pull the shaft of the attachment to verify that it is securely locked into the coupler.
- Tighten the wing knob securely.

### Removing the attachment

- Remove the battery pack from the power head.
- Loosen the wing knob.
- Press down the spring-loaded pin and pull the attachment shaft out of the coupler (Fig. 2c).

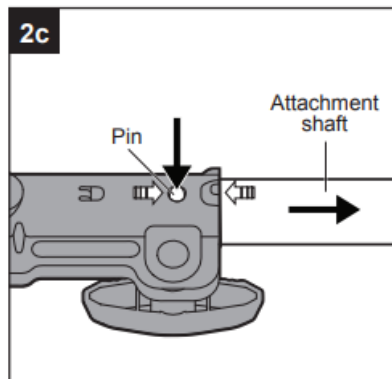

## OPERATING INSTRUCTIONS

### Holding the String Trimmer

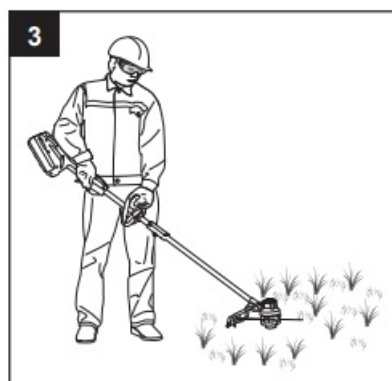

### WARNING

- Dress properly to reduce the risk of injury when operating this tool. Do not wear loose clothing or jewelry. Wear eye and ear/hearing protection. Wear heavy, long pants, boots and gloves. Do not wear short pants and sandals or go barefoot. Before operating the unit, stand in the operating position and check that:
  - The operator is wearing eye protection and proper clothing.
  - One arm is slightly bent. The hand of that arm is holding the rear handle.

- The other arm is straight. The hand of that arm is holding the front-assist handle.
- The trimmer head is parallel to the ground and easily contacts the material to be cut without the operator having to bend over.

### To Start/Stop the String Trimmer

See “STARTING/STOPPING THE POWER HEAD” section in the KMH 1040-03 power head operator’s manual.

### Using the String Trimmer

#### Tips for best trimming results (Fig. 5a)

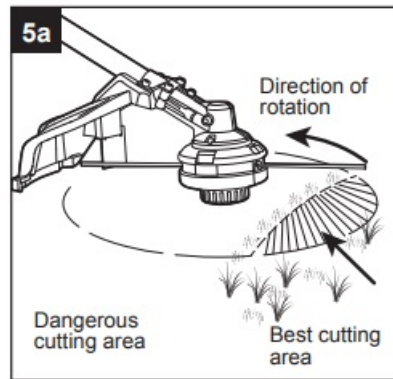

### WARNING

- Check for damaged/worn parts before each use.
- To avoid serious personal injury, wear goggles or safety glasses at all times when operating this unit. Wear a face mask or dust mask in dusty locations. Wear proper clothing and footwear during operation to reduce the risk of injury that may be caused by flying debris.
- Clear the area to be cut before each use. Remove all objects, such as rocks, broken glass, nails, wire, or string that can be thrown or become entangled in the cutting attachment. Clear the area of children, bystanders, and pets. At a minimum, keep all children, bystanders, and pets at least 100 ft. (30.5 m) away. There still may be risk to bystanders from thrown objects.
- Bystanders should be encouraged to wear eye protection. If you are approached, stop the motor and cutting attachment immediately.
- The correct angle for the cutting attachment is parallel to the ground.
- This string trimmer allows you to rest the bump head (A) on the ground for more comfortable operation.
- Do not force the trimmer. Allow the very tip of the line to do the cutting (especially along walls). Cutting with more than the tip will reduce cutting efficiency and may overload the motor.
- The cutting height is determined by the distance of the cutting line from the lawn surface.
- Grass over 8 in. (200 mm) should be cut by working from top to the bottom in small increments to avoid premature line wear or motor drag.
- Slowly move the trimmer into and out of the area being cut, maintaining the cutting head position at the desired cutting height. This movement can be either a forward-backward motion or a side-to-side motion. Cutting shorter lengths produces best results.
- Trim only when grass and weeds are dry.
- Wire and picket fences can cause extra string wear or breakage. Stone and brick walls, curbs, and wood may wear strings rapidly.
- Avoid trees and shrubs. Tree bark, wood moldings, siding, and fence posts can easily be damaged by the

strings.

### Adjusting Cutting Line Length (Fig 5b)

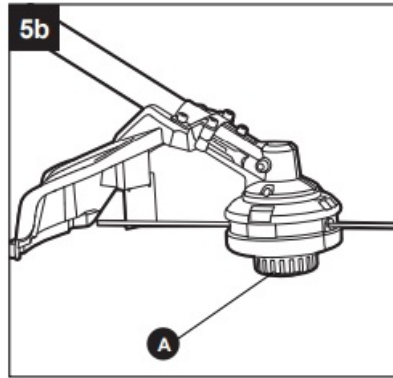

The trimmer head allows the operator to release more cutting line without stopping the motor. As the line becomes frayed or worn, the additional line can be released by lightly tapping the bump head (A) on the ground while operating the trimmer (Fig.5b). For best results, tap the bump head on bare ground or hard soil. If line release is attempted in tall grass, the motor may overheat. Always keep the trimming line fully extended. Line release becomes more difficult as the cutting line becomes shorter.

### WARNING

- Do not remove or alter the line-cutting blade assembly. Excessive line length will cause the motor to overheat and may result in serious personal injury.

### CARE AND MAINTENANCE

#### WARNING

All maintenance should only be carried out by a qualified service technician.

**Clean the trimmer after each use**

#### WARNING

- To prevent serious personal injury, remove the battery pack from the tool before servicing, cleaning, changing attachments or removing material from the tool.
  - Clear any grass that may have wrapped itself around the motor shaft or trimmer head.
  - Use only a clean, dry and soft cloth to clean the tool. Never let any liquid get inside the tool; never immerse any part of the tool into a liquid.
  - Keep the air vents free from debris at all times.

NOTICE: Obstructing the vents will prevent the air from flowing into the motor housing and may result in overheating or damage to the motor.

### WARNING

- Never use water for cleaning your trimmer. Avoid using solvents when cleaning plastic parts. Most plastics are susceptible to damage from various types of commercial solvents. Use clean clothes to remove dirt, dust, oil, grease, etc.

### Line Replacement

**NOTICE:** Always use a triangle-shaped twisted nylon cutting line with a size that does not exceed 0.08 in. (2.0 mm). Using line other than that specified may cause the string trimmer to overheat or become damaged.

## **WARNING**

- Never use metal-reinforced line, wire, or rope, etc. These can break off and become dangerous projectiles.

## **Wind the spool with new line**

### **WARNING**

- To prevent serious personal injury, remove the battery pack from the tool before servicing, cleaning, changing attachments, or removing material from the unit.
  - Press the two release tabs on the spool base and remove the spool retainer by pulling it straight out (Fig. 6a).

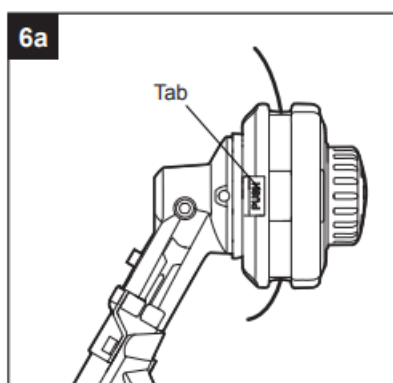

- Use a clean cloth to clean the inner surface of the spool retainer and spool base.

**NOTICE:** Always clean the spool retainer and spool base before reassembling the trimmer head.

- Check the spool retainer and spool base for worn or damaged parts.
- Fold the cutting line in half and hook the folded end of the cutting line as shown in Fig. 6b.

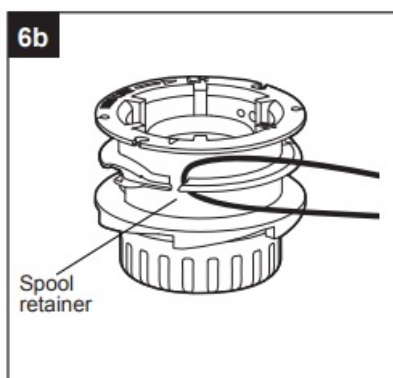

- Wind the line, in two even and tight layers, onto the spool retainer.

**NOTICE:** Failure to wind the line in the direction indicated will cause the trimmer head to operate incorrectly.

- Place the ends of the line in two opposite eyelets (Fig. 6c).

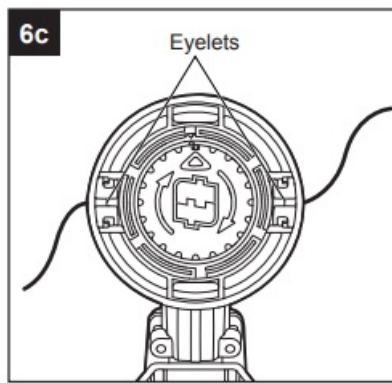

- Align the two tabs on the spool base with the slots on trimmer head and press it until it snaps into place (Fig. 6d).

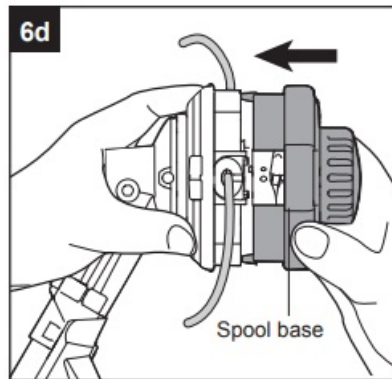

**NOTICE:** Make sure that the tabs on the spool base snap into place, otherwise the spool will come out during operation.

You can replace the new line in another way:

### WARNING

- To prevent serious personal injury, remove the battery pack from the tool before servicing, cleaning, changing attachments or removing material from the unit.
  - Press the two release tabs on the spool base and remove the spool retainer.
  - Reinstall the spool retainer in such a way that the threading hole on the spool retainer is aligned with one of the eyelets (Fig. 6e).

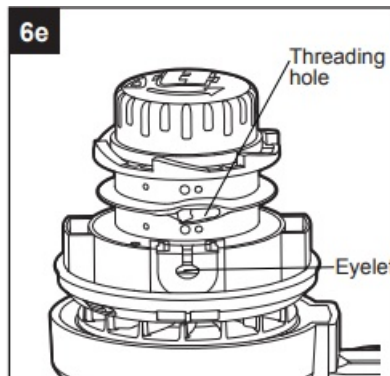

- Insert the new line into the eyelet. Feed the line until the end of the line comes out of the other side eyelet of the spool base (Fig. 6f).

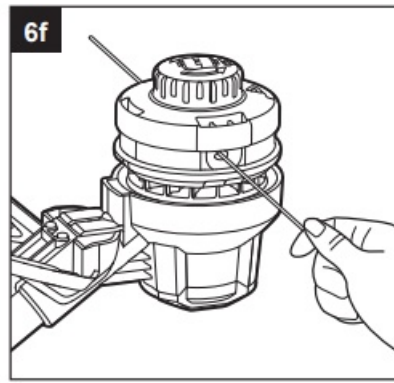
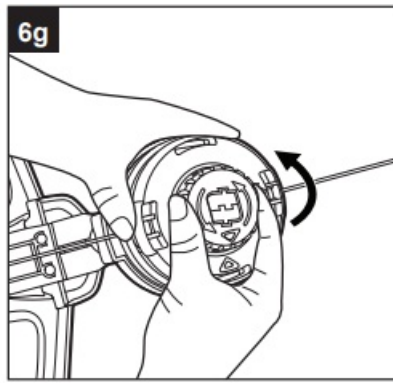

- Pull the line from the other side until equal amounts of line appear on both sides.
- Hold the spool base and rotate the bump head in the direction indicated by the arrow to wind the cutting line into the trimmer head (Fig. 6g).
- Push down on the bump head and check for proper installation of the cutting line.

### Transmission Gears Lubrication

The transmission gears in the gear case need be lubricated periodically with gear grease. Check the gear case grease level about every 50 hours of operation by removing the sealing screw on the side of the case. If no grease can be seen on the sides of the gear, follow the steps below to fill with gear grease up to 3/4 capacity. Do not completely fill the transmission gear case.

- Hold the string trimmer attachment on its side so that the sealing screw is facing upwards (Fig. 7).

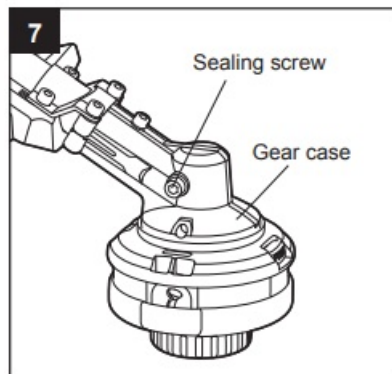

- Use the multi-function wrench (I) to loosen and remove the sealing screw.
- Use a grease syringe (not included) to inject some grease into the lubrication opening, taking care not to exceed 3/4 capacity.
- Tighten the sealing screw after injection.

### Storage

Clean the tool thoroughly before storing it. Store the unit in a dry, well-ventilated area, locked-up or up high, out of the reach of children. Keep away from corrosive agents, such as garden chemicals and de-icing salts.

## TROUBLESHOOTING

### WARNING:

- Release trigger switch (B) in the OFF position and remove the battery before performing troubleshooting procedures.

PROBLEM	POSSIBLE CAUSE	CORRECTIVE ACTION
Tool does not work.	1. Low battery pack capacity.	1. Charge the battery pack.
	2. The battery pack is not attached to the power head.	2. Attach the battery pack to the power head.
String trimmer stops while cutting.	1. The motor shaft or trimmer head is bound with grass.	1. Stop the trimmer, remove the battery pack, and remove the grass from the motor shaft and trimmer head.
	2. The motor is overloaded.	2. Move the trimmer head to cut the grass no more than 8 in. (20 cm) of length in a single cut. Remove the trimmer head from the grass and restart the tool.
	3. The battery pack or string trimmer is too hot.	3. Release the trigger switch, wait for the tool to cool down, and then start the tool again.
	4. The guard is not mounted on the trimmer, resulting in an overly long cutting line and overload.	4. Remove the battery pack and mount the guard on the trimmer.
Trimmer head will not advance the cutting line.	1. The trimmer head is bound with grass.	1. Stop the trimmer, remove the battery pack, and clean the trimmer head.
	2. There is not enough line on the spool.	2. Remove the battery pack and replace the cutting line by following the section "Line Replacement" in this manual.

## WARRANTY

For 5 years from the date of purchase, this product is warranted for the original purchaser to be free from defects in material and workmanship. This guarantee does not cover damage due to abuse, normal wear, improper maintenance, neglect, unauthorized repair/alteration, or expendable parts and accessories expected to become unusable after a reasonable period of use. This warranty is limited to 90 days for commercial and rental use. If you think your product meets the above guarantee criteria, please return it to the place of purchase with valid proof of purchase and the defective product will be repaired or replaced at no charge. This guarantee gives you specific legal rights, and you may also have other rights that vary from state to state.

Lowe's Home Centers LLC.

Mooresville, NC 28117

Printed in China

KOBALT and logo design are trademarks or registered trademarks of LF, LLC. All rights reserved.

### ATTACH YOUR RECEIPT HERE

- Serial Number
- Purchase Date

Questions, problems, missing parts? Before returning to your retailer, call our customer service department at 1-888-3KOBALT (1-888-356-2258), 8 a.m. – 8 p.m., EST, Monday – Sunday. You could also contact us at [partsplus@lowes.com](mailto:partsplus@lowes.com) or visit [www.lowespartsplus.com](http://www.lowespartsplus.com).

## Documents / Resources



[KOBALT KMS 1040-03 String Trimmer Attachment](#) [pdf] User Manual  
KMS 1040-03 String Trimmer Attachment, KMS 1040-03, String Trimmer Attachment, Trimmer Attachment, Attachment

## References

- [Lowe's Parts Plus](#)

[Manuals+.](#)