



KOAMTAC KTSync App for Keyboard User Guide

[Home](#) » [KOAMTAC](#) » KOAMTAC KTSync App for Keyboard User Guide 

Contents

- 1 KOAMTAC KTSync App for Keyboard
- 2 Downloading and Installing KTSync
- 3 Connecting to KTSync
- 4 Setting up the KTSync Keyboard
- 5 How to get the Activation Code for the Software Decoder (KDC8)
- 6 KTSync Demo Feature (Scan & Search)
- 7 CONTACT
- 8 Documents / Resources
 - 8.1 References



KOAMTAC KTSync App for Keyboard



Downloading and Installing KTSync

1. Go to the Play Store and search for the app name "KTSync".
2. Download and install KTSync on your phone.
3. When you execute KTSync for the first time on your phone, there are several permission popups, which require you to allow them all.

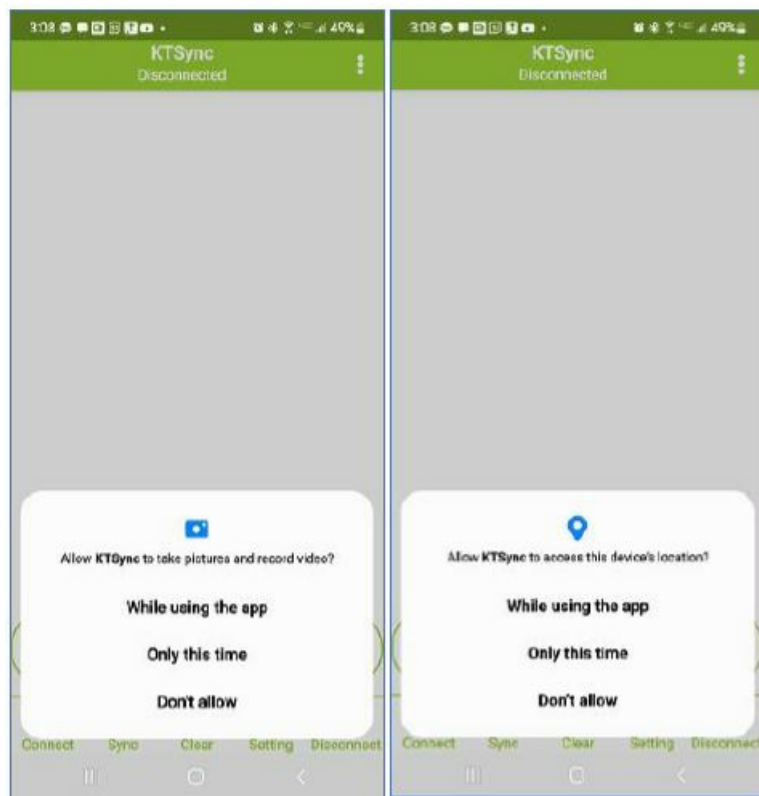

Connecting to KTSync

There are 3 types of KDC products to connect to KTSync.

1. Bluetooth (BLE) Devices (All KDC Bluetooth Devices)

- Can be connected to KTSync on the host device (phone or tablet) using Bluetooth SPP pairing barcode.
- Navigate to the Bluetooth setting on the phone/tablet.
- Ensure that Bluetooth is enabled on the phone/tablet.
- Using the KDC, scan the pairing barcode below. If the KDC has a display, it will display the message “Pairing[SPP] Started” on the screen and the LED light on the KDC will blink red.
- Check the list of available Bluetooth devices on your phone/tablet.
- From the list, select your KDC listed by serial number in brackets that matches the serial number found on the KDC.
- From the KTSync, complete the connection.



2. USB Devices (SKXPro or SKX6Pro).

- Can be connected to KTSync on the host device using USB Serial mode.

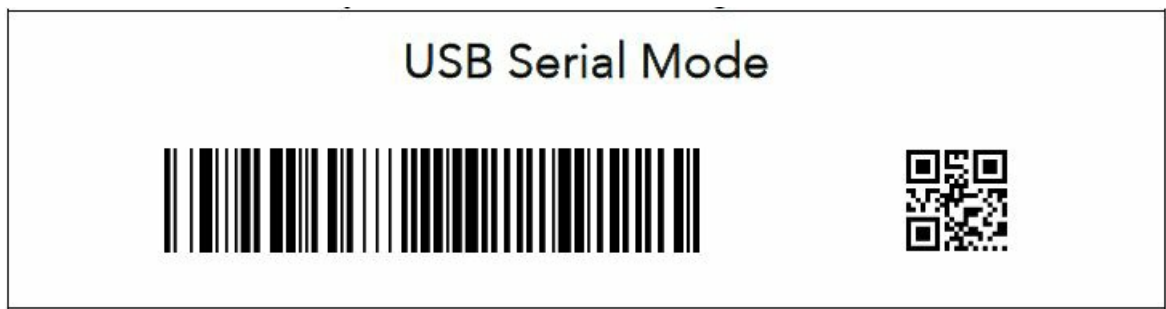

- Or, you can use the hot key combinations. SKX has two green SCAN buttons on the left and the right. Press Left-Left-Left-Right-Right-Right-Left-Right within 3 seconds then you will hear two beeps. If you hear one beep, do that again. (One beep is HID Mode and two beeps is Serial Mode)

3. Software Decoder (Camera Scanner) (KDC8)

- Can be connected to KTSync on the host device using Activation Code (License Code). (Please refer to “IV. How to get the Activation Code for the Software Decoder (KDC8)” below.)
- Once you receive the activation code via email, register the activation code to KTSync.

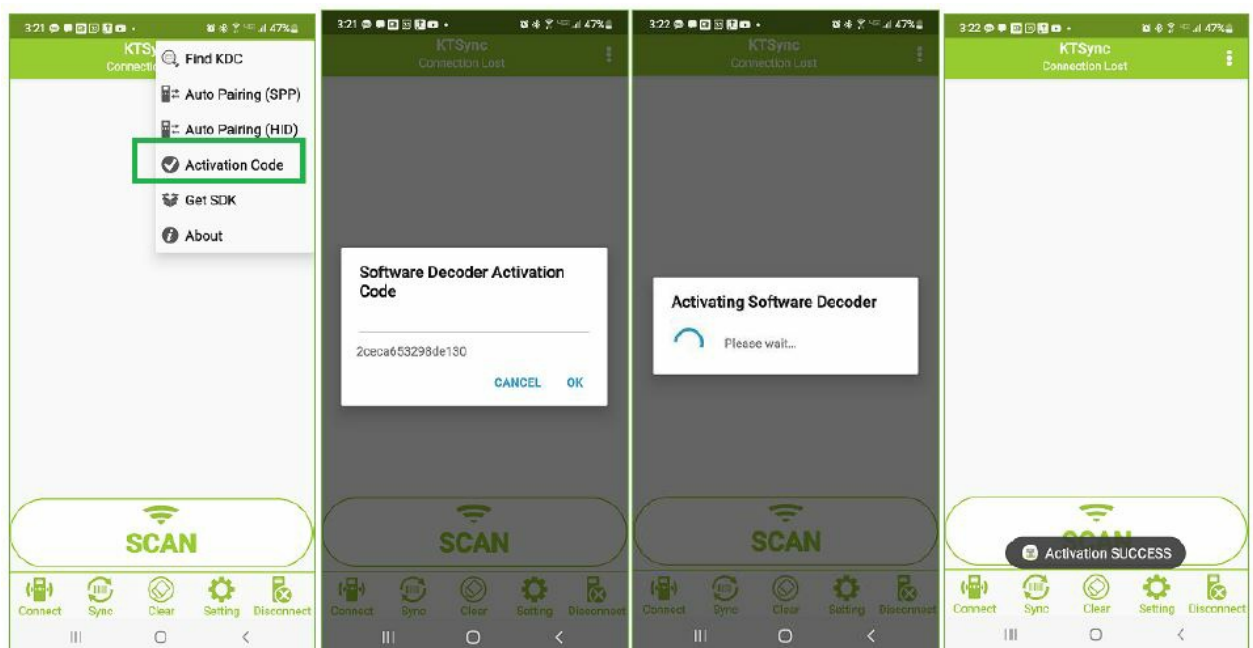

- The phone/tablet will automatically connect to the KDC8 (SW Decoder).
- If not connected automatically, tap the “Connect” menu icon at the bottom and select the correct device: KDC8 [SW] in this case.
- If you see the connected message toward the top of the screen, you can scan with the app. For testing purposes, scan any barcode and see if it is displayed in KTSync.

Once the connection is established, KTSync will display “Connected” next to the name of the device at the top of the application. If not, tab on “Connect” menu at the bottom and select a proper device you want to connect to. To make sure that the device and KTSync are connected properly, scan any barcode. If the connection is successful, the barcode data will display on the screen.

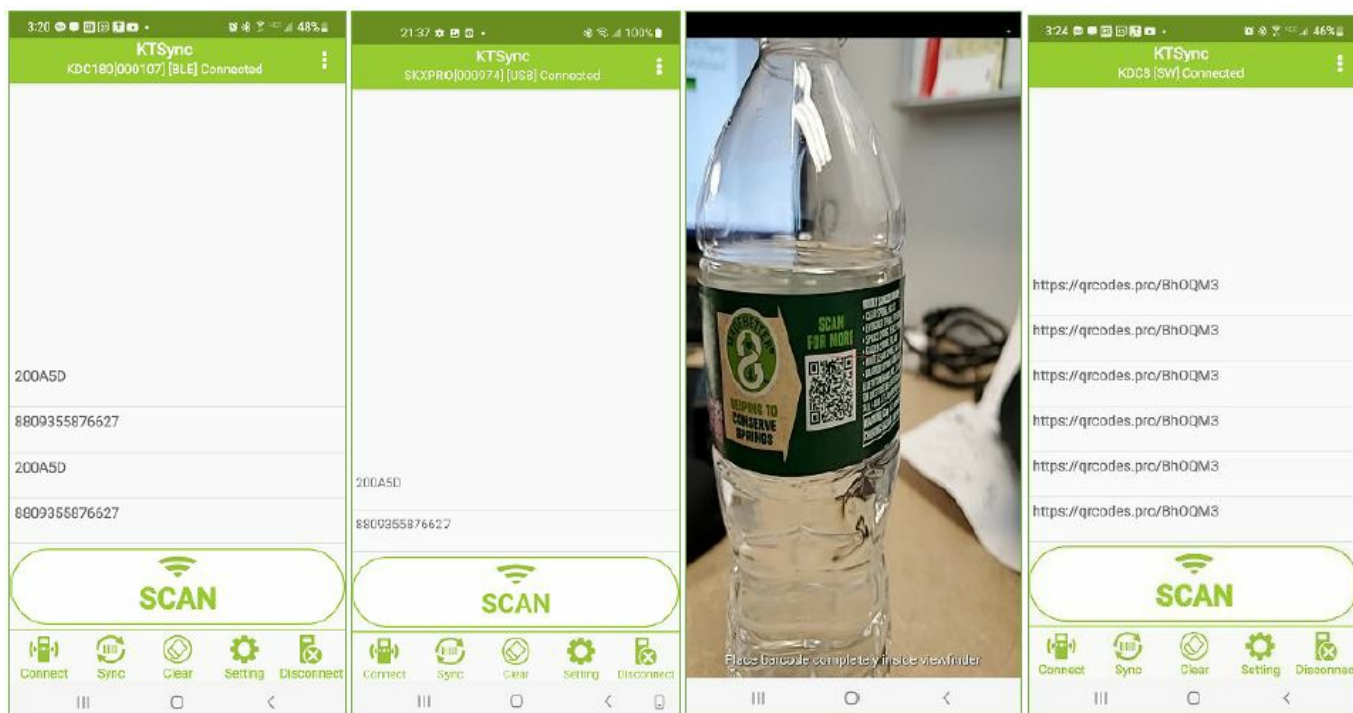

Setting up the KTSync Keyboard

1. Go to phone's or tablet's Settings > General management > keyboard list and default. Find KTSync Keyboard and enable it by sliding the button to the right. Also, tap on Default keyboard and change the default keyboard from the other keyboard to KTSync Keyboard. (Fig. 1)

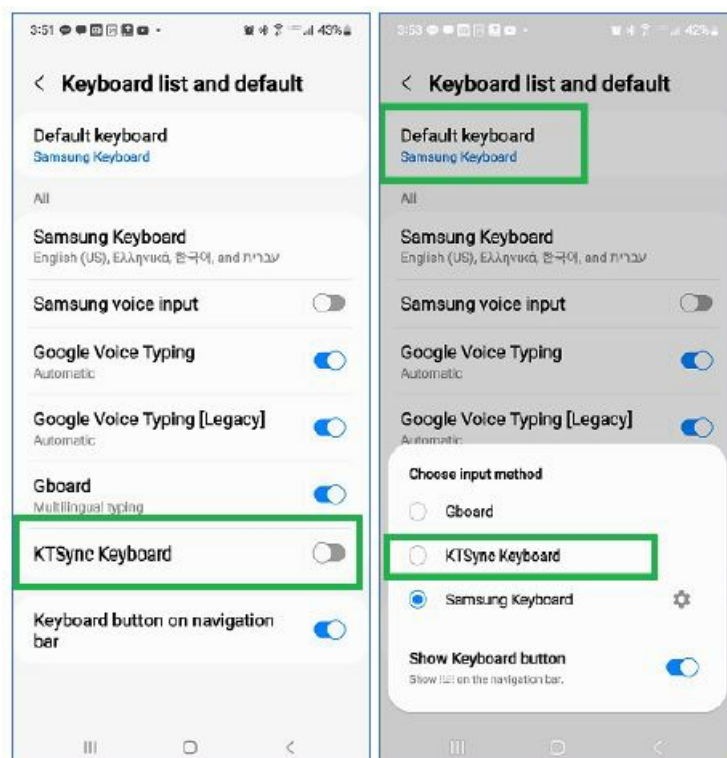

< Fig. 1 >

2. To switch back to the other keyboard, simply change the default keyboard again. Or, select keyboard button from the navigation bar and you can change the default keyboard from here. (Fig. 2)

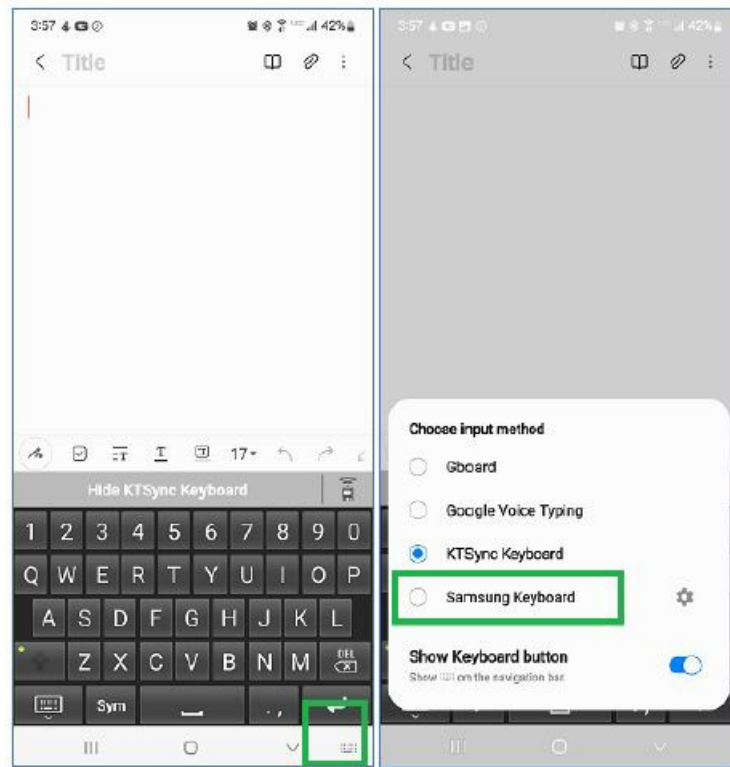

< Fig. 2 >

How to get the Activation Code for the Software Decoder (KDC8)

1. If you already purchased and used a (trial) license, skip this procedure, and use the license code. Otherwise, continue.
2. To use the software scanner, please purchase an activation code from <https://koamtacon.com/kdc8-software-decoder/>. Or you can obtain a 1-month free trial activation code from the same site.
3. To receive the activation code, please complete the signup process first.
4. Once you sign up and purchase the activation code per your plan (trial plan, monthly plan, yearly plan, or unlimited plan), the trial or purchased activation code will be sent to your email registered during sign-up. (Please do not lose the activation code.)

← → ↻ koamtacn.com/kdc8-software-decoder/ ☆

+1 609.256.4700 | koamtacn@koamtac.com | Sign Up | Sign In

KOAMTACON

KDC8 Software Decoder

Fast > Reliable > Accurate > Versatile
Collect barcode data using your smart device's built-in camera.

The KDC8 software decoder fills the gap between low-quality free barcode decoding software and professional-

Sign Up



Sign Up

All fields are mandatory, except site URL.

KDC Mobile Data Management Suite can be used after signing up as a member and after sending an administrator-approved email.

KDC8 Software Decoder

*User ID

ID DUPLICATION CHECK

- ID must be between 8 ~ 15 characters.
- ID can contain letters, numbers, or period.
- ID must contain at least one letter.
- ID is case-sensitive.

* Email

* Name

* Password



* Confirm Password

* Phone Number

* Company Name

URL of your site(optional)

-- * Select your country. --

SUBMIT

KTSync Demo Feature (Scan & Search)

Purpose

1. When you scan any barcode on any product or any logistics tracking package, the selected retail/logistics website pops up and shows the searched result or the tracking information.

➤ **How to test**

1. Enable Demo Mode (Settings → Other Settings → Check “Enable Demo”)
2. Select demo type (demo store): FedEx, UPS, DHL Global, DHL US, Amazon, Walmart, The Home Depot, Lowes. (Settings → Other Settings → Demo Type) And tap the “Home” icon at the right upper corner.

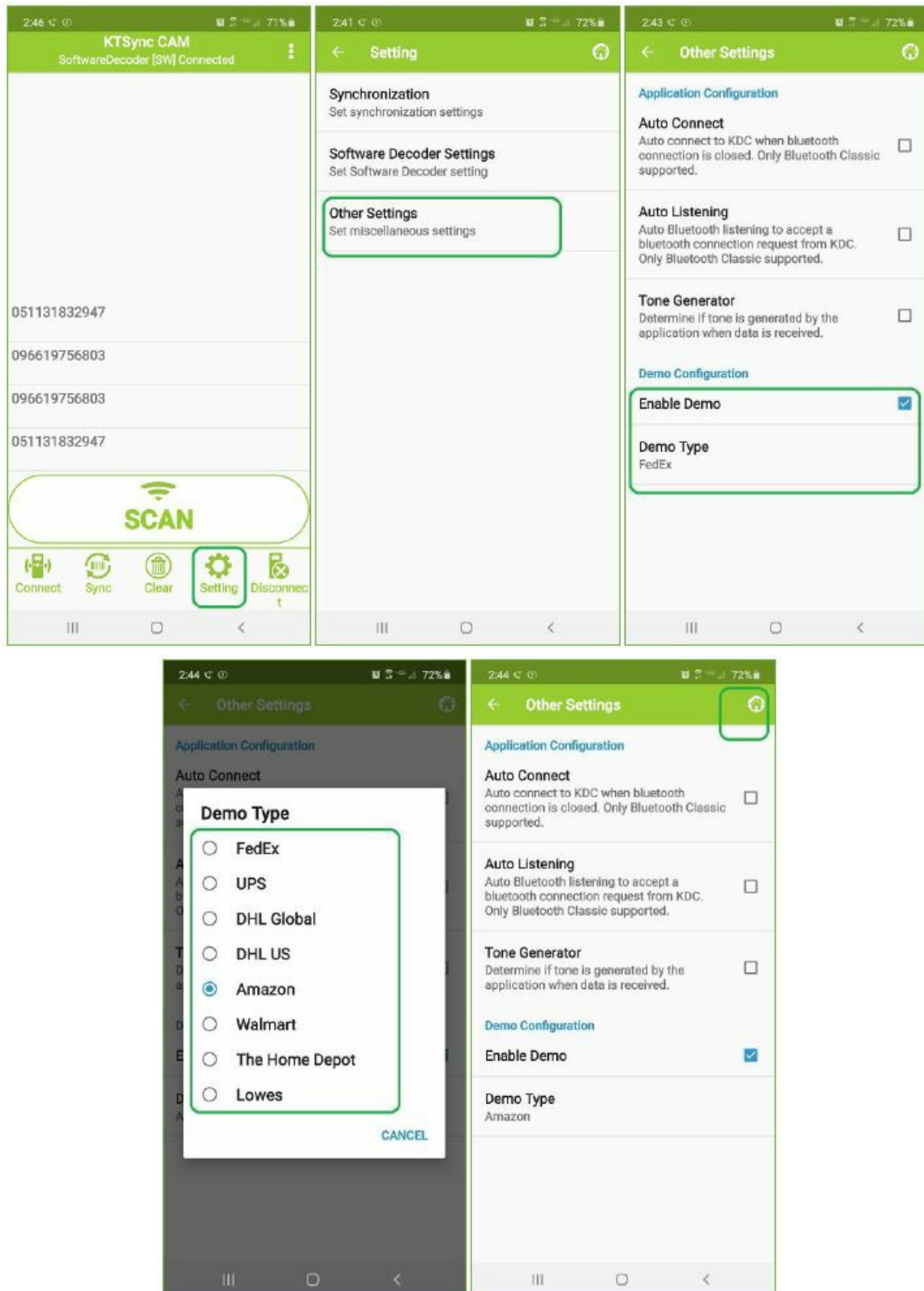

3. Now scan any barcode and the selected store website will pop up with a searched result.

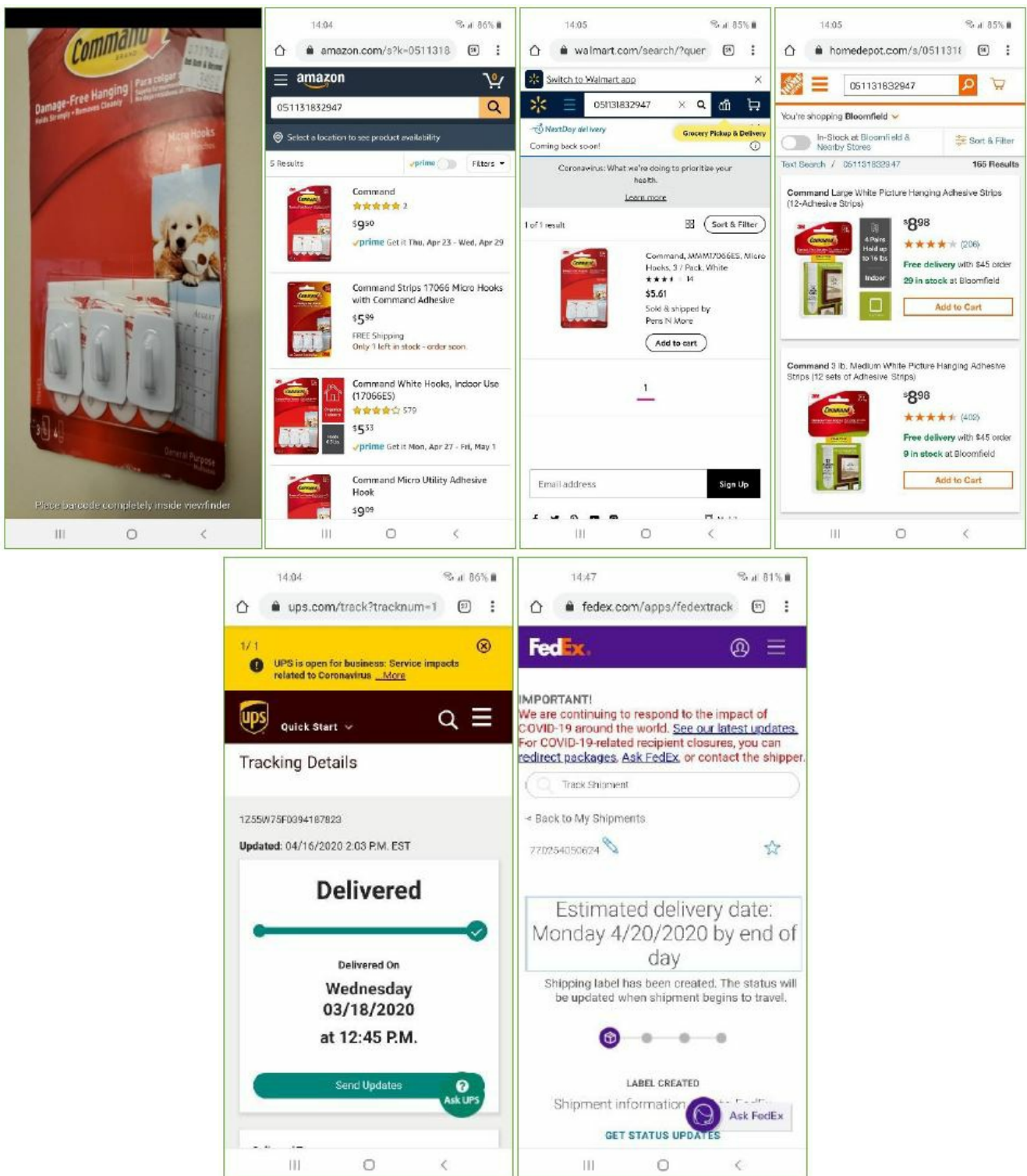

4. There are some example barcodes on the next page.

Sample Barcodes for Scan & Search Testing

- UPS



- FedEx



- Amazon/Walmart/Home Depot



CONTACT

- 116 Village Blvd, Suite 305, Princeton, NJ 08540 USA 14
- **T:** + 1-609-256-4700
- **F:** +1-609-228-4373
- info@koamtac.com.
- www.koamtac.com.

© 2020-2022 KOAMTAC, Inc. KTSync_Keyboard_Android_20220719

Documents / Resources

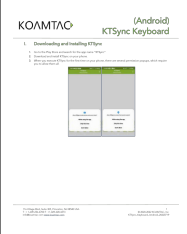
	KOAMTAC KTSync App for Keyboard [pdf] User Guide KTSync, App for Keyboard, KTSync App, App
---	---

References

- [▶ KOAMTAC Bluetooth Barcode Scanners, RFID Readers, and mPOS](#)
- [▶ KOAMTAC Bluetooth Barcode Scanners, RFID Readers, and mPOS](#)
- [K KDC8 Software Decoder | Collect Barcode Data with Your Phone or Tablet](#)
- [K KDC8 Software Decoder | Collect Barcode Data with Your Phone or Tablet](#)