



KNZ Retro 2 Wireless Speaker and Radio User Manual

[Home](#) » [KNZ](#) » KNZ Retro 2 Wireless Speaker and Radio User Manual 



RETRO²
Wireless Speaker and Radio
User Manual



Contents

[1 FRONT OF PRODUCT](#)

[2 CHARGING](#)

[3 BLUETOOTH MODE](#)

[4 PAIRING TWO RETRO2
SPEAKERS](#)

[5 REMOTE CONTROL](#)

[6 WARRANTY](#)

[7 Documents / Resources](#)

[8 Related Posts](#)

FRONT OF PRODUCT

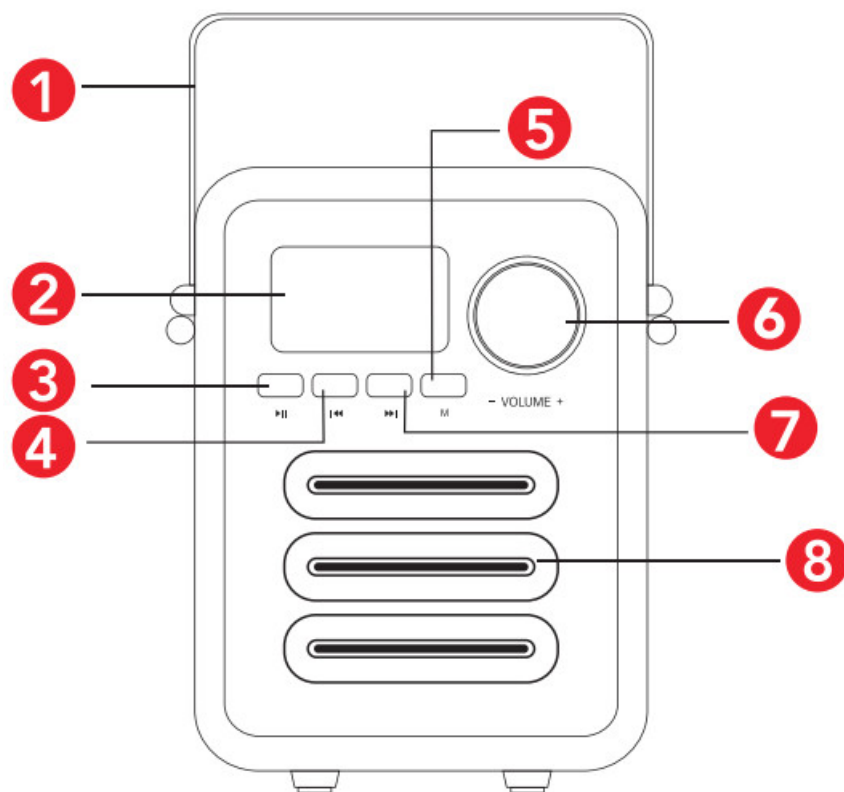

1. Handle Stripe
2. Display
3. Play/Pause
4. Last Song/Last Channel
5. Mode
6. Volume Control
7. Next Song/Next Channel
8. Speaker

BACK OF PRODUCT

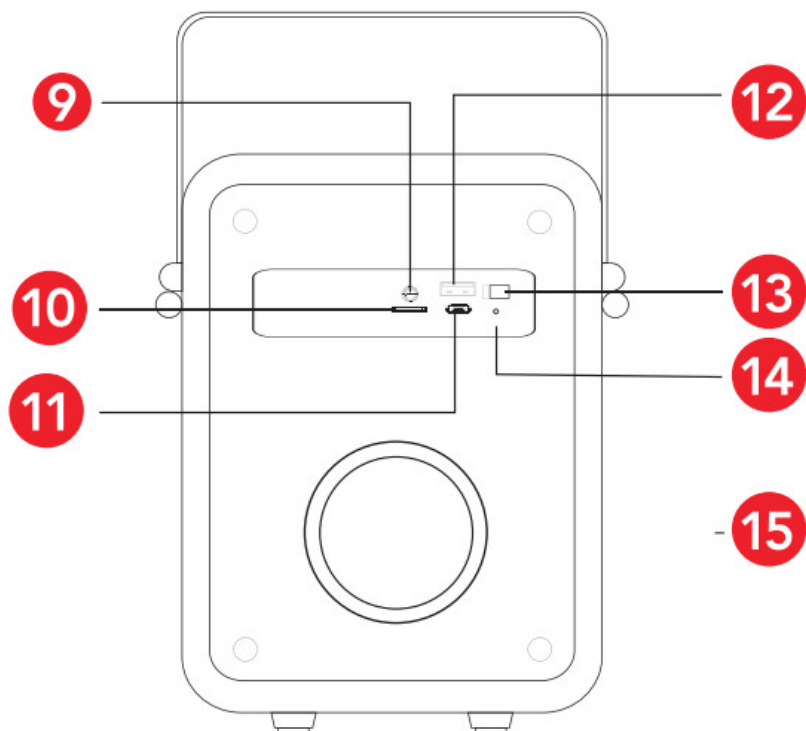

- 9. Aux Input
- 10. Micro SD Slot
- 11. Micro USB Charging Port
- 12. USB Port
- 13. Power On/Off
- 14. LED Indicator Light
- 15. Subwoofer

CHARGING

Use the charging cable included in package, connect the micro-USB end to RETRO' speaker, and connect the USB end to USB power source (wall charger, computer, portable battery, etc.) to charge the speaker. Before using, make sure the RETRO' speaker is fully charged. A solid red LED light indicates that the speaker is being charged, and it will turn off when the speaker is fully charged.

POWER ON/OFF

Switch the power button on the back of RETRO2 speaker to turn the power ON and OFF. To maximize battery life, switch power off when you are not using the RETRO' speaker.

BLUETOOTH MODE

After power on, RETRO' goes directly to Bluetooth mode if there is no external device connected to it, such as micro-SD card, AUX cable, or USB driver. If there are external devices connected to RETRO2, you will need to press the "M" button to switch to Bluetooth mode.

PAIRING

When RETRO' is in Bluetooth mode, turn on the Bluetooth settings of your phone, tablet or other Bluetooth enabled device, and search for Bluetooth devices. Locate "RETRO?" and connect to it. Once successfully paired, there will be a voice prompt indicating Bluetooth connection is set up and ready to use.

PAIRING TWO RETRO2 SPEAKERS

The true wireless capability of RETRO2 speaker support two such speakers to be connected as a stereo pair. To pair two RETRO2 speakers, follow below instructions.

1. Power on both speakers, and make sure they are both not connected to any other Bluetooth devices.
2. Double press the Play/Pause button (NI) on one speaker, and you will hear the voice prompt "Paired" when they are successfully connected.
3. Find "RETRO2" in your phone's Bluetooth settings list and connect to it.

To disconnect the two paired speakers, double press the Play/Pause button (▶||) on RETRO2 and it disconnects the two linked speakers.

HANDS FREE PHONE CALL

Press the Play/Pause (▶||) button to answer an incoming phone call. Press and hold the Play/Pause (▶||) button to reject an incoming phone call.

When the speaker is in Standby mode, press and hold the Play/Pause (▶||) button to redial the last number.

Select a song or playlist on your Bluetooth enabled device, Press Play/Pause (▶||) button to listen. Press Play/Pause (▶||) button again to PAUSE listening. Press the Fast Forward (▶||) button and Rewind (▶||) button to switch the song or playlist.

VOLUME CONTROL

Turn the Knob Clockwise for more volume and turn the other way to decrease the volume.

MICRO-SD/USB/AUX MODES

Insert Micro-SD card into the card slot on back of the speaker. Press the "M" button to switch to micro-SD mode to play. Plug USB drive to the USB port on back of the speaker, and press "M" button to switch to USB mode to play. Use the included AUX cable, connect one end to the AUX port on back of the speaker, and connect the other end to AUX supported phone, tablet or computer, then press "M" button to switch to AUX mode to play.

FM RADIO

Press the "M" button to switch to FM mode. Use USB cable or AUX cable to increase reception. The cable acts as an antenna. Press the Play/Pause (▶||) button to cycle through the entire FM band. The Radio will automatically preset all available stations. Then use the Fast Forward (▶||) button and Rewind (▶||) button to tune to those stations. The Radio has 20+ presets available depending on reception and area. Press M button to start or pause.

EQ PRESETS

EQ (Equalizer) is adjusted using the Remote Control. Choose the type of music to maximize listening pleasure.

The 6 EQ presets are:

- Normal (LED shows NOR)
- Classic (LED shows CLA)
- Country (LED shows CUT)
- Pop (LED shows POP)
- Jazz (LED shows JAZ)
- Rock (LED shows ROC)

REMOTE CONTROL

Before using, pull out the plastic tab (which is inserted in the battery slot) to activate the remote control. Remote control uses CR2025 battery.

FCC STATEMENT

This equipment has been tested and found to comply with the limits for a Class B digital device, pursuant to part 15 of the FCC Rules. These limits are designed to provide reasonable protection against harmful interference in a residential installation. This equipment generates uses and can radiate radio frequency energy and, if not installed and used in accordance with the instructions, may cause harmful interference to radio communications. However,

there is no guarantee that interference will not occur in a particular installation. If this equipment does cause harmful interference to radio or television reception, which can be determined by turning the equipment off and on, the user is encouraged to try to correct the interference by one or more of the following measures: (1) Reorient or relocate the receiving antenna. (2) Increase the separation between the equipment and receiver. (3) Connect the equipment into an outlet on a circuit different from that to which the receiver is connected. (4)Consult the dealer or an experienced radio/TV technician for help. This device complies with part 15 of the FCC Rules. Operation is subject to the following two conditions: (1) This device may not cause harmful interference, and (2) this device must accept any interference received, including interference that may cause undesired operation. Changes or modifications not expressly approved by the party responsible for compliance could void the user's authority to operate the equipment. For further inquiries please visit www.knztech.com/support.

WARRANTY

KNZ Technology LLC. warrants this product as free of defects in material, design, and workmanship for the period of one year from the original date of purchase. The warranty is limited to the original purchaser. If during the period of warranty this product proves defective under normal use and service, you should return the product to the retailer from whom it was purchased or to an authorized warranty center. The liability of KNZ Technology LLC. and its appointed repair company is limited to the cost of repair and/or replacement of the product under warranty. Products sent for warranty service must be accompanied by a copy of the original purchase receipt, the original box, materials, and accessories. All cost associated with the return of the product under warranty are the responsibility of the original purchaser. Shipping and Handling Fee will apply in order for KNZ Technology LLC. to ship out a new/refurbished product to a customer. KNZ Technology LLC. will not assume any responsibility for any loss or damage occurred in shipping.

KNZ is registered trademark of KNZ Technology LLC. All other trademarks are the property of their respective owners. Copyright 2021. All rights reserved. This product is not a toy. Contains small parts, not for children under 3 years.

Documents / Resources

	KNZ Retro 2 Wireless Speaker and Radio [pdf] User Manual Retro 2 Wireless Speaker and Radio, Retro 2, Wireless Speaker and Radio, Speaker and Radi o, Radio, Speaker
---	--