



KLIPSCH kO-R1 2 Way Multicell Loudspeaker Owner's Manual

[Home](#) » [Klipsch](#) » KLIPSCH kO-R1 2 Way Multicell Loudspeaker Owner's Manual 



kO-R1
2-WAY MULTICELLED LOUDSPEAKER
HAUT-PARLEUR MULTI-CELLULES 2 VOIES

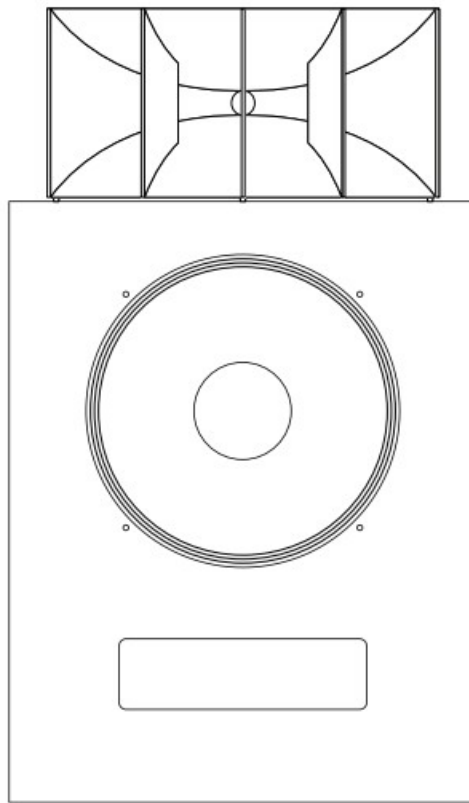

OWNER'S MANUAL

Contents

- 1 UNPACKING AND ASSEMBLY
- 2 PLACEMENT
- 3 HORN ASSEMBLY
- 4 CONNECTIONS
- 5 IMPORTANT SAFETY INSTRUCTIONS
- 6 INSPECTION
- 7 ABOUT YOUR KLIPSCH PURCHASE
- 8 Documents / Resources
 - 8.1 References

UNPACKING AND ASSEMBLY

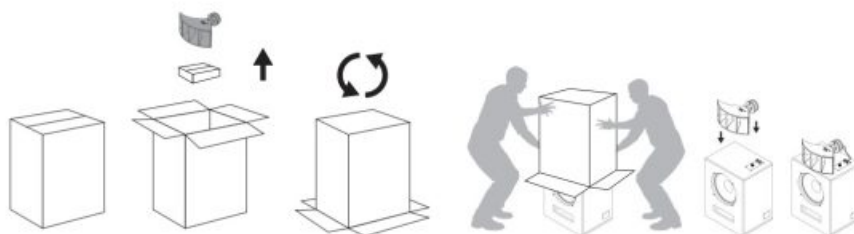

PLACEMENT

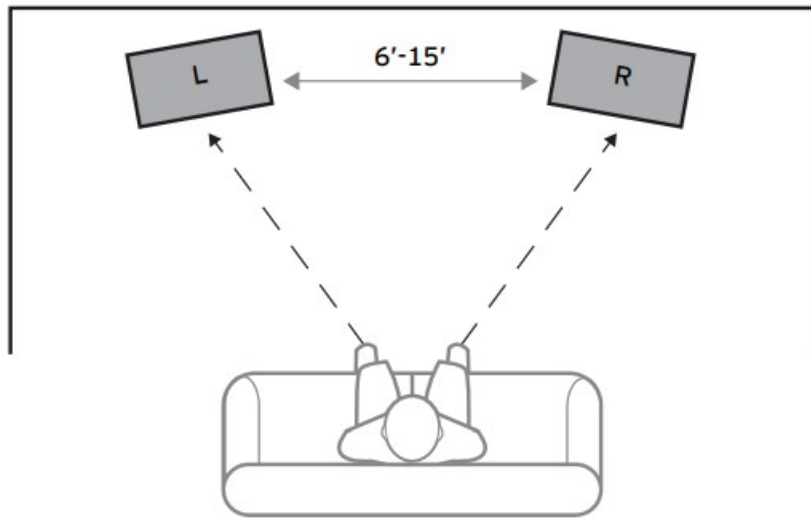

Your KO-R1 loudspeakers will perform well in a variety of locations but best results will be achieved using the following general guidelines:

- Place on a common wall 6 to 15 feet apart.
- Position them equidistant from the wall behind the speakers.
- Leave at least 12" between the wall and the back of the speaker.
- Angle speakers toward the listener and even with or forward of any adjacent obstructions.
- Placing them near a corner or wall provides the greatest amount of bass while moving the speakers away from room boundaries reduces bass energy.
- Asymmetrical placement of a pair of speakers from adjacent side walls can smooth room-induced bass unevenness.
- Experiment with the above guidelines to suit your taste and to compensate for your room's acoustic characteristics.
- Self-stick rubber pads are supplied for attachment to the bottom of the riser for use on hard floors.

HORN ASSEMBLY

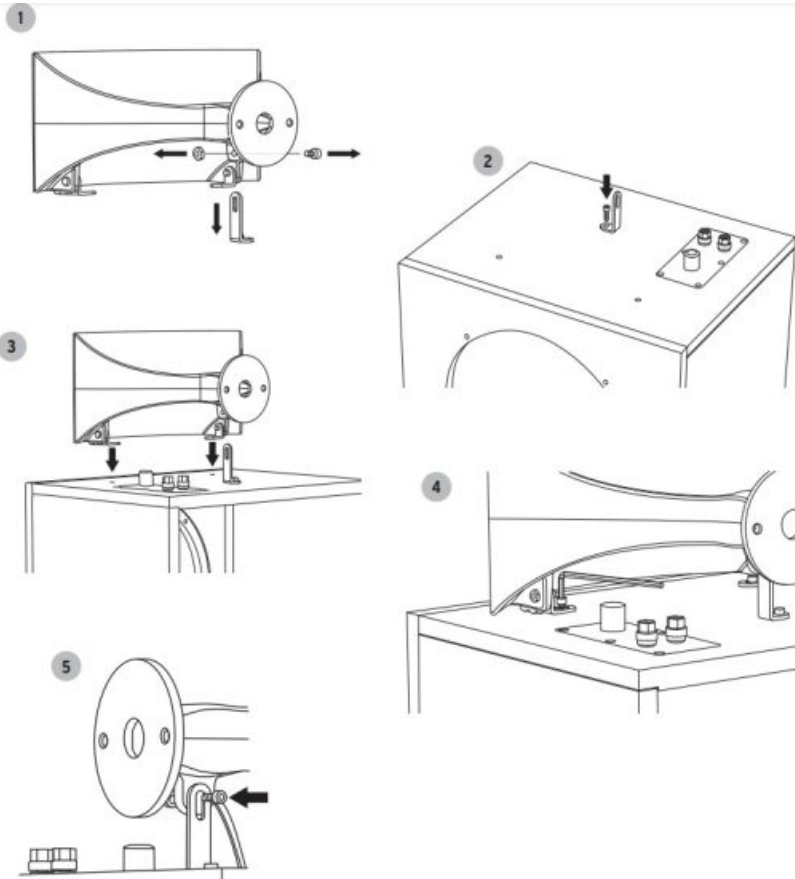

CONNECTIONS

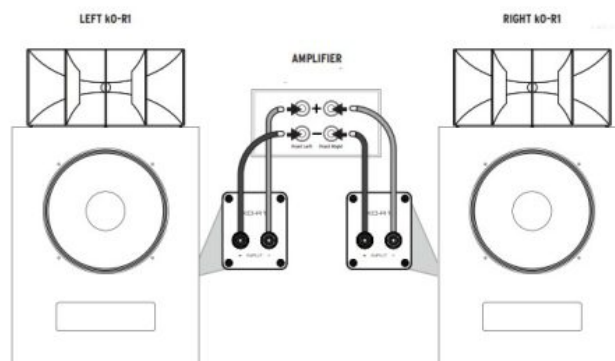
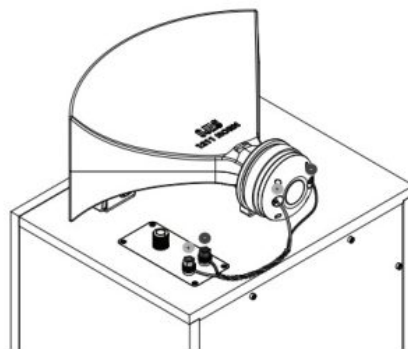

! HAND TIGHTEN ONLY, MAY INCUR DAMAGE IF TOOL IS USED

IMPORTANT SAFETY INSTRUCTIONS

1. READ these instructions.

2. KEEP these instructions.
3. HEED all warnings.
4. FOLLOW all instructions.
5. DO NOT use this apparatus near water.
6. CLEAN ONLY with dry cloth.
7. DO NOT block any ventilation openings. Install in accordance with the manufacturer's instructions.
8. DO NOT install near any heat sources such as radiators, heat registers, stoves, or other apparatus (including amplifiers) that produce heat.
9. ONLY USE attachments/accessories specified by the manufacturer.
10.  USE only with a cart, stand, tripod, bracket, or table specified by the manufacturer, or sold with the apparatus. When a cart is used, use caution when moving the cart/ apparatus combination to avoid injury from tip-over.
11. REFER all servicing to qualified service personnel. Servicing is required when the apparatus has been damaged in any way, such as power-supply cord or plug is damaged, liquid has been spilled or objects have fallen into the apparatus, the apparatus has been exposed to rain or moisture, does not operate normally, or has been dropped.



This symbol indicates that there are important operating and maintenance instructions in the literature accompanying this unit

WARNING: To reduce the risk of fire or electrical shock, do not expose this apparatus to rain or moisture.

WARNING: No user-serviceable parts inside. Refer all servicing to qualified service personnel.

INSPECTION

We want your new speaker system to look as good as it did leaving the factory! Please check promptly for any transit damage. Carefully unpack your new speaker system and verify the components against the packing list. In extreme circumstances, items may have become damaged in transit. If any damage is discovered, notify the delivery service and dealer where the system was purchased. Make a request for inspection, and follow their instructions for evaluation. Be sure to keep the product's original shipping carton.

ABOUT YOUR KLIPSCH PURCHASE

Thank you for your purchase of Klipsch Heritage loudspeakers. After reading this manual and connecting your system, you will hear the result of over 70 years of stringent engineering and class-leading research and development. Like all Klipsch products, your loudspeakers feature Klipsch Horn-loaded Technology—the guiding design for the first Klipschorn® developed in 1946 and for every Klipsch product that has followed. Horn-loading allows your speakers to deliver very high sensitivity, wide dynamic range, low distortion, controlled dispersion and flat frequency response. This translates to unequalled power, detail and dynamics, the hallmarks of “The Klipsch Sound.” Again, thank you for choosing Klipsch and we hope that your speakers bring life to your music and movies for many years.



Klipsch

©2024 PREMIUM AUDIO COMPANY, LLC, A WHOLLY-OWNED SUBSIDIARY OF VOXX INTERNATIONAL CORPORATION. KLIPSCH GROUP, INC. IS A WHOLLY OWNED SUBSIDIARY OF VOXX INTERNATIONAL CORPORATION. KLIPSCH IS A TRADEMARK REGISTERED IN THE USA AND OTHER COUNTRIES, AND IS OWNED BY KLIPSCH GROUP, INC.



Documents / Resources



[KLIPSCH kO-R1 2 Way Multicell Loudspeaker](#) [pdf] Owner's Manual
kO-R1 2 Way Multicell Loudspeaker, kO-R1, 2 Way Multicell Loudspeaker, Multicell Loudspeaker, Loudspeaker

References

- [User Manual](#)

[Manuals+](#), [Privacy Policy](#)

This website is an independent publication and is neither affiliated with nor endorsed by any of the trademark owners. The "Bluetooth®" word mark and logos are registered trademarks owned by Bluetooth SIG, Inc. The "Wi-Fi®" word mark and logos are registered trademarks owned by the Wi-Fi Alliance. Any use of these marks on this website does not imply any affiliation with or endorsement.