

Klipsch

**Flexus
Core 200
Sound
Bar**



Klipsch Flexus Core 200 Sound Bar Owner's Manual

[Home](#) » [Klipsch](#) » Klipsch Flexus Core 200 Sound Bar Owner's Manual 

Contents

- 1 Klipsch Flexus Core 200 Sound Bar
- 2 Product Specifications
- 3 Product Usage Instructions
- 4 KLIPSCH CONNECT PLUS APP
- 5 ADD TO YOUR SYSTEM
- 6 INSIDE
- 7 SOUNDBAR CONTROLS
- 8 SOUNDBAR INPUT/OUTPUT
- 9 DIRECT WALL MOUNTING
- 10 CONNECTING TO POWER
- 11 CONNECTING WIRED SUBWOOFER
- 12 LED BRIGHTNESS
- 13 FLEXUS REMOTE
- 14 CONNECTIONS
- 15 TURN OFF TV SPEAKERS
- 16 ADJUSTING BASS LEVEL
- 17 SURROUND LEVEL ADJUSTMENT
- 18 NIGHT MODE
- 19 DIALOGUE MODE
- 20 BLUETOOTH® PAIRING MODE
- 21 FACTORY RESET
- 22 DECODING AND PLAYBACK MODES
- 23 LED DISPLAY
- 24 POWER CONSUMPTION
- 25 TRADEMARK
- 26 IMPORTANT SAFETY INSTRUCTIONS
- 27 EU COMPLIANCE INFORMATION
- 28 WE NOTICE
- 29 FCC AND CANADA EMC COMPLIANCE INFORMATION
- 30 WIRELESS TRANSMITTER COMPLIANCE INFORMATION
- 31 WARRANTY – U.S.
- 32 Frequently Asked Questions (FAQ)
- 33 Documents / Resources
 - 33.1 References
- 34 Related Posts



Klipsch Flexus Core 200 Sound Bar



Product Specifications

- **Model:** Flexus Core 200
- **Sound Bar Controls:** Virtual Remote, Equalizer, Channel Control
- **Input/Output:** Power, Sub Out, IR, Optical, HDMI eARC, USB-C
- **LED Brightness:** Low, High, Dim Off after inactivity, Bright Off after inactivity

Product Usage Instructions

Adding Components

The Flexus Sound System allows for expansion by adding up to two wireless subwoofers and two wireless surround speakers for a complete home theater setup. Visit klipsch.com/flexus-get-started for more information.

Wall Mounting

Use the included wall mount template and hardware to securely mount the soundbar. Ensure proper alignment and attachment for optimal performance.

Sound Bar Controls

- **On / Off:** Power the sound bar on or off.
- **Volume Up/Down:** Adjust the volume levels accordingly.
- **Source Select:** Toggle between different input sources.

Connecting to Power

Connect the power cord to a power source to supply electricity to the sound bar for operation.

Connecting Wired Subwoofer

If using wired subwoofers like Flexus Sub 100 or Sub 200, connect them to the designated Sub Out or LFE In ports on the sound bar for enhanced bass output.

LED Brightness Control

Adjust the LED brightness settings based on preference using the provided controls to suit different lighting

conditions.

Flexus Remote 100

The remote control allows for various functions including sound mode selection, dialog boost adjustments, night mode activation, and surround level control.

KLIPSCH CONNECT PLUS APP

Scan the QR code for enhanced functionality.

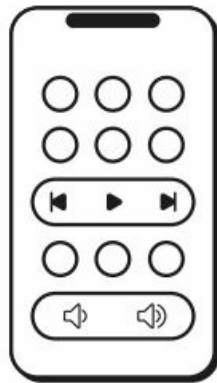

VIRTUAL REMOTE

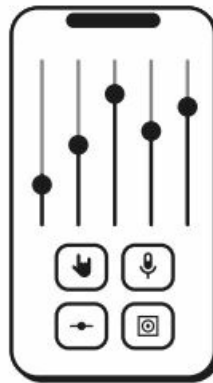

EQUALIZER

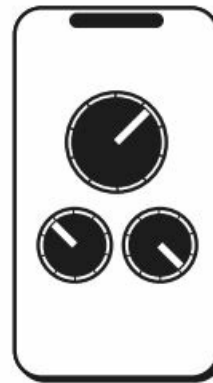

CHANNEL CONTROL



SUPPORT

ADD TO YOUR SYSTEM

Flexus Sound System is built to grow with you. Add up to two wireless subwoofers and two wireless surround speakers to create a home theater.

For more information, please visit: klipsch.com/flexus-get-started

SUB 100

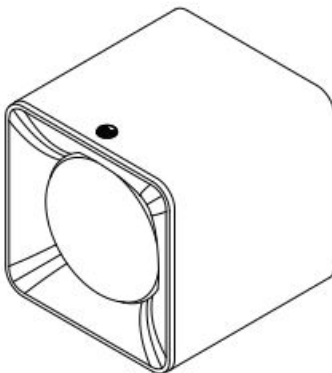

SUB 200

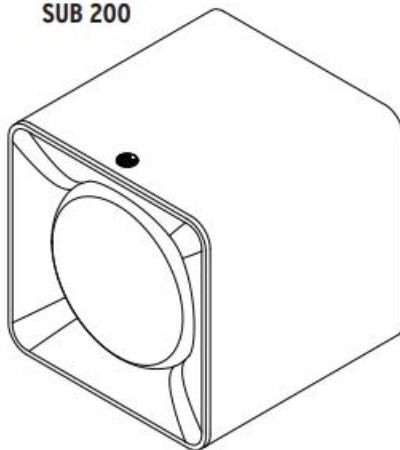

SURR 100



SURR 200



INSIDE



Sound Bar



Wall-Mount Template



Flexus
Remote
100



Wall Mount Brackets (2)



Wrench



Wall Mount
Screws (2)



Power Cord



HDMI Cable

SOUNDBAR CONTROLS

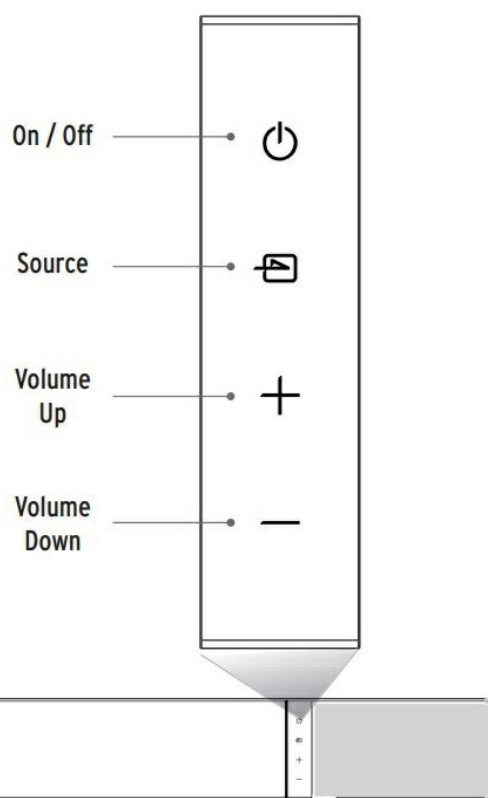

SOUNDBAR INPUT/OUTPUT

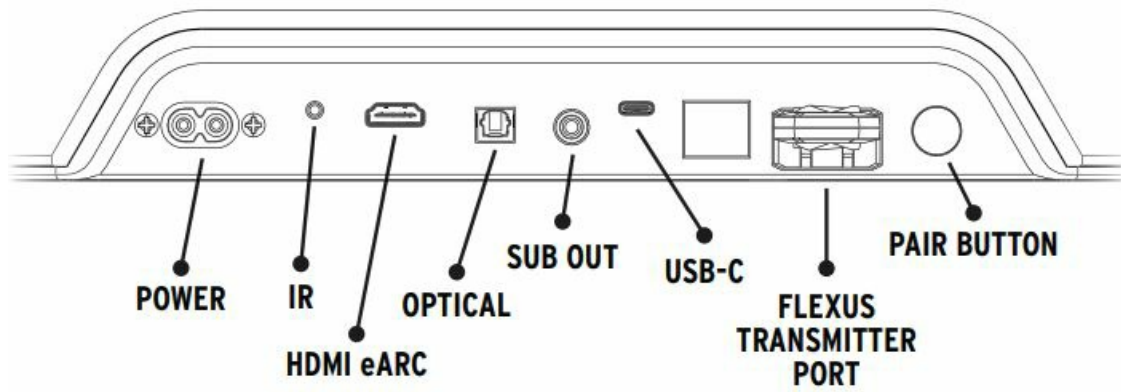

DIRECT WALL MOUNTING

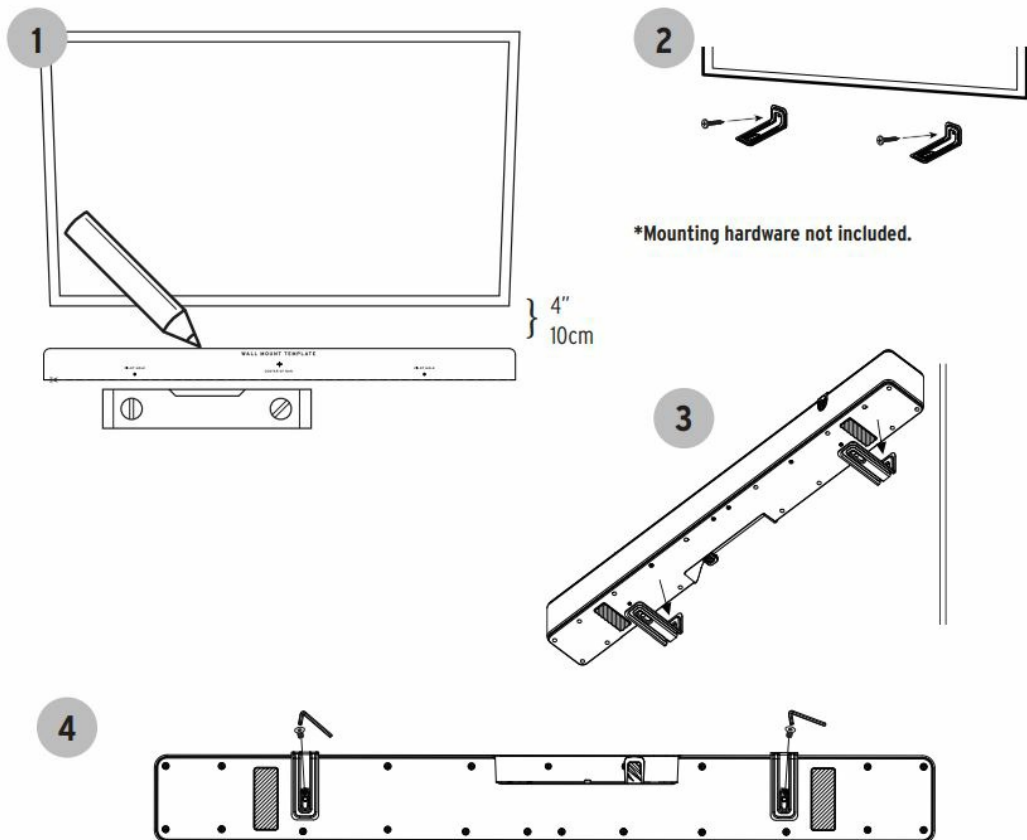

CONNECTING TO POWER

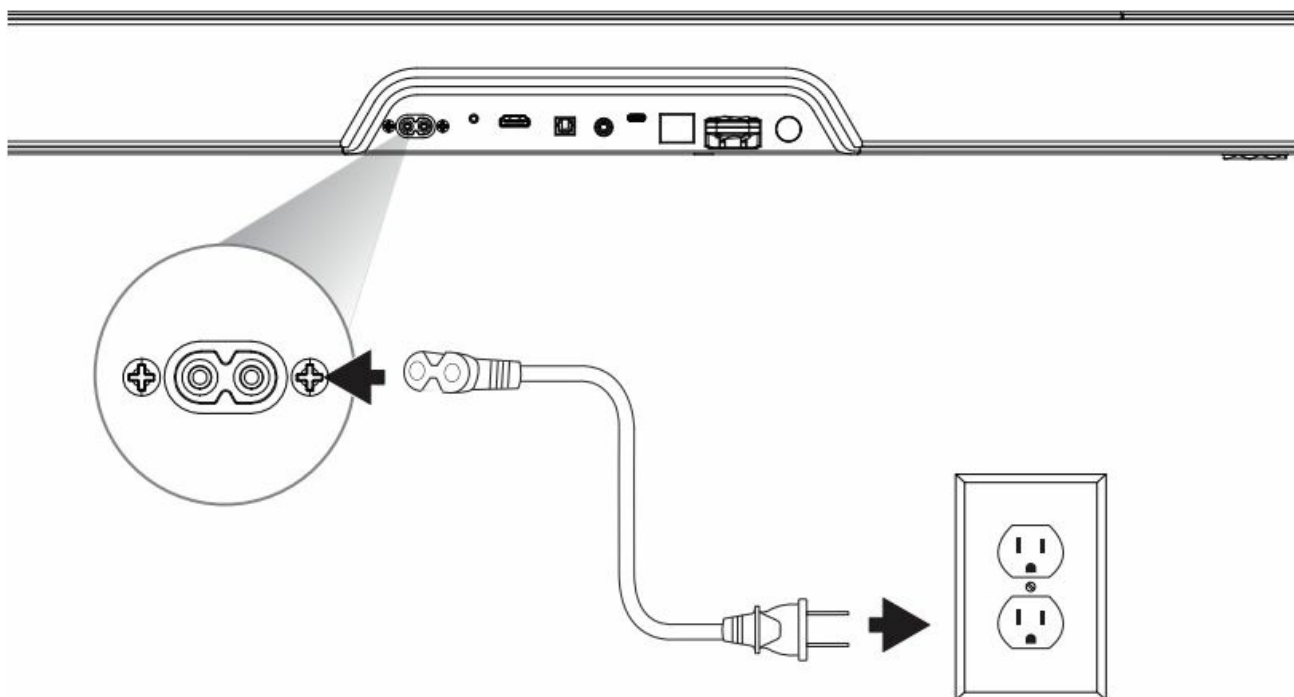

CONNECTING WIRED SUBWOOFER

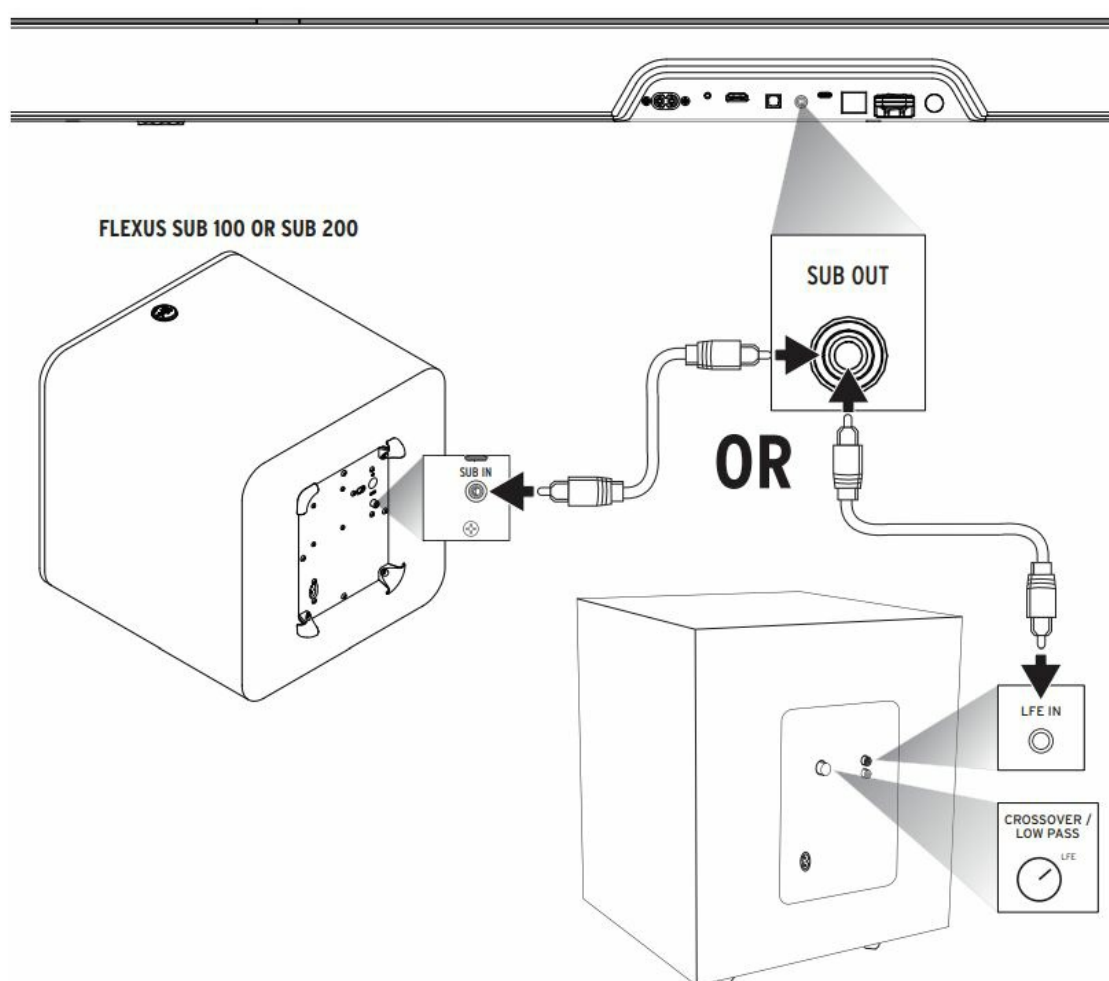

LED BRIGHTNESS

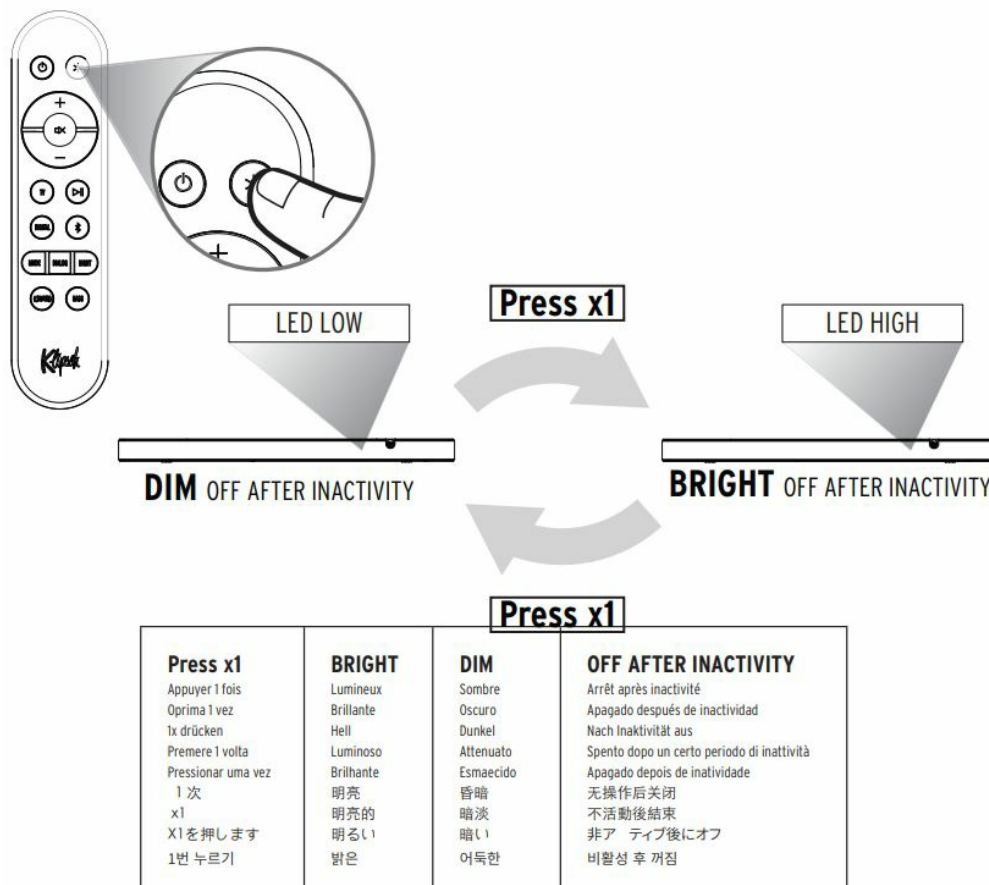

FLEXUS REMOTE

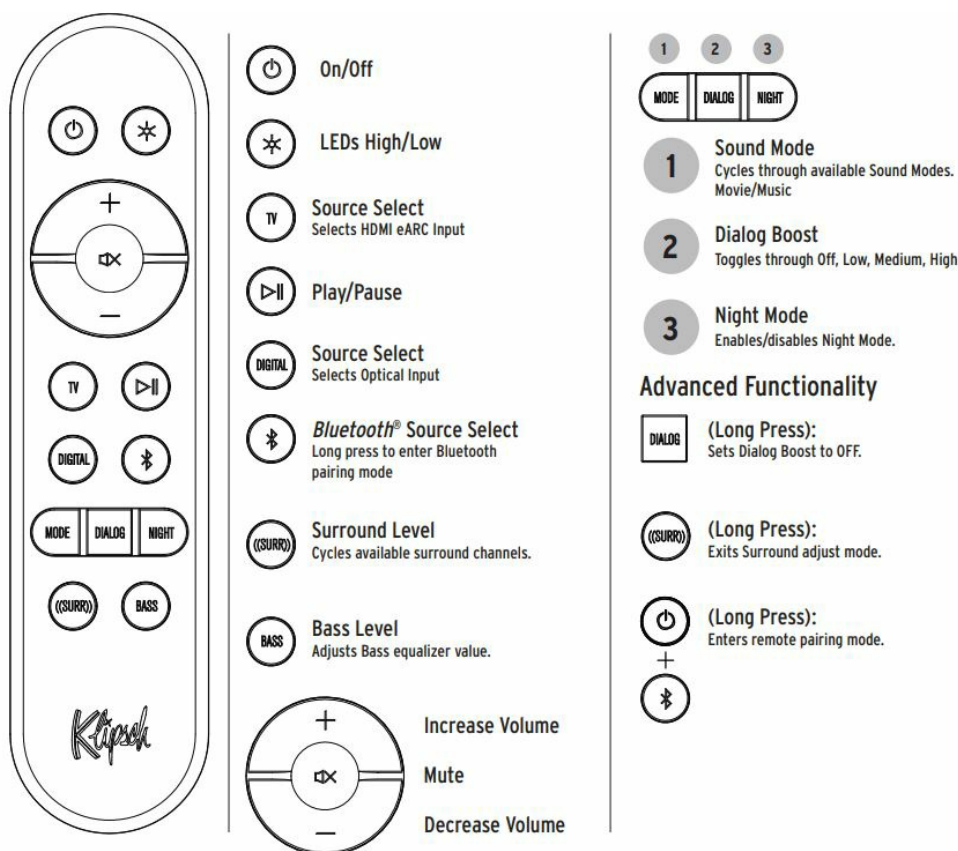

CONNECTIONS

HDMI eARC

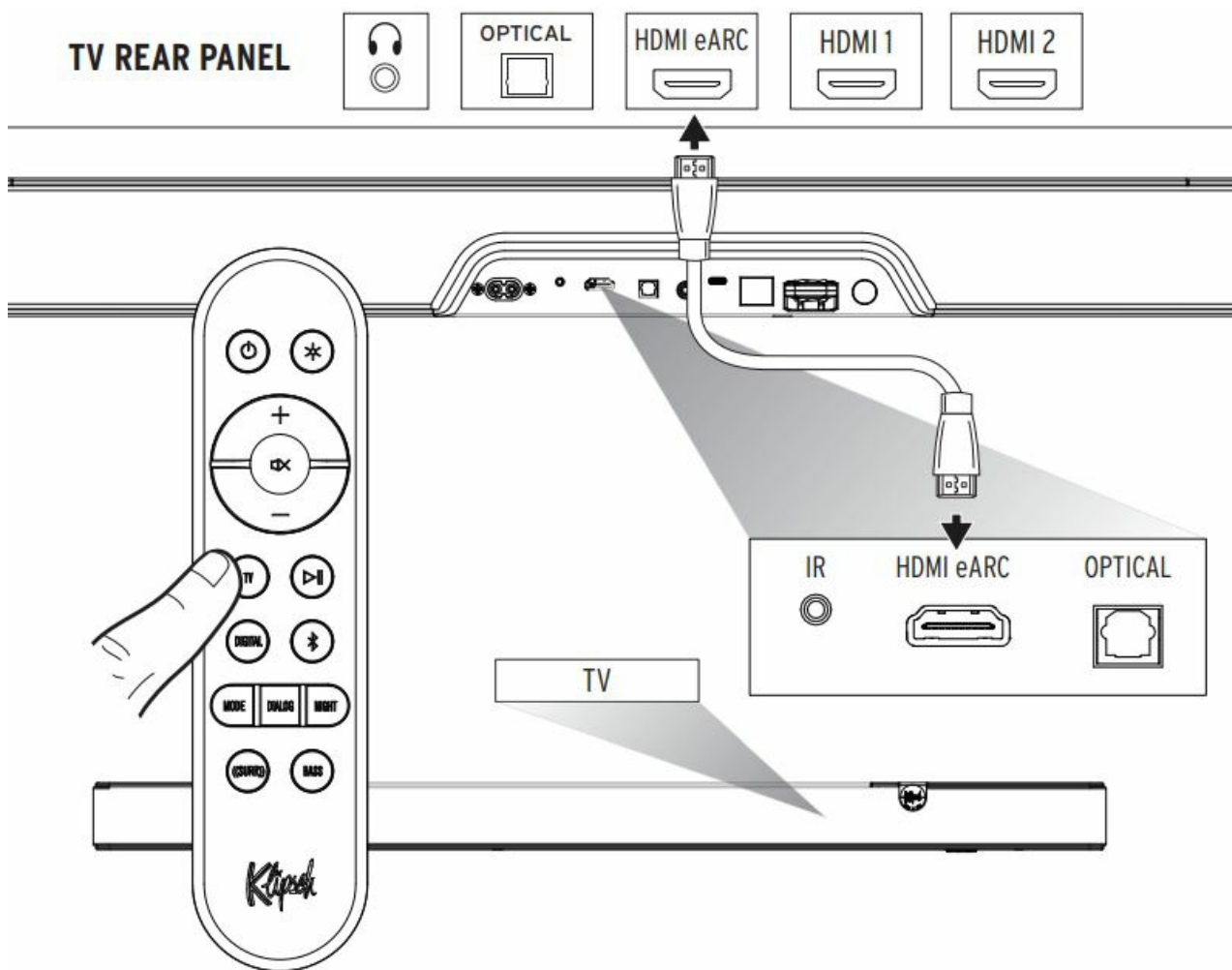

DIGITAL OPTICAL

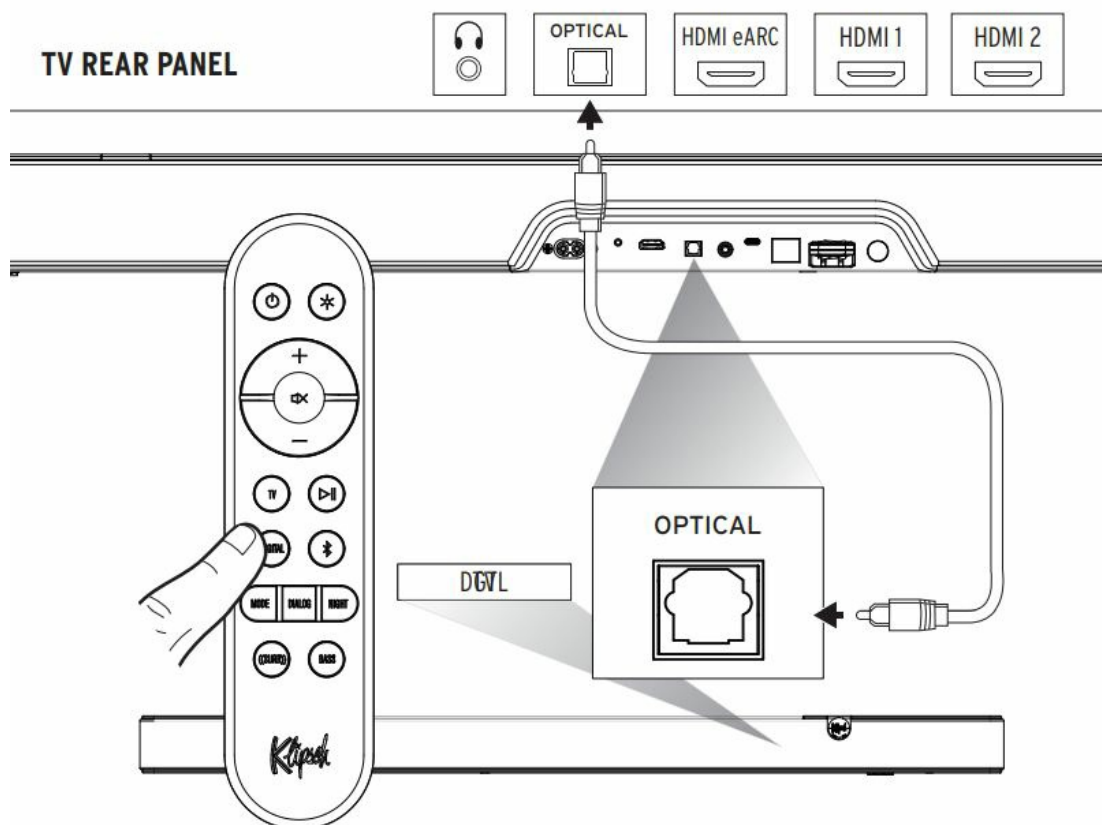

EXTERNAL HDMI SOURCE THROUGH TV

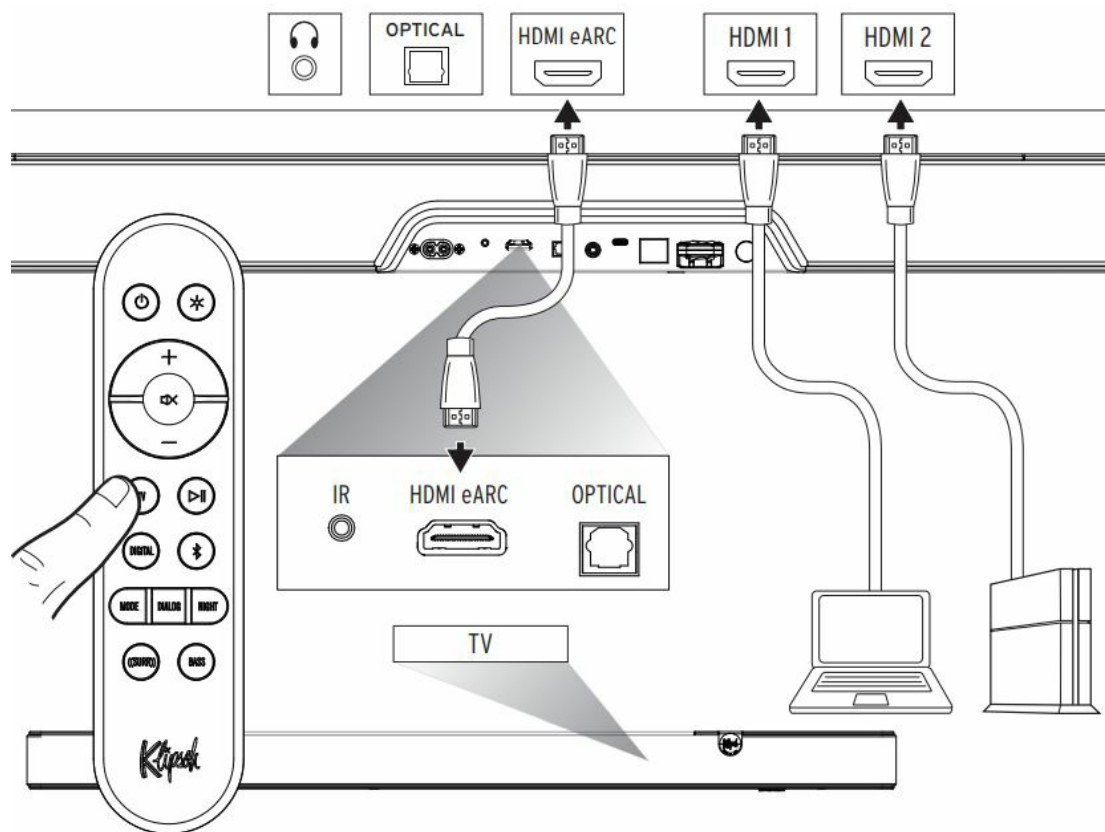

Use this connection method when using external HDMI sources (Streaming boxes, Blu-Ray Players, gaming consoles, etc) to play audio/video content, and want to use TV as the source switch.

Note: This connection method will only support Dolby Atmos playback if your TV supports HDMI eARC. Check your TV owner's manual for compatibility. Dolby Atmos playback also requires Dolby Atmos content and Dolby Atmos-compatible playback hardware.

EXTERNAL AUDIO VIA DIGITAL OPTICAL

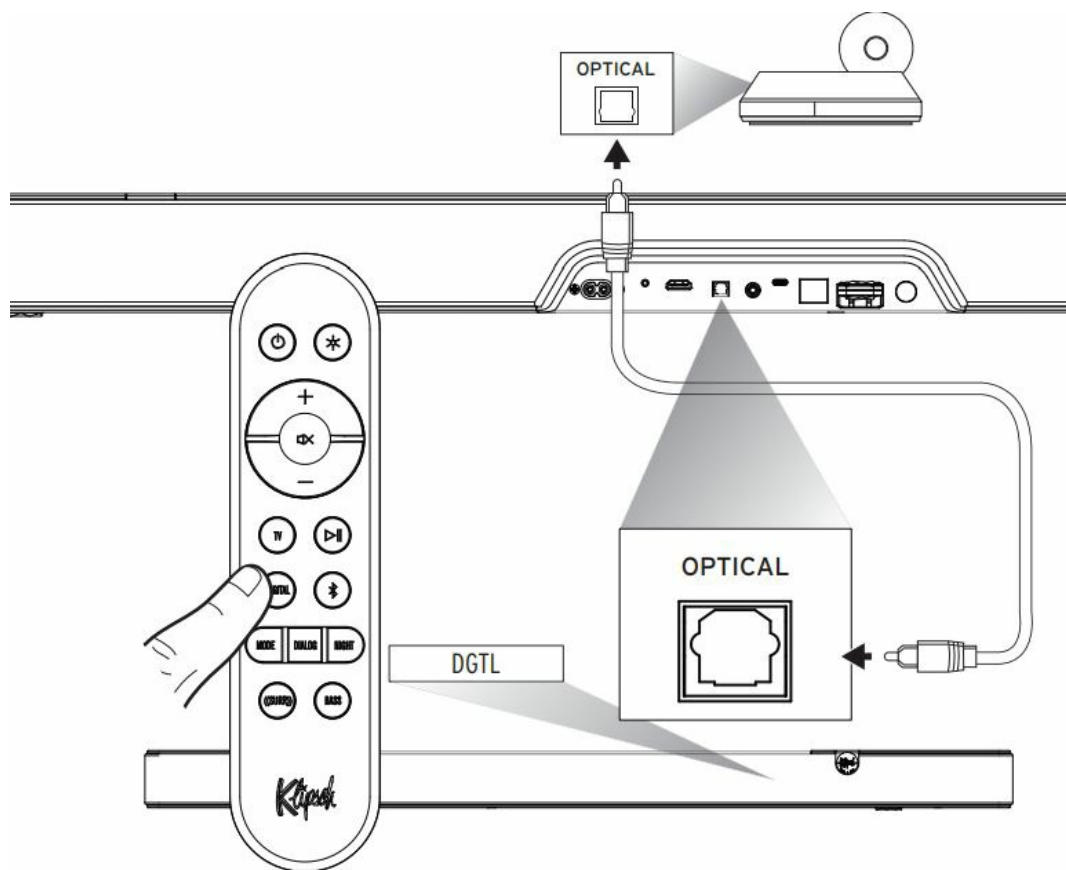

Use this connection method when connecting audio sources with a digital optical output, such as CD Players, PC audio servers, or streaming audio players.

Note: Digital connection only supports Dolby Audio-Dolby Digital Decoding, not Dolby Atmos.

TURN OFF TV SPEAKERS



OR



OR

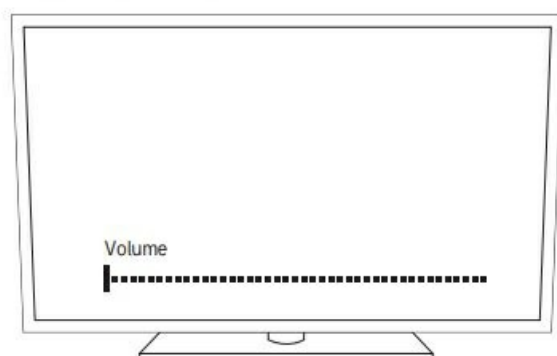

ADJUSTING BASS LEVEL

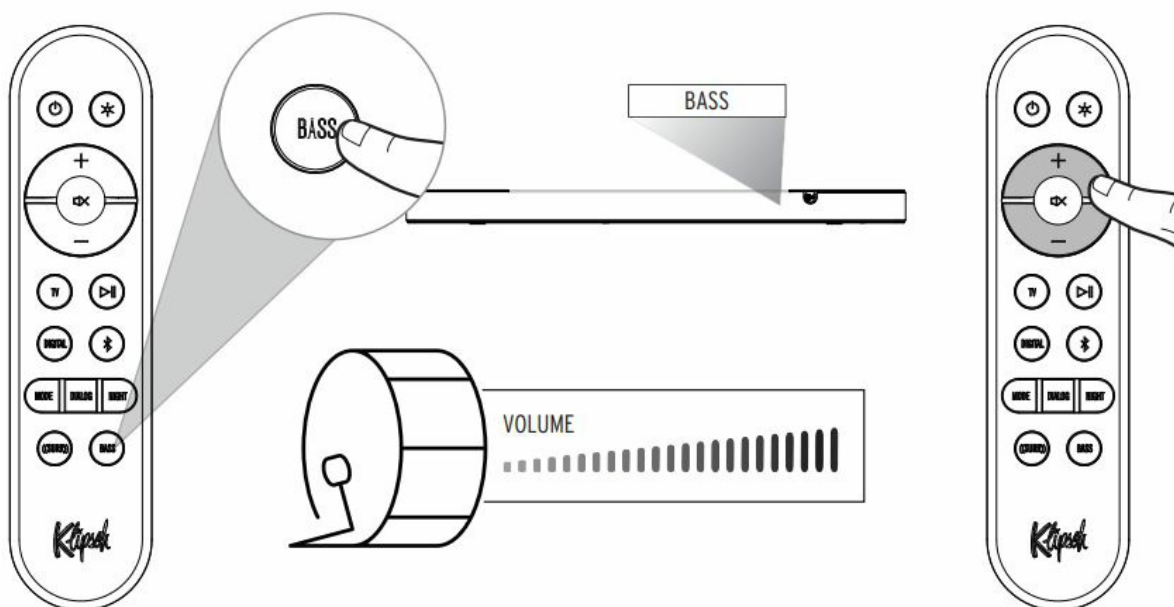

SURROUND LEVEL ADJUSTMENT

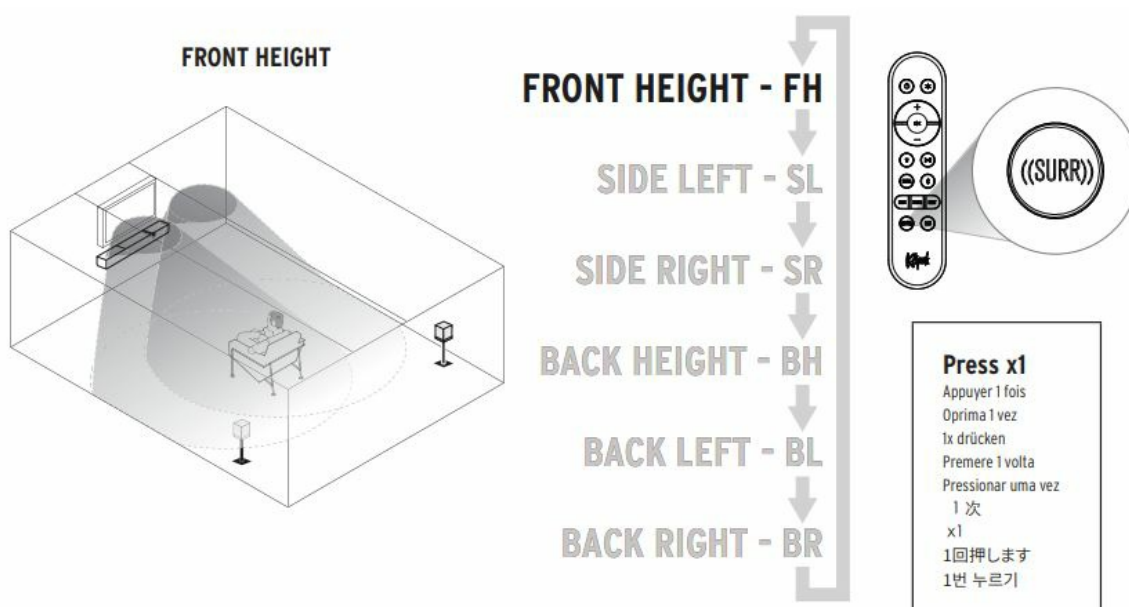

NIGHT MODE

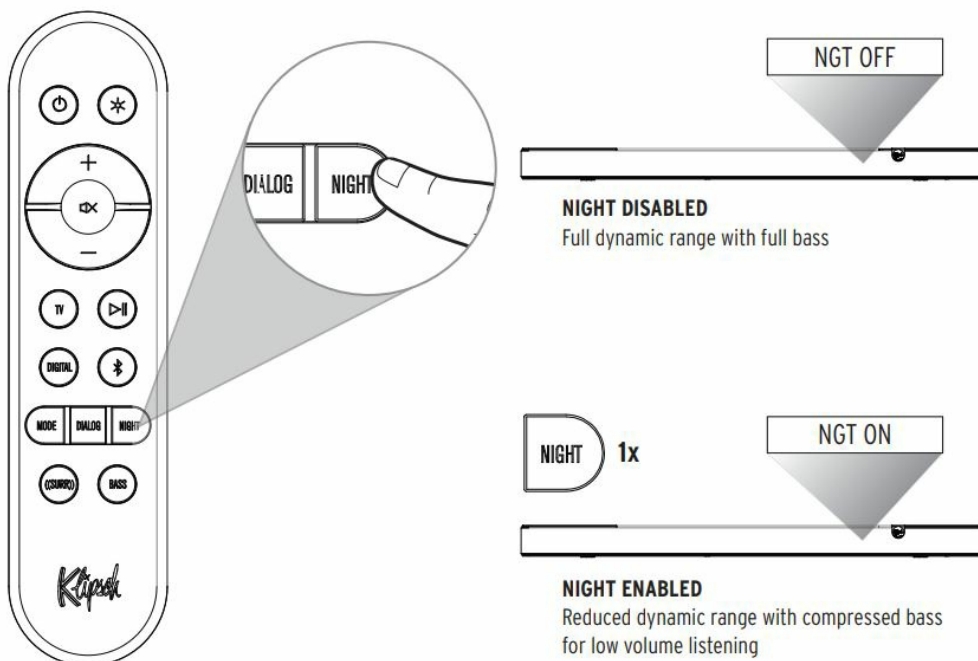

DIALOGUE MODE

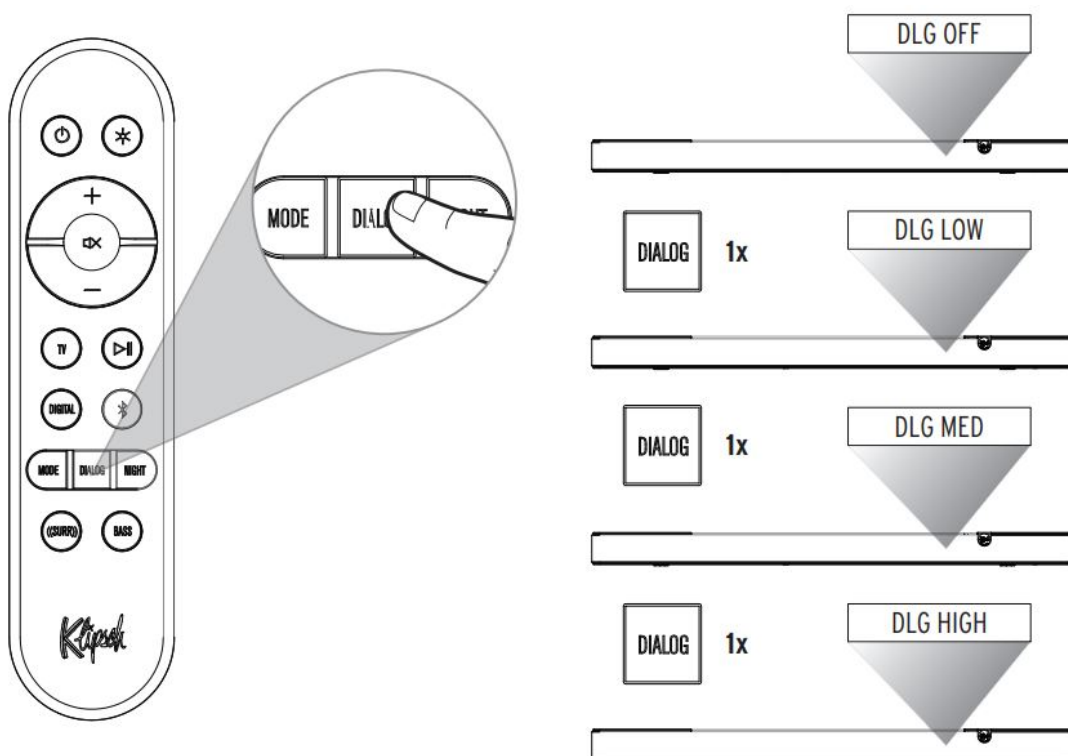

BLUETOOTH® PAIRING MODE

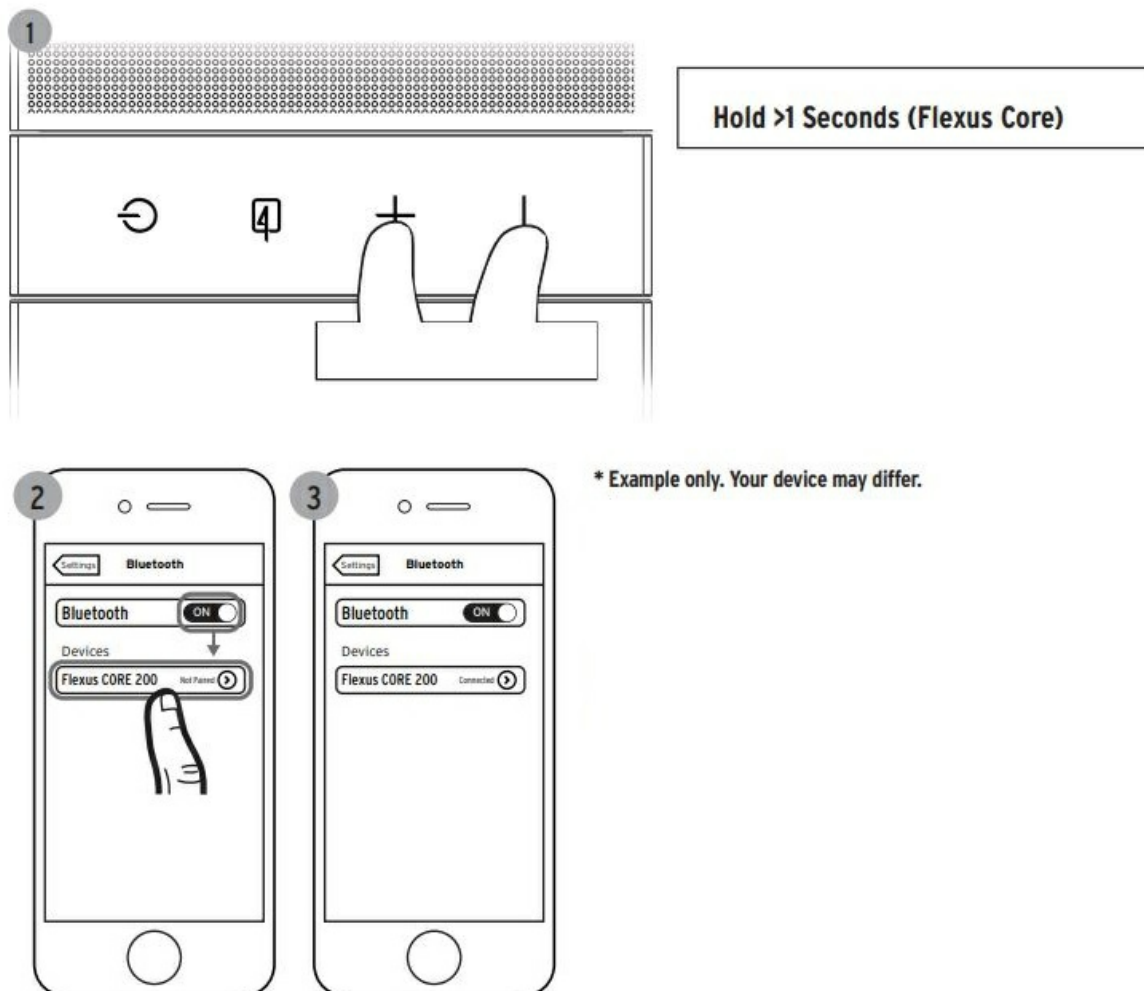

FACTORY RESET

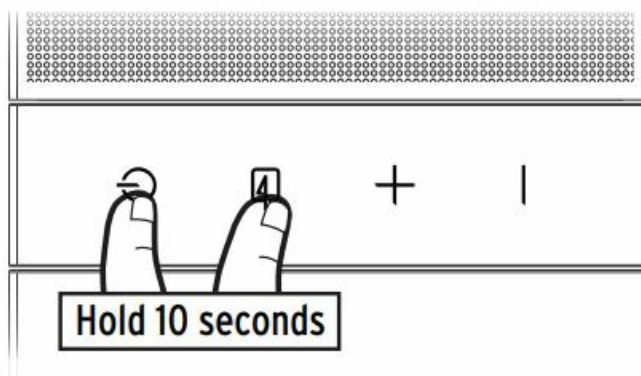

Clears Bluetooth ® pairing history and user-programmed IR commands

DECODING AND PLAYBACK MODES

INCOMING DIGITAL AUDIO SIGNALS THE FLEXUS CORE 200 WILL DECODE	PCM
	LPCM Up to 8 Channels
	Dolby Audio-Dolby Digital (2.0, 5.1, Etc.)
	Dolby Audio-Dolby Digital Plus (2.0, 5.1, 7.1, Etc.)
	Dolby TrueHD
	Dolby Atmos

Flexus Core 200 comes equipped with several user-selectable playback modes. Depending on which playback mode the user has selected, the system will decode the surround sound signal. The following chart shows which playback modes will result in which type of surround sound from the system, along with the recommended uses for each mode. For more information on decoding and TV compatibility, visit support.klipsch.com

USER SELECTED INPUT MODE	OUTPUT FORMAT	RECOMMENDED FOR:
MOVIE (DEFAULT)	Dolby Atmos mixed to 5.1.4	The most immersive and complete system tuning for everyday use. Perfect for shows and movies, Movie mode mixes all signals into all available channels and virtualizes a wide soundstage. Movie mode boosts surround effects and increases dialog clarity.
MUSIC	Dolby Atmos mixed to 5.1.4	Optimized to keep music sounding like the artist intended, Music mode disables virtualization, dialog enhancement, and boosted surround experience while maintaining upmixing stereo sources to all available channels.

LED DISPLAY

	DISPLAY	BAR STATUS
INPUTS	BT	Bluetooth Input Selected
	DIGITAL	Digital (Optical) input Selected
	TV	HDMI-eARC input Selected
	USB	USB Thumb Drive Input
SOUND	MOVIE (Default)	Movie Mode ON
MODES	MUSIC	Music Mode ON
	DLG OFF	Dialog Boost Off
DIALOG	DLG LOW	Dialog Boost Low
MODE	DLG MED	Dialog Boost Medium
	DLG HIGH	Dialog Boost High
NIGHT	NGT OFF	Night Mode OFF
MODE	NGT ON	Night Mode ON

LEVEL ADJUST	[SOURCE] XX	System Volume Setting [0] – [50]
	MUTE	System Muted / Volume Set To Minimum
	[SOURCE] MAX	System Volume Set To Max
	BASS [XX]	Bass equalizer volume [-6] – [+6]
CEC TOGGLE	CEC [XXX]	CEC Protocol Turned [On] or [Off]
DECODING	DOLBY SURROUND	Dolby Audio (supporting Dolby Digital, Dolby Digital Plus, Dolby TrueHD)
	DOLBY ATMOS	Dolby Atmos Input
	PCM	PCM or LPCM Input
OTHER	BT PAIRING	Pairing Bluetooth
	BT PAIRED	Bluetooth Paired
	LED HI	LED high brightness
	LED LOW	LED low brightness

POWER CONSUMPTION

INFORMATION OF POWER CONSUMPTION	
STANDBY MODE	Power consumption is lower than 0.5W in this mode.
BLUETOOTH MODE	In this mode, when there is no signal output, the idle power consumption is lower than 0.5W after 15 minutes.
HDMI MODE	In this mode, when there is no signal output, the idle power consumption is lower than 0.5W after 15 minutes.
OPTICAL MODE	In this mode, when there is no signal output, the idle power consumption is lower than 0.5W after 15 minutes.
USB MODE	In this mode, when there is no signal output, the idle power consumption is lower than 0.5W after 15 minutes.

TRADEMARK

- “The Bluetooth® word mark and logos are registered trademarks owned by the Bluetooth SIG, Inc. and any use of such marks by Klipsch Group, Inc. is under license. Other trademarks and trade names are those of their respective owners.”
- Dolby, Dolby Audio, Dolby Atmos, and the double-D symbol are registered trademarks of Dolby Laboratories Licensing Corporation. Manufactured under license from Dolby Laboratories. Confidential unpublished works. Copyright © 2012-2021 Dolby Laboratories. All rights reserved.
- The Adopted Trademarks HDMI, HDMI High-Definition Multimedia Interface, HDMI trade dress, and the HDMI logos are trademarks or registered trademarks of HDMI Licensing Administrator, Inc. in the United States and other countries.

IMPORTANT SAFETY INSTRUCTIONS

1. READ these instructions.
2. KEEP these instructions.
3. HEED all warnings.
4. FOLLOW all instructions.
5. DO NOT use this apparatus near water.
6. CLEAN ONLY with a dry cloth.
7. DO NOT block any ventilation openings. Install by the manufacturer's instructions.
8. DO NOT install near any heat sources such as radiators, heat registers, stoves, or other apparatus (including amplifiers) that produce heat.
9. DO NOT defeat the safety purpose of the polarized or grounding-type plug. A polarized plug has two blades one wider than the other. A grounding-type plug has two blades and a third grounding prong. The wider blade or the third prong is provided for your safety. If the provided plug does not fit into your outlet, consult an electrician for the replacement of the obsolete outlet.
10. PROTECT the power cord from being walked on or pinched, particularly at plugs, convenience receptacles, and the point where they exit from the apparatus.
11. ONLY USE attachments/accessories specified by the manufacturer.

12. USE ONLY with the cart, stand, tripod, bracket, or table specified by the manufacturer, or sold with the apparatus. When a cart is used, use caution when moving the cart/ apparatus combination to avoid injury from tip-over.
13. UNPLUG this apparatus during lightning storms or when unused for long periods.
14. REFER all servicing to qualified service personnel. Servicing is required when the apparatus has been damaged in any way, such as power-supply cord or plug is damaged, liquid has been spilled or objects have fallen into the apparatus, the apparatus has been exposed to rain or moisture, does not operate normally, or has been dropped.
15. DO NOT expose this apparatus to dripping or splashing and ensure that no objects filled with liquids, such as vases, are placed on the apparatus.
16. To completely disconnect this apparatus from the AC Mains, disconnect the power supply cord plug from the AC receptacle.
17. The mains plug/appliance coupler is used as a disconnect device, the disconnect device shall remain readily operable.
18. DO NOT overload wall outlets or extension cords beyond their rated capacity as this can cause electric shock or fire.
19. The equipment shall be used at a maximum of 113°F / 45°C ambient temperature.

The exclamation point, within an equilateral triangle, is intended to alert the user to the presence of important operating and maintenance (servicing) instructions in the literature accompanying the product.

The lightning flash with the arrowhead symbol within an equilateral triangle is intended to alert the user to the presence of uninsulated "dangerous voltage" within the product's enclosure that may be of sufficient magnitude to constitute a risk of electrical shock to persons.

- **WARNING:** To reduce the risk of fire or electrical shock, do not expose this apparatus to rain or moisture.
- **WARNING:** To prevent injury, this apparatus must be securely attached to the floor/wall by the installation instructions. **WARNING:** No naked flame sources – such as candles – should be placed on the product.
- **WARNING:** This equipment is a Class II or double insulated electrical appliance. It has been designed in such a way that it does not require a safety connection to electrical earth.
- **WARNING:** Do not place batteries in the mouth or ingest. Chemical burn hazard. Keep new and used batteries out of reach of children and pets. If swallowed, it can cause severe internal burns in just 2 hours and can lead to death. If you think batteries might have been swallowed or placed inside any part of the body, seek immediate medical attention.
- **WARNING:** If the battery compartment does not close securely, stop using the product and keep it away from children and pets.
- **WARNING:** Do not handle leaking or damaged Lithium batteries.
- **WARNING:** Risk of leakage. Only use the specified type of batteries. Never mix new and used batteries. Observe correct polarity. Remove batteries from products that are not in use for extended periods. Store batteries in a dry place.
- **WARNING:** Batteries (battery pack or batteries installed) shall not be exposed to excessive heat such as sunshine, fire, or the like.
- **WARNING:** Danger of explosion if battery is incorrectly replaced. Replace only with the same or equivalent type.
- **WARNING:** Do not recharge non-rechargeable batteries. **WARNING:** Avoid exposure to extreme heat or cold. Please dispose of any used batteries properly, following any local regulations. Do not incinerate.



- **WARNING:** Do Not Open! Risk of Electrical Shock. Voltages in this equipment are hazardous to life. No user-serviceable parts inside. Refer all servicing to qualified service personnel.
Place the equipment near a main power supply outlet and make sure that you can easily access the power breaker switch.
- **WARNING:** This product is intended to be operated ONLY from the AC Voltages listed on the back panel or included power supply of the product. Operation from other voltages other than those indicated may cause irreversible damage to the product and void the product's warranty. The use of AC Plug Adapters is cautioned because it can allow the product to be plugged into voltages in which the product was not designed to operate. If the product is equipped with a detachable power cord, use only the type provided with your product or by your local distributor and/or retailer. If you are unsure of the correct operational voltage, please contact your local distributor and/or retailer.

EU COMPLIANCE INFORMATION

- Eligible to bear the CE mark; Conforms to European Union Low Voltage Directive 2014/35/EU; European Union EMC Directive 2014/30/EU; European Union Restriction of Hazardous Substances Recast (RoHS2) Directive 2011/65/EU; European Union WEEE Directive 2012/19/EU;
- European Union Eco-Design Directive 2009/125/EC; European Union Registration, Evaluation, Authorization and Restriction of Chemicals (REACH) Directive 2006/121/EC; European Union Radio Equipment Directive (RED) 2014/53/EU.
- This product contains batteries that are covered under the 2006/66/EC European Directive, which cannot be disposed of with normal household waste. Please follow local regulations.
- You may obtain a free copy of the Declaration of Conformity by contacting your dealer, distributor, or Klipsch Group, Inc.'s worldwide headquarters. Contact information can be found here:
<http://www.klipsch.com/Contact-Us>

WE NOTICE

Note: This mark applies only to countries within the European Union (EU) and Norway. This appliance is labeled by European Directive 2012/19/EU concerning waste of electrical and electronic equipment (WEEE). This label indicates that this product should not be disposed of with household waste. It should be deposited at an appropriate facility to enable recovery and recycling.

FCC AND CANADA EMC COMPLIANCE INFORMATION

This device complies with Part 15 of the FCC Rules. Operation is subject to the following two conditions:

1. This device may not cause harmful interference, and
2. This device must accept any interference received, including interference that may cause undesired operation.

NOTE: This equipment has been tested and found to comply with the limits for a Class B digital device, under part 15 of the FCC Rules. These limits are designed to provide reasonable protection against harmful interference in a

residential installation. This equipment generates, uses, and can radiate radio frequency energy and, if not installed and used by the instructions, may cause harmful interference to radio communications. However, there is no guarantee that interference will not occur in a particular installation. If this equipment does cause harmful interference to radio or television reception, which can be determined by turning the equipment off and on, the user is encouraged to try to correct the interference by one or more of the following measures:

- Reorient or relocate the receiving antenna.
- Increase the separation between the equipment and the receiver.
- Connect the equipment to an outlet on a circuit different from that to which the receiver is connected.
- Consult the dealer or an experienced radio/TV technician for help.

Approved under the verification provision of FCC Part 15 as a Class B Digital Device.

Caution: Changes or modifications not expressly approved by the manufacturer could void the user's authority to operate this device.

Caution: To comply with the limits of the Class B digital device, under Part 15 of the FCC Rules, this device is to comply with Class B limits. All peripherals must be shielded and grounded. Operation with non-certified peripherals or non-shielded cables may result in interference to radio or reception.

WIRELESS TRANSMITTER COMPLIANCE INFORMATION

Radiation Exposure Statement:

This equipment complies with FCC radiation exposure limits set forth for an uncontrolled environment. This equipment should be installed and operated with a minimum distance of 20cm between the radiator & your body.

Industry Canada statement:

This device complies with Industry Canada's license-exempt RSSs. Operation is subject to the following two conditions:

1. This device may not cause interference; and
2. This device must accept any interference, including interference that may cause undesired operation of the device.

Radiation Exposure Statement:

This equipment complies with ISSED radiation exposure limits set forth for an uncontrolled environment. This equipment should be installed and operated with a minimum distance of 20cm between the radiator & your body.

WARRANTY – U.S.

Klipsch Group, Inc., (KGI), 3502 Woodview Trace, Suite 200, Indianapolis, Indiana (USA) 46268, warrants to the original retail purchaser that this product will be free from defective materials and workmanship for two (2) years from the date of purchase, subject to the limitations below. This warranty period is not extended if we repair or replace the product. Except as limited below, if this product proves defective in either material or workmanship, KGI, at its option, will (a) repair the product, or (b) replace the product, at no charge for parts or labor. If the product model is no longer available and cannot be repaired effectively or replaced with an identical model, KGI at its sole option may replace the unit with a current model of equal or greater value. In some cases, modification to the mounting surface may be required where a new model is substituted. KGI assumes no responsibility or liability for such modification. To obtain a repair or replacement under the terms of this warranty, you must return the product to the dealer from which it was purchased with your original receipt. If the return of the product to the dealer from which it was purchased is impossible, you must contact our warranty service number at 1-[800-554-7724](tel:800-554-7724) to arrange for the return of the product to us or in-field destruction of the product at our option, as well as provision of your original receipt to us. Return, repair, and replacement shipping, liability, and cost are the responsibility of the original retail purchaser.

Limitations:

- This limited warranty does not cover failure of the product arising, in whole or in part, from improper installation, storage, transportation, misuse, abuse, accident, neglect, mishandling, unauthorized repair, modification, or wear from ordinary use or environmental deterioration.
- This limited warranty does not cover cosmetic damage, including paint damage, or consequential damage to other components or premises which may result for any reason from the failure of the product.
- This limited warranty is null and void for products not used by KGI's instructions.
- This limited warranty is null and void for products with altered or missing serial numbers and for products not purchased from Klipsch Group, Inc. or an authorized dealer (See: www.klipsch.com/dealers).
- This limited warranty terminates if the original retail purchaser sells or otherwise transfers this product.
- This limited warranty is null and void for defects or damage caused by installation or repair performed by any person or entity other than a Klipsch-authorized installer or dealer.

THIS WARRANTY GIVES YOU SPECIFIC LEGAL RIGHTS, AND YOU MAY ALSO HAVE OTHER RIGHTS THAT VARY FROM STATE TO STATE, JURISDICTION TO JURISDICTION, OR COUNTRY TO COUNTRY. ALL EXPRESS AND IMPLIED WARRANTIES FOR THE PRODUCT, INCLUDING BUT NOT LIMITED TO ANY IMPLIED WARRANTIES OF MERCHANTABILITY AND FITNESS FOR A PARTICULAR PURPOSE, ARE LIMITED IN TIME TO THE TERM OF THIS WARRANTY. SOME STATES, JURISDICTIONS, OR COUNTRIES DO NOT ALLOW THE EXCLUSION OF CERTAIN IMPLIED WARRANTIES OR CONDITIONS, OR LIMITATIONS ON HOW LONG AN IMPLIED WARRANTY OR CONDITION LASTS, SO THIS LIMITATION MAY NOT APPLY TO YOU. KGI'S RESPONSIBILITY FOR MALFUNCTIONS AND DEFECTS IN HARDWARE IS LIMITED TO REPLACEMENT OR REPAIR AS OUTLINED IN THIS WARRANTY STATEMENT. KGI DOES NOT ACCEPT LIABILITY FOR SPECIAL, PUNITIVE, CONSEQUENTIAL, OR INCIDENTAL DAMAGES OR LOSSES, WHETHER DIRECT OR INDIRECT, INCLUDING WITHOUT LIMITATION, ANY LIABILITY FOR THIRD-PARTY CLAIMS AGAINST YOU FOR DAMAGES OR LOSSES OR FOR PRODUCTS NOT BEING AVAILABLE FOR USE. THE MAXIMUM LIABILITY FOR WHICH KGI MAY BE RESPONSIBLE WILL BE NO MORE THAN THE AMOUNT YOU PAID FOR THE PRODUCT THAT IS THE SUBJECT OF THE CLAIM. SOME STATES, JURISDICTIONS, OR COUNTRIES DO NOT ALLOW THE EXCLUSION OR LIMITATION OF SPECIAL, INDIRECT, INCIDENTAL, OR CONSEQUENTIAL DAMAGES, SO THE ABOVE LIMITATION OR EXCLUSION MAY NOT APPLY TO YOU.

WARRANTY OUTSIDE THE U.S.

The Warranty on this product shall comply with applicable law when sold to a consumer outside of the United States. To obtain any applicable warranty service, please contact the dealer from which you purchased this product, or the distributor that supplied this product.

Frequently Asked Questions (FAQ)

• How do I pair additional components with the Flexus Sound System?

To add wireless subwoofers or surround speakers, follow the pairing instructions provided with each component and ensure compatibility with the Flexus Core 200 sound bar.

• Can I mount the sound bar on any type of wall?

The sound bar can be mounted on most walls using the included mounting hardware. Ensure the wall can support the weight of the sound bar and follow the installation guidelines for safety.

Documents / Resources

	<p>Klipsch Flexus Core 200 Sound Bar [pdf] Owner's Manual 714FLCR200, 714FLCR200, Flexus Core 200 Sound Bar, Flexus Core 200, Sound Bar, Sound Bar</p>
---	--

References

- [🌐 Klipsch](#)
- [User Manual](#)

[Manuals+](#), [Privacy Policy](#)

This website is an independent publication and is neither affiliated with nor endorsed by any of the trademark owners. The "Bluetooth®" word mark and logos are registered trademarks owned by Bluetooth SIG, Inc. The "Wi-Fi®" word mark and logos are registered trademarks owned by the Wi-Fi Alliance. Any use of these marks on this website does not imply any affiliation with or endorsement.