



KLEIN TOOLS BC503C Work Tray Module Rail System Instruction Manual

[Home](#) » [KLEIN TOOLS](#) » KLEIN TOOLS BC503C Work Tray Module Rail System Instruction Manual 

Contents

- [1 KLEIN TOOLS BC503C Work Tray Module Rail System](#)
- [2 Product Information](#)
- [3 Product Usage Instructions](#)
- [4 SYMBOLS ON PRODUCT](#)
- [5 ASSEMBLY INSTRUCTIONS](#)
- [6 PARTS INCLUDED](#)
- [7 CLEANING AND STORAGE](#)
- [8 Documents / Resources](#)
 - [8.1 References](#)



KLEIN TOOLS BC503C Work Tray Module Rail System



Product Information

The product is a work tray designed for holding buckets and preventing them from falling or being accidentally bumped. It has a weight rating of 40 lbs. The assembly includes various parts such as arms, barrel nuts, lock washers, bolts, flat washers, and foam pads (optional).

Product Usage Instructions

1. Read all instructions and warnings carefully before using the product.
2. Assemble the work tray by following the assembly instructions provided in the manual.
3. Use the M6 Hex Key to tighten the sleeve to the bolt until snug. Repeat this step for all hardware sets.
4. Ensure all fasteners are fully tightened before using the work tray.
5. (Optional) Install foam pads on the underside of the arms to prevent damage to the rail system wall.
6. Do not step or stand on the work tray.
7. Clean the product with mild soap and water only. Rinse and wipe dry after cleaning.
8. Store the product in a cool place when not in use.

If you have any questions or need assistance, please contact Klein Tools customer service:
Klein Tools, Inc. 450 Bond Street, Lincolnshire, IL 60069 1-800-553-4676

customerservice@kleintools.com
www.kleintools.com

WARNINGS

READ ALL INSTRUCTIONS. FAILURE TO FOLLOW THESE WARNINGS AND INSTRUCTIONS MAY RESULT IN SERIOUS BODILY INJURY OR DEATH.

- Check all hardware is tightened before each use.
- Inspect before each use: make sure all hardware is fully tightened. Do not use if there are signs of cracks, breakage or any other damage.
- The Work Tray is rated to hold a maximum of 40 lbs. (18 kg) Do NOT exceed.
- Do NOT step or stand on the Work Tray. It is NOT for human support.
- Risk of Dropped Objects: Do not hang or tether tools or equipment from the Work Tray.
- Always remove and stow your Work Tray before driving

SYMBOLS ON PRODUCT



- Warning or Caution



- Weight Rating: 40 lbs



- Read Instructions



- No Tether Point: Not for Fall Arrest,



- Not for Dropped Object Prevention

- Do Not Step or Stand

ASSEMBLY INSTRUCTIONS

Read these instructions carefully before operating and keep for future reference.

ASSEMBLY

1. Assemble 1 Arm 2 into an arm slot in the Tray 1 .
2. Align the holes of the Arm 2 with the holes in the Tray 1 .
3. Add an M8 Lock Washer 7 to a M6 × 10 mm Long Barrel Nut 4 .
4. From the inside of the Tray 1 , insert the Long Barrel Nut 4 into one of the upper 2 holes 2 . Press it through the Arm 2 , Work Tray 1 and Arm 2 on the outside of the Work Tray 1 .
5. Insert a M6 × 16 mm Bolt 3 from the outside of the Work Tray 1 through the Arm 2 so it meets up with the Barrel Nut 3 and hand-tighten.
6. Repeat with another Long Barrel Nut 4 , Lock Washer 7 and Bolt 3 at the other upper hole location.
7. Add an M8 Lock Washer 7 and M8 Flat Washer 6 to an M6 × 10 mm Short Barrel Nut 5 . From the inside of the Tray 1 , insert the Barrel 5 into one of the lower 4 holes 2 .
8. Press the sleeve through the Work Tray 1 and Arm 2 on the outside of the Work Tray 1 .
9. Insert a M6 × 16 mm Bolt 3 from the outside of the Work Tray 1 through the Arm 2 so it meets up with the Barrel Nut 4 and hand-tighten.
10. Repeat with three more Short Barrels 5 , Lock Washers 7 , Flat Washers 6 , and Bolts 3 at the 3 other lower hole locations.
11. Use the M6 Hex Key 8 on the corresponding sleeve, and while holding the Bolt 3 in the pocket, tighten the sleeve to the Bolt 3 until snug
12. Repeat on the other five hardware sets.
13. Repeat on the second Arm 2 .
14. Make sure all fasteners are fully tightened before using.
15. Install Foam Pads 9 on to the underside of the Arms 2 (optional, see FOAM PADS section).

INSTALLATION ONTO BUCKET WORK CENTER

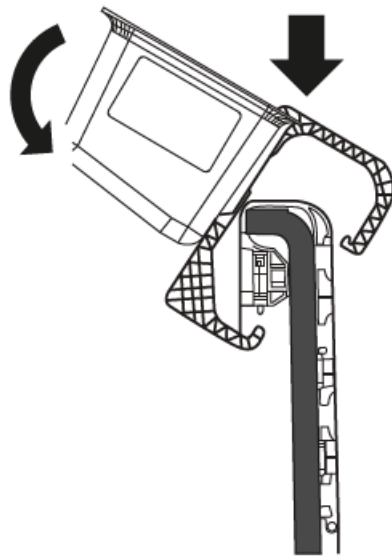
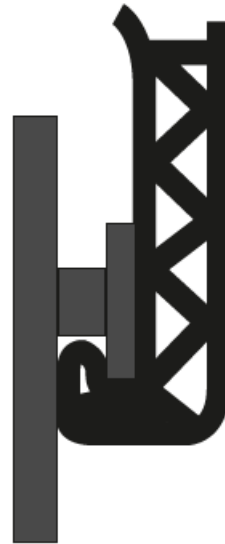
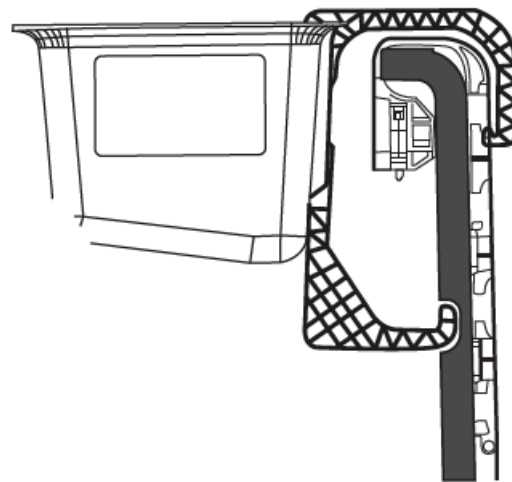
FIG. A**FIG. B****FIG. C**

- Lower assembled Work Tray at an angle so that the opening in the Arms 2 wrap around the Bucket Work Center wall, with the top of the Arm 2 reaching inside the bucket and the bottom of the Arm 2 on the outside (Fig A).
- Hook the lips of both Arms 2 under the bottom of the top rail inside the bucket (Fig B).
- Rotate the Work Tray 1 so that the bottom of the Arms 2 rest against the outside of the bucket. (FIG C).

FOAM PADS

- Foam Pads 9 can be used to minimize movement of the Work Tray 1 along the rail system wall that may occur when positioning your bucket or accidentally bumping it.
- If the Work Tray 1 moves around too easily, consider adding the pads 9 to the assembly.
- The Foam Pads 9 are designed to sit between each Arm 2 and the top of the rail system wall. Simply remove the adhesive liner from each Pad 9 and press firmly at the locations shown.

NOTE: The Foam Pads 9 are not designed to slide along the wall so repositioning the Work Tray 1 will require it to be lifted and rotated away from the wall before sliding

PARTS INCLUDED

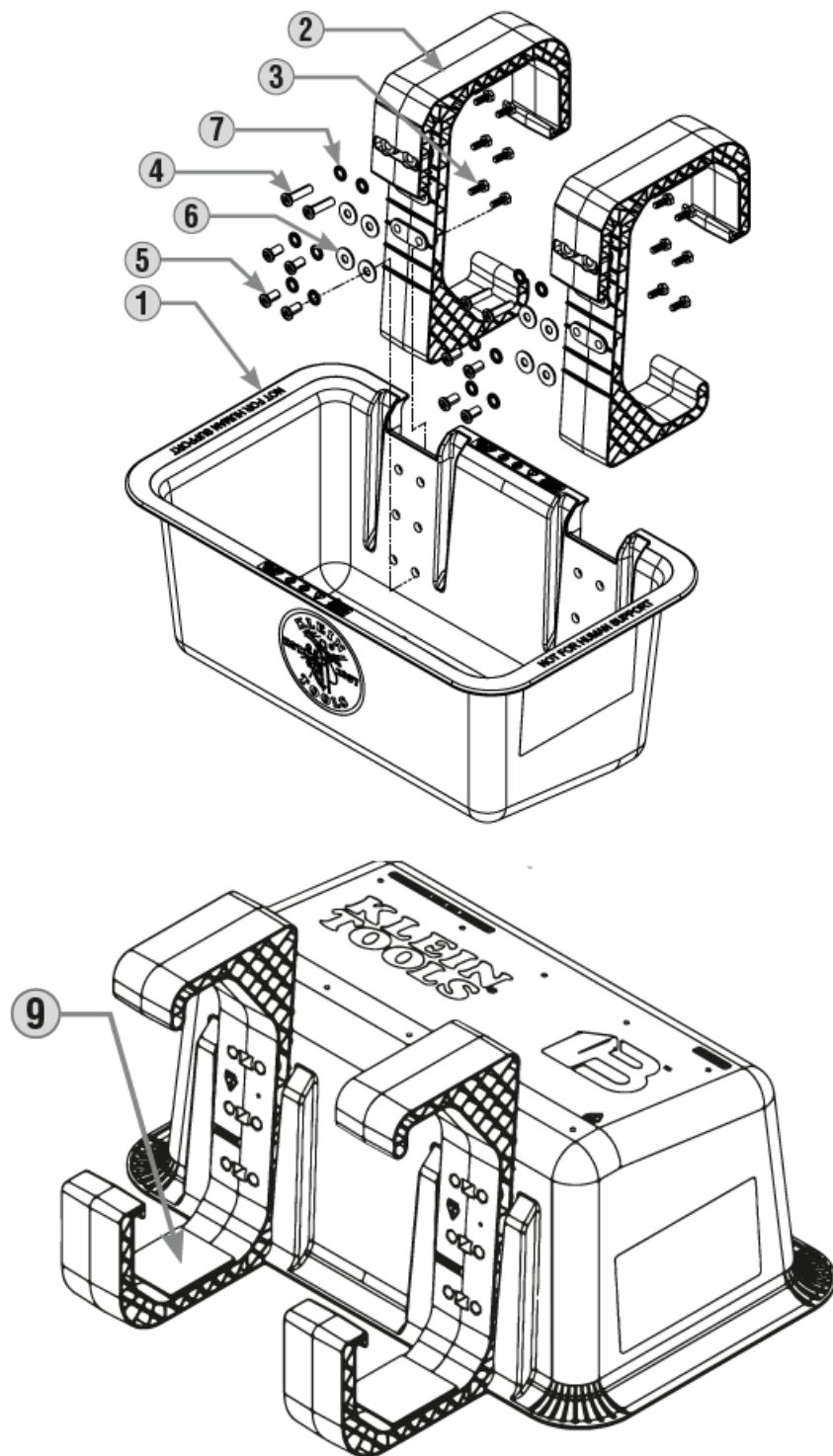

- 1. Tray (×1)
- 2. Arms (×2)
- 3. M6 × 16 mm Bolt (×13)
- 4. M6 × 10 mm Long Barrel (×5)
- 5. M6 × 10 mm Short Barrel (×9)
- 6. M8 Flat Washer (×9)
- 7. M8 Lock Washer (×13)
- 8. M6 Hex Key (×1)
- 9. Foam Pads (×2)

NOTE: Parts in 3, 4, 5, 6, 7, 8 may include extra hardware

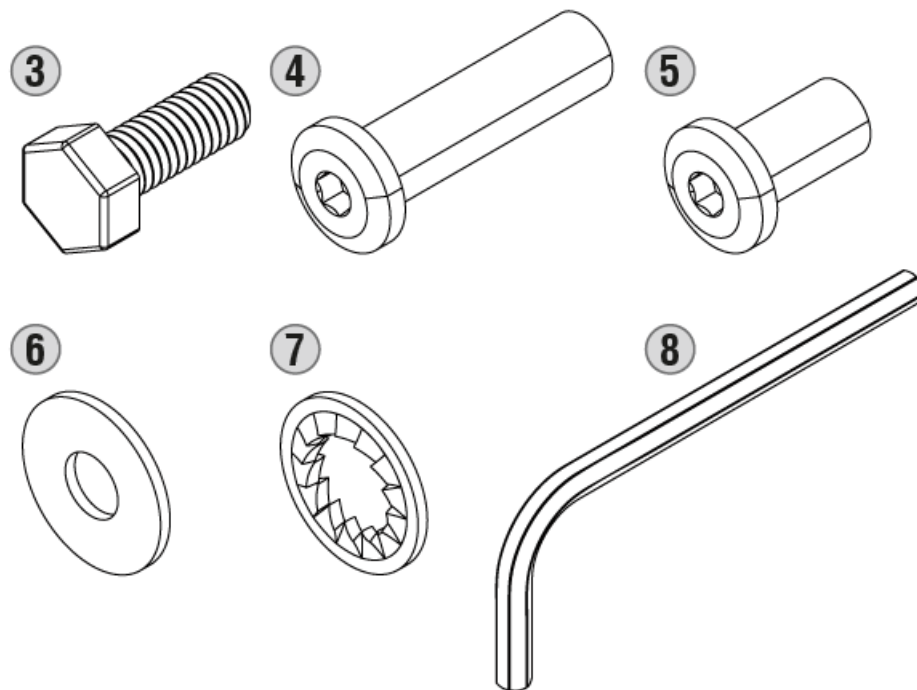

CLEANING AND STORAGE

Clean the product with mild soap and water only. Rinse and wipe dry. Store in a cool place.

CUSTOMER SERVICE

KLEIN TOOLS, INC. 450 Bond Street, Lincolnshire, IL 60069 1-800-553-4676

customerservice@kleintools.com www.kleintools.com

Documents / Resources



[KLEIN TOOLS BC503C Work Tray Module Rail System](#) [pdf] Instruction Manual
BC503C Work Tray Module Rail System, BC503C, Work Tray Module Rail System, Tray Module Rail System, Module Rail System, Rail System

References

-  [Klein Tools - For Professionals since 1857 | Klein Tools](#)