



KLARSTEIN 10033256 Ice Cube Maker Instruction Manual

[Home](#) » [Klarstein](#) » KLARSTEIN 10033256 Ice Cube Maker Instruction Manual 

KLARSTEIN 10033256 Ice Cube Maker
Instruction Manual



Dear Customer,

Congratulations on purchasing this equipment. Please read this manual carefully and take care of the following hints to avoid damages. Any failure caused by ignoring the items and cautions mentioned in the instruction manual is not covered by our warranty and any liability. Scan the QR code to get access to the latest user manual and other information about the product:



<https://use.berlin/10033256>

Contents

- 1 TECHNICAL DATA
- 2 MANUFACTURER & IMPORTER (UK)
- 3 SAFETY INSTRUCTIONS
- 4 DEVICE OVERVIEW
- 5 INSTALLATION
- 6 GETTING STARTED
- 7 OPERATION
- 8 CLEANING AND CARE
- 9 TROUBLESHOOTING
- 10 HINTS ON DISPOSAL
- 11 Documents / Resources
 - 11.1 References
- 12 Related Posts

TECHNICAL DATA

Item number	10033256
Power supply	220 V ~ 50 Hz

MANUFACTURER & IMPORTER (UK)

Manufacturer: Chal-Tec GmbH, Wallstrasse 16, 10179 Berlin, Germany.

Importer for Great Britain: Chal-Tec UK limited Unit 6 Riverside Business Centre Brighton Road Shoreham-by-Sea BN43 6RE United Kingdom

SAFETY INSTRUCTIONS

- Check that the mains voltage corresponds to the rating of the appliance before operating. The rated capacity of wire should be over 6 A, the section area of the wire is 0.75 mm². The wire could be consisted by single ply or multiplies. The rated current of fuse is 5 A.
- Unplug from socket outlet when not in use.
- To protect against electric shock, do not immerse the appliance, the cord or plug in water or any other liquid.
- The use of accessory attachments not recommended by the appliance manufacturer, may cause injury.
- Do not let the power cord hang from the counter top where it can be easily pulled by children.
- Do not overfill as this may cause a hazard.

- Ensure that the lid is closed during operation.
- To remove the plug from the outlet, do not pull on the supply cord. Grasp the plug firmly and pull to remove.
- Do not use this appliance for anything else other than its intended use. No liability can be accepted for any damage caused by non compliance with these instructions or any other improper use or mishandling.
- This appliance is for household use only. Do not use outdoors.
- This appliance is not intended to be operated by means of an external timer or separate remote control system.
- If the supply cord is damaged, it must be replaced by the manufacturer or its service agent or a similarly qualified person in order to avoid a hazard.
- Do not store explosive substances such as aerosol cans with a flammable propellant in this appliance.
- Please according to local regulations regarding disposal of the appliance for its flammable blowing gas.
- Fill with fresh potable water only.
- This appliance is not intended for use by persons (including children) with reduced physical, sensory or mental capabilities, or lack of experience and knowledge, unless they have been given supervision or instruction concerning use of the appliance by a person responsible for their safety. Children should be supervised to ensure that they do not play with the appliance.

This appliance contains the coolant isobutane (R600a), a natural gas which is environmentally friendly. Although it is flammable, it does not damage the ozone layer and does not increase the greenhouse effect. The use of this coolant has, however, led to a slight increase in the noise level of the appliance. In addition to the noise of the compressor, you might be able to hear the coolant flowing around the system. This is unavoidable, and does not have any adverse effect on the performance of the appliance. Care must be taken during the transportation and setting up of the appliance that no parts of the cooling system are damaged. Leaking coolant can damage the eyes.

Transportation and Placement

- The incline angle of the cabinet should not be over 45 °C during transportation. Do not turn the ice maker upside-down as this may damage the compressor or refrigerating system.
- Place on a flat and stable surface for use.
- At least about 150 mm space should be left around the ice maker to ensure good ventilation.
- Please adjust the feet when placing the ice maker somewhere, otherwise the water level will be effected and so does the ice shape.
- The outlet of drainage tube should be lower than the cabinet so as to drain water easily.
- Do not locate this appliance immediately below a socket outlet.
- Make sure that the appliance is not placed near heat sources and aggressive gases.
- Do not use near or in the immediate vicinity of a bath or swimming pool or any source of liquid.
- Before using the ice maker for the first time, you should wait about 12 hours after positioning it in a proper place.

Special Notes

- When positioning the unit, make sure that the power cord is not pinched or damaged.
- Make sure that there are no multiple sockets or power supplies on the back of the unit.



WARNING When using, servicing and disposing of the unit, pay attention to the left symbol on the rear of the unit or on the compressor. This symbol warns of possible fires. There are flammable substances in the refrigerant lines and in the compressor. Keep the appliance away from sources of fire during use, maintenance and disposal.

DEVICE OVERVIEW

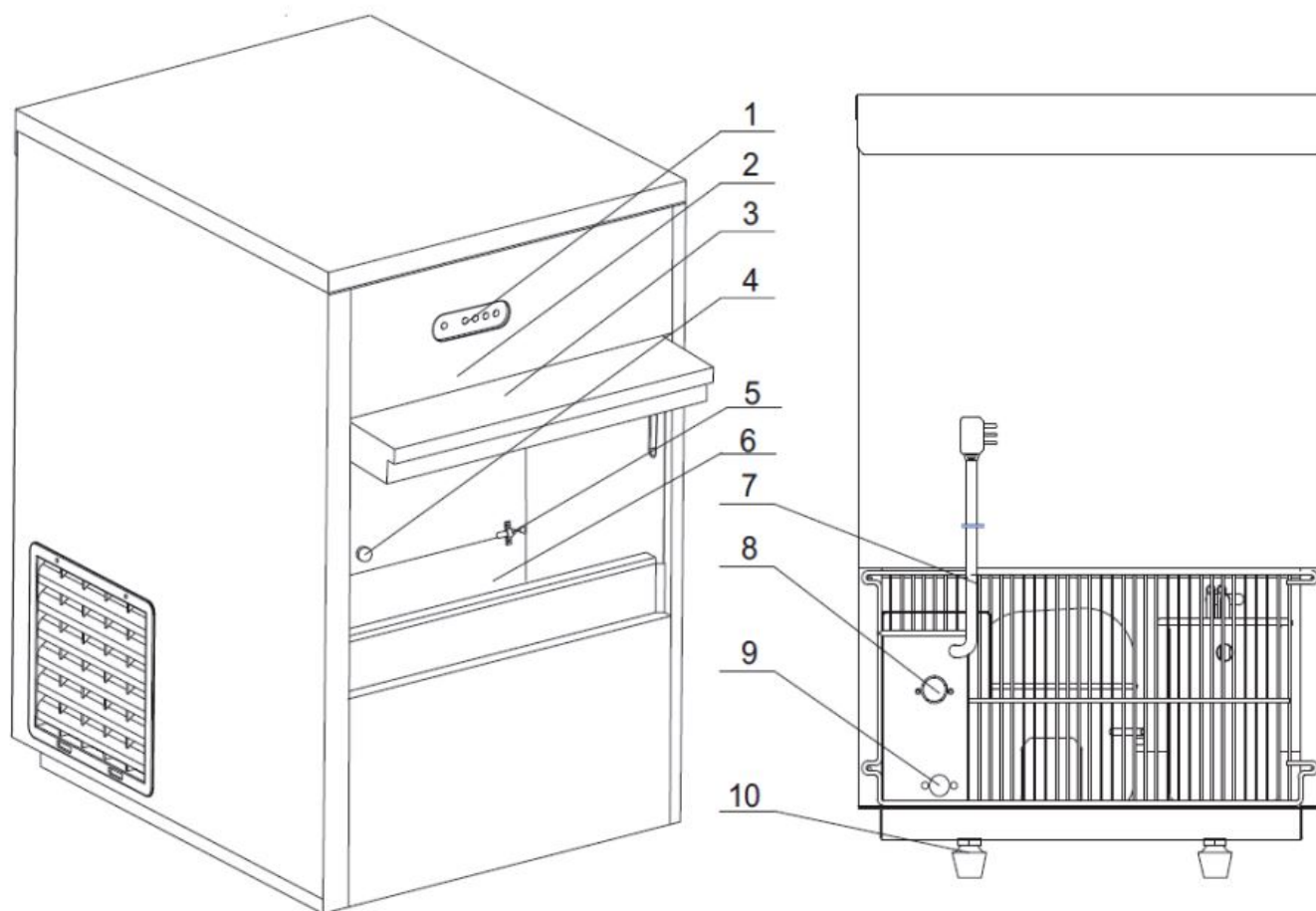

1. Operation panel
2. Front panel
3. Door
4. Screw of drainage
5. Ice level sensor
6. Ice storage container
7. Power cord
8. Water inlet
9. Drainage tube
10. Bottom feet

INSTALLATION

Install the filter

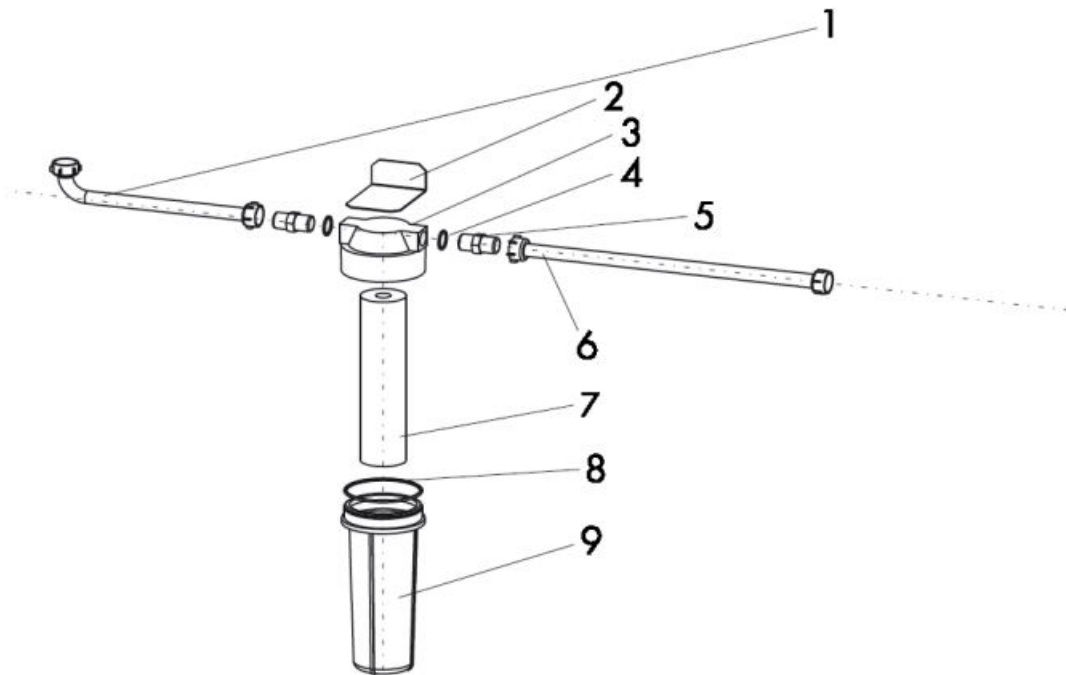

1. Water outlet tube of the filter hull
2. Fixed board of the filter hull
3. Cover of filter hull
4. Washer of Connector
5. Connector of the filter hull
6. Water inlet tube of the filter hull
7. Filter core
8. Washer
9. Filter hull

Insert filter

1. Set the washer into the groove of the upper filter hull.
2. Put the filter core into the filter hull, then cover both with the cover of the filter hull.
3. Fasten the fixed board of the filter hull on the filter cover with screws.
4. Connect the filter hull connector with the water inlet tube of the filter hull, install the washer, then connect it to the end of the filter cover with the inscription "in" on it.
5. Connect the filter hull connector with the water outlet tube of the filter hull, install the washer, then connect it to the end of the filter cover with the inscription "out" on it.
6. After completing the installation, fix the filter to the back of the ice maker with screws.
7. Connect the water inlet tube of the filter hull to the water supply.
8. Connect the water outlet tube of the filter hull to the water inlet valve of the ice maker.

GETTING STARTED

1. Take all components out of the packaging.
2. Position the ice maker on a well ventilated place and leave at least 150 mm distance between the ice maker and the wall. Adjust the feet of the ice maker so that it is positioned levelly.

3. Connect one end of the flexible 14 plastic corrugated pipe (supplied with the machine) with the water outlet tube on the back of the machine, another pipe end should be placed in a container for surplus water (prepared by the user himself) or in the sewer.
4. Connect one end of the water inlet tube (supplied with the machine) with the 3/4 inch screw type connector of the water tap so as to get the drinkable tap water. The water pressure of the water supply pipe is 1-8 kg/cm².) The other end of the water inlet tube should be connected with the screw type connector of the water valve on the back of the ice maker. Be sure to put the gaskets (supplied with the machine) into both ends of the water inlet tube before connecting. If it is an ice maker for purified water, a 14 corrugated pipe (supplied with the machine) should be used. Connect one end of the pipe with the purified water supplier (cold water tap or end of the water drainage tube of a water dispenser) and another end with the water valve connector on the back of the ice maker. Make sure that the purified water outlet position is higher than the top of the ice maker.

Note: Wait at least 12 hours after setting up the ice machine for the first time before using it for the first time.

OPERATION

1. Plug the power plug of the appliance into the wall outlet and press the power button on the control panel. The "RUN" indicator light illuminates. The appliance starts operation. All procedures such as water inlet, ice making, ice rapping and ice storage are automatically controlled during ice production. If problems occur, the corresponding indicator lights illuminate (see indicator lights in the "Troubleshooting" section).
2. Only purified drinking water should be used for the appliance. If the "WATER LOW" indicator light illuminates and no ice is produced, maybe there is air in the water inlet tube. Disconnect one end of the water inlet tube from the water valve of the ice maker. Open the water inlet switch until water and air run out from the end. Then quickly reconnect the water inlet tube with the water valve of the appliance.

Note: If the water storage is defective or the water supply system is faulty, the ice maker will restart automatically in 24 hours. If the problem has not been solved, stop the appliance and restart it again.

Drain the water

- When the appliance is used for the first time or has not been used for an extended period of time, drain any water remaining in the appliance. To do this, unscrew the drainage screw and place a container under it to collect stale water. The first and second ice making cycles are just for cleaning the tube system. The resulting ice should never be consumed. After the water has been drained and the draining screw is tightened again, the normal ice making procedures can begin and you can use the ice.

CLEANING AND CARE

1. If the compressor stops for any reasons, such as water shortage, too much ice, power off, etc., do not restart it right away. Wait at least 5 minutes before restarting to protect the compressor.
2. Check the connectors of the water inlet and outlet tubes regularly and drain the little surplus water that may occur.
3. If the ice maker will be unused for long periods of time, please screw off the plastic drainage connector screw on the back of the ice maker so as to drain the surplus water and place a container underneath to collect the

water. Then screw it on. Wipe the inner liner of the ice storage container with a clean rag.

4. Pull out the mains plug only at the plug head and do not pull on the cable under any circumstances.
5. Clean the ice maker and its water supply system at least once a month. Unplug the appliance from the wall outlet before cleaning.

TROUBLESHOOTING

Problem	Possible Cause	Suggested Solution
The ice maker does not work.	1.) Too low voltage.	1.) Turn off the appliance. Check the wall socket and if it is working, turn the appliance on again.
	2.) The ambient temperature is too low (lower than 10 °C).	2.) Try again if the ambient temperature is above 10 °C.
Compressor works, but no ice is made.	1.) Refrigerant leaks.	1.) Refill the refrigerant and perform a leak test.
	2.) The refrigerating system is blocked.	2.) Replace the filter for the N2 filling system.
	3.) The solenoid valve opens continuously.	3.) Replace the solenoid valve.
	4.) The condensation fan does not work.	4.) Check that the condensation fan is working.
	5.) The filter element does not react.	5.) Check that the filter element is working and in the correct position.

The compressor does not work.	1.) No water supply.	1.) Check the water inlet (water valve and water inlet tube).
	2.) The ice storage container is full.	2.) Take out some ice.
	3.) The Compressor stops automatically (the temperature of the outer casing is too high).	3.) Switch off the appliance and switch it on again after 1 hour.
The indicator light "WATER LOW" illuminates.	1.) The appliance is not supplied with water.	1.) Check the water supply and make sure that everything is in order. Only then restart the appliance.
	2.) The water inlet valve is damaged.	2.) Check the water inlet valve.
	3.) The tap water pressure is too low.	3.) For tap water, the water pressure should not be lower than 1 kg/cm ² .
The indicator light "FAULT" illuminates.	1.) Ice has jammed in the appliance and has not fallen into the ice storage container.	1.) Check that the solenoid valve is open. Replace it if not.
	2.) The water tank is not in the correct position.	2.) <ul style="list-style-type: none"> • Check whether the switch (SQ1) can receive information from the rotation of the unbalance wheel. • Check whether the rotating motor and the unbalance wheel spin. • Check whether the motor gear is damaged by turning the unbalance wheel by hand.

Indicator lights

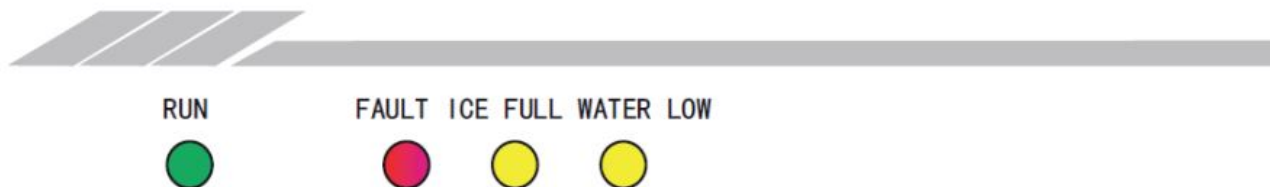

Indicator	Possible Cause
No indicator is on.	Connect the appliance to the power supply. The appliance is currently in self-analysis mode.
The "RUN" indicator light is on.	The appliance is in normal operation mode.
The "ICE FULL" indicator light is on.	The storage container is full or the temperature is less than 5 °C.
The "WATER LOW" indicator light flashes every second.	There is no water in the appliance. As soon as the appliance is supplied with water again, it functions automatically.
The indicator light "WATER LOW" lights up permanently.	There is no water in the appliance. Reset the appliance as soon as water is added again.

HINTS ON DISPOSAL



If there is a legal regulation for the disposal of electrical and electronic devices in your country, this symbol on the product or on the packaging indicates that this product must not be disposed of with household waste. Instead, it must be taken to a collection point for the recycling of electrical and electronic equipment. By disposing of it in accordance with the rules, you are protecting the environment and the health of your fellow human beings from negative consequences. For information about the recycling and disposal of this product, please contact your local authority or your household waste disposal service.

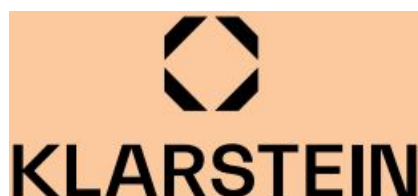

Documents / Resources



[KLARSTEIN 10033256 Ice Cube Maker](#) [pdf] Instruction Manual
10033256 Ice Cube Maker, 10033256, Ice Cube Maker

References

- [K Klarstein | Your home. Your kitchen. Your style.](#)

[Manuals+.](#)