

KJOY JTPD-03-005 Smart LED Display User Guide

[Home](#) » [KJOY](#) » KJOY JTPD-03-005 Smart LED Display User Guide 

KJOY JTPD-03-005 Smart LED Display User Guide

LED Display User Guide

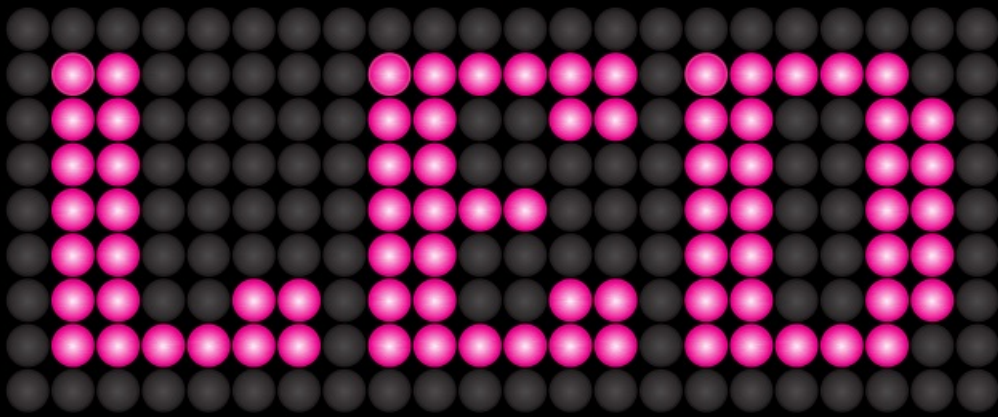

JTPD-03-005

LED Display User Guide

Thanks for your purchase, there are some tips for the suit, please read carefully before use. Please refer to the instruction manual of the corresponding product.

Contents

- 1 Product A
- 2 Product B
- 3 Product Overview
- 4 Basic Function
- 5 App download
- 6 App Overview
- 7 App Operation
 - 7.1 Device List
 - 7.2 Main page
 - 7.3 Pattern page
 - 7.4 Graffiti page
 - 7.5 Animation page
 - 7.6 Music Mode
 - 7.7 Mic Mode
 - 7.8 Settings
- 8 Documents / Resources

Product A



LED Display



USB Cable

- A. Long press the button to switch the LED display.
- B. Double click the button to switch the display direction.
- C. Charge the device with the USB cable.

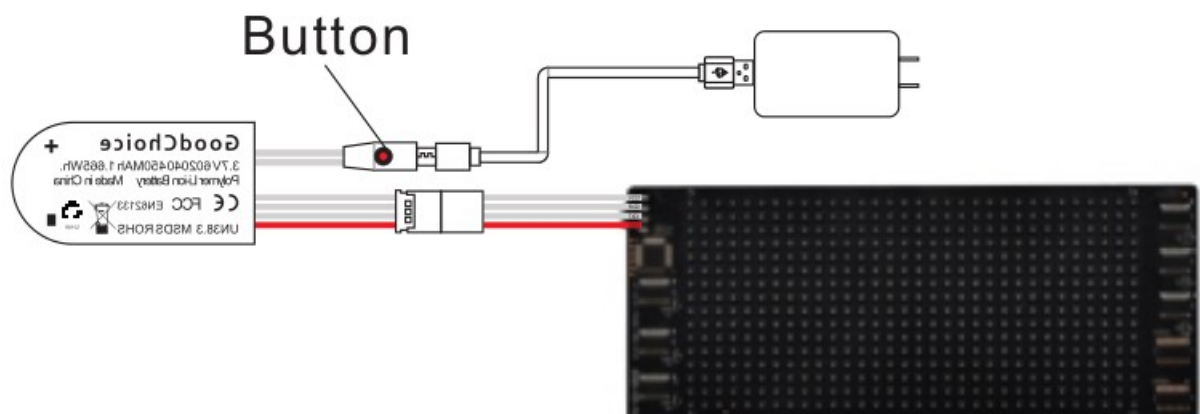

Accessories

- (1) LED Display x 1
- (2) USB Cable x 1
- (3) User Guide x 1

⚠ CAUTION:

- (1) Do not use a charger with an output voltage greater than 5V to charge the device.
- (2) The product is not waterproof, please do not expose to the sun and rain.
- (3) After fully charged, please stop charging in time.

Product B



LED Display



LED Display Controller



3M back adhesive

- A. Long press the button to switch the LED display.
- B. Double click the button to switch the display direction.

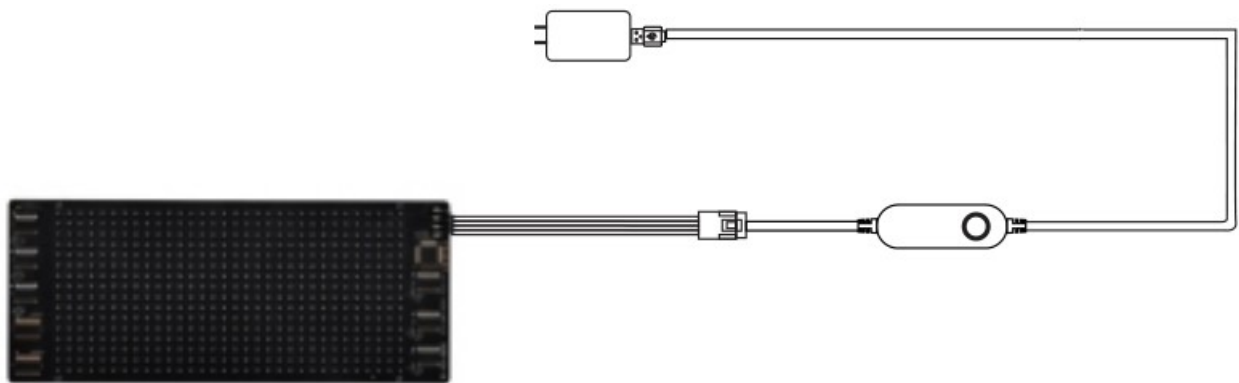

Accessories

- (1) LED Display x 1
- (2) USB Display Controller x 1
- (3) 3M Back Adhesive x 1
- (4) User Guide x 1

⚠ CAUTION:

- (1) Do not use an adapter with voltage over 5V to power the device.
- (2) Do not use a computer or TV USB to power the device.
- (3) The output current of the adapter cannot be lower than 2A.

Product Overview

This product is a flexible display package product. It is controlled by mobile phone APP, and supports modification of text, graffiti, animation, etc. Smart, lightweight and easy to use.

Basic Function

- (1) Thin and bendable, easy to use.
- (2) Mobile APP control.
- (3) Support for diy Text, Graffiti, Animation, etc.

App download

Please scan the QR code to download the app or you can search “CoolLED1248” in the App Store / Google play.



(3 in 1)

If you cannot scan this 3 in 1 code, please check this two codes to download it.



IOS



Android

App Overview

CoolLED1248 is an APP dedicated to controlling the display screen, supporting functions such as text editing, hand-painted graffiti, DIY animation, music rhythm, etc. The operation is simple and convenient, and can be immediately displayed on the screen after modification.

Note: The APP operation interface of different display devices may be different, and the APP will be updated. The following operation instructions are for reference only, please refer to the actual operation interface.

App Operation



1. Run the application, the APP will request the necessary permissions, please allow.

2. Then it will prompt “Allow CoolLED1248 to enable Bluetooth?”, please click “ALLOW”.

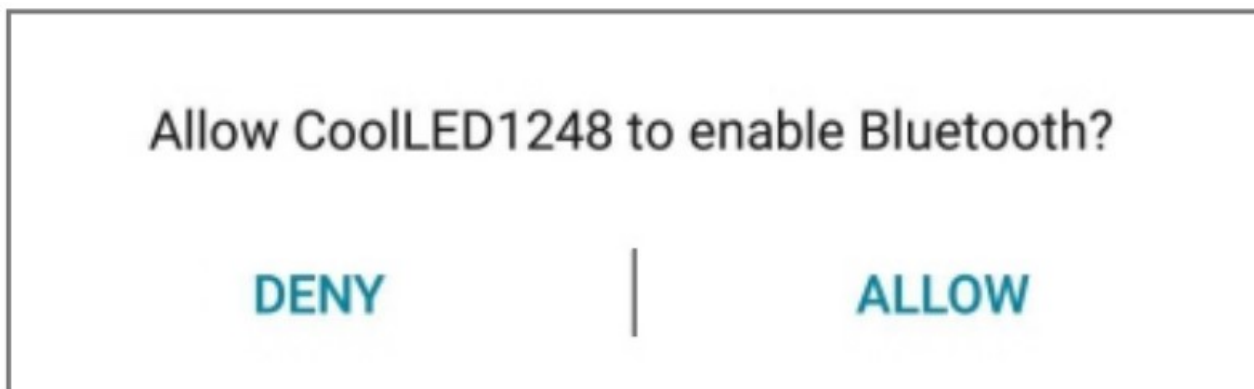
As the dialog below:



3. The application will automatically search the led display, and shows the device in the device list. If automatic search failed, please drop own the device list box, manually refresh.

4. Click the device need to be connected, waiting for connection state change from connecting  to the connection is successful. If connection problem occurs, please drop down the refresh to connect the device. If you want to disconnect from the device, click .

Device List

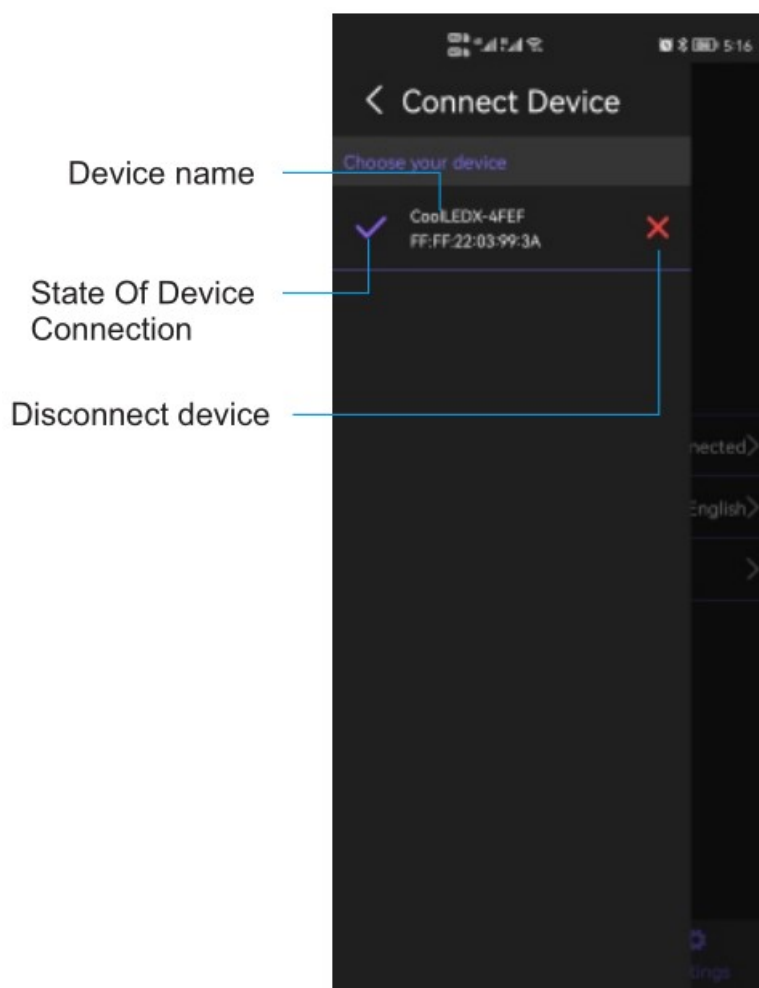

Note:

1. If you can't find the device, please pull down to refresh.
2. If the device cannot be found after multiple refreshes, please check whether the permission is turned on and switch the device again.

Main page

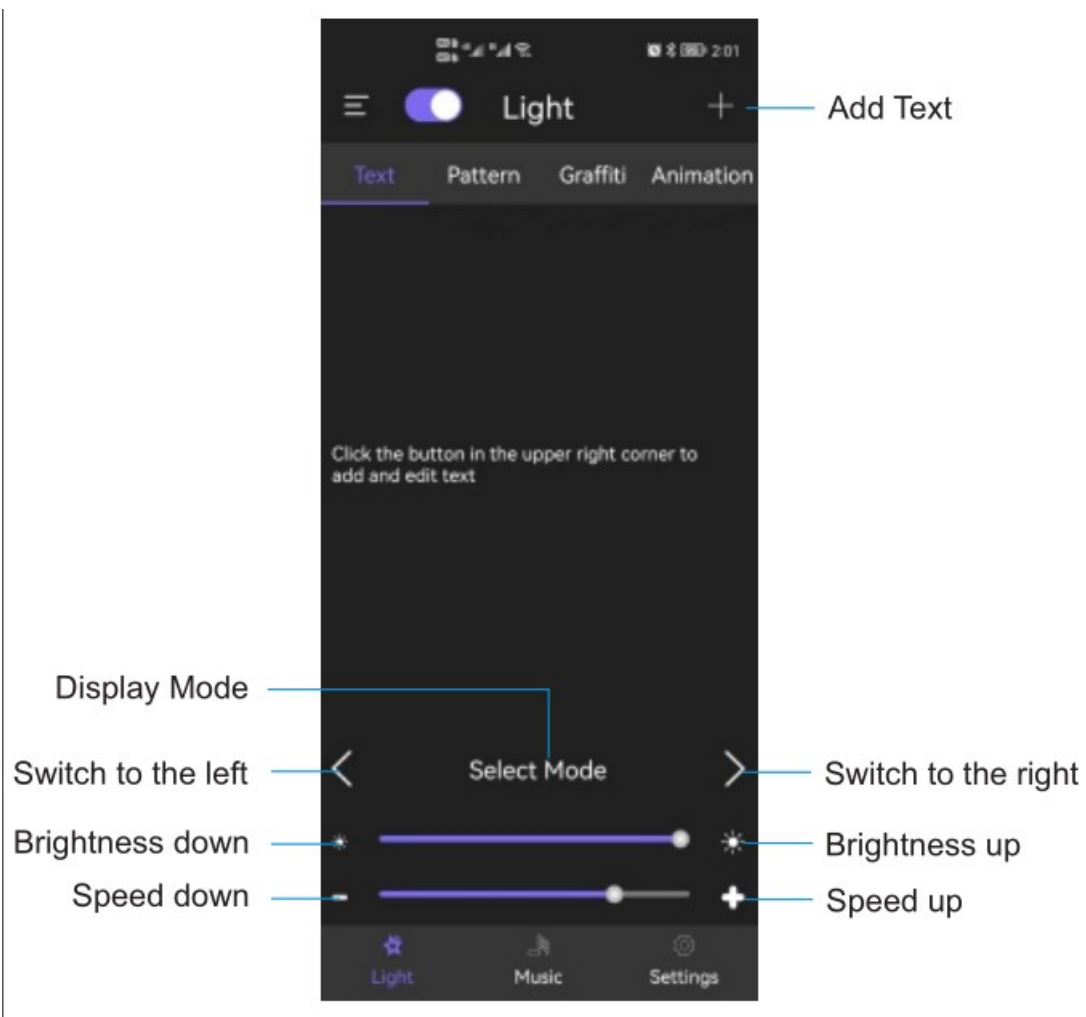

Pattern page

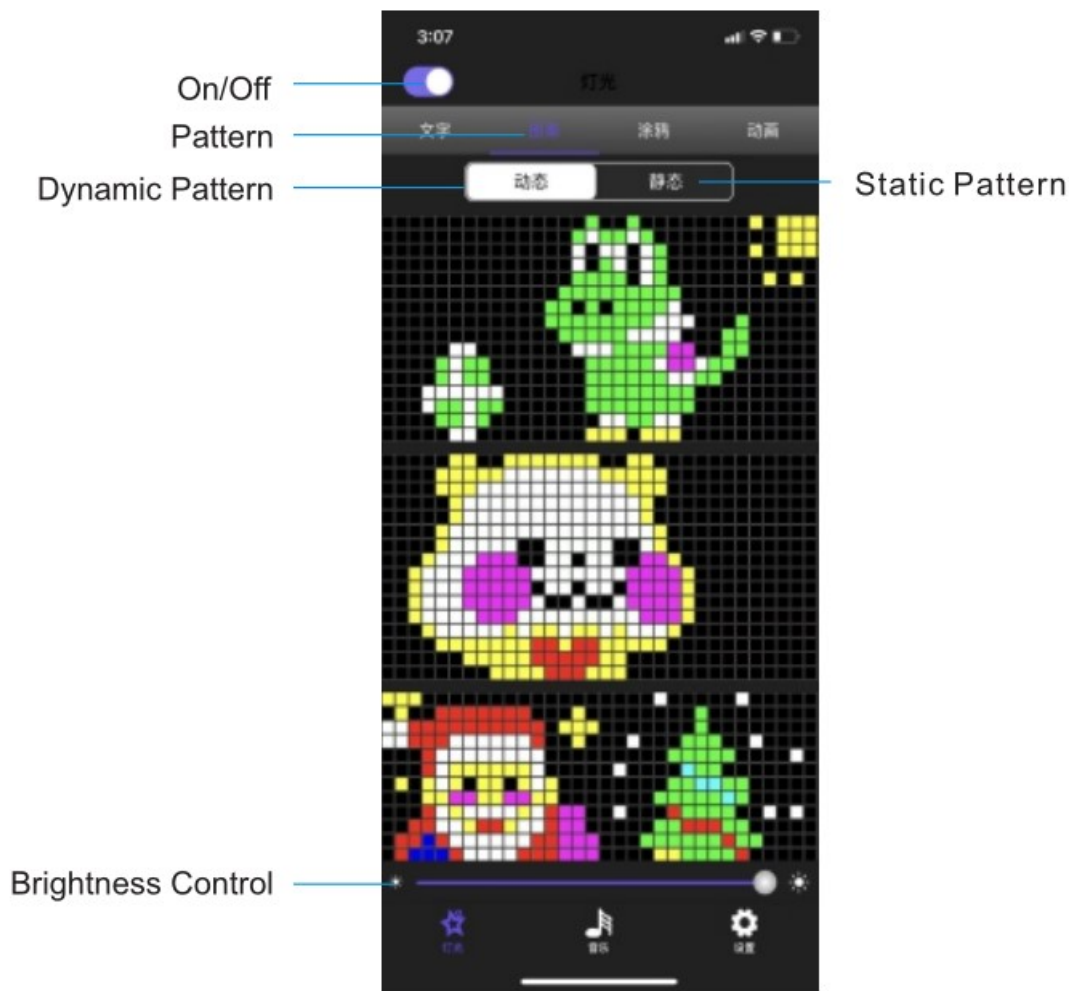

Graffiti page

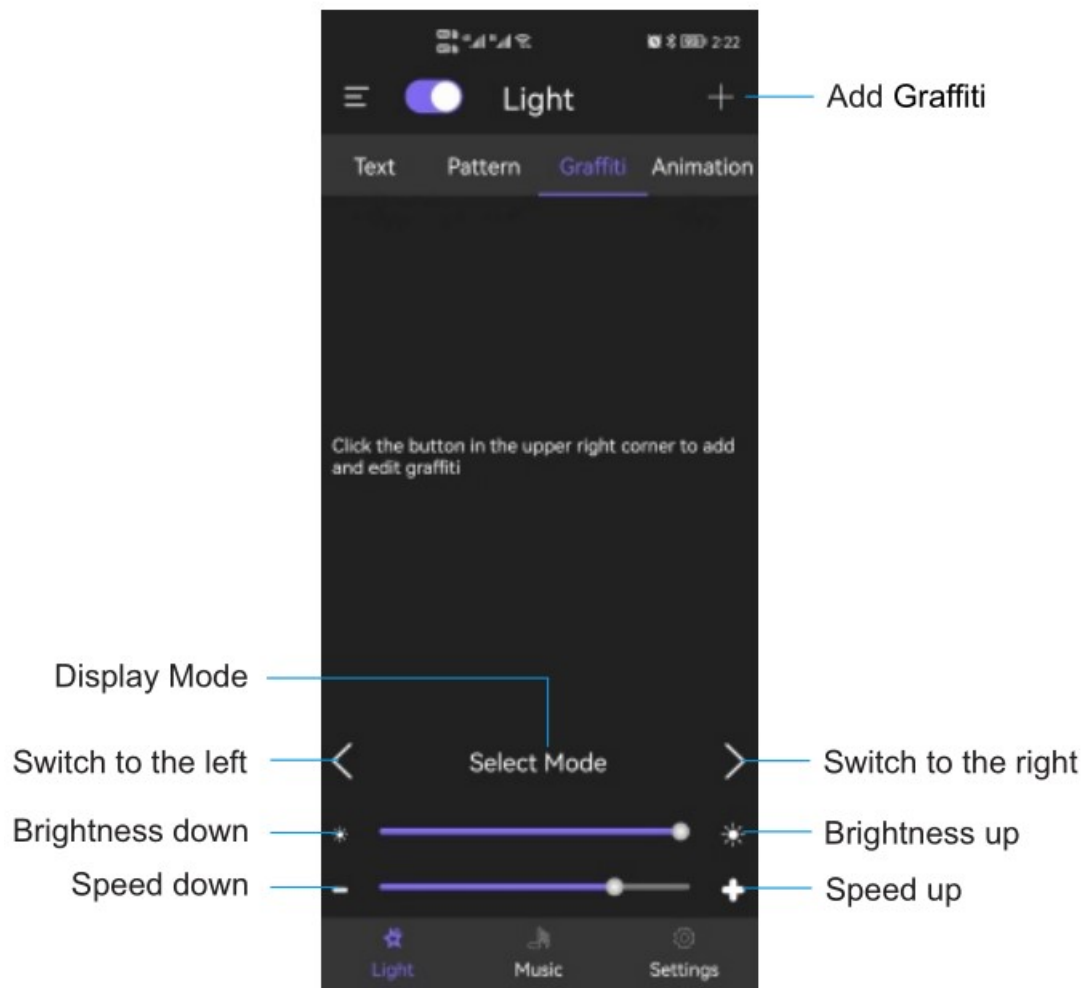

Animation page

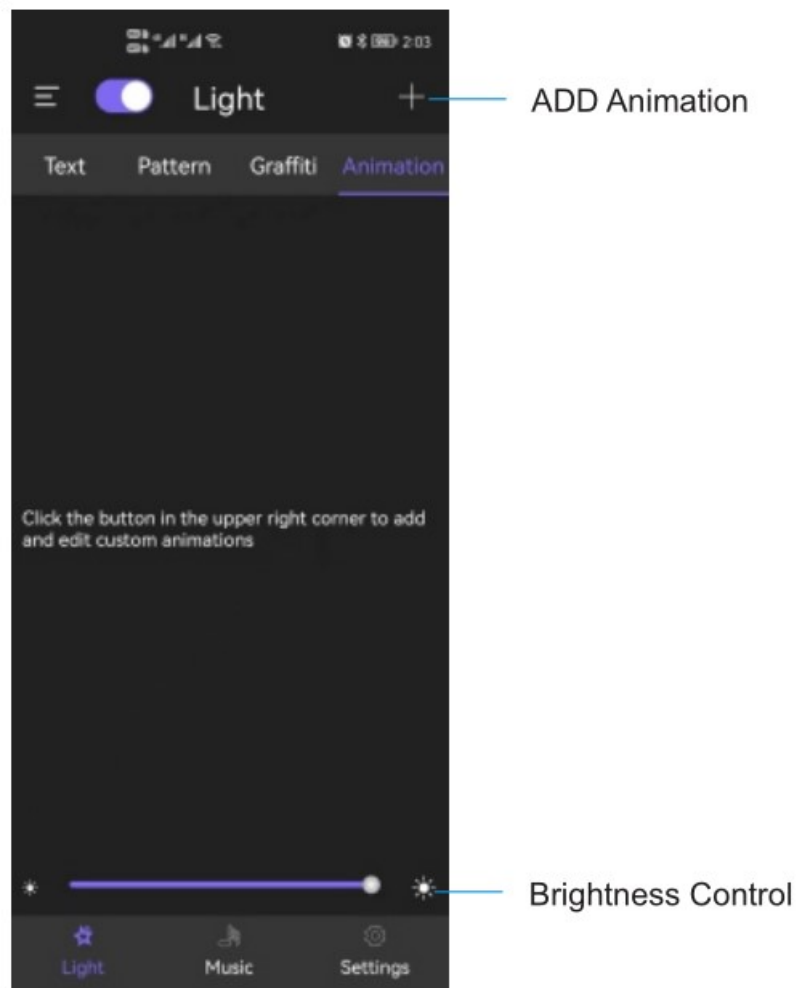

Music Mode

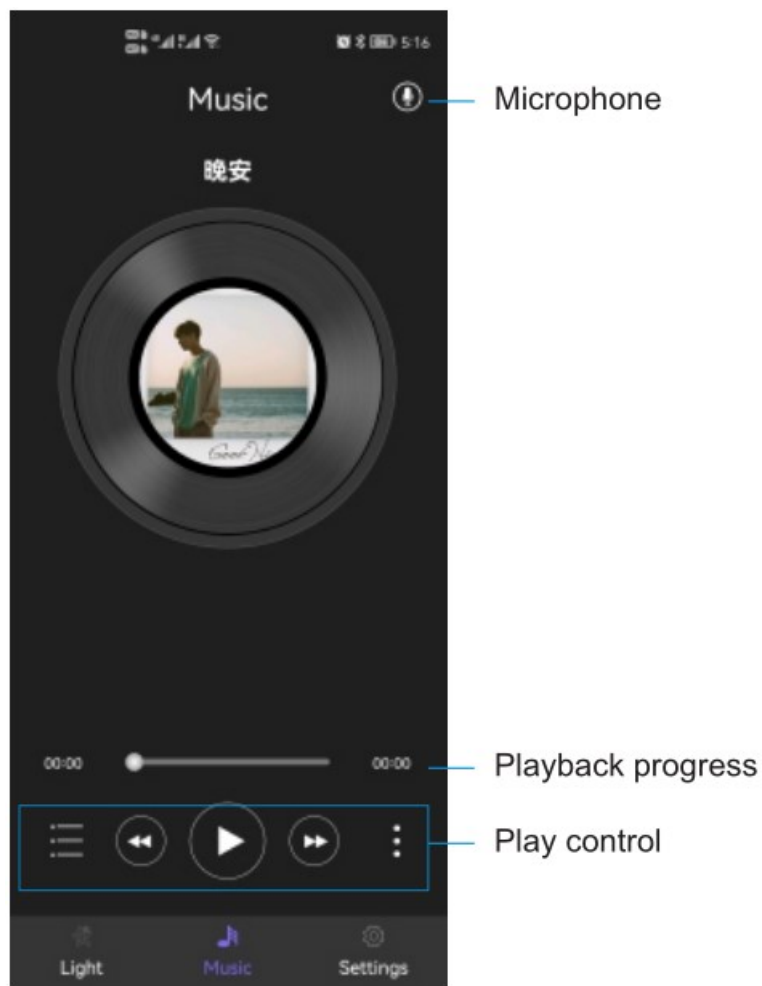

For iPhone users, you need to manually add music to the APP through your computer. Please check this:

Transfer music files through Window PC

1. Connect iPhone to Windows PC with USB.
2. In iTunes on Windows PC, click the iPhone button near the top left of the iTunes window.
3. Click File Sharing, select App (CoolLED1248) in the list, and transfer files from your computer to iPhone: Click Add, select the files you want to transfer, and then click Add.

Regarding the use of our APP, here we provide a demo video with detailed text explanations. You can use your mobile phone to scan the QR code below the text and view it in your browser.



Mic Mode

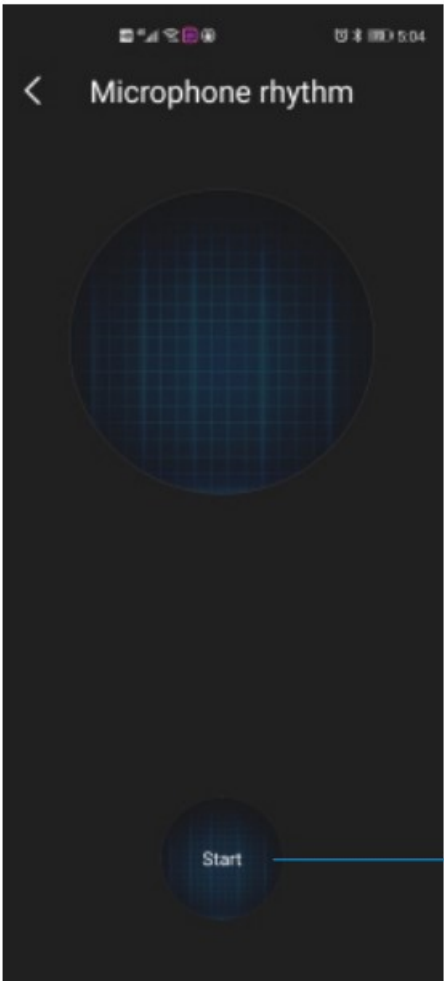

Start / Stop

Settings

3

LED Display User Guide

User Guide

1. Product Overview

This product is a flexible display package product. It is controlled by mobile phone APP, and supports modification of text, graphics, animation, etc. Smart, lightweight and easy to use.

2. Basic Function

- (1) Thin and bendable, easy to use.
- (2) Mobile APP control.
- (3) Support for dy Text, Graffiti, Animation, etc.

3. App download

Please scan the QR code to download the app or you can search "CoolLED1248" in the App Store / Google play



4

LED Display User Guide

If you cannot scan this 3 in 1 code, please check the two codes to download it



iOS

Android

4. App Overview

CoolLED1248 is an APP dedicated to controlling the display screen, supporting functions such as text editing, hand-painted graffiti, GY animation, music rhythm, etc. The operation is simple and convenient, and can be immediately displayed on the screen after modification.

Note: The APP operation interface of different display devices may be different, and the APP will be updated. The following operation instructions are for reference only, please refer to the actual operation interface.

5

LED Display User Guide

5. App Operation

1. Run the application, the APP will request the necessary permissions, please allow.
2. Then it will prompt "Allow CoolLED1248 to enable Bluetooth?", please click "ALLOW".

As the dialog below:



3. The application will automatically search the led display, and shows the device in the device list. If automatic search failed, please drop down the device list box, manually refresh.
4. Click the device need to be connected, waiting for connection state change from connecting to the connection is successful. If connection problem occurs, please drop down the refresh to connect the device. If you want to disconnect from the device, click the disconnect button.

6

LED Display User Guide

5.1 Device List



- Note:**
1. If you can't find the device, please pull down to refresh.
 2. If the device cannot be found after multiple refreshes, please check whether the permission is turned on and switch the device again.

7

LED Display User Guide

5.2 Main page

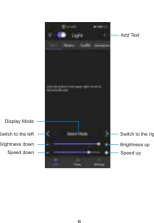

8

LED Display User Guide

5.3 Pattern page



9

LED Display User Guide

5.4 Graffiti page



10

LED Display User Guide

5.5 Animation page

KJOY JTPD-03-005 Smart LED Display [pdf] User Guide

JTPD-03-005, JTPD-03-005 Smart LED Display, Smart LED Display, LED Display, Display



10

LED Display User Guide

5.6 Music Mode



11

LED Display User Guide

For iPhone users, you need to manually add music to the APP through your computer. Please check this:
Transfer music files through Windows PC
1. Connect iPhone to Windows PC with USB.
2. In iTunes on Windows PC, click the iPhone button near the top left of the iTunes window.
3. Click File Sharing, select App (CoolLED1248) in the list, and transfer files from your computer to iPhone. Click Add, select the files you want to transfer, and then click Add.
Regarding the use of our APP, here we provide a demo video with detailed text explanations. You can use your mobile phone to scan the QR code below the text and view it in your browser.



12

LED Display User Guide

5.7 Mic Mode



13

LED Display User Guide

5.8 Settings



14