



KINGSLIM D5 4K Dash Cam with Built-in WiFi GPS User Manual

[Home](#) » [KINGSLIM](#) » KINGSLIM D5 4K Dash Cam with Built-in WiFi GPS User Manual 

Kingslim

USER MANUAL
KingSlim D5 Dash Cam



V1.0

Contents

- [1 What's in the Box](#)
- [2 Camera Overview](#)
- [3 Installation](#)
- [4 Icon Introduction](#)
- [5 Using the “Road Cam” App](#)
- [6 Specifications](#)
- [7 Documents / Resources](#)
 - [7.1 References](#)
- [8 Related Posts](#)

What's in the Box

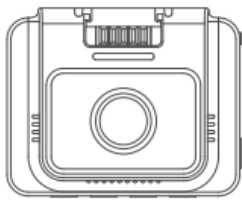

D5 Dash Cam * 1

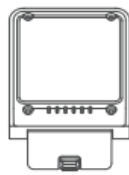

GPS Bracket * 1

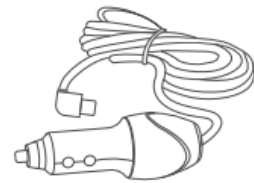

Car Charger with
3.5m Power Cable * 1



Cable Clips * 5



Double-sided
Adhesive Tape * 2

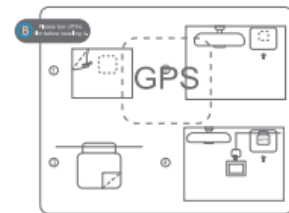

Static Sticker * 2



Pry Tool * 1

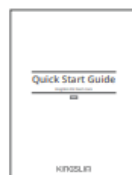

Quick Start Guide * 1

Camera Overview

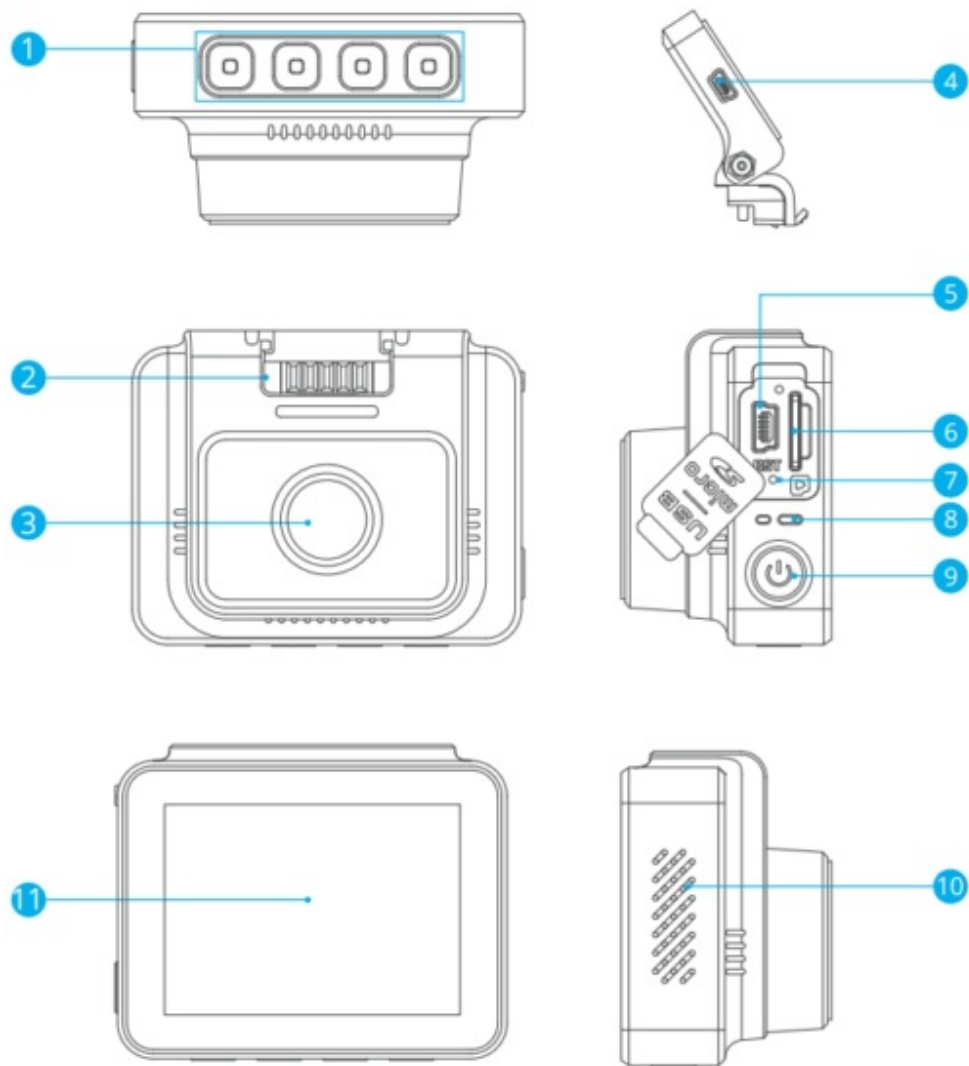

1	Function Button	6	Reset
2	Bracket Slot	7	Working Indicator
3	Front Camera	8	Power Button
4	Mini USB Power Port 1 (Power supply)	9	Speaker
5	Mini USB Power Port 2	10	Screen
6	microSD Card Slot		

Installation

1. Insert a microSD card.

Tip: The D5 Dash Cam supports a Class 10 or above microSD card of up to 256 GB (microSD card not included). Please format the card in the camera before using it in the dashcam. Do not remove or insert the microSD card when the dashcam is turned on as this may damage the card.

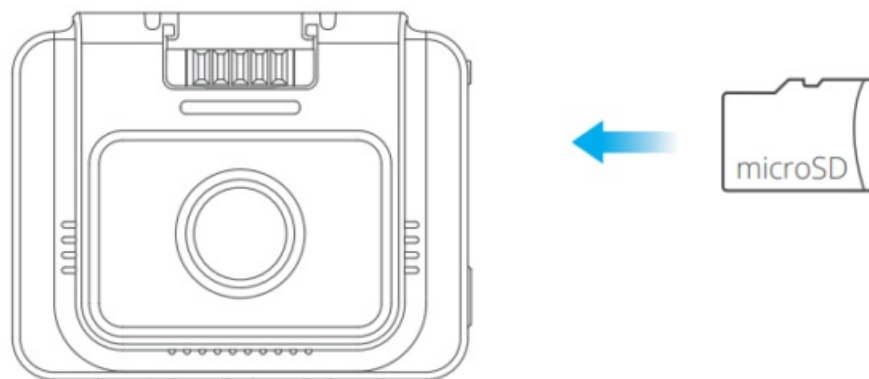

2. Insert the GPS bracket into the bracket slot.

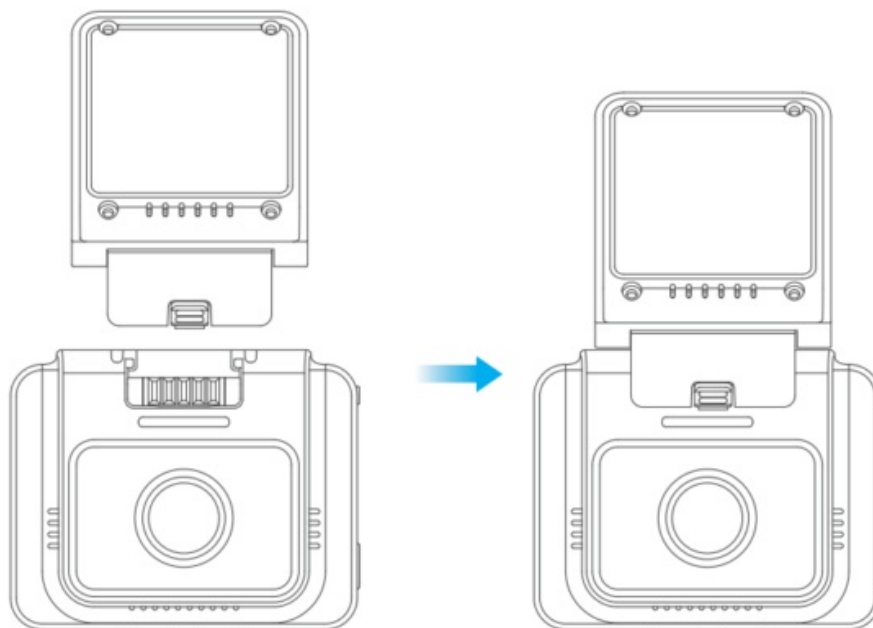

3. Install the D5 Dash Cam on the windshield.

- ① Clean the windshield with a dry cloth.
- ② Remove the static sticker film and apply the sticker to the windshield while making sure there are no air bubbles.
- ③ Peel off the film on one side of the double-sided adhesive tape and apply the tape to the D5 Dash Cam.
- ④ Peel off the film on the other side of the adhesive tape and press the D5 Dash Cam firmly to secure it on the static sticker (if you wish to remove the dashcam, please take off the static sticker).

Note: You can stick the dashcam to the windshield without using the static sticker.

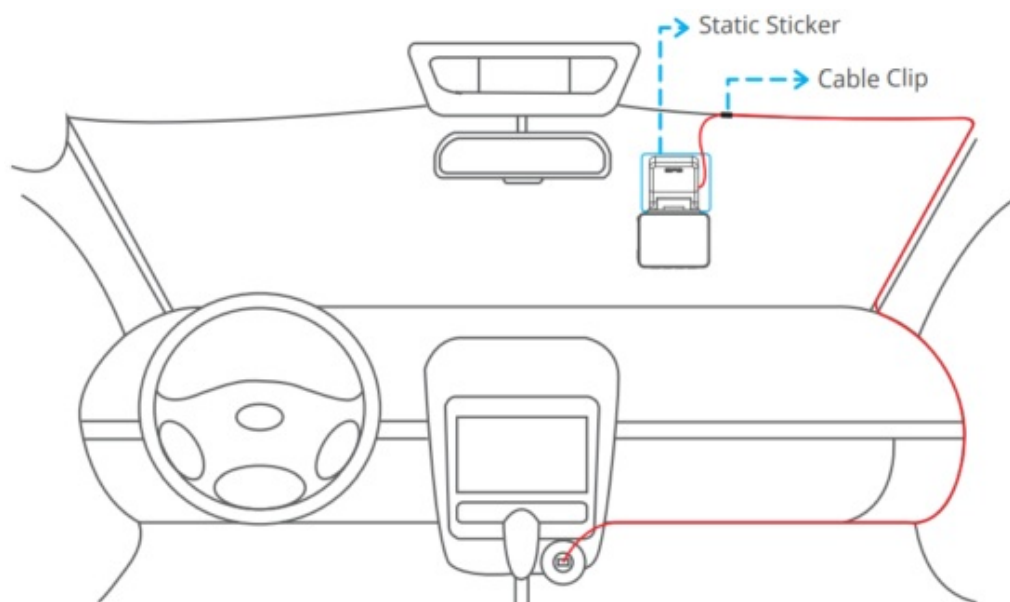



4. Adjust the viewing angle of the dashcam accordingly.
5. Connect the car charger to the dashcam. Plug the car charger into the cigarette lighter.
6. Use the pry tool to hide the cables.

Formatting the MicroSD Card

Please format the microSD in the camera before using this dashcam.

Tip: Do not remove or insert the microSD card when the dashcam is turned on as this may damage the card.

1. Press the  button to pause the recording.
2. Press the  button to enter the setting page.
3. Press the  button to select Format, then press the button.
4. Select “OK” and press the “Confirm” button.

Once formatting is complete, it will automatically exit this page.

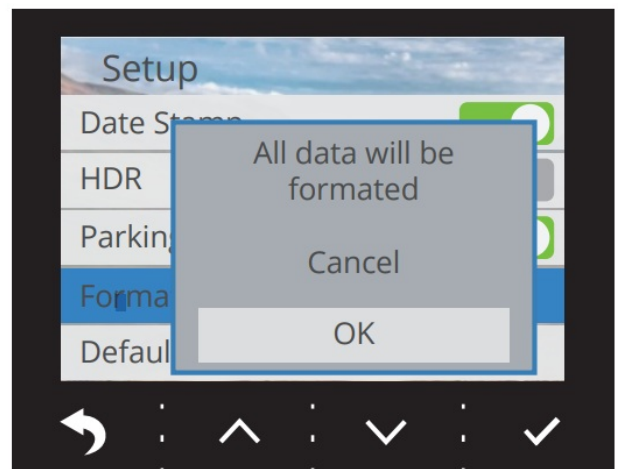
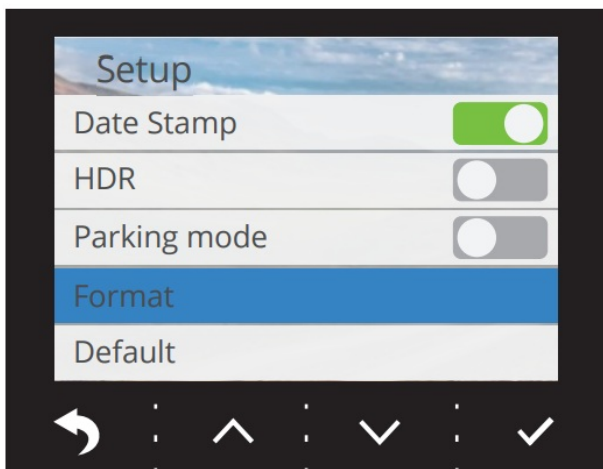

Video Recording

1. After formatting is complete, connect a car charger and start the engine; the device will automatically turn on and begin recording.
2. Loop recording is already enabled on the D5 Dash Cam; the default setting is 3 Minutes.
3. The G-sensor is already enabled on the D5 Dash Cam; the default setting is Low.

If an impact or sudden braking is detected, it will automatically start recording and save the footage in the “frontier” folder.

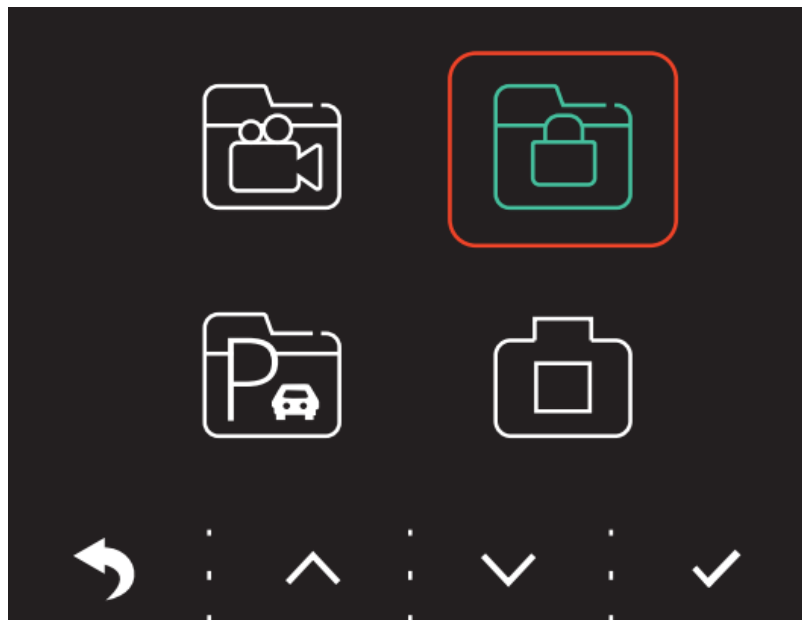

Viewing Album

1.



Press the 4th function button to stop recording.

2. Press the 2nd function button to enter the album.

Options:

1. Video
2. Emergency recording
3. Parking mode recording
4. Photo

Tips: To unlock the emergency recording, please enter the album, short press the power button, then select your option in the Unlock menu.

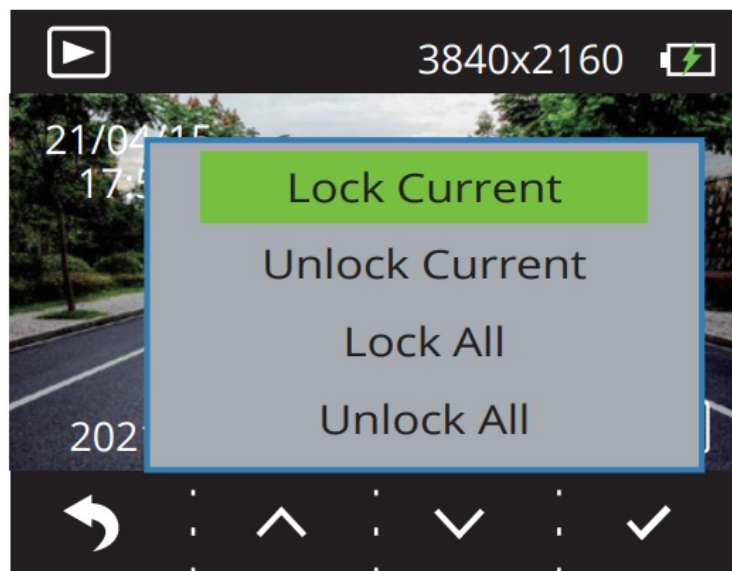

Icon Introduction

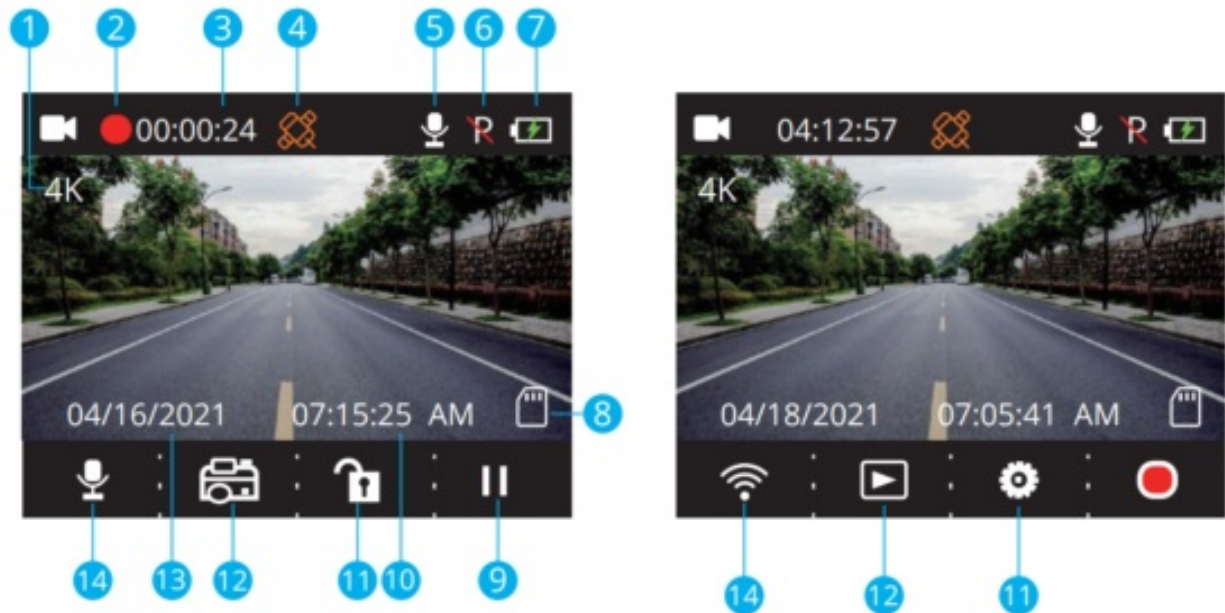

1	Recording Resolution	8	MicroSD Card Indicator
2	Recording Indicator	9	Stop/Start Recording
3	Video Time	10	Time
4	GPS	11	Setting/Emergency Recording
5	Microphone Indicator	12	Album/Photo
6	Parking Mode	13	Date
7	Power Status	14	WiFi Indicator/Audio Recording (Mute/Unmute)

1. Language

Select to switch language.

Options:

- English

Default setting: English

2. **Resolution**

Select to switch resolution.

Options:

- 4K P30
- 2K P30
- 1080P P60

Default setting: 4K P30

3. **Loop Recording**

If you choose the 3 Minutes option, the files will be saved every 3 minutes.

When the microSD card is full, new files will overwrite the old ones if Loop Recording is on. If it is off, the camera will stop recording when the card is full. You will then need to format the microSD card or insert a new one.

Options:

- 1 Minute
- 3 Minutes
- 5 Minutes
- Off

Default setting: 3 Minutes

4. **Beep Sound**

Turn the beep sound on/off.

Default setting: On

5. **Frequency**

Choose the right frequency to avoid flickering. This should be based on your local AC parameters.

Options:

- 60 Hz
- 50 Hz

Default setting: 60 Hz

6. **G-Sensor**

When G-Sensor Mode is turned on, it will automatically start recording and save content if an impact or sudden braking is detected. The videos will be locked and never overwritten by new files. The higher the sensitivity level, the easier it is to trigger the G-Sensor.

Options:

- Off
- Low
- Middle
- High

Default Setting: Low

7. **EV**

Select to change exposure.

Options:

- +0.0
- -1/3

- -2/3
- -1.0
- -4/3
- -5/3
- -2.0

Default setting: +0.0

8. **Time Zone**

Choose the time zone manually. The device will then display the time of the selected time zone.

Default setting: GMT – 5 (U.S. Eastern Time Zone)

9. **GPS**

Track your driving speed and show your preferred speed unit.

Options:

- KM/H
- MPH

Default setting: KM/H

10. **Screen Saver**

The display screen will turn off automatically after a set time. When the screen is turned off, power consumption will be reduced. The camera will still work while the screen is turned off. Just click the screen to turn it back on.

Options:

- Off
- 30 Seconds
- 1 Minute
- 2 Minutes

Default setting: 1 Minute

11. **Codec**

Select your video compression standard. H.265 is faster and more efficient than H.264.

Options:

- H.265
- H.264

Default setting: H.265

12. **Car No.**

Enter your license plate number and videos/photos will include it in the left or right corner.

13. **Date/Time**

Set the date and time manually.

14. **Motion Detection**

When Motion Detection is on, the D5 Dash Cam will detect whether you are driving or parked. If no movement is detected after 5 minutes of recording, Parking Mode will be activated.

Default setting: Off

15. **Time-lapse Recording**

When Time-lapse Recording is selected, the camera will take static photos to create a video montage.

Default setting: Off

16. Date Stamp

Select to add a date stamp to photos/videos.

Default setting: On

17. HDR

Select to turn HDR mode on/off.

Default setting: Off

18. Parking Mode

If there is an impact on the car during parking, the camera will turn on automatically and create a locked 20-second recording. The higher the selected level, the easier it is to trigger the recording.

Default setting: Off

19. Format

Format your memory card.

20. Default

Restore the default settings.

21. Version

Check the software version of the camera. This information may be required when technical support is needed.

Download the App and GPS Player

Download the "RoadCam" app on the App Store or Google Play.



Download the GPS player: www.kingslim.net/player

Using the "Road Cam" App

Connect the camera with the app.



1. Short press the fourth function button to stop recording on the D5 Dash Cam.

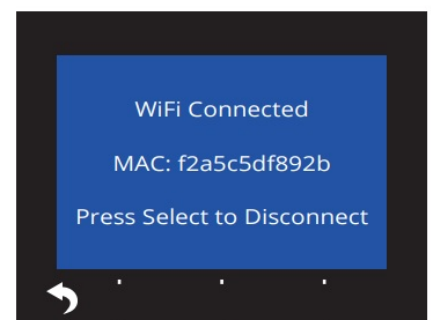
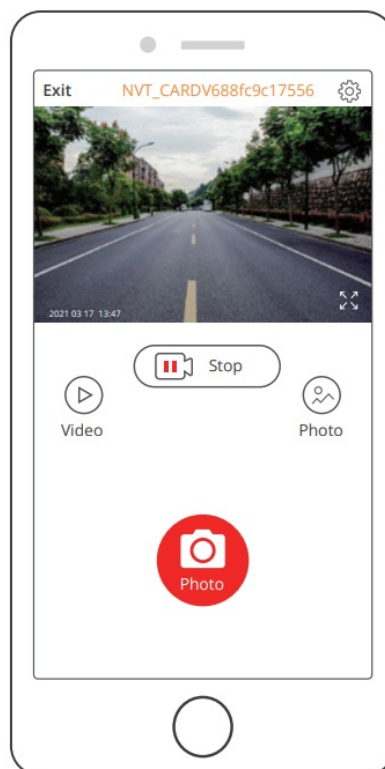
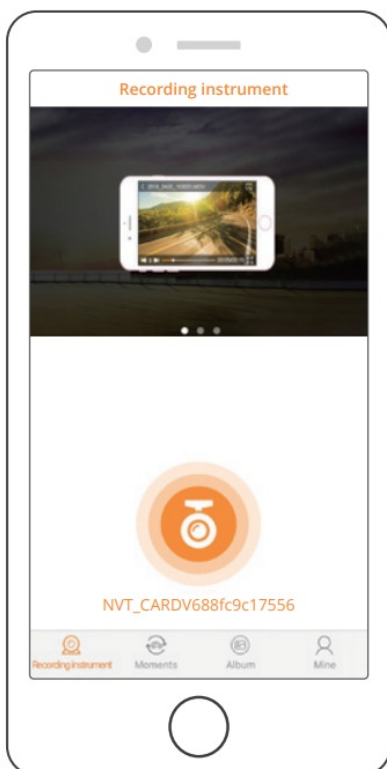

2. Short press the first function button to enter Wifi settings on the main menu.
3. Go to your smartphone's Wifi settings and connect to the Wifi name shown on the dashcam. Enter the password and confirm the Wifi network.
4. Open the "Road Cam" app, tap "NVT_CARDVxxxx" and wait a few seconds to enter the preview interface.
5. Tap the video or photo icon to control the D5 Dash Cam in either recording videos or shooting photos.

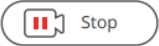

DOWNLOAD OR DELETE VIDEOS AND PHOTOS

1. Tap the  icon to stop recording.
2. Tap the  OR  icon to check the videos or photos.

3. Tap “Select” and choose the videos or photos that you want.
4. Tap the download or delete icon to download or delete.

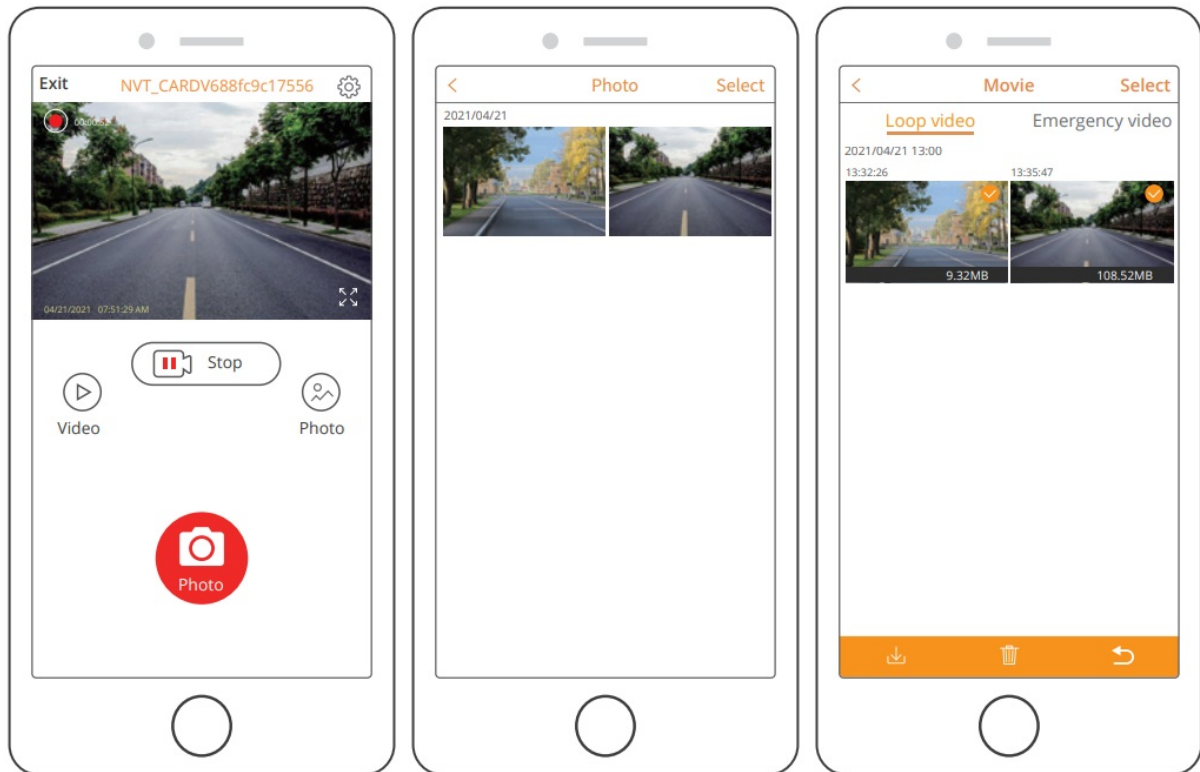

Note:

To exit Wifi settings, please press the first button on the dashcam.

To delete the emergency recording on the app, please unlock the video in the album by short pressing the power button to call out the Unlock menu.

Specifications

Video: 4K at 30 fps/2K at 30 fps/1080P at 60 fps

Video Coding: H.264/H.265

Working temperature: 20–60°C (-4–140°F)

Input: 5V DC

If your D5 Dash Cam is not working properly, please follow these troubleshooting steps:

1. The dashcam cannot record.

- Check whether the microSD card has enough space. Please back up any important data to other devices first, then format the microSD card.
- Check if Loop Recording in the Settings menu is set to Off.
Set “Loop Recording” to 3 minutes.

2. Recording stops automatically.

During recording, a large amount of high-definition video data is processed.
Please use a high-speed MicroSD card of Class 10 or higher.

3. A “File Error” prompt appears when playing back pictures and videos.

Please use a genuine MicroSD card. Please format the microSD card.

4. The image is misty.

Ensure that there are no fingerprints or other marks on the camera lens. Use a soft dry cloth to clean the lens.

Clean the front windshield.

5. The device crashes.

If your device crashes, use a sharp object to press the reset button and restart the device.

6. There is no sound in the video.

Ensure that Audio Recording Mode is on.

7. The camera keeps turning on and off automatically.

Please charge the camera with the included car charger. Do not charge the battery via the USB data cable with other adapters.

Caution

1. Please mount your device in a secure place and protect the lens from scratches and dirt.
2. Do not expose the device to rain, moisture or water under any circumstances.
3. Avoid leaving the device in direct sunlight for extended periods of time.
4. Do not dismantle or expose the internal battery.

Contact Us

For any inquiries about KingSlim products, please feel free to contact us.
We will respond within 24 hours.

Email: cs@kingslim.net

Tel: 888-811-1140 (US) Mon-Fri (except holiday) 9am-5pm (EST)

Official website: www.kingslim.net

The microSD, microSDHC, microSDXC, and SD marks and logos are trademarks of SD-3C, LLC.

Kingslim

Documents / Resources

	KINGSLIM D5 4K Dash Cam with Built-in WiFi GPS [pdf] User Manual D5, 4K Dash Cam with Built-in WiFi GPS, 4K Dash Cam
---	---

References

- [Kingslim-Dash Camera](#)
- [GPS Player & Kingslim APP](#)