



KICKER CWTB8 Loaded Weather-Proof Enclosures Owner's Manual

[Home](#) » [KICKER](#) » KICKER CWTB8 Loaded Weather-Proof Enclosures Owner's Manual 

Contents

- [1 KICKER CWTB8 Loaded Weather-Proof Enclosures](#)
- [2 CONTENTS](#)
- [3 HORIZONTAL INSTALLATION](#)
- [4 VERTICAL INSTALLATION](#)
- [5 SPECIFICATIONS](#)
- [6 ACOUSTICS LIMITED WARRANTY](#)
 - [6.1 INTERNATIONAL WARRANTY](#)
- [7 Documents / Resources](#)
- [8 Related Posts](#)



KICKER CWTB8 Loaded Weather-Proof Enclosures



CONTENTS

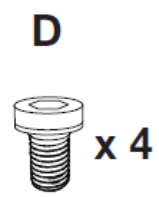
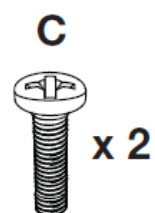
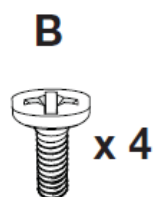
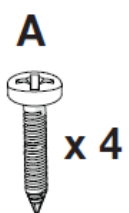
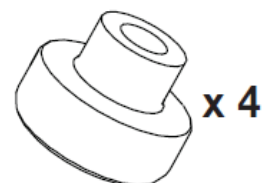
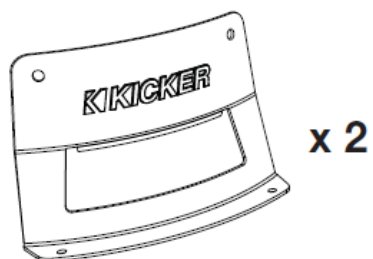
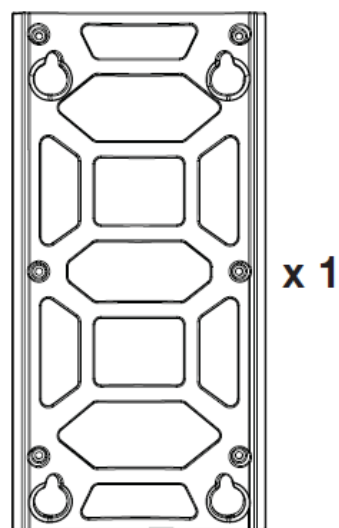
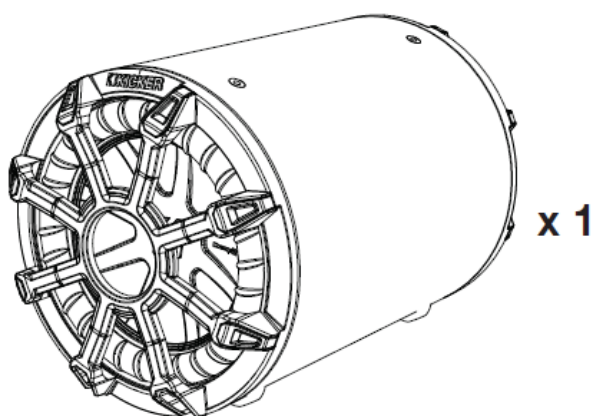

To avoid potential injury or possible death from forward movement of the enclosure during abrupt stops or accidents, the enclosure must be properly installed and securely fastened to your vehicle. You are solely responsible for securely fastening the enclosure in your vehicle.

HORIZONTAL INSTALLATION

Mount the horizontal mounting plate to the vehicle.

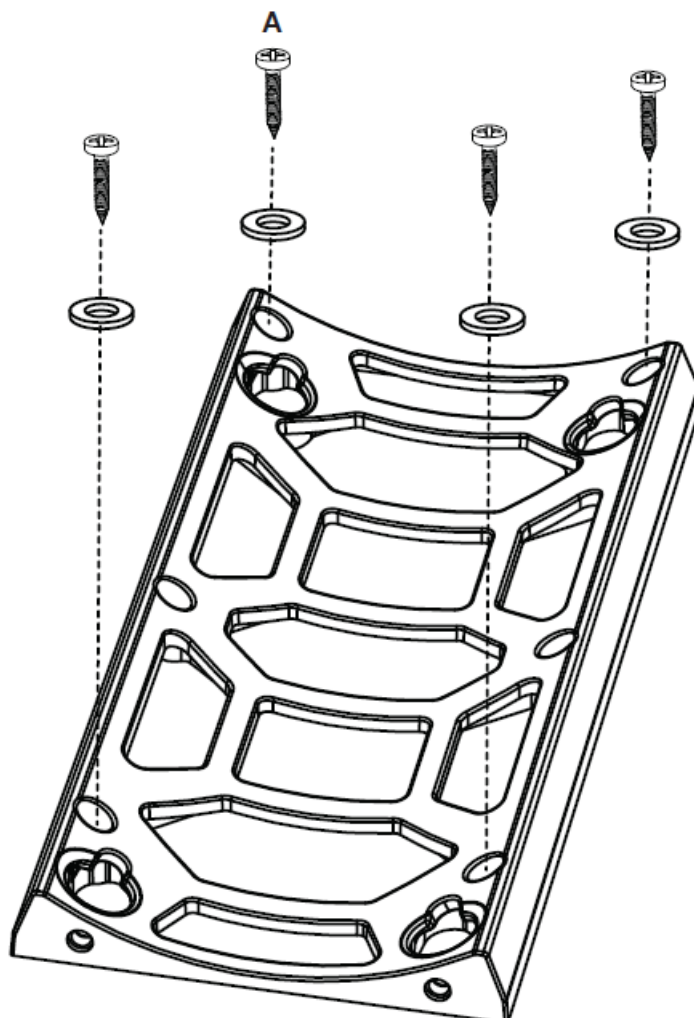

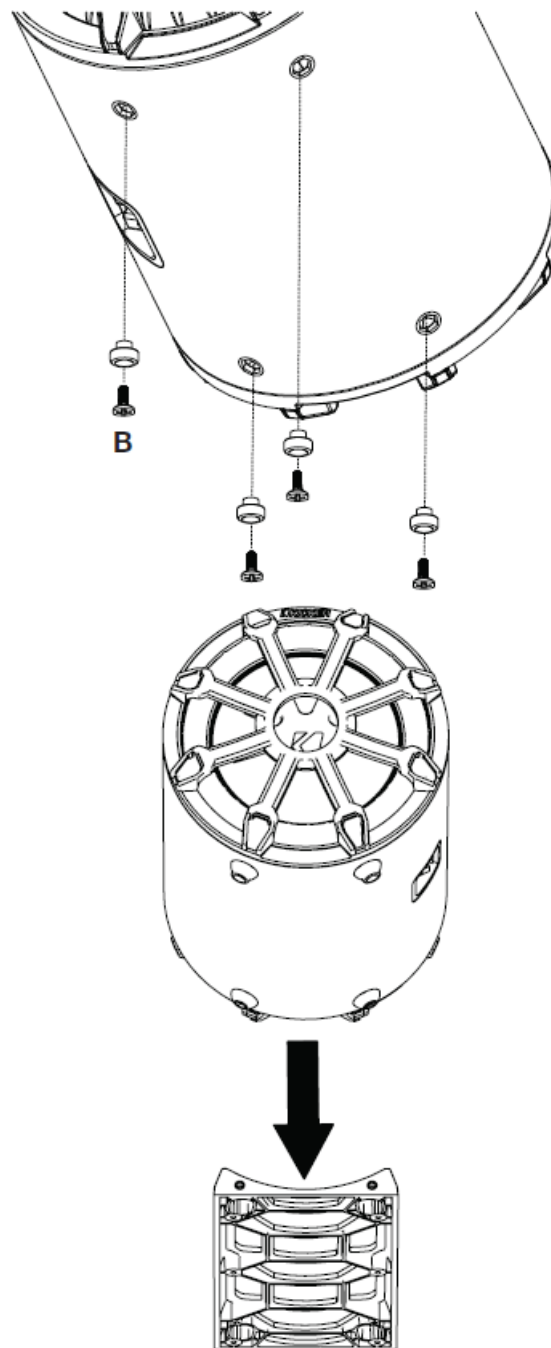

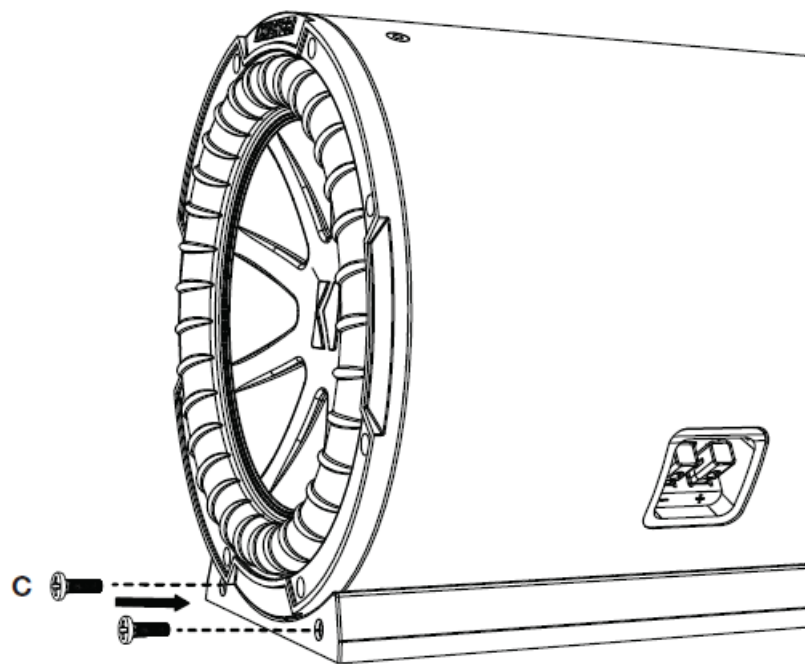
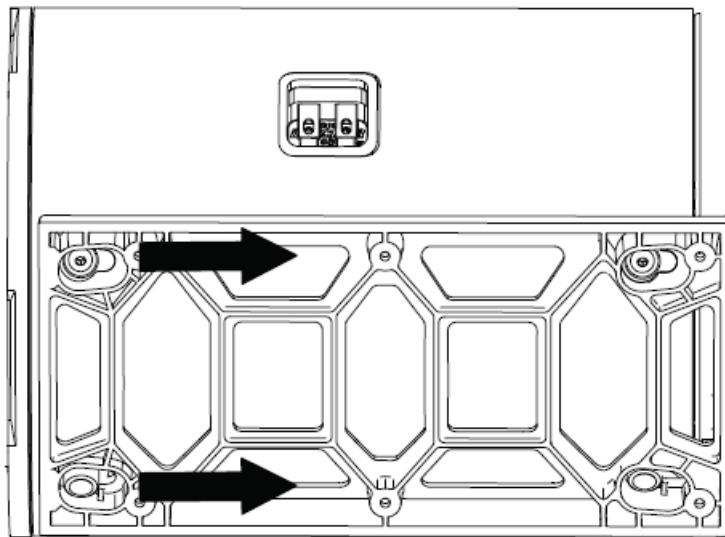

VERTICAL INSTALLATION

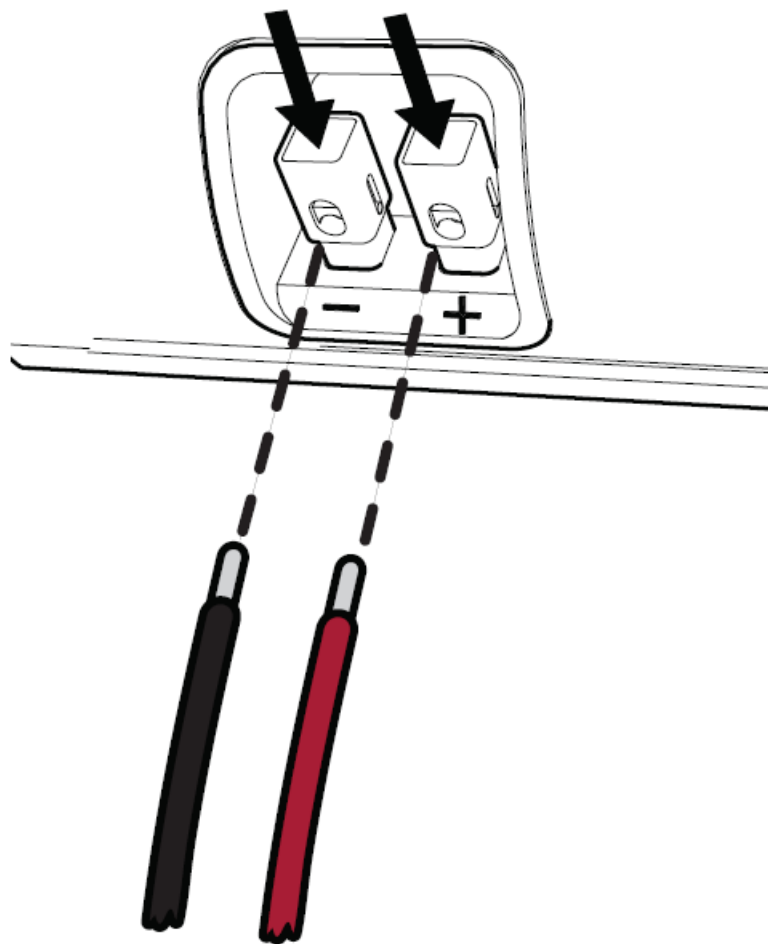

SPECIFICATIONS

SPECIFICATIONS		
Model	CWTB8	CWTB10
Rated Impedance [Ω]	2 or 4	2 or 4
Sensitivity [1W, 1m]	84.4 dB	85.7 dB
Continuous Power Handling [Watts RMS]	300	400
Frequency Response [Hz]	30–500	25–500
Enclosure Diameter [in., cm]	8-1/2, 21.6	10-5/8, 27
Enclosure Depth [in., cm]	12-7/8, 32.8	16-9/16, 42.1
Enclosure Height (hor. mount) [in., cm]	8-3/4, 22.2	10-15/16, 27.7
Enclosure Height (vert. mount) [in., cm]	13-7/16, 34.1	17-1/16, 43.4

WARNING: KICKER products are capable of producing sound levels that can permanently damage your hearing! Turning up a system to a level that has audible distortion is more damaging to your ears than listening to an undistorted system at the same volume level. The threshold of pain is always an indicator that the sound level is too loud and may permanently damage your hearing. Please use common sense when controlling volume.

IMPORTANT SAFETY WARNING – PROLONGED CONTINUOUS OPERATION OF AN AMPLIFIER IN A DISTORTED OR CLIPPED MANNER CAN CAUSE YOUR AUDIO SYSTEM TO OVERHEAT, POSSIBLY CATCHING FIRE AND RESULTING IN SERIOUS DAMAGE TO YOUR COMPONENTS AND/OR VEHICLE.

ACOUSTICS LIMITED WARRANTY

When purchased from an Authorized KICKER Dealer, KICKER warrants this product to be free from defects in material and workmanship under normal use for a period of ONE (1) YEAR from date of original purchase. If this product is identified as "Refurbished" or "B Goods", the warranty is limited to a period of THREE (3) MONTHS from date of original purchase. In all cases you must have the original receipt. Should service be necessary under this warranty for any reason due to manufacturing defect or malfunction during the warranty period, KICKER will repair or replace (at its discretion) the defective merchandise with equivalent merchandise. Warranty replacements may have cosmetic scratches and blemishes. Discontinued products may be replaced with more current equivalent products. This warranty is valid only for the original purchaser and is not extended to owners of the product subsequent to the original purchaser. Any applicable implied warranties are limited in duration to a period of the express warranty as provided herein beginning with the date of the original purchase at retail, and no warranties, whether express or implied, shall apply to this product thereafter. Some states do not allow limitations on implied warranties; therefore, these exclusions may not apply to you. This warranty gives you specific legal rights; however you may have other rights that vary from state to state.

WHAT TO DO IF YOU NEED WARRANTY OR SERVICE:

Defective merchandise should be returned to your local Authorized Stillwater Designs (KICKER) Dealer for warranty service. Assistance in locating an Authorized Dealer can be found at www.kicker.com or by contacting Stillwater Designs directly. You can confirm that a dealer is authorized by asking to see a current authorized dealer window decal.

If it becomes necessary for you to return defective merchandise directly to Stillwater Designs (KICKER), call the KICKER Customer Service Department at (405) 624-8510 for a Return Merchandise Authorization (RMA) number. Package only the defective items in a package that will prevent shipping damage, and return to: Stillwater Designs, 3100 North Husband St, Stillwater, OK 74075

The RMA number must be clearly marked on the outside of the package. Please return only defective component systems. The return of functioning items increases your return freight charges. Non-defective items will be returned freightcollect to you. For example, if a subwoofer is defective, only return the defective subwoofer, not the entire enclosure. Include a copy of the original receipt with the purchase date clearly visible, and a "proof-of-purchase" statement listing the Customer's name, Dealer's name and invoice number, and product purchased. Warranty expiration on items without proof-of-purchase will be determined from the type of sale and manufacturing date code. Freight must be prepaid; items sent freight-collect, or COD, will be refused.

WHAT IS NOT COVERED?

This warranty is valid only if the product is used for the purpose for which it was designed. It does not cover:

- Damage due to improper installation
- Subsequent damage to other components
- Damage caused by exposure to excessive heat, chemical cleaners, and/or UV radiation
- Damage through negligence, misuse, accident or abuse.

Repeated returns for the same damage may be considered abuse

- Any cost or expense related to the removal or reinstallation of product
- Speakers damaged due to amplifier clipping or distortion
- Items previously repaired or modified by any unauthorized repair facility
- Return shipping on non-defective items
- Products with tampered or missing barcode labels
- Products with tampered or missing serial numbers

- Products returned without a Return Merchandise Authorization (RMA) number
- Products purchased from an UNAUTHORIZED dealer
- Freight Damage
- The cost of shipping product to KICKER
- Service performed by anyone other than KICKER

HOW LONG WILL IT TAKE?

KICKER strives to maintain a goal of one-week service for all acoustics (subwoofers, midrange drivers, tweeters, crossovers, etc) returns. Delays may be incurred if lack of replacement inventory or parts is encountered. Failure to follow these steps may void your warranty. Any questions can be directed to the KICKER Customer Service Department at (405) 624-8510. Contact your International KICKER dealer or distributor concerning specific procedures for your country's warranty policies.

INTERNATIONAL WARRANTY

Contact your International Kicker dealer or distributor concerning specific procedures for your country's warranty policies.

Our goods come with guarantees that cannot be excluded under the Australian Consumer Law. You are entitled to a replacement or refund for a major failure and for compensation for any other reasonably foreseeable loss or damage. You are also entitled to have the goods repaired or replaced if the goods fail to be of acceptable quality and the failure does not amount to a major failure.

Documents / Resources

	<p>KICKER CWTB8 Loaded Weather-Proof Enclosures [pdf] Owner's Manual CWTB10, CWTB8, Loaded Weather-Proof Enclosures, CWTB8 Loaded Weather-Proof Enclosures, Weather-Proof Enclosures, Proof Enclosures, Enclosures</p>
---	--