



Kezhi K20 Mechanical Keyboard User Manual

[Home](#) » [Kezhi](#) » Kezhi K20 Mechanical Keyboard User Manual 

K2zi

K68 Pro
K20
MECHANICAL KEYBOARD

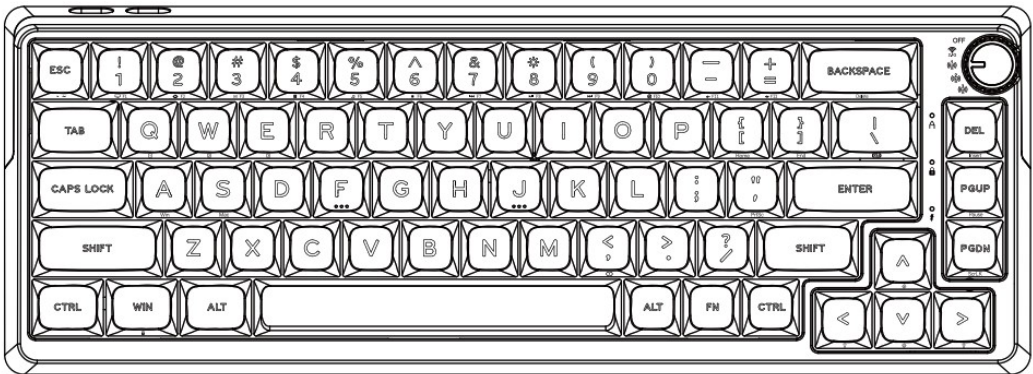

Contents

- 1 PRODUCT BASIC INFORMATION
- 2 INDICATOR LIGHT
- 3 WIERD MODE
- 4 BT CONNECTION
- 5 2.4G RECEIVER CONNITION
- 6 BACKLIGHT CONTROL
- 7 FN KEY
- 8 SPECIAL FUNCTION KEYS
- 9 KEYBOARD BATTERY LEVEL INDICATION AND CHECK
- 10 WINDOWS MULTIMEDIA KEYS
- 11 MAC MULTIMEDIA KEYS
- 12 ISED STATEMENT:
- 13 Documents / Resources
 - 13.1 References
- 14 Related Posts

PRODUCT BASIC INFORMATION



Manual



Switch and Keycaps Puller

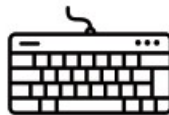

Keyboard



Type-C Cable



2.4G Receiver

INDICATOR LIGHT

K68Pro	Caps Lock 	Win Lock 	 Charging indicator: Breath mode during charging, steady light when fully charged, and low voltage blinking.
K20	Num 	 Charging indicator: Solid light during charging, off when fully charged, and flashing when battery is low	

	Size	Layout	Version	Backlit	Key Switches
K68PRO	329.4(L)x118.15(W)x37.9(H)±2	67 keys	USB- wired/2.4G wireless/BT	RGB	Mechanical switches
K20	89.7(L)x 132.5(W) x 38.3(H)±2	19 keys			

WIERD MODE

K68Pro

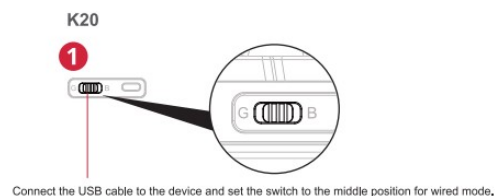
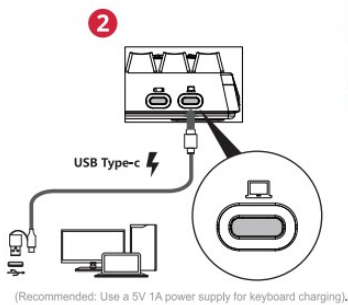
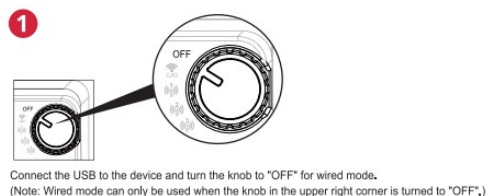

BT CONNECTION

K68Pro

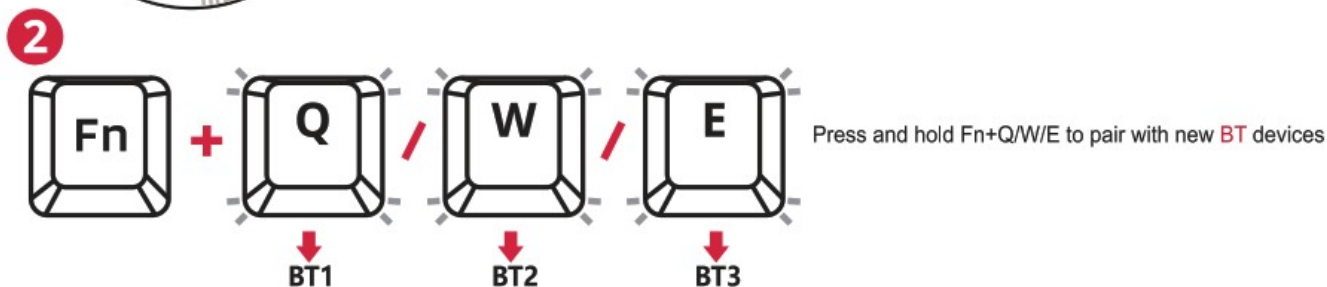
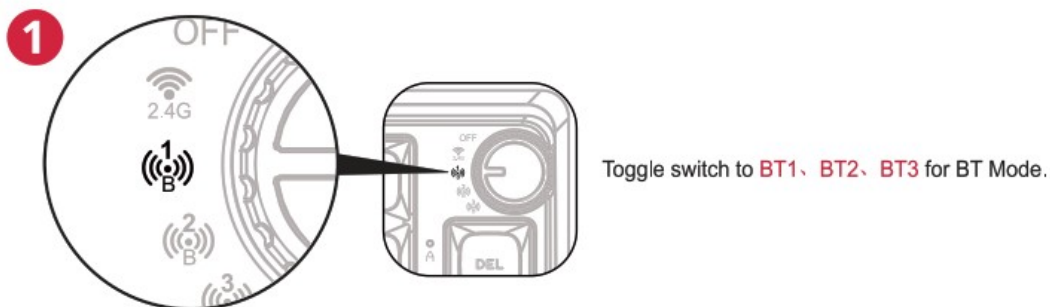

K20

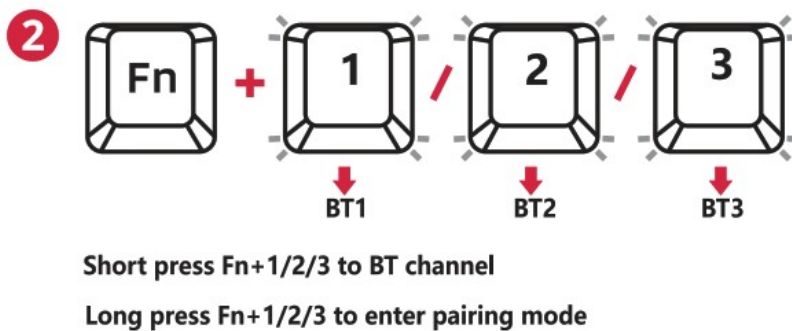
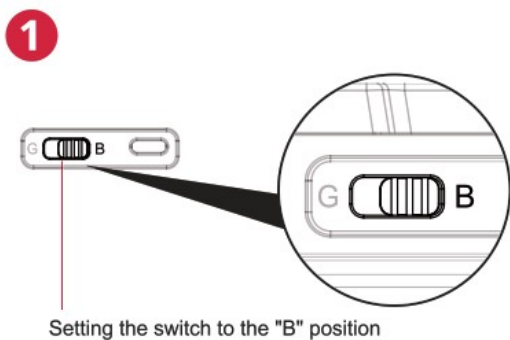

2.4G RECEIVER CONNITION

K68Pro

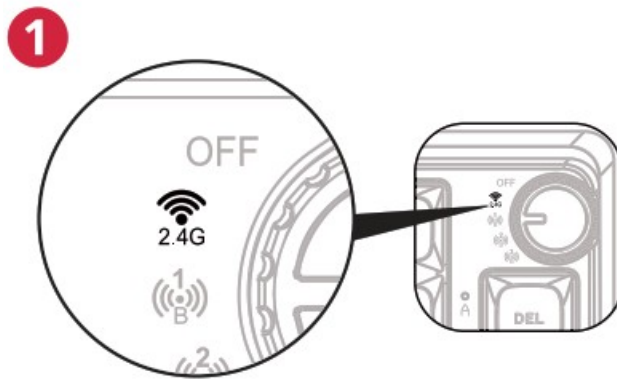

1. Switch to the 2.4G position,

Press and hold FN+P to pair,

As the P key flashing, plug the receiver into the device. if the P key stops flashing, pairing is successful.

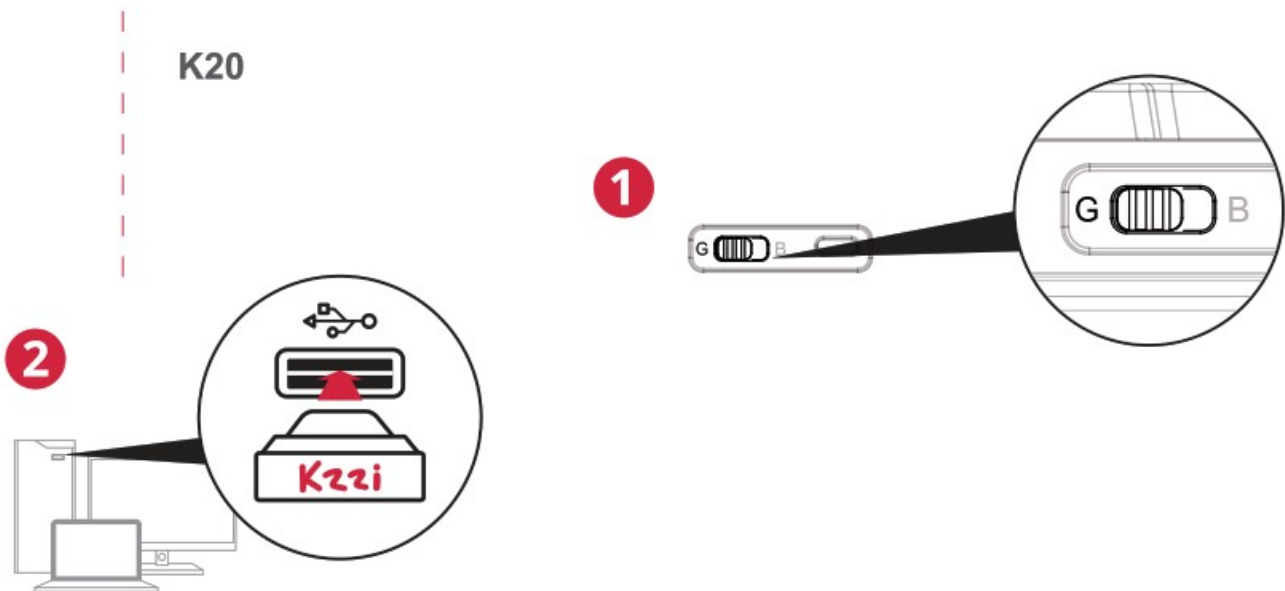

1. Switch to the *G" position. To pair the receiver,

2. long-press FN + 0. The 0 key will flash. Insert the receiver and wait for the flashing to stop, indicating successful pairing.

Tips: The receiver is set to be paired at the factory You just need to set it only once, when pairing not working properly.

BACKLIGHT CONTROL

K68Pro

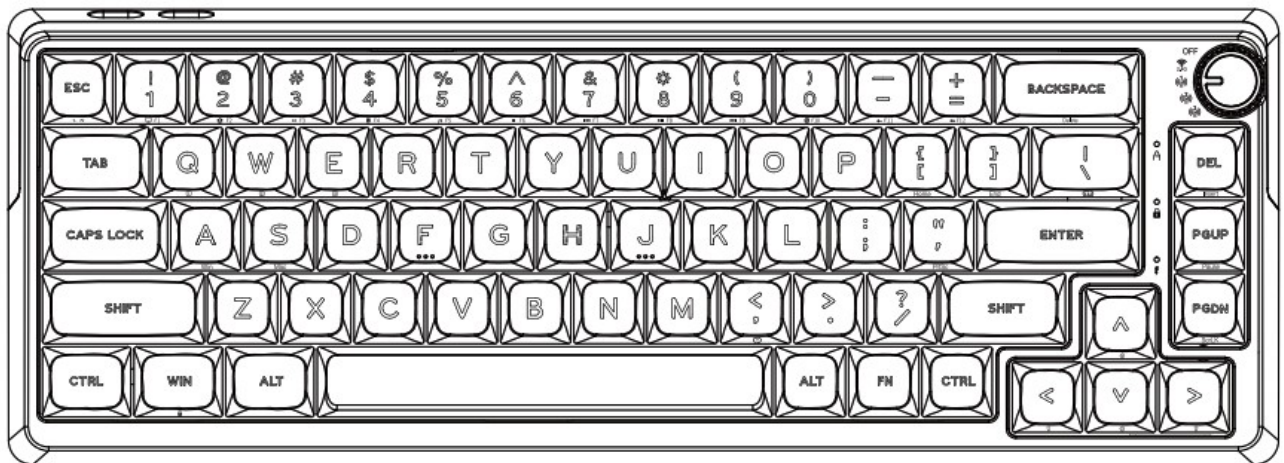

- | | |
|---------------------------------------|--|
| + Multiple backlight effects switch | + Backlight monochrome switching |
| + Backlight brightness + | + Backlight speed - |
| + Backlight brightness - | + Backlight speed + |
| + Windows lock | + Long-press for three seconds to restore factory settings |

K20

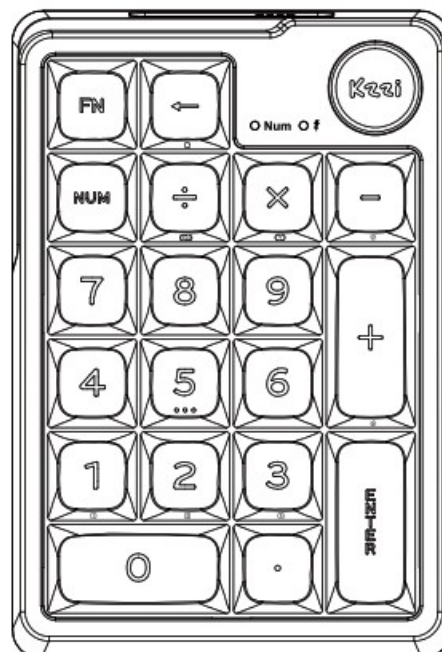

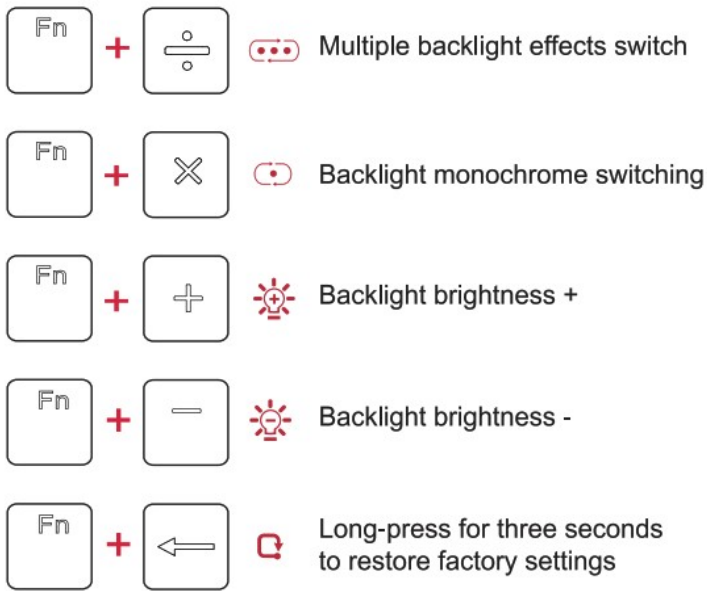

FN KEY

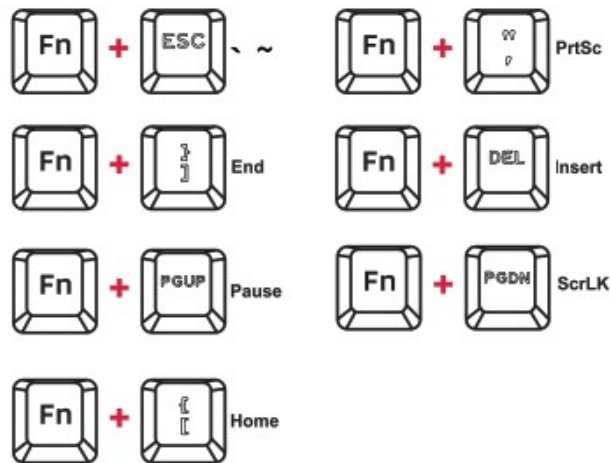

SPECIAL FUNCTION KEYS

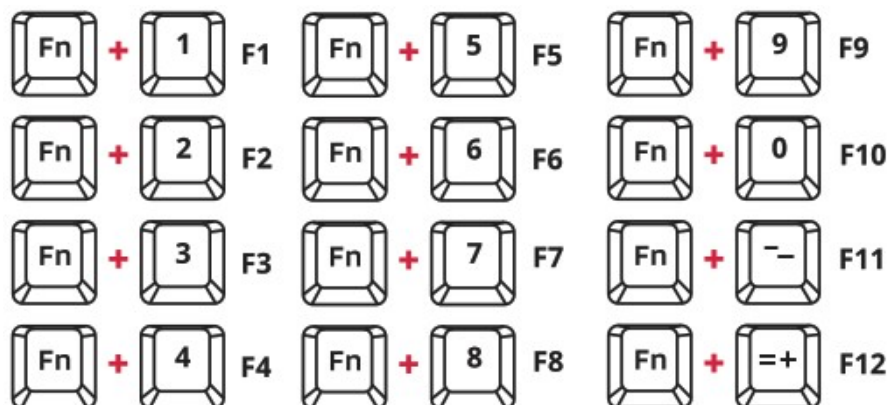

KEYBOARD BATTERY LEVEL INDICATION AND CHECK

K68Pro

The keyboard's lighting can display the current battery level status.

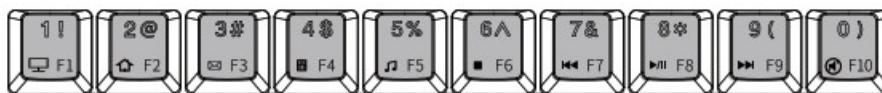

Pressing FN+ ENTER allows you to view the battery level status. Each key from “1° to “0” represents a specific battery level range.

For example:



The backlight of the “1°” key is illuminated, indicating that the keyboard’s current battery level is at 10%.



The “1°” and “2°” keys are both illuminated, indicating that the keyboard’s current battery level is at 20%.



When both the “1°” and “0°” keys are illuminated, it signifies that the keyboard’s battery level is at 100%.

K20



1. Volume mode (default): Rotating the knob clockwise increases the volume, rotating it counterclockwise decreases the volume, and pressing the knob mutes the sound (the knob lights up red while rotating).
2. Backlight mode: Clockwise rotation increases brightness, counterclockwise rotation decreases brightness, and pressing the knob toggles between lighting effects (knob lights up green while rotating).
3. Mouse scroll wheel mode: Rotating the knob clockwise scrolls down, rotating it counterclockwise scrolls up (the knob lights up blue while rotating).

WINDOWS MULTIMEDIA KEYS

In Windows mode (FN+A: Switch to Windows system)

FN + Left Ctrl (Swap primary key function and secondary function of compound keys)



Computer



Calculator



Previous Song



Mute



Browser



Media Player



Play/Pause



Volume -



Email



Stop



Next Song



Volume +

MAC MULTIMEDIA KEYS

In macOS mode (FN+S: Switch to macOS system)

FN + Left Ctrl (Swap primary key function and secondary function of compound keys)



ISED STATEMENT:

This device contains licence-exempt transmitter(s)/receiver(s) that comply with Innovation, Science and Economic Development Canada's licence-exempt RSS(s). Operation is subject to the following two conditions:

1. This device may not cause interference.
2. This device must accept any interference, including interference that may cause undesired operation of the device.

The digital apparatus complies with Canadian CAN ICES-3 (B)/NMB-3(B).

This device meets the exemption from the routine evaluation limits in section 2.5 of RSS 102 and compliance with RSS 102 RF exposure, users can obtain Canadian information on RF exposure and compliance

This equipment complies with Canada radiation exposure limits set forth for an uncontrolled environment

BATTERIES:

A warning that batteries (battery pack or batteries installed) shall not be exposed to excessive heat such as sunshine, fire or the light.

1. Replacement of a battery with an incorrect type that can defeat a safeguard;
2. Disposal of a battery into fire or a hot oven, or mechanically crushing or cutting of a battery, that can result in an explosion;
3. Leaving a battery in an extremely high temperature surrounding environment that can result in an explosion or the leakage of flammable liquid or gas;
4. A battery subjected to extremely low air pressure that may result in an explosion or the leakage of flammable liquid or gas.

12 MONTHS WARRANTY

Non-human damage 12-month warranty

Thank you for choosing KZZI products! If you have any questions or need assistance, please feel free to contact us. Our team is dedicated to providing support and addressing your inquiries.

We highly value your feedback and suggestions as they help us continuously improve and enhance product quality. Once again, we appreciate your support for KZZI!

KZZI

Hot-line: 400-0221-288

Email: kzzi@kzzi.com

Official Website: www.kzzi.com

Brand: Kezhi(huizhou)Electronic Technology Co., Ltd

Executive standard: GB /T 14081-2010

Documents / Resources

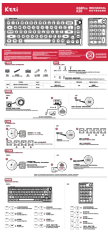
	<p>Kezhi K20 Mechanical Keyboard [pdf] User Manual</p> <p>K20 Mechanical Keyboard, K20, Mechanical Keyboard, Keyboard</p>
---	---

References

- [User Manual](#)

[Manuals+](#), [Privacy Policy](#)

This website is an independent publication and is neither affiliated with nor endorsed by any of the trademark owners. The "Bluetooth®" word mark and logos are registered trademarks owned by Bluetooth SIG, Inc. The "Wi-Fi®" word mark and logos are registered trademarks owned by the Wi-Fi Alliance. Any use of these marks on this website does not imply any affiliation with or endorsement.