



Keychron V2 Max Wireless Mechanical Keyboard User Manual

[Home](#) » [Keychron](#) » **Keychron V2 Max Wireless Mechanical Keyboard User Manual**

Contents

- 1 Keychron V2 Max Wireless Mechanical Keyboard
- 2 Fully Assembled Version
- 3 Barebone Version
- 4 Quick Start Guide
- 5 Documents / Resources
 - 5.1 References



Keychron V2 Max Wireless Mechanical Keyboard



Fully Assembled Version

Keyboard

1x Fully Assembled Keyboard

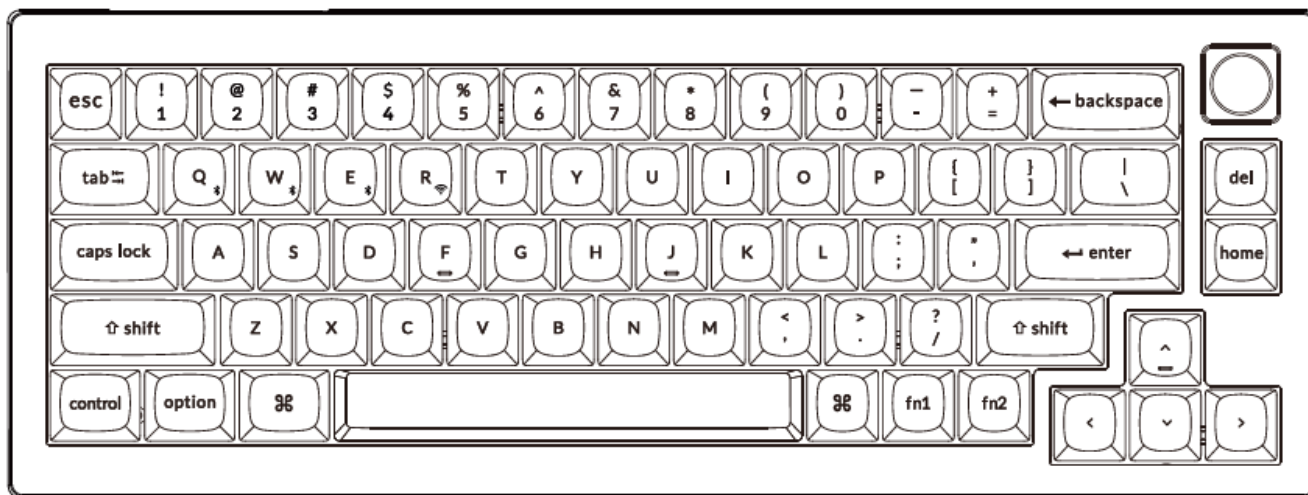

Including

- 1x Case
- 1x PCB
- 1x PC Plate
- 1x PET Foam
- 1x Case Foam
- 1x Sound Absorbing Foam
- 4 Sets x Stabilizers
- 1 Set x Keycaps (PBT Double-shot)
- 1 Set x Switches

Cable

- 1x Type-C to Type-C Cable
- 1x Type-A to Type-C Adapter
- 1x Extension Adapter For Receiver

Receiver

- 1x Type-A 2.4GHz Receiver
- 1x Type-C 2.4GHz Receiver

Tools

- 1x Keycap & Switch Puller
- 1x Screwdriver
- 1x Hex Key

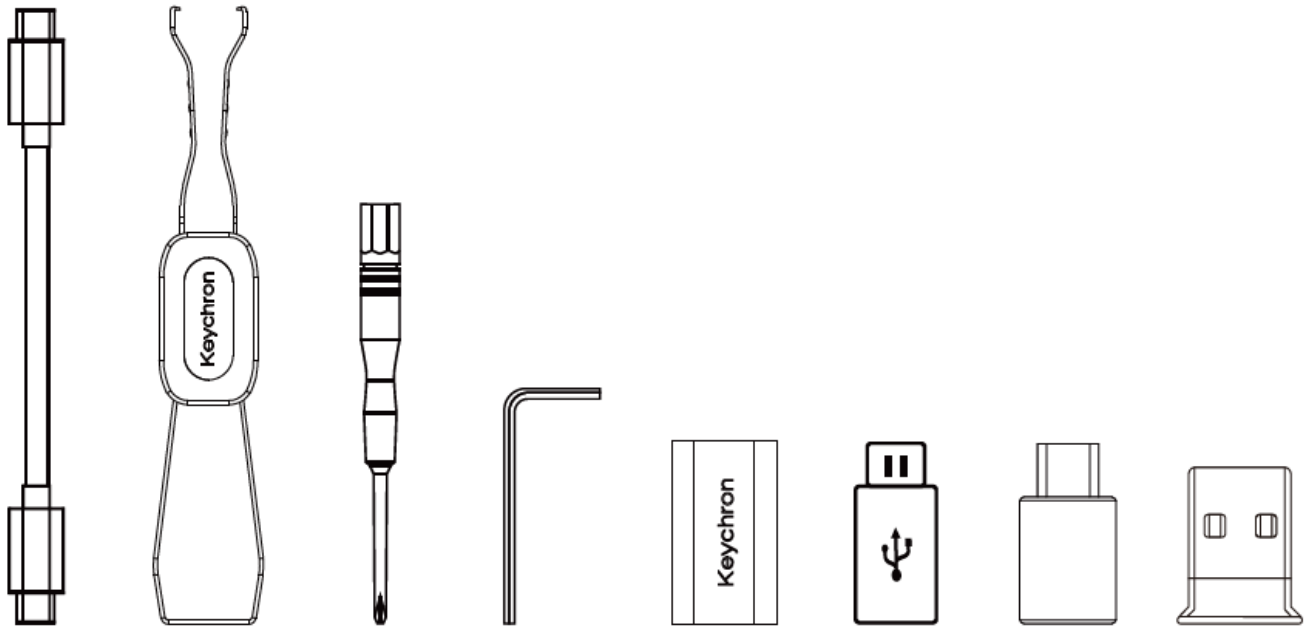

Barebone Version

Keyboard Kit

1x Keyboard Kit (Without Keycaps & Switches)

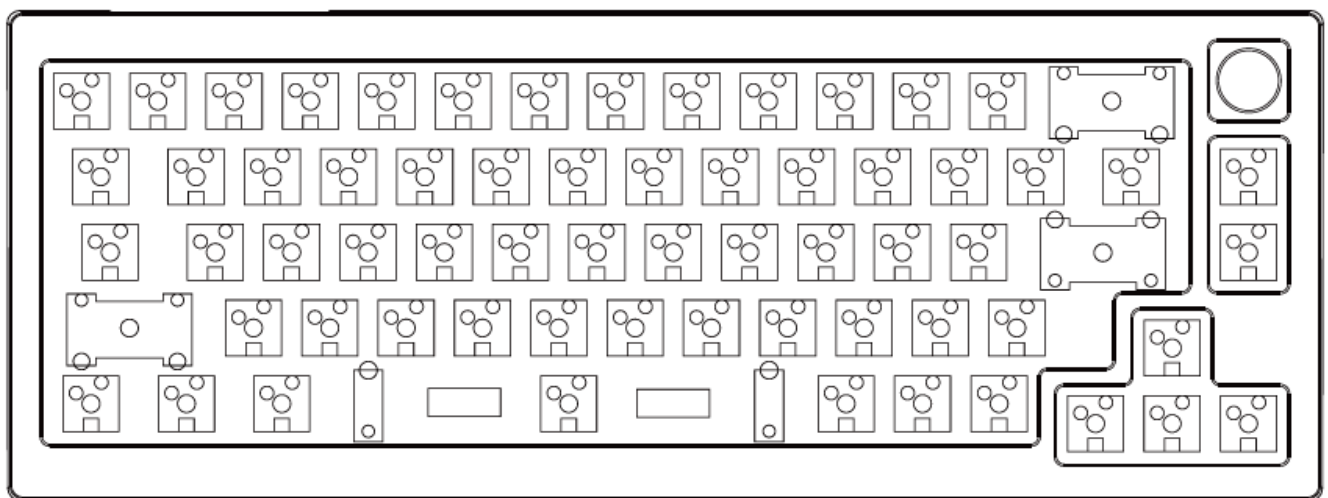

Including

- 1x Case
- 1x PCB
- 1x PC Plate
- 1x PET Foam
- 1x Case Foam
- 1x Sound Absorbing Foam
- 4 Sets x Stabilizers

Cable

- 1x Type-C to Type-C Cable
- 1x Type-A to Type-C Adapter
- 1x Extension Adapter For Receiver

Receiver

- 1x Type-A 2.4GHz Receiver
- 1x Type-C 2.4GHz Receiver

Tools

- 1x Keycap & Switch Puller
- 1x Screwdriver
- 1x Hex Key

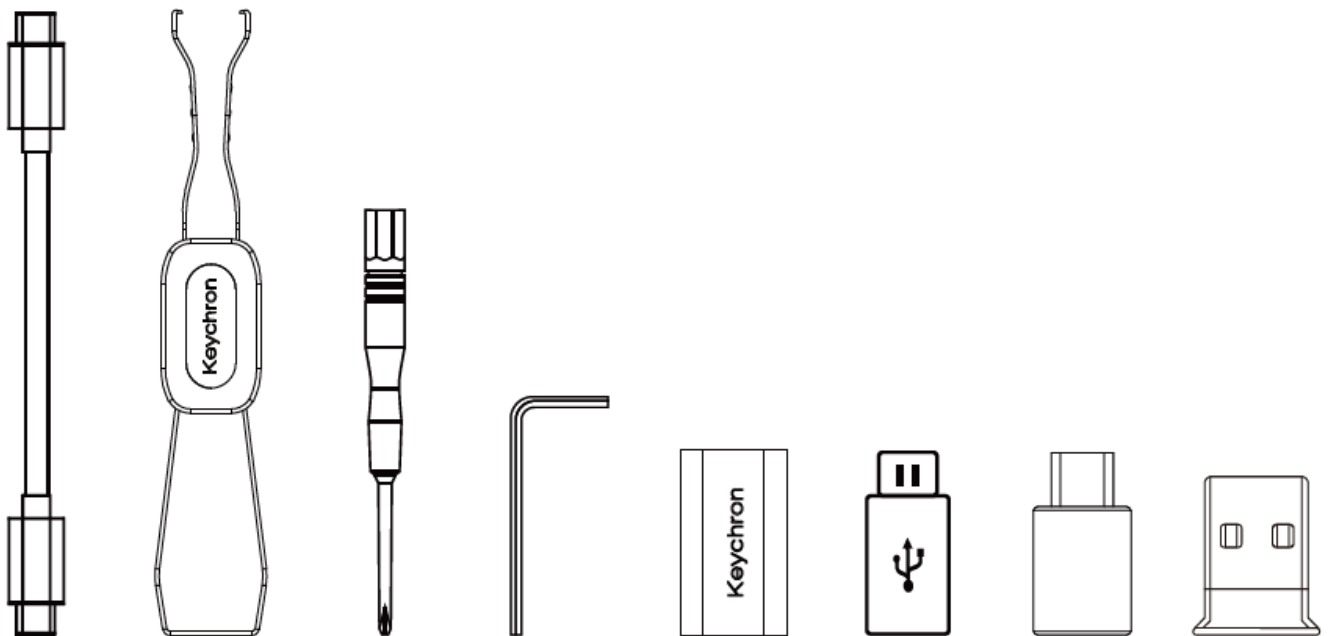

Quick Start Guide

If you are a Windows user, please find the appropriate keycaps in the box, then follow the instructions below to find and replace the following keycaps.

Mac / Windows

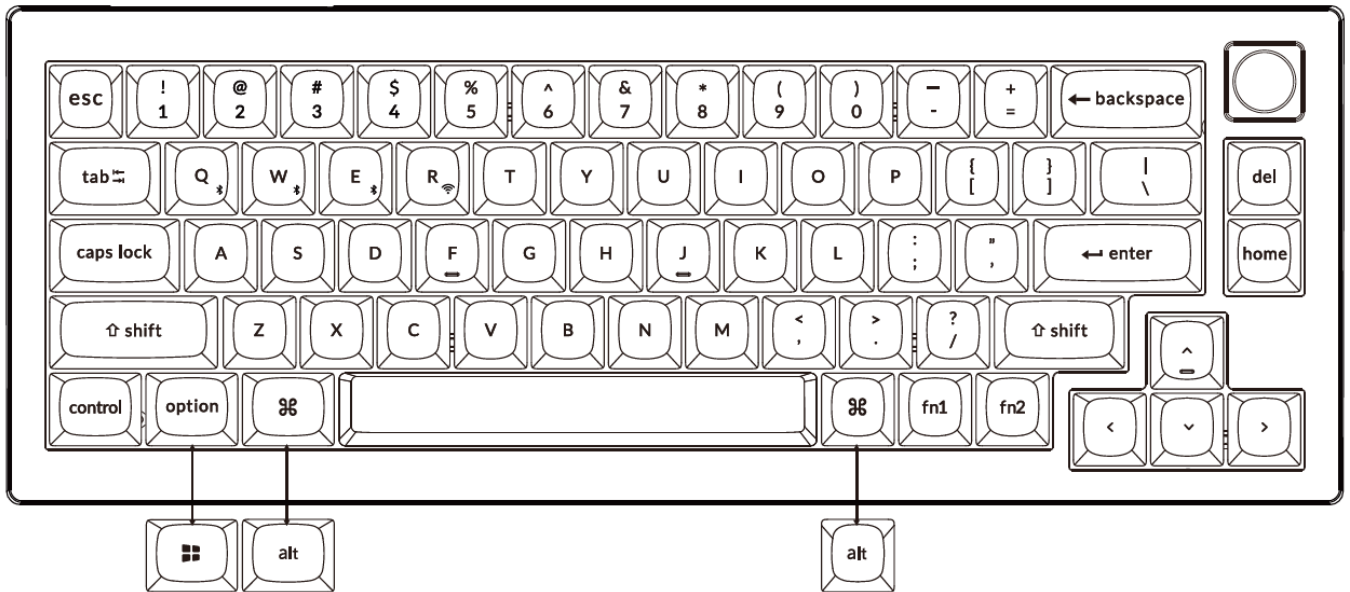

Switch To The Right System

Please make sure the system toggle on the top left corner has been switched to the same system as your computer's operating system.

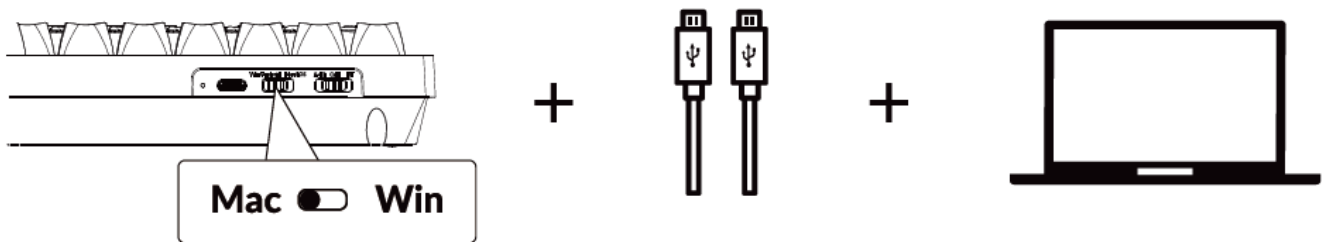

Connect 2.4GHz Receiver

Connect the 2.4GHz receiver to the device USB port.

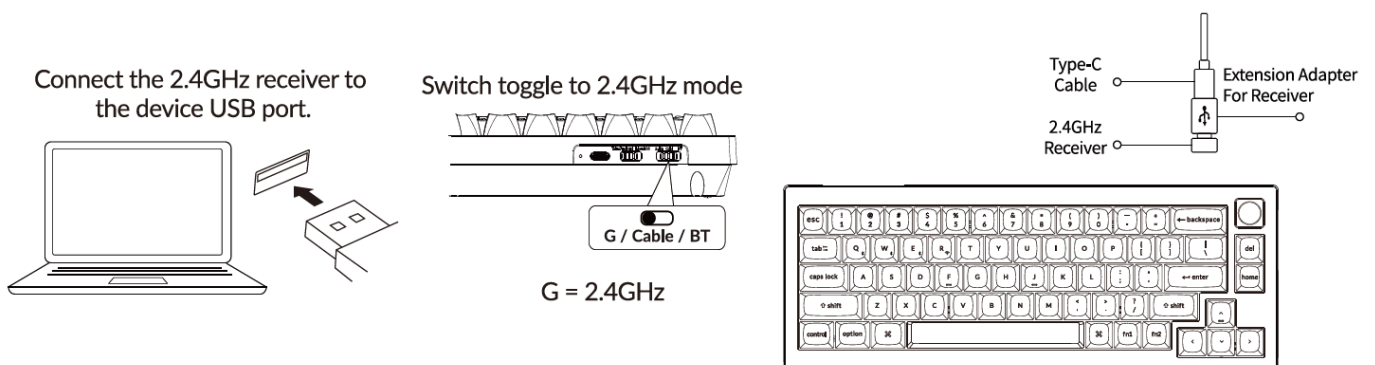

Note: For the best wireless experience, we recommend using the extension adapter for receiver and putting the 2.4GHz receiver somewhere on your desk close to your keyboard for a low rate of latency and fewer signal interferences.

Connect Bluetooth

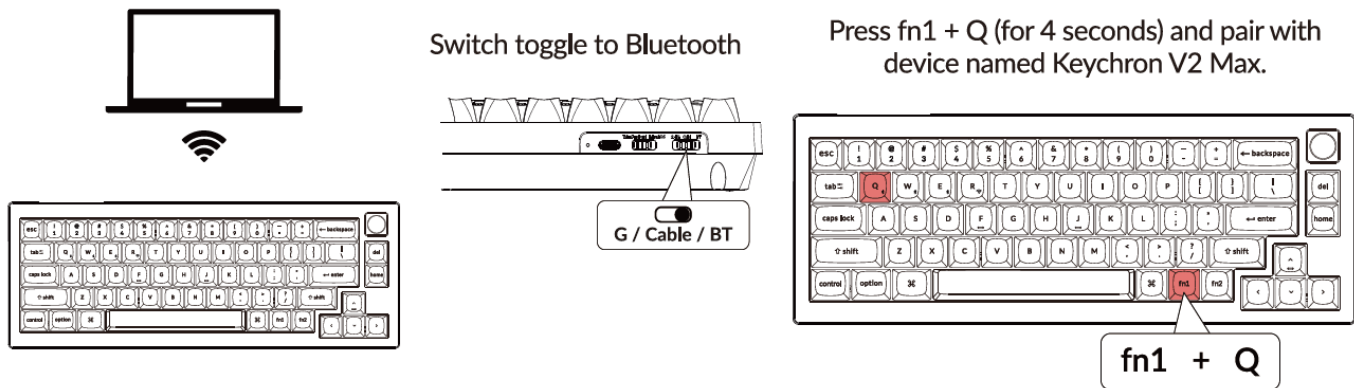

Connect Cable

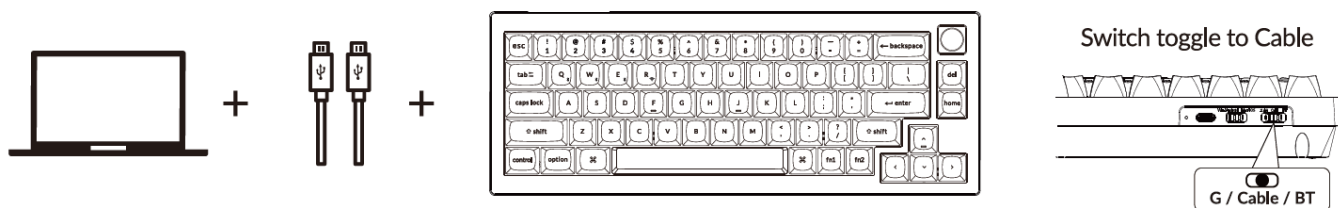

The VIA Key Remapping Software

Please visit usevia.app to use the online VIA software to remap the keys.

If the VIA cannot recognize your keyboard, please reach our support to get the instruction.

The online VIA software can only run on the latest version of Chrome, Edge, and Opera browsers yet. VIA only works when the keyboard is connected by wire to the computer.

The Layers

There are five layers of key settings on the keyboard. The layer 0 is for the Mac system.

The layer 1 is for the Windows system.

The layer 2 is for the Mac Multimedia keys.

The layer 3 is for the Windows Multimedia keys.

The layer 4 is for function keys.

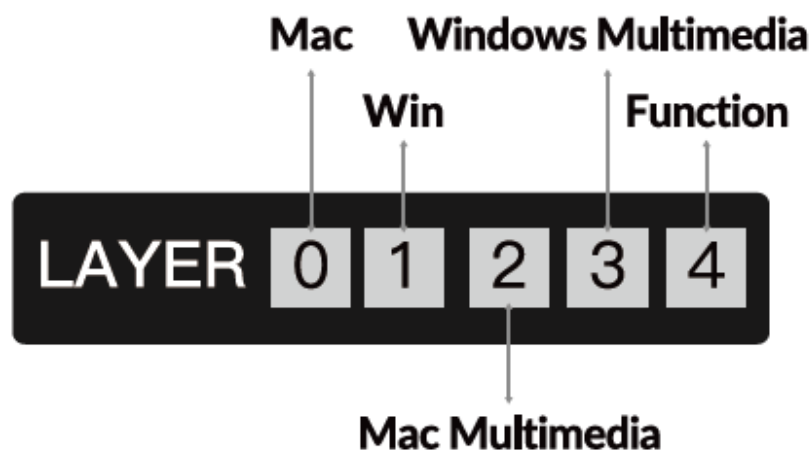

If your system toggle is switched to Mac, then the layer 0 will be activated.



If your system toggle is switched to Windows, then the layer 1 will be activated.



Documents / Resources

 V2 MAX WIRELESS MECHANICAL KEYBOARD USER MANUAL	Keychron V2 Max Wireless Mechanical Keyboard [pdf] User Manual V2 Max, V2 Max Wireless Mechanical Keyboard, Wireless Mechanical Keyboard, Mechanical Keyboard, Keyboard
---	--

References

- [User Manual](#)

[Manuals+](#), [Privacy Policy](#)

This website is an independent publication and is neither affiliated with nor endorsed by any of the trademark owners. The "Bluetooth®" word mark and logos are registered trademarks owned by Bluetooth SIG, Inc. The "Wi-Fi®" word mark and logos are registered trademarks owned by the Wi-Fi Alliance. Any use of these marks on this website does not imply any affiliation with or endorsement.