



# Keychron Q3PRO Bluetooth Mechanical Keyboard User Manual

[Home](#) » [Keychron](#) » Keychron Q3PRO Bluetooth Mechanical Keyboard User Manual 

## Contents

- [1 Keychron Q3PRO Bluetooth Mechanical Keyboard](#)
- [2 Fully Assembled Version](#)
- [3 Barebone Version](#)
- [4 Quick Start Guide](#)
- [5 Troubleshooting? Don't know whafs going on with the keyboard?](#)
- [6 Q3 PRO BLUETOOTH MECHANICAL KEYBOARD OVERVIEW](#)
- [7 Documents / Resources](#)
  - [7.1 References](#)
- [8 Related Posts](#)



## Keychron Q3PRO Bluetooth Mechanical Keyboard



## Fully Assembled Version

- **Keyboard**

- 1x Fully Assembled Keyboard

- **Including**

- 1x Aluminum Case
- 1xPCB
- 1x PC Plate
- 1x Sound Absorbing Foam
- 1xCase Foam
- 16x Gaskets (12 Installed and 4 in the Box) 5 Sets x Stabilizers
- 1 Set x Keycaps (PBT Double-shot )
- 1 Set x Switches

- **Cable**

- 1x Type-C to Type-C Cable
- 1x Type-A to Type-C Adapter

- **Tools**

- 1x Switch Puller
- 1x Keycap Puller
- 1x Screwdriver
- 1xHex Key

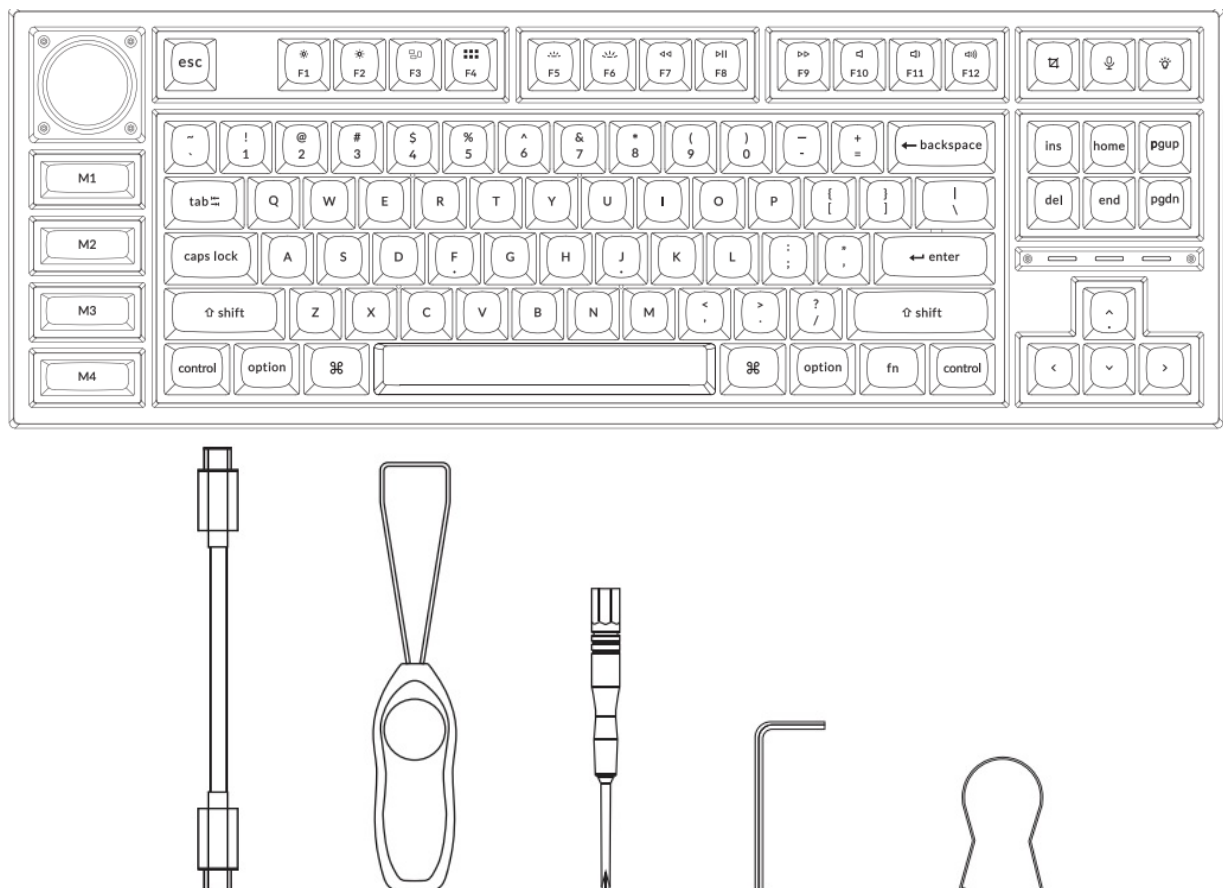

## **Barebone Version**

- **Keyboard Kit**

- 1x Keyboard Kit (Without Keycaps & Switches ) Including

- 1x Aluminum Case
- 1xPCB
- 1x PC Plate
- 1x Sound Absorbing Foam
- 1xCASE Foam
- 16x Gaskets (12 Installed and 4 in the Box)
- S Sets x Stabilizers
- **Cable**
  - 1x Type-C to Type-C Cable
  - 1x Type-A to Type-C Adapter
- **Tools**
  - 1x Switch Puller
  - 1x Keycap Puller
  - 1x Screwdriver
  - 1x Hex Key

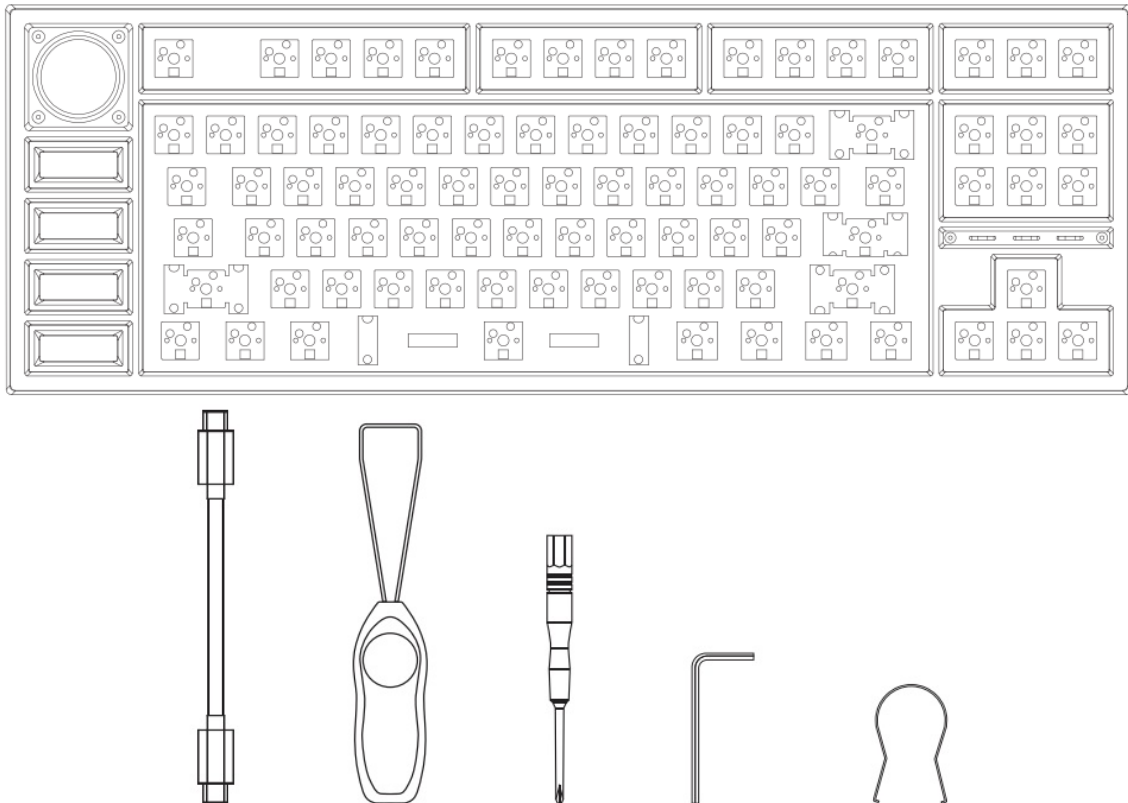

## Quick Start Guide

- If you are a Windows user, please find the appropriate keycaps in the box, then follow the instructions below to find and replace the following keycaps.

Mac / Windows

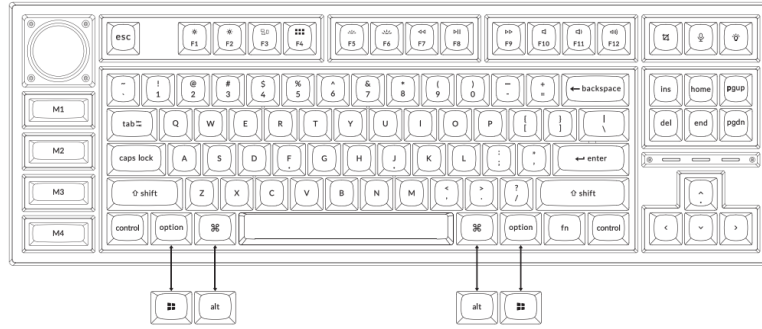

## • Connect Bluetooth

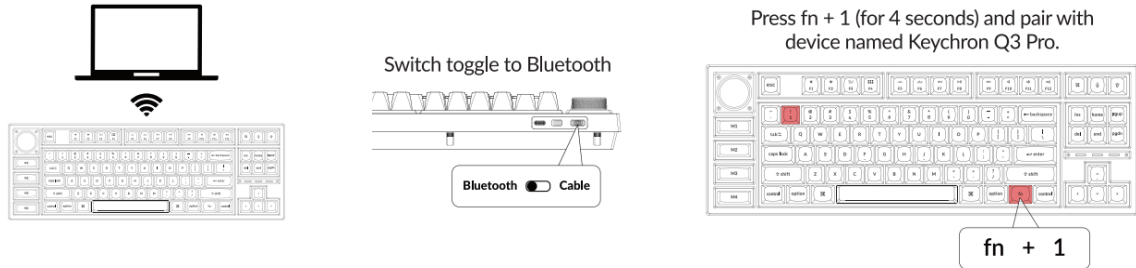

## • Connect Cable

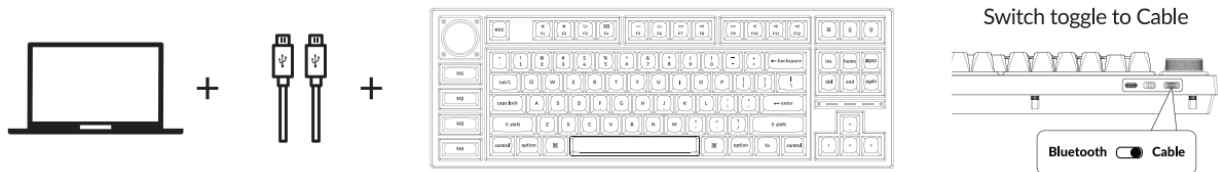

## • The VIA Key Remapping Software

- Please visit [caniusevia.com](https://caniusevia.com) to download the latest VIA software to remap the keys. If the VIA software cannot recognize your keyboard, please reach out to our support to get the instruction. (VIA only works when the keyboard is connected by wire to the computer.)



## • The Layers

- There are four layers of key settings on the keyboard. The layer 0 and layer 1 are for the Mac system. The layer 2 and layer 3 are for the Windows system.

If your system toggle is switched to Mac, then the layer 0 will be activated. If your system toggle is switched to Windows, then the layer 2 will be activated. Remember that if you are using it in Windows mode, please make changes to the layer 2 instead of the top layer (the layer 0). This is a common mistake people are making.

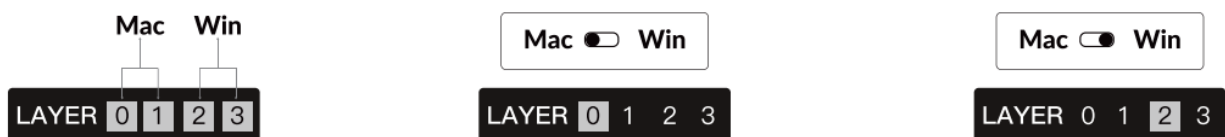

- **The Backlight**

- Press fn + Q to change the lighting effect
- Press fn + tab to turn the backlight on/off



fn + Q



fn + tab

- **Adjust The Backlight Brightness**

- Press fn + W to increase the backlight brightness
- Press fn + S to decrease the backlight brightness

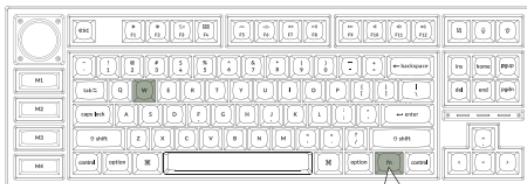

fn + W

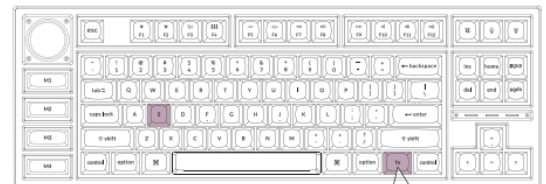

fn + S

- **Adjust The Backlight Speed**

- Press fn + T to increase the light effect speed
- Press fn + G to decrease the light effect speed



fn + T



fn + G

- **Warranty**

- The keyboard is highly customizable and easy to be rebuilt. If anything goes wrong with any of the keyboard components of keyboard during the warranty period, we will only replace the defective parts of the keyboard, not the whole keyboard.

**WARRANTY**

- **Watch The Building Tutorial On Our Website**

- If you are building the keyboard for the first time, we highly recommend you watch the building tutorial video on our website first, then start building the keyboard yourself.



- **Factory Reset**

### **Troubleshooting? Don't know what's going on with the keyboard?**

1. Plug in the power cable and switch the keyboard to Cable mode.
2. Factory reset the keyboard by pressing fn + J + Z (for 4 seconds).
3. Download the right firmware and QMK Toolbox from our website.
4. Switch the keyboard to OFF mode and remove the space bar keycap to find the reset button on the PCB.
5. Hold the reset key first, then switch the keyboard to Cable mode.  
Release the reset key, and the keyboard will now enter DFU mode.
6. Flash the firmware with the QMK Toolbox.
7. Factory reset the keyboard again by pressing fn + J + Z (for 4 seconds).

Step by step guide can be found on our website.

### **Q3 PRO BLUETOOTH MECHANICAL KEYBOARD SPECIFICATIONS**

- **Number of keys:** 91
- **Switch type:** Mechanical
- **Battery:** 4000mAh
- **Bluetooth working time** (RGB): Up to 100 hours (Lowest brightness)
- **Charging time:** Around 5 hours
- **Charging port:** USB Type-C
- **Mode:** Bluetooth / Wired
- **Bluetooth operating distance:** Within 10 meters (open space)
- **Name of Bluetooth device:** Keychron Q3 Pro

**Operating environment:** -10 to 50°C

- Technical specifications can be subjected to change without notice, we apologize for any inconvenience caused.

### **Q3 PRO BLUETOOTH MECHANICAL KEYBOARD OVERVIEW**

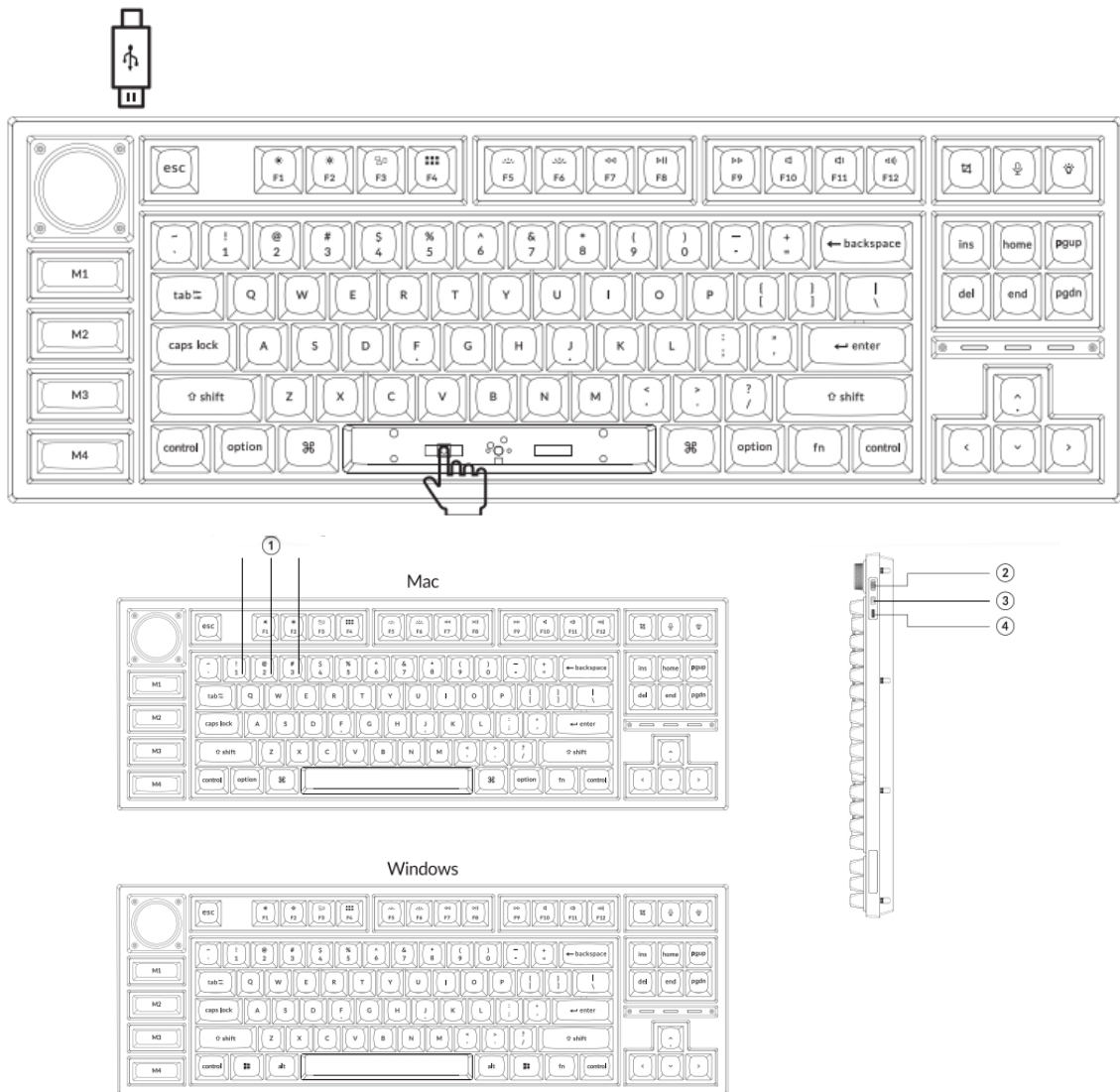

1. Bluetooth indicator
2. BT OFF Cable (Mode Toggle Switch)
3. Win/Android Mac/IOS (OS Toggle Switch)
4. Charging port

## Documents / Resources

 <small>Q3 Pro Bluetooth Mechanical Keyboard</small>	<p><a href="#">Keychron Q3PRO Bluetooth Mechanical Keyboard</a> [pdf] User Manual</p> <p>Q3PRO Bluetooth Mechanical Keyboard, Q3PRO, Bluetooth Mechanical Keyboard, Mechanical Keyboard, Keyboard</p>
--	---

## References

- [User Manual](#)

